

STATE OF ILLINOIS  
 DEPARTMENT OF TRANSPORTATION  
 DIVISION OF HIGHWAYS

**PROPOSED  
 HIGHWAY PLANS**

F.A.P. ROUTE 880: IL 131 (GREENBAY RD.)  
 WISCONSIN STATE LINE (RUSSELL RD.) TO IL 173 (ROSECRANS RD.)  
 SECTION: 32RS-6  
 RESURFACING  
 LAKE COUNTY  
 C-91-047-14

F.A.P. RTE.	SECTION	COUNTY	TOTAL SHEETS	SHEET NO.
880	32RS-6	LAKE	26	1
		ILLINOIS	CONTRACT NO. 60X26	

FOR INDEX OF SHEETS, SEE SHEET NO. 2

THIS IMPROVEMENT IS LOCATED IN THE CITY OF ZION

**TRAFFIC DATA**

ADT (2011) = 13800  
 POSTED SPEED LIMIT = 45 MPH - 55 MPH

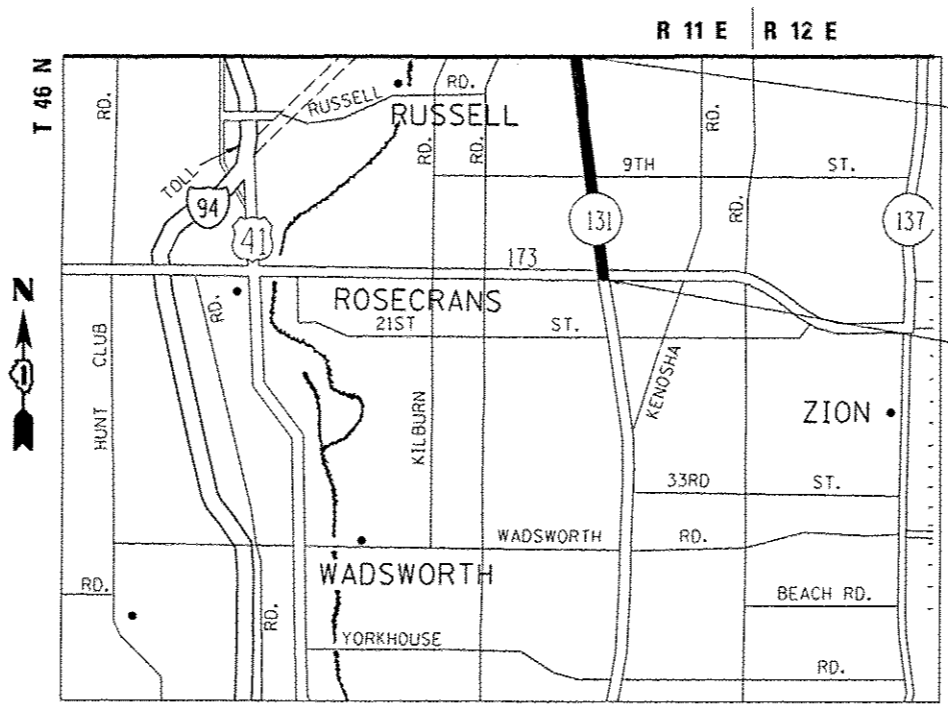

IMPROVEMENT ENDS  
 STA: 128 + 20

IMPROVEMENT BEGINS  
 STA: 19 + 70

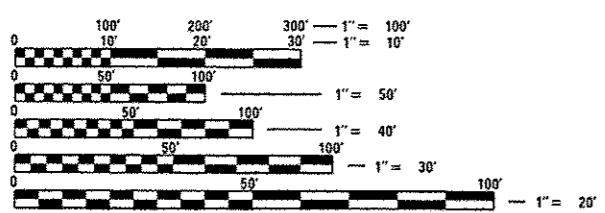

FULL SIZE PLANS HAVE BEEN PREPARED USING STANDARD ENGINEERING SCALES. REDUCED SIZED PLANS WILL NOT CONFORM TO STANDARD SCALES. IN MAKING MEASUREMENTS ON REDUCED PLANS, THE ABOVE SCALES MAY BE USED.

J.U.L.I.E.  
 JOINT UTILITY LOCATION INFORMATION FOR EXCAVATION  
 1-800-892-0123  
 OR 811

PROJECT ENGINEER: J. ALAIN MIDY (847) 221-3056  
 PROJECT MANAGER: ISSAM RAYYAN (847) 705-4178

GROSS & NET LENGTH = 10850 FT. = 2.06 MILES

CONTRACT NO. 60X26

STATE OF ILLINOIS  
 DEPARTMENT OF TRANSPORTATION  
 DIVISION OF HIGHWAYS

SUBMITTED December 9, 2013  
John Fortmann, PE  
 DEPUTY DIRECTOR OF HIGHWAYS, REGION ENGINEER

Jan 24, 2014  
John D. Baranzelli, PE  
 ENGINEER OF DESIGN AND ENVIRONMENT

Jan 24, 2014  
Omer Osman, PE  
 DIRECTOR OF HIGHWAYS, CHIEF ENGINEER

PRINTED BY THE AUTHORITY  
 OF THE STATE OF ILLINOIS