

DETECTOR LOOPS SHALL BE INSTALLED
AFTER BINDER IS INSTALLED BUT BEFORE
SURFACE COURSE IS INSTALLED

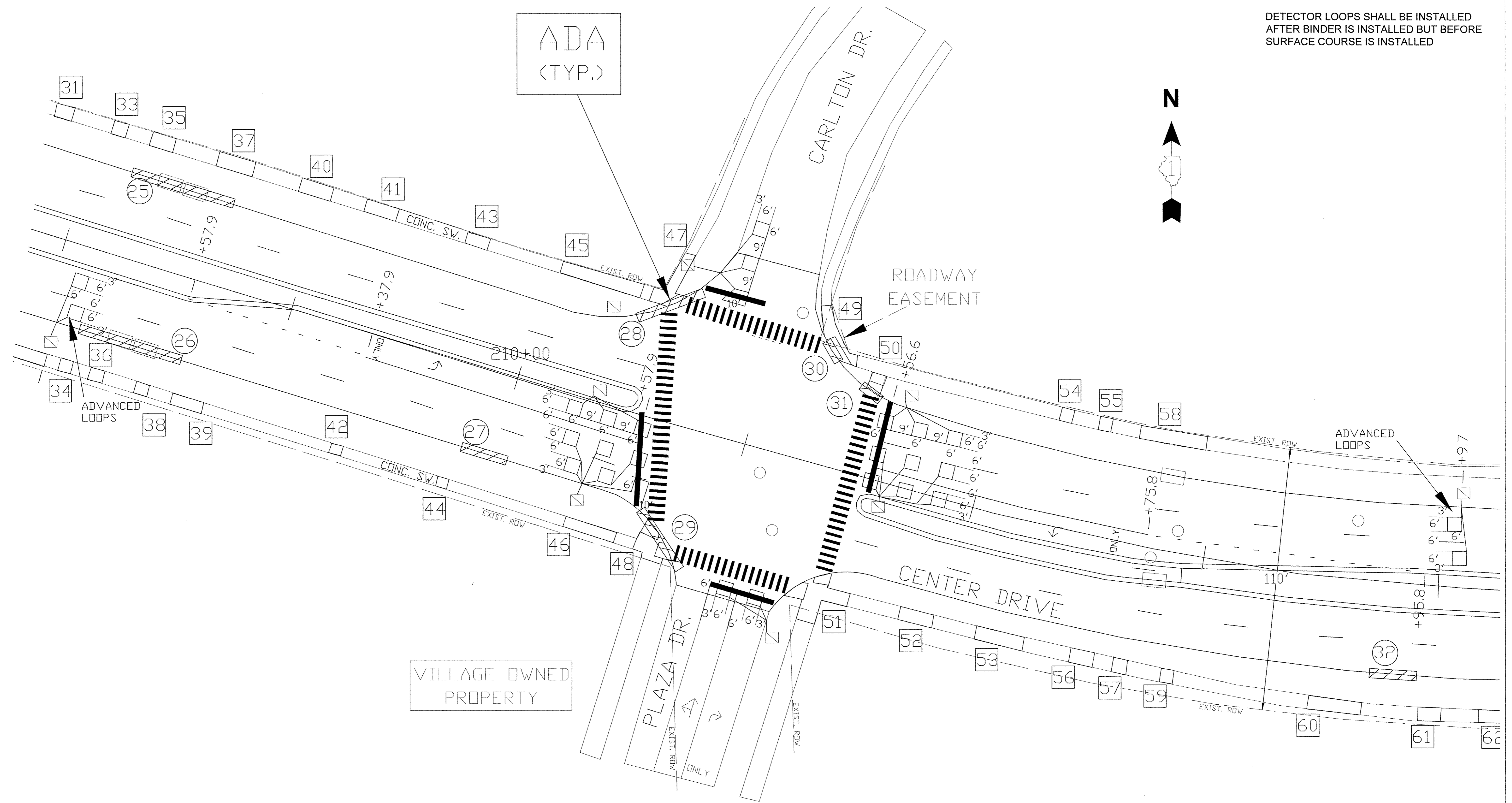
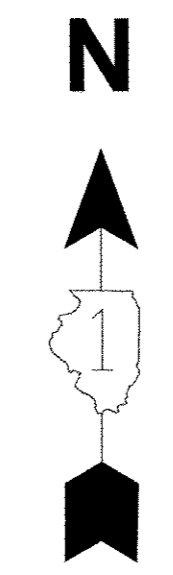

VILLAGE OF WOODRIDGE DEPARTMENT OF PUBLIC WORKS 1 Plaza Drive, Woodridge IL 60517 (630) 719-4750	DESIGNED - AF	REVISED -	STATE OF ILLINOIS DEPARTMENT OF TRANSPORTATION	PLAZA DRIVE, CARLTON DRIVE DETECTOR LOOP PLAN	F.A.U. RTE.	SECTION	COUNTY	TOTAL SHEETS	SHEET NO.		
	DRAWN - AF				3573	11-00068-00-RS	DUPAGE	17	9		
	CHECKED -				CONTRACT NO. 63894						
	DATE -				ILLINOIS FEDERAL AID PROJECT						
				SCALE: 1"=20'	STA. 210+50						