

FOR INDEX OF SHEETS, SEE SHEET NO. 2

FOR INDEX OF HIGHWAY STANDARDS, SEE SHEET NO. 2

PROJECT LOCATED IN THE VILLAGE OF ITASCA

STATE OF ILLINOIS
 DEPARTMENT OF TRANSPORTATION
 DIVISION OF HIGHWAYS
**PLANS FOR PROPOSED
 FEDERAL AID HIGHWAY
 FAU 2997 (PARK BOULEVARD)**
 THORNDALE AVENUE TO DEVON AVENUE (FAU 1346)
 RESURFACING

PROJECT NO.: M-4003(243)
 SECTION NO.: 13-00061-00-RS
 VILLAGE OF ITASCA
 DUPAGE COUNTY
 C-91-093-14

F.A.U. RTE.	SECTION	COUNTY	TOTAL SHEETS	SHEET NO.
2997	13-00061-00-RS	DUPAGE	25	1
STA.	TO STA.			
FED. ROAD DIST. NO 1	ILLINOIS	FED AID PROJECT		
CONTRACT NO. 63895				



LOCATION OF SECTION INDICATED THUS: [Black box symbol]

BEGIN RESURFACING
 PARK BOULEVARD
 STA 1+12

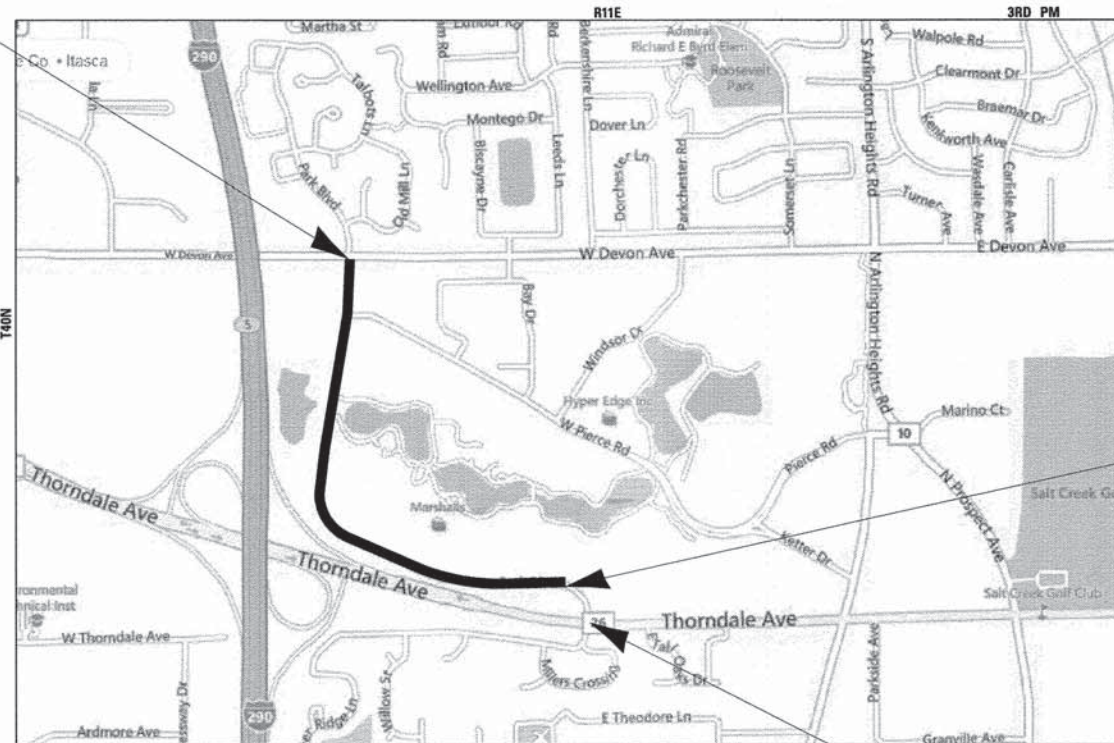

END RESURFACING
 BEGIN OMISSION
 PARK BOULEVARD
 STA 44+62

END OMISSION
 PARK BOULEVARD
 STA 50+97

COPYRIGHT 2013, BY BAXTER & WOODMAN, INC.
 STATE OF ILLINOIS - PROFESSIONAL DESIGN FIRM
 LICENSE NO. - 184-001121 - EXPIRES 4/30/2015

TRAFFIC DATA
PARK BOULEVARD
 POSTED & DESIGN SPEED LIMIT = 30 MPH
 ADT = 11,100
 FUNCTIONAL CLASSIFICATION = MAJOR COLLECTOR

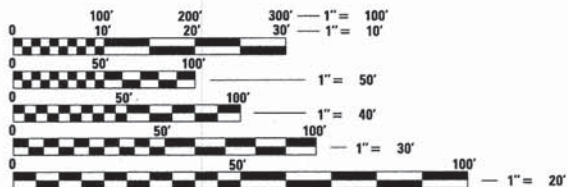

FULL SIZE PLANS HAVE BEEN PREPARED USING STANDARD
 ENGINEERING SCALES. REDUCED SIZED PLANS WILL NOT
 CONFORM TO STANDARD SCALES. IN MAKING MEASUREMENTS
 ON REDUCED PLANS, THE ABOVE SCALES MAY BE USED.

J.U.L.I.E. DESIGN STAGE REQUEST
 DIG. No. X0570650



CONTACT JULIE AT 811 OR 800-892-0123
 WITH THE FOLLOWING:
 COUNTY = DUPAGE
 CITY-TWNSHP. = ITASCA-ADDISON
 SEC. & 1/4 SEC. NO. = SEC 5 & E SEC 6
 48 HOURS (2 working days) BEFORE YOU DIG

ADDISON TOWNSHIP
 LOCATION MAP
 (NOT TO SCALE)
 ADDISON TOWNSHIP
 GROSS LENGTH OF RESURFACING = 4,997 LF OR 0.946 MILES
 LENGTH OF RESURFACING OMISSION = 647 LF OR 0.123 MILES
 NET LENGTH OF RESURFACING = 4,350 LF OR 0.824 MILES

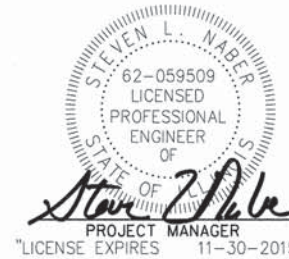

STATE OF ILLINOIS
 DEPARTMENT OF TRANSPORTATION
 DIVISION OF HIGHWAYS

APPROVED *[Signature]*
 12/03/2013
 VILLAGE OF ITASCA

PASSED *[Signature]* C.J. HOLT
 DISTRICT ENGINEER OF LOCAL ROADS AND STREETS

RELEASING FOR BID
 BASED ON LIMITED
 REVIEW *[Signature]* December 17 2013
 DEPUTY DIRECTOR OF HIGHWAYS, REGION 1 ENGINEER

PRINTED BY THE AUTHORITY
 OF THE STATE OF ILLINOIS

CONTRACT NO. 63895

COPYRIGHT © 2013 BY BAXTER & WOODMAN, INC.
 LICENSE NO. 184-001121 - EXPIRES 4/30/2015
 PROGRAM AND OFFICE ENGINEER: CHARLES F. RIDDLE, P.E. 847-705-4406 SCHAUMBURG, IL

SUMMARY OF QUANTITIES

SUMMARY OF QUANTITIES						CONSTRUCTION TYPE CODE
						0005
						PARTICIPATING
SPECIAL PROVISION	SPECIALTY ITEM	CODE NUMBER	DESCRIPTION	UNITS	TOTAL QUANTITY	PARK BOULEVARD
		21101615	TOPSOIL FURNISH AND PLACE, 4"	SQ YD	1,000	1,000
		25000400	NITROGEN FERTILIZER NUTRIENT	POUND	19	19
		25000500	PHOSPHORUS FERTILIZER NUTRIENT	POUND	19	19
		25000600	POTASSIUM FERTILIZER NUTRIENT	POUND	19	19
		25200100	SODDING	SQ YD	1,000	1,000
		25200200	SUPPLEMENTAL WATERING	UNIT	100	100
X		30300104	AGGREGATE SUBGRADE IMPROVEMENT 4"	SQ YD	1,598	1,598
		35501300	HOT-MIX ASPHALT BASE COURSE, 4"	SQ YD	91	91
		35501316	HOT-MIX ASPHALT BASE COURSE, 8"	SQ YD	293	293
		40600200	BITUMINOUS MATERIALS (PRIME COAT)	TON	10	10
		40600300	AGGREGATE (PRIME COAT)	TON	53	53
		40600400	MIXTURE FOR CRACKS, JOINTS, AND FLANGWAYS	TON	8	8
		40600827	POLYMERIZED LEVELING BINDER (MACHINE METHOD), IL-4.75, N50	TON	1,316	1,316
		40600895	CONSTRUCTING TEST STRIP	EACH	2	2
		40600982	HOT-MIX ASPHALT SURFACE REMOVAL - BUTT JOINT	SQ YD	94	94
		40603335	HOT-MIX ASPHALT SURFACE COURSE, MIX "D", N50	TON	48	48
		40603340	HOT-MIX ASPHALT SURFACE COURSE, MIX "D", N70	TON	2,924	2,924
		42400200	PORTLAND CEMENT CONCRETE SIDEWALK 5 INCH	SQ FT	160	160
		42400800	DETECTABLE WARNINGS	SQ FT	48	48
		44000159	HOT-MIX ASPHALT SURFACE REMOVAL, 2 1/2"	SQ YD	26,106	26,106
		44000200	DRIVEWAY PAVEMENT REMOVAL	SQ YD	293	293
		44000500	COMBINATION CURB AND GUTTER REMOVAL	FOOT	3,700	3,700
		44201761	CLASS D PATCHES, TYPE I, 10 INCH	SQ YD	75	75
		44201765	CLASS D PATCHES, TYPE II, 10 INCH	SQ YD	225	225
		44201769	CLASS D PATCHES, TYPE III, 10 INCH	SQ YD	150	150
		44201771	CLASS D PATCHES, TYPE IV, 10 INCH	SQ YD	4,350	4,350
		50800205	REINFORCEMENT BARS, EPOXY COATED	POUND	677	677
		60107700	PIPE UNDERDRAINS 6"	FOOT	210	210
		60201340	CATCH BASINS, TYPE A, 4'-DIAMETER, TYPE 24 FRAME AND GRATE	EACH	1	1
		60404950	FRAMES AND GRATES, TYPE 24	EACH	1	1

© 2013 BY BAXTER & WOODMAN, INC.
 ALL RIGHTS RESERVED.
 LICENSE NO. 384-00121 - EXPIRES 4/30/2015
 2/6/2013 8:42:27 AM
 I:\06\06\13\130089\SH_S00_Park.sht
 I:\06\06\13\130089\SH_S00_Park.sht



DESIGNED - JGH	REVISED -
DRAWN - CJC	REVISED -
CHECKED - SLN	REVISED -
DATE - 11/11/13	FILE - 130089.SH_S00_Park.sht

**STATE OF ILLINOIS
DEPARTMENT OF TRANSPORTATION**

SUMMARY OF QUANTITIES	
SCALE:	STA. TO STA.

F.A.U. RTE.	SECTION	COUNTY	TOTAL SHEETS	SHEET NO.
2997	13-00061-00-RS		25	3
CONTRACT NO. 63895			ILLINOIS FED. AID PROJECT	

SUMMARY OF QUANTITIES

SUMMARY OF QUANTITIES					CONSTRUCTION TYPE CODE	
					0005	
					PARTICIPATING	
SPECIAL PROVISION	SPECIALTY ITEM	CODE NUMBER	DESCRIPTION	UNITS	TOTAL QUANTITY	PARK BOULEVARD
		60500050	REMOVING CATCH BASINS	EACH	1	1
		60603800	COMBINATION CONCRETE CURB AND GUTTER, TYPE B-6.12	FOOT	900	900
		60605000	COMBINATION CONCRETE CURB AND GUTTER, TYPE B-6.24	FOOT	2,800	2,800
		67100100	MOBILIZATION	L SUM	1	1
		70102630	TRAFFIC CONTROL AND PROTECTION, STANDARD 701601	L SUM	1	1
		70102635	TRAFFIC CONTROL AND PROTECTION, STANDARD 701701	L SUM	1	1
		70102640	TRAFFIC CONTROL AND PROTECTION, STANDARD 701801	L SUM	1	1
		70106800	CHANGEABLE MESSAGE SIGN	CAL MO	9	9
		70300100	SHORT TERM PAVEMENT MARKING	FOOT	2,500	2,500
		70301000	WORK ZONE PAVEMENT MARKING REMOVAL	SQ FT	825	825
	X	78000100	THERMOPLASTIC PAVEMENT MARKING - LETTERS AND SYMBOLS	SQ FT	322	322
	X	78000200	THERMOPLASTIC PAVEMENT MARKING - LINE 4"	FOOT	2,130	2,130
	X	78000400	THERMOPLASTIC PAVEMENT MARKING - LINE 6"	FOOT	1,333	1,333
	X	78000650	THERMOPLASTIC PAVEMENT MARKING - LINE 24"	FOOT	132	132
X	X	85000200	MAINTENANCE OF EXISTING TRAFFIC SIGNAL INSTALLATION	EACH	2	2
X	X	88600100	DETECTOR LOOP, TYPE I	FOOT	700	700
X	X	89502376	REBUILD EXISTING HANDHOLE	EACH	1	1
X		X0323117	LANDSCAPING GRAVEL	SQ YD	25	25
X		X0326883	BRICK SIDEWALK	SQ FT	50	50
X		X0327036	BIKE PATH REMOVAL	SQ YD	93	93
X		X4403300	CONCRETE MEDIAN REMOVAL	SQ FT	500	500
X		X6060714	CONCRETE MEDIAN (SPECIAL)	SQ FT	500	500
X		X7240600	REMOVE AND RE-ERECT EXISTING SIGN	EACH	2	2
X		Z0018400	DRAINAGE STRUCTURES TO BE ADJUSTED	EACH	36	36
X		Z0018600	DRAINAGE STRUCTURES TO BE RECONSTRUCTED	EACH	3	3
X		Z0030850	TEMPORARY INFORMATION SIGNING	SQ FT	78	78
X		Z0062456	TEMPORARY PAVEMENT	SQ YD	250	250
X		XX001621	BRICK PAVER REMOVAL	SQ FT	201	201
X	X	XX008171	SPRINKLER SYSTEM REPAIR	L SUM	1	1

COPYRIGHT © 2011 BY BAXTER & WOODMAN, INC.
 ALL RIGHTS RESERVED.
 LICENSE NO. 184-00021 - EXPIRES 4/30/2015
 11/06/2013 11:45:00 AM
 I:\06\06\11\13\130089\SH_S00_Park.sht



DESIGNED - JGH	REVISED - 12/17/13 PER IDOT
DRAWN - CJC	REVISED -
CHECKED - SLN	REVISED -
DATE - 11/11/13	FILE - 130089.SH_S00_Park.sht

**STATE OF ILLINOIS
DEPARTMENT OF TRANSPORTATION**

SUMMARY OF QUANTITIES	
SCALE:	STA. TO STA.

F.A.U. RTE.	SECTION	COUNTY	TOTAL SHEETS	SHEET NO.
2997	13-00061-00-RS	DUPAGE	25	4
CONTRACT NO. 63895				
FED. ROAD DIST. NO. 1 ILLINOIS FED. AID PROJECT				

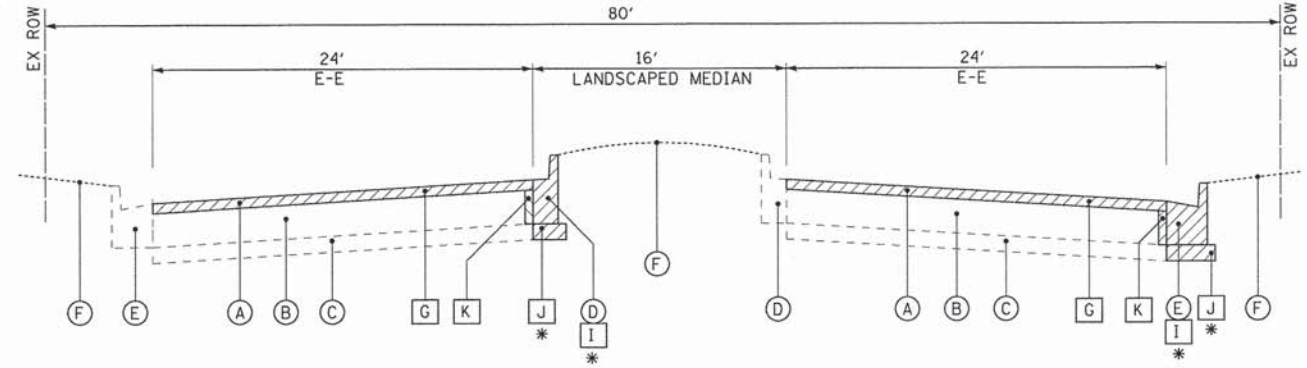

EXISTING TYPICAL SECTION
PARK BOULEVARD
STA 1+12 TO STA 44+62
NOT TO SCALE

* AS INDICATED ON THE PLANS OR AS DETERMINED BY THE ENGINEER IN THE FIELD DURING CONSTRUCTION

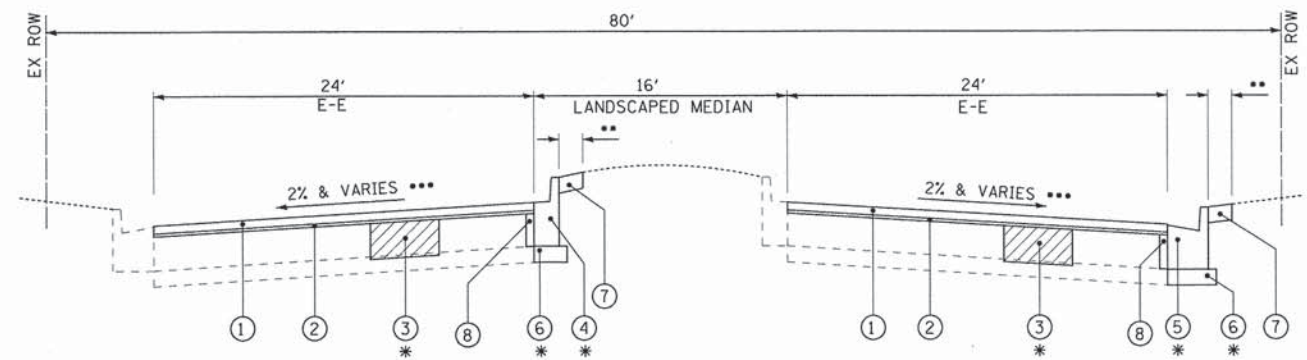

PROPOSED TYPICAL SECTION
PARK BOULEVARD
STA 1+12 TO STA 44+62
NOT TO SCALE

* AS INDICATED ON THE PLANS OR AS DETERMINED BY THE ENGINEER IN THE FIELD DURING CONSTRUCTION
** 2' MAXIMUM OR AS DETERMINED BY THE ENGINEER IN THE FIELD DURING CONSTRUCTION
*** CONTRACTOR SHALL MATCH EXISTING CROSS SLOPE OF PAVEMENT AND GUTTER IN ORDER TO MAINTAIN EXISTING SUPER ELEVATION.

HOT-MIX ASPHALT MIXTURE REQUIREMENTS NOTES:

- CONTRACTOR SHALL MILL BEFORE PATCHING.

HOT-MIX ASPHALT MIXTURE REQUIREMENTS

MIXTURE TYPE	AIR VOIDS @ Ndes
RESURFACING	
HOT-MIX ASPHALT SURFACE COURSE, MIX "D", N70 (IL 9.5mm); 2"	4% @ 70 GYR.
POLYMERIZED LEVELING BINDER (MACHINE METHOD), IL-4.75, N50; 3/4"	3.5% @ 50 GYR.
PATCHING	
CLASS D PATCHES (HMA BINDER IL-19 mm); 10-INCH (3 LIFTS)	4% @ 70 GYR.
HOT-MIX ASPHALT DRIVEWAY PAVEMENT	
HOT-MIX ASPHALT SURFACE COURSE, MIX "D", N50 (IL 9.5mm); 2"	4% @ 50 GYR.
HOT-MIX ASPHALT BASE COURSE (HMA BINDER IL-19mm); 8" (2 LIFTS)	4% @ 50 GYR.
BIKE PATH PAVEMENT	
HOT-MIX ASPHALT SURFACE COURSE, MIX "D", N50 (IL 9.5mm); 2"	4% @ 50 GYR.
HOT-MIX ASPHALT BASE COURSE (HMA BINDER IL-19mm); 4"	4% @ 50 GYR.
TEMPORARY PAVEMENT	
HOT-MIX ASPHALT BINDER COURSE, IL-19.0, N50; 2 1/4"	4% @ 50 GYR.

THE UNIT WEIGHT USED TO CALCULATE ALL HMA SURFACE MIXTURE QUANTITIES IS 112 LBS/SQ YD/IN.
THE "AC TYPE" FOR POLYMERIZED HMA MIXES SHALL BE "SBS/SBR PG 76-22" AND FOR NON-POLYMERIZED HMA THE "AC TYPE" SHALL BE "PG 64-22" UNLESS MODIFIED BY DISTRICT ONE SPECIAL PROVISIONS.
FOR "PERCENT OF RAP" SEE SPECIAL PROVISIONS.

EXISTING LEGEND

- (A) HOT-MIX ASPHALT SURFACE COURSE, VARIES 1 1/2" TO 3" (AVERAGES 2 1/2")
- (B) HOT-MIX ASPHALT BINDER COURSE, VARIES 7" TO 12" (AVERAGES 8 1/2")
- (C) AGGREGATE SUBBASE, VARIES 0" TO 6" (AVERAGES 4")
- (D) COMBINATION CONCRETE CURB AND GUTTER, TYPE B-6.12
- (E) COMBINATION CONCRETE CURB AND GUTTER, TYPE B-6.24
- (F) GROUND SURFACE
- (G) HOT-MIX ASPHALT SURFACE REMOVAL, 2 1/2" (REMOVE 2 3/4" ALONG ALL PITCH OUT GUTTERS) (AS INCLUDED IN THE COST OF HOT-MIX ASPHALT SURFACE REMOVAL, 2 1/2")
- (I) COMBINATION CURB AND GUTTER REMOVAL
- (J) SUBBASE OR SUBGRADE REMOVAL (INCLUDED IN THE COST OF AGGREGATE SUBGRADE IMPROVEMENT 4")
- (K) PAVEMENT, BASE, SUBBASE AND SUBGRADE REMOVAL NECESSARY FOR CURB AND GUTTER REPLACEMENT- 6" MINIMUM WIDTH (INCLUDED IN THE COST OF COMBINATION CURB AND GUTTER REMOVAL).
- ▨ ITEM TO BE REMOVED

PROPOSED LEGEND

- (1) HOT-MIX ASPHALT SURFACE COURSE, MIX "D", N70 - 2"
- (2) POLYMERIZED LEVELING BINDER (MACHINE METHOD), IL-4.75, N50 - 3/4"
- (3) CLASS D PATCHES, TYPE I - IV, 10 INCH
- (4) COMBINATION CONCRETE CURB AND GUTTER, TYPE B-6.12
- (5) COMBINATION CONCRETE CURB AND GUTTER, TYPE B-6.24
- (6) AGGREGATE SUBGRADE IMPROVEMENT, 4"
- (7) TOPSOIL FURNISH AND PLACE, 4" AND SODDING
- (8) CLASS SI CONCRETE BACKFILL TO 2 1/2" BELOW THE PROPOSED GUTTER FLAG (INCLUDED IN THE COST OF COMBINATION CONCRETE CURB AND GUTTER CONSTRUCTION)

COPYRIGHT © 2013 BY BAXTER & WOODMAN, INC. STATE OF ILLINOIS PROFESSIONAL ENGINEERING REGISTRATION BOARD, REG. NO. 1218-0031. PROJECT NO. 13-00061-00-RS. SHEET 25 OF 25. DATE: 11/11/13. DRAWN BY: CJC. CHECKED BY: SLN. DATE: 11/11/13.

BAXTER & WOODMAN
Consulting Engineers

DESIGNED - JGH	REVISED -
DRAWN - CJC	REVISED -
CHECKED - SLN	REVISED -
DATE - 11/11/13	FILE - 130089.SH_TypSec_Park.sh

STATE OF ILLINOIS
DEPARTMENT OF TRANSPORTATION

TYPICAL SECTIONS AND
HOT-MIX ASPHALT MIXTURE REQUIREMENTS

SCALE: STA. TO STA.

F.A.U. RTE.	SECTION	COUNTY	TOTAL SHEETS	SHEET NO.
2997	13-00061-00-RS	DUPAGE	25	5
CONTRACT NO. 63895			FED. ROAD DIST. NO. 1 (ILLINOIS) FED. AID PROJECT	

SCHEDULE OF MATERIALS

Table with 6 columns: STATION, STATION, LOCATION, REMOVAL LENGTH (FT), TYPE B-6.12 LENGTH (FT), TYPE B-6.24 LENGTH (FT). Rows include various stationing and locations like LT, RT, and RT MEDIAN.

Table with 6 columns: STATION, STATION, LOCATION, REMOVAL LENGTH (FT), TYPE B-6.12 LENGTH (FT), TYPE B-6.24 LENGTH (FT). Rows include various stationing and locations like RT MEDIAN, LT, and MEDIAN NOSE.

Table for LANDSCAPING GRAVEL. Columns: STATION, STATION, LOCATION, WIDTH (FT), RESTORATION AREA (SQ YD). Includes rows for various stationing and a TOTAL row.

Table for REINFORCEMENT BARS, EPOXY COATED. Columns: STATION, STATION, LOCATION, LENGTH (FT), WEIGHT (LB). Includes rows for DRIVEWAY locations and a TOTAL row.

Table for CONCRETE MEDIAN REMOVAL AND CONCRETE MEDIAN (SPECIAL). Columns: STATION, STATION, LOCATION, REMOVAL (SQ FT), REPLACEMENT (SQ FT). Includes rows for various stationing and a TOTAL row.

Table for HOT-MIX ASPHALT DRIVEWAY PAVEMENT REMOVAL AND REPLACEMENT. Columns: STATION, LOCATION, LENGTH (FT), WIDTH (FT), AREA (SQ YD), DRIVEWAY PAVEMENT REMOVAL (SQ YD), HOT-MIX ASPHALT BASE COURSE, 8" (SQ YD), HOT-MIX ASPHALT SURFACE COURSE, MIX "D", N50 (TON). Includes rows for various stationing and a TOTAL row.

Table for REMOVE AND RE-ERECT EXISTING SIGN. Columns: STATION, OFFSET, TYPE, EACH. Includes rows for 28+76 and 34+78.

Table for HOT-MIX ASPHALT SURFACE REMOVAL - BUTT JOINT. Columns: STATION, LOCATION, LENGTH (FT), WIDTH (FT), AREA (SQ YD). Includes rows for 1+12, 5+68, 44+62.

Table for BIKE PATH, BRICK PAVEMENT AND SIDEWALK REMOVAL AND REPLACEMENT. Columns: STATION, LOCATION, BIKE PATH REMOVAL (SQ YD), HOT-MIX ASPHALT BASE COURSE, 4" (SQ YD), HOT-MIX ASPHALT SURFACE COURSE, MIX "D", N50 (TON), BRICK PAVEMENT REMOVAL (SQ FT), BRICK SIDEWALK (SQ FT), PCC SIDEWALK 5 INCH (SQ FT), DETECTABLE WARNINGS (SQ FT). Includes rows for various stationing and a TOTAL row.

Project information footer including BAXTER & WOODMAN logo, design/revision details, STATE OF ILLINOIS DEPARTMENT OF TRANSPORTATION logo, SCHEDULES OF QUANTITIES, and contract information.

Vertical text on the left margin: COPYRIGHT © 2011 BY BAXTER & WOODMAN, INC. ... STATE OF ILLINOIS - PROFESSIONAL DESIGN FIRM ...

SCHEDULE OF MATERIALS

THERMOPLASTIC PAVEMENT MARKING - LETTERS AND SYMBOLS
PARK BOULEVARD
STATION LOCATION SQ. FT.

THERMOPLASTIC PAVEMENT MARKING - LINE 4"
PARK BOULEVARD
STATION STATION LOCATION LENGTH (FT)

THERMOPLASTIC PAVEMENT MARKING - LINE 6"
PARK BOULEVARD
STATION STATION LOCATION LENGTH (FT)

THERMOPLASTIC PAVEMENT MARKING - LINE 24"
PARK BOULEVARD
STATION LOCATION LENGTH (FT)

DRAINAGE STRUCTURE WORK
PARK BOULEVARD
STATION LOCATION CATCH BASINS, TY A, 4'-DIA, TY 24 F&G (EACH) FRAMES AND GRATES, TYPE 24 (EACH) REMOVING CATCH BASINS (EACH) DRAINAGE STRUCTURE TO BE ADJUSTED (EACH) DRAINAGE STRUCTURE TO BE RECONSTRUCTED (SQ FT) PIPE UNDERDRAINS (FEET)

DETECTOR LOOP, TYPE I
(FOR TRAFFIC SIGNALS MAINTAINED BY COOK COUNTY)
PARK BOULEVARD
STATION LOCATION LENGTH (FT)

REBUILD EXISTING HANDHOLE
PARK BOULEVARD
STATION OFFSET TYPE EACH

MAINTENANCE OF EXISTING TRAFFIC SIGNAL INSTALLATION
(FOR TRAFFIC SIGNALS MAINTAINED BY COOK COUNTY)
PARK BOULEVARD
LOCATION EACH

COPYRIGHT © 2013 BY BAXTER & WOODMAN, INC.
STATE OF ILLINOIS PROFESSIONAL ENGINEERING REGISTRATION BOARD
REGISTERED PROFESSIONAL ENGINEER NO. 322514 PW
02/17/2013

DESIGNED - JGH REVISED - 12/17/13 PER IDOT
DRAWN - CJC REVISED -
CHECKED - SLN REVISED -
DATE - 11/11/13 FILE - 130089.SH_Schedules_Park_1.shx

STATE OF ILLINOIS
DEPARTMENT OF TRANSPORTATION

SCHEDULES OF QUANTITIES
SCALE: STA. TO STA.

F.A.U. SECTION COUNTY TOTAL SHEET SHEET
RTE. 13-00061-00-RS DUPAGE 25 7
2997 CONTRACT NO. 63895
FED. ROAD DIST. NO. 1 [ILLINOIS] FED. AID PROJECT

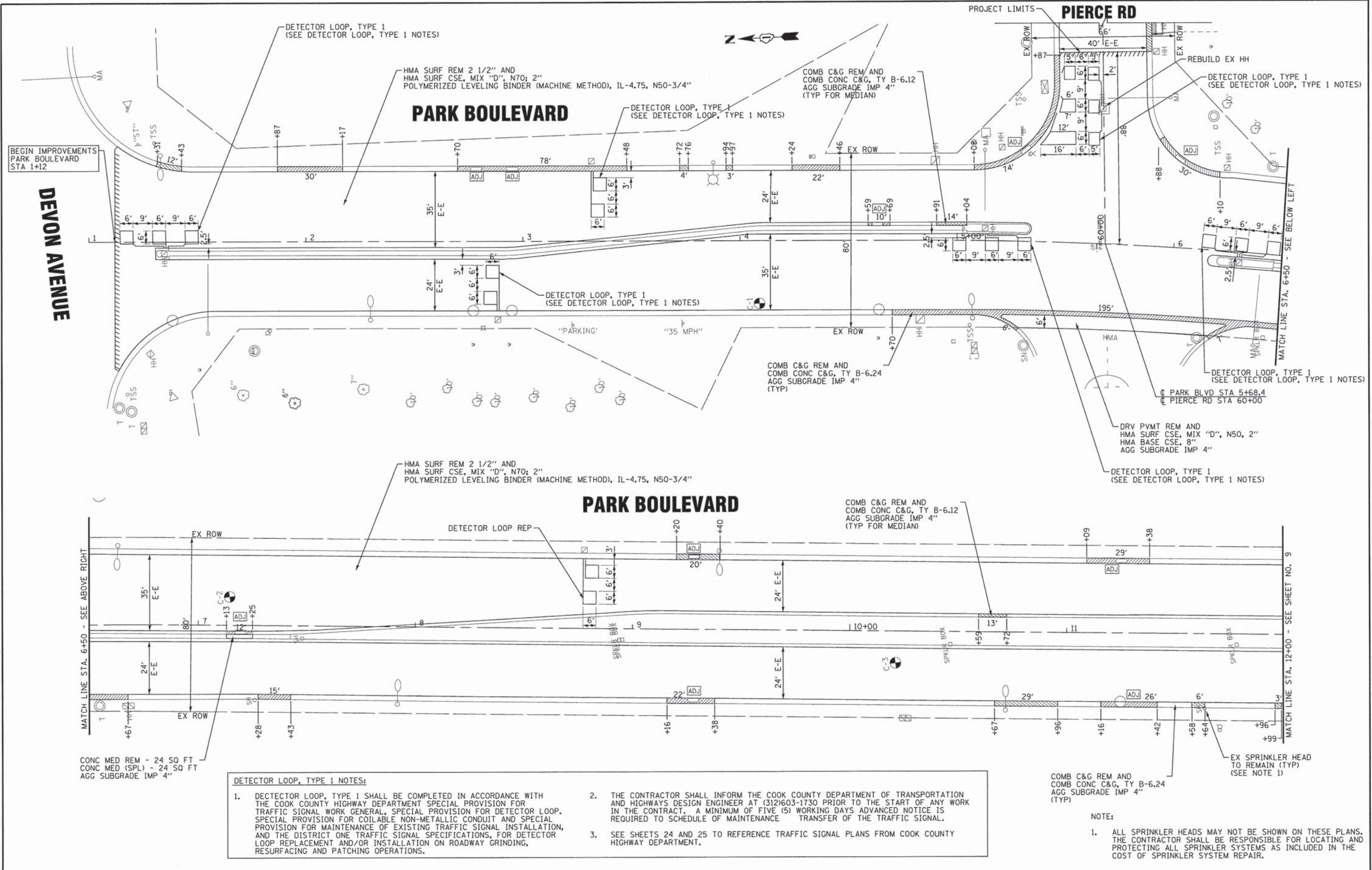

- DETECTOR LOOP, TYPE 1 NOTES:**
- DETECTOR LOOP, TYPE 1 SHALL BE COMPLETED IN ACCORDANCE WITH THE COOK COUNTY HIGHWAY DEPARTMENT SPECIAL PROVISION FOR TRAFFIC SIGNAL WORK GENERAL, SPECIAL PROVISION FOR DETECTOR LOOP, SPECIAL PROVISION FOR COILABLE NON-METALLIC CONDUIT AND SPECIAL PROVISION FOR MAINTENANCE OF EXISTING TRAFFIC SIGNAL INSTALLATION, AND THE DISTRICT ONE TRAFFIC SIGNAL SPECIFICATIONS, FOR DETECTOR LOOP REPLACEMENT AND/OR INSTALLATION ON ROADWAY GRINDING, RESURFACING AND PATCHING OPERATIONS.
 - THE CONTRACTOR SHALL INFORM THE COOK COUNTY DEPARTMENT OF TRANSPORTATION AND HIGHWAYS DESIGN ENGINEER AT (312)603-1730 PRIOR TO THE START OF ANY WORK IN THE CONTRACT. A MINIMUM OF FIVE (5) WORKING DAYS ADVANCED NOTICE IS REQUIRED TO SCHEDULE OF MAINTENANCE TRANSFER OF THE TRAFFIC SIGNAL.
 - SEE SHEETS 24 AND 25 TO REFERENCE TRAFFIC SIGNAL PLANS FROM COOK COUNTY HIGHWAY DEPARTMENT.

NOTE:

- ALL SPRINKLER HEADS MAY NOT BE SHOWN ON THESE PLANS. THE CONTRACTOR SHALL BE RESPONSIBLE FOR LOCATING AND PROTECTING ALL SPRINKLER SYSTEMS AS INCLUDED IN THE COST OF SPRINKLER SYSTEM REPAIR.

COPYRIGHT © 2011 BY BAXTER & WOODMAN, INC.
 ALL RIGHTS RESERVED. NO PART OF THIS DOCUMENT IS TO BE REPRODUCED OR TRANSMITTED IN ANY FORM OR BY ANY MEANS, ELECTRONIC OR MECHANICAL, INCLUDING PHOTOCOPYING, RECORDING, OR BY ANY INFORMATION STORAGE AND RETRIEVAL SYSTEM.
 DATE: 11/17/2011 12:17:23 PM
 IN:\04\08\11\AS\130089-Homilton_SSA\CADD\Drawings\SSA\130089-SH_Plan1_Park.knt



DESIGNED - JGH	REVISED -
DRAWN - CJC	REVISED -
CHECKED - SLN	REVISED -
DATE - 11/11/13	FILE - 130089.SH_Plan1_Park.shp

**STATE OF ILLINOIS
DEPARTMENT OF TRANSPORTATION**

**GEOMETRIC PLAN
PARK BOULEVARD**

SCALE: 1" = 20'

STA. 1+00 TO STA. 12+00

F.A.U. RTE.	SECTION	COUNTY	TOTAL SHEETS	SHEET NO.
2997	13-00061-00-RS	DUPAGE	25	8
CONTRACT NO. 63895				FED. ROAD DIST. NO. 1 ILLINOIS FED. AID PROJECT

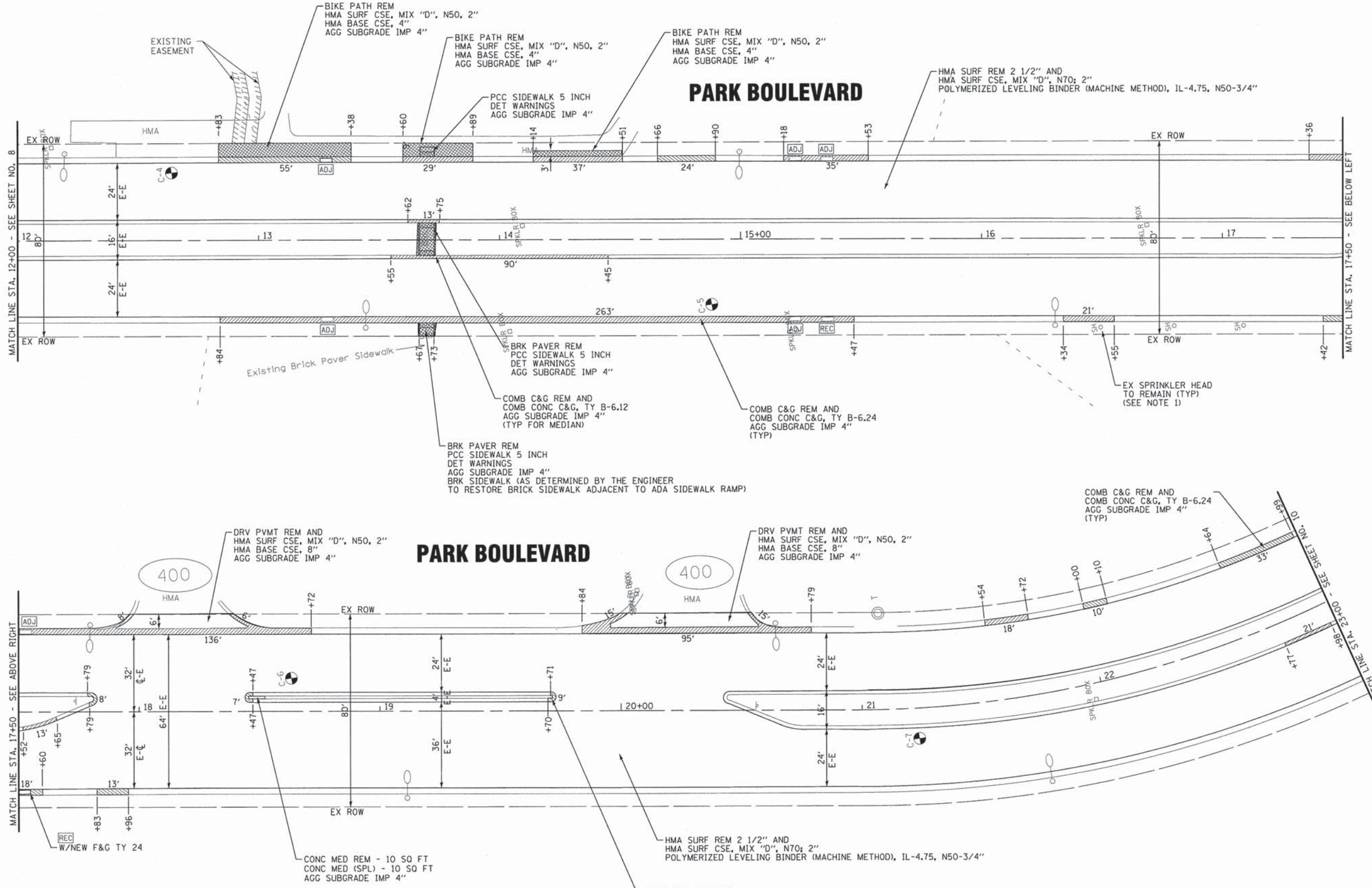

MATCH LINE STA. 12+00 - SEE SHEET NO. 8

MATCH LINE STA. 17+50 - SEE BELOW LEFT

MATCH LINE STA. 17+50 - SEE ABOVE RIGHT

MATCH LINE STA. 23+00 - SEE SHEET NO. 10

COPYRIGHT © 2013 BY BAXTER & WOODMAN, INC.
 STATE OF ILLINOIS - PROFESSIONAL DESIGN FIRM
 1100605VITASY130089-Hamilton 55A/CADD/Drawings/Sheets/Park/23009_S1_Plan2_Park.sht
 12/6/2013 10:43:00 AM



DESIGNED - JGH	REVISED -
DRAWN - CJC	REVISED -
CHECKED - SLN	REVISED -
DATE - 11/11/13	FILE - 130089_S1_Plan2_Park.sht

**STATE OF ILLINOIS
DEPARTMENT OF TRANSPORTATION**

**GEOMETRIC PLAN
PARK BOULEVARD**

SCALE: 1" = 20'
STA. 12+00 TO STA. 23+00

F.A.U. RTE. 2997	SECTION 13-00061-00-RS	COUNTY DUPAGE	TOTAL SHEETS 25	SHEET NO. 9
FED. ROAD DIST. NO. 1 ILLINOIS/FED. AID PROJECT			CONTRACT NO. 63895	

- NOTE:
- ALL SPRINKLER HEADS MAY NOT BE SHOWN ON THESE PLANS. THE CONTRACTOR SHALL BE RESPONSIBLE FOR LOCATING AND PROTECTING ALL SPRINKLER SYSTEMS AS INCLUDED IN THE COST OF SPRINKLER SYSTEM REPAIR.

Copyright © 2013 by BAXTER & WOODMAN, INC.
 STATE OF ILLINOIS PROFESSIONAL DESIGN FIRM
 5400 N. WISCONSIN AVENUE, SUITE 200, CHICAGO, IL 60642
 TEL: 773.399.8800 FAX: 773.399.8801
 WWW.BANDW.COM



DESIGNED - JGH	REVISED -
DRAWN - CJC	REVISED -
CHECKED - SLN	REVISED -
DATE - 11/11/13	FILE - 130089.SH_Plan3_Park.sht

**STATE OF ILLINOIS
 DEPARTMENT OF TRANSPORTATION**

SCALE: 1" = 20'

**GEOMETRIC PLAN
 PARK BOULEVARD**

STA. 23+00 TO STA. 33+50

F.A.U. RTE. 2997	SECTION 13-00061-00-RS	COUNTY DUPAGE	TOTAL SHEETS 25	SHEET NO. 10
FED. ROAD DIST. NO. 1 ILLINOIS FED. AID PROJECT			CONTRACT NO. 63895	

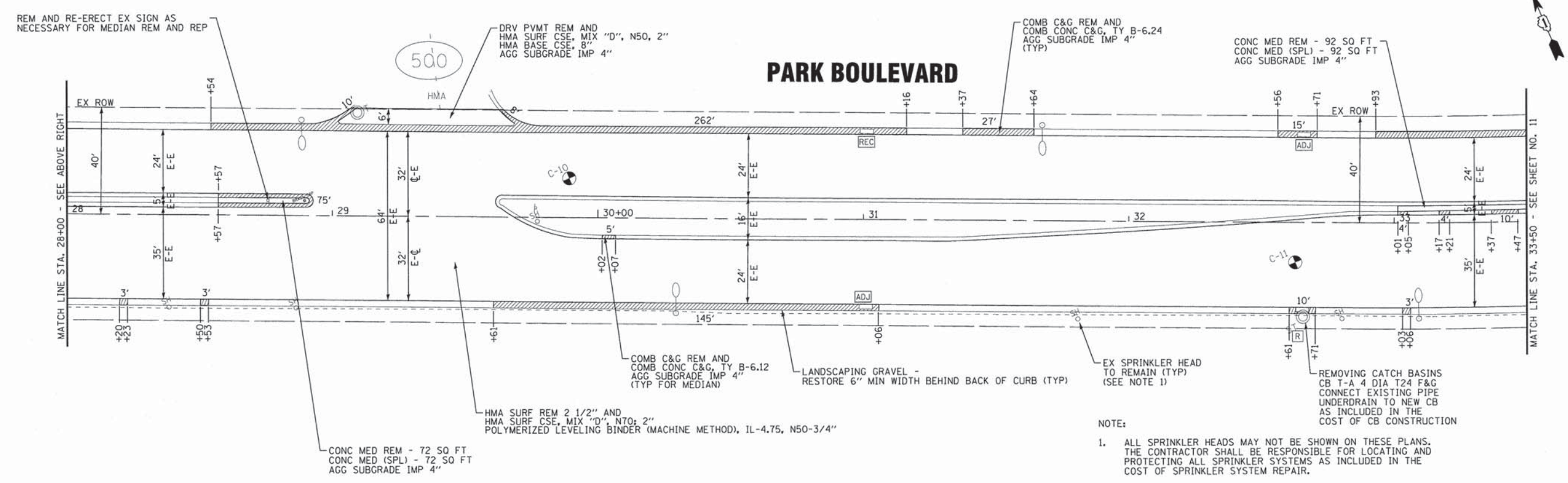
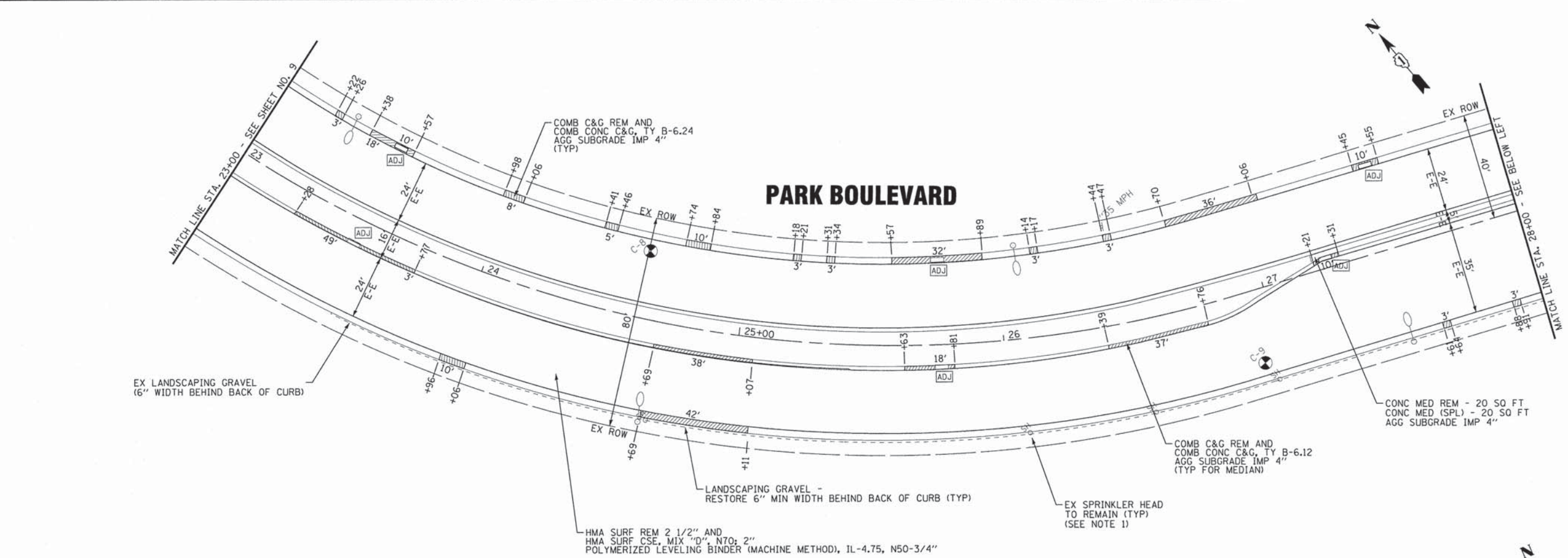

NOTE:

1. ALL SPRINKLER HEADS MAY NOT BE SHOWN ON THESE PLANS. THE CONTRACTOR SHALL BE RESPONSIBLE FOR LOCATING AND PROTECTING ALL SPRINKLER SYSTEMS AS INCLUDED IN THE COST OF SPRINKLER SYSTEM REPAIR.

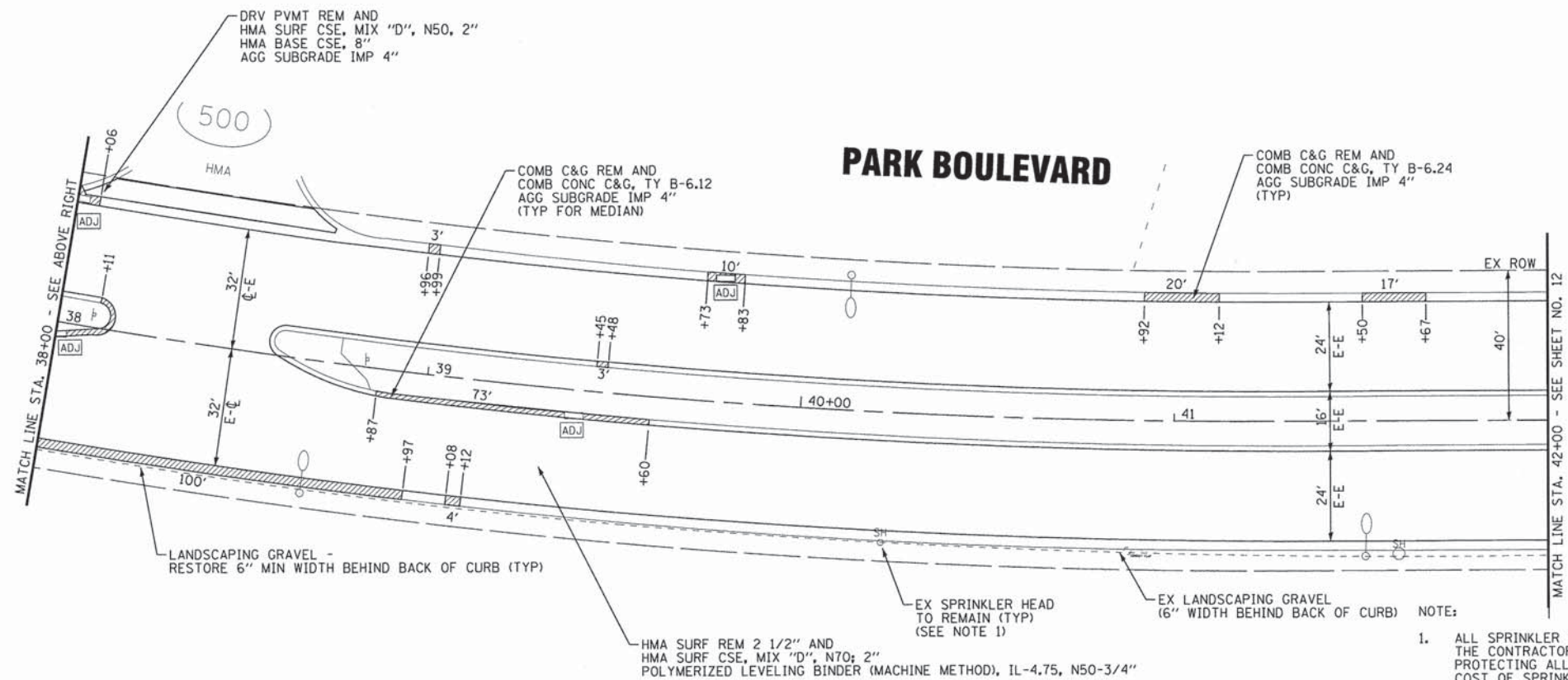
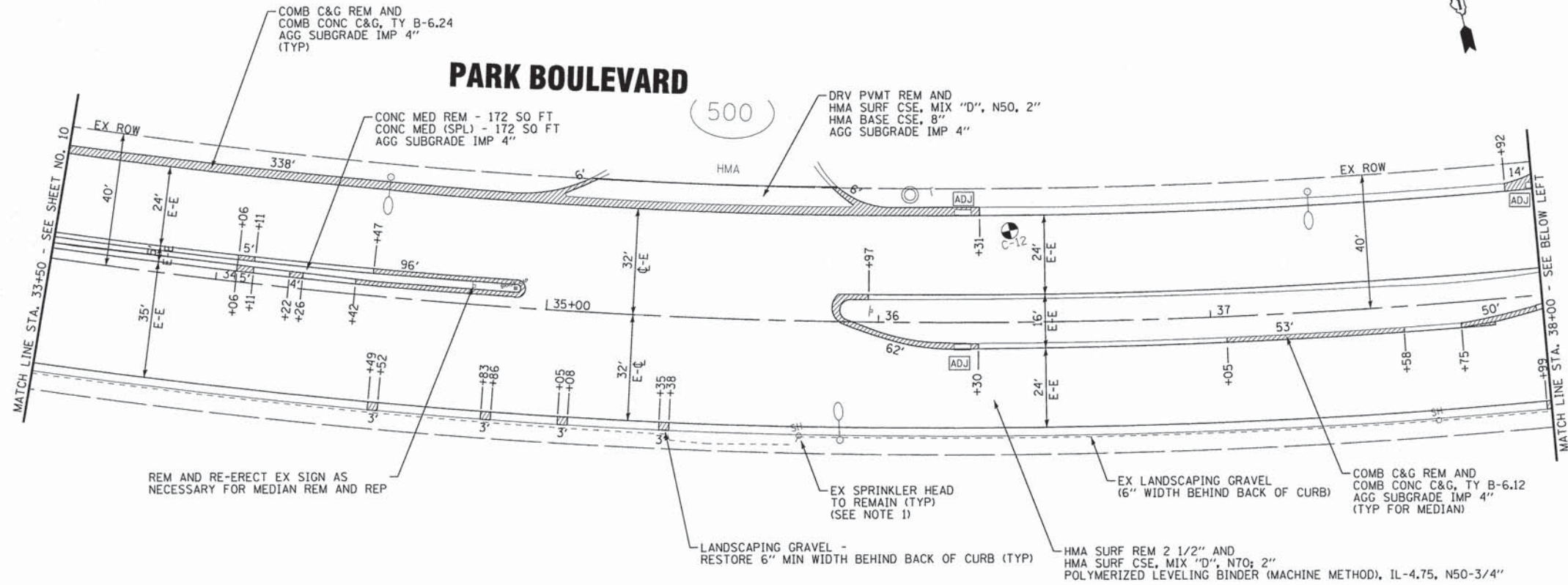

NOTE:
 1. ALL SPRINKLER HEADS MAY NOT BE SHOWN ON THESE PLANS. THE CONTRACTOR SHALL BE RESPONSIBLE FOR LOCATING AND PROTECTING ALL SPRINKLER SYSTEMS AS INCLUDED IN THE COST OF SPRINKLER SYSTEM REPAIR.

COPYRIGHT © 2011 BY BAXTER & WOODMAN, INC.
 STATE OF ILLINOIS - PROFESSIONAL DESIGN FIRM
 LICENSE NO. 061-1216-2/03
 PROJECT NO. 130089-SH_Plan4_Park.knt
 I:\061089\130089-Homilton\SSACADD\Drawings\Sheets\130089-SH_Plan4_Park.knt

BAXTER & WOODMAN Consulting Engineers	DESIGNED - JGH	REVISED -
	DRAWN - CJC	REVISED -
	CHECKED - SLN	REVISED -
	DATE - 11/11/13	FILE - 130089.SH_Plan4_Park.sht

**STATE OF ILLINOIS
 DEPARTMENT OF TRANSPORTATION**

GEOMETRIC PLAN PARK BOULEVARD		
SCALE: 1" = 20'	STA. 33+50	TO STA. 42+00

F.A.U. RTE.	SECTION	COUNTY	TOTAL SHEETS	SHEET NO.
2997	13-00061-00-RS	DUPAGE	25	11
FED. ROAD DIST. NO. 1 ILLINOIS FED. AID PROJECT			CONTRACT NO. 63895	

COPYRIGHT © 2013 BY BAXTER & WOODMAN, INC. \\snp\p\A\self-08-Det\out\p\... \CADD\PROJ\130089\Plan5_Park.sht
 LICENSE NO. 086-00030 - EXPIRES 4/30/2015
 12/6/2013 8:43:58 AM \\cpr\p\woodman.com\p\j\p\130089\Plan5_Park.sht

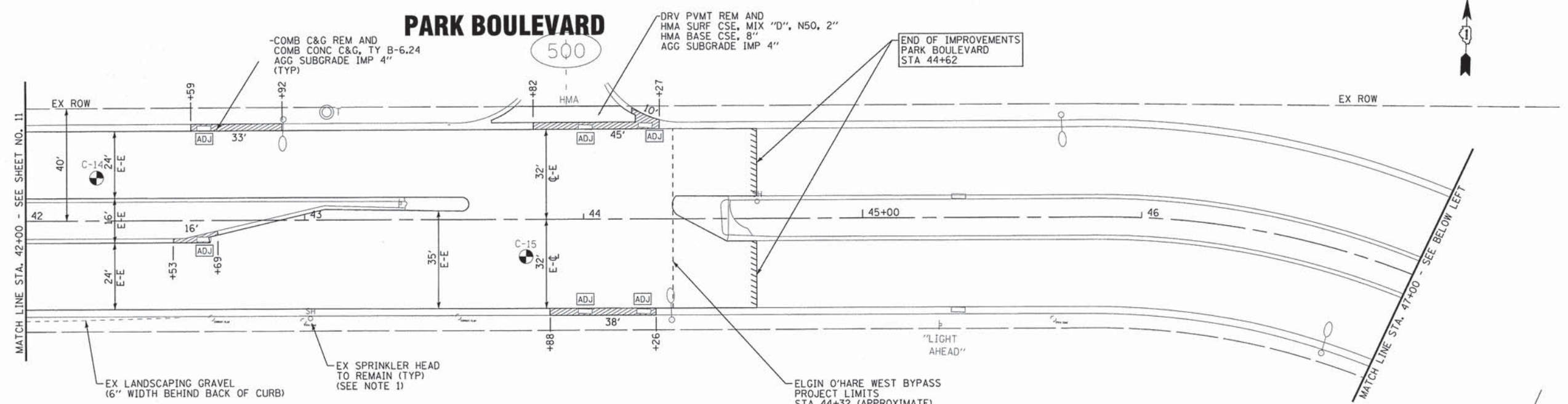

NOTE:
 1. ALL SPRINKLER HEADS MAY NOT BE SHOWN ON THESE PLANS. THE CONTRACTOR SHALL BE RESPONSIBLE FOR LOCATING AND PROTECTING ALL SPRINKLER SYSTEMS AS INCLUDED IN THE COST OF SPRINKLER SYSTEM REPAIR.

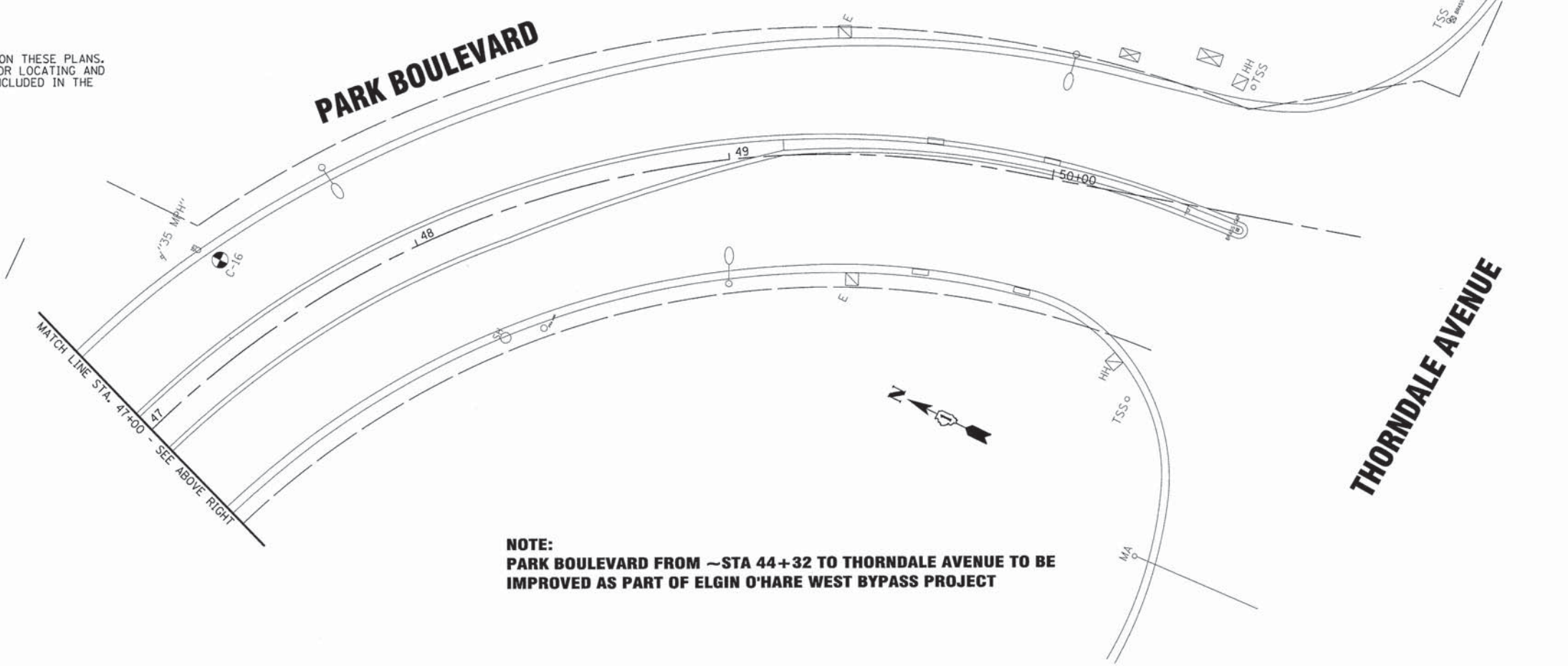

NOTE:
 PARK BOULEVARD FROM ~STA 44+32 TO THORNDALE AVENUE TO BE IMPROVED AS PART OF ELGIN O'HARE WEST BYPASS PROJECT



DESIGNED - JGH	REVISED -
DRAWN - CJC	REVISED -
CHECKED - SLN	REVISED -
DATE - 11/11/13	FILE - 130089_SH_Plan5_Park.sht

STATE OF ILLINOIS
 DEPARTMENT OF TRANSPORTATION

GEOMETRIC PLAN
 PARK BOULEVARD

SCALE: 1" = 20'

STA. 42+00 TO STA. 48+50

F.A.U. RTE.	SECTION	COUNTY	TOTAL SHEETS	SHEET NO.
2997	13-00061-00-RS	DUPAGE	25	12
CONTRACT NO. 63895				
FED. ROAD DIST. NO. 1 ILLINOIS FED. AID PROJECT				

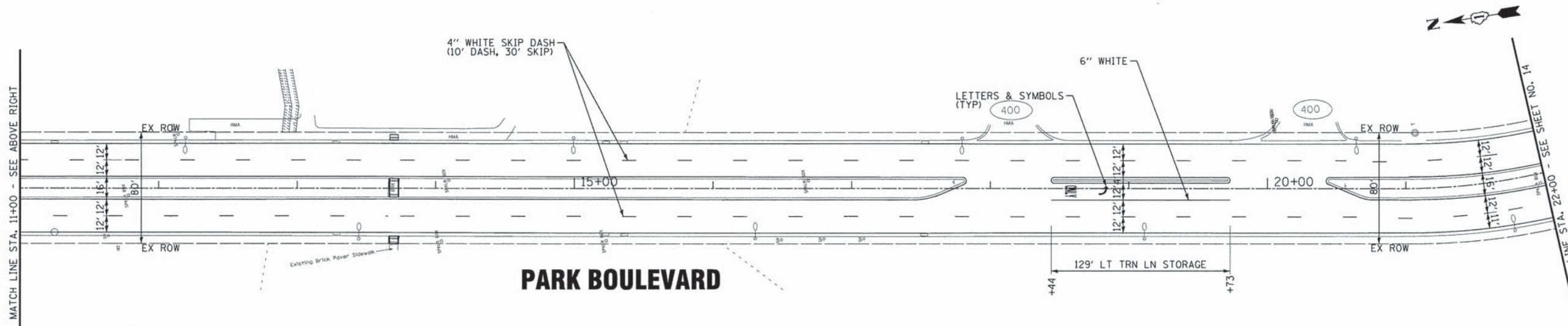
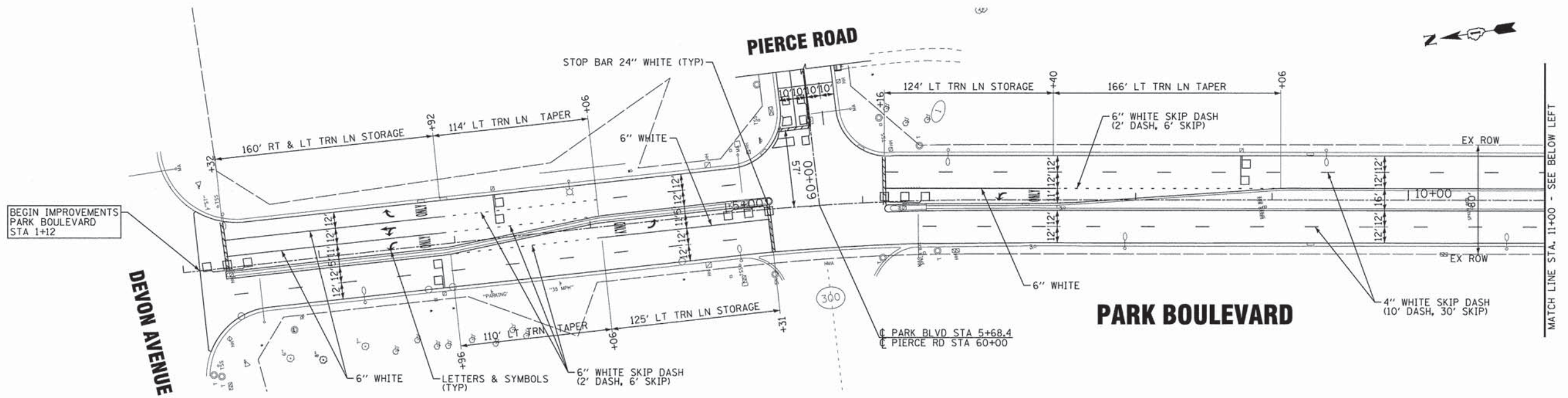

NOTE:
ALL PAVEMENT MARKINGS ARE THERMOPLASTIC UNLESS OTHERWISE NOTED.

COPYRIGHT © 2013 BY BAXTER & WOODMAN, INC.
 ALL RIGHTS RESERVED.
 LICENSE NO. 114-000791 - EXPIRES 4/30/2015
 12/17/2013 4:25:03 PM
 I:\04\03\13\130089\130089-SH_Park.sht
 S:\A\2013\130089\130089-SH_Park.sht

BAXTER & WOODMAN
Consulting Engineers

DESIGNED - JGH	REVISED - 12/17/13 PER IDOT
DRAWN - CJC	REVISED -
CHECKED - SLN	REVISED -
DATE - 11/11/13	FILE - 130089.SH_PMI_Park.sht

STATE OF ILLINOIS
DEPARTMENT OF TRANSPORTATION

PAVEMENT MARKING PLAN
PARK BOULEVARD

SCALE: 1" = 40'

STA. 1+00 TO STA. 22+00

F.A.U. RE.	SECTION	COUNTY	TOTAL SHEETS	SHEET NO.
2997	13-00061-00-RS	DUPAGE	25	13
CONTRACT NO. 63895				
FED. ROAD DIST. NO. 1 ILLINOIS FED. AID PROJECT				

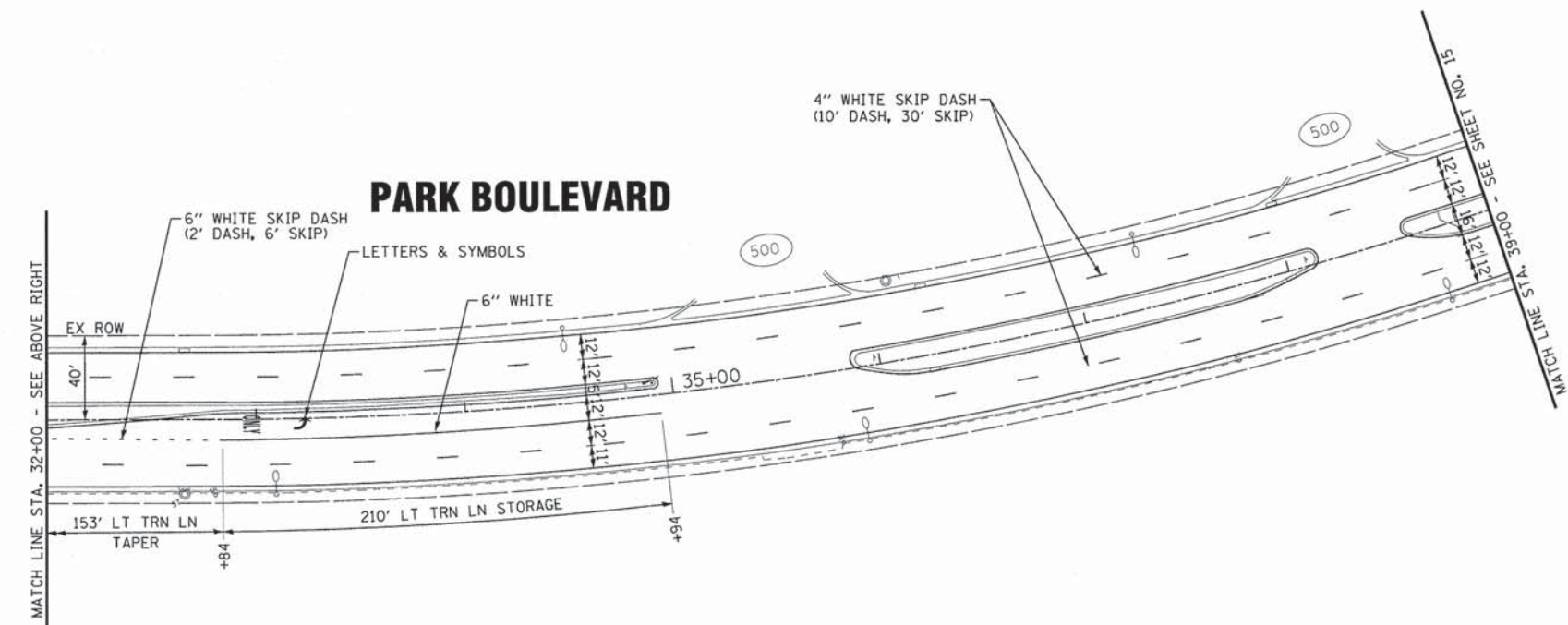
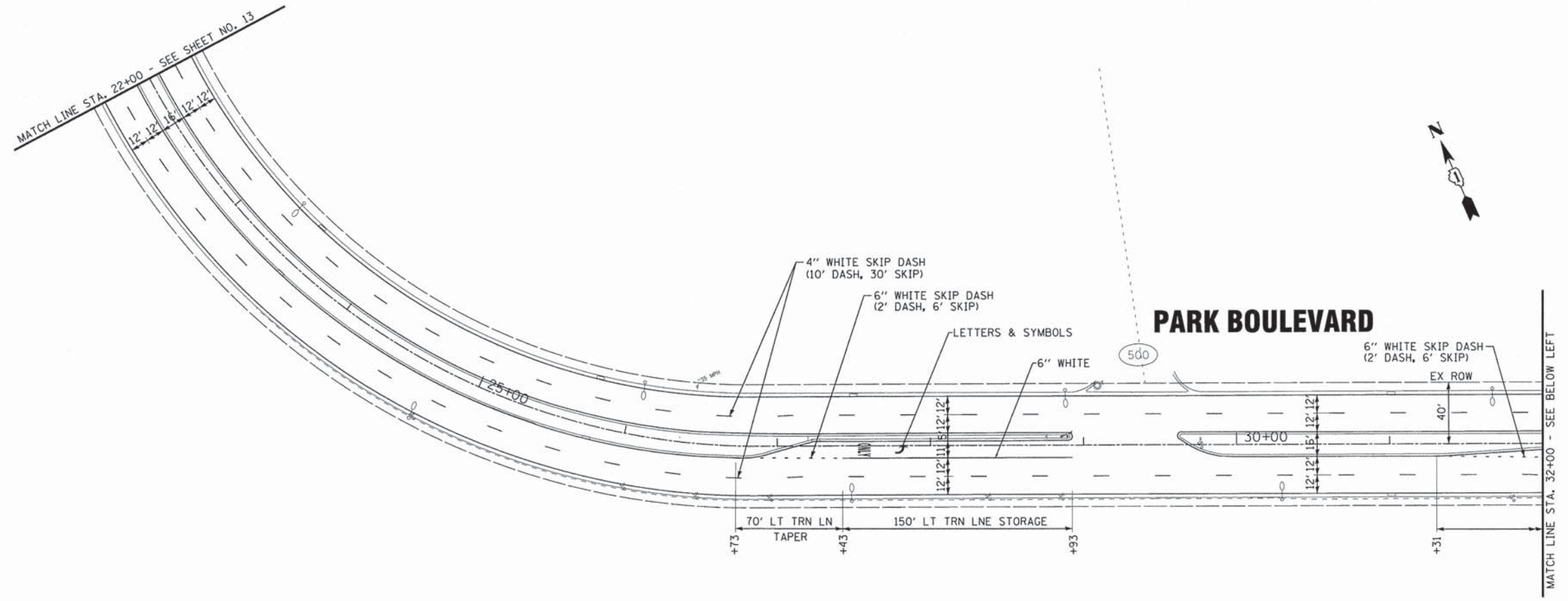

NOTE:
ALL PAVEMENT MARKINGS ARE THERMOPLASTIC UNLESS OTHERWISE NOTED.

COPYRIGHT © 2013 BY BAXTER & WOODMAN, INC.
 STATE OF ILLINOIS - PROFESSIONAL DESIGN FIRM
 4850 G ST. SUITE 100
 BLOOMINGTON, IL 61820
 TEL: 312.231.1111
 FAX: 312.231.1112
 WWW.BAXTERANDWOODMAN.COM



DESIGNED - JGH	REVISED -
DRAWN - CJC	REVISED -
CHECKED - SLN	REVISED -
DATE - 11/11/13	FILE - 130089_SH_PM2_Park.sht

STATE OF ILLINOIS
DEPARTMENT OF TRANSPORTATION

PAVEMENT MARKING PLAN
PARK BOULEVARD

SCALE: 1" = 40' STA. 22+00 TO STA. 39+00

F.A.U. RTE.	SECTION	COUNTY	TOTAL SHEETS	SHEET NO.
2997	13-00061-00-RS	DUPAGE	25	14
CONTRACT NO. 63895			FED. ROAD DIST. NO. 1 (ILLINOIS) FED. AID PROJECT	

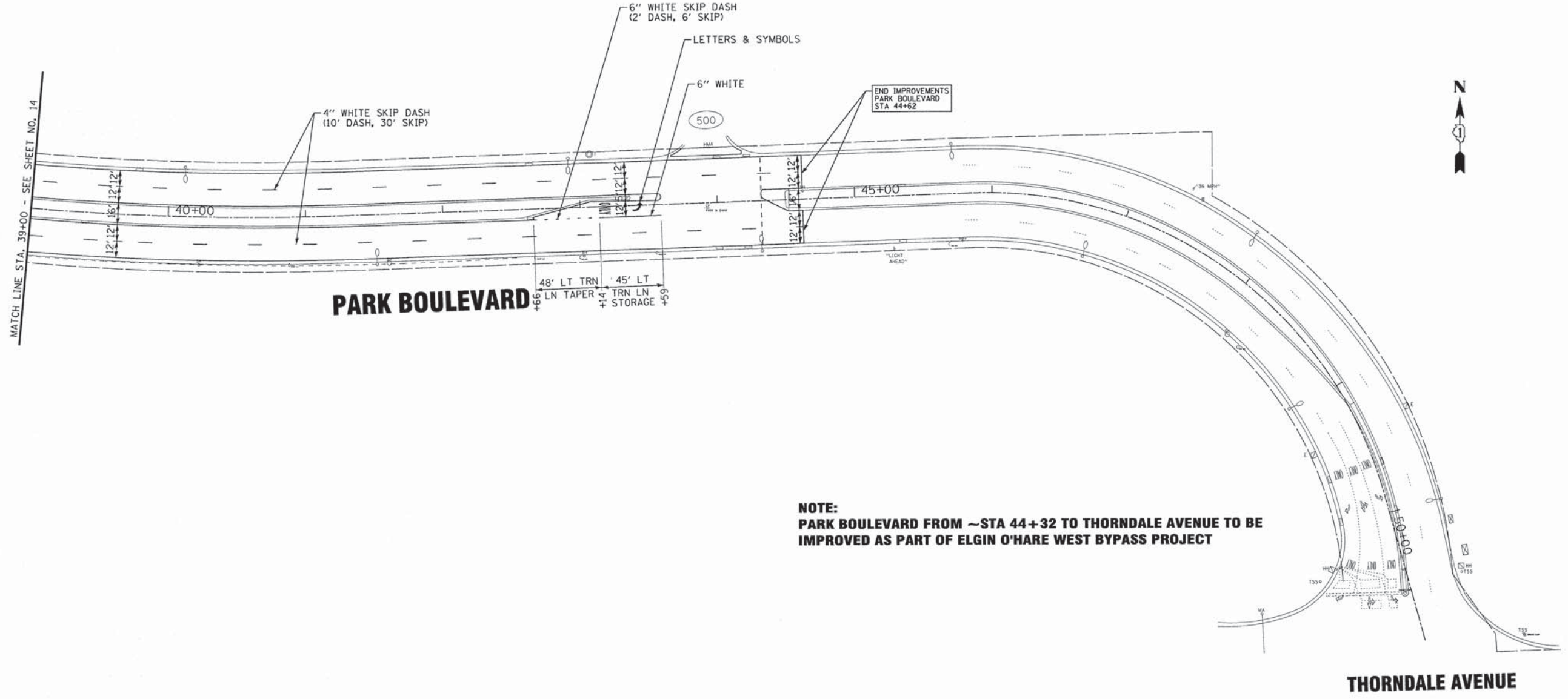

NOTE:
PARK BOULEVARD FROM ~STA 44+32 TO THORNDALE AVENUE TO BE IMPROVED AS PART OF ELGIN O'HARE WEST BYPASS PROJECT

NOTE:
 ALL PAVEMENT MARKINGS ARE THERMOPLASTIC UNLESS OTHERWISE NOTED.

COPYRIGHT © 2013 BY BAXTER & WOODMAN, INC.
 STATE OF ILLINOIS PROFESSIONAL DESIGN FIRM
 4860 DE WILSON AVENUE, SUITE 200, BLOOMINGTON, IL 61824
 12/16/2013 12:16:24 AM I:\Users\JG\Documents\130089\130089-SH\130089-SH-PM3.Park.sht



DESIGNED - JGH	REVISED -
DRAWN - CJC	REVISED -
CHECKED - SLN	REVISED -
DATE - 11/11/13	FILE - 130089.SH_PM3.Park.sht

STATE OF ILLINOIS
 DEPARTMENT OF TRANSPORTATION

PAVEMENT MARKING PLAN
 PARK BOULEVARD

SCALE: 1" = 40' STA. 39+00 TO STA. 51+00

F.A.U. RTE.	SECTION	COUNTY	TOTAL SHEETS	SHEET NO.
2997	13-00061-00-RS	DUPAGE	25	15
FED. ROAD DIST. NO. 1 ILLINOIS FED. AID PROJECT			CONTRACT NO. 63895	

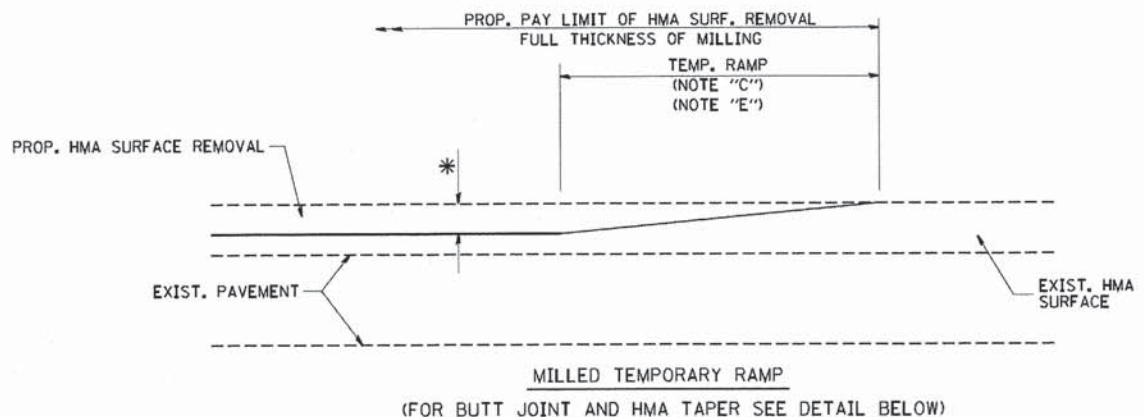

MILLED TEMPORARY RAMP
(FOR BUTT JOINT AND HMA TAPER SEE DETAIL BELOW)

OPTION 1

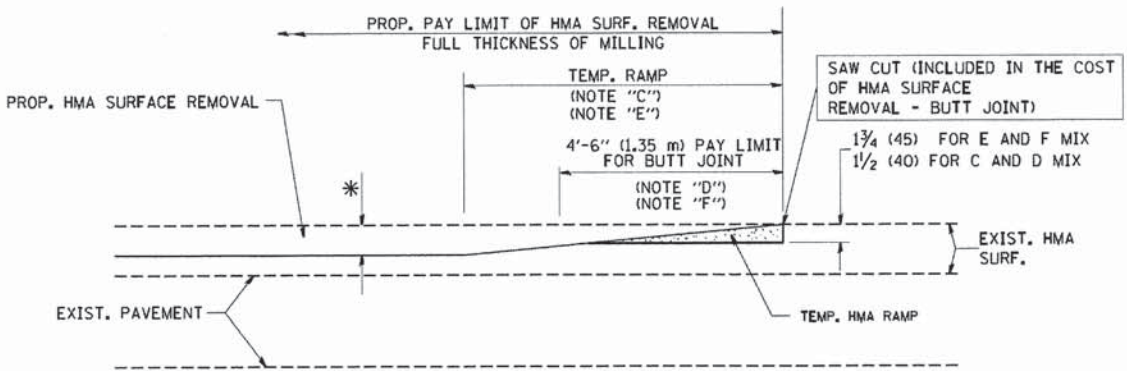

HMA CONSTRUCTED TEMPORARY RAMP
(FOR BUTT JOINT AND HMA TAPER SEE DETAIL BELOW)

OPTION 2
TYPICAL TEMPORARY RAMP

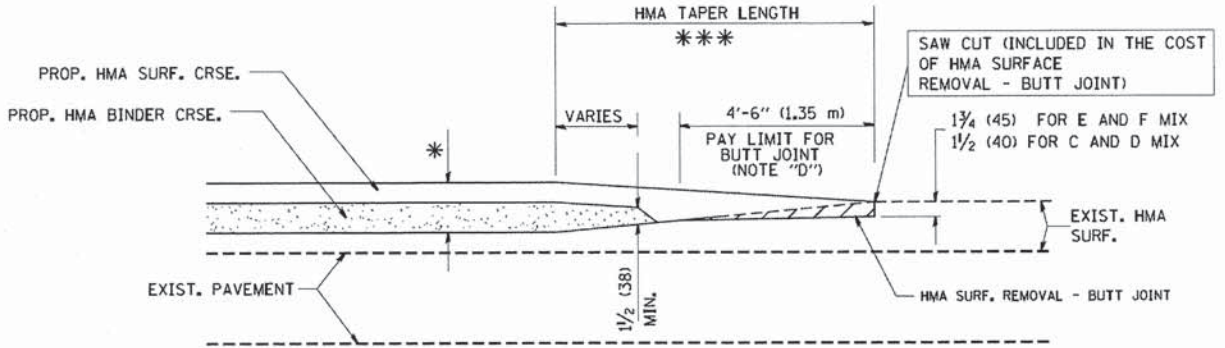

BUTT JOINT AND HMA TAPER

TYPICAL BUTT JOINT AND HMA TAPER FOR MILLING AND RESURFACING

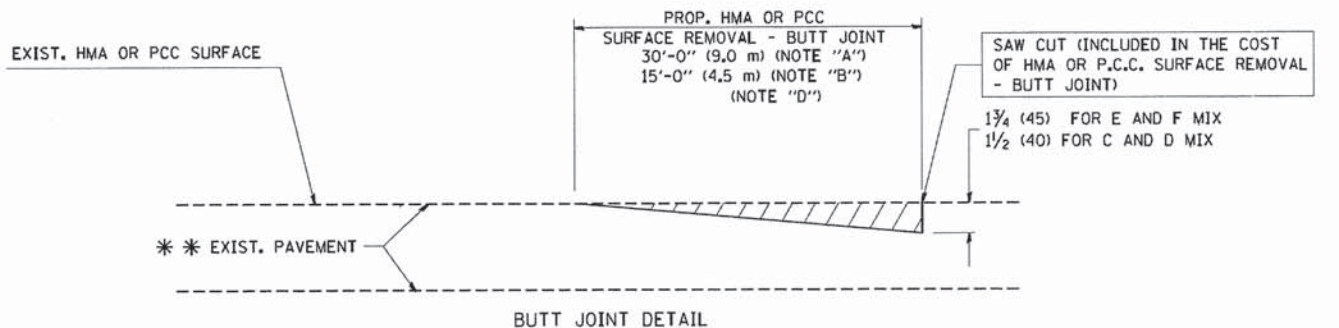

BUTT JOINT DETAIL

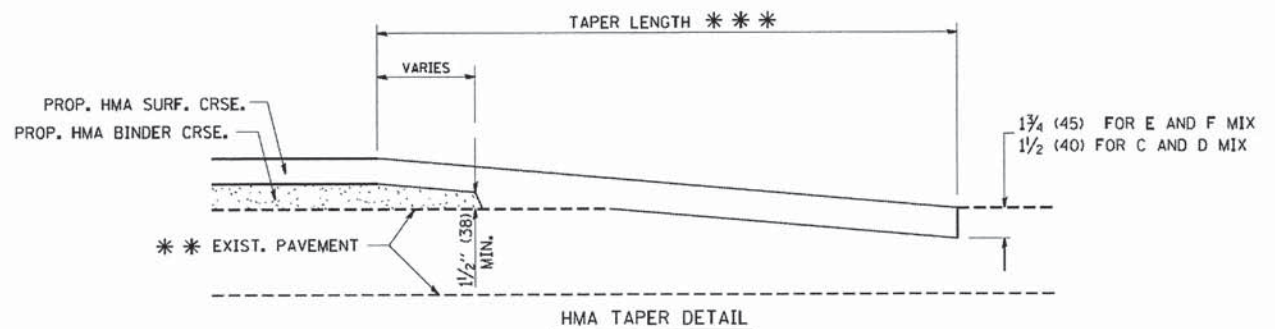

HMA TAPER DETAIL

TYPICAL BUTT JOINT AND HMA TAPER FOR RESURFACING ONLY

*** PC CONCRETE, HMA OR HMA RESURFACED PAVEMENT.

NOTES

- A: MAINLINE ROADWAYS AND MAJOR SIDE ROADS.
- B: MINOR SIDE ROADS.
- C: THE TEMP. RAMP SHALL BE CONSTRUCTED IMMEDIATELY UPON REMOVAL OF THE EXISTING HMA SURFACE.
- D: THE BUTT JOINT SHALL BE CONSTRUCTED IMMEDIATELY PRIOR TO PLACING THE PROPOSED HMA COURSES.
- E: TAPER THE TEMP. RAMP AT A RATE OF 3'-0" (900 mm) PER 1 INCH (25 mm) OF MILLING THICKNESS.
- F: INSTALLATION AND REMOVAL OF THE 4'-6" (1.35 m) TEMP. RAMP IS INCLUDED IN COST OF HMA SURFACE REMOVAL - BUTT JOINT
- G: SEE ARTICLE 406.08 AND 406.14 OF THE STANDARD SPECIFICATIONS FOR "HMA AND/OR PCC SURFACE REMOVAL, BUTT JOINT".
- * SEE TYPICAL SECTIONS FOR MILLING THICKNESS.
- *** 20'-0" (6.1 m) PER 1 (25) RESURFACING (NOTE "A")
10'-0" (3.0 m) PER 1 (25) RESURFACING (NOTE "B")

BASIS OF PAYMENT:

THE BUTT JOINT WILL BE PAID FOR AT THE CONTRACT UNIT PRICE PER SQUARE YARD (SQUARE METER) FOR "HOT-MIX ASPHALT SURFACE REMOVAL - BUTT JOINT" OR FOR "PORTLAND CEMENT CONCRETE SURFACE REMOVAL - BUTT JOINT".

ALL DIMENSIONS ARE IN INCHES (MILLIMETERS) UNLESS OTHERWISE SHOWN.

COPYRIGHT © 2011 BY BAXTER & WOODMAN, INC.
 STATE OF ILLINOIS - PROFESSIONAL DESIGN FIRM
 480 S. WASHINGTON ST., SUITE 200, CHICAGO, IL 60601
 TEL: 312.467.1000 FAX: 312.467.1001
 WWW.BAXTERANDWOODMAN.COM
 FILE NAME = W:\distata\22x34\bd32.dgn
 USER NAME = goglianob
 DESIGNED - M. DE YONG
 DRAWN -
 CHECKED -
 DATE - 06-13-90
 REVISED - R. SHAH 10-25-94
 REVISED - A. ABBAS 03-21-97
 REVISED - M. GOMEZ 04-06-01
 REVISED - R. BORO 01-01-07

FILE NAME =	USER NAME = goglianob	DESIGNED - M. DE YONG	REVISED - R. SHAH 10-25-94
W:\distata\22x34\bd32.dgn		DRAWN -	REVISED - A. ABBAS 03-21-97
	PLOT SCALE = 50.0000' / IN.	CHECKED -	REVISED - M. GOMEZ 04-06-01
	PLOT DATE = 1/4/2008	DATE - 06-13-90	REVISED - R. BORO 01-01-07

**STATE OF ILLINOIS
DEPARTMENT OF TRANSPORTATION**

BUTT JOINT AND HMA TAPER DETAILS			
SCALE: NONE	SHEET NO. 1 OF 1 SHEETS	STA.	TO STA.

F.A. RTE.	SECTION	COUNTY	TOTAL SHEETS	SHEET NO.
2997	13-00061-00-RS	DUPAGE	25	17
BD400-05 BD32		CONTRACT NO. 63895		
FED. ROAD DIST. NO. 1 ILLINOIS FED. AID PROJECT				

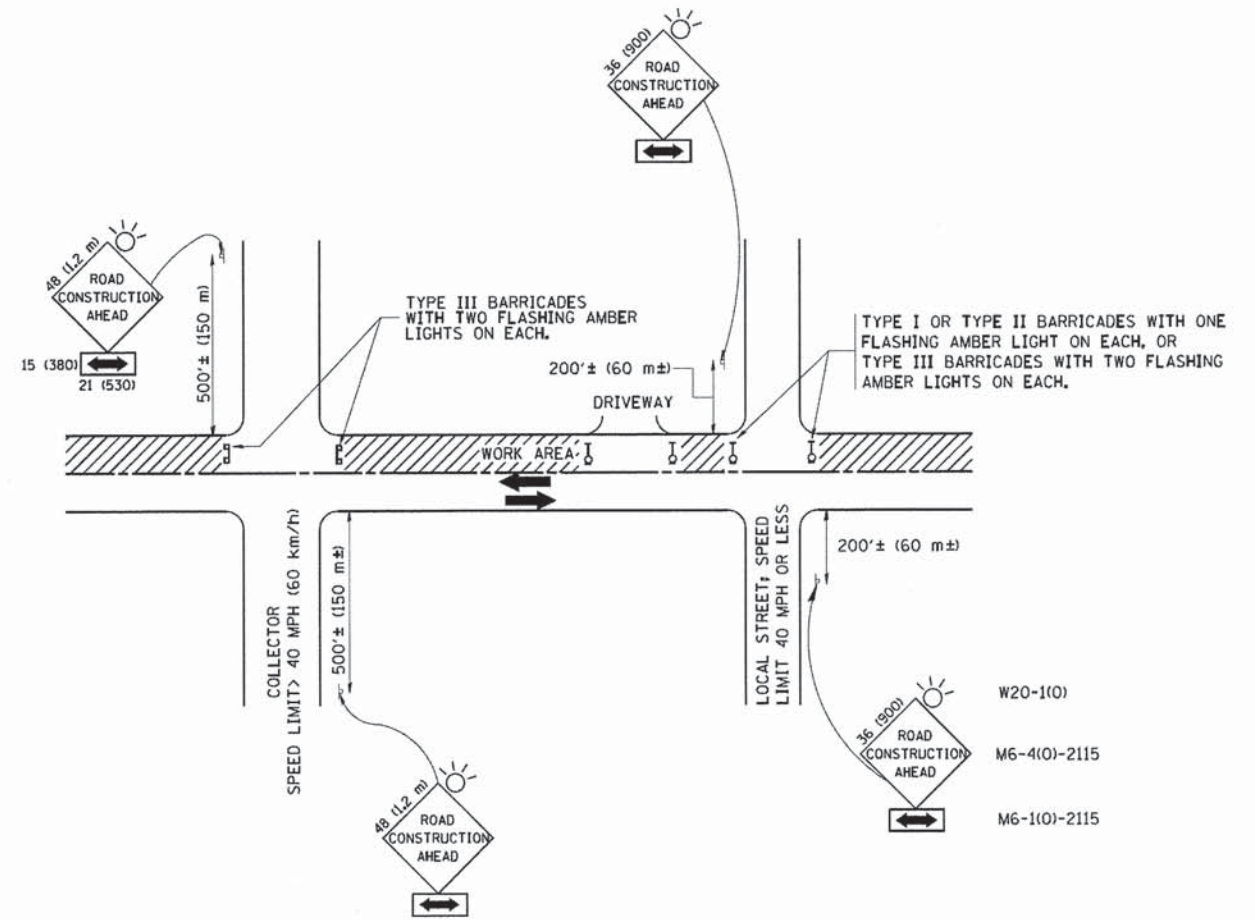

TRAFFIC CONTROL AND PROTECTION FOR SIDE ROADS, INTERSECTIONS, AND DRIVEWAYS

NOTES:

- A. FOR NO LANE RESTRICTION ON THE SIDE ROAD OR DRIVEWAYS
- 1. SIDE ROAD WITH A SPEED LIMIT OF 40 MPH (60 km/h) OR LESS AS SHOWN ON THE DRAWING AND AS DIRECTED BY THE ENGINEER:
 - a) ONE ROAD CONSTRUCTION AHEAD SIGN 36 x 36 (900x900) WITH A FLASHER AND FLAG MOUNTED ON IT APPROXIMATELY 200' (60 m) IN ADVANCE OF THE MAIN ROUTE.
 - b) THE CLOSED PORTION OF THE MAIN ROUTE SHALL BE PROTECTED BY BLOCKING WITH TYPE I, TYPE II OR TYPE III BARRICADES, 1/3 OF THE CROSS SECTION OF THE CLOSED PORTION.
- 2. SIDE ROAD WITH A SPEED LIMIT GREATER THAN 40 MPH (60 km/h) AS SHOWN ON THE DRAWING AND AS DIRECTED BY THE ENGINEER:
 - a) ONE ROAD CONSTRUCTION AHEAD SIGN 48 x 48 (1.2 m x 1.2 m) WITH A FLASHER MOUNTED ON IT APPROXIMATELY 500' (150 m) IN ADVANCE OF THE MAIN ROUTE.
 - b) THE CLOSED PORTION OF THE MAIN ROUTE SHALL BE PROTECTED BY BLOCKING WITH TYPE III BARRICADES, 1/2 OF THE CROSS SECTION OF THE CLOSED PORTION.
- 3. WHEN THE SIDE ROAD LIES BETWEEN THE BEGINNING OF THE MAINLINE SIGNING AND THE WORK ZONE, A SINGLE HEADED ARROW (M6-1) SHALL BE USED IN LIEU OF THE DOUBLE HEADED ARROW (M6-4).
- B. FOR A LANE CLOSURE ON A SIDE ROAD OR DRIVEWAY:
 - USE APPLICABLE PORTIONS OF THE TYPICAL APPLICATION OF TRAFFIC CONTROL DEVICES (STD. 701501, STD. 701606 OR THE APPROPRIATE STANDARD). THE SPACING OF SIGNS AND BARRICADES SHALL BE ADJUSTED FOR FIELD CONDITIONS AS DIRECTED BY THE ENGINEER. THE DIRECTIONAL ARROW SHALL BE COVERED OR REMOVED WHEN NO LONGER CONSISTENT WITH THE SIDE ROAD LANE CLOSURE.
- C. ADVANCE WARNING SIGNS ARE TO BE OMITTED ON DRIVEWAY UNLESS OTHERWISE NOTED.
- D. THE TRAFFIC CONTROL AND PROTECTION FOR SIDE ROADS, INTERSECTIONS, AND DRIVEWAYS SHALL BE INCIDENTAL TO THE COST OF SPECIFIED TRAFFIC CONTROL STANDARDS OR ITEMS.

All dimensions are in millimeters (inches) unless otherwise shown.

COPYRIGHT © 2001 BY BAXTER & WOODMAN, INC. ...
 FILE NAME = W:\diststd\22x34\vol18.dgn
 USER NAME = geglianobt
 DESIGNED - LHA
 DRAWN -
 CHECKED -
 DATE - 06-89
 REVISED - J. OBERLE 10-18-95
 REVISED - A. HOUSEH 03-06-96
 REVISED - A. HOUSEH 10-15-96
 REVISED - T. RAMMACHER 01-06-00

FILE NAME =	USER NAME = geglianobt	DESIGNED - LHA	REVISED - J. OBERLE 10-18-95
W:\diststd\22x34\vol18.dgn		DRAWN -	REVISED - A. HOUSEH 03-06-96
	PLOT SCALE = 50.000 / / IN.	CHECKED -	REVISED - A. HOUSEH 10-15-96
	PLOT DATE = 1/4/2008	DATE - 06-89	REVISED - T. RAMMACHER 01-06-00

**STATE OF ILLINOIS
DEPARTMENT OF TRANSPORTATION**

TRAFFIC CONTROL AND PROTECTION FOR SIDE ROADS, INTERSECTIONS, AND DRIVEWAYS			
SCALE: NONE	SHEET NO. 1 OF 1 SHEETS	STA.	TO STA.

F.A. RTE. -	SECTION	COUNTY	TOTAL SHEETS	SHEET NO.
2997	13-00061-00-RS	DUPAGE	25	18
TC-10			CONTRACT NO. 63895	
FED. ROAD DIST. NO. 1 ILLINOIS FED. AID PROJECT				

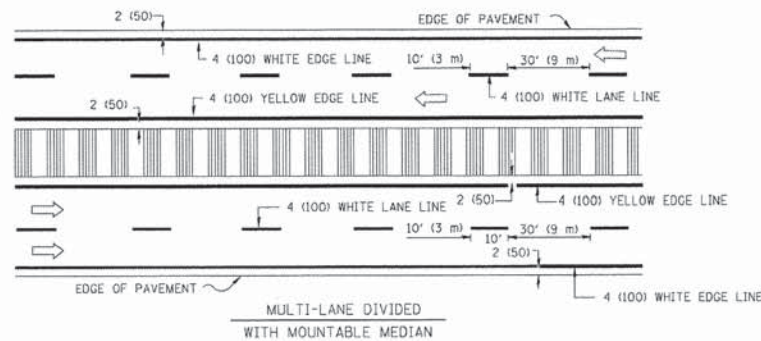
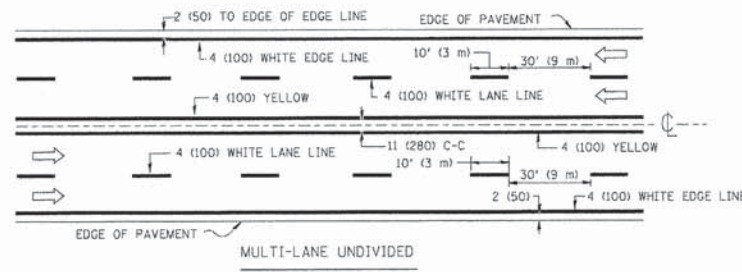
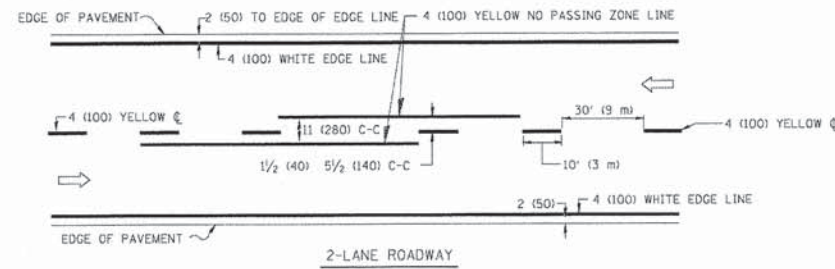

NOTE: MEDIANS WITH BARRIER CURB DO NOT REQUIRE AN EDGE LINE

TYPICAL LANE AND EDGE LINE MARKING

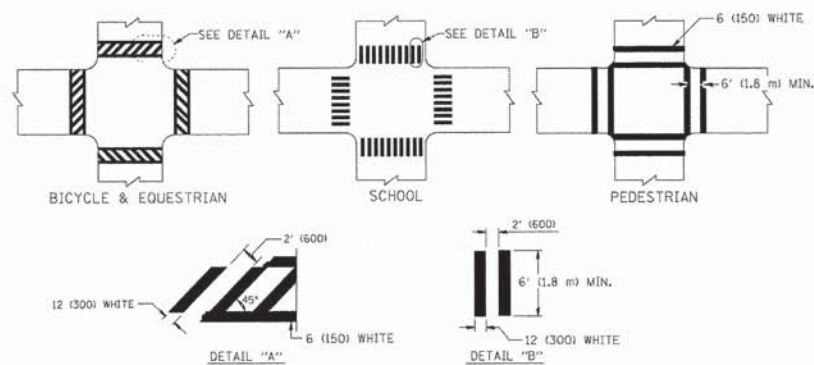

TYPICAL CROSSWALK MARKING

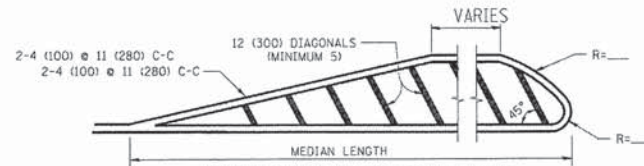
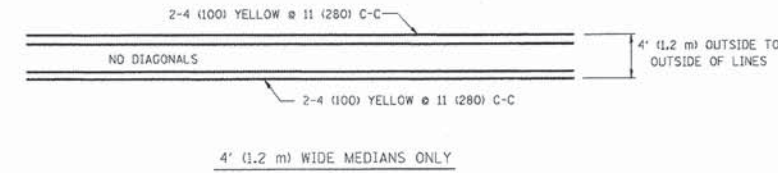

FOR MEDIAN LENGTHS WHERE DIAGONAL SPACING CANNOT BE ATTAINED, USE 5 (FIVE) EQUALLY SPACED DIAGONAL LINES.
 DIAGONAL LINE SPACING: 50' (15 m) C-C (LESS THAN 30MPH (50 km/h))
 75' (25 m) C-C (30MPH (50 km/h) TO 45MPH (70 km/h))
 150' (45 m) C-C (MORE THAN 45MPH (70 km/h))

MEDIANS OVER 4' (1.2 m) WIDE

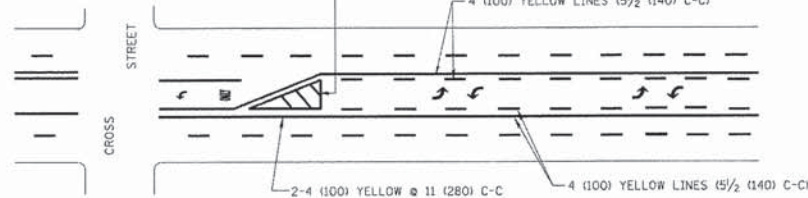

A MINIMUM OF TWO PAIRS OF TURN ARROWS SHALL BE USED, WHITE IN COLOR. ADDITIONAL PAIRS SHALL BE PLACED AT 200' (60 m) TO 300' (90 m) INTERVALS.

MEDIAN WITH TWO-WAY LEFT TURN LANE

TYPICAL PAINTED MEDIAN MARKING

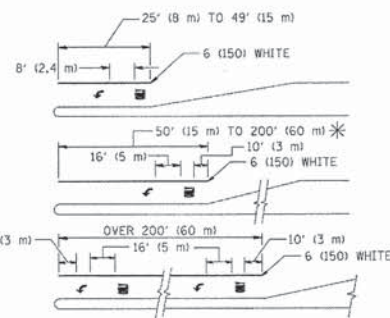

FULL SIZE LETTERS 8' (2.4 m) AND ARROWS SHALL BE USED.
 * TURN LANES IN EXCESS OF 400' (120 m) IN LENGTH MAY HAVE AN ADDITIONAL SET OF ARROW - "ONLY" INSTALLED MIDWAY BETWEEN THE OTHER TWO SETS OF ARROW - "ONLY".

TYPICAL LEFT (OR RIGHT) TURN LANE

TYPICAL TURN LANE MARKING

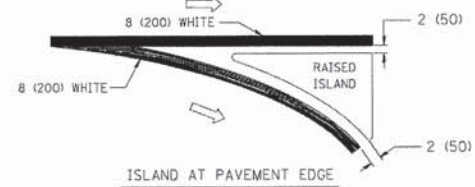
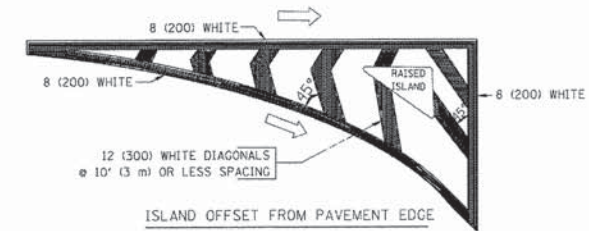

TYPICAL ISLAND MARKING

TYPE OF MARKING	WIDTH OF LINE	PATTERN	COLOR	SPACING / REMARKS
CENTERLINE ON 2 LANE PAVEMENT	4 (1000)	SKIP-DASH	YELLOW	10' (3 m) LINE WITH 30' (9 m) SPACE
CENTERLINE ON MULTI-LANE UNDIVIDED PAVEMENT	2 @ 4 (1000)	SOLID	YELLOW	11 (2800) C-C
NO PASSING ZONE LINES: FOR ONE DIRECTION FOR BOTH DIRECTIONS	4 (1000) 2 @ 4 (1000)	SOLID SOLID	YELLOW YELLOW	5 1/2' (1400) C-C FROM SKIP-DASH CENTERLINE 11 (2800) C-C OMIT SKIP-DASH CENTERLINE BETWEEN
LANE LINES	4 (1000) 5 (1250) ON FREEWAYS	SKIP-DASH SKIP-DASH	WHITE WHITE	10' (3 m) LINE WITH 30' (9 m) SPACE
DOTTED LINES (EXTENSIONS OF CENTER, LANE OR TURN LANE MARKINGS)	SAME AS LINE BEING EXTENDED	SKIP-DASH	SAME AS LINE BEING EXTENDED	2' (600) LINE WITH 6' (1.8 m) SPACE
EDGE LINES	4 (1000)	SOLID	YELLOW-LEFT WHITE-RIGHT	OUTLINE MOUNTABLE MEDIANS IN YELLOW; EDGE LINES ARE NOT USED NEXT TO BARRIER CURB
TURN LANE MARKINGS	6 (1500) LINES; FULL SIZE LETTERS & SYMBOLS (8' (2.4m))	SOLID	WHITE	SEE TYPICAL TURN LANE MARKING DETAIL
TWO WAY LEFT TURN MARKING	2 @ 4 (1000) EACH DIRECTION 8' (2.4m) LEFT ARROW	SKIP-DASH AND SOLID IN PAIRS	YELLOW WHITE	10' (3 m) LINE WITH 30' (9 m) SPACE FOR SKIP-DASH; 5 1/2' (1400) C-C BETWEEN SOLID LINE AND SKIP-DASH LINE SEE TYPICAL TWO-WAY LEFT TURN MARKING DETAIL
CROSSWALK LINES (PEDESTRIAN) A. DIAGONALS (BIKE & EQUESTRIAN) B. LONGITUDINAL BARS (SCHOOL)	2 @ 6 (1500) 12 (3000) @ 45° 12 (3000) @ 90°	SOLID SOLID SOLID	WHITE WHITE WHITE	NOT LESS THAN 6' (1.8 m) APART 2' (600) APART 2' (600) APART SEE TYPICAL CROSSWALK MARKING DETAILS.
STOP LINES	24 (600)	SOLID	WHITE	PLACE 4' (1.2 m) IN ADVANCE OF AND PARALLEL TO CROSSWALK, IF PRESENT. OTHERWISE, PLACE AT DESIRED STOPPING POINT, PARALLEL TO CROSSROAD CENTERLINE, WHERE POSSIBLE
PAINTED MEDIANS	2 @ 4 (1000) WITH 12 (3000) DIAGONALS @ 45° NO DIAGONALS USED FOR 4' (1.2 m) WIDE MEDIANS	SOLID	YELLOW: TWO WAY TRAFFIC WHITE: ONE WAY TRAFFIC	11 (2800) C-C FOR THE DOUBLE LINE SEE TYPICAL PAINTED MEDIAN MARKING.
CORE MARKING AND CHANNELIZING LINES	8 (2000) WITH 12 (3000) DIAGONALS @ 45°	SOLID	WHITE	DIAGONALS: 15' (4.5 m) C-C (LESS THAN 30MPH (50 km/h)) 20' (6 m) C-C (30MPH (50 km/h) TO 45MPH (70 km/h)) 30' (9 m) C-C (OVER 45MPH (70 km/h))
RAILROAD CROSSING	24 (600) TRANSVERSE LINES; "RR" IS 6' (1.8 m) LETTERS; 16 (4000) LINE FOR "X"	SOLID	WHITE	SEE STATE STANDARD 780001 AREA OF: "R"=3.6 SQ. FT. (0.33 m²) EACH "X"=54.0 SQ. FT. (5.0 m²)
SHOULDER DIAGONALS	12 (3000) @ 45°	SOLID	WHITE - RIGHT YELLOW - LEFT	50' (15 m) C-C (LESS THAN 30MPH (50 km/h)) 75' (25 m) C-C (30 MPH (50 km/h) TO 45MPH (70 km/h)) 150' (45 m) C-C (OVER 45MPH (70 km/h))

FOR FURTHER DETAILS ON PAVEMENT MARKING REFER TO STANDARD SPECIFICATIONS FOR ROAD AND BRIDGE CONSTRUCTION AND STATE STANDARD 780001.

All dimensions are in inches (millimeters) unless otherwise shown.

COPYRIGHT © 2011 BY BAXTER & WOODMAN, INC.
 STATE OF ILLINOIS PROFESSIONAL DESIGNER
 12/6/2013 8:44:02 AM
 C:\pwworkspace\p1\dot\drivakosgn\10180315\10180315.dgn
 12/6/2013 8:44:02 AM

FILE NAME =	USER NAME = drivakosgn	DESIGNED - EVERS	REVISED - T. RAMMACHER 10-27-94
as\pwworkspace\p1\dot\drivakosgn\10180315\10180315.dgn		DRAWN -	REVISED - C. JUCCIUS 09-09-09
	PLOT SCALE = 50:000 / IN.	CHECKED -	REVISED -
	PLOT DATE = 9/9/2009	DATE - 03-19-90	REVISED -

**STATE OF ILLINOIS
DEPARTMENT OF TRANSPORTATION**

SCALE: NONE		SHEET NO. 1 OF 1 SHEETS		STA. TO STA.		DISTRICT ONE TYPICAL PAVEMENT MARKINGS		F.A. RTE. 2997	SECTION 13-00061-00-RS	COUNTY DUPAGE	TOTAL SHEETS 25	SHEET NO. 19
								TC-13		CONTRACT NO. 63895		
FED. ROAD DIST. NO. 1 (ILLINOIS) FED. AID PROJECT												

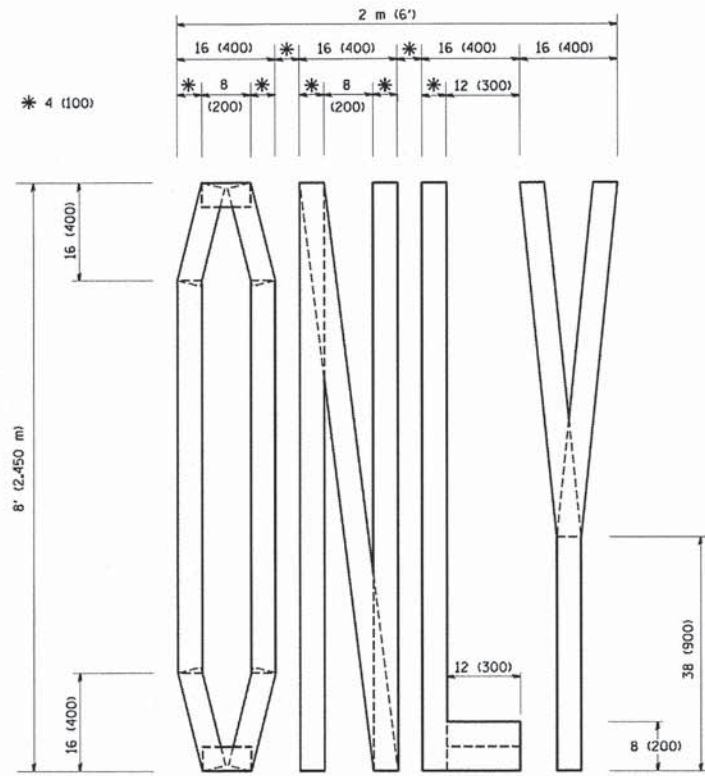

QUANTITY
4 (100) LINE = 64.1 ft. (19.7 m)
21.1 sq. ft. (1.97 sq. m)

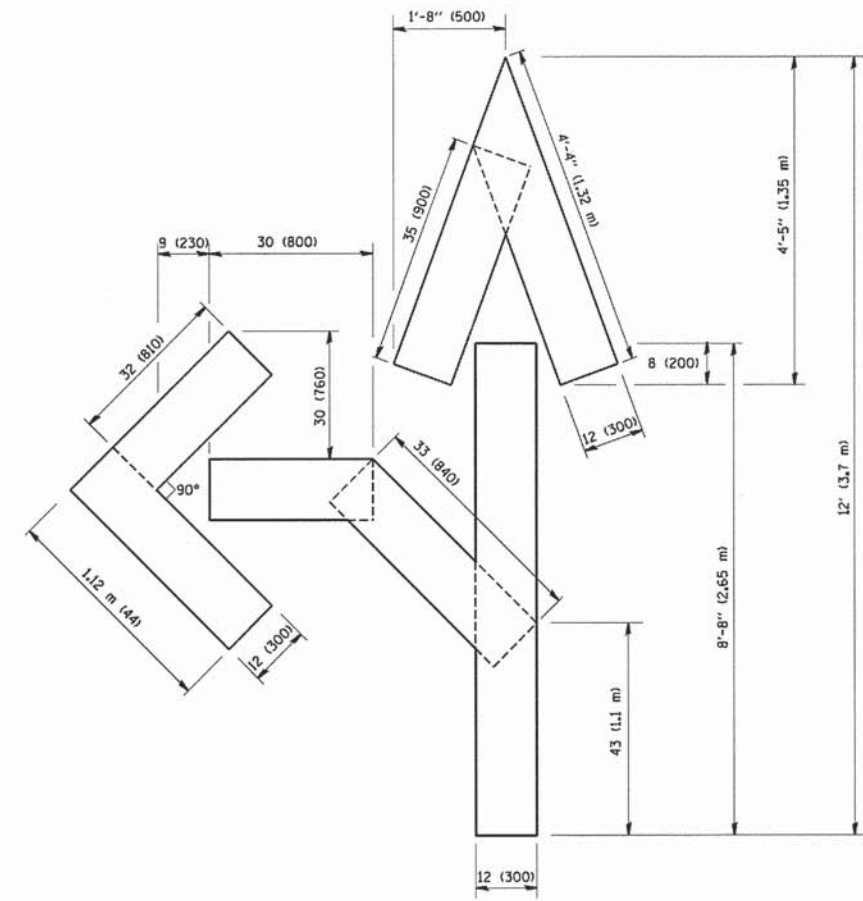

QUANTITY
4 (100) LINE = 82.5 ft. (25.3 m)
27.5 sq. ft. (2.53 sq. m)

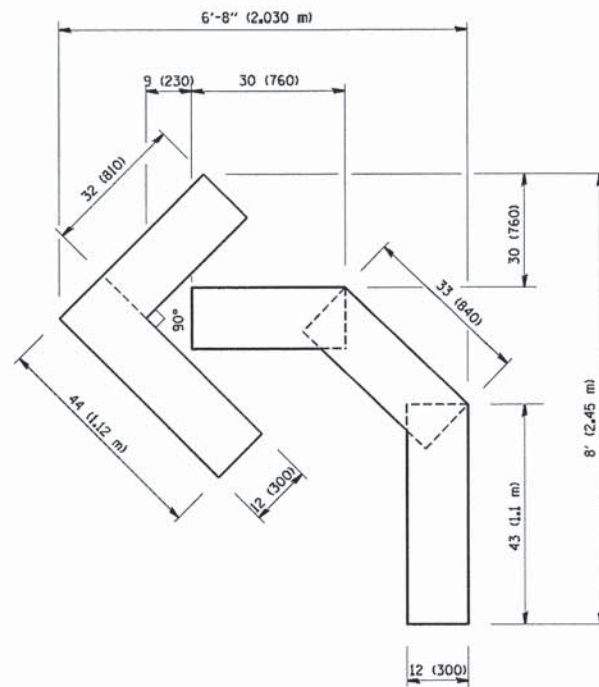

QUANTITY
4 (100) LINE = 45.5 ft. (13.9 m)
15.2 sq. ft. (1.39 sq. m)

All dimensions are in inches (millimeters) unless otherwise shown.

Copyright © 2011 by BAXTER & WOODMAN, INC.
A PROFESSIONAL ENGINEERING FIRM
1100 S. W. 10th Street, Fort Lauderdale, FL 33311
Tel: 954-575-1100 Fax: 954-575-1101
www.baxterwoodman.com
Project: 13-0061-00-RS - DUPAGE
Sheet: TC-16
Date: 09/18/94

FILE NAME =	USER NAME = goglionobt	DESIGNED -	REVISED - T. RAMMACHER 06-05-96
W:\distated\22x34\16.dgn		DRAWN -	REVISED - T. RAMMACHER 11-04-97
	PLOT SCALE = 50.0000" / IN.	CHECKED -	REVISED - T. RAMMACHER 03-02-98
	PLOT DATE = 1/4/2008	DATE = 09-18-94	REVISED - E. GOMEZ 08-28-00

STATE OF ILLINOIS
DEPARTMENT OF TRANSPORTATION

PAVEMENT MARKING LETTERS AND SYMBOLS
FOR TRAFFIC STAGING

SCALE: NONE SHEET NO. 1 OF 1 SHEETS STA. TO STA.

F.A. RTE.	SECTION	COUNTY	TOTAL SHEETS	SHEET NO.
2997	13-0061-00-RS	DUPAGE	25	20
TC-16			CONTRACT NO. 63895	
FED. ROAD DIST. NO. 1 ILLINOIS FED. AID PROJECT				

COPYRIGHT © 2011 BY BAXTER & WOODMAN, INC.
 STATE OF ILLINOIS - PROFESSIONAL DESIGN FIRM
 PROJECT NO. 13-00061-00-RS
 12/6/2013 8:45:57 AM
 W:\distata\22x34\to22.dgn
 ...gaglionobt
 W:\proj\road\projecta\dev\dev\13-00061-00-RS\Sheets-PARK\01.DETS - TC.dwt

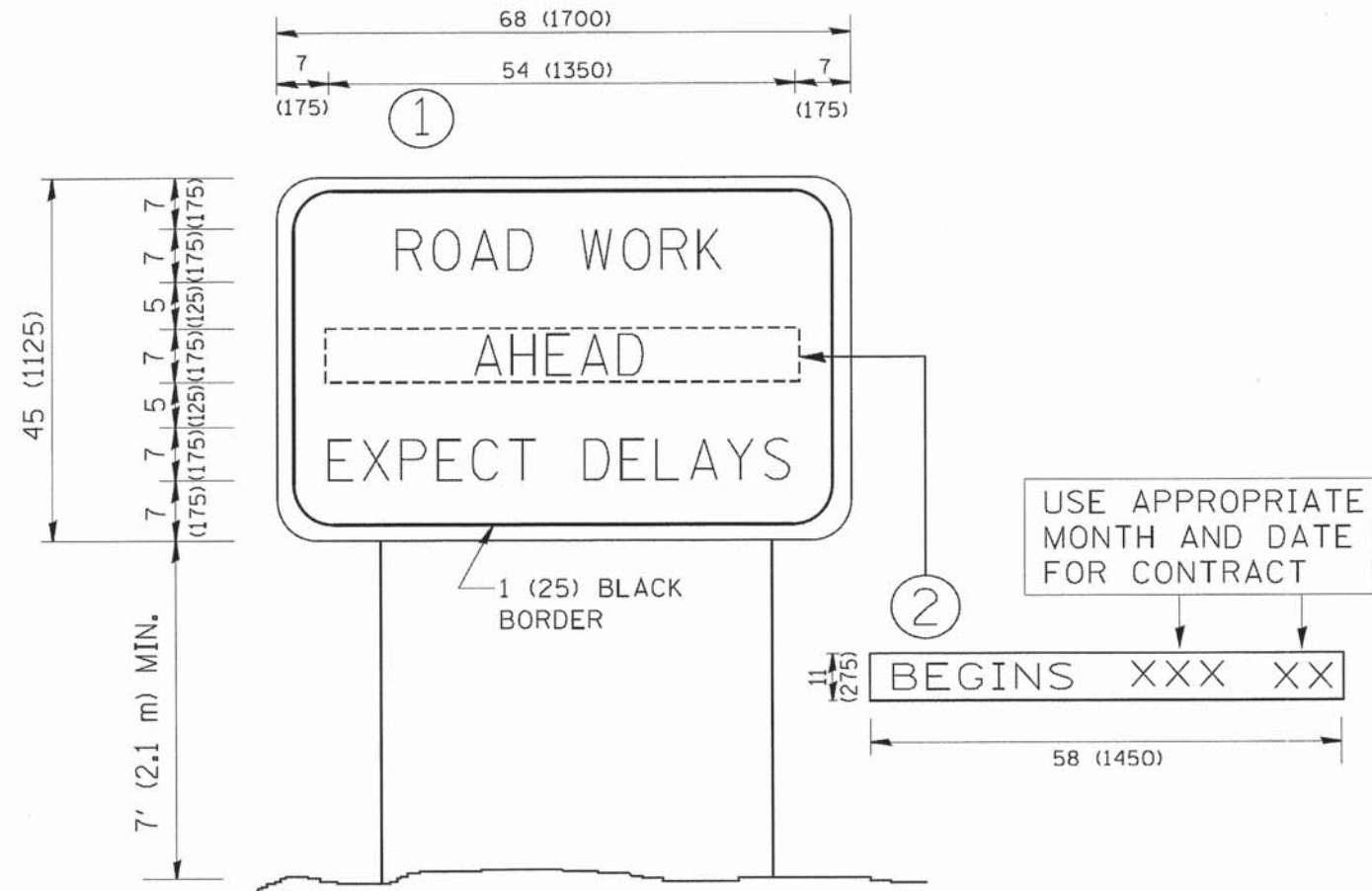

NOTES:

1. USE BLACK LETTERING ON ORANGE BACKGROUND.
2. ERECT SIGNS IN ADVANCE OF THE LOCATION FOR THE "ROAD CONSTRUCTION AHEAD" SIGN AT LOCATIONS AS DIRECTED BY THE ENGINEER.
3. ERECT SIGN ① WITH INSTALLED PANEL ② ONE WEEK PRIOR TO THE START OF CONSTRUCTION.
4. REMOVE PANEL ② SOON AFTER THE START OF CONSTRUCTION.
5. SEE SPECIAL PROVISION FOR "TEMPORARY INFORMATION SIGNING" FOR ADDITIONAL INFORMATION.
6. ONE SIGN ASSEMBLY EQUALS 25.70 SQ. FT. (2.3 SQ. M.)
7. SHALL BE PAID FOR AS TEMPORARY INFORMATION SIGNING.

ALL DIMENSIONS ARE IN INCHES (MILLIMETERS) UNLESS OTHERWISE SHOWN.

FILE NAME = W:\distata\22x34\to22.dgn	USER NAME = gaglionobt	DESIGNED -	REVISED - R. MIRS 09-15-97	STATE OF ILLINOIS DEPARTMENT OF TRANSPORTATION	ARTERIAL ROAD INFORMATION SIGN	F.A. - RTE. 2997	SECTION 13-00061-00-RS	COUNTY DUPAGE	TOTAL SHEETS 25	SHEET NO. 21		
PLOT SCALE = 50.000' / IN.	CHECKED -	REVISED - T. RAMMACHER 02-02-99	REVISED - R. MIRS 12-11-97			SCALE: NONE	SHEET NO. 1 OF 1 SHEETS	STA.	TO STA.	FED. ROAD DIST. NO. 1 ILLINOIS FED. AID PROJECT		
PLOT DATE = 1/4/2008	DATE -	REVISED - C. JUCIUS 01-31-07	REVISED -			CONTRACT NO. 63895						

LOOP DETECTOR NOTES

1. EACH PAIR OF LOOP WIRES SHALL BE PLACED IN A SEPARATE EMPTY COILABLE NONMETALLIC CONDUIT FROM THE EDGE OF PAVEMENT TO THE HANDHOLE. SPACING BETWEEN THE HOLES DRILLED IN THE PAVEMENT SHALL NOT BE LESS THAN 6" (150 mm). EMPTY COILABLE NONMETALLIC CONDUIT SHALL BE INCLUDED IN THE COST OF THE LOOP WIRE.
2. THE NUMBER OF LOOP TURNS SHALL BE AS RECOMMENDED BY THE AMPLIFIER MANUFACTURER. ALL ADJACENT SIDES OF THE LOOPS SHALL BE INSTALLED IN SUCH A WAY THAT THE CURRENT FLOW IS IN THE SAME DIRECTION TO REINFORCE ITS MAGNETIC FIELDS FOR SMALL VEHICLE DETECTION.
3. EACH LOOP LEAD-IN SHALL BE IDENTIFIED AND PERMANENTLY TAGGED IN THE HANDHOLE. EACH LEAD-IN CABLE TAG SHALL INDICATE THE LOCATION OF THE LOOP, LOOP ROTATION (CLOCKWISE/COUNTERCLOCKWISE), LOOP LEAD-IN DIRECTION (IN OR OUT), LOOP CABLE NUMBER AND LOCATION IN CABINET, AND NUMBER OF TURNS IN THE DETECTOR LOOPS IN WATER PROOF INK AS INDICATED ON THE DISTRICT 1 STANDARD TRAFFIC SIGNAL DESIGN DETAIL. THE CONTRACTOR SHALL MARK LOOP LOCATIONS ON RECORD DRAWINGS AND PRESENT TO THE ENGINEER AFTER FINAL INSPECTION. LOOPS SHALL BE MARKED BY LANE AND LOOP NUMBER. SEE DETAIL BELOW.
4. ALL LOOP CABLE SHALL BE FASTENED WITH PLASTIC TIE WRAP TO THE HANDHOLE HOOKS.
5. IN ASPHALT PAVEMENT, LOOPS SHOULD BE PLACED IN THE BINDER AND DIVESHOLES MARKED AT THE CURB WITH A SAW-CUT. THE SAW-CUT SHALL BE CUT IN ACCORDANCE WITH LOCAL AND E.P.A. DUST CONTROL REQUIREMENTS. DETECTOR LOOP(S) SHALL NOT BE INSTALLED IN WET CONDITIONS AND THE SAW-CUTS MUST BE FREE OF DEBRIS AND RESIDUE SUCH AS DUST AND WATER WHICH IS TO BE ACHIEVED BY THE USE OF COMPRESSED AIR, WIRE BRUSHING AND HEAT DRYING ACCORDING TO SEALANT MANUFACTURER REQUIREMENTS. THE DETECTOR WIRE SHALL BE HELD IN PLACE BY THE USE OF FORM WEDGES. WEDGES SHALL BE SPACED NO MORE THAN 18" (450 mm) APART.
6. LOOP SPLICES SHALL BE SOLDERED USING A SOLDERING IRON. BLOW TORCHES OR OTHER DEVICES WHICH OXIDIZE COPPER CABLE SHALL NOT BE ALLOWED FOR SOLDERING OPERATIONS. SEE DETAIL BELOW RIGHT.
7. PREFORMED DETECTOR LOOPS SHALL BE USED, AS SHOWN ON THE PLANS, WHERE NEW CONCRETE PAVEMENT IS PROPOSED. THE INSTALLATION OF PREFORMED LOOPS SHALL BE IN ACCORDANCE WITH THE DISTRICT 1 SPECIFICATIONS OR AS DIRECTED BY THE ENGINEER.

LOOP LEAD-IN CABLE TAG

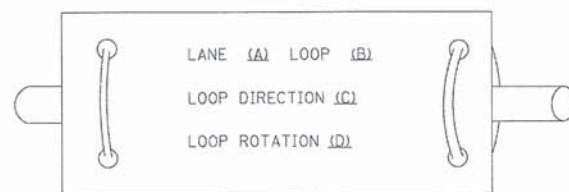

- A. LANE 1 IS THE LANE CLOSEST TO THE CENTERLINE OF THE ROADWAY
- B. LOOP #1 IS THE LOOP IN THE LANE CLOSEST TO THE INTERSECTION.
- C. LABEL LOOP CABLE "IN" OR LOOP CABLE "OUT".
- D. LABEL LOOP CABLE CLOCKWISE OR LOOP CABLE COUNTERCLOCKWISE.

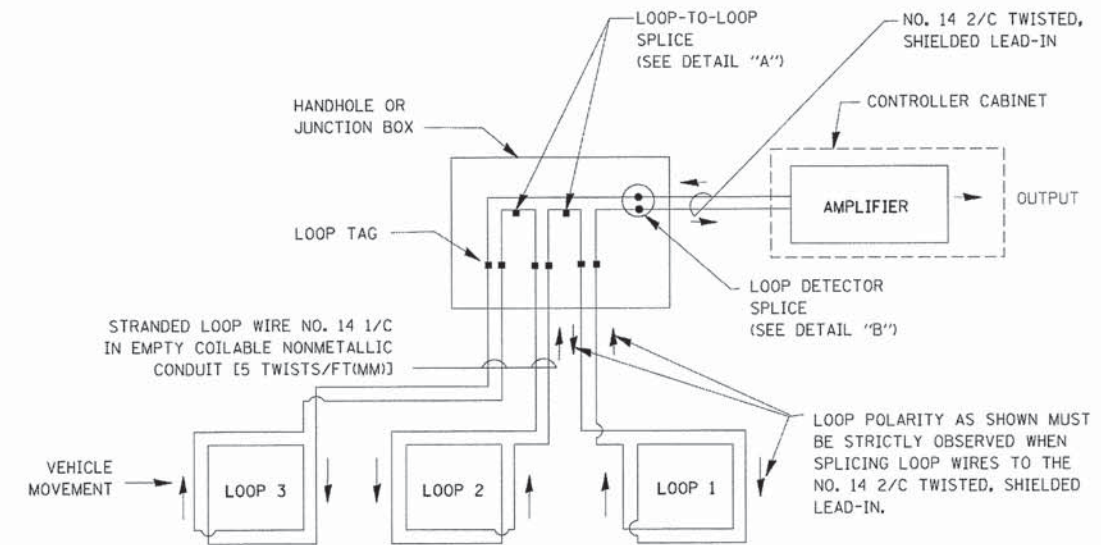

DETECTOR LOOP WIRING SCHEMATIC

- LOOPS SHALL BE SPLICED IN SERIES.
- SAW-CUTS SHALL BE A MINIMUM WIDTH OF 5/16" (8 mm).
- SAW-CUT DEPTHS SHALL BE 3" (75 mm). IF IN CONCRETE, THE SAW-CUT DEPTH SHALL BE TO THE TOP OF THE REINFORCEMENT.
- LOOP CORNERS SHALL BE DRILLED WITH A 2" (50 mm) DIAMETER CORE.

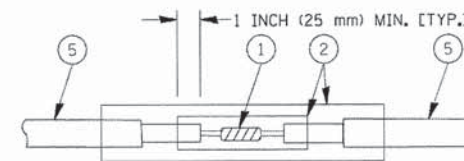

DETAIL "A" LOOP-TO-LOOP SPLICE

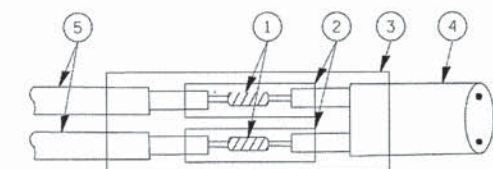

DETAIL "B" LOOP-TO-CONTROLLER SPLICE

TYPE I LOOP

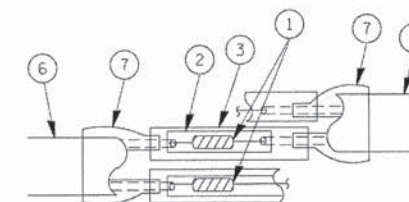

DETAIL "A" LOOP-TO-LOOP SPLICE

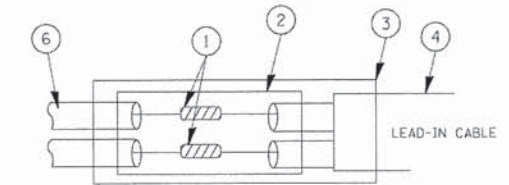

DETAIL "B" LOOP-TO-CONTROLLER SPLICE

LOOP DETECTOR SPLICE

- 1 WESTERN UNION SPLICE SOLDERED WITH ROSIN CORE FLUX. ALL EXPOSED SURFACES OF THE SOLDER SHALL BE SMOOTH.
- 2 WCSMW 30/100 HEAT SHRINK TUBE, MINIMUM LENGTH 3" (75 mm), UNDERWATER GRADE.
- 3 WCS 200/750 HEAT SHRINK TUBE, MINIMUM LENGTH 6" (150 mm), UNDERWATER GRADE.
- 4 NO. 14 2/C TWISTED, SHIELDED CABLE.
- 5 LOOP CONDUCTOR WITH FLEXIBLE PLASTIC TUBE.
- 6 PRE-FORMED LOOP
- 7 XL POLYOLEFIN 2 CONDUCTOR BREAKOUT SEALS. TYCO CBR-2 OR APPROVED EQUAL

COPYRIGHT © 2011 BY BAXTER & WOODMAN, INC.
 STATE OF ILLINOIS - PROFESSIONAL DESIGN FIRM
 11/14/2009 10:54 AM
 ...\\pwwork\pwwork\BWAUER\DL\8108315\ts05.dgn
 ...\\pwwork\pwwork\BWAUER\DL\8108315\ts05.dgn
 ...\\pwwork\pwwork\BWAUER\DL\8108315\ts05.dgn

FILE NAME =	USER NAME = bauerdl	DESIGNED - DAD	REVISED -
es:\pwwork\pwwork\BWAUER\DL\8108315\ts05.dgn		DRAWN - BCK	REVISED -
		CHECKED - DAD	REVISED -
		DATE - 10-28-09	REVISED -

**STATE OF ILLINOIS
DEPARTMENT OF TRANSPORTATION**

**DISTRICT ONE
STANDARD TRAFFIC SIGNAL DESIGN DETAILS**

F.A. RTE.	SECTION	COUNTY	TOTAL SHEETS	SHEET NO.
2997	13-00061-00-RS	DUPAGE	25	22
TS-05			CONTRACT NO. 63895	
FED. ROAD DIST. NO. 1 [ILLINOIS] FED. AID PROJECT				

SCALE: NONE SHEET NO. 1 OF 6 SHEETS STA. TO STA.

LOOPS NEXT TO SHOULDERS

PROVIDE A PAVEMENT REPLACEMENT
NOTE WHICH SHOULD EQUAL
3' (900 mm) X WIDTH OF
PAVED SHOULDER.

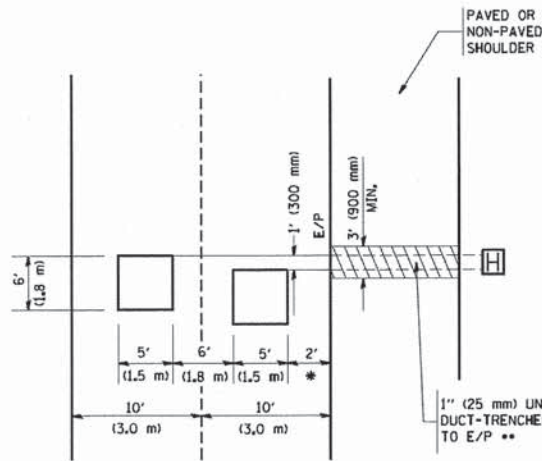

* = (600 mm)

** UNIT DUCT IS TO BE SHOWN ON PLAN SHEETS
BUT SHALL NOT BE INCLUDED IN THE PAY ITEMS.

**LEFT TURN LANES WITH MEDIANS
VOLUME DENSITY ("FAR OUT" DETECTION)
ON SAME APPROACH
(PROTECTED / PERMITTED LEFT TURN PHASING)**

HANDHOLE LOCATION MAY
VARY DEPENDING ON GEOMETRICS
AND DESIGN OF TRAFFIC SIGNALS.
HEAVY-DUTY HANDHOLES TO BE
USED WHEN THE MEDIAN IS
MOUNTABLE. REFER TO STANDARD
S14001 TO ENSURE THAT HANDHOLE
FITS IN MEDIAN.

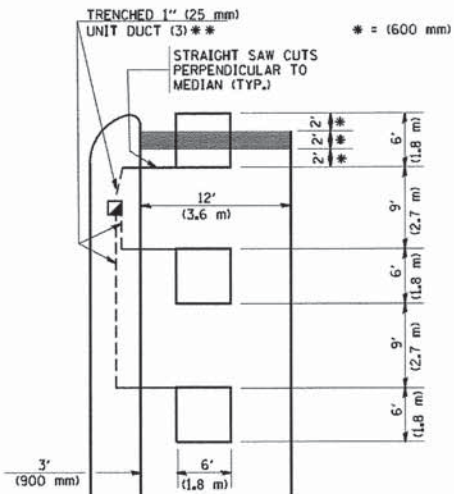

* = (600 mm)

** UNIT DUCT IS TO BE SHOWN ON PLAN SHEETS
BUT SHALL NOT BE INCLUDED IN THE PAY ITEMS.

NOTE: DUAL LEFT TURNS NOT SHOWN REFER TO
PLAN SHEET FOR DETECTOR LOOP REPLACEMENT

**LEFT TURN LANES WITHOUT MEDIANS
VOLUME DENSITY ("FAR OUT" DETECTION)
ON SAME APPROACH
(PROTECTED / PERMITTED LEFT TURN PHASING)**

* = (600 mm)

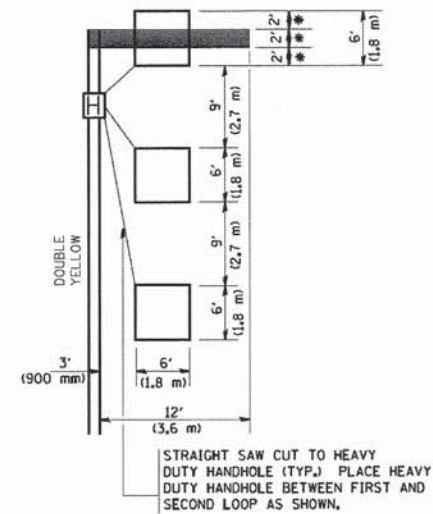

NOTE: DUAL LEFT TURNS NOT SHOWN REFER TO
PLAN SHEET FOR DETECTOR LOOP REPLACEMENT

**ARTERIAL-VOLUME DENSITY ("FAR OUT" DETECTION)
CROSS STREET-VOLUME DENSITY ("FAR OUT" DETECTION)**

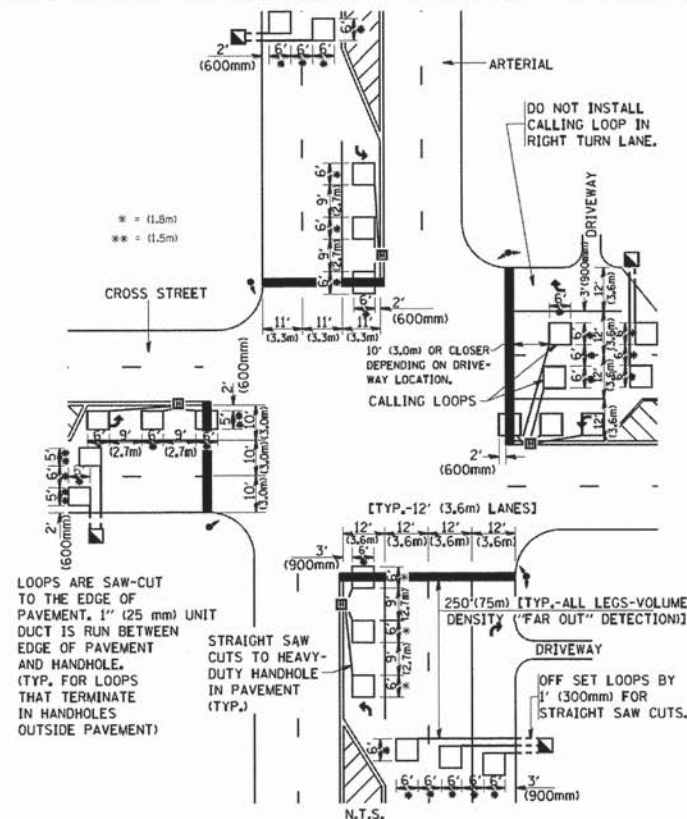

LOOPS ARE SAW-CUT
TO THE EDGE OF
PAVEMENT. 1" (25mm) UNIT
DUCT IS RUN BETWEEN
EDGE OF PAVEMENT
AND HANDHOLE.
(TYP. FOR LOOPS
THAT TERMINATE
IN HANDHOLES
OUTSIDE PAVEMENT)

STRAIGHT SAW
CUTS TO HEAVY-
DUTY HANDHOLE
IN PAVEMENT
(TYP.)

**DETAIL 1
N.T.S.**

**ARTERIAL-VOLUME DENSITY ("FAR OUT" DETECTION)
CROSS STREET-NON VOLUME DENSITY ("UPTIGHT" PRESENCE DETECTION)**

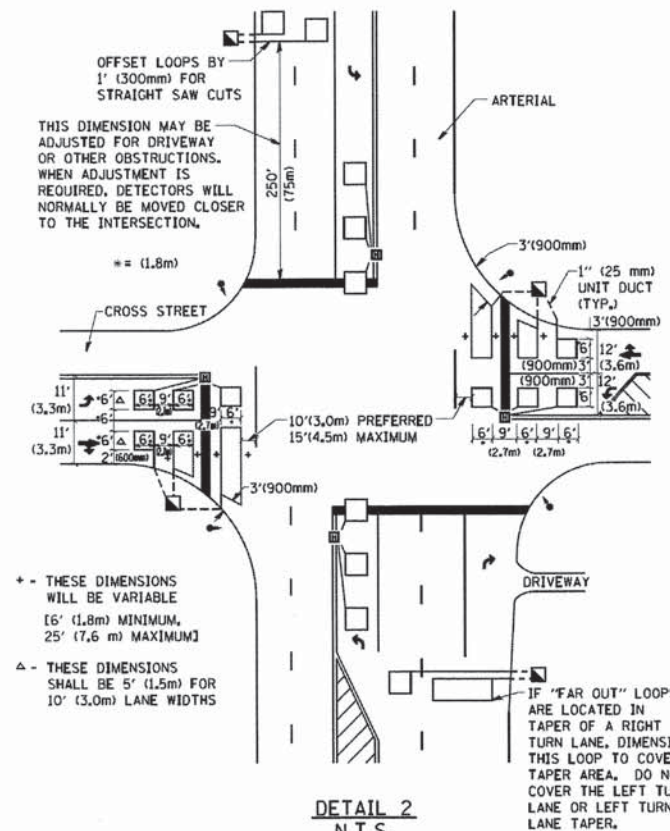

+- THESE DIMENSIONS
WILL BE VARIABLE
[6' (1.8m) MINIMUM,
25' (7.6 m) MAXIMUM]

△ - THESE DIMENSIONS
SHALL BE 5' (1.5m) FOR
10' (3.0m) LANE WIDTHS

IF "FAR OUT" LOOPS
ARE LOCATED IN
TAPER OF A RIGHT
TURN LANE, DIMENSION
THIS LOOP TO COVER
TAPER AREA. DO NOT
COVER THE LEFT TURN
LANE OR LEFT TURN
LANE TAPER.

**DETAIL 2
N.T.S.**

NOTES:

VEHICLES LOOP DETECTORS

- * ALL LEAD IN CABLE SHALL BE TWO CONDUCTOR NO. 14 TWISTED, SHIELDED.
- * EACH DETECTOR LOOP SHALL HAVE ITS OWN SAW CUT FROM THE LOOP TO THE EDGE OF PAVEMENT OR TO A HANDHOLE IN THE PAVEMENT.
- * EACH DETECTOR LOOP SHALL HAVE ITS OWN ONE INCH (25 mm) UNIT DUCT BETWEEN THE EDGE OF PAVEMENT AND THE FIRST HANDHOLE OR JUNCTION BOX. EACH UNIT DUCT RUN SHALL BE SHOWN ON THE PLANS BY THE DESIGNER, BUT SHALL NOT BE PAID FOR SEPARATELY. THIS ITEM IS INCIDENTAL TO THE PAY ITEM FOR DETECTOR LOOPS.
- * ONE DIMENSION OF ALL DETECTOR LOOPS SHALL BE SIX FEET (1.8 m)
- * EACH LANE OF NON-LOCKING, PRESENCE DETECTION AND EACH LANE OF A DOUBLE LEFT TURN LANE REQUIRES A SEPARATE INDUCTIVE LOOP DETECTOR AND LEAD IN CABLE.
- * WHEN NON-LOCKING, PRESENCE DETECTION IS USED, MORE THAN ONE LOOP PER LANE IS REQUIRED BEHIND THE STOP BAR (i.e. 1-1/2, 1-3/4, 2).
- * WHEN SYSTEM LOOPS ARE REQUIRED ON AN APPROACH OF AN INTERSECTION, THE LOOPS USED FOR VOLUME DENSITY AND INTERSECTION TIMING SHALL ALSO BE USED AS SYSTEM DETECTORS. EACH ONE OF THESE TYPE OF LOOPS REQUIRES A SEPARATE TWO CONDUCTOR NO. 14 TWISTED SHIELDED CABLE AND A SEPARATE INDUCTIVE LOOP DETECTOR WHEN NEW CONTROLLERS ARE UTILIZED. THE DESIGNER SHALL LABEL THESE TYPES OF LOOPS AS "INTERSECTION AND SAMPLING (SYSTEM) DETECTORS" ON THE SIGNAL LAYOUT, THE INTERCONNECT PLAN AND THE SYSTEM CABLE PLAN. WHEN AN EXISTING CONTROLLER IS UTILIZED FOR THIS TYPE OF DETECTION, THE PAY ITEM "INDUCTIVE LOOP DETECTOR WITH SYSTEM OUTPUT" SHOULD BE USED.

PLACEMENT OF DETECTORS

THE FOLLOWING FIGURES REPRESENT THE MOST COMMON DETECTOR LOOP LOCATIONS AND SIZES. ADJUSTMENTS WILL BE NECESSARY FOR SPECIFIC GEOMETRIC CONSIDERATIONS.

LOCATIONS AND DIMENSIONS OF DETECTOR LOOPS ARE REQUIRED ON ALL SIGNAL LAYOUT PLAN SHEETS.

"FAR OUT" DETECTION REFERS TO LOCKING, PRESENCE TYPE DETECTION LOCATED IN THRU LANES, RIGHT TURN LANES, AND RIGHT TURN LANE TAPER AREAS (IF APPLICABLE), USUALLY 250' (75 m) IN ADVANCE OF STOP BARS. "UPTIGHT" DETECTION REFERS TO NON-LOCKING PRESENCE TYPE DETECTION LOCATED IN ALL LANES AND 10'-15' (3.0 m-4.5 m) BEHIND THE CROSSING STREET'S EDGE OF PAVEMENT EXTENDED.

NOTE:

ALL DETAILS AND NOTES SHOWN ARE FROM THE I.D.O.T. DISTRICT 1 TRAFFIC SIGNAL DESIGN GUIDELINES DATED JANUARY 1995

THIS DRAWING HAS BEEN PREPARED TO ASSIST THE RESIDENT ENGINEER FOR ALL ROADWAY RESURFACING OR S.M.A.R.T. PROJECTS WHERE THE DIMENSIONS ARE NOT SHOWN ON THE PLANS AND THE FINAL LOCATIONS FOR CROSSWALKS OR STOP BARS ARE NOT DETERMINED.

Copyright © 2011 by BAXTER & WOODMAN, INC.
 1000 North 1st Street, Suite 100, Oak Park, IL 60452
 License No. 184-0023 - EXPRESS 4/20/2013
 02/6/2013 8:45:32 AM
 File Name: W:\data\22x34\ts87.dgn
 User Name: gaglianob
 Designed: -
 Drawn: -
 Checked: R.K.F.
 Date: -
 Revised: -
 Revised: -
 Revised: -
 Revised: -
 Scale: NONE
 Sheet No. 1 of 1 Sheets
 STA. TO STA.

FILE NAME = W:\data\22x34\ts87.dgn	USER NAME = gaglianob	DESIGNED -	REVISED -	STATE OF ILLINOIS DEPARTMENT OF TRANSPORTATION	DISTRICT 1 - DETECTOR LOOP INSTALLATION DETAILS FOR ROADWAY RESURFACING				F.A. - RTE. 2997	SECTION 13-0061-00-R5	COUNTY DUPAGE	TOTAL SHEETS 25	SHEET NO. 23
PLOT SCALE = 50.0000' / IN.	PLOT DATE = 1/4/2008	CHECKED - R.K.F.	REVISED -		SCALE: NONE	SHEET NO. 1 OF 1 SHEETS	STA.	TO STA.	TS-07		CONTRACT NO. 63895		
		DATE -	REVISED -										

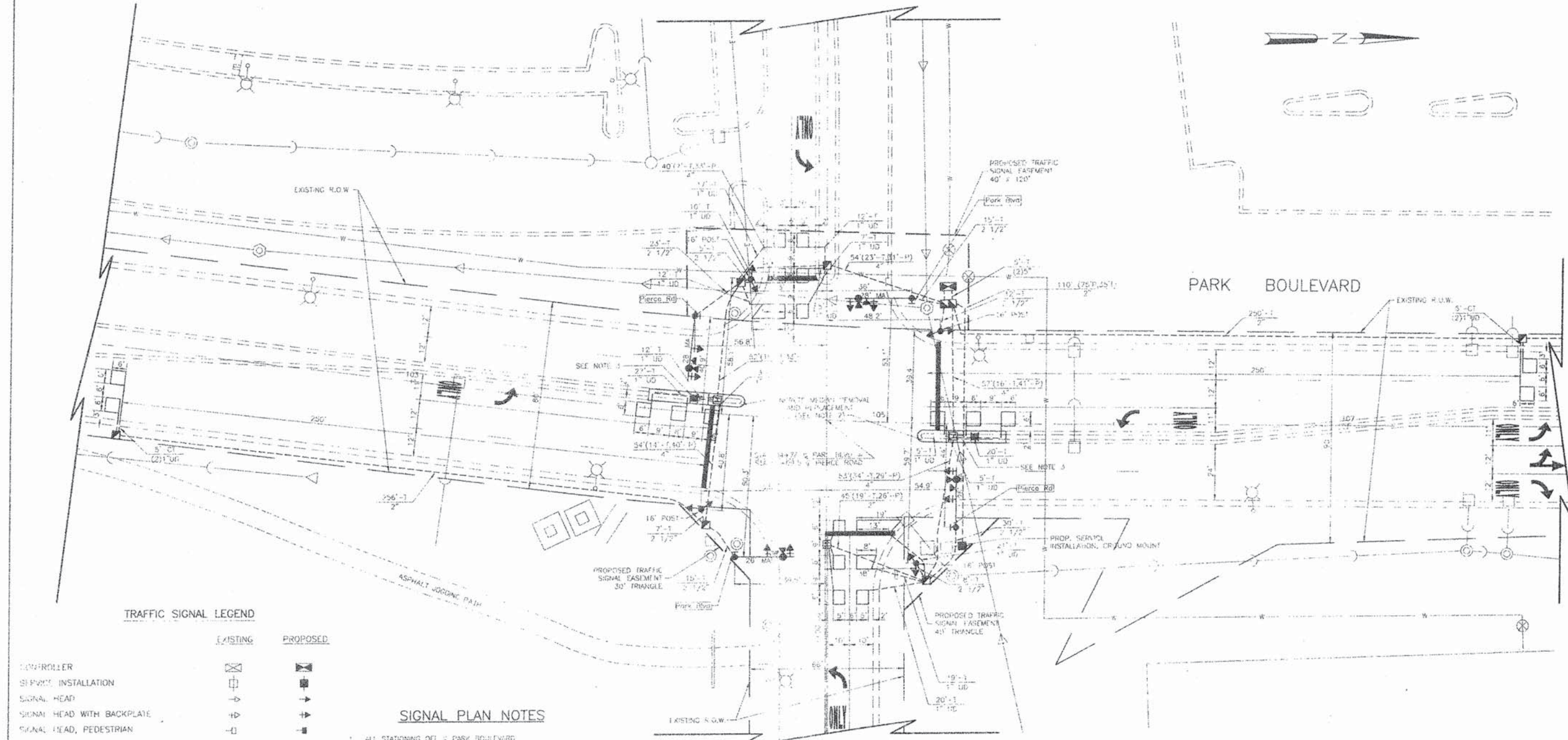

TRAFFIC SIGNAL LEGEND

EXISTING	PROPOSED

SIGNAL PLAN NOTES

1. ALL STATIONING OFF OF PARK BOULEVARD.
2. CONCRETE MEDIAN NOSE ON SOUTH LEG SHALL BE FLUSH WITH ADJACENT PAVEMENT TO ACCOMMODATE FUTURE CROSSWALK, THEN TRANSITION TO EXISTING TYPE SB-612 MEDIAN NOSE ON NORTH LEG SHALL BE TYPE M-2, THEN TRANSITION TO EXISTING TYPE SB-612.
3. THE EXISTING STREET SIGNS LOCATED IN THE CENTER MEDIAN NOSES SHALL BE REMOVED AND RELOCATED AS SHOWN ON THE PLANS. THIS WILL BE PAID FOR AT THE CONTRACT UNIT PRICE EACH FOR "RELOCATE EXISTING SIGN" WHICH PRICE SHALL INCLUDE REMOVAL OF THE EXISTING SIGN AND FOUNDATION, CONSTRUCTION OF A NEW FOUNDATION OF THE SAME SIZE AND TYPE AS THE EXISTING AND ERECTION OF THE EXISTING SIGN ON THE NEW FOUNDATION.
4. THE CONTRACTOR SHALL NOTIFY THE VILLAGE OF TASCA PUBLIC WORKS AT (630) 232-2455, FIRE DEPARTMENT AT (630) 775-1223, AND POLICE DEPARTMENT AT (630) 775-1004 PRIOR TO THE START OF ANY WORK ON THE CONTRACT. A MINIMUM OF FIVE (5) WORKING DAYS ADVANCED NOTICE IS REQUIRED.
5. ALL MAST ARM MOUNTED SIGNAL HEADS ARE TO BE ATTACHED 2'-0" FROM THE END OF MAST ARM UNLESS OTHERWISE NOTED.
6. ALL SIGNAL POSTS SHALL BE SET BACK 4 FEET MINIMUM AND ALL MAST ARM POLES SHALL BE SET BACK 6 FEET MINIMUM FROM THEIR CENTER TO THE BACK OF CURB UNLESS OTHERWISE NOTED. ON NON-CURBED AREAS THE MAST ARM POLE AND THE SIGNAL POST SHALL BE LOCATED A MINIMUM OF 10 FEET BEHIND THE EDGE OF PAVEMENT OR 2 FEET BEHIND THE EDGE OF SHOULDER, WHICHEVER IS GREATER.

FOR REFERENCE ONLY

HAMILTON PARTNERS
TRAFFIC SIGNAL PLAN
 PARK BOULEVARD/PIERCE ROAD

SCALE: 1" = 20'
 DATE: 5/19/2000

DRAWN BY: JU
 CHECKED BY: KMM/GPO

REVISIONS	
NAME	DATE

DESIGNED - JGH	REVISED -
DRAWN - CJC	REVISED -
CHECKED - SLN	REVISED -
DATE - 11/11/13	FILE - 130089_SH_TS_Park.ksh

STATE OF ILLINOIS
 DEPARTMENT OF TRANSPORTATION

COOK COUNTY HIGHWAY DEPARTMENT
 TRAFFIC SIGNAL PLANS
 (FOR REFERENCE ONLY)

F.A.U. RTE. 2997	SECTION 13-00061-00-RS	COUNTY DUPAGE	TOTAL SHEETS 25	SHEET NO. 24
FED. ROAD DIST. NO. 1 ILLINOIS FED. AID PROJECT			CONTRACT NO. 63895	

COPYRIGHT © 2013 BY BAXTER & WOODMAN, INC.
 STATE OF ILLINOIS - PROFESSIONAL DESIGN FIRM
 LICENSE NO. - 184-00081 - EXPIRES 4/30/2015
 1000001130089-HAMILTON SSA-CADD/UP-CADD/SH-TS-Park.ksh

PROPOSED CONTROLLER SEQUENCE

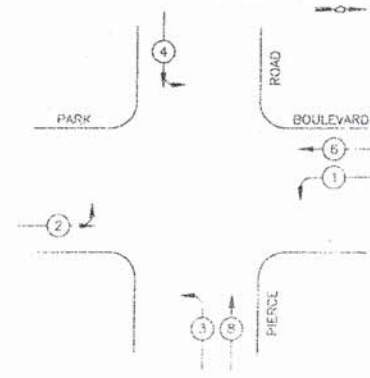

PROPOSED EMERGENCY VEHICLE PREEMPTION SEQUENCE

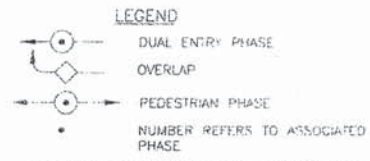
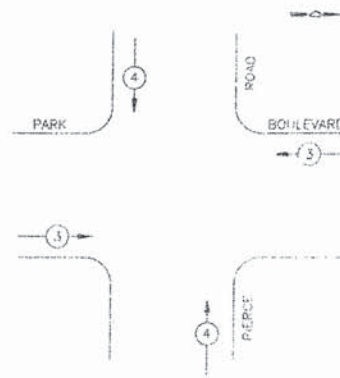

PHASE DESIGNATION DIAGRAM

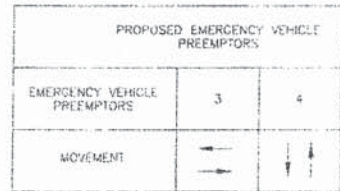

SCHEDULE OF QUANTITIES

UNIT	QTY	PAV ITEM
SUM	1	TRAFFIC CONTROL AND PROTECTION
SF	350	MEDIAN REMOVAL AND REPLACEMENT
SF	37	THERMOPLASTIC PAVEMENT - MARKING LETTERS & SYMBOLS
FOOT	76	THERMOPLASTIC PAVEMENT MARKING - LINE 6"
FOOT	125	THERMOPLASTIC PAVEMENT MARKING - LINE 24"
SF	30	THERMOPLASTIC PAVEMENT MARKING REMOVAL
FOOT	560	CONDUIT IN TRENCH, 2" DIA., GALVANIZED STEEL
FOOT	179	CONDUIT IN TRENCH, 2 1/2" DIA., GALVANIZED STEEL
FOOT	115	CONDUIT IN TRENCH, 4" DIA., GALVANIZED STEEL
FOOT	10	CONDUIT IN TRENCH, 5" DIA., GALVANIZED STEEL
FOOT	105	CONDUIT PUSHED, 2" DIA., GALVANIZED STEEL
FOOT	270	CONDUIT PUSHED, 4" DIA., GALVANIZED STEEL
EA	6	CONCRETE HANDHOLE
EA	5	CONCRETE HEAVY DUTY HANDHOLE
EA	1	CONCRETE DOUBLE HANDHOLE
FOOT	710	ELECTRIC CABLE IN CONDUIT, GROUNDING NO. 6 1C (GREEN)
FOOT	620	ELECTRIC CABLE IN CONDUIT, SIGNAL NO. 14 3C
FOOT	890	ELECTRIC CABLE IN CONDUIT, SIGNAL NO. 14 5C
FOOT	1970	ELECTRIC CABLE IN CONDUIT, SIGNAL NO. 14 7C
FOOT	1810	ELECTRIC CABLE IN CONDUIT, LEAD-IN NO. 14 1 PAIR
FOOT	125	ELECTRIC CABLE IN CONDUIT, SERVICE NO. 6 2C
EA	4	TRAFFIC SIGNAL POST, GALVANIZED STEEL, 16 FT
EA	2	STEEL MAST ARM ASSEMBLY AND POLE, 26 FT
EA	2	STEEL MAST ARM ASSEMBLY AND POLE, 28 FT
FOOT	16	CONCRETE FOUNDATION, TYPE A
FOOT	4	CONCRETE FOUNDATION, TYPE B
FOOT	40	CONCRETE FOUNDATION, TYPE C, 30-INCH DIA.
EA	6	SIGNAL HEAD, 1-FACE, 3-SECTION, MAST ARM MOUNTED
EA	2	SIGNAL HEAD, 1-FACE, 5-SECTION, MAST ARM MOUNTED
EA	2	SIGNAL HEAD, 2-FACE, 3-SECTION, BRACKET MOUNTED
EA	2	SIGNAL HEAD, 2-FACE, 1-3 SECTION, 1-5 SECTION, BRACKET MOUNTED
EA	8	TRAFFIC SIGNAL BACKPLATE
EA	8	INDUCTIVE LOOP DETECTOR
FOOT	660	DETECTOR LOOP, TYPE I
EA	1	FULL ACTUATED CONTROLLER AND TYPE IV CABINET
EA	1	SERVICE INSTALLATION, GROUND MOUNTED
FOOT	780	TRENCH AND BACKFILL FOR ELECTRICAL WORK
EA	2	RELOCATE EXISTING SIGN
FOOT	275	UNIT DUCT, WITHOUT CABLE, IN TRENCH 1"
FOOT	825	ELECTRIC CABLE IN CONDUIT NO. 20 3/C, TWISTED, SHIELDED
EA	1	AMBER-OFFSET COORDINATING UNIT
SF	30	SIGN PANEL - TYPE 1

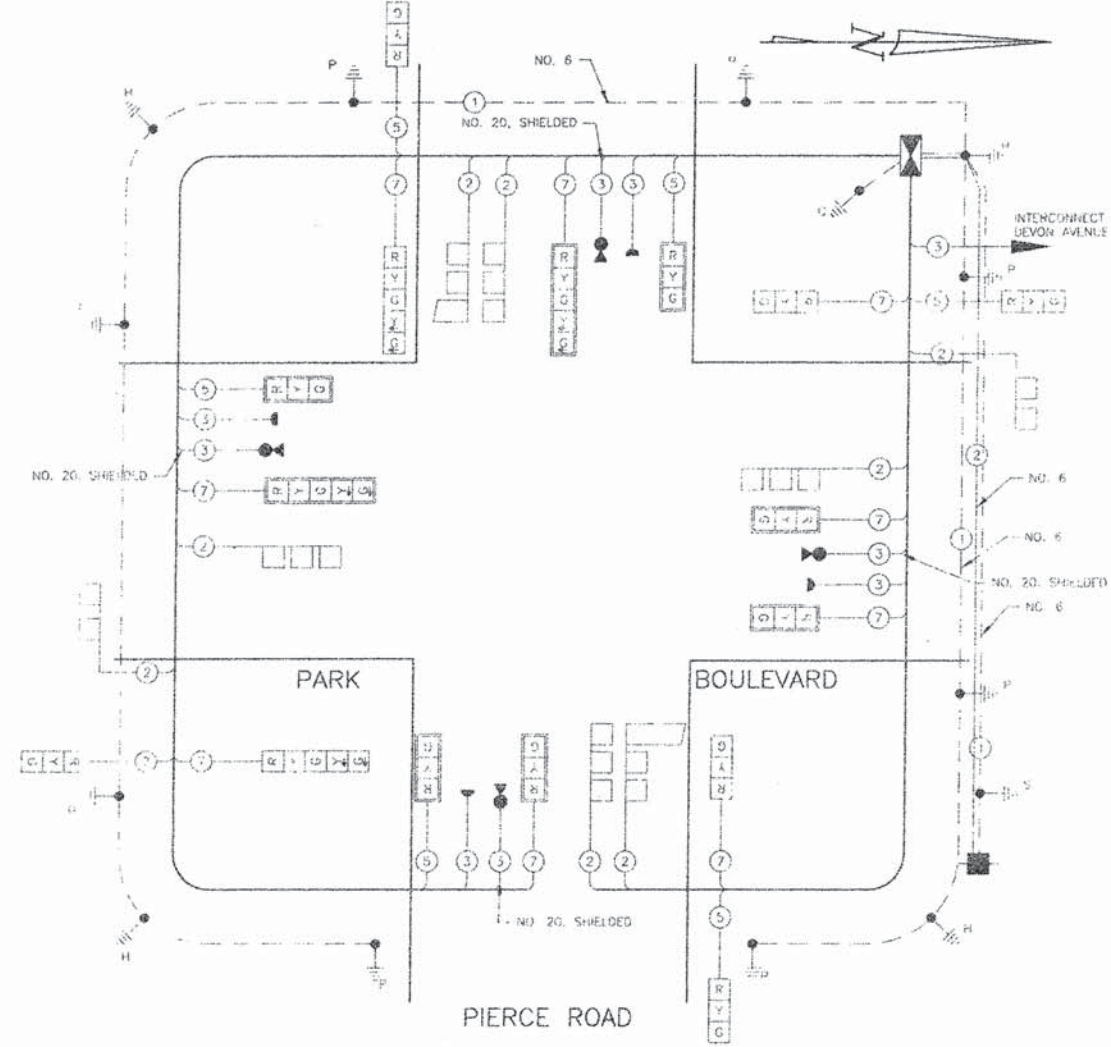

- NOTES:
- EASTBOUND LEFT TURN LANE LOOPS SHALL PLACE A CALL IN PHASE #2.
 - NORTHBOUND LEFT TURN LANE LOOPS SHALL PLACE A CALL IN PHASE #4.

CABLE PLAN
NOT TO SCALE

CABLE PLAN LEGEND

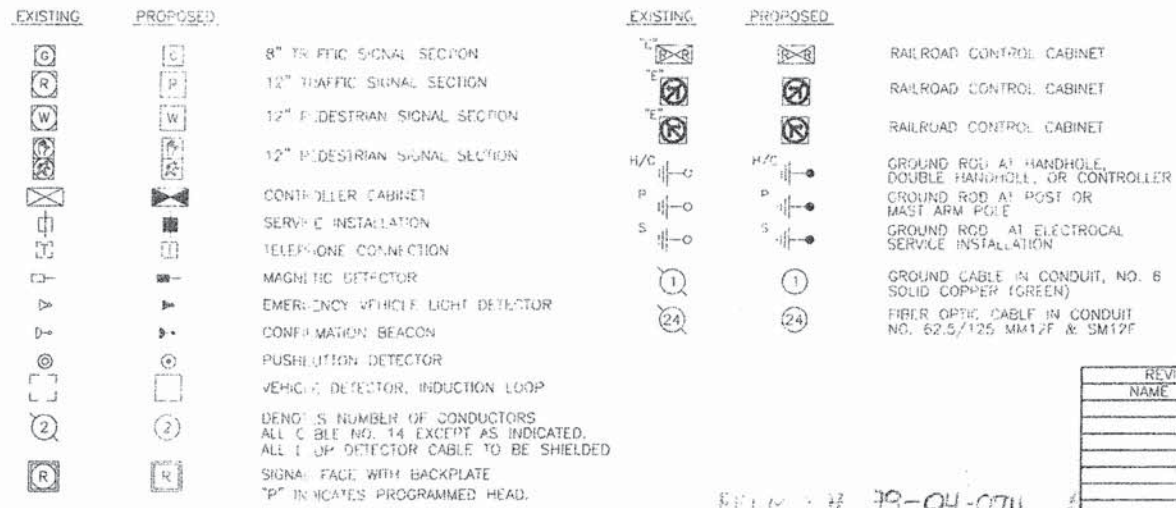

FOR REFERENCE ONLY

HAMILTON PARTNERS
CABLE PLAN, SCHEDULE OF QUANTITIES, SEQUENCE OF OPERATIONS
 PARK BOULEVARD/PIERCE ROAD

SCALE: NOT TO SCALE
 DATE: 5/19/2000
 DRAWN BY: JMJ
 CHECKED BY: KMM/SGP

REVISIONS	
NAME	DATE

COPYRIGHT © 2013 BY BAXTER & WOODMAN, INC.
 STATE OF ILLINOIS - PROFESSIONAL DESIGN FIRM
 LICENSE NO. 019-034035
 PROJECT NO. 130089-SH-TS-Park-Sht
 DRAWING NO. 19-04-0711

DESIGNED - JGH	REVISED -
DRAWN - CJC	REVISED -
CHECKED - SLN	REVISED -
DATE - 11/11/13	FILE - 130089-SH-TS-Park-Sht

STATE OF ILLINOIS
 DEPARTMENT OF TRANSPORTATION

COOK COUNTY HIGHWAY DEPARTMENT
 TRAFFIC SIGNAL PLANS
 (FOR REFERENCE ONLY)

F.A.U. RTE.	SECTION	COUNTY	TOTAL SHEETS	SHEET NO.
2997	13-00061-00-RS	DUPAGE	25	25
CONTRACT NO. 63895				

SCALE: STA. TO STA.