

ROUTE 150 WATERMAIN RELOCATION BETWEEN URBANA AND ST. JOSEPH ILLINOIS AMERICAN WATER COMPANY CHAMPAIGN COUNTY, ILLINOIS IDOT CONTRACT NO. 70663

HORIZONTAL AND VERTICAL CONTROL POINTS

PLANS PREPARED BASED ON IDOT STATIONING AND EXISTING GROUND ELEVATIONS. SEE IDOT HORIZONTAL AND VERTICAL CONTROL SHEETS FOR FURTHER DETAILS.

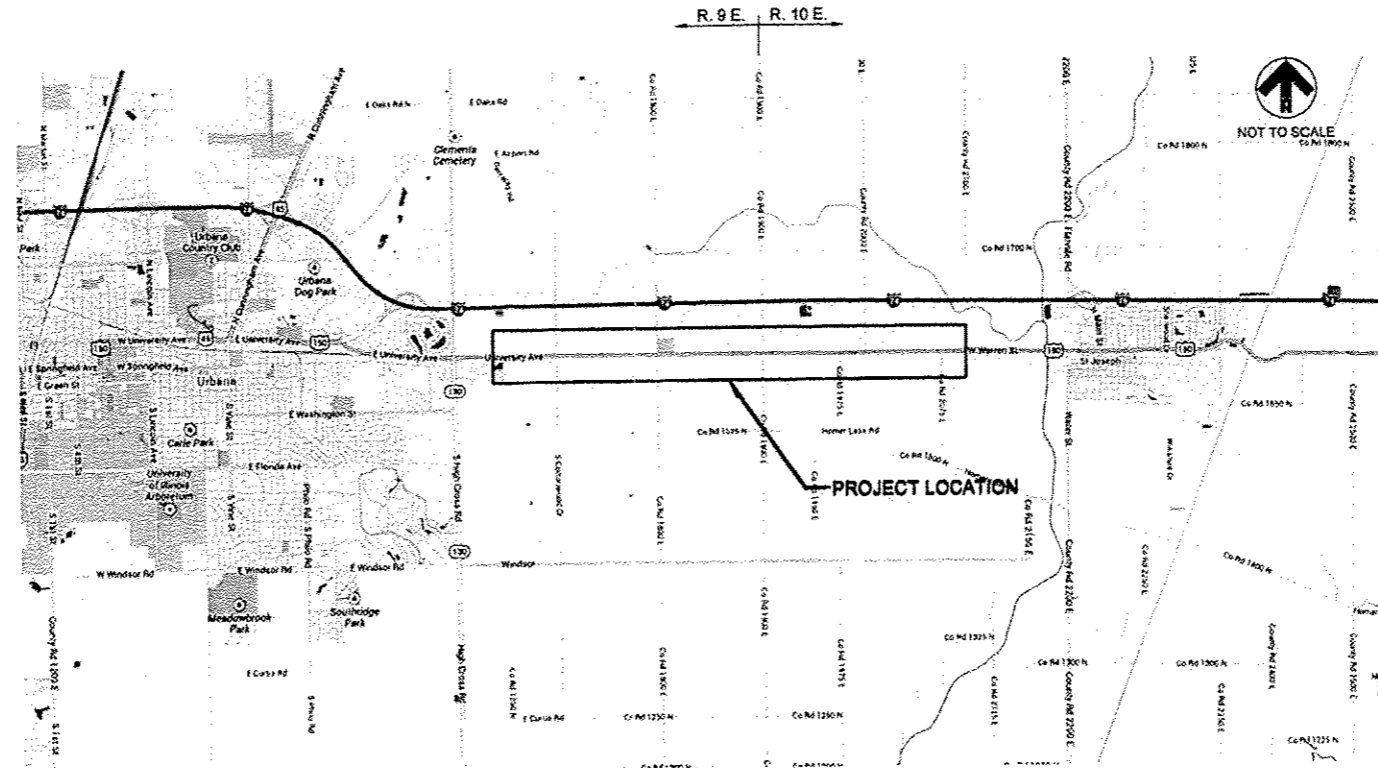

LOCATION MAP

INDEX OF SHEETS

- G0.01 COVER SHEET
- G0.02 STANDARD SYMBOLS
- G0.03 GENERAL NOTES & SUMMARY OF QUANTITIES
- C1.01 PLAN AND PROFILE - STA. 115+00 TO STA. 120+40
- C1.02 PLAN AND PROFILE - STA. 120+40 TO STA. 125+80
- C1.03 PLAN AND PROFILE - STA. 125+80 TO STA. 131+20
- C1.04 PLAN AND PROFILE - STA. 131+20 TO STA. 136+60
- C1.05 PLAN AND PROFILE - STA. 136+60 TO STA. 140+80
- C1.06 PLAN AND PROFILE - STA. 140+80 TO STA. 145+00
- C1.07 PLAN AND PROFILE - STA. 157+00 TO STA. 161+50
- C1.08 PLAN AND PROFILE - STA. 164+75 TO STA. 169+50
- C1.09 PLAN AND PROFILE - STA. 182+00 TO STA. 186+60
- C1.10 PLAN AND PROFILE - STA. 186+60 TO STA. 190+00
- C1.11 PLAN AND PROFILE - STA. 199+50 TO STA. 201+60
- C1.12 PLAN AND PROFILE - STA. 201+60 TO STA. 205+50
- C1.13 PLAN AND PROFILE - STA. 213+50 TO STA. 218+40
- C1.14 PLAN AND PROFILE - STA. 218+40 TO STA. 223+00
- C1.15 PLAN AND PROFILE - STA. 275+50 TO STA. 276+50
- C1.16 PLAN AND PROFILE - STA. 284+00 TO STA. 286+80
- C1.17 PLAN AND PROFILE - STA. 286+80 TO STA. 290+00
- C1.18 PLAN AND PROFILE - STA. 315+00 TO STA. 317+50
- C1.19 PLAN AND PROFILE - STA. 321+50 TO STA. 322+50
- C1.20 PLAN AND PROFILE - STA. 326+80 TO STA. 329+00
- C1.21 PLAN AND PROFILE - STA. 332+50 TO STA. 334+00
- C1.22 PLAN AND PROFILE - STA. 338+00 TO STA. 341+20
- C1.23 PLAN AND PROFILE - STA. 341+20 TO STA. 343+70
- C5.01 WATERMAIN DETAILS
- C5.02 BACKFILL DETAILS
- C5.03 DETAILS



CALL J.U.L.I.E. BEFORE YOU DIG
1-800-892-0123
COUNTY/CITY Champaign/Township
SECTION VARIOUS, T19N, R9E AND R10E

Steven Wegman 8/23/13
STEVEN WEGMAN, P.E.
SENIOR ENGINEER
ILLINOIS AMERICAN WATER

MATTHEW A. JOHNSON
 PROJECT DESIGN ENGINEER
 ILL. PROFESSIONAL ENGINEER NO. 61675
 EXPIRES NOVEMBER 30, 2013

IDPR DESIGN FIRM #184-004913	
Date of Preparation: July 17, 2013	PROJECT ID 11013
Foth	
Foth Infrastructure & Environment, LLC 1810 Broadview Drive Champaign, IL 61821 Phone: 217-242-1100 Fax: 217-242-0045	
REUSE OF DOCUMENTS	
THIS DOCUMENT HAS BEEN DEVELOPED FOR A SPECIFIC APPLICATION AND NOT FOR GENERAL USE. THEREFORE IT MAY NOT BE USED WITHOUT THE WRITTEN APPROVAL OF FOTH INFRASTRUCTURE AND ENVIRONMENT, LLC. UNAPPROVED USE IS THE SOLE RESPONSIBILITY OF THE UNAUTHORIZED USER.	
OF 29 SHEETS	