

SEC. 10, T. 19 N, R. 10 E.

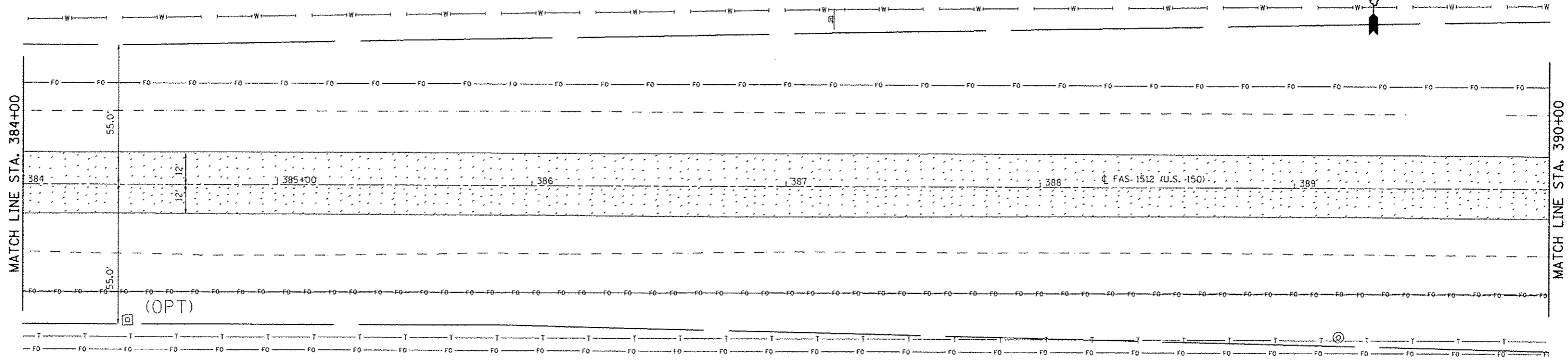
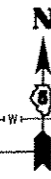

HMA SURFACE REMOVAL, 1 1/2" (MAINLINE)

SEC. 15, T. 19 N, R. 10 E.

SEC. 10, T. 19 N, R. 10 E.

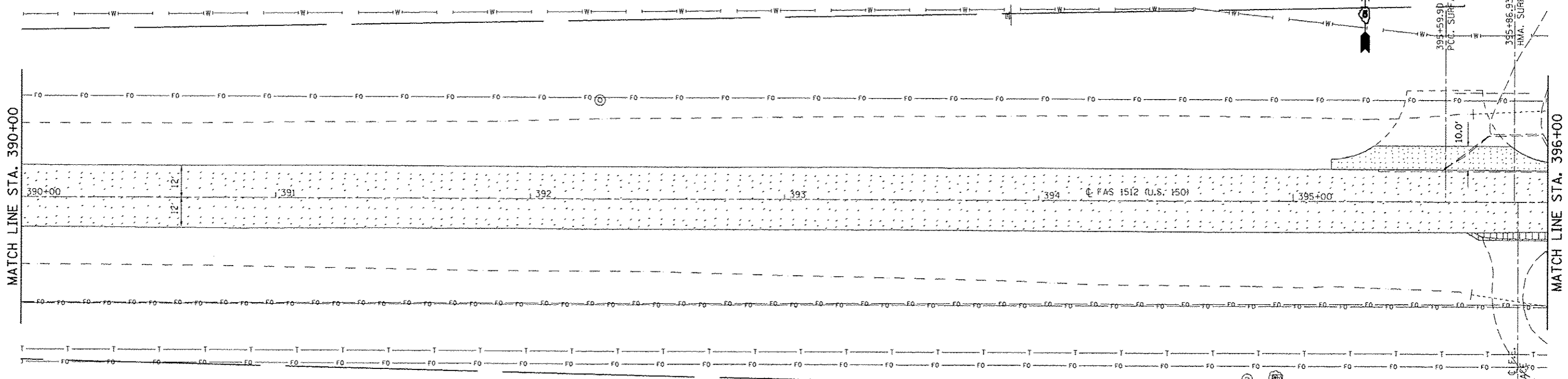

HMA SURFACE REMOVAL, 1 1/2" (MAINLINE) PCC SURFACE REMOVAL BUTT-JOINT PAVEMENT REMOVAL

SEE DETAIL FOR HMA SURF REM SPECIAL

PCC SURFACE REMOVAL BUTT-JOINT

SEC. 15, T. 19 N, R. 10 E.

FILE NAME :	USER NAME : ccr-loakjd	DESIGNED - JMS	REVISED -	STATE OF ILLINOIS DEPARTMENT OF TRANSPORTATION	REMOVAL DETAILS US 150 MAINLINE			F.A.U. RTE.	SECTION	COUNTY	TOTAL SHEETS	SHEET NO.
c:\pwwork\pwwork\ccr-loakjd\0120316\0570663-sht-removal.dgn		DRAWN - JMS	REVISED -		SCALE: 1:20	SHEET NO. 25 OF 27 SHEETS	STA. 384+00.00 TO STA. 396+00.00	12X,3RS-3 & 2RS-4	CHAMPAIGN	551	67	
		CHECKED -	REVISED -					FAU 7152 & FAS 1512	CONTRACT NO. 70663			
		DATE - 051011	REVISED -					ILLINOIS FED. AID PROJECT				