

SEC. 12, T. 19 N, R. 9 E.

30-21-12-400-001
SMITH, LORENE RUBY
5730007

172+00.00
40.00' LT

DATE	
BY	
PROJECT	
REVISIONS	
NOTES	
NO.	

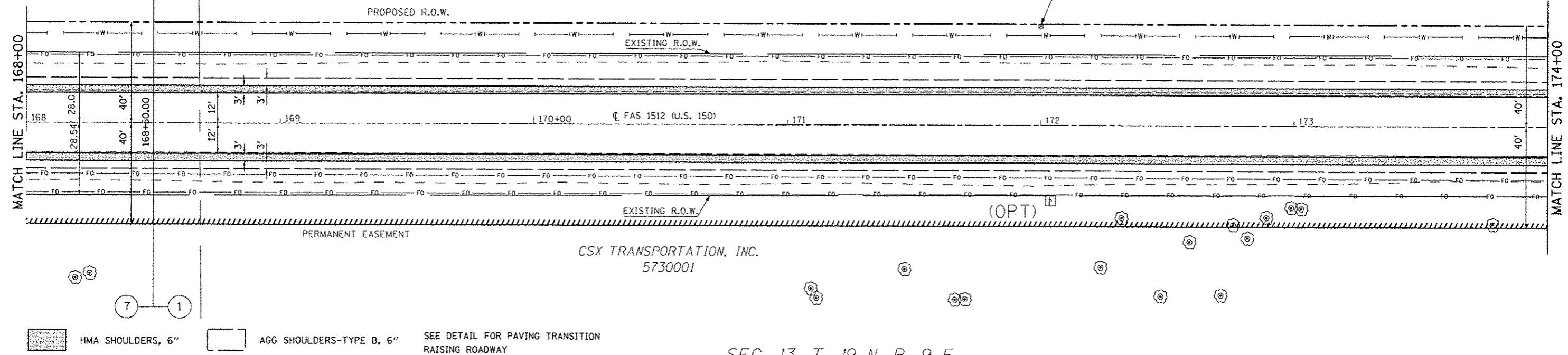

HMA SHOULDERS, 6" AGG SHOULDERS-TYPE B, 6" SEE DETAIL FOR PAVING TRANSITION RAISING ROADWAY

SEC. 13, T. 19 N, R. 9 E.

DATE	
BY	
PROJECT	
REVISIONS	
NOTES	
NO.	

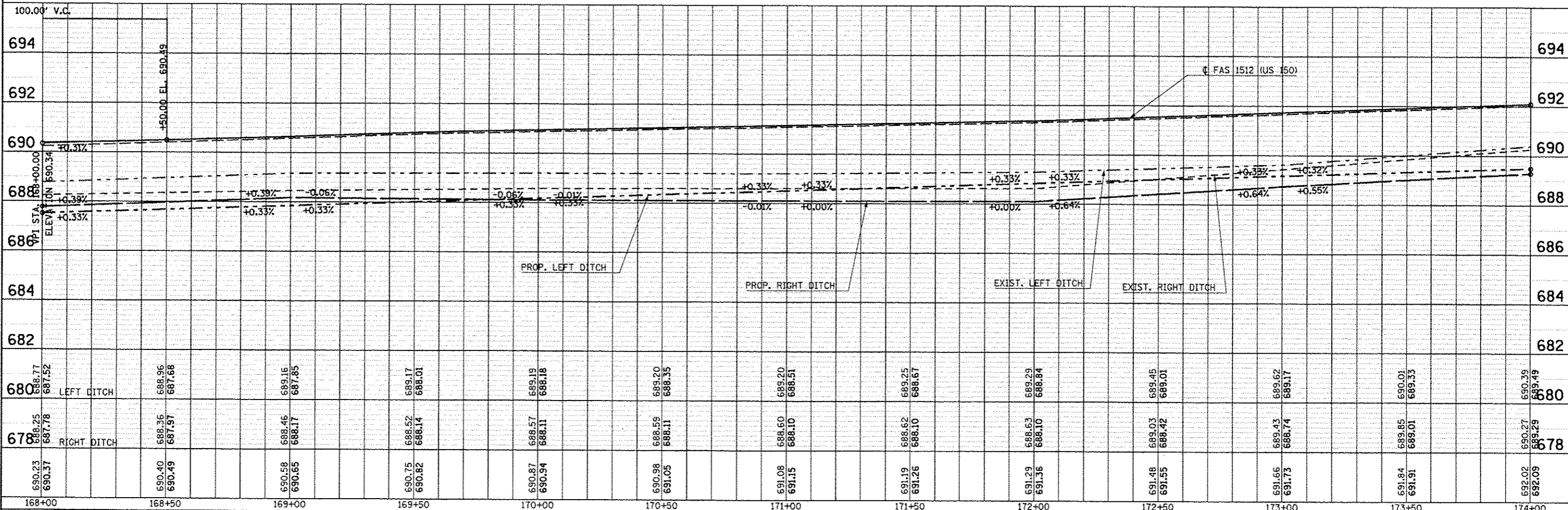

FILE NAME: c:\pwwork\p\d\st\c\c\lock\j\d\28316\057	USER NAME: c\c\lock\j	DESIGNED: JMS	REVISIONS:	STATE OF ILLINOIS DEPARTMENT OF TRANSPORTATION	US 150 MAINLINE PLAN AND PROFILE SHEET	F.A.U. RTE.	SECTION	COUNTY	TOTAL SHEETS	SHEET NO.
DRAWN: JMS	CHECKED:	REVISIONS:	• (2X,3RS-3 & 2RS-4			Champaign	551	94		
PLOT SCALE: 48.0000' / in.	DATE: 081610	REVISIONS:	• F.A.U. 7152 & F.A.S. 1512							
PLOT DATE: 10/16/2013			CONTRACT NO. 70663							

SCALE: 1" = 20' SHEET NO. 13 OF 54 SHEETS STA. 168+00.00 TO STA. 174+00.00

ILLINOIS FED. AID PROJECT