

SEC. 7, T. 19 N, R. 10 E.

28-22-07-476-013  
ORDAL, JOHN

SEC. 8, T. 19 N, R. 10 E.

28-22-08-300-012  
KOCH, DAVID A.  
KOCH, REBECCA S.  
5730012

SEE TR 1900 E PLAN & PROFILES

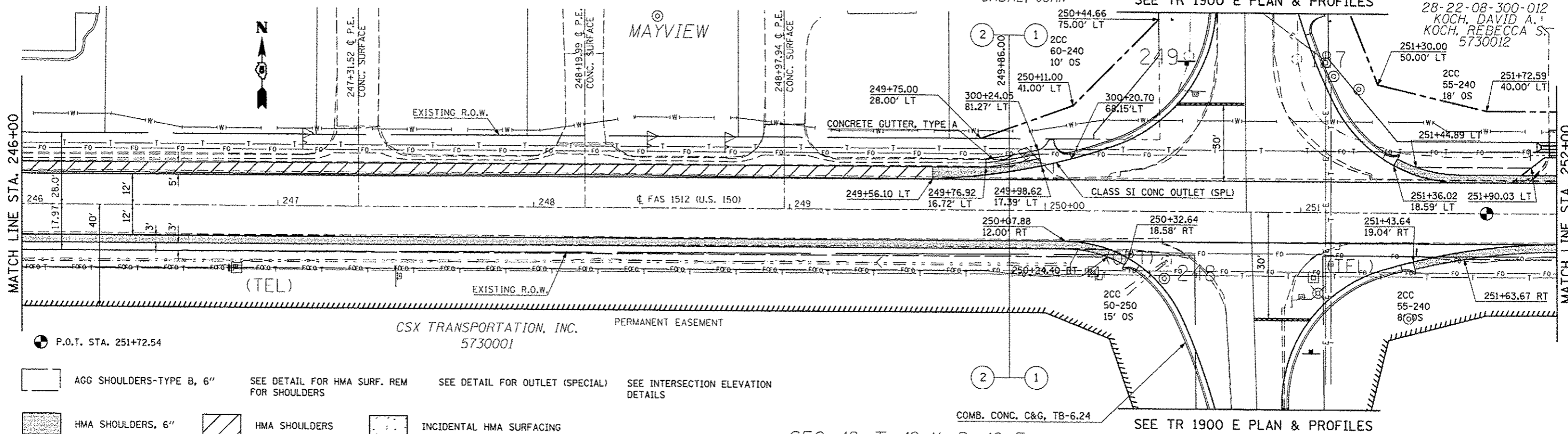

DATE	BT
PROJECT NO.	
DATE	
BY	
CHECKED	
DATE	
BY	
CHECKED	
DATE	
BY	
CHECKED	
DATE	

DATE	BT
PROJECT NO.	
DATE	
BY	
CHECKED	
DATE	
BY	
CHECKED	
DATE	
BY	
CHECKED	
DATE	

SEC. 18, T. 19 N, R. 10 E.

SEC. 17, T. 19 N, R. 10 E.

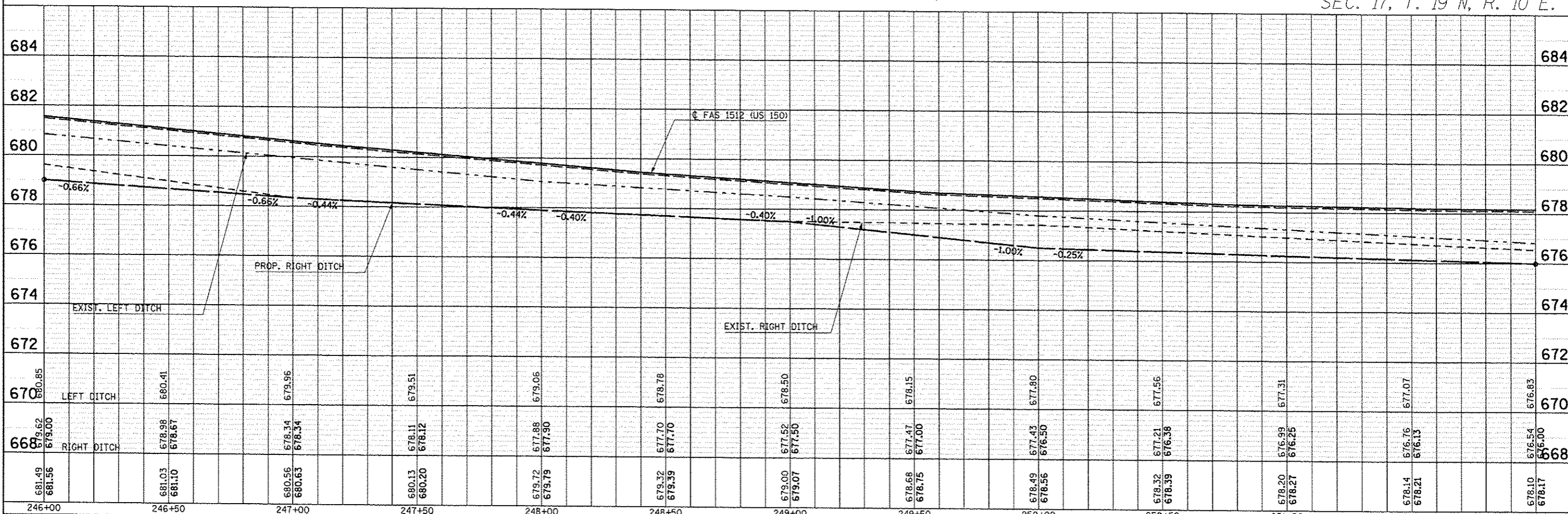

FILE NAME	USER NAME	DESIGNED	REVISIONS	<p align="center"><b>STATE OF ILLINOIS</b> <b>DEPARTMENT OF TRANSPORTATION</b></p> <p align="center"><b>US 150 MAINLINE</b> <b>PLAN AND PROFILE SHEET</b></p> <p>SCALE: 1" = 20'    SHEET NO. 26 OF 54 SHEETS    STA. 246+00000 TO STA. 252+00.00</p>	F.A.U. RTE.	SECTION	COUNTY	TOTAL SHEETS	SHEET NO.
C:\pwork\pwork\clearlock\j\2012\315\0579663-sht-planprf.dgn	clearlock_jd	JMS	-		12X, 3/RS-3 & 2RS-4	Champaign	551	107	
PLOT SCALE: 1/8" = 1'		JMS	-		F.A.U. 7152 & F.A.S. 1512			CONTRACT NO. 70663	
PLOT DATE: 10/16/2013		JMS	-		ILLINOIS FED. AID PROJECT				