

SEC. 9, T. 19 N, R. 10 E.

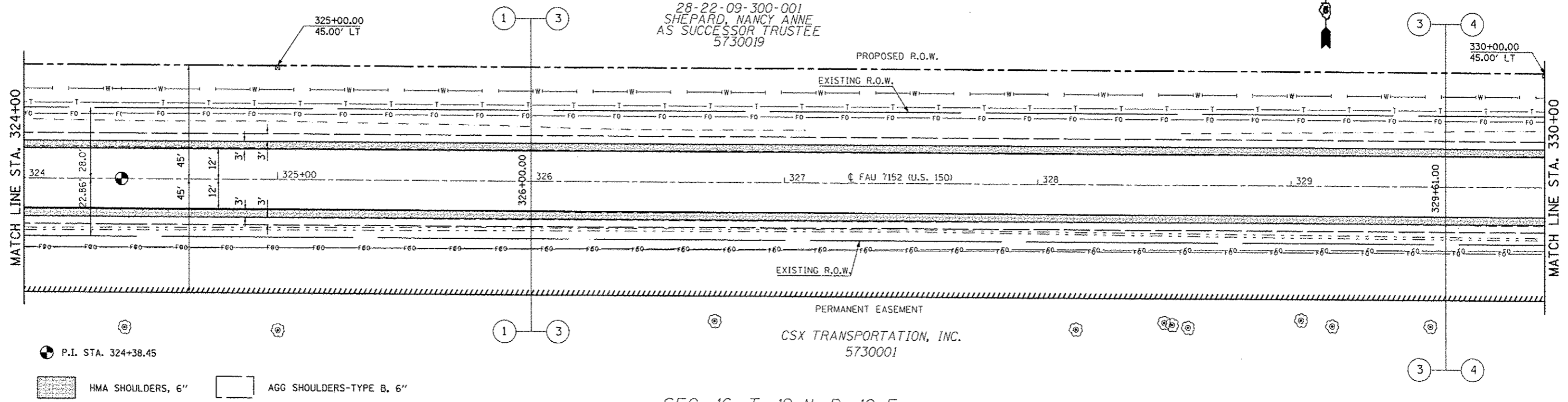

28-22-09-300-001
SHEPARD, NANCY ANNE
AS SUCCESSOR TRUSTEE
5730019



P.I. STA. 324+38.45

HMA SHOULDERS, 6" AGG SHOULDERS-TYPE B, 6"

SEC. 16, T. 19 N, R. 10 E.

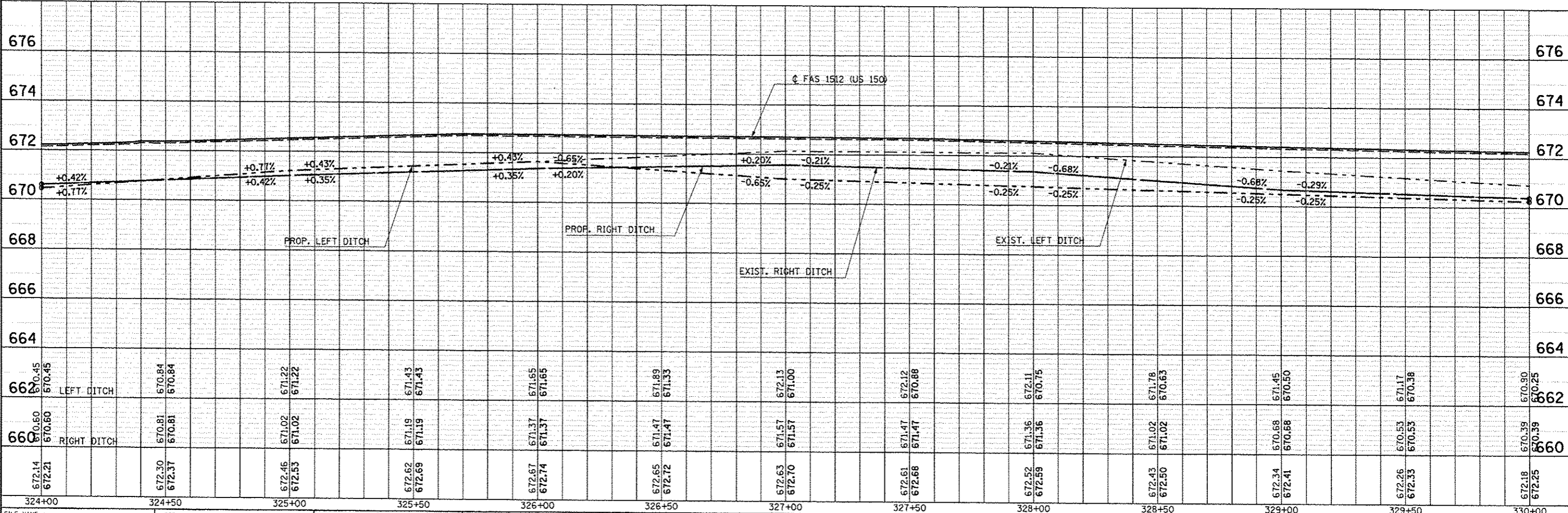

FILE NAME =	USER NAME = coorlockjd	DESIGNED JMS	REVISED -
or\p\work\p\d\dot\coorlockjd\08120316\0577	663-shr.plnprf.dgn	DRAWN JMS	REVISED -
	PLOT SCALE = 48.0000' / in.	CHECKED -	REVISED -
	PLOT DATE = 10/18/2013	DATE 081610	REVISED -

STATE OF ILLINOIS
DEPARTMENT OF TRANSPORTATION

US 150 MAINLINE
PLAN AND PROFILE SHEET
SCALE: 1" = 20'
SHEET NO. 39 OF 54 SHEETS
STA. 324+00.00 TO STA. 330+00.00

F.A.U. RTE.	SECTION	COUNTY	TOTAL SHEETS	SHEET NO.
F.A.U. 7152 & F.A.S. 1512	(2X,3)RS-3 & 2RS-4	Champaign	551	120
ILLINOIS FED. AID PROJECT			CONTRACT NO. 70663	

PLAN	DATE
NO.	
NO.	
NO.	
NO.	

PROFILE	DATE
NO.	
NO.	
NO.	
NO.	