

SEC. 7, T. 19 N, R. 10 E.

MAYVIEW

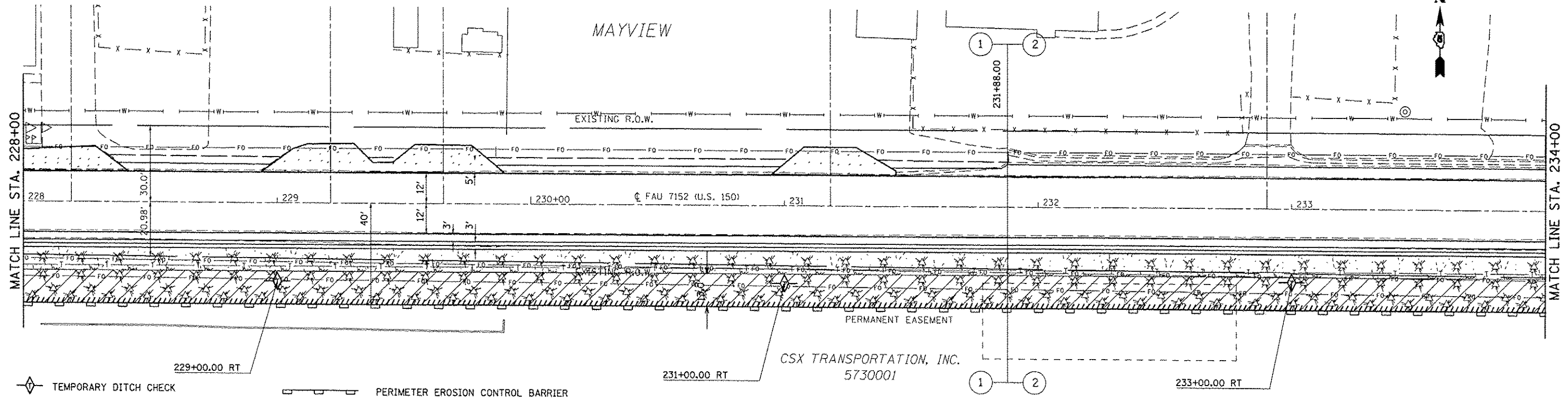

SEEDING, CLASS 2 SEEDING, CLASS 7 MULCH METHOD 2 SEEDING, CLASS 4 & 5A

SEC. 18, T. 19 N, R. 10 E.

SEC. 7, T. 19 N, R. 10 E.

DISH

MAYVIEW

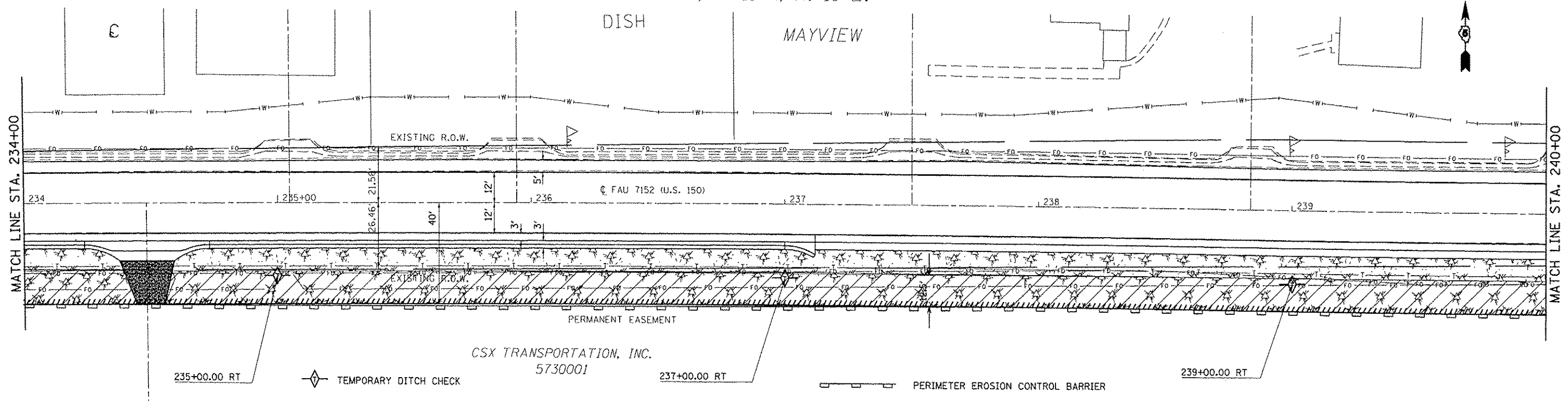

SEEDING, CLASS 2 SEEDING, CLASS 7 MULCH METHOD 2 SEEDING, CLASS 4 & 5A

SEC. 18, T. 19 N, R. 10 E.

FILE NAME =	USER NAME = coo-lockjd	DESIGNED -	REVISED -	STATE OF ILLINOIS DEPARTMENT OF TRANSPORTATION	EROSION CONTROL DETAILS US 150 MAINLINE	F.A.U. RTE.	SECTION	COUNTY	TOTAL SHEETS	SHEET NO.
ca:\p\work\pda\coo-lockjd\0124316\0278663-sht-erosioncontrol.dgn		DRAWN -	REVISED -			• (2X,3RS-3 & 2RS-4	Champaign	551	155	
PLOT SCALE = 48,0000' / in.		CHECKED -	REVISED -			• F.A.U. 7152 & F.A.S. 1512			CONTRACT NO. 70663	
PLOT DATE = 10/18/2013		DATE -	REVISED -				ILLINOIS FED. AID PROJECT			
					SCALE: 1:20	SHEET NO. 12 OF 23 SHEETS	STA. 228+00.00 TO STA. 240+00.00			