

28-22-08-300-012
 KOCH, DAVID A.
 KOCH, REBECCA S.
 5730012

SEC. 8, T. 19 N, R. 10 E.

28-22-08-300-011
 GROGAN, KERMIT W.
 GROGAN, DELORES A.
 5730013

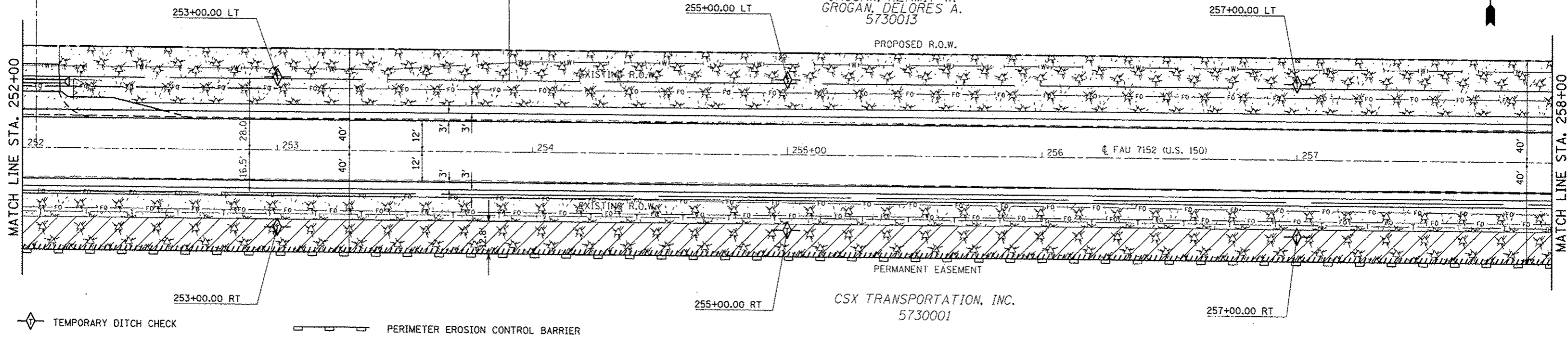

- SEEDING, CLASS 2
- SEEDING, CLASS 7
- MULCH METHOD 2
- SEEDING, CLASS 4 & 5A

SEC. 17, T. 19 N, R. 10 E.

SEC. 8, T. 19 N, R. 10 E.

28-22-08-300-011
 GROGAN, KERMIT W.
 GROGAN, DELORES A.
 5730013

28-22-08-376-002
 WOLFE, WALTER F.
 WOLFE, JANET L.
 5730014

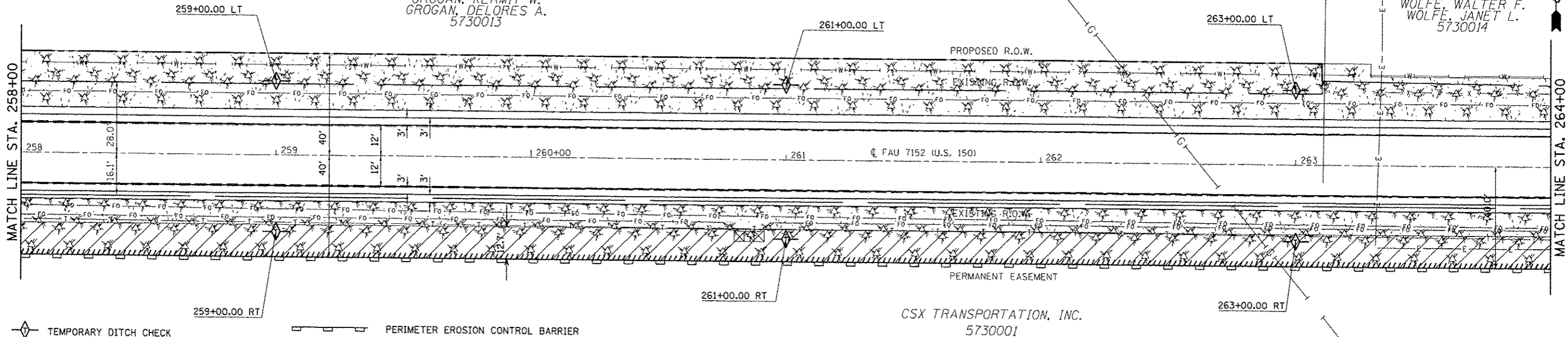

- SEEDING, CLASS 2
- SEEDING, CLASS 7
- MULCH METHOD 2
- SEEDING, CLASS 4 & 5A

SEC. 17, T. 19 N, R. 10 E.

FILE NAME :	USER NAME : ceerlockjd	DESIGNED -	REVISED -	STATE OF ILLINOIS DEPARTMENT OF TRANSPORTATION	EROSION CONTROL DETAILS US 150 MAINLINE	F.A.U. RTE.	SECTION	COUNTY	TOTAL SHEETS	SHEET NO.
\\pwork\pwork\ceerlockjd\2128316\0	28663-sht-erosioncontrol.dgn.dgn	DRAWN -	REVISED -			•	(2X,3)RS-3 & 2RS-4	Champaign	551	157
	PLOT SCALE = 48,0000 / in.	CHECKED -	REVISED -			•	F.A.U. 7152 & F.A.S. 1512			CONTRACT NO. 70663
	PLOT DATE = 10/18/2013	DATE -	REVISED -			ILLINOIS FED. AID PROJECT				
					SCALE: 1:20	SHEET NO. 14 OF 23 SHEETS		STA. 252+00.00 TO STA. 264+00.00		