

28-22-08-376-002  
WOLFE, WALTER F.  
WOLFE, JANET L.  
5730014

SEC. 8, T. 19 N, R. 10 E.

28-22-08-376-001  
WOLFE, WALTER F.  
WOLFE, JANET L.

28-22-08-300-08  
LUEBCHOW, KEVIN H.  
LUEBCHOW, PAIGE L.  
5730015

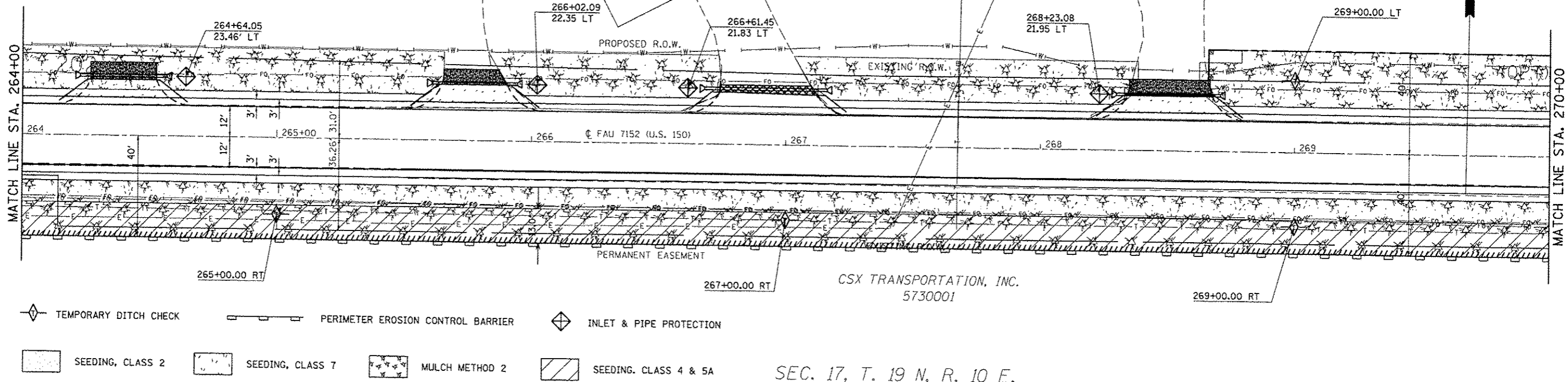

SEC. 17, T. 19 N, R. 10 E.

SEC. 8, T. 19 N, R. 10 E.

28-22-08-300-013  
BUSBOOM, DALE H.  
BUSBOOM, LORETTA J.  
AS TRUSTEE  
5730016

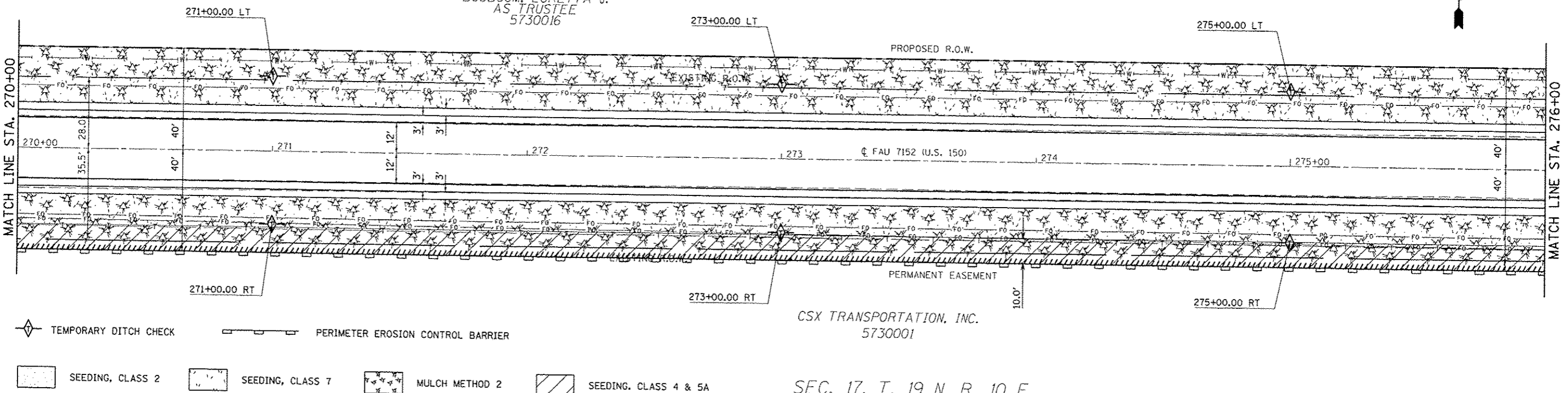

SEC. 17, T. 19 N, R. 10 E.

FILE NAME : c:\p\work\p1\dot\cear\lock\j\d120316\05	USER NAME : cear\lock_jd	DESIGNED -	REVISED -	<b>STATE OF ILLINOIS DEPARTMENT OF TRANSPORTATION</b>	<b>EROSION CONTROL DETAILS US 150 MAINLINE</b>			F.A.U. RTE.	SECTION	COUNTY	TOTAL SHEETS	SHEET NO.
	08663-shr-erosioncontrol.dgn	DRAWN -	REVISED -		SCALE: 1:20	SHEET NO. 15 OF 23 SHEETS	STA. 264+00.00 TO STA. 276+00.00	12X,3RS-3 & 2RS-4	Champaign	551	158	
	PLOT SCALE = 48,0000' / in.	CHECKED -	REVISED -					F.A.U. 7152 & F.A.S. 1512				CONTRACT NO. 70663
	PLOT DATE = 10/19/2013	DATE -	REVISED -					ILLINOIS FED. AID PROJECT				