

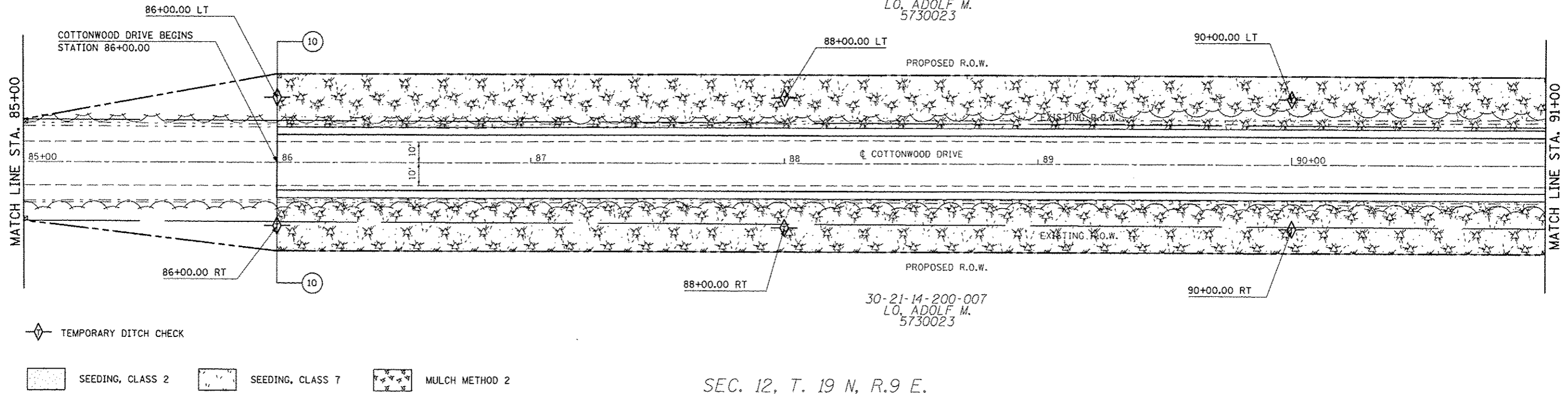

SEC. 14, T. 19 N, R. 9 E.

30-21-14-200-004
LO. ADOLF M.
5730023



SEC. 12, T. 19 N, R. 9 E.

SEC. 14, T. 19 N, R. 9 E.

30-21-14-200-004
LO. ADOLF M.
5730023

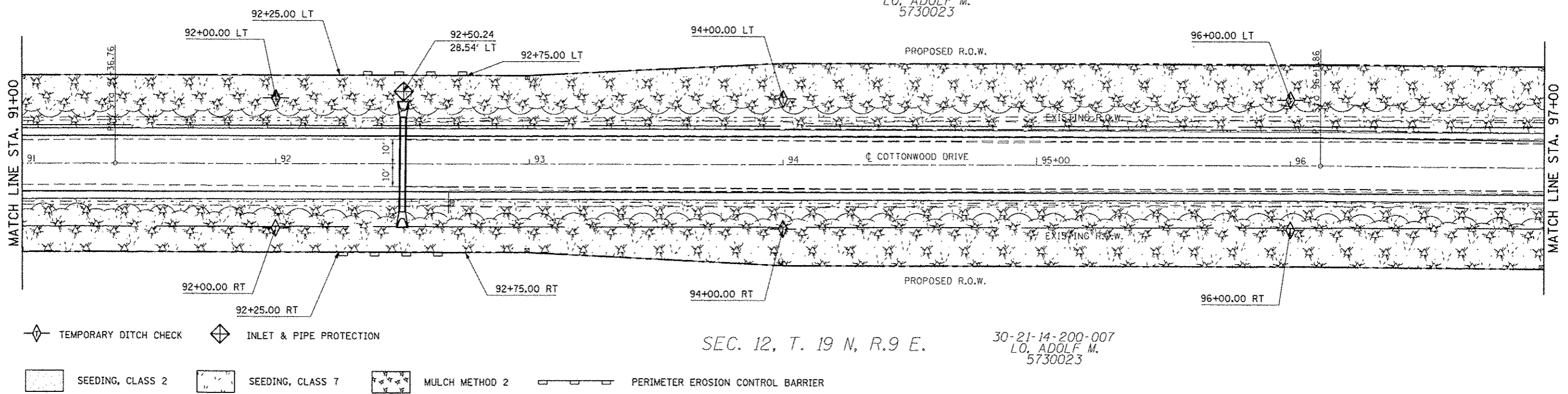

SEC. 12, T. 19 N, R. 9 E.

30-21-14-200-007
LO. ADOLF M.
5730023

FILE NAME	USER NAME	DESIGNED	REVISED	STATE OF ILLINOIS DEPARTMENT OF TRANSPORTATION	EROSION CONTROL DETAILS COTTONWOOD DRIVE		F.A.U. RTE.	SECTION	COUNTY	TOTAL SHEETS	SHEET NO.	
		DRAWN	REVISED		SCALE: 1:20	SHEET NO. 1 OF 2 SHEETS	STA. 85+00.00 TO STA. 97+00.00	12X, 3RS-3 & 2RS-4	Champaign	551	167	
		CHECKED	REVISED					F.A.U. 7152 & F.A.S. 1512				CONTRACT NO. 70663
		DATE	REVISED					ILLINOIS FED. AID PROJECT				