

THE LOCATION OF THE UTILITIES SHOWN ARE DETERMINED FROM THE BEST AVAILABLE DATA. THEY ARE FOR INFORMATIONAL PURPOSES ONLY AND ARE NOT INTENDED TO PURPORT THE ACTUAL LOCATIONS OF SUCH UTILITIES. THE CONTRACTOR SHALL VERIFY THE LOCATIONS OF THE UTILITIES IN THE FIELD AT THE TIME OF CONSTRUCTION. THE CONTRACTOR SHALL BE RESPONSIBLE FOR PROTECTING ALL UTILITIES AND SHALL BE LIABLE FOR ANY DAMAGES TO THEM RESULTING FROM HIS OPERATIONS.

NEW WATERMAIN SHALL BE 12-INCH D.I.P.  
TYTON JOINT, PRESSURE CLASS 350  
WITH 8 MIL POLYETHYLENE PIPE WRAP

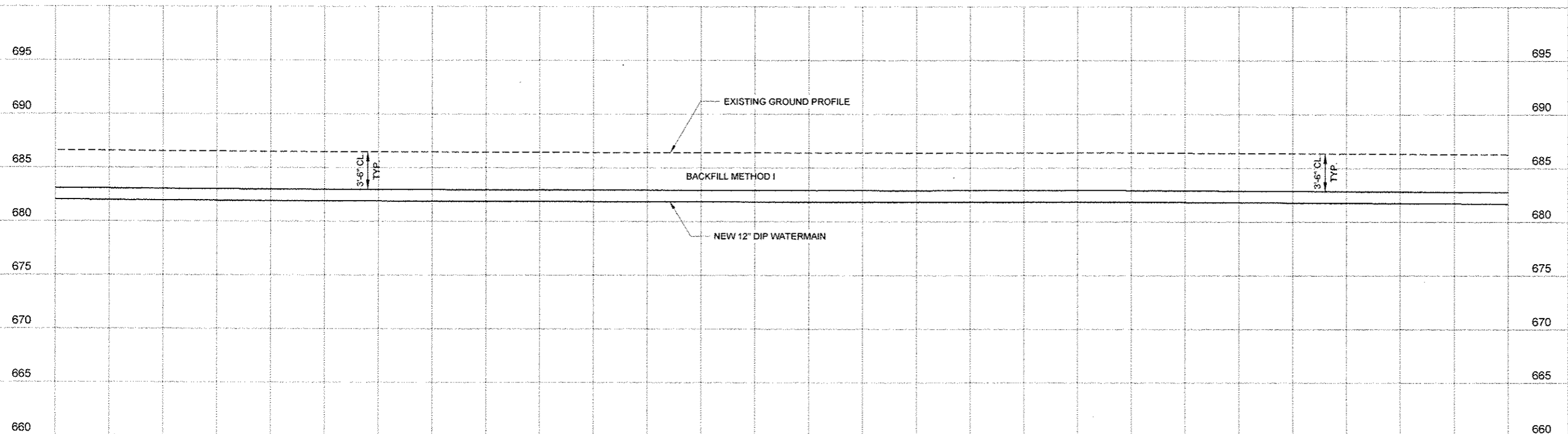
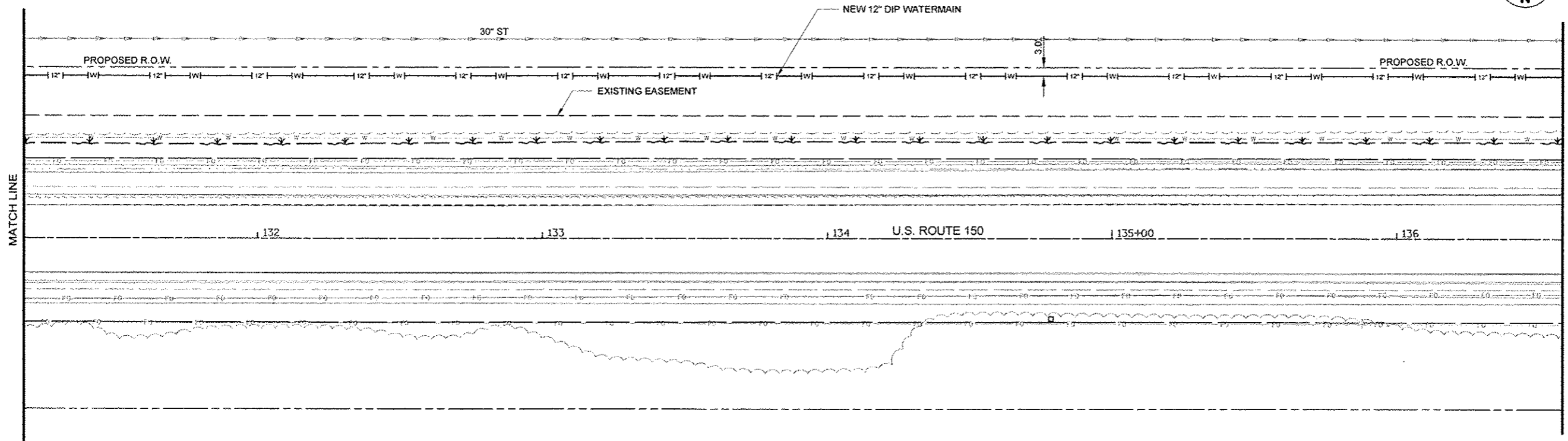

42" MINIMUM COVER TO 48" MAXIMUM COVER FOR WATERMAIN INSTALLATION UNLESS NOTED ON DRAWINGS OR APPROVED BY ILLINOIS AMERICAN WATER.

CUSTOMER NOTIFICATION OF SERVICE INTERRUPTION, IF NECESSARY, WILL BE THE RESPONSIBILITY OF ILLINOIS-AMERICAN. CONTRACTOR SHALL ADHERE TO THE SUBMITTED CONSTRUCTION SCHEDULE OR NOTIFY ILLINOIS-AMERICAN OF ANY DELAYS ONE WEEK PRIOR TO SCHEDULED WORK.

TRAFFIC CONTROL SHALL BE IN ACCORDANCE WITH IDOT STD 701101 UNLESS NOTED OTHERWISE.

WATERMAIN BACKFILL, FINAL GRADING, TOPSOIL STORAGE AND REPLACEMENT, SEEDING AND MULCHING SHALL BE AS REQUIRED IN THE STANDARD SPECIFICATIONS FOR WATER AND SEWER MAIN CONSTRUCTION IN ILLINOIS.

**Foth**  
Foth Infrastructure & Environment, LLC  
1610 Broadmoor Drive  
Champaign, IL 61821  
Phone: 217-352-4189 Fax: 217-352-0085  
Illinois Professional Design Firm No. 184-094913

REUSE OF DOCUMENTS  
THIS DOCUMENT HAS BEEN DEVELOPED FOR A SPECIFIC APPLICATION AND NOT FOR GENERAL USE. IT IS NOT TO BE REPRODUCED OR TRANSMITTED IN ANY FORM OR BY ANY MEANS, ELECTRONIC OR MECHANICAL, WITHOUT THE WRITTEN APPROVAL OF FOTH INFRASTRUCTURE AND ENVIRONMENT, LLC. THE USER SHALL BE RESPONSIBLE FOR THE UNAUTHORIZED USE.

**ROUTE 150 WATERMAIN RELOCATION  
BETWEEN URBANA AND ST. JOSEPH  
ILLINOIS AMERICAN WATER COMPANY  
IDOT CONTRACT NO. 70863**

CHAMPAIGN COUNTY  
URBANA, ILLINOIS

REVISIONS		RECORD DRAWING OF COMPLETED CONSTRUCTION BY	
NO.	DATE	DESCRIPTION	DATE

RECORD DRAWINGS OF COMPLETED CONSTRUCTION CONFORMING TO CONTRACTOR AND/OR OWNERS RECORDS BY DATE

Date of Preparation: July 17, 2013

	BY	DATE
SURVEYED	POTH	07-13-2013
DRAWN	WKH	07-17-2013
DESIGNED	MAJ	07-17-2013
CHECKED	MAJ	07-17-2013

SHEET NAME  
STA. 131+20 TO  
STA. 136+60

