

**STATE OF ILLINOIS**  
**DEPARTMENT OF TRANSPORTATION**  
**DIVISION OF HIGHWAYS**  
**RIGHT OF WAY PLANS**  
**FOR PROPOSED**  
**FEDERAL AID HIGHWAY**

FAU 7152 & FAS 1512 (US 150)  
 SECTION (2X,3)RS-3 & 2RS-4  
 JOB R-95-073-10  
 CHAMPAIGN COUNTY

ROUTE	SECTION	COUNTY	TOTAL SHEETS	SHEET NO.
FAU 7152 & FAS 1512 (US 150)	(2X,3)RS-3 & 2RS-4	CHAMPAIGN	10	1
F.H.W.A. REG.	ILLINOIS	PROJECT		

CONTRACT NO. 70663

REGION 3 / DISTRICT 5

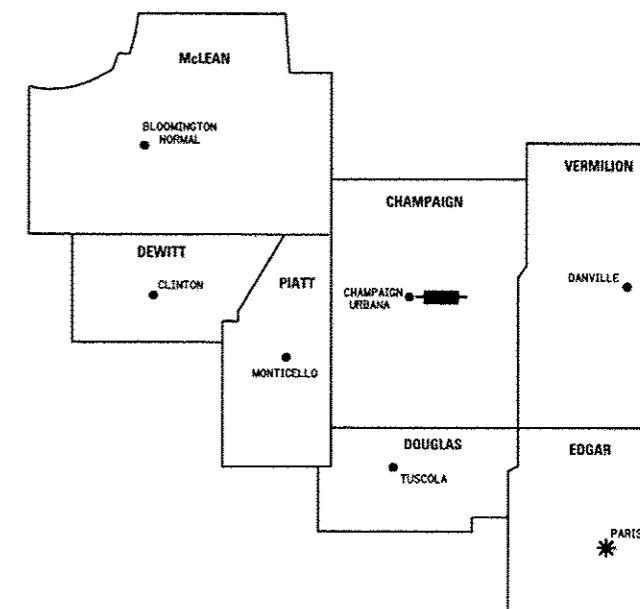

\* DISTRICT HEADQUARTERS  
 — PROJECT LOCATION

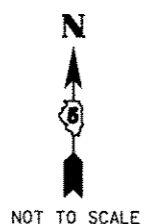

NOT TO SCALE

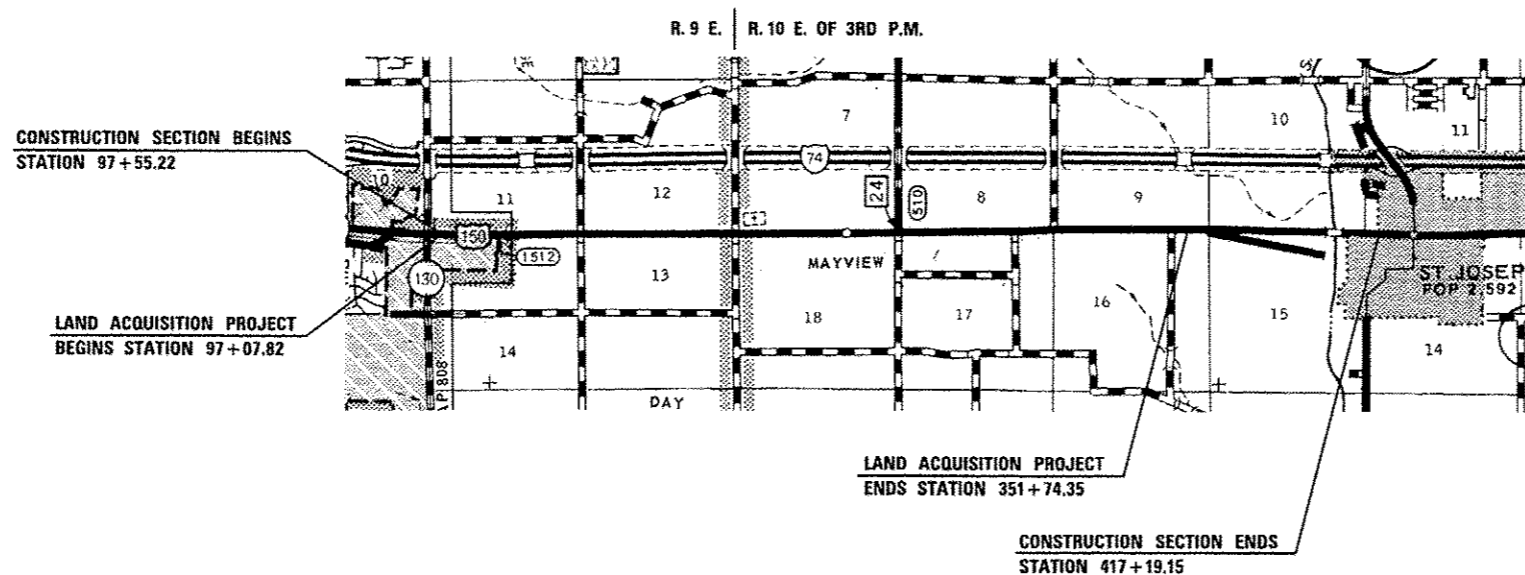

THIS IS TO CERTIFY THAT THIS IS A TRUE AND CORRECT SET OF RIGHT OF WAY PLANS MADE UNDER MY DIRECTION FOR THE DIVISION OF HIGHWAYS, STATE OF ILLINOIS.

ILLINOIS PROFESSIONAL LAND SURVEYOR NO. 3135 DATE LICENSE EXPIRES 11/30/12

LENGTH OF LAND ACQUISITION PROJECT = 25467 LIN. FT. = 4.823 MILE

**STATE OF ILLINOIS**  
**DEPARTMENT OF TRANSPORTATION**  
**DIVISION OF HIGHWAYS**

SUBMITTED \_\_\_\_\_ 20\_\_

JOSEPH E. CROWE, P.E.  
 DEPUTY DIRECTOR OF HIGHWAYS  
 REGION 3 ENGINEER

EXAMINED \_\_\_\_\_ 20\_\_

DISTRICT CHIEF OF PLATS & PLANS

PASSED \_\_\_\_\_ 20\_\_

DISTRICT LAND ACQUISITION ENGINEER