

ROUTE	SECTION	COUNTY	TOTAL SHEETS	SHEET NO.
FAI 55	84-2-1K	SANGAMON	171	69

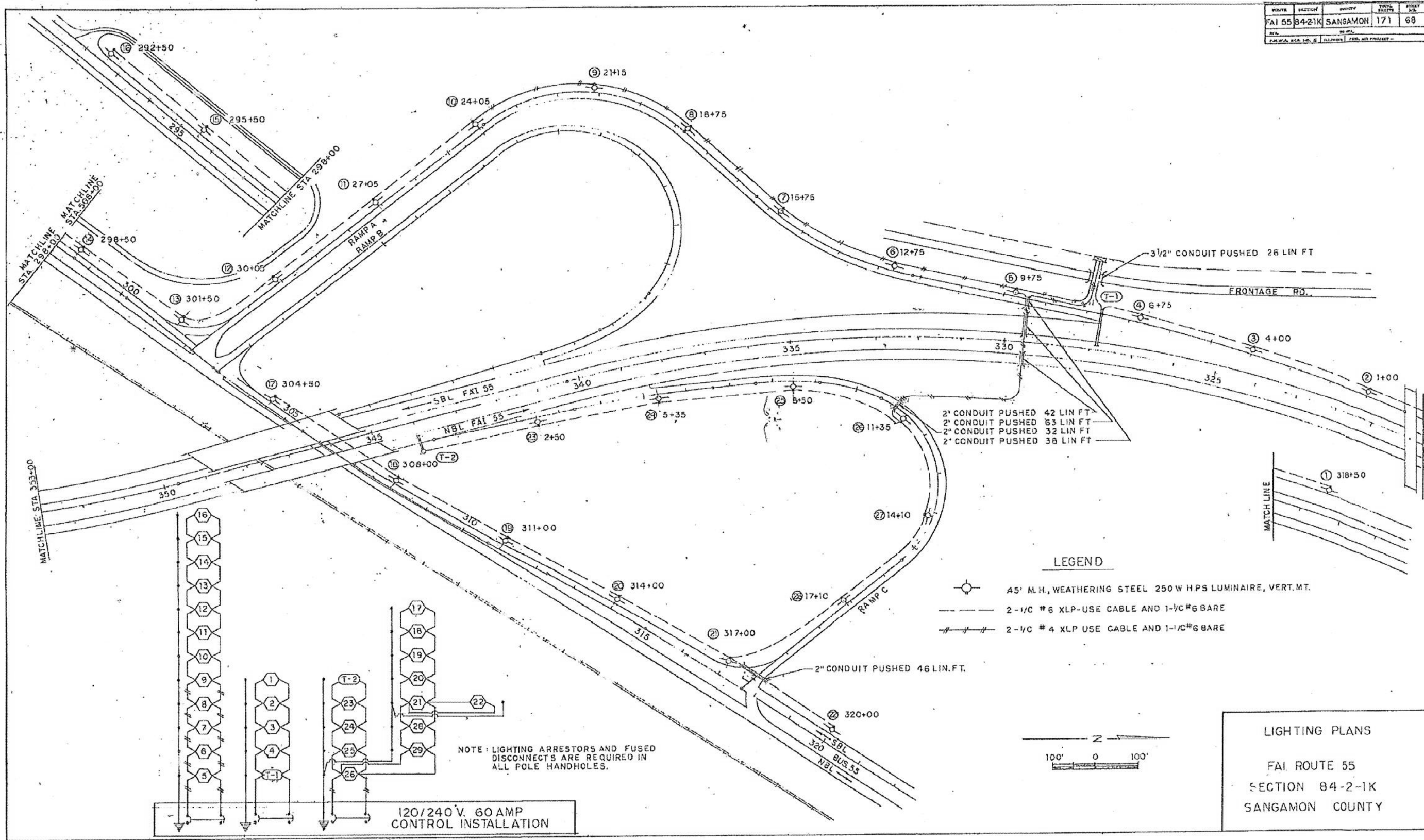

LEGEND

- 45' M.H., WEATHERING STEEL 250 W HPS LUMINAIRE, VERT. MT.
- 2 - 1/2" # 6 XLP-USE CABLE AND 1-1/2" # 6 BARE
- 2 - 1/2" # 4 XLP USE CABLE AND 1-1/2" # 6 BARE



LIGHTING PLANS
 FAI ROUTE 55
 SECTION 84-2-1K
 SANGAMON COUNTY

NOTE: LIGHTING ARRESTORS AND FUSED DISCONNECTS ARE REQUIRED IN ALL POLE HANDHOLES.

120/240 V. 60 AMP
 CONTROL INSTALLATION

FOR INFORMATION ONLY

FILE NAME =	USER NAME = sparksgw	DESIGNED -	REVISED -	STATE OF ILLINOIS DEPARTMENT OF TRANSPORTATION	LIGHTING PLAN INFORMATION SHEET				F.A.P. RTE.	SECTION	COUNTY	TOTAL SHEETS	SHEET NO.
et:\pw\work\p\dot\sparksgw\10306018\0672\F50-Sht-Lgt-Pln.dgn		DRAWN -	REVISED -		666	(26)RS,I	SANGAMON	116	56				
Default	PLOT SCALE = 40.0000' / in.	CHECKED -	REVISED -		SCALE: SHEET OF SHEETS STA. TO STA.				CONTRACT NO. 72F50				
	PLOT DATE = Dec-06-2013 09:54:38AM	DATE -	REVISED -		ILLINOIS FED. AID PROJECT								