

STATE OF ILLINOIS  
DEPARTMENT OF TRANSPORTATION

F.A.P. RTE.	SECTION	COUNTY	TOTAL SHEETS	SHEET NO.
786	SECTION (110, 110X) SFY	LASALLE	6	1
		ILLINOIS	CONTRACT NO. 66F98	

INDEX OF SHEETS

- 1 COVER SHEET
- 2 GENERAL NOTES
- 3 SUMMARY OF QUANTITIES
- 4 TYPICAL SECTIONS
- 5 SCHEDULES
- 6 DETAILS

STANDARDS

- 000001-06 STANDARD SYMBOLS, ABBREVIATIONS AND PATTERNS
- 001006 DECIMAL OF AN INCH AND OF A FOOT
- 406201-01 MAILBOX TURNOUT
- 482001-02 HMA SHOULDER ADJACENT TO FLEXIBLE PAVEMENT
- 482006-03 HMA SHOULDER ADJACENT TO RIGID PAVEMENT
- 642006 SHOULDER RUMBLE STRIPS, 8 INCH
- 701006-05 OFF-ROAD OPERATIONS 2L, 2W, 15' (4.5 m) TO 24" (600 mm) FROM PAVEMENT EDGE
- 701311-03 LANE CLOSURE, 2L, 2W, MOVING OPERATIONS - DAY ONLY
- 701326-04 LANE CLOSURE, 2L, 2W, PAVEMENT WIDENING, FOR SPEEDS ≥ 45 MPH
- 701901-06 TRAFFIC CONTROL DEVICES

PROPOSED  
HIGHWAY PLANS

FAP ROUTE 786 (IL 170)  
SECTION (110, 110X) SFY  
PROJECT ACHSIP-0786(014)  
SHOULDER WIDENING AND RUMBLE STRIPS  
LASALLE COUNTY

C-93-021-17

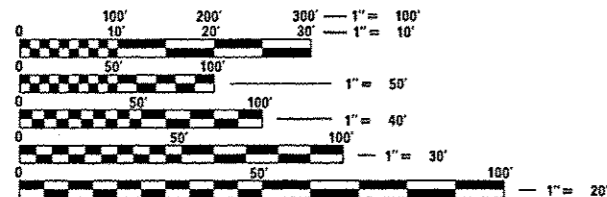
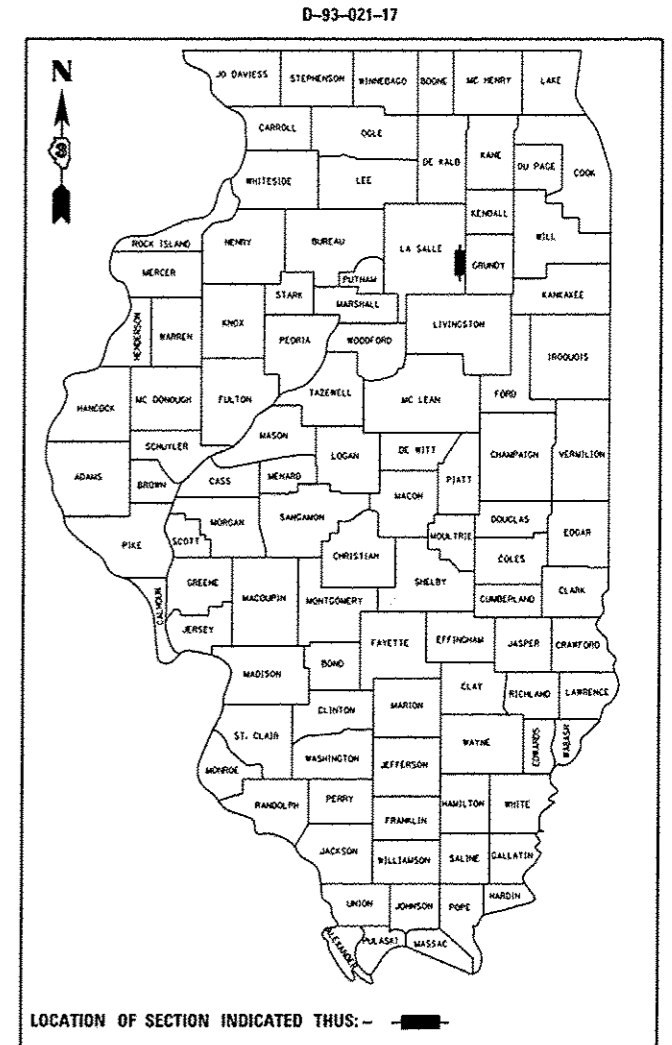

FULL SIZE PLANS HAVE BEEN PREPARED USING STANDARD ENGINEERING SCALES. REDUCED SIZED PLANS WILL NOT CONFORM TO STANDARD SCALES. IN MAKING MEASUREMENTS ON REDUCED PLANS, THE ABOVE SCALES MAY BE USED.

J.U.L.I.E.  
JOINT UTILITY LOCATION INFORMATION FOR EXCAVATION  
1-800-892-0123  
OR 811

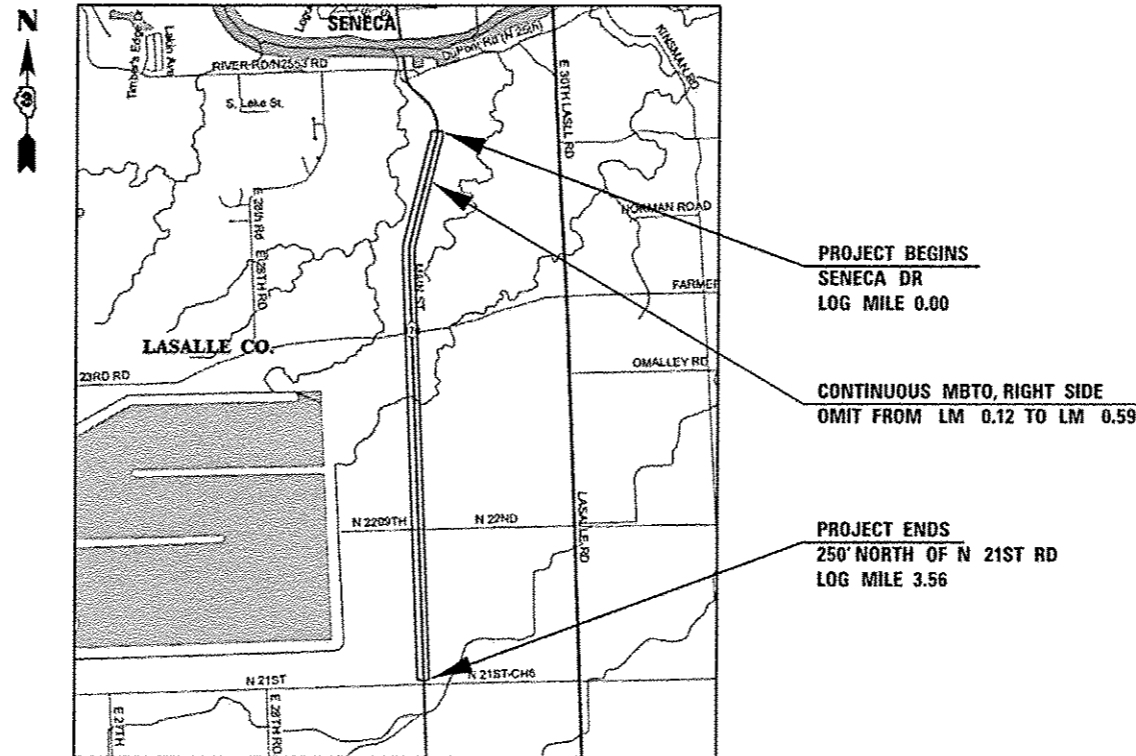

GROSS AND NET LENGTH = 18,797 FT. = 3.56 MILES

PROJECT ENGINEER: JOE KANNEL, P.E.  
UNIT CHIEF: MARC BUDZYNSKI  
DISTRICT 3 NO. (815) 434-6131  
CONTRACT NO. 66F98

RURAL MINOR ARTERIAL  
2015 ADT = 2850  
P.V. = 87.5% S.U. = 4.6% M.U. = 7.9%

STATE OF ILLINOIS  
DEPARTMENT OF TRANSPORTATION

SUBMITTED *December 9, 2016*  
*Kenneth Marchek P.E.*  
REGIONAL ENGINEER

*Jan 27, 2017*  
*Mawm M. Addis P.E.*  
ENGINEER OF DESIGN AND ENVIRONMENT

*Jan 27, 2017*  
*[Signature]*  
DIRECTOR OF PROGRAM DEVELOPMENT

PRINTED BY THE AUTHORITY  
OF THE STATE OF ILLINOIS

GENERAL NOTES

THE THICKNESS OF HMA SHOWN ON THE PLANS IS THE NOMINAL THICKNESS. DEVIATIONS FROM THE NOMINAL THICKNESS WILL BE PERMITTED WHEN SUCH DEVIATIONS OCCUR DUE TO IRREGULARITIES IN THE EXISTING SURFACE OR BASE ON WHICH THE HMA IS PLACED.

THE HMA SURFACE OF ALL MAILBOX TURNOUTS, PRIVATE ENTRANCES, COMMERCIAL ENTRANCES, AND SIDE ROADS SHALL BE MADE NEATLY, IN A WORKMANLIKE MANNER, AND SHALL ACCURATELY CONFORM TO THE SHAPES AND DIMENSIONS SHOWN ON THE PLAN DETAILS. IF REQUIRED BY THE ENGINEER, THE CONTRACTOR SHALL SAW CUT THE HMA SURFACE TO CONFORM TO THE SHAPES AND DIMENSIONS SHOWN ON THE PLAN DETAILS. THIS WORK WILL BE INCLUDED IN THE COST OF THE HMA SURFACE.

THE ENGINEER WILL BE THE SOLE JUDGE CONCERNING CURING TIME FOR THE VARIOUS HMA LIFTS.

FOR STABILIZATION, ALL TYPE III BARRICADES WILL REQUIRE A MINIMUM OF FOUR SAND BAGS PER BARRICADE.

SEEDING WILL NOT BE PERMITTED AT ANY TIME WHEN THE GROUND IS FROZEN, WET, OR IN AN UNTILLABLE CONDITION. LOCATIONS TO BE SEEDED WILL BE DETERMINED BY THE ENGINEER.

ALL EXCAVATED MATERIAL, WHICH INCLUDES DIGGING OR GRADING OF ANY SOIL OR FILL MATERIAL, WITH THE EXCEPTION OF AGGREGATE FILLS, MUST BE INCORPORATED WITHIN THE IDOT RIGHT OF WAY DUE TO ENVIRONMENTAL DOCUMENTATION REQUIREMENTS.

ANY REFERENCE TO A STANDARD IN THESE PLANS SHALL BE INTERPRETED TO MEAN THE EDITION AS INDICATED BY THE SUBNUMBER SHOWN IN THE LIST OF STANDARDS OR THE COPY INCLUDED IN THESE PLANS.

THE FOLLOWING RATES OF APPLICATION HAVE BEEN USED IN CALCULATING PLAN QUANTITIES:

HMA RESURFACING	112	LBS / SQ YD / IN
-----------------	-----	------------------

ALL DAMAGE TO DEPARTMENT OWNED UNDERGROUND FACILITIES, CAUSED BY THE CONTRACTOR SHALL BE REPAIRED TO THE SATISFACTION OF THE DEPARTMENT AT THE CONTRACTOR'S EXPENSE. THIS SHALL INCLUDE ALL TEMPORARY REPAIRS REQUIRED TO KEEP THE FACILITY OPERATIONAL WHILE MATERIAL IS BEING OBTAINED TO MAKE PERMANENT REPAIRS. SPLICING OF ELECTRIC CABLE WILL NOT BE ALLOWED. ELECTRIC CABLE SHALL BE REPLACED FROM POLE TO POLE OR CONTROLLER.

THE CONTRACTOR SHALL CONTACT JULIE AT LEAST 48 HOURS PRIOR TO EXCAVATION TO DETERMINE WHICH UTILITIES ARE IN THE AREA.

LOCATION(S):	ENTIRE PROJECT	ENTIRE PROJECT	ENTIRE PROJECT
MIXTURE USE(S):	SHOULDER BOTTOM LIFT(S)	SHOULDER TOP LIFT (2")	MAILBOX TURNOUTS
BINDER GRADE (PG):	PG 64-22	PG 64-22	PG 64-22
DESIGN AIR VOIDS:	4.0% @ N50	4.0% @ N50	4.0% @ N50
MIXTURE COMPOSITION: (MIXTURE GRADATION)	IL-19.0	IL-9.5 FG	IL-9.5 FG
FRICTION AGGREGATE:	-	MIXTURE C	MIXTURE C
MIXTURE WEIGHT:	112.0 LB/SY/IN	112.0 LB/SY/IN	112.0 LB/SY/IN
QUALITY MANAGEMENT PROGRAM:	QC/OA	QC/OA	QC/OA
SUBLOT SIZE:	N/A	N/A	N/A
DENSITY TEST METHOD:	CORES	% GROWTH CURVE	SATISFACTION OF THE ENGINEER

COMMITMENTS:

STATE OF ILLINOIS  
DEPARTMENT OF TRANSPORTATION  
DISTRICT THREE  
AS BUILT INFORMATION

\_\_\_\_\_  
SUPERVISING CONSTRUCTION FIELD ENGINEER

\_\_\_\_\_  
RESIDENT ENGINEER / TECHNICIAN

START & END DATES  
OF CONSTRUCTION:

INSPECTORS:

STATE OF ILLINOIS  
DEPARTMENT OF TRANSPORTATION  
DISTRICT THREE

PREPARED BY: *Don Benoit*  
DISTRICT STUDIES & PLANS ENGINEER

DATE: December 9, 2016

EXAMINED BY: *Walter J. ...*  
DISTRICT CONSTRUCTION ENGINEER

*Walter J. ...*  
DISTRICT MATERIALS ENGINEER

*Tom ...*  
DISTRICT OPERATIONS ENGINEER

STATE OF ILLINOIS  
DEPARTMENT OF TRANSPORTATION

GENERAL NOTES

FILE NAME *	USER NAME * budzynskim	DESIGNED -	REVISED -	STATE OF ILLINOIS DEPARTMENT OF TRANSPORTATION	SCALE: SHEET OF SHEETS STA. TO STA.	F.A.P. RTE.	SECTION	COUNTY	TOTAL SHEETS	SHEET NO.	
Default	12/9/2016	CHECKED -	REVISED -			786	SECTION (110, 110X) SFY	LASALLE	6	2	
		DATE -	REVISED -			CONTRACT NO. 66F98					
						[ILLINOIS] FED. AID PROJECT					

90% FEDERAL  
10% STATE

CONSTR. CODE

CODE NO.	ITEM	UNIT	TOTAL QUANTITY	ROADWAY	
				0021	RURAL
20200600	EXCAVATING AND GRADING EXISTING SHOULDER	UNIT	352	352	
40600290	BITUMINOUS MATERIALS (TACK COAT)	POUND	6790	6790	
40800050	INCIDENTAL HOT-MIX ASPHALT SURFACING	TON	3.9	3.9	
44000157	HOT-MIX ASPHALT SURFACE REMOVAL, 2"	SQ YD	33.4	33.4	
48203029	HOT-MIX ASPHALT SHOULDERS, 8"	SQ YD	15605	15605	
64200108	SHOULDER RUMBLE STRIPS, 8 INCH	FOOT	32630	32630	
67100100	MOBILIZATION	LSUM	1.0	1.0	
70100500	TRAFFIC CONTROL AND PROTECTION, STANDARD 701326	LSUM	1.0	1.0	
70103815	TRAFFIC CONTROL SURVEILLANCE	CAL DA	5	5	
* 78001110	PAINT PAVEMENT MARKING - LINE 4"	FOOT	70224	70224	
X0800001	SHOULDER REMOVAL (SPECIAL)	SQ YD	15605	15605	
Z0030850	TEMPORARY INFORMATION SIGNING	SQ FT	42	42	

12

\* SPECIALTY ITEM

FILE NAME *	USER NAME * budzynskim	DESIGNED -	REVISED -	<b>STATE OF ILLINOIS DEPARTMENT OF TRANSPORTATION</b>	<b>SUMMARY OF QUANTITIES</b>	F.A.P. RTE.	SECTION	COUNTY	TOTAL SHEETS	SHEET NO.	
pw:\IL084EBID\INTEG\Illinois.gov\PI\DOT\Documents\DOT Offices\District 3\Projects\0364\BID\DATA\GAD\Sheets\0366F98-sht-cover	PLOT SCALE * 100.0000' / 1"	CHECKED -	REVISED -			786	SECTION 110, 110X1 SFY	LASALLE	6	3	
Default	PLOT DATE * 12/9/2016	DATE -	REVISED -			CONTRACT NO. 66F98					
						ILLINOIS FED. AID PROJECT					

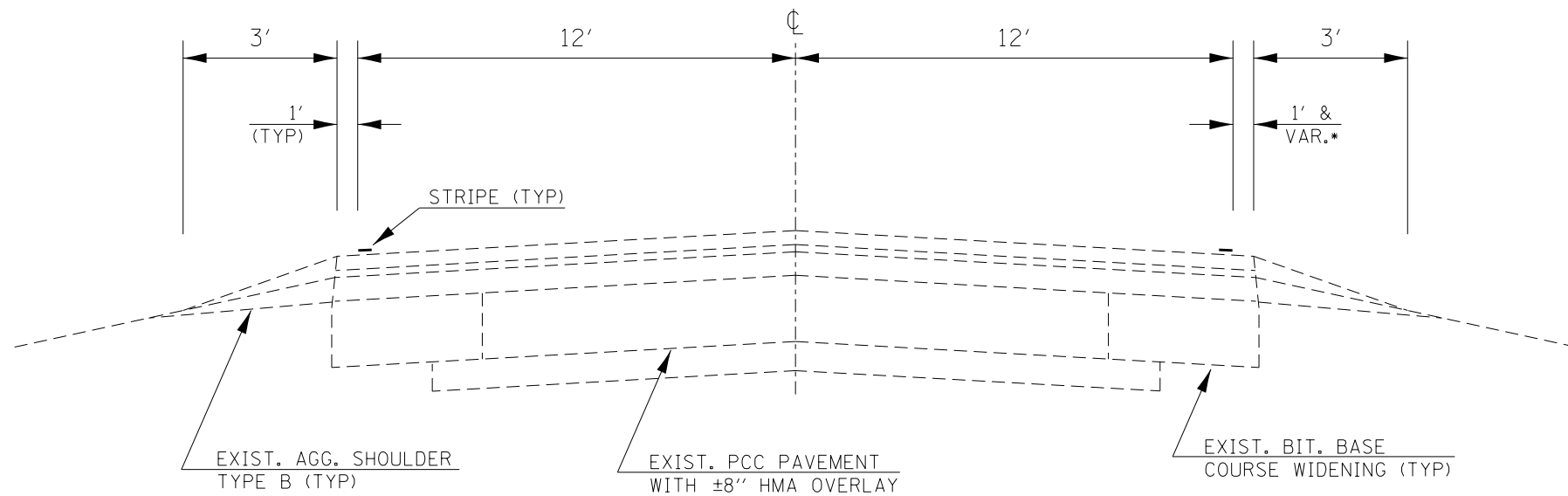

**EXISTING TYPICAL SECTION**

LM 0.00 TO LM 3.56

\*EXISTING 10' WIDE MBTO FROM LM 0.12 TO LM 0.59 RT WILL BE OMITTED

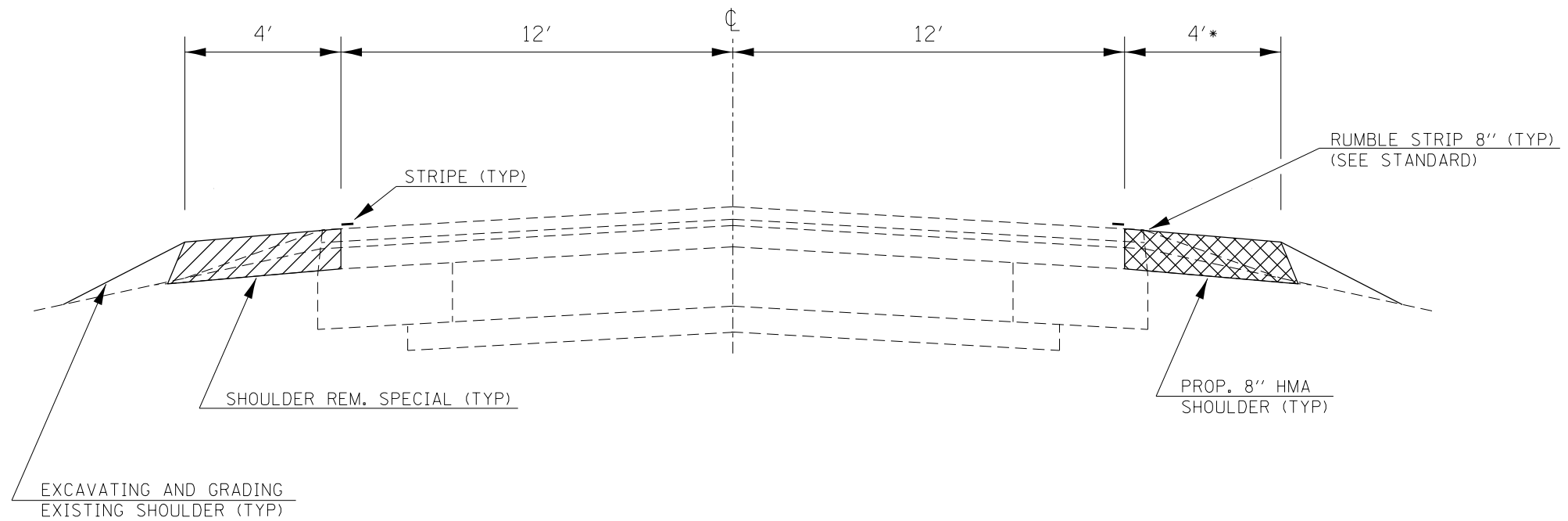

**PROPOSED TYPICAL SECTION**

LM 0.00 TO LM 3.56

\*EXISTING 10' WIDE MBTO FROM LM 0.12 TO LM 0.59 RT WILL BE OMITTED

FILE NAME =	USER NAME = budzynskim	DESIGNED -	REVISED -
p:\11084EBID\INTEG.illinois.gov\PIWIDOT\Documents\DOT Offices\District 3\Projects\0366\DRAWING\DATA\CAD\Sheets\0366F98-shr-cover.dwg		DRAWN -	REVISED -
Default	PLOT SCALE = 100.0000' / 1in.	CHECKED -	REVISED -
	PLOT DATE = 12/9/2016	DATE -	REVISED -

**STATE OF ILLINOIS  
DEPARTMENT OF TRANSPORTATION**

**TYPICAL SECTIONS**

SCALE: SHEET OF SHEETS STA. TO STA.

F.A.P. RTE.	SECTION	COUNTY	TOTAL SHEETS	SHEET NO.
786	SECTION (110, 110X) SFY	LASALLE	6	4
CONTRACT NO. 66F98			ILLINOIS FED. AID PROJECT	

SHOULDER REMOVAL & REPLACEMENT SCHEDULE									
LOCATION			SIDE	LENGTH	SHOULDER REMOVAL (SPECIAL)	HMA SHOULDERS 8"	BIT MTLs (TACK COAT)	SHOULDER RUMBLE STRIPS 8"	*PAINT PVMT MARKING WHITE 4"
L.M.	TO	L.M.	LT / RT	FOOT	SQ YD	SQ YD	POUND	FOOT	FOOT
0.00	TO	0.12	LT & RT	634	563	563	253	1267	2534
0.12	TO	0.59	LT	2482	1103	1103	248	-	4963
0.59	TO	3.56	LT & RT	15682	13939	13939	6273	31363	62726
TOTAL				18797	15605	15605	6774	32630	70224

\*QUANTITY REPRESENTS TWO SEPARATE APPLICATIONS

MAILBOX TURNOUT REMOVAL & REPLACEMENT SCHEDULE					
L.M. / SIDE		AREA	HMA SURF REMOVAL 2"	INCIDENTAL HMA SURF 2"	BIT MTLs (TACK COAT)
		SQ YD	SQ YD	TON	POUND
1.03	RT	18.3	1.8	0.3	1
2.47	RT	45.5	16.9	1.9	8
2.58	RT	35.4	13.0	1.5	6
2.84	RT	14.5	1.7	0.2	1
TOTAL		113.7	33.4	3.9	16

THE FIRST 4 FEET OF THE MBTO ADJACENT TO THE TRAVELED WAY IS PAID AS SHOULDER REMOVAL (SPECIAL) AND HMA SHOULDERS 8"  
THE REMAINING AREA OF THE MBTO IS PAID AS HMA SURFACE REMOVAL 2" AND INCIDENTAL HMA SURFACE 2"

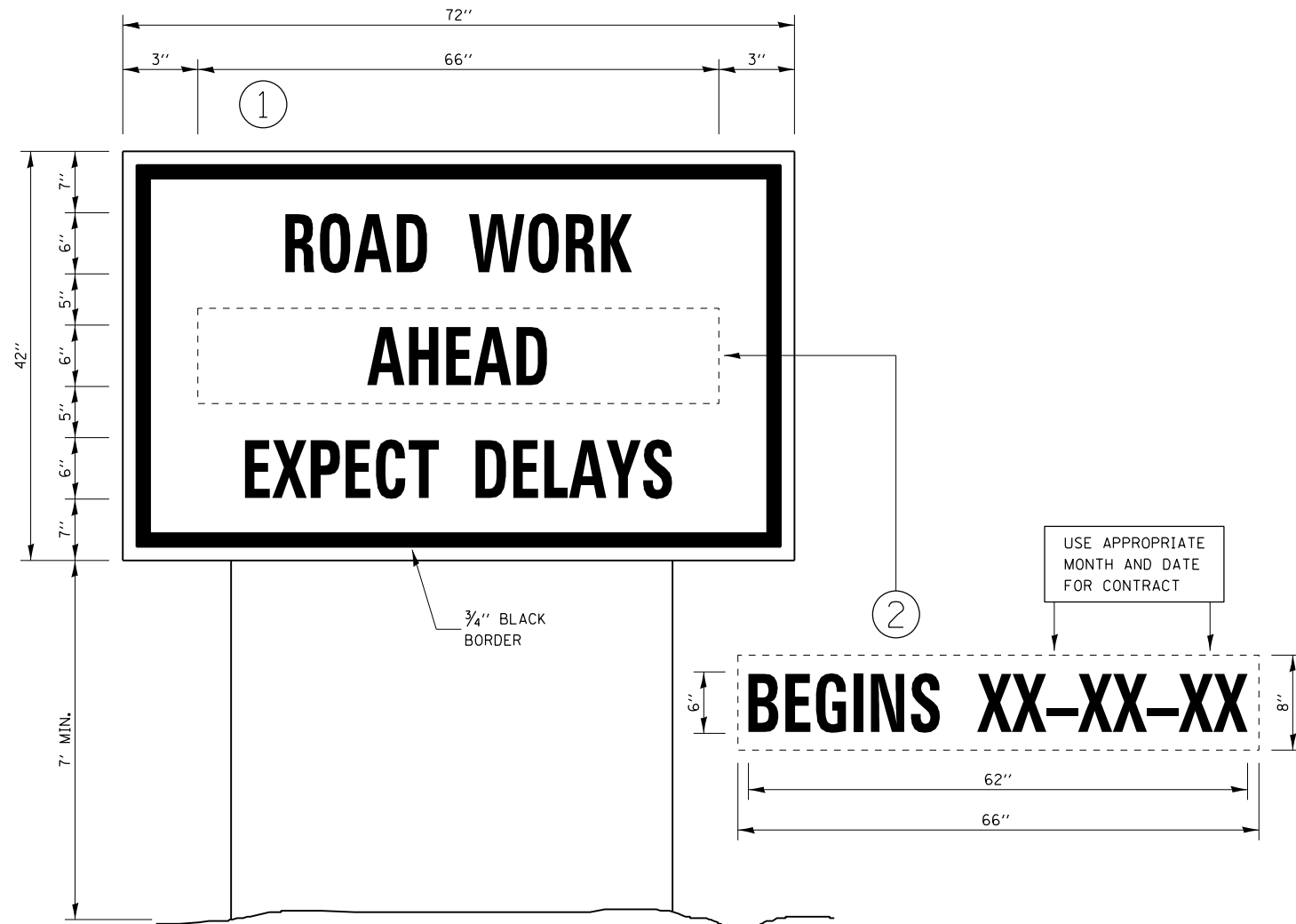

**TEMPORARY INFORMATION SIGNING**

**NOTES:**

1. USE 6" D BLACK LETTERING ON FLOURESENT ORANGE BACKGROUND.
2. ERECT SIGNS AT LOCATIONS IN ADVANCE OF THE "ROAD CONSTRUCTION AHEAD" SIGNS AS DIRECTED BY THE ENGINEER.
3. ERECT SIGN ① WITH INSTALLED PANEL ② A MINIMUM OF ONE WEEK PRIOR TO THE START OF THE LANE CLOSURE.
4. REMOVE PANEL ② ON THAT DATE.
5. SEE SPECIAL PROVISION "TEMPORARY INFORMATION SIGNING" FOR ADDITIONAL INFORMATION.
6. WILL BE PAID FOR PER SQ FT AS "TEMPORARY INFORMATION SIGNING". EACH SIGN = 21 SQ FT AND THE DATE PANEL ② WILL NOT BE MEASURED SEPARATELY FOR PAYMENT.

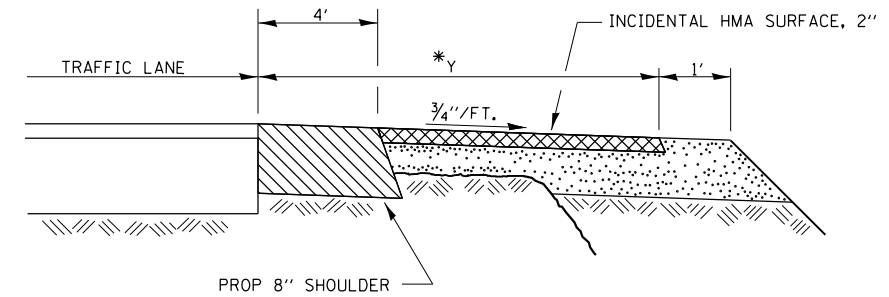
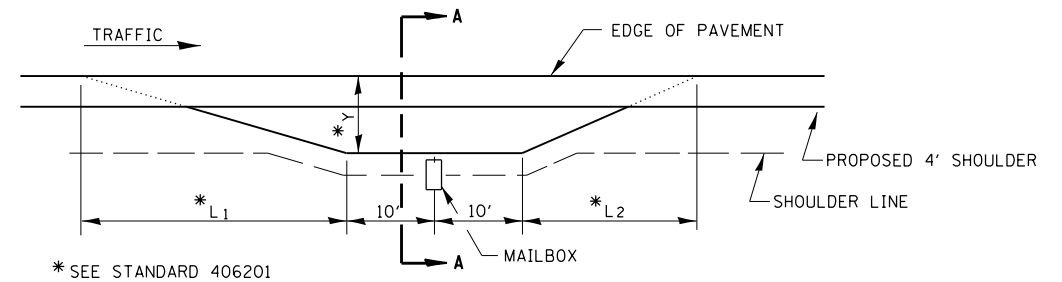

**SECTION A-A**

**RURAL MAILBOX TURNOUT DETAILS (NTS)**

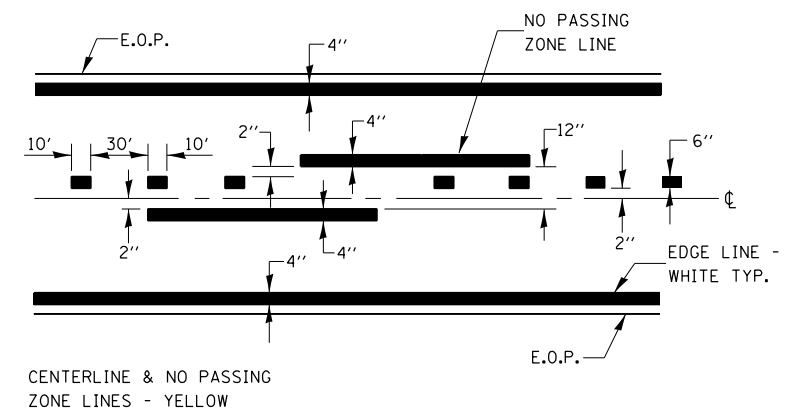

**PAVEMENT MARKING**

FILE NAME =	USER NAME = budzynskim	DESIGNED -	REVISED -	<b>STATE OF ILLINOIS DEPARTMENT OF TRANSPORTATION</b>	<b>DETAILS</b>	F.A.P. RTE.	SECTION	COUNTY	TOTAL SHEETS	SHEET NO.
pw:\IL\084EBIDINTEG.illinois.gov\PIWIDOT\Documents\DOT Offices\District 3\Projects\D3666\DRAWING\DATA\CADsheets\D366F98-shft-cover.dwg	DESIGNED -	REVISED -	786			SECTION (110, 110X) SFY	LASALLE	6	6	
Default	PLOT SCALE = 100.0000' / 1in.	CHECKED -	REVISED -			CONTRACT NO. 66F98				
	PLOT DATE = 12/9/2016	DATE -	REVISED -			ILLINOIS FED. AID PROJECT				
SCALE: SHEET OF SHEETS STA. TO STA.										