

INDEX OF SHEETS

- 1 COVER SHEET
- 2 COMMITMENTS/JOB SPECIFIC NOTES
- 3 SUMMARY OF QUANTITIES
- 4 SCHEDULE OF QUANTITIES
- 5-10 LOCATION MAPS
- 11 CADD STANDARDS

HIGHWAY STANDARDS

- 701101-05
- 701301-04
- 701306-03
- 701311-03
- 701400-09
- 701406-11
- 701421-08
- 701901-09

DISTRICT STANDARDS

452001

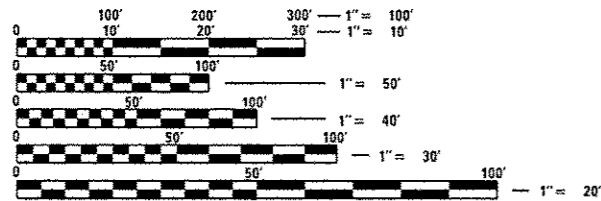

FULL SIZE PLANS HAVE BEEN PREPARED USING STANDARD ENGINEERING SCALES. REDUCED SIZED PLANS WILL NOT CONFORM TO STANDARD SCALES. IN MAKING MEASUREMENTS ON REDUCED PLANS, THE ABOVE SCALES MAY BE USED.

J.U.L.I.E.
JOINT UTILITY LOCATION INFORMATION FOR EXCAVATION
1-800-892-0123
OR 811

PROJECT ENGINEER: CHRISTOPHER MAUSHARD 609-671-3453
PROJECT MANAGER: SOBHI LABABIDI/RAY SAMARA 309-671-3460

CATALOG NO. 035409-00D
CONTRACT NO. 68D25

STATE OF ILLINOIS

DEPARTMENT OF TRANSPORTATION

DIVISION OF HIGHWAYS

**PROPOSED
HIGHWAY PLANS**

VARIOUS ROUTE
SECTION D4 CRACK & JOINT SEAL 2017-1

TYPE of IMPROVEMENT: CONTRACT MAINTENANCE
VARIOUS COUNTIES

C-94-068-16



GROSS LENGTH = N/A
NET LENGTH = N/A

F.A. RTE.	SECTION	COUNTY	TOTAL SHEETS	SHEET NO.
	D4 CRACK & JOINT SEAL 2017-1	VARIOUS	11	1
		ILLINOIS	CONTRACT NO. 68D25	

D-94-036-16



PROJECT DESCRIPTION:

CRACK AND JOINT SEALING AT VARIOUS LOCATIONS WITHIN WESTERN HALF OF DISTRICT 4

STATE OF ILLINOIS
DEPARTMENT OF TRANSPORTATION
DIVISION OF HIGHWAYS

SUBMITTED December 14 2016
Ray Samara
REGION THREE ENGINEER

Jan 27 2017
Maureen M. Addis
ENGINEER OF DESIGN AND ENVIRONMENT

Jan 27 2017
Paula A. ...
DIRECTOR OF PROGRAM DEVELOPMENT

PRINTED BY THE AUTHORITY
OF THE STATE OF ILLINOIS

REV

COMMITMENTS

NO COMMITMENTS HAVE BEEN MADE FOR THIS PROJECT.

JOB SPECIFIC NOTES

ROUT & SEAL CENTERLINE, TRANSVERSE, INNER EDGELINE OF TURNING LANES AND CONSISTENT CENTER OF LANE CRACKS ONLY.

CARE SHALL BE EXERCISED TO KEEP SEALANT OFF EXISTING PAVEMENT MARKINGS. ANY DAMAGE TO THE PAVEMENT MARKINGS SHALL BE REPAIRED BY THE CONTRACTOR AT HIS/HER OWN EXPENSE. WORK SHALL BE DONE IN ACCORDANCE TO SECTION 780 OF THE STANDARD SPECIFICATIONS AND TO THE SATISFACTION OF THE ENGINEER.

ALL DIRT AND DEBRIS CREATED BY THE ROUTING OPERATION SHALL BE CLEANED FROM THE PAVEMENT AND PAVED SHOULDERS AT THE END OF THE DAY'S OPERATIONS ACCORDING TO ARTICLE 107.15 OF THE STANDARD SPECIFICATIONS.

LOCATIONS ARE NUMBERED BY PRIORITY. LOCATIONS SHALL BE COMPLETED IN THIS ORDER ONLY.

FILE NAME : PLANeng.dgn Default	USER NAME : Jobbidism	DESIGNED -	REVISED -	STATE OF ILLINOIS DEPARTMENT OF TRANSPORTATION	COMMITMENTS & JOB SPECIFIC NOTES	F.A. RTE.	SECTION	COUNTY	TOTAL SHEETS	SHEET NO.
	PLOT SCALE : 400.0000' / in.	CHECKED -	REVISED -			VAR. 04 CRACK & JOINT SEAL 2017-1	VARIOUS	11	2	
	PLOT DATE : 12/12/2016	DATE -	REVISED -			CONTRACT NO. 68025				
						SCALE:	SHEET	OF	SHEETS	STA.

CODE NO.	ITEM	UNIT	TOTAL QUANTITY	CONST. CODE
				100 % STATE VAR. COUNTIES 0005
67100100	MOBILIZATION	L SUM	1	1
70100310	TRAFFIC CONTROL AND PROTECTION, STANDARD 701421	L SUM	1	1
70100460	TRAFFIC CONTROL AND PROTECTION, STANDARD 701306	L SUM	1	1
70100700	TRAFFIC CONTROL AND PROTECTION, STANDARD 701406	L SUM	1	1
X4510100	CRACK ROUTING AND FILLING	POUND	139545	139545
X7010410	SPEED DISPLAY TRAILER	CAL MO	0.1	0.1

6

REV

CRACK ROUTING AND FILLING		
LOCATION		POUND
PEORIA COUNTY		
LOCATION 1	IL 91 FROM IL 90 IN PRICVILLE TO STARK COUNTY LINE	15314
STARK COUNTY		
LOCATION 1	IL 91 FROM STARK COUNTY LINE TO STARK-SPEER ROAD	7659
FULTON COUNTY		
LOCATION 2	IL 9 FROM IL 41 (N) TO 2 MILES WEST OF THE SPOON RIVER	55009
KNOX COUNTY		
LOCATION 3	IL 164 FROM IL 41 TO WARREN COUNTY LINE	16418
LOCATION 4	US 150 FROM CARL SANDBURG DRIVE TO 0.25 MILES NORTH OF NORTH LAKE STOREY RD. IN GALESBURG	13426
LOCATION 5	MAIN STREET FROM SOANGETAHA ROAD TO COUNTY HIGHWAY 9 IN EAST GALESBURG	6015
MERCER COUNTY		
LOCATION 6	US 67 FROM ONE MILE NORTH OF GOOD HOPE TO WARREN COUNTY LINE	25704
TOTAL		139,545

TRAFFIC CONTROL AND PROTECTION, STANDARD 701306	
LOCATION	L SUM
JOBSITE	1
TOTAL	1

TRAFFIC CONTROL AND PROTECTION, STANDARD 701406	
LOCATION	L SUM
JOBSITE	1
TOTAL	1

TRAFFIC CONTROL AND PROTECTION, STANDARD 701421	
LOCATION	L SUM
JOBSITE	1
TOTAL	1

SPEED DISPLAY TRAILER	
LOCATION	CAL MO
JOBSITE	0.1
TOTAL	0.1

MOBILIZATION	
LOCATION	L SUM
JOBSITE	1
TOTAL	1

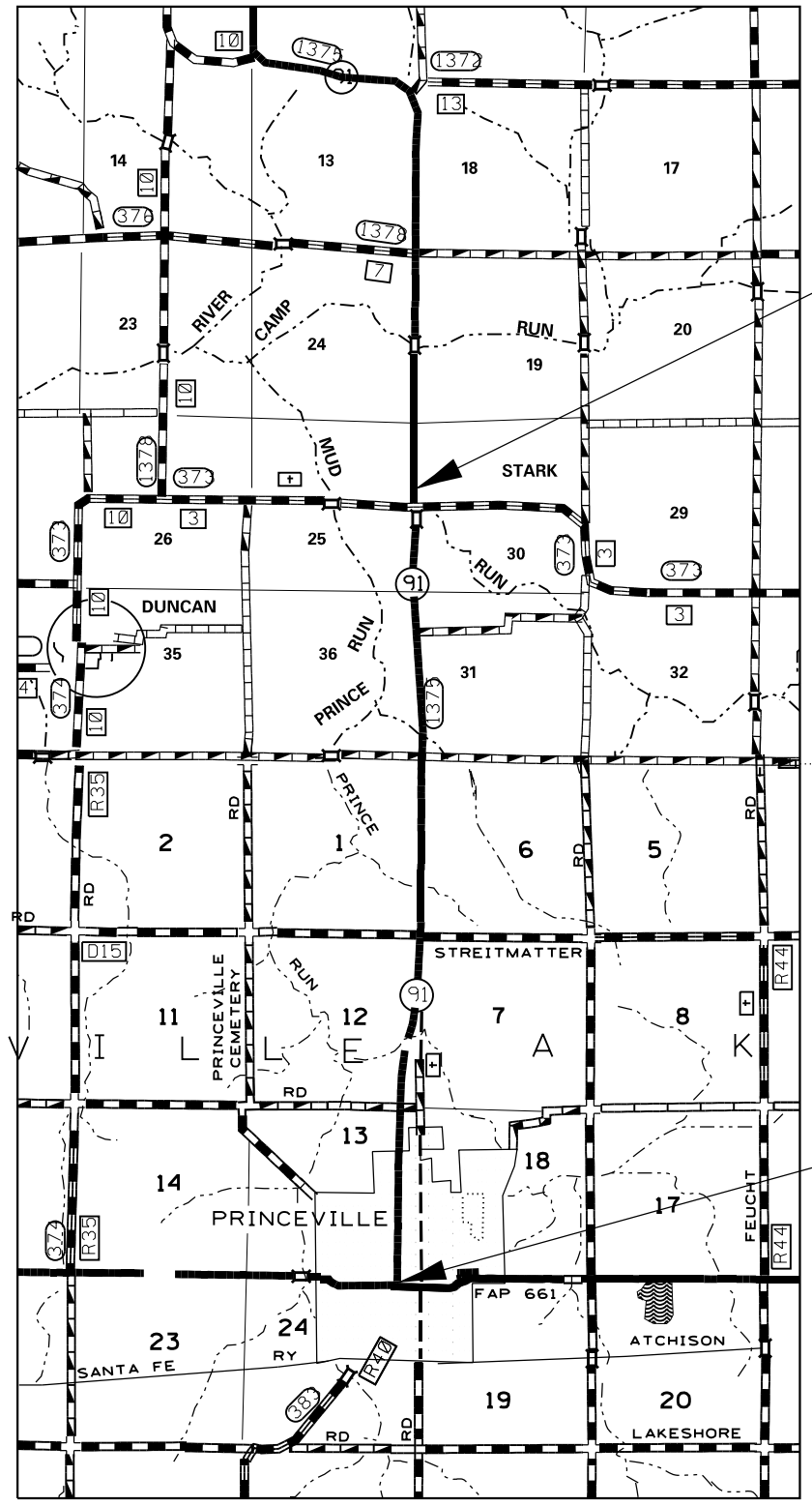

Project Ends
IL 91 Sta. 284+66

Stark County

Peoria County

Project Begins
IL 91 Sta. 42+33

Bridge Omission:
Sta. 119+13 to Sta. 121+03
Sta. 212+94 to Sta. 214+81
Sta. 278+94 to Sta. 280+95

FILE NAME = PLANeng.dgn	USER NAME = lababidism	DESIGNED -	REVISED -	STATE OF ILLINOIS DEPARTMENT OF TRANSPORTATION	LOCATION #1 IL 91 PEORIA /STARK COUNTY			F.A. RTE.	SECTION	COUNTY	TOTAL SHEETS	SHEET NO.			
Default	PLOT SCALE = 400.0000' / in.	DRAWN -	REVISED -		SCALE:	SHEET	OF	SHEETS	STA.	TO	STA.	D4 CRACK & JOINT SEAL 2017-1	VARIOUS	11	5
	PLOT DATE = 12/12/2016	CHECKED -	REVISED -									CONTRACT NO. 68D25			
		DATE -	REVISED -									ILLINOIS FED. AID PROJECT			

Project Ends
IL 9 Sta. 623+06

McDonough County Fulton County

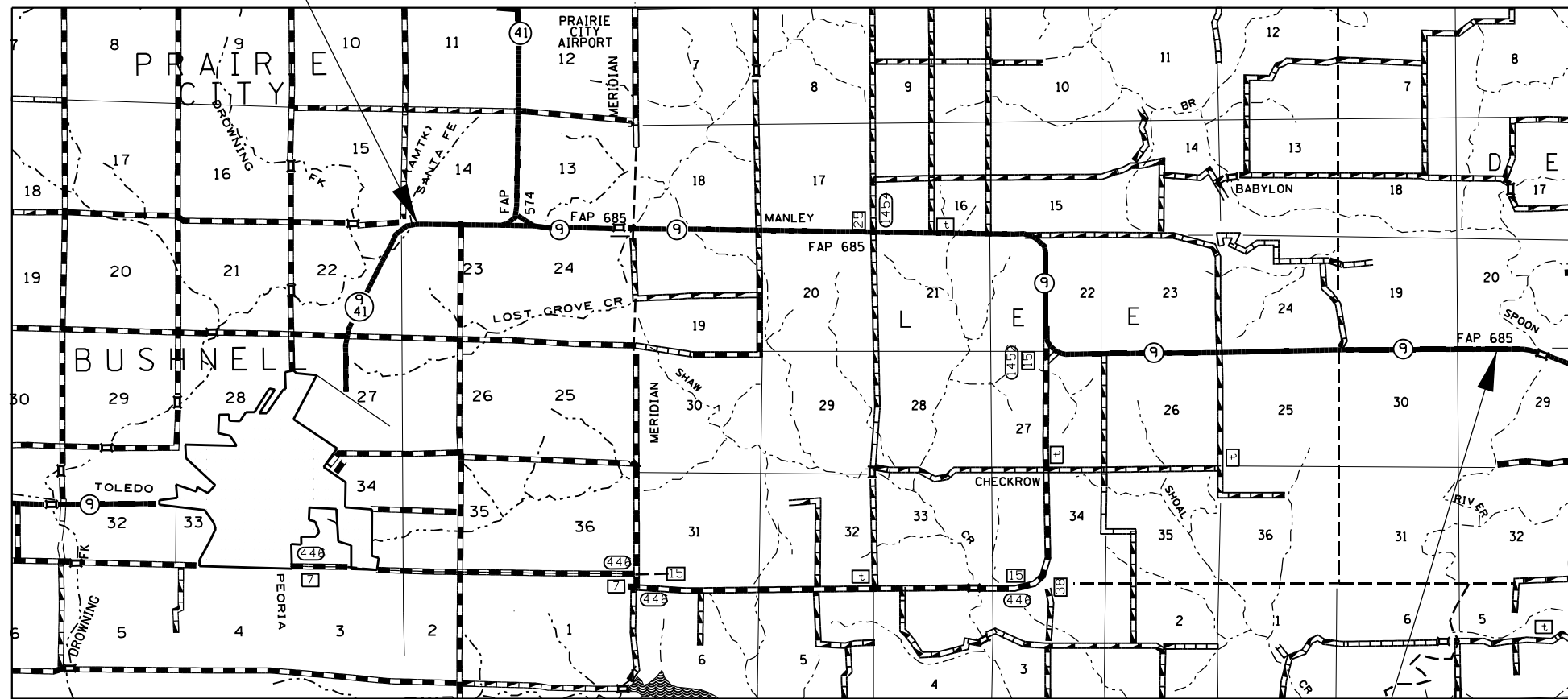
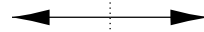

Project Begins
IL 9 Sta 198+80

Bridge Omission Sta. 558+50 to Sta. 588+70

FILE NAME = PLANeng.dgn	USER NAME = lababidism	DESIGNED -	REVISED -	STATE OF ILLINOIS DEPARTMENT OF TRANSPORTATION	LOCATION #2 IL 9 FULTON COUNTY				F.A. RTE.	SECTION	COUNTY	TOTAL SHEETS	SHEET NO.		
Default	PLOT SCALE = 400.0000' / in.	DRAWN -	REVISED -		SCALE:	SHEET	OF	SHEETS	STA.	TO	STA.	D4 CRACK & JOINT SEAL 2017-1	VARIOUS	11	6
	PLOT DATE = 12/12/2016	CHECKED -	REVISED -									CONTRACT NO. 68D25			
		DATE -	REVISED -									ILLINOIS FED. AID PROJECT			

Warren County Knox County

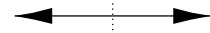

Project Ends
IL 164 Sta 119+36

Project Begins
IL 164 Sta 69+22

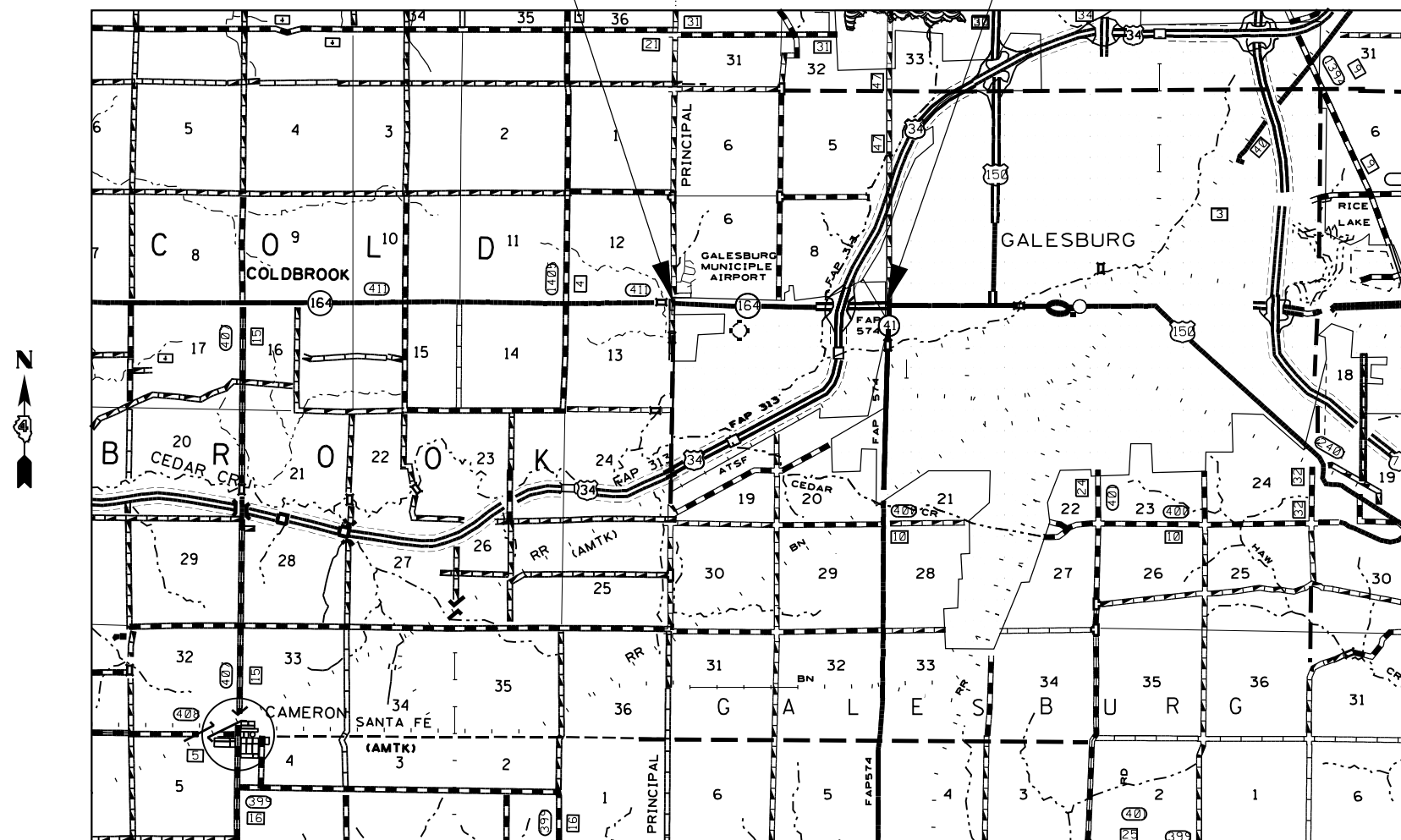

FILE NAME = PLANeng.dgn	USER NAME = lababidism	DESIGNED -	REVISED -
Default	PLOT SCALE = 400.0000' / in.	DRAWN -	REVISED -
	PLOT DATE = 12/12/2016	CHECKED -	REVISED -
		DATE -	REVISED -

**STATE OF ILLINOIS
DEPARTMENT OF TRANSPORTATION**

LOCATION #3 IL 164 KNOX COUNTY

SCALE: SHEET OF SHEETS STA. TO STA.

F.A. RTE.	SECTION	COUNTY	TOTAL SHEETS	SHEET NO.
	D4 CRACK & JOINT SEAL 2017-1	VARIOUS	11	7
			CONTRACT NO. 68D25	
ILLINOIS FED. AID PROJECT				

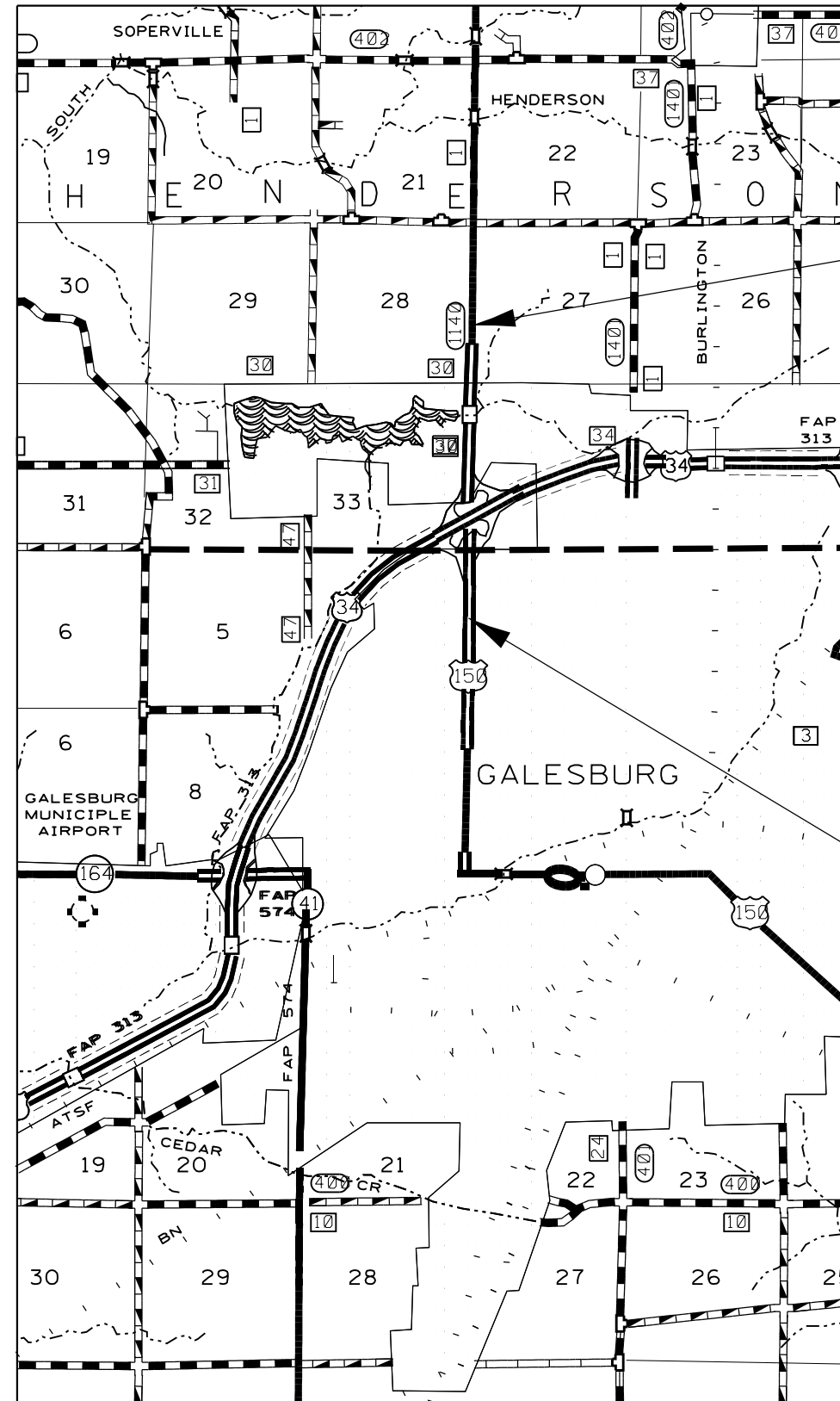

Project Begins
US 150 Sta. 418+09

Project Ends
US 150 Sta. 494+72
(W. Carl Sandburg Dr.)

FILE NAME = PLANeng.dgn	USER NAME = lababidism	DESIGNED -	REVISED -	STATE OF ILLINOIS DEPARTMENT OF TRANSPORTATION	LOCATION #4 US 150 KNOX COUNTY			F.A. RTE.	SECTION	COUNTY	TOTAL SHEETS	SHEET NO.			
Default		DRAWN -	REVISED -		SCALE:	SHEET	OF	SHEETS	STA.	TO	STA.	D4 CRACK & JOINT SEAL 2017-1	VARIOUS	11	8
	PLOT SCALE = 400.0000' / in.	CHECKED -	REVISED -		CONTRACT NO. 68D25										
	PLOT DATE = 12/12/2016	DATE -	REVISED -		ILLINOIS FED. AID PROJECT										

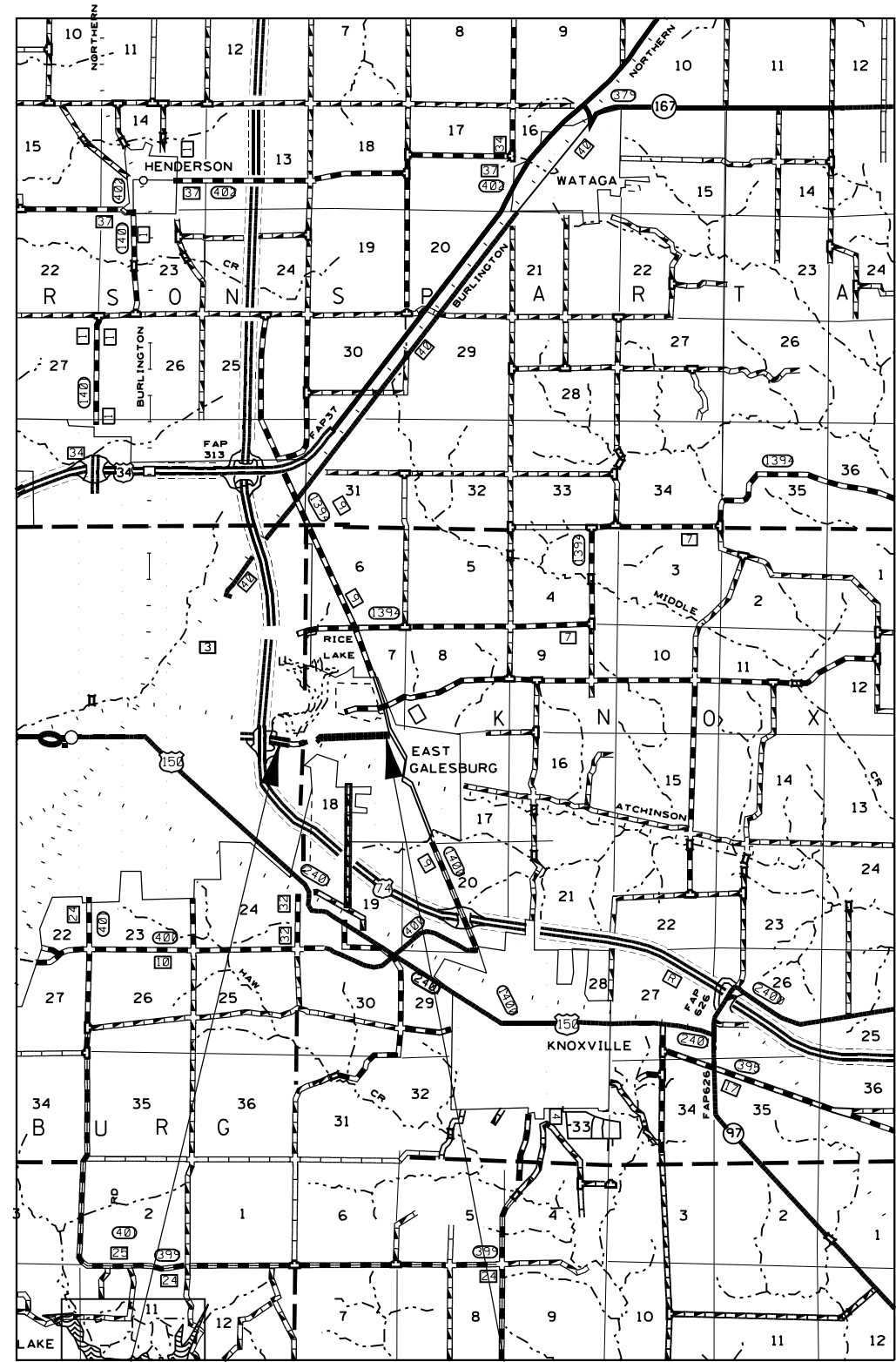

Project Begins
Main St. Sta. 53+00

Project Ends
Main St. Sta. 103+00

FILE NAME = PLANeng.dgn	USER NAME = lababidism	DESIGNED -	REVISED -	STATE OF ILLINOIS DEPARTMENT OF TRANSPORTATION	LOCATION #5 MAIN ST. KNOX COUNTY			F.A. RTE.	SECTION	COUNTY	TOTAL SHEETS	SHEET NO.
	PLOT SCALE = 400.0000' / in.	CHECKED -	REVISED -					D4 CRACK & JOINT SEAL 2017-1	VARIOUS	KNOX	11	9
Default	PLOT DATE = 12/12/2016	DATE -	REVISED -	SCALE: SHEET OF SHEETS STA. TO STA.			CONTRACT NO. 68D25					
ILLINOIS FED. AID PROJECT												

Project Ends
US 67 Sta. 592+60

Project Begins
US 67 Sta. 402+45

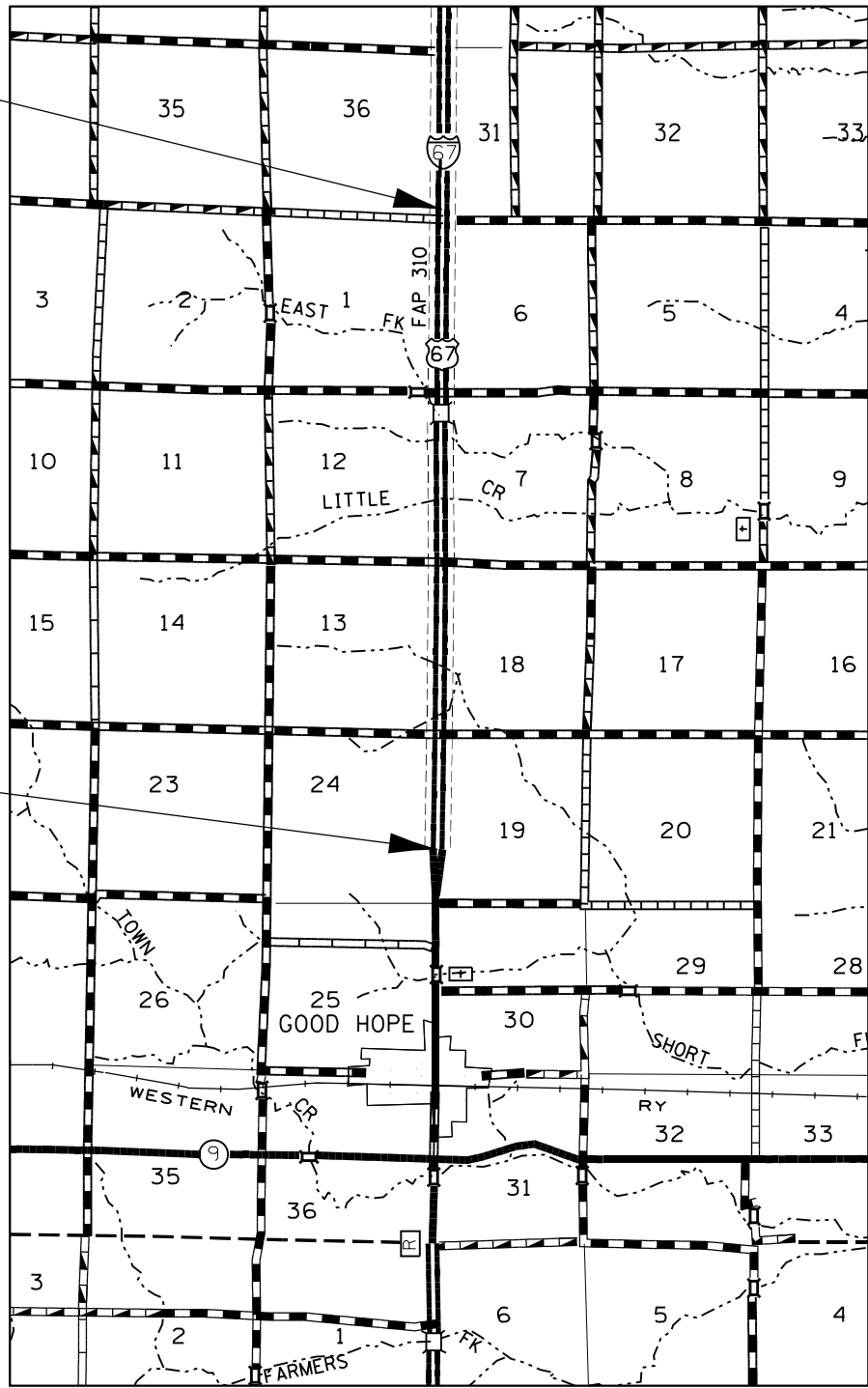

Bridge Omission SN 055-2002

FILE NAME = PLANeng.dgn	USER NAME = lababidism	DESIGNED -	REVISED -
Default	PLOT SCALE = 400.0000' / in.	DRAWN -	REVISED -
	PLOT DATE = 12/12/2016	CHECKED -	REVISED -
		DATE -	REVISED -

STATE OF ILLINOIS
DEPARTMENT OF TRANSPORTATION

LOCATION #6 US 67 MCDONOUGH COUNTY

SCALE: SHEET OF SHEETS STA. TO STA.

F.A. RTE.	SECTION	COUNTY	TOTAL SHEETS	SHEET NO.
VAR. D4 CRACK & JOINT SEAL 2017-1		VARIOUS	11	10
CONTRACT NO. 68D25			ILLINOIS FED. AID PROJECT	

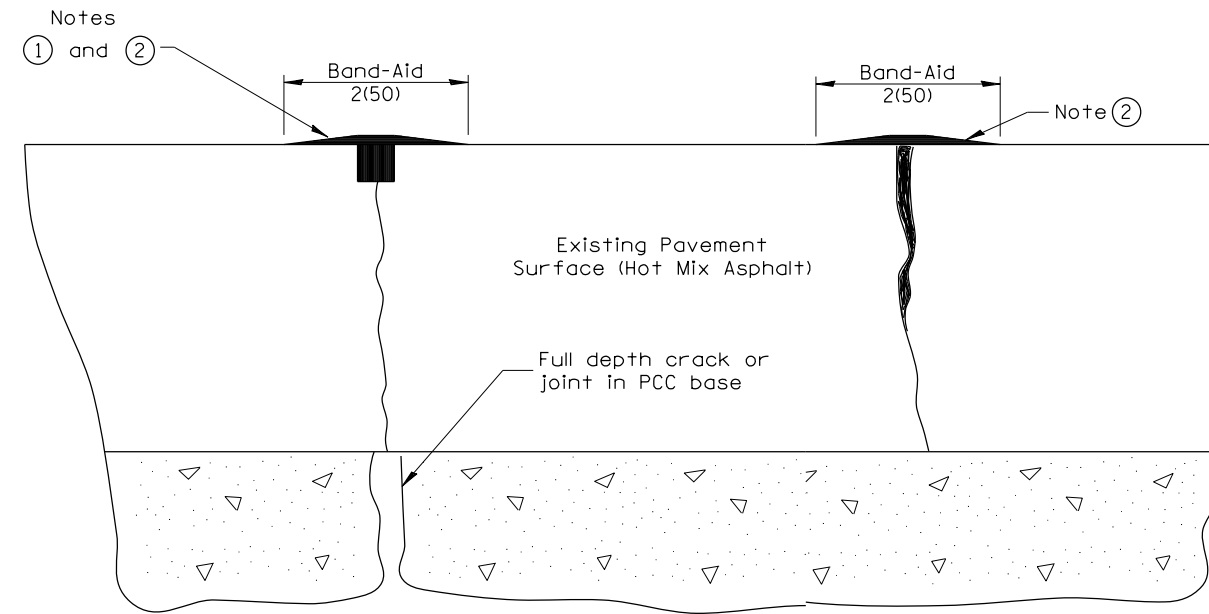

**PRIMARY TRANSVERSE,
LONGITUDINAL CRACK &
P.C.C. CENTERLINE JOINT**

**SECONDARY
ADJACENT CRACK**

NOTES

- ① Route or saw to $\frac{3}{4}(20)$ wide by $\frac{3}{4}(20)$ deep; (1:1 ratio).
- ② Overfill with sealant; squeeze to provide 2 (50) wide flush "band-aid" effect; feather edges flush.
- ③ Seal flush without "band-aid" effect.
- ④ Route to 1(25) depth; clean and reface walls.
- ⑤ Route or saw $\frac{3}{4}(20)$ wide by variable depth. Depth based upon crack or joint depth and $\frac{3}{4}(20)$ minimum sealer over backer rod.

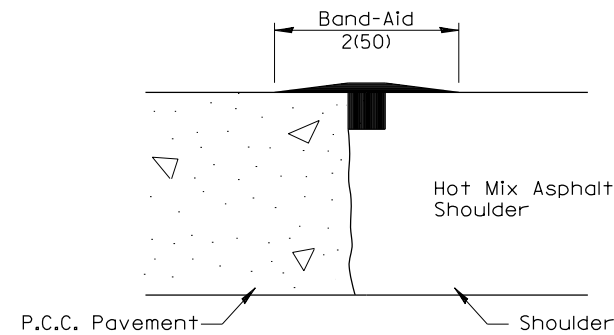

**SHOULDER JOINT (Notes ① & ②) AND
LONGITUDINAL RANDOM CRACK (Notes ① & ③)**

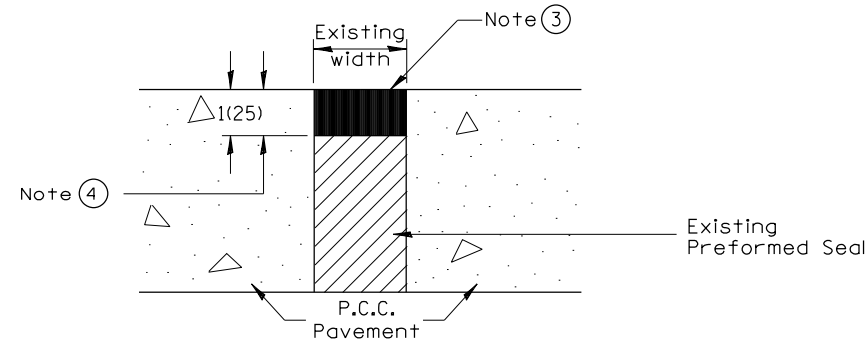

TRANVERSE EXPANSION JOINT

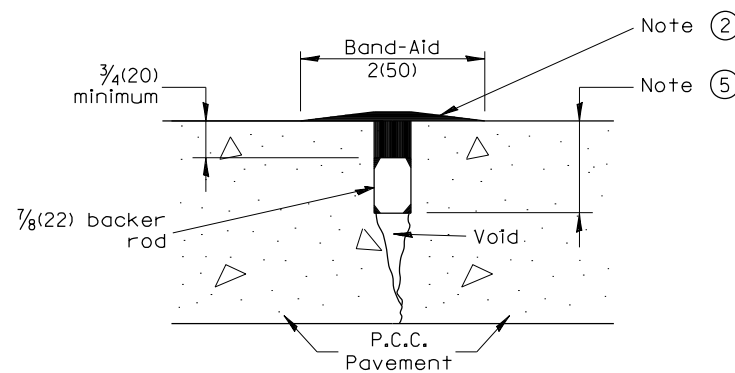

SPECIAL TREATMENT - BACKER ROD
FOR JOINTS AND/OR CRACKS GREATER
THAN $\frac{3}{4}(20)$ DEEP
(DOES NOT APPLY TO TRANSVERSE RANDOM CRACKS
IN CONTINUOUSLY REINFORCED PAVEMENTS)

GENERAL NOTES

- 1. Crack and Joint Sealing shall conform to Section 451 and 452.
- 2. The "Band Aid" width shall be reduced or eliminated in areas adjacent to existing pavement markings.

All dimensions are in inches (millimeters) unless otherwise noted.

01-01-97	RENUM. C-36.01, NEW REVISE BOX	T.P.
05-01-97	REVISED	E.T.
10-16-06	REVISED TO 2007 SPEC.	M.A.

**STATE OF ILLINOIS
DEPARTMENT OF TRANSPORTATION**

CRACK AND JOINT SEALING

NOT TO SCALE

CADD STD. 452001-D4

F.A. RTE.	SECTION	COUNTY	TOTAL SHEETS	SHEET NO.
	D4 CRACK & JOINT SEAL 2017-1	VARIOUS	11	11
			CONTRACT NO. 68D25	
FED. ROAD DIST. NO.		ILLINOIS FED. AID PROJECT		