

F.A.P. RTE.	SECTION	COUNTY	TOTAL SHEETS	SHEET NO.
VAR	D6 MONTGOMERY CO. ADA	MONTGOMERY	24	1
FED. ROAD DIST. NO.	ILLINOIS	CONTRACT NO. 72J15		

**INDEX OF SHEETS**

- 1 COVER SHEET W/ INDEX OF SHEETS
- 2 GENERAL NOTES AND HIGHWAY STANDARDS
- 3-4 SUMMARY OF QUANTITIES
- 5-6 SCHEDULE OF QUANTITIES
- 7 ALIGNMENT & STREET LAYOUT LOCATION
- 8-23 PLAN & PROFILE SHEETS
- 24 DETAILS - STEPS

FOR SUMMARY OF QUANTITIES, SEE SHEET NO. 3

**STATE OF ILLINOIS**  
**DEPARTMENT OF TRANSPORTATION**  
**DIVISION OF HIGHWAYS**  
**PROPOSED**  
**HIGHWAY PLANS**  
 VARIOUS (IL 16 /IL 127)  
 SECTION D6 MONTGOMERY CO. ADA  
 MONTGOMERY COUNTY  
 C-96-053-16

**SIDEWALK ACCESSIBILITY AT VARIOUS INTERSECTIONS IN HILLSBORO**  
**ACF-000V(091)**



FULL SIZE PLANS HAVE BEEN PREPARED USING STANDARD ENGINEERING SCALES. REDUCED SIZED PLANS WILL NOT CONFORM TO STANDARD SCALES. IN MAKING MEASUREMENTS ON REDUCED PLANS, THE ABOVE SCALES MAY BE USED.

D-96-053-16

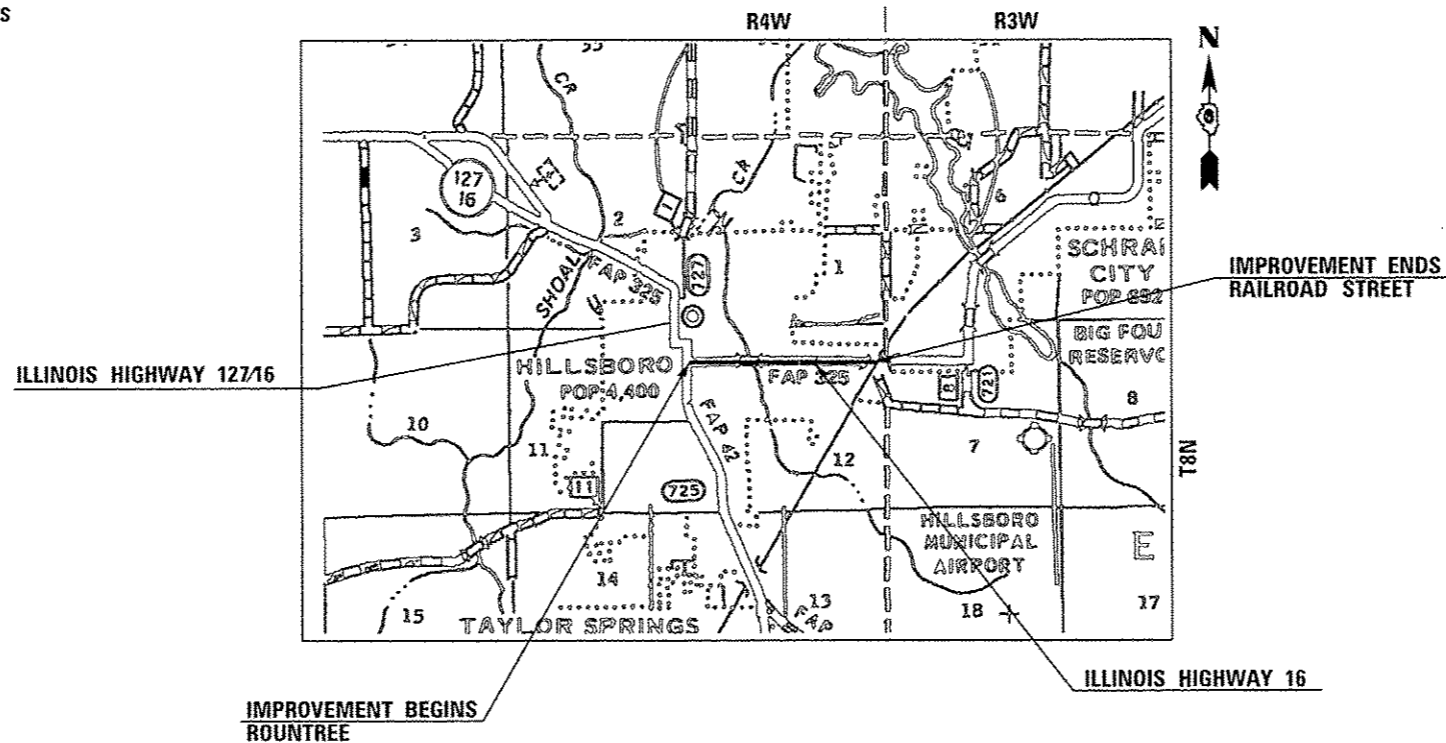
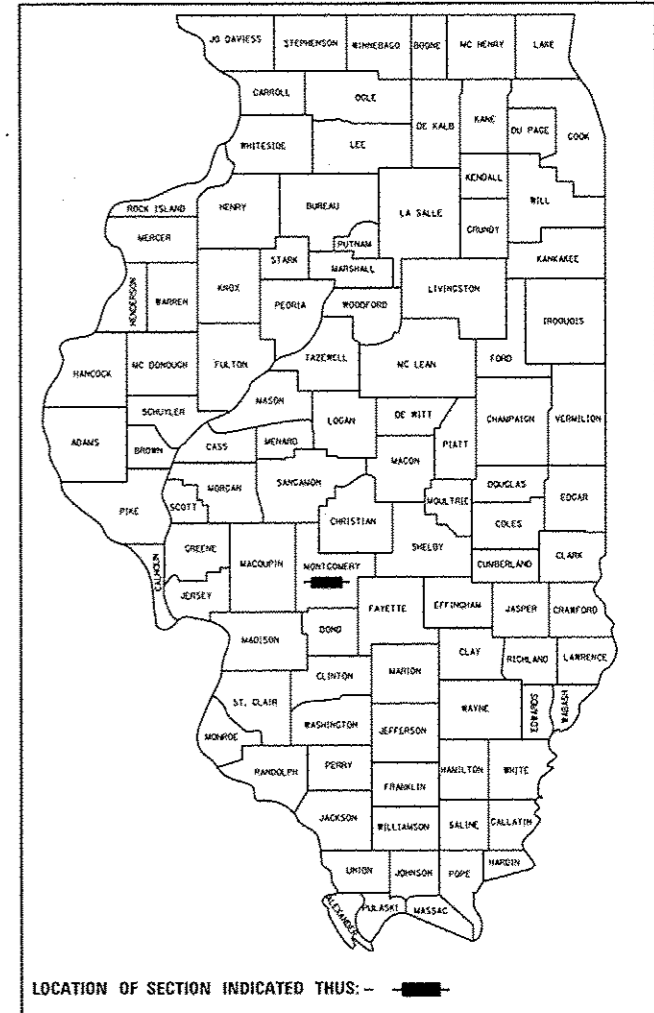

LOCATION MAP



TOTAL LENGTH OF PROJECT = 4785 FEET = 0.906 MILES  
 NET LENGTH OF PROJECT = 4785 FEET = 0.906 MILES

J.U.L.I.E.  
 JOINT UTILITY LOCATION INFORMATION FOR EXCAVATION  
 1-800-892-0123 HILLSBORO TWP. - MONTGOMERY CO.  
 OR 811

PROJECT ENGINEER: KEITH DONOVAN 217-782-4761  
 SQUAD LEADER: TOM COX 217-557-6349

CONTRACT NO. 72J15

STATE OF ILLINOIS  
 DEPARTMENT OF TRANSPORTATION  
 DIVISION OF HIGHWAYS

SUBMITTED 14 December 2016

*[Signature]*  
 DEPUTY DIRECTOR OF HIGHWAYS, REGION ENGINEER

Jan 27 2017  
*[Signature]*  
 ENGINEER OF DESIGN AND ENVIRONMENT

Jan 27 2017  
*[Signature]*  
 DIRECTOR OF PROGRAM DEVELOPMENT

BLANK, WESSELINK, COOK & ASSOCIATES  
 ENGINEERS - CONSULTANTS  
 DECATUR, ILLINOIS



*[Signature]*  
 CHARLES W. GUTHRIE, JR., P.E.  
 DATE December 8 2016  
 EXPIRES NOVEMBER 30, 2017

**PRINTED BY THE AUTHORITY**  
**OF THE STATE OF ILLINOIS**

**HIGHWAY STANDARDS**

- 000001-06 STANDARD SYMBOLS, ABBREVIATIONS AND PATTERNS
- 001001-02 AREAS OF REINFORCEMENT BARS
- 001006 DECIMAL OF AN INCH AND OF A FOOT
- 280001-07 TEMPORARY EROSION CONTROL SYSTEMS
- 424001-09 PERPENDICULAR CURB RAMP FOR SIDEWALKS
- 442201-03 CLASS C AND D PATCHES
- 604066-02 FRAME & LIO, TYPE 15
- 606001-06 CONCRETE CURB TYPE B AND COMB. CONC. CURB & GUTTER
- 701006-05 OFF-RD OPERATIONS, 2L, 2W, 15' (4.5M) TO 24" (600MM) FROM PAVEMENT EDGE
- 701301-04 LANE CLOSURE, 2L, 2W, SHORT TIME OPERATIONS
- 701501-06 URBAN LANE CLOSURE, 2L, 2W, UNDIVIDED
- 701801-06 SIDEWALK, CORNER OR CROSSWALK CLOSURE
- 701901-06 TRAFFIC CONTROL DEVICES

**GENERAL NOTES**

1. WHERE SECTION OR SUB-SECTION MARKERS ARE ENCOUNTERED, THE ENGINEER SHALL BE NOTIFIED BEFORE SUCH MONUMENTS ARE REMOVED. THE CONTRACTOR SHALL PROTECT AND CAREFULLY PRESERVE ALL PROPERTY MARKERS AND MONUMENTS UNTIL THE OWNER, AN AUTHORIZED AGENT OR LAND SURVEYOR HAS WITNESSED OR OTHERWISE REFERENCED THEIR LOCATION.
2. THE CONTRACTOR SHALL BE RESPONSIBLE FOR PROTECTING UTILITY PROPERTY FROM CONSTRUCTION OPERATIONS AS OUTLINED IN ARTICLE 107.31 OF THE STANDARD SPECIFICATIONS. THE J.U.L.I.E. NUMBER IS 800-892-0123.  
  
THE LOCATION OF ALL UTILITIES ARE BASED ON INFORMATION PROVIDED BY OTHERS AND ARE INTENDED TO BE APPROXIMATE. IT SHALL BE THE CONTRACTOR'S RESPONSIBILITY TO COORDINATE HIS CONSTRUCTION ACTIVITIES WITH THE VARIOUS UTILITY OWNERS. ALL POTENTIAL CONFLICTS SHALL BE INVESTIGATED AND REMEDIAL ACTION TAKEN PRIOR TO INTERRUPTION OF THE CONTRACTOR'S PROGRESS. ALL UTILITIES AND PRIVATELY OWNED STREET LIGHTS AND SIGNS THAT REQUIRE RELOCATION SHALL BE MOVED BY OTHERS.
3. WHERE PROPOSED CONSTRUCTION ABUTS EXISTING APPURTENANCES, A SAW CUT SHALL BE MADE TO ACHIEVE A NEAT BUTT JOINT. SAW CUTS WILL NOT BE PAID FOR SEPARATELY. COST OF SAW CUTS SHALL BE INCLUDED IN THE TYPE OF WORK ENCOUNTERED.
4. IN ADDITION TO FIELD SURVEYS, PLAN DIMENSIONS AND DETAILS RELATIVE TO THE EXISTING FACILITIES HAVE BEEN TAKEN FROM EXISTING PLANS AND ARE SUBJECT TO CONSTRUCTION VARIATIONS. IT SHALL BE THE RESPONSIBILITY OF THE CONTRACTOR TO VERIFY SUCH DIMENSIONS AND DETAILS IN THE FIELD. SUCH VARIATIONS SHALL NOT BE A CAUSE FOR ADDITIONAL COMPENSATION DUE TO A CHANGE IN THE SCOPE OF WORK. HOWEVER, THE CONTRACTOR WILL BE PAID FOR THE QUANTITY ACTUALLY FURNISHED AT THE UNIT PRICE BID FOR THE WORK.
5. EXISTING ROAD SIGNS THAT INTERFERE WITH CONSTRUCTION SHALL BE REMOVED OR RELOCATED AS DIRECTED BY THE ENGINEER. THE CONTRACTOR WILL REPLACE THE SIGNS AS DIRECTED BY THE ENGINEER. THIS WORK WILL NOT BE PAID FOR SEPARATELY BUT SHALL BE CONSIDERED INCLUDED IN THE COST OF THE CONTRACT.
6. ALL ELEVATIONS SHOWN ON THE PLANS ARE BASED ON NAVD 88 DATUM.
7. ANY REFERENCE TO A STANDARD IN THESE PLANS SHALL BE INTERPRETED TO MEAN THE EDITION, AS INDICATED BY THE SUB-NUMBER LISTED IN THE INDEX OF SHEETS, OR THE COPY OF THE STANDARD INCLUDED IN THESE PLANS.
8. ACCESS TO ALL PROPERTIES SHALL BE MAINTAINED DURING CONSTRUCTION ACTIVITIES.
9. TREES NOT MARKED FOR REMOVAL SHALL BE CONSIDERED AS DESIGNATED TO BE SAVED AND SHALL BE PROTECTED UNDER THE PROVISIONS OF ARTICLE 201.05.

10. WHEN REQUIRED BY ARTICLE 420.18, A PROTECTIVE COAT SHALL BE APPLIED TO CONCRETE PAVEMENT, GUTTER FLAGS, CURB SURFACES AND OTHER CONCRETE APPURTENANCES ADJACENT TO THE PAVEMENT.
11. SEEDING SHALL BE DONE ON ALL AREAS THAT ARE DISTURBED BY CONSTRUCTION OPERATIONS AS DIRECTED BY THE ENGINEER. SEEDING SHALL BE PAID FOR ONLY WITHIN THE PROPOSED RIGHT-OF-WAY OR EASEMENT LIMITS. ALL AREAS DISTURBED BY THE CONTRACTOR OUTSIDE THE PROPOSED CONSTRUCTION LIMITS SHALL BE SEEDED, AS DIRECTED BY THE ENGINEER, AT THE CONTRACTOR'S EXPENSE. SEEDING WILL NOT BE PERMITTED AT ANY TIME WHEN THE GROUND IS FROZEN, WET OR IN AN UNTILLABLE CONDITION. SEEDING, CLASS 1 SHALL BE USED.
12. IF THE CONTRACTOR REQUESTS OLD PLANS THEY SHALL CONTACT THE PROJECT ENGINEER OR TEAM ENGINEER AS SHOWN ON THE COVER SHEET TO HAVE THEM AVAILABLE FOR REVIEW.
13. PAVEMENT REPAIR - ANY DAMAGE OR REMOVAL OF THE PAVEMENT DUE TO THE REMOVAL OF THE CONCRETE CURB AND GUTTER OR SIDEWALK, SHALL BE REPLACED AND INCLUDED IN THE CONCRETE CURB AND GUTTER OR SIDEWALK REMOVAL. THIS INCLUDES ALL WORK AND MATERIALS ASSOCIATED WITH THE REPLACEMENT.
14. WHERE CURB AND CUTTER IS REMOVED FOR REPLACEMENT AS PART OF THE SIDEWALK RAMP, THE GUTTER REPLACEMENT SHALL MATCH THE EXISTING FLOW LINE AT THE EDGE OF PAVEMENT OR EXISTING GUTTER.

**COMMITMENTS**

NONE

**DISTRICT SIX**

EXAMINED December 1, 20 16

*John C. Wynn*

OPERATIONS ENGINEER

EXAMINED December 2, 20 16

*Jeffrey P. Myer*

PROGRAM DEVELOPMENT ENGINEER

EXAMINED November 30, 20 16

*Ron Duchambeser*

PROJECT IMPLEMENTATION ENGINEER

FILE NAME: p:\11284EBI\INTEG\Illinois.gov\PI001\06	USER NAME: coxka	DESIGNED: CWG	REVISED: -	<b>STATE OF ILLINOIS DEPARTMENT OF TRANSPORTATION</b>	<b>STANDARDS &amp; GENERAL NOTES</b>	F.A.P. RTE. VAR	SECTION 06 MONTGOMERY CO. ADA	COUNTY MONTGOMERY	TOTAL SHEETS 24	SHEET NO. 2		
PLOT SCALE: 1/8" = 1'-0"						CHECKED: -	REVISED: -	CONTRACT NO. 72J15		FED. ROAD DIST. NO. [ILLINOIS] FED. AID PROJECT		
PLOT DATE: 12/9/2016						DATE: -	REVISED: -	SCALE: SHEET NO. 1 OF 1 SHEETS		STA. TO STA.		
SCALE: SHEET NO. 1 OF 1 SHEETS STA. TO STA.												

PPS#6-00784-0100  
 STP-URBAN  
 80% FEDERAL  
 20% STATE  
 0021  
 URBAN  
 TOTAL  
 QUANTITY

PAY CODE NUMBER	ITEM DESCRIPTION	UNIT	QUANTITY
20200100	EARTH EXCAVATION	CU YD	60
25100115	MULCH, METHOD 2	ACRE	0.25
28000500	INLET AND PIPE PROTECTION	EACH	2
42400200	PORTLAND CEMENT CONCRETE SIDEWALK 5 INCH	SQ FT	3919
42400410	PORTLAND CEMENT CONCRETE SIDEWALK 8 INCH	SQ FT	151
42400800	DETECTABLE WARNINGS	SQ FT	318
44000300	CURB REMOVAL	FOOT	329
44000400	GUTTER REMOVAL	FOOT	7
44000500	COMBINATION CURB AND GUTTER REMOVAL	FOOT	141
44000600	SIDEWALK REMOVAL	SQ FT	3566
50300225	CONCRETE STRUCTURES	CU YD	20
60255900	MANHOLES TO BE ADJUSTED WITH NEW TYPE 3 FRAME AND GRATE	EACH	2
60266600	VALVE BOXES TO BE ADJUSTED	EACH	3
60604500	COMBINATION CONCRETE CURB AND GUTTER, TYPE B-6.18 (ABUTTING EXISTING PAVEMENT)	FOOT	169

DECATUR, ILLINOIS

ENGINEERS - CONSULTANTS

BLANK, WESSELINK, COOK & ASSOCIATES

FILE NAME #	USER NAME # USER#	DESIGNED - CWG	REVISED -	STATE OF ILLINOIS DEPARTMENT OF TRANSPORTATION	SUMMARY OF QUANTITIES				F.A. RTE.	SECTION	COUNTY	TOTAL SHEETS	SHEET NO.
#FILE#		DRAWN - BWC	REVISED -		SCALE:	SHEET NO. 1 OF 3 SHEETS	STA.	TO STA.	VAR	D6 MONTGOMERY CO. ADA	MONTGOMERY	24	3
	PLOT SCALE * SCALE#	CHECKED -	REVISED -		FED. ROAD DIST. NO. [ILLINOIS] FED. AID PROJECT								
	PLOT DATE * DATE#	DATE -	REVISED -		CONTRACT NO. 72J15								



**EARTH EXCAVATION**

LOCATION	STATION TO	STATION	OFFSET	CU YD
ROUNTREE NW	48+84	49+21	LT	2.4
	49+07	49+12	LT	0.5
ROUNTREE NE	49+53	49+72	LT	1.1
	49+60	49+64	LT	0.7
ROUNTREE SE	49+52	49+73	RT	0.7
	49+61	49+66	RT	1.0
CHASE SW	4+24	4+59	RT	4.6
CHASE SE	4+59	4+79	RT	2.7
	5+10	5+29	RT	0.9
	5+17	5+22	RT	2.6
CRITTENDEN NW	13+44	13+68	LT	2.0
CRITTENDEN NE	13+97	14+57	LT	19.4
PRESTON SW	17+49	17+59	RT	0.1
PRESTON SE	17+82	18+08	RT	1.7
	17+83	17+88	RT	0.9
ECCLES NE	23+92	24+20	LT	0.5
ECCLES SW	23+32	23+46	RT	1.0
	23+42	23+46	RT	0.9
ECCLES SE	23+75	23+96	RT	1.0
	23+96	24+06	RT	0.6
	24+06	24+11	RT	0.1
LEVA SW	27+18	27+28	RT	0.1
LEVA SE	27+28	27+37	RT	0.2
	27+66	27+80	RT	0.3
	27+80	27+90	RT	0.1
ANNA SW	30+72	30+93	RT	0.8
ANNA SE	30+84	30+89	RT	0.3
	31+26	31+36	RT	0.3
	31+36	31+40	RT	0.1
VIRGINIA NW	34+32	34+47	LT	0.4
VIRGINIA NE	34+72	34+83	LT	0.1
VIRGINIA SW	34+24	34+37	RT	0.1
VIRGINIA SE	34+75	35+04	RT	1.7
	34+80	34+84	RT	0.6
PARK SW	37+84	37+99	RT	0.5
	37+89	37+93	RT	0.1
PARK SE	38+37	38+60	RT	1.4
	38+43	38+48	RT	0.7
BEAL SW	41+27	41+44	RT	0.2
BEAL SE	41+80	41+97	RT	0.3
INDUSTRIAL PARK	1073+31	1073+52	RT	1.8
RAILROAD ST.	1073+51	1073+56	LT	4.4
ROUNDED TOTAL				60

**SEEDING AND MULCH**

LOCATION	SEEDING CLASS 1 SPECIAL (ACRE)	MULCH METHOD 2 (ACRE)
IL 16	0.25	0.25

**INLET & PIPE PROTECTION**

LOCATION	STATION	OFFSET	EACH
PARK SW	37+95	22.7' RT	1
PARK SE	38+40	22.3' RT	1
TOTAL			2

**P.C.C. SIDEWALK 8"**

LOCATION	STATION TO	STATION	OFFSET	SQ FT
LAKEVIEW SW	7+94	7+98	RT	16
LAKEVIEW SE	7+98	8+08	RT	40
	8+08	8+28	RT	95
TOTAL				151

**GUTTER REMOVAL**

LOCATION	STATION TO	STATION	OFFSET	SQ FT
PARK SW	37+94	37+97	RT	4
PARK SE	38+39	38+41	RT	3
TOTAL				7

**MANHOLES TO BE ADJUSTED WITH NEW TYPE 3 FRAME & GRATE**

LOCATION	STATION	OFFSET	EACH
PARK SW	37+95	22.7' RT	1
PARK SE	38+40	22.3' RT	1
TOTAL			2

**VALVE BOX ADJUSTED**

LOCATION	STATION	OFFSET	EACH
LAKEVIEW DR.	8+13	25.4' RT	1
LEVA SE	27+68	28.9' RT	1
PARK SE	38+40	28.7' RT	1
TOTAL			3

**P.C.C. SIDEWALK 5"**

LOCATION	STATION TO	STATION	OFFSET	SQ FT
ROUNTREE NW	48+84	49+19	LT	217
ROUNTREE NE	49+55	49+72	LT	143
ROUNTREE SE	49+54	49+73	RT	218
CHASE SW	4+24	4+77	RT	270
CHASE SE	5+13	5+29	RT	200
CRITTENDEN NW	13+44	13+68	LT	135
CRITTENDEN NE	13+97	14+57	LT	300
PRESTON SW	17+49	17+58	RT	46
PRESTON SE	17+83	18+08	RT	189
ECCLES NW	23+22	23+39	LT	76
ECCLES NE	23+96	24+20	LT	115
ECCLES SW	23+32	23+48	RT	156
ECCLES SE	23+75	24+11	RT	186
LEVA SW	27+18	27+37	RT	94
LEVA SE	27+66	27+90	RT	121
ANNA SW	30+72	30+73	RT	125
ANNA SE	31+23	31+40	RT	106
VIRGINIA NW	34+32	34+48	LT	96
VIRGINIA NE	34+72	34+83	LT	44
VIRGINIA SW	34+24	34+42	RT	78
VIRGINIA SE	34+74	35+04	RT	216
PARK SW	37+84	37+99	RT	84
PARK SE	38+37	38+60	RT	182
BEAL SW	41+27	41+44	RT	102
BEAL SE	41+80	41+97	RT	111
INDUSTRIAL PARK	1073+52	1073+31	RT	113
RAILROAD ST.	1073+85	1073+51	LT	196
TOTAL				3919

**COMBINATION CURB AND GUTTER REMOVAL**

LOCATION	STATION TO	STATION	OFFSET	FOOT
ROUNTREE NW	49+08	49+19	LT	15
ROUNTREE NE	49+54	49+64	LT	15
ROUNTREE SE	49+53	49+66	RT	19
CHASE SW	4+74	4+77	RT	6
CHASE SE	5+12	5+15	RT	6
PRESTON SW	17+58	17+59	RT	5
PRESTON SE	17+82	17+83	RT	6
ECCLES NW	23+32	23+40	LT	10
ECCLES NE	23+95	24+02	LT	9
ECCLES SE	23+75	23+77	RT	6
ANNA SW	30+92	30+94	RT	4
ANNA SE	31+23	31+26	RT	7
PARK SW	37+97	37+99	RT	6
PARK SE	38+37	38+39	RT	5
BEAL SW	41+42	41+44	RT	5
BEAL SE	41+80	41+81	RT	5
INDUSTRIAL PARK	1073+47	1073+57	RT	12
TOTAL				141

**DETECTABLE WARNINGS**

LOCATION	STATION TO	STATION	OFFSET	SQ FT
ROUNTREE NW	49+07	49+12	LT	10
ROUNTREE NE	49+13	49+15	LT	10
	49+58	49+60	LT	10
	49+60	49+64	LT	9
ROUNTREE SE	49+55	49+57	RT	8
	49+61	49+66	RT	10
CHASE SW	4+72	4+74	RT	10
CHASE SE	5+15	5+17	RT	9
LAVEVIEW SW	7+96	7+98	RT	8
LAVEVIEW SE	8+18	8+20	RT	8
CRITTENDEN NW	13+62	13+64	LT	10
CRITTENDEN NE	13+98	14+00	LT	10
PRESTON SW	17+55	17+57	RT	8
PRESTON SE	17+83	17+85	RT	9
ECCLES NW	23+30	23+39	LT	16
ECCLES NE	23+96	24+05	LT	16
ECCLES SW	23+44	23+46	RT	10
ECCLES SE	23+79	23+81	RT	10
LEVA SW	27+35	27+37	RT	10
LEVA SE	27+66	27+68	RT	10
ANNA SW	30+90	30+92	RT	8
ANNA SE	31+26	31+28	RT	10
VIRGINIA NW	34+45	34+47	LT	12
VIRGINIA NE	34+72	34+74	LT	8
VIRGINIA SW	34+38	34+40	RT	10
VIRGINIA SE	34+78	34+80	RT	10
PARK SW	37+95	37+97	RT	8
PARK SE	38+39	38+41	RT	11
BEAL SW	41+40	41+42	RT	10
BEAL SE	41+81	41+83	RT	10
INDUSTRIAL PARK	1073+52	1073+47	RT	10
RAILROAD ST.	1073+56	1073+51	LT	10
TOTAL				318

**CURB REMOVAL**

LOCATION	STATION TO	STATION	OFFSET	FOOT
ROUNTREE NW	49+07	49+08	LT	2
	48+94	49+08	LT	19
	48+94	49+19	LT	25
ROUNTREE NE	49+64	49+64	LT	5
ROUNTREE SE	49+65	49+65	RT	9
CRITTENDEN NW	13+55	13+68	LT	14
	13+55	13+64	LT	9
CRITTENDEN NE	14+04	14+48	LT	44
PRESTON SW	17+49	17+57	RT	9
	17+49	17+58	RT	10
PRESTON SE	17+83	17+84	RT	1
	17+83	17+88	RT	4
ECCLES NW	23+28	23+31	LT	3
	23+28	23+39	LT	11
ECCLES NE	23+96	24+07	LT	11
	24+04	24+07	LT	3
ECCLES SW	23+32	23+42	RT	10
	23+42	23+44	RT	3
ECCLES SE	23+75	24+06	RT	30
	23+77	24+06	RT	29
LEVA SW	27+36	27+37	RT	2
ANNA SE	31+23	31+28	RT	5
	31+26	31+36	RT	11
VIRGINIA SW	34+40	34+42	RT	6
	34+74	34+78	RT	7
PARK SW	37+92	37+94	RT	3
PARK SE	38+39	38+44	RT	4
	38+41	38+43	RT	3
INDUSTRIAL PARK	1073+46	1073+57	RT	11
RAILROAD ST.	1073+51	1073+57	LT	7
	1073+52	1073+61	LT	8
	1073+49	1073+60	LT	11
<b>TOTAL</b>				<b>329</b>

**SIDEWALK REMOVAL**

LOCATION	STATION TO	STATION	OFFSET	SQ FT
ROUNTREE NW	48+84	49+19	LT	182
ROUNTREE NE	49+55	49+72	LT	123
ROUNTREE SE	49+54	49+73	RT	214
CHASE SW	4+24	4+77	RT	210
CHASE SE	5+12	5+29	RT	171
LAKEVIEW SW	7+94	7+98	RT	16
LAKEVIEW SE	8+08	8+28	RT	91
CRITTENDEN NW	13+44	13+68	LT	106
CRITTENDEN NE	13+97	14+57	LT	300
PRESTON SW	17+49	17+59	RT	31
PRESTON SE	17+82	18+08	RT	138
ECCLES NW	23+22	23+39	LT	65
ECCLES NE	23+96	24+20	LT	69
ECCLES SW	23+32	23+48	RT	136
ECCLES SE	23+76	24+11	RT	132
LEVA SW	27+18	27+37	RT	76
LEVA SE	27+66	27+90	RT	146
ANNA SW	30+72	30+93	RT	125
ANNA SE	31+24	31+40	RT	81
VIRGINIA NW	34+32	34+48	LT	96
VIRGINIA NE	34+72	34+83	LT	43
VIRGINIA SW	34+24	34+42	RT	75
VIRGINIA SE	34+73	35+04	RT	187
PARK SW	37+84	37+99	RT	87
PARK SE	38+38	38+60	RT	167
BEAL SW	41+27	41+44	RT	104
BEAL SE	41+80	41+97	RT	115
INDUSTRIAL PARK	1073+31	1073+57	RT	113
RAILROAD ST.	1073+51	1073+85	LT	167
<b>TOTAL</b>				<b>3566</b>

**COMBINATION CURB AND GUTTER,  
TYPE B-6.18 (ABUTTING EXISTING PAVEMENT)**

LOCATION	STATION TO	STATION	OFFSET	FOOT
ROUNTREE NW	49+07	49+21	LT	17
ROUNTREE NE	49+53	49+64	LT	14
ROUNTREE SE	49+52	49+66	RT	19
CHASE SW	4+75	4+79	RT	6
CHASE SE	5+10	5+14	RT	6
PRESTON SW	17+59	17+60	RT	5
PRESTON SE	17+80	17+82	RT	5
ECCLES NW	23+32	23+43	LT	10
ECCLES NE	23+92	24+03	LT	10
ECCLES SE	23+75	23+78	RT	6
ANNA SW	30+92	30+93	RT	5
ANNA SE	31+23	31+26	RT	7
VIRGINIA SW	34+40	34+42	RT	6
VIRGINIA SE	34+74	34+78	RT	7
PARK SW	37+92	37+99	RT	12
PARK SE	38+37	38+43	RT	12
BEAL SW	41+42	41+44	RT	5
BEAL SE	41+80	41+81	RT	5
INDUSTRIAL PARK	1073+47	1073+57	RT	12
<b>TOTAL</b>				<b>169</b>

**CONCRETE STRUCTURES**

LOCATION	STATION TO	STATION	OFFSET	CU YD
CHASE NW	4+43	4+67	RT	3
CRITTENDON NE	13+97	14+57	LT	10
ECCLES SE	23+75	24+06	RT	4
RAILROAD ST.	1073+51	1073+75	LT	3
<b>TOTAL</b>				<b>20</b>

**CONCRETE STEP REMOVAL**

LOCATION	STATION	OFFSET	EACH
CRITTENDEN NE	13+98	LT	1
	13+99	LT	1
	14+00	LT	1
	14+01	LT	1
<b>TOTAL</b>			<b>4</b>

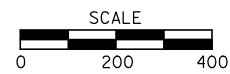

ALIGNMENT	STATION	NORTHING	EASTING
SCHOOL ST.	43+57.01	907,147.46	2,487,479.06
	50+00.00	907,156.52	2,488,121.98
E109	0+00.00	907,156.52	2,488,121.98
	4+99.38	907,163.97	2,488,621.30
	14+98.78	907,178.67	2,489,620.60
	24+89.47	907,192.85	2,490,611.19
	44+23.98	907,219.05	2,492,545.52
E110	1074+61.66	907,232.40	2,492,973.80
PT	1073+74.58	907,233.96	2,492,923.87
	1072+53.78	907,230.42	2,492,874.02
PC	1071+32.91	907,221.84	2,492,753.45
	1070+82.93	907,220.22	2,492,632.59
	1070+32.97	907,219.05	2,492,545.52

CONTROL POINT	NORTHING	EASTING	ELEVATION
CP106	907,138.09	2,489,578.49	587.20
CP108	907,226.55	2,491,228.04	630.03
CP110	907,242.73	2,492,351.31	625.50
CP111	907,264.07	2,492,677.17	621.76

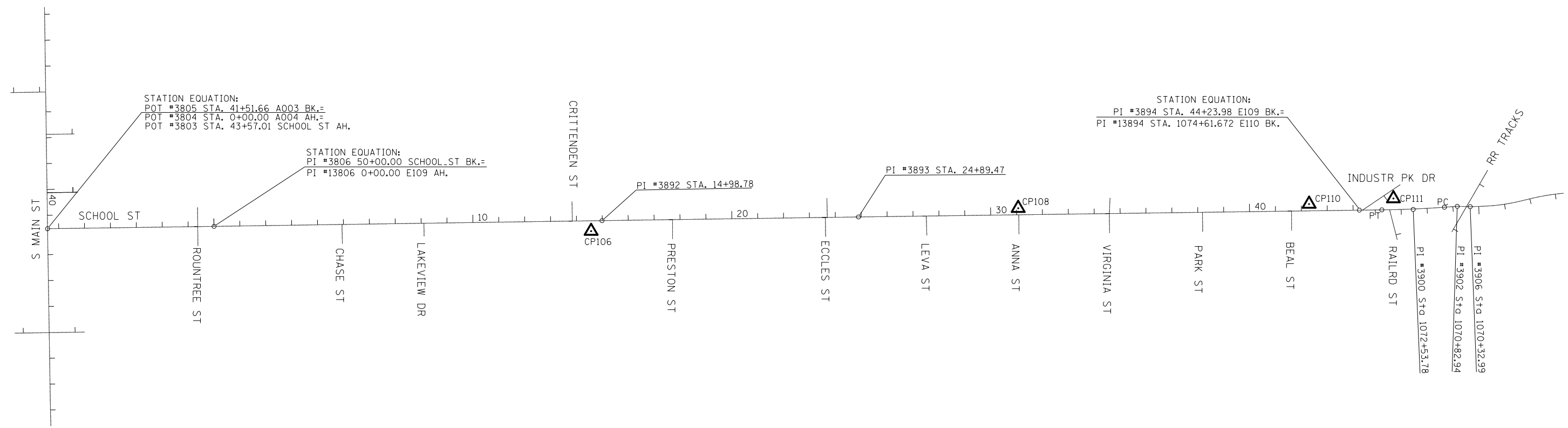

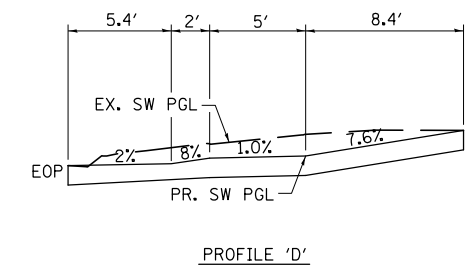
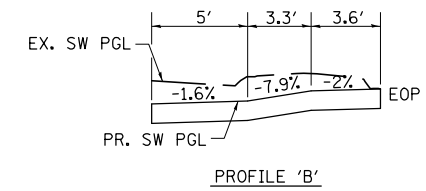
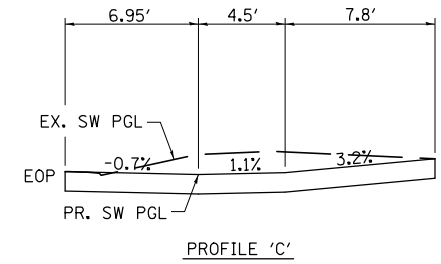
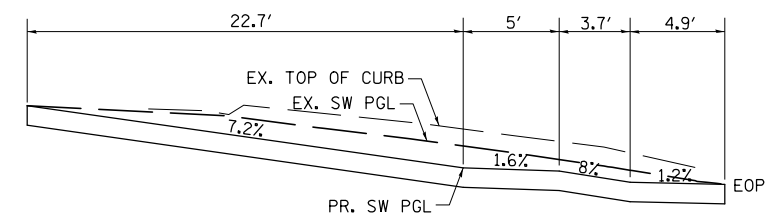
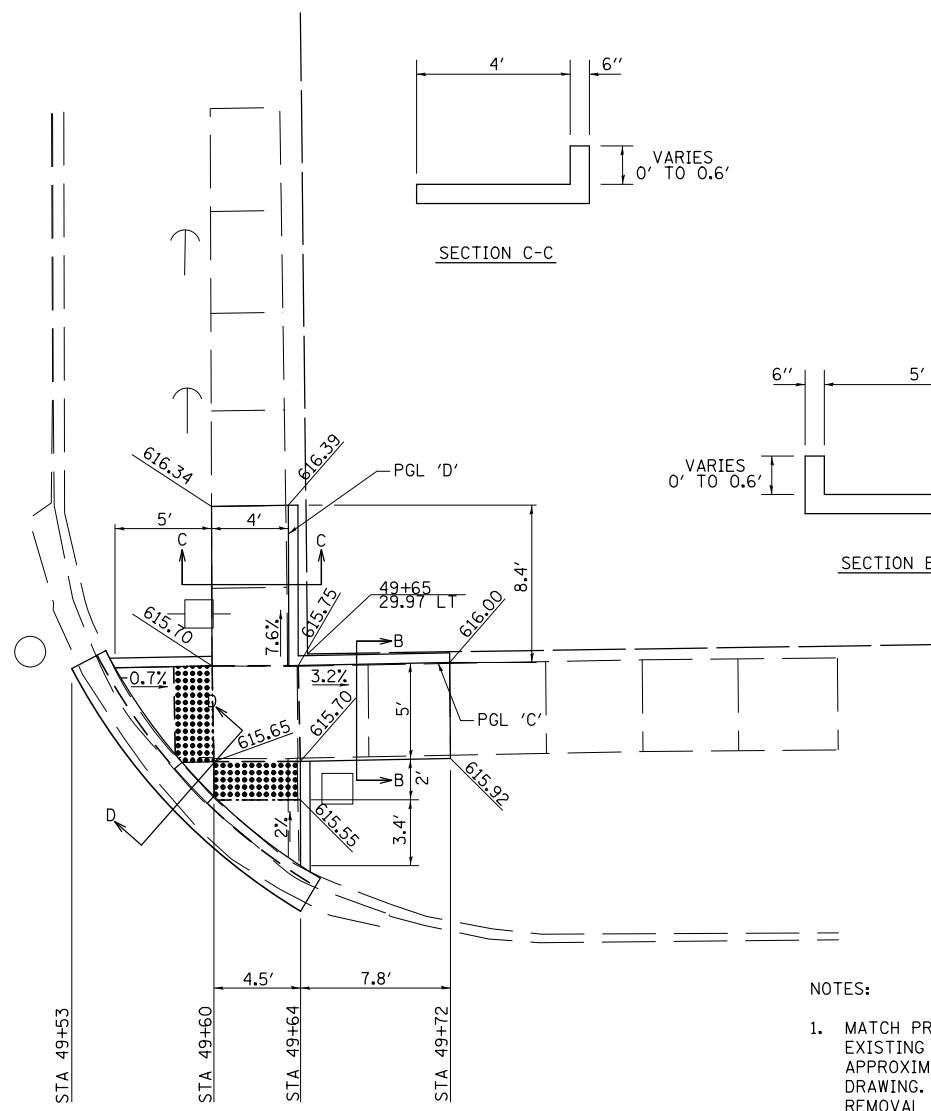
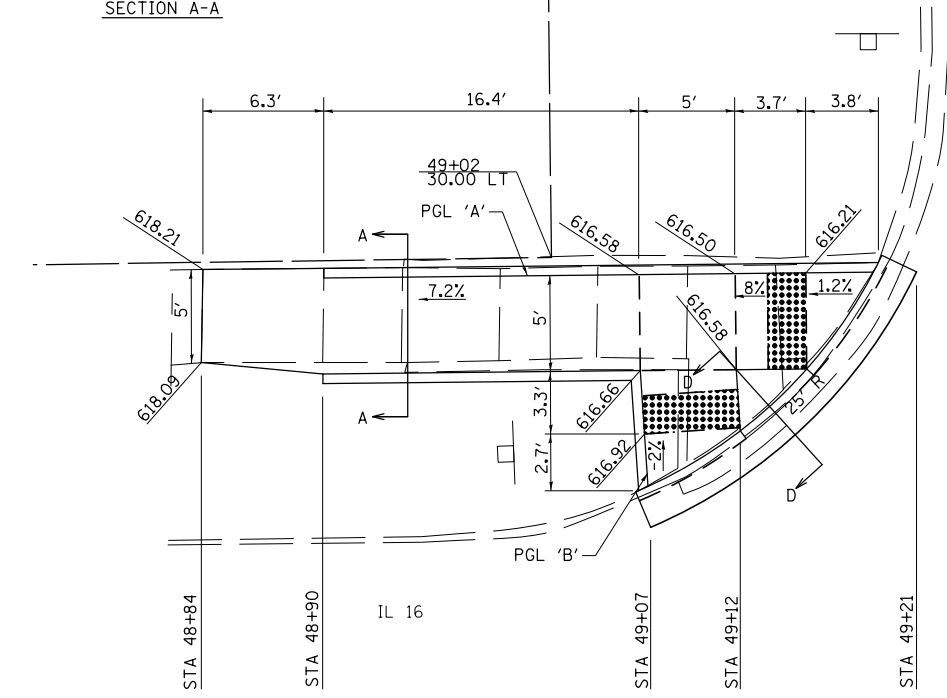
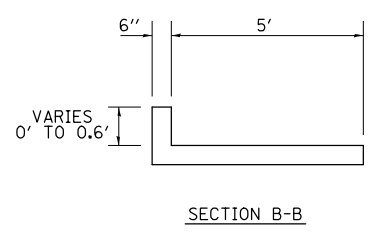
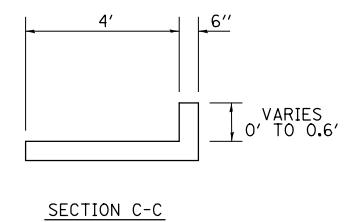
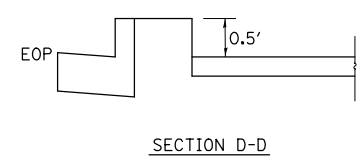
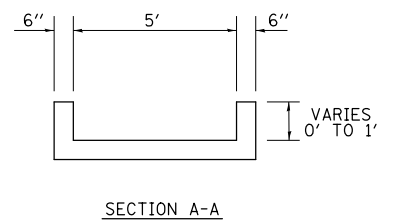
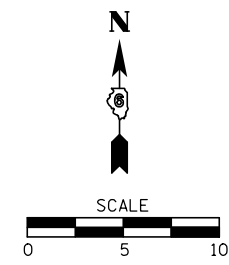

- NOTES:
1. MATCH PROPOSED CURB & GUTTER TO EXISTING CURB AND GUTTER AT THE APPROXIMATE LOCATIONS SHOWN ON THE DRAWING. SAW CUT FULL-DEPTH FOR REMOVAL OF CURB AND GUTTER.
  2. MATCH PROPOSED SIDEWALK TO THE EXISTING SIDEWALK AT AN EXISTING JOINT. SAW CUT FULL-DEPTH FOR REMOVAL OF SIDEWALK.
  3. SEE IDOT STD. 424001 FOR DETAILS OF PERPENDICULAR CURB RAMPS FOR SIDEWALKS.
  4. STA.'S & OFFSETS ARE FROM IL RT. 16  $\perp$
  5. ELEVATIONS SHOWN ARE TO THE TOP OF SIDEWALK UNLESS OTHERWISE NOTED.
  6. THE CONTRACTOR SHALL VERIFY EXISTING FIELD CONDITIONS PRIOR TO THE CONSTRUCTION OF ANY RAMP OR SIDEWALK. ANY ADJUSTMENTS NECESSARY TO MEET EXISTING FIELD CONDITIONS SHALL BE APPROVED BY THE ENGINEER PRIOR TO CONSTRUCTION.

FILE NAME =	USER NAME = \$USER*	DESIGNED - CWG	REVISED -
*FILEL*		DRAWN - BWC	REVISED -
	PLOT SCALE = \$SCALE*	CHECKED -	REVISED -
*MODELNAME*	PLOT DATE = \$DATE*	DATE -	REVISED -

**STATE OF ILLINOIS  
DEPARTMENT OF TRANSPORTATION**

**SIDEWALK DETAILS  
ROUNTREE & IL 16**

SCALE: 1"=5'      SHEET 1      OF 16      SHEETS      STA.      TO STA.

F.A. RTE.	SECTION	COUNTY	TOTAL SHEETS	SHEET NO.
VAR	D6 MONTGOMERY CO. ADA	MONTGOMERY	24	8
			CONTRACT NO. 72J15	
ILLINOIS FED. AID PROJECT				



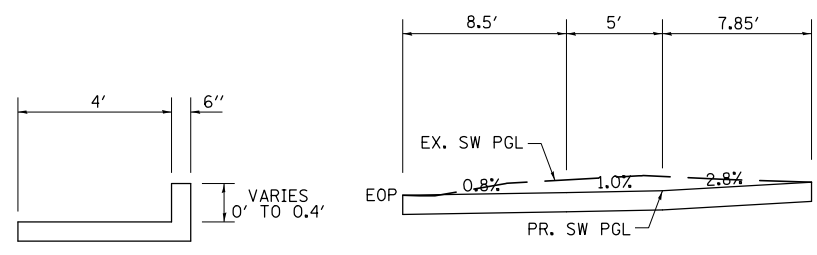
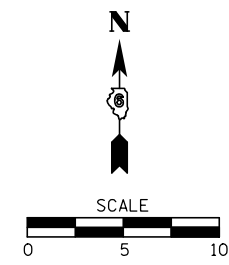

SECTION A-A

PROFILE 'A'

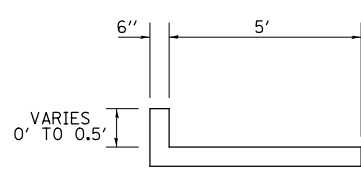

SECTION B-B

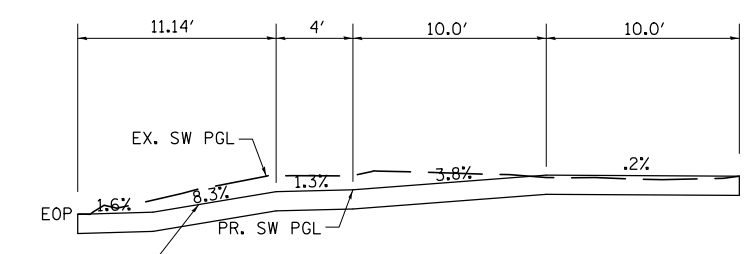

PROFILE 'B'

GRADE AT OR ABOVE ALLOWABLE  
DUE TO MATCHING EXISTING SIDEWALK

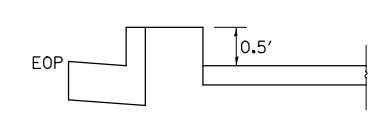

SECTION C-C

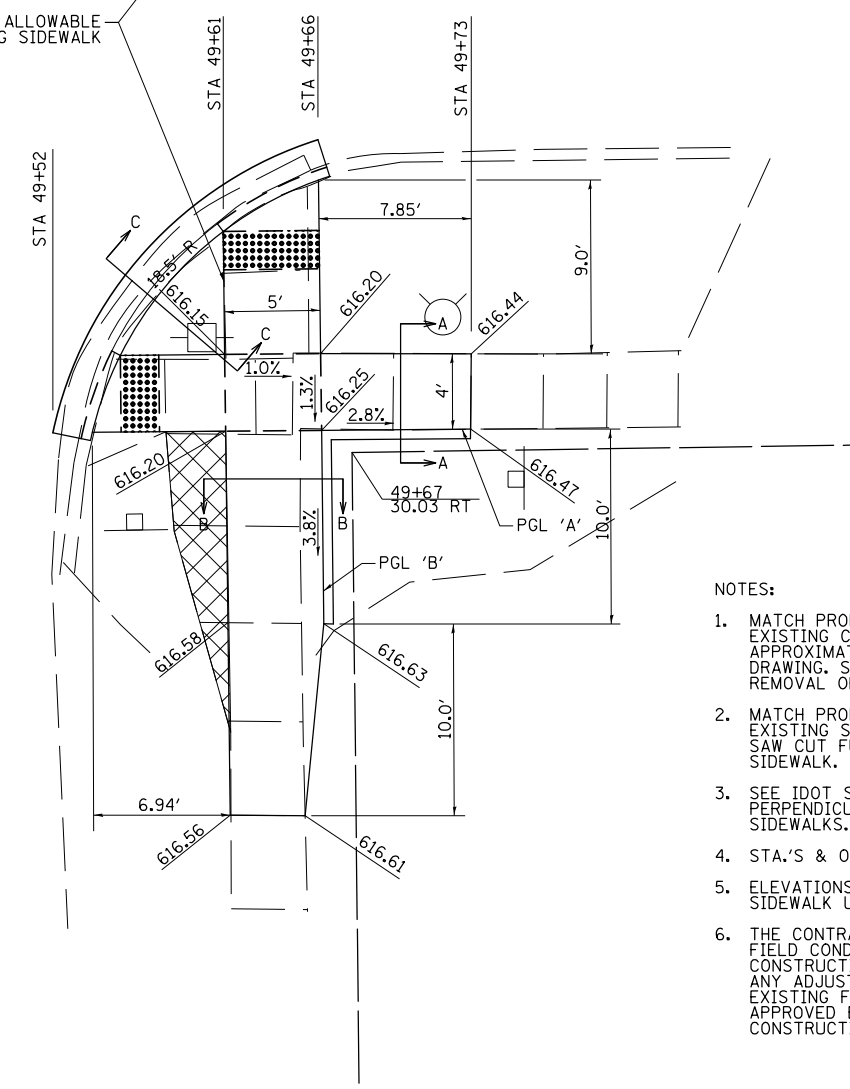
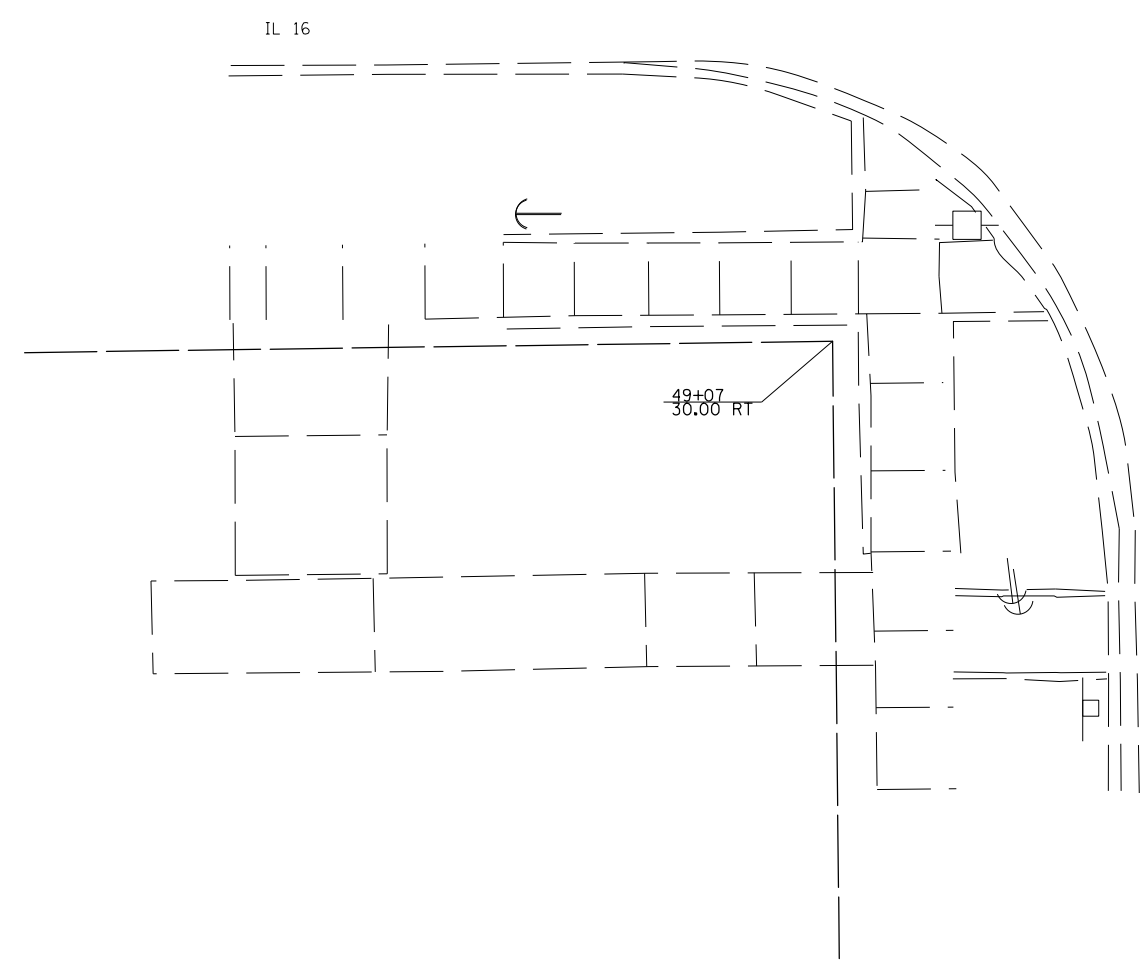

NOTES:

1. MATCH PROPOSED CURB & GUTTER TO EXISTING CURB AND GUTTER AT THE APPROXIMATE LOCATIONS SHOWN ON THE DRAWING. SAW CUT FULL-DEPTH FOR REMOVAL OF CURB AND GUTTER.
2. MATCH PROPOSED SIDEWALK TO THE EXISTING SIDEWALK AT AN EXISTING JOINT. SAW CUT FULL-DEPTH FOR REMOVAL OF SIDEWALK.
3. SEE IDOT STD. 424001 FOR DETAILS OF PERPENDICULAR CURB RAMPS FOR SIDEWALKS.
4. STA.'S & OFFSETS ARE FROM IL RT. 16 C
5. ELEVATIONS SHOWN ARE TO THE TOP OF SIDEWALK UNLESS OTHERWISE NOTED.
6. THE CONTRACTOR SHALL VERIFY EXISTING FIELD CONDITIONS PRIOR TO THE CONSTRUCTION OF ANY RAMP OR SIDEWALK. ANY ADJUSTMENTS NECESSARY TO MEET EXISTING FIELD CONDITIONS SHALL BE APPROVED BY THE ENGINEER PRIOR TO CONSTRUCTION.

FILE NAME =	USER NAME = \$USER*	DESIGNED - CWG	REVISED -
*FILEL\$		DRAWN - BWC	REVISED -
	PLOT SCALE = \$SCALE*	CHECKED -	REVISED -
*MODELNAME\$	PLOT DATE = \$DATE*	DATE -	REVISED -

STATE OF ILLINOIS  
DEPARTMENT OF TRANSPORTATION

SIDEWALK DETAILS  
ROUNTREE & IL 16

SCALE: 1"=5' SHEET 2 OF 16 SHEETS STA. TO STA.

F.A. RTE.	SECTION	COUNTY	TOTAL SHEETS	SHEET NO.
VAR	D6 MONTGOMERY CO. ADA	MONTGOMERY	24	9
			CONTRACT NO. 72J15	
ILLINOIS FED. AID PROJECT				

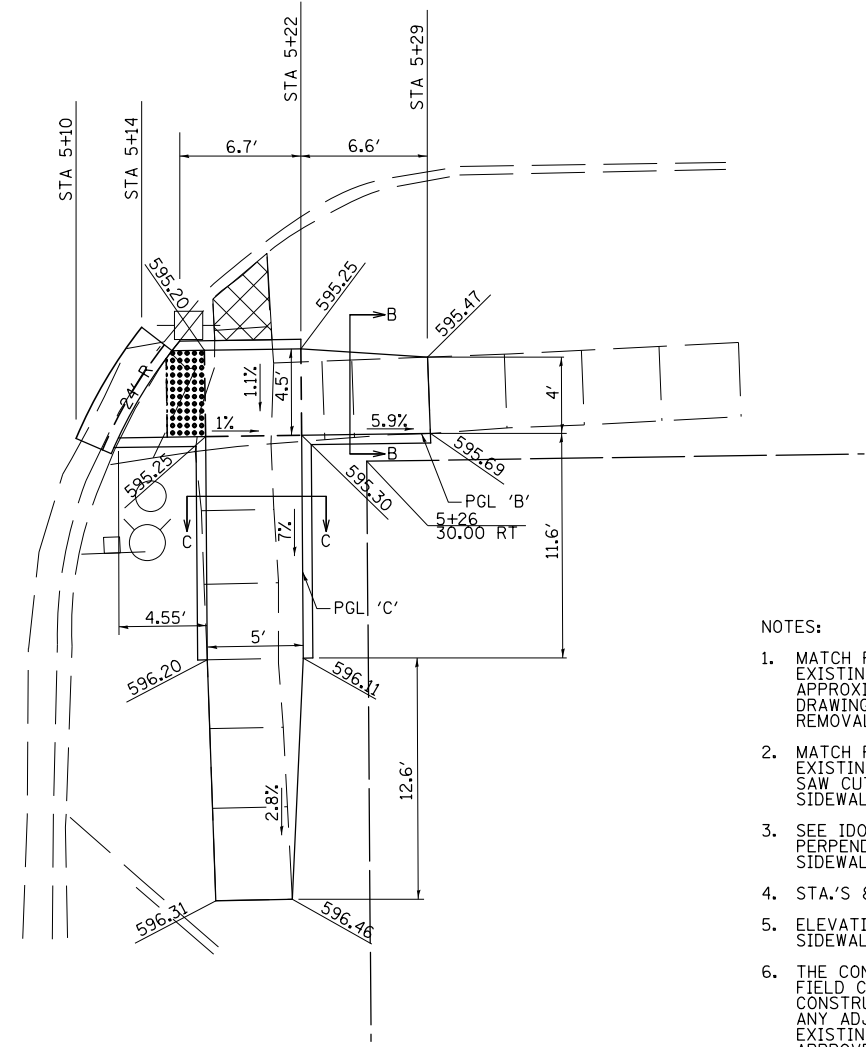
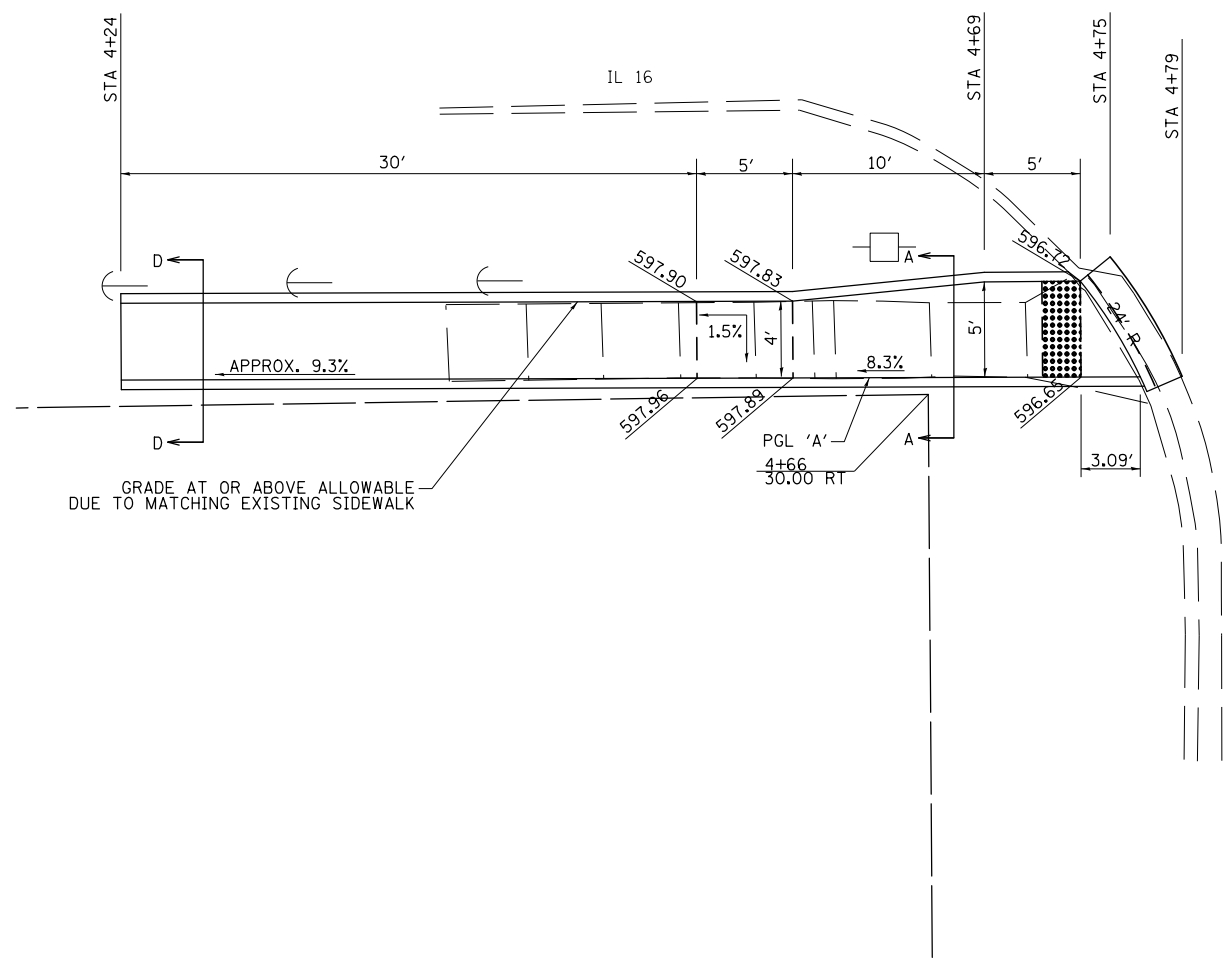
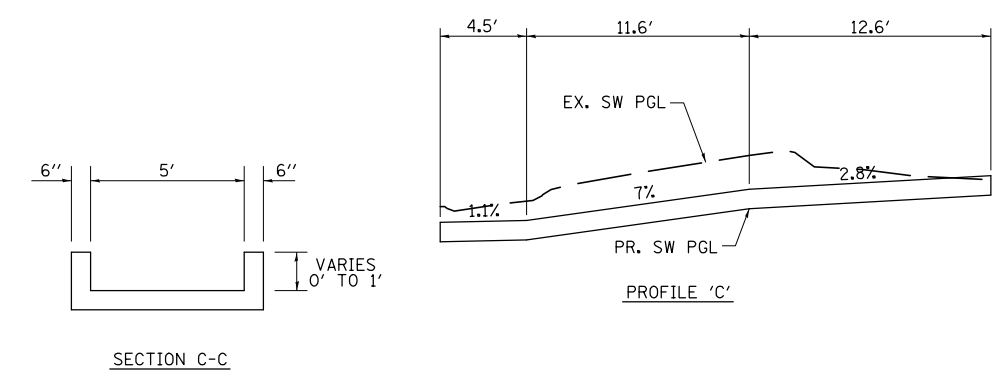
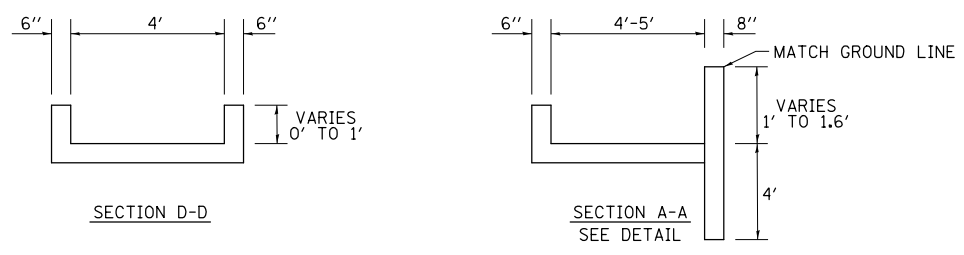
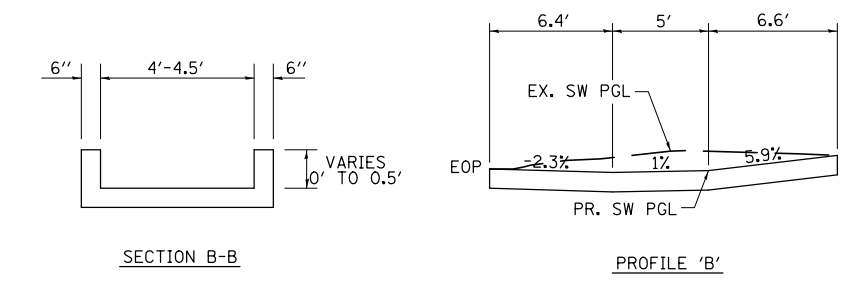
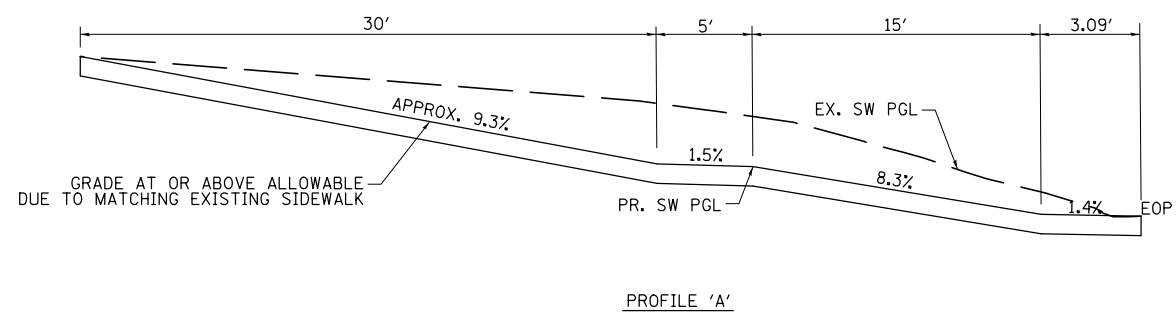
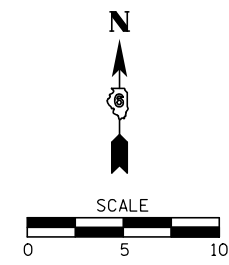

- NOTES:
1. MATCH PROPOSED CURB & GUTTER TO EXISTING CURB AND GUTTER AT THE APPROXIMATE LOCATIONS SHOWN ON THE DRAWING. SAW CUT FULL-DEPTH FOR REMOVAL OF CURB AND GUTTER.
  2. MATCH PROPOSED SIDEWALK TO THE EXISTING SIDEWALK AT AN EXISTING JOINT. SAW CUT FULL-DEPTH FOR REMOVAL OF SIDEWALK.
  3. SEE IDOT STD. 424001 FOR DETAILS OF PERPENDICULAR CURB RAMPS FOR SIDEWALKS.
  4. STA.'S & OFFSETS ARE FROM IL RT. 16 C
  5. ELEVATIONS SHOWN ARE TO THE TOP OF SIDEWALK UNLESS OTHERWISE NOTED.
  6. THE CONTRACTOR SHALL VERIFY EXISTING FIELD CONDITIONS PRIOR TO THE CONSTRUCTION OF ANY RAMP OR SIDEWALK. ANY ADJUSTMENTS NECESSARY TO MEET EXISTING FIELD CONDITIONS SHALL BE APPROVED BY THE ENGINEER PRIOR TO CONSTRUCTION.

FILE NAME =	USER NAME = #USER#	DESIGNED - CWG	REVISED -
#FILE#		DRAWN - BWC	REVISED -
	PLOT SCALE = #SCALE#	CHECKED -	REVISED -
#MODELNAME#	PLOT DATE = #DATE#	DATE -	REVISED -

**STATE OF ILLINOIS  
DEPARTMENT OF TRANSPORTATION**

<b>SIDEWALK DETAILS</b>	
<b>CHASE ST. &amp; IL 16</b>	
SCALE: 1"=5'	SHEET 3 OF 16 SHEETS STA. TO STA.

F.A. RTE.	SECTION	COUNTY	TOTAL SHEETS	SHEET NO.
VAR	D6 MONTGOMERY CO. ADA	MONTGOMERY	24	10
			CONTRACT NO. 72J15	
ILLINOIS FED. AID PROJECT				

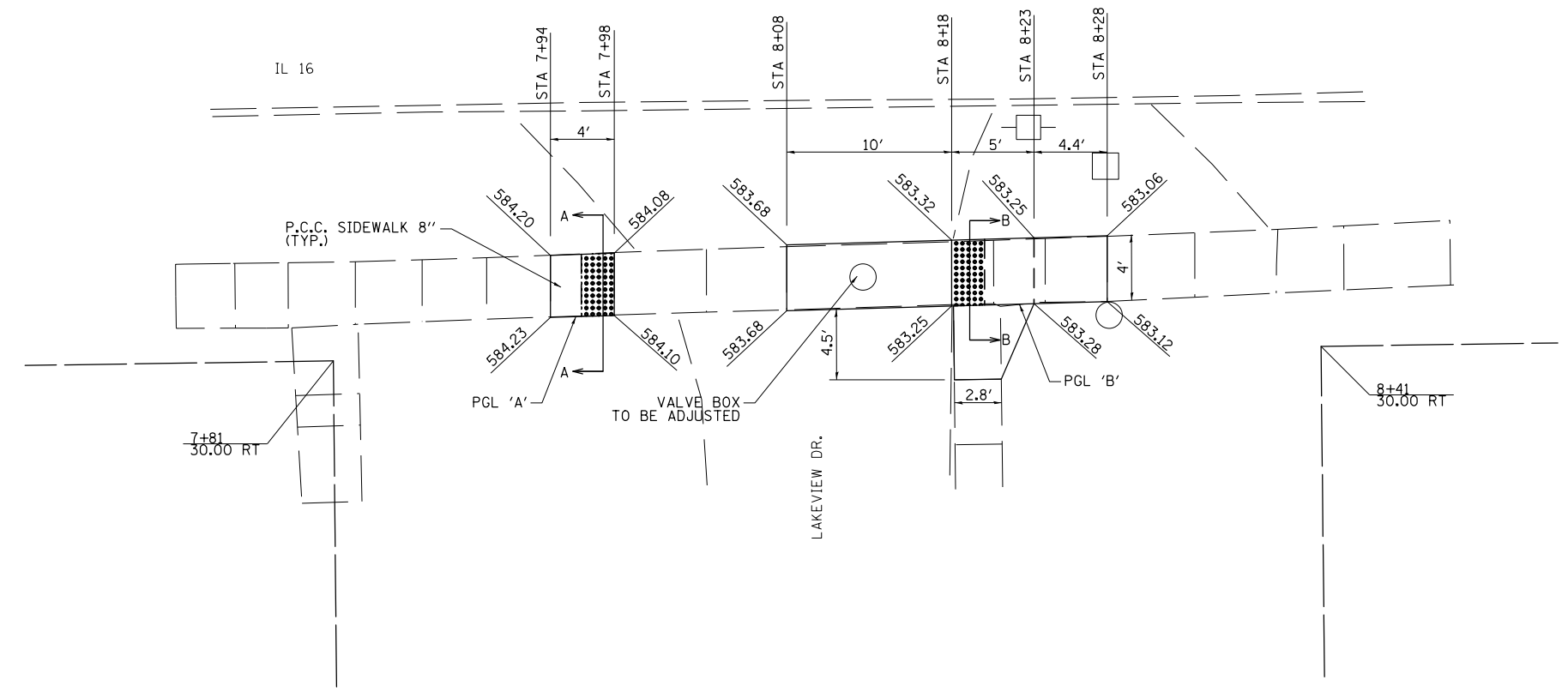
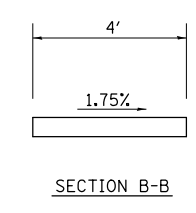
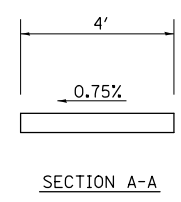
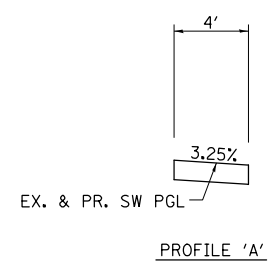
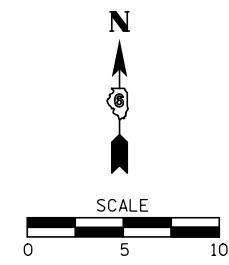

- NOTES:
1. MATCH PROPOSED CURB & GUTTER TO EXISTING CURB AND GUTTER AT THE APPROXIMATE LOCATIONS SHOWN ON THE DRAWING. SAW CUT FULL-DEPTH FOR REMOVAL OF CURB AND GUTTER.
  2. MATCH PROPOSED SIDEWALK TO THE EXISTING SIDEWALK AT AN EXISTING JOINT. SAW CUT FULL-DEPTH FOR REMOVAL OF SIDEWALK.
  3. SEE IDOT STD. 424001 FOR DETAILS OF PERPENDICULAR CURB RAMPS FOR SIDEWALKS.
  4. STA.'S & OFFSETS ARE FROM IL RT. 16  $\nabla$
  5. ELEVATIONS SHOWN ARE TO THE TOP OF SIDEWALK UNLESS OTHERWISE NOTED.
  6. THE CONTRACTOR SHALL VERIFY EXISTING FIELD CONDITIONS PRIOR TO THE CONSTRUCTION OF ANY RAMP OR SIDEWALK. ANY ADJUSTMENTS NECESSARY TO MEET EXISTING FIELD CONDITIONS SHALL BE APPROVED BY THE ENGINEER PRIOR TO CONSTRUCTION.

FILE NAME =	USER NAME = \$USER*	DESIGNED - CWG	REVISED -
\$FILEL\$		DRAWN - BWC	REVISED -
\$MODELNAME\$		CHECKED -	REVISED -
	PLOT DATE = \$DATE*	DATE -	REVISED -

**STATE OF ILLINOIS  
DEPARTMENT OF TRANSPORTATION**

<b>SIDEWALK DETAILS LAKEVIEW DR. &amp; IL 16</b>			
SCALE: 1"=5'	SHEET 4	OF 16 SHEETS	STA. TO STA.

F.A. RTE.	SECTION	COUNTY	TOTAL SHEETS	SHEET NO.
VAR	D6 MONTGOMERY CO. ADA	MONTGOMERY	24	11
			CONTRACT NO. 72J15	
ILLINOIS FED. AID PROJECT				

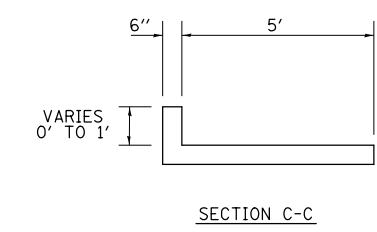
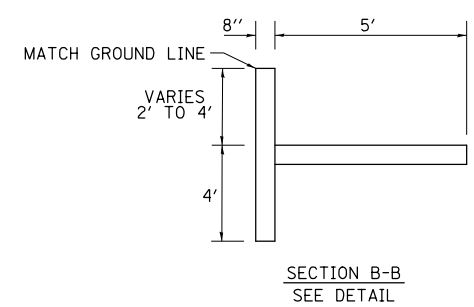
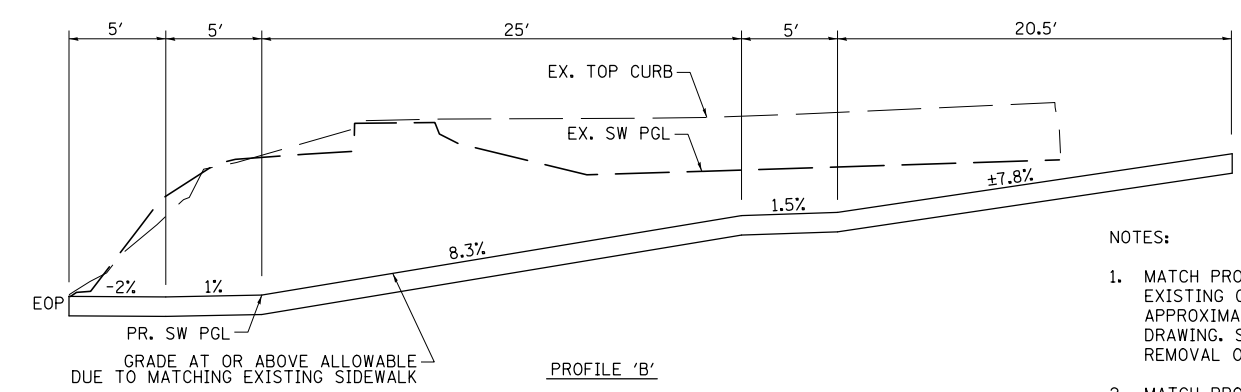
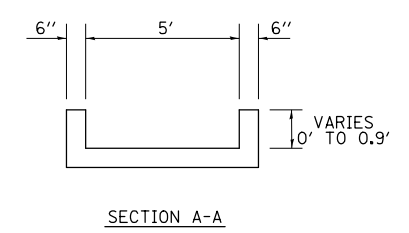
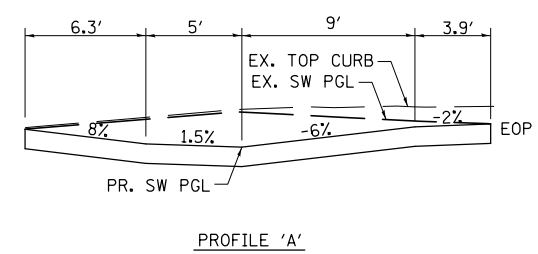
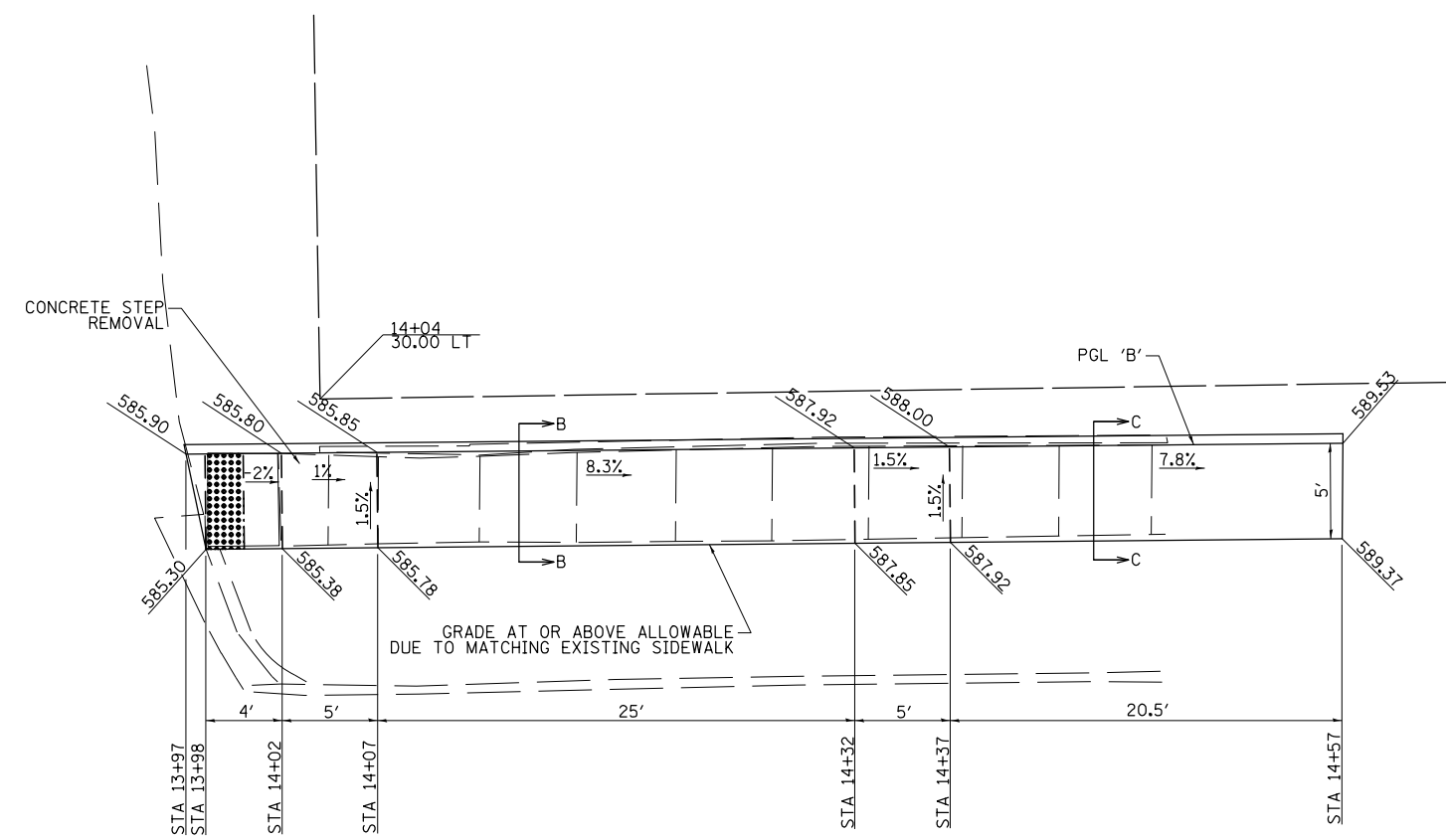
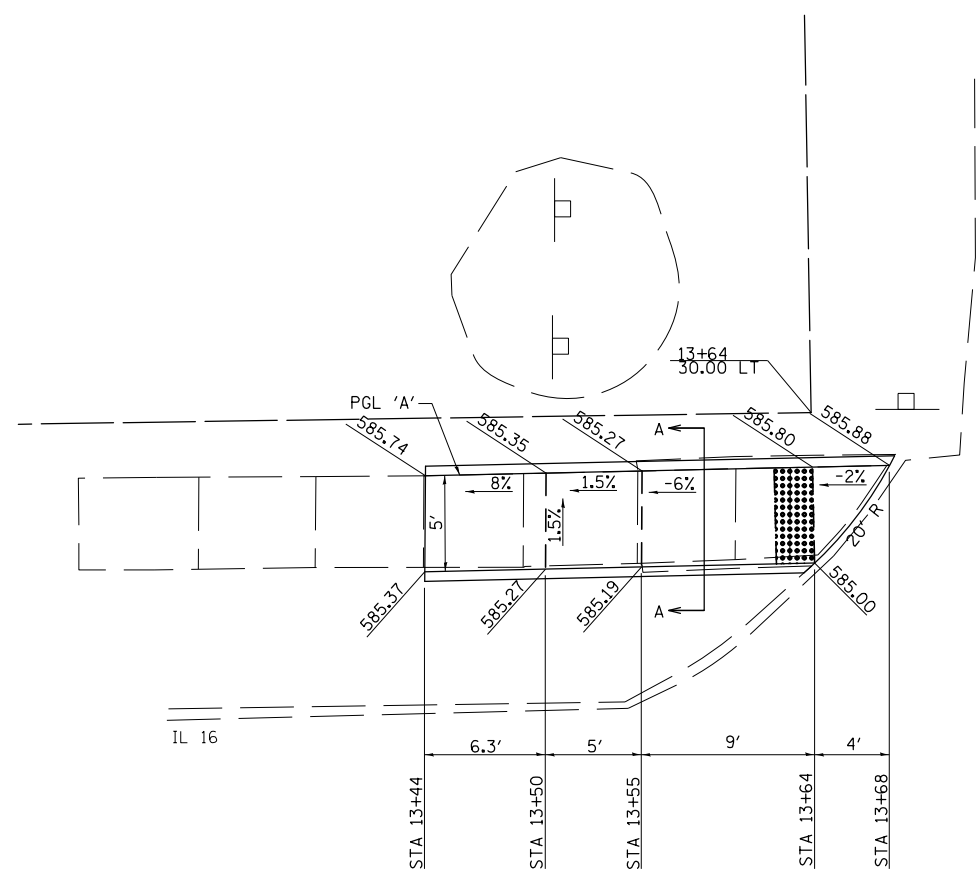
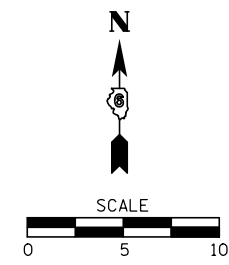

- NOTES:**
1. MATCH PROPOSED CURB & GUTTER TO EXISTING CURB AND GUTTER AT THE APPROXIMATE LOCATIONS SHOWN ON THE DRAWING. SAW CUT FULL-DEPTH FOR REMOVAL OF CURB AND GUTTER.
  2. MATCH PROPOSED SIDEWALK TO THE EXISTING SIDEWALK AT AN EXISTING JOINT. SAW CUT FULL-DEPTH FOR REMOVAL OF SIDEWALK.
  3. SEE IDOT STD. 424001 FOR DETAILS OF PERPENDICULAR CURB RAMPS FOR SIDEWALKS.
  4. STA.'S & OFFSETS ARE FROM IL RT. 16 C.
  5. ELEVATIONS SHOWN ARE TO THE TOP OF SIDEWALK UNLESS OTHERWISE NOTED.
  6. THE CONTRACTOR SHALL VERIFY EXISTING FIELD CONDITIONS PRIOR TO THE CONSTRUCTION OF ANY RAMP OR SIDEWALK. ANY ADJUSTMENTS NECESSARY TO MEET EXISTING FIELD CONDITIONS SHALL BE APPROVED BY THE ENGINEER PRIOR TO CONSTRUCTION.

FILE NAME =	USER NAME = #USER*	DESIGNED - CWG	REVISED -
#FILEL#		DRAWN - BWC	REVISED -
#MODELNAME#		CHECKED -	REVISED -
	PLOT DATE = #DATE*	DATE -	REVISED -

**STATE OF ILLINOIS  
DEPARTMENT OF TRANSPORTATION**

<b>SIDEWALK DETAILS CRITTENDON ST. &amp; IL 16</b>			
SCALE: 1"=5'	SHEET 5	OF 16 SHEETS	STA. TO STA.

F.A. RTE.	SECTION	COUNTY	TOTAL SHEETS	SHEET NO.
VAR	D6 MONTGOMERY CO. ADA	MONTGOMERY	24	12
			CONTRACT NO. 72J15	
ILLINOIS FED. AID PROJECT				

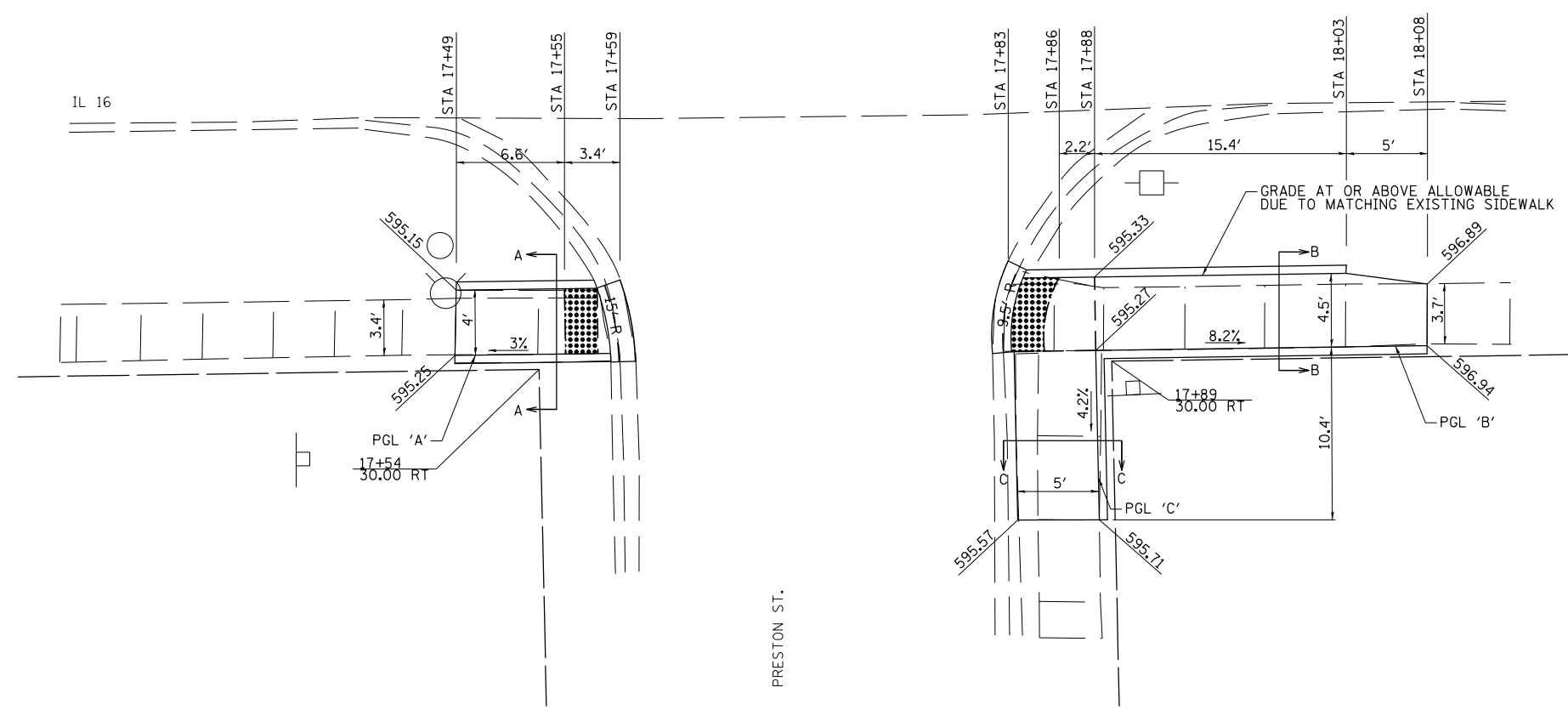
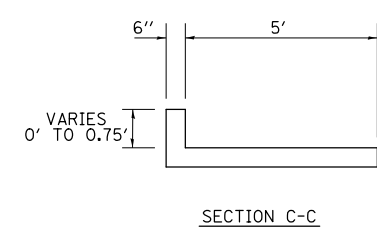
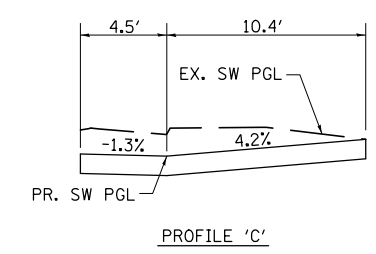
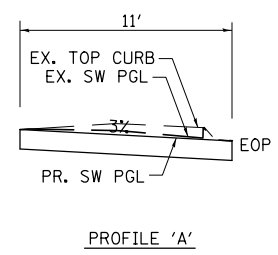
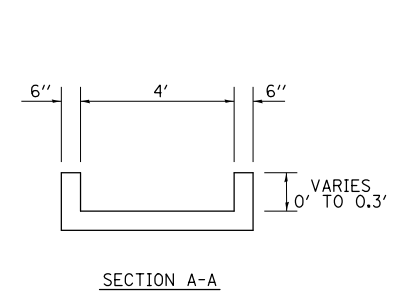
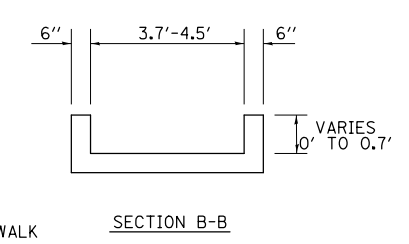
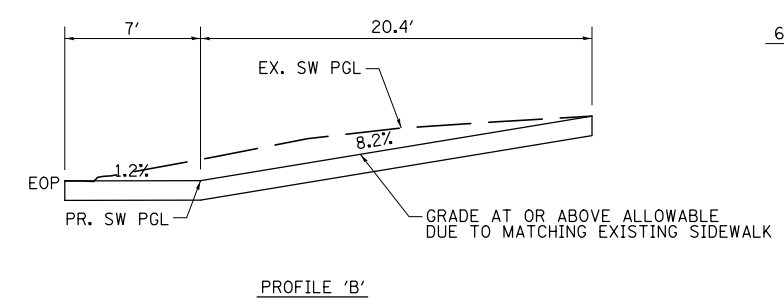
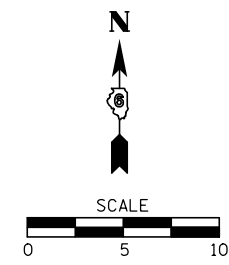

- NOTES:
1. MATCH PROPOSED CURB & GUTTER TO EXISTING CURB AND GUTTER AT THE APPROXIMATE LOCATIONS SHOWN ON THE DRAWING. SAW CUT FULL-DEPTH FOR REMOVAL OF CURB AND GUTTER.
  2. MATCH PROPOSED SIDEWALK TO THE EXISTING SIDEWALK AT AN EXISTING JOINT. SAW CUT FULL-DEPTH FOR REMOVAL OF SIDEWALK.
  3. SEE IDOT STD. 424001 FOR DETAILS OF PERPENDICULAR CURB RAMPS FOR SIDEWALKS.
  4. STA.'S & OFFSETS ARE FROM IL RT. 16  $\phi$
  5. ELEVATIONS SHOWN ARE TO THE TOP OF SIDEWALK UNLESS OTHERWISE NOTED.
  6. THE CONTRACTOR SHALL VERIFY EXISTING FIELD CONDITIONS PRIOR TO THE CONSTRUCTION OF ANY RAMP OR SIDEWALK. ANY ADJUSTMENTS NECESSARY TO MEET EXISTING FIELD CONDITIONS SHALL BE APPROVED BY THE ENGINEER PRIOR TO CONSTRUCTION.

FILE NAME =	USER NAME = *USER*	DESIGNED - CWG	REVISED -
*FILEL*		DRAWN - BWC	REVISED -
	PLOT SCALE = *SCALE*	CHECKED -	REVISED -
*MODELNAME*	PLOT DATE = *DATE*	DATE -	REVISED -

**STATE OF ILLINOIS  
DEPARTMENT OF TRANSPORTATION**

**SIDEWALK DETAILS  
PRESTON ST. & IL 16**

SCALE: 1"=5'      SHEET 6      OF 16 SHEETS      STA.      TO STA.

F.A. RTE.	SECTION	COUNTY	TOTAL SHEETS	SHEET NO.
VAR	D6 MONTGOMERY CO. ADA	MONTGOMERY	24	13
			CONTRACT NO. 72J15	
ILLINOIS FED. AID PROJECT				

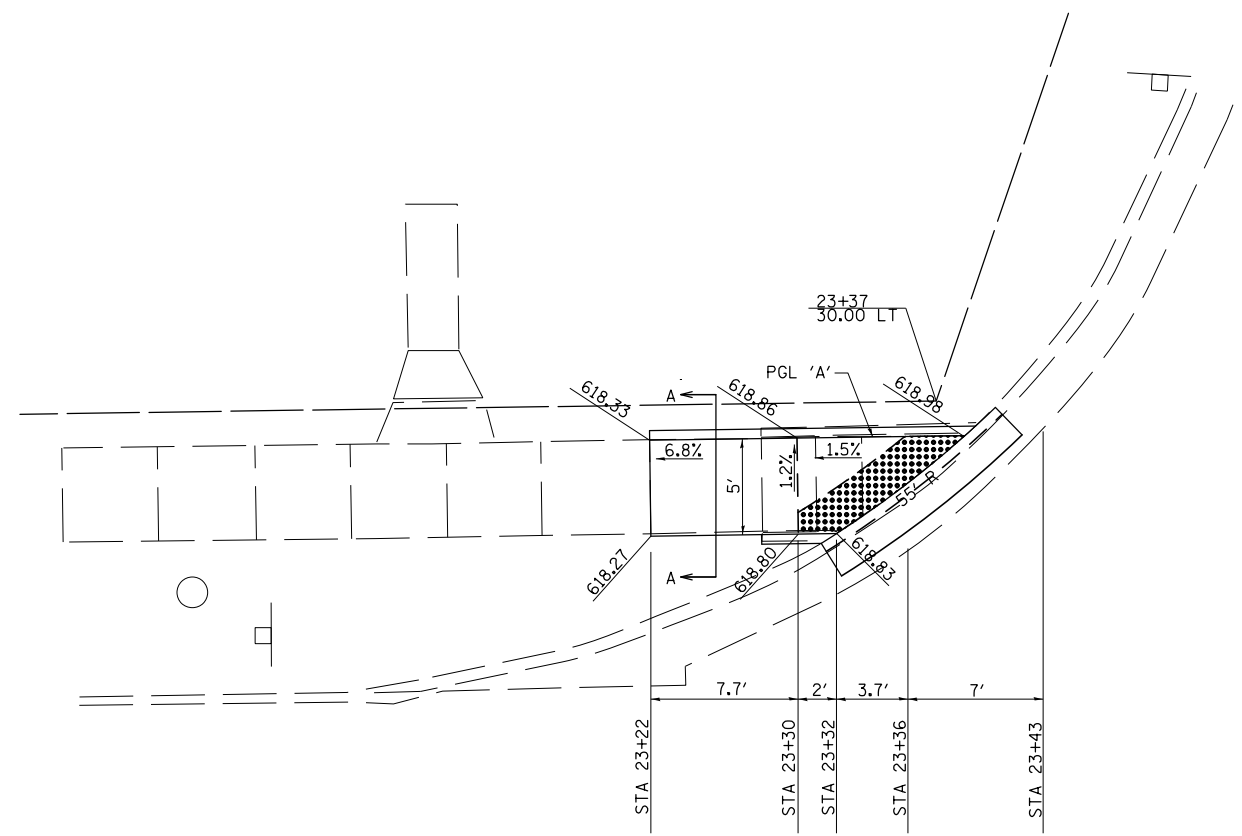
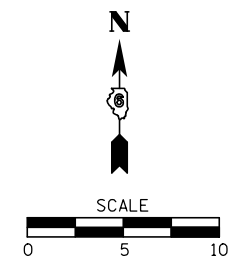

ECCLES ST.

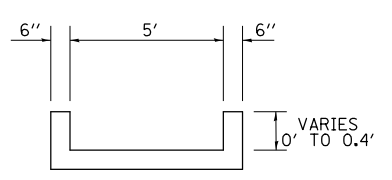
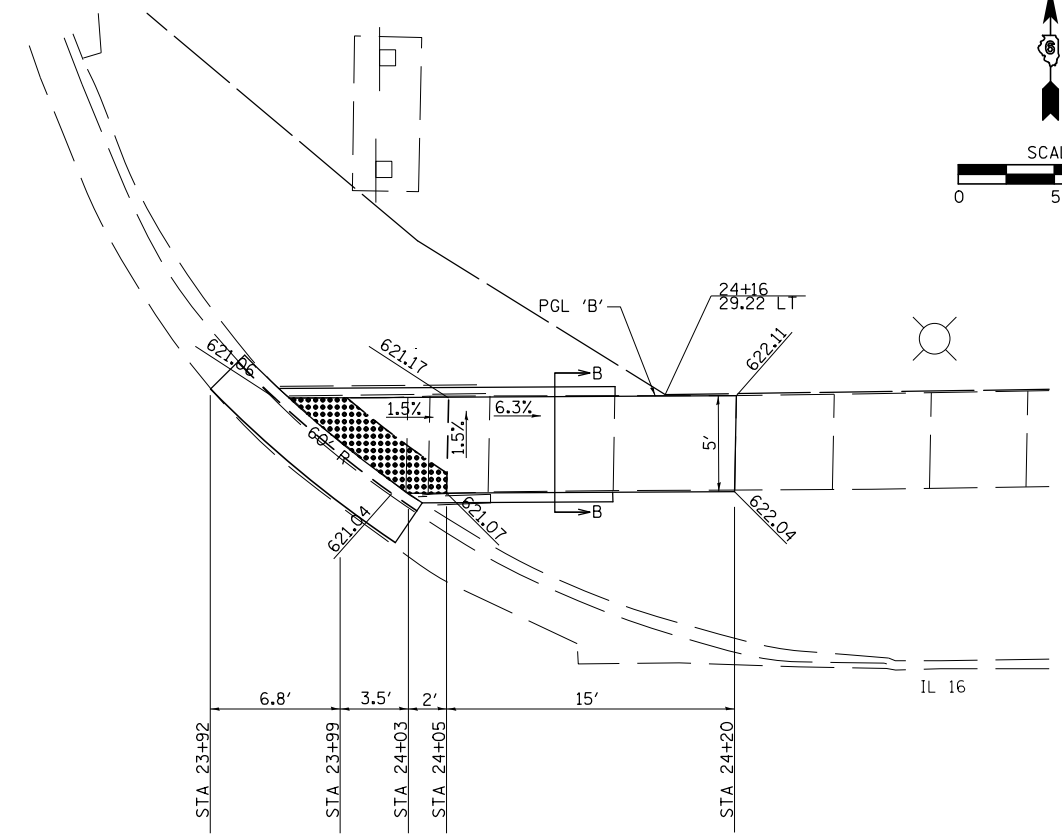

SECTION A-A

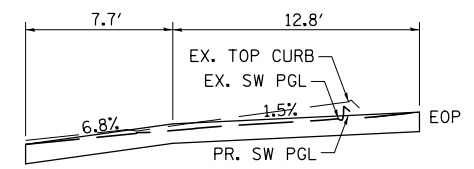

PROFILE 'A'

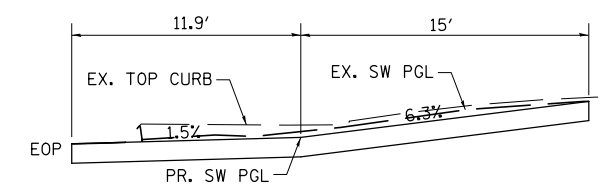

PROFILE 'B'

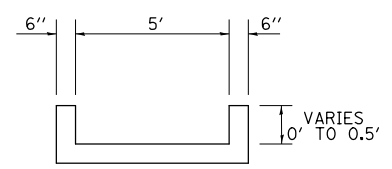

SECTION B-B

NOTES:

1. MATCH PROPOSED CURB & GUTTER TO EXISTING CURB AND GUTTER AT THE APPROXIMATE LOCATIONS SHOWN ON THE DRAWING. SAW CUT FULL-DEPTH FOR REMOVAL OF CURB AND GUTTER.
2. MATCH PROPOSED SIDEWALK TO THE EXISTING SIDEWALK AT AN EXISTING JOINT. SAW CUT FULL-DEPTH FOR REMOVAL OF SIDEWALK.
3. SEE IDOT STD. 424001 FOR DETAILS OF PERPENDICULAR CURB RAMPS FOR SIDEWALKS.
4. STA.'S & OFFSETS ARE FROM IL RT. 16 C
5. ELEVATIONS SHOWN ARE TO THE TOP OF SIDEWALK UNLESS OTHERWISE NOTED.
6. THE CONTRACTOR SHALL VERIFY EXISTING FIELD CONDITIONS PRIOR TO THE CONSTRUCTION OF ANY RAMP OR SIDEWALK. ANY ADJUSTMENTS NECESSARY TO MEET EXISTING FIELD CONDITIONS SHALL BE APPROVED BY THE ENGINEER PRIOR TO CONSTRUCTION.

FILE NAME =	USER NAME = \$USER*	DESIGNED - CWG	REVISED -
*FILEL*		DRAWN - BWC	REVISED -
	PLOT SCALE = \$SCALE*	CHECKED -	REVISED -
*MODELNAME*	PLOT DATE = \$DATE*	DATE -	REVISED -

STATE OF ILLINOIS  
DEPARTMENT OF TRANSPORTATION

SIDEWALK DETAILS  
ECCLES ST. & IL 16

SCALE: 1"=5' SHEET 7 OF 16 SHEETS STA. TO STA.

F.A. RTE.	SECTION	COUNTY	TOTAL SHEETS	SHEET NO.
VAR	D6 MONTGOMERY CO. ADA	MONTGOMERY	24	14
			CONTRACT NO. 72J15	
ILLINOIS FED. AID PROJECT				

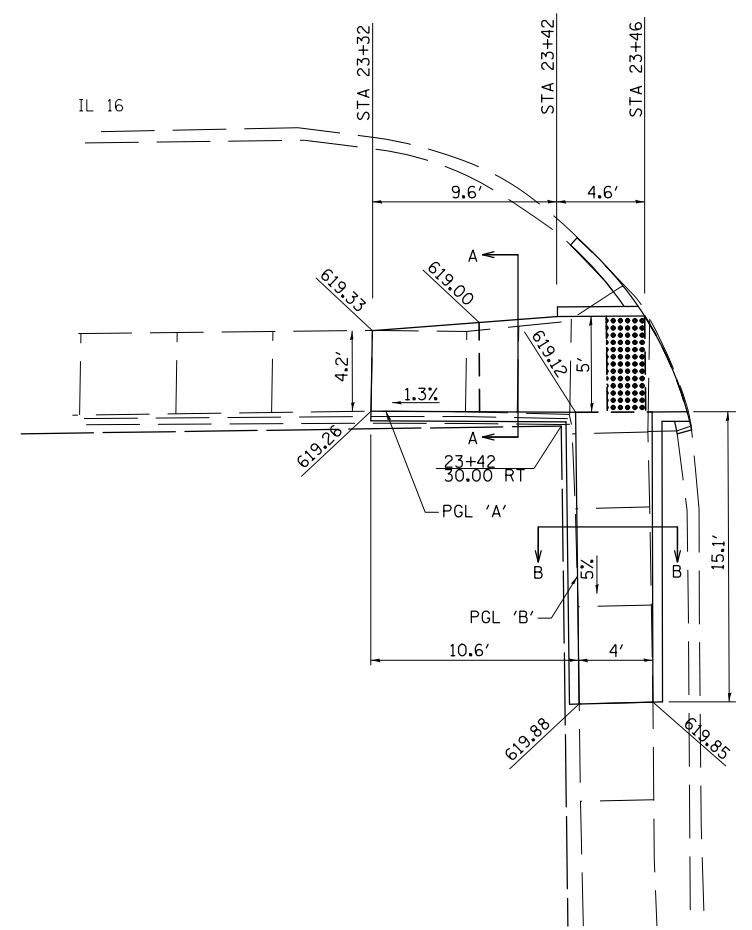
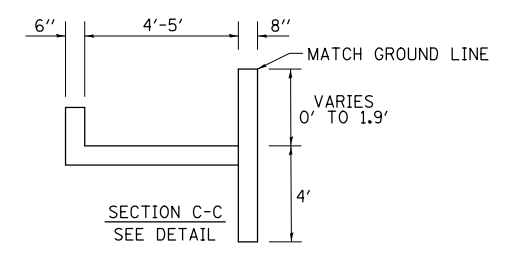
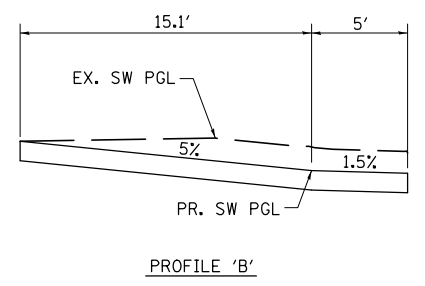
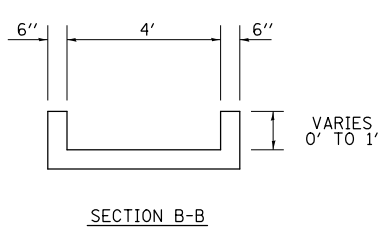
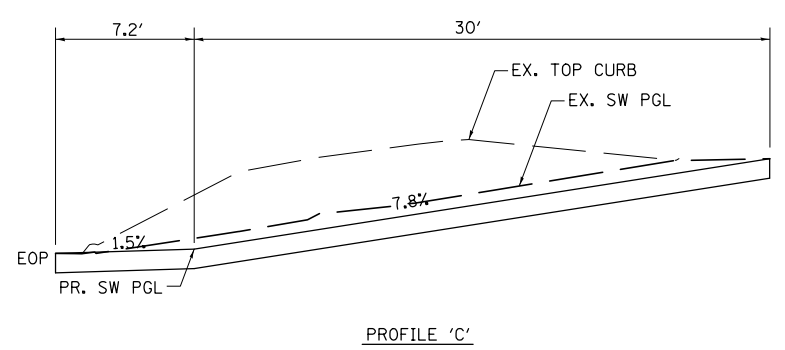
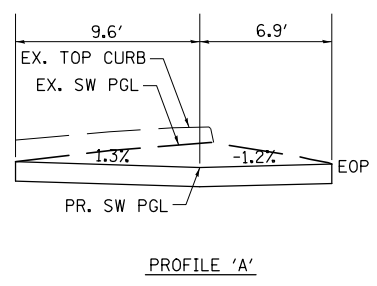
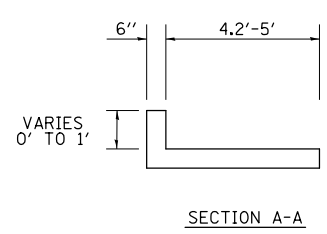
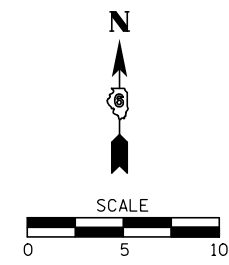

ECCLES ST.

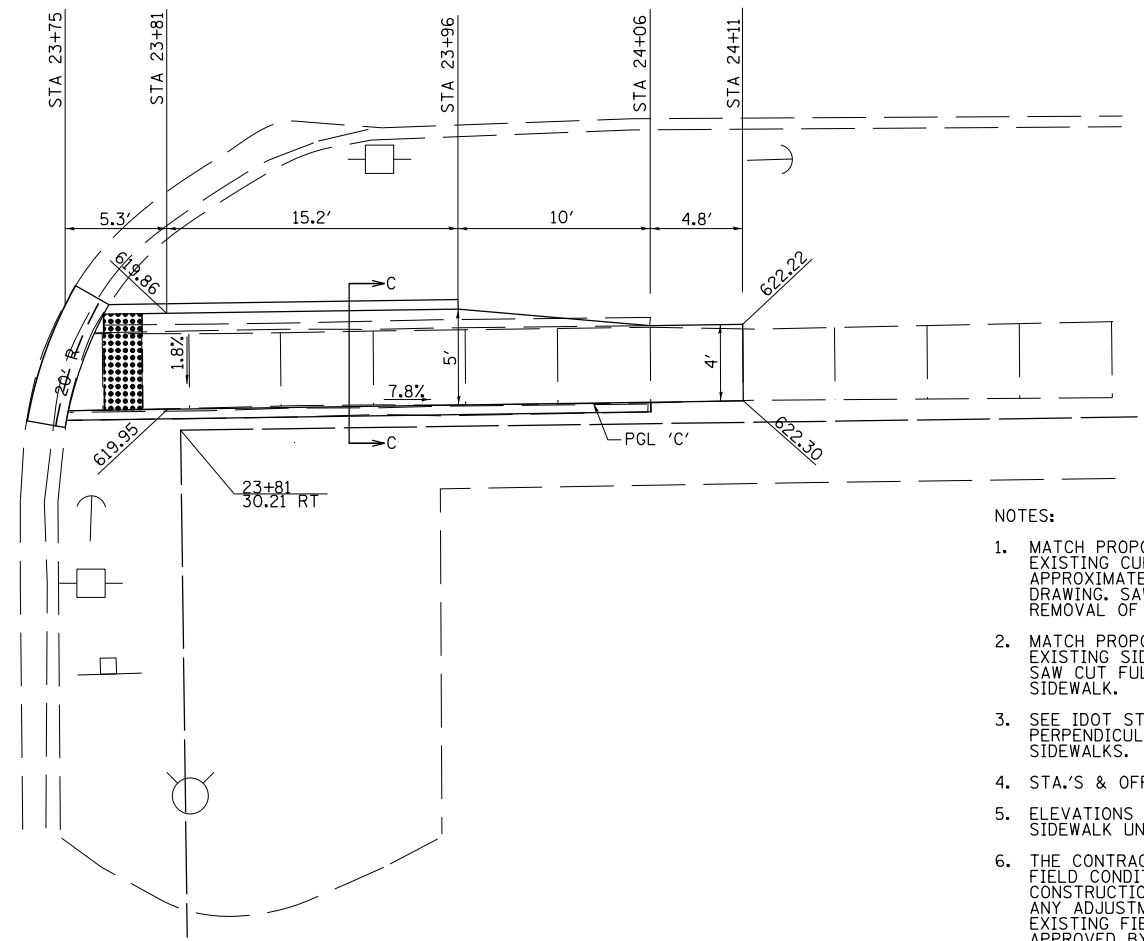

- NOTES:
1. MATCH PROPOSED CURB & GUTTER TO EXISTING CURB AND GUTTER AT THE APPROXIMATE LOCATIONS SHOWN ON THE DRAWING. SAW CUT FULL-DEPTH FOR REMOVAL OF CURB AND GUTTER.
  2. MATCH PROPOSED SIDEWALK TO THE EXISTING SIDEWALK AT AN EXISTING JOINT. SAW CUT FULL-DEPTH FOR REMOVAL OF SIDEWALK.
  3. SEE IDOT STD. 424001 FOR DETAILS OF PERPENDICULAR CURB RAMPS FOR SIDEWALKS.
  4. STA.'S & OFFSETS ARE FROM IL RT. 16  $\phi$
  5. ELEVATIONS SHOWN ARE TO THE TOP OF SIDEWALK UNLESS OTHERWISE NOTED.
  6. THE CONTRACTOR SHALL VERIFY EXISTING FIELD CONDITIONS PRIOR TO THE CONSTRUCTION OF ANY RAMP OR SIDEWALK. ANY ADJUSTMENTS NECESSARY TO MEET EXISTING FIELD CONDITIONS SHALL BE APPROVED BY THE ENGINEER PRIOR TO CONSTRUCTION.

FILE NAME =	USER NAME = *USER*	DESIGNED - CWG	REVISED -	<b>STATE OF ILLINOIS DEPARTMENT OF TRANSPORTATION</b>	<b>SIDEWALK DETAILS ECCLES ST. &amp; IL 16</b>			F.A. RTE.	SECTION	COUNTY	TOTAL SHEETS	SHEET NO.		
*FILEL*		DRAWN - BWC	REVISED -		SCALE: 1"=5'	SHEET 16	OF 25 SHEETS	STA.	TO STA.	VAR	D6 MONTGOMERY CO. ADA	MONTGOMERY	24	15
*MODELNAME*		CHECKED -	REVISED -								CONTRACT NO. 72J15			
		DATE -	REVISED -		ILLINOIS FED. AID PROJECT									

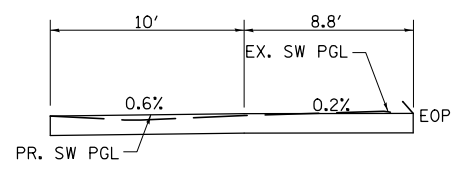
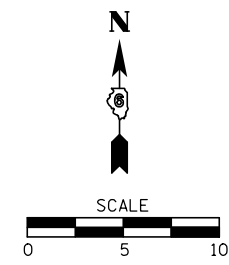

PROFILE 'A'

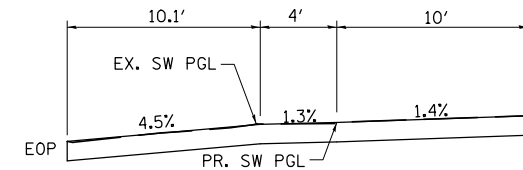

PROFILE 'B'

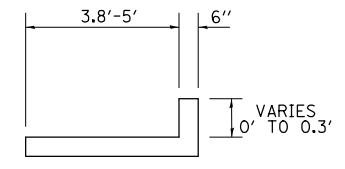

SECTION A-A

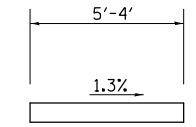

SECTION B-B

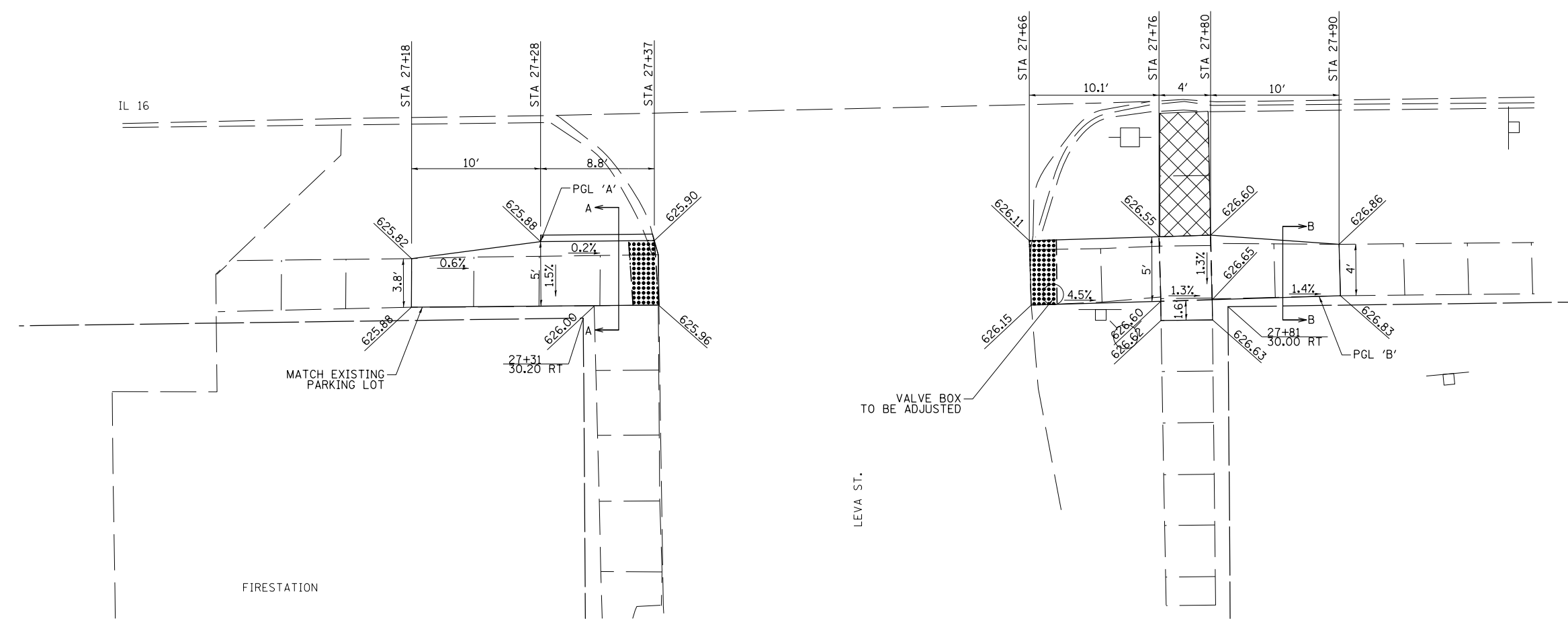

- NOTES:
1. MATCH PROPOSED CURB & GUTTER TO EXISTING CURB AND GUTTER AT THE APPROXIMATE LOCATIONS SHOWN ON THE DRAWING. SAW CUT FULL-DEPTH FOR REMOVAL OF CURB AND GUTTER.
  2. MATCH PROPOSED SIDEWALK TO THE EXISTING SIDEWALK AT AN EXISTING JOINT. SAW CUT FULL-DEPTH FOR REMOVAL OF SIDEWALK.
  3. SEE IDOT STD. 424001 FOR DETAILS OF PERPENDICULAR CURB RAMPS FOR SIDEWALKS.
  4. STA.'S & OFFSETS ARE FROM IL RT. 16  $\perp$
  5. ELEVATIONS SHOWN ARE TO THE TOP OF SIDEWALK UNLESS OTHERWISE NOTED.
  6. THE CONTRACTOR SHALL VERIFY EXISTING FIELD CONDITIONS PRIOR TO THE CONSTRUCTION OF ANY RAMP OR SIDEWALK. ANY ADJUSTMENTS NECESSARY TO MEET EXISTING FIELD CONDITIONS SHALL BE APPROVED BY THE ENGINEER PRIOR TO CONSTRUCTION.

FILE NAME =	USER NAME = \$USER*	DESIGNED - CWG	REVISED -
\$FILEL\$		DRAWN - BWC	REVISED -
\$MODELNAME\$		CHECKED -	REVISED -
	PLOT DATE = \$DATE*	DATE -	REVISED -

**STATE OF ILLINOIS  
DEPARTMENT OF TRANSPORTATION**

**SIDEWALK DETAILS  
LEVA ST. & IL 16**

SCALE: 1"=5'      SHEET 9      OF 16 SHEETS      STA.      TO STA.

F.A. RTE.	SECTION	COUNTY	TOTAL SHEETS	SHEET NO.
VAR	D6 MONTGOMERY CO. ADA	MONTGOMERY	24	16
			CONTRACT NO. 72J15	
ILLINOIS FED. AID PROJECT				



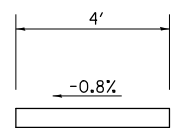

SECTION A-A

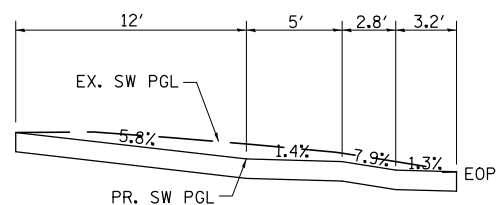

PROFILE 'A'

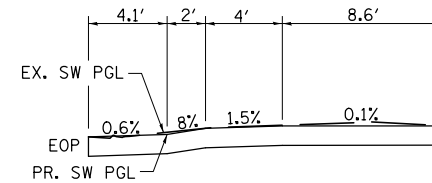

PROFILE 'C'

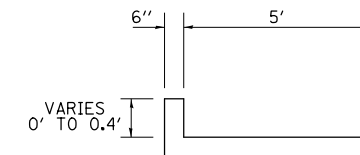

SECTION C-C

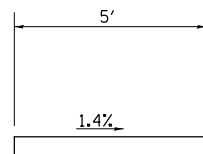
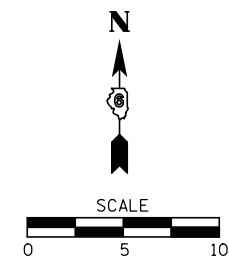

SECTION B-B

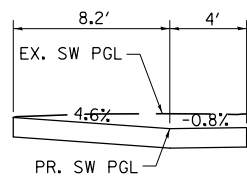

PROFILE 'B'

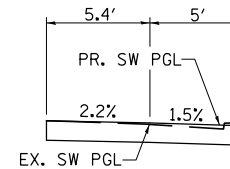

PROFILE 'D'

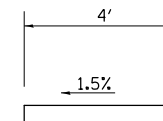

SECTION D-D

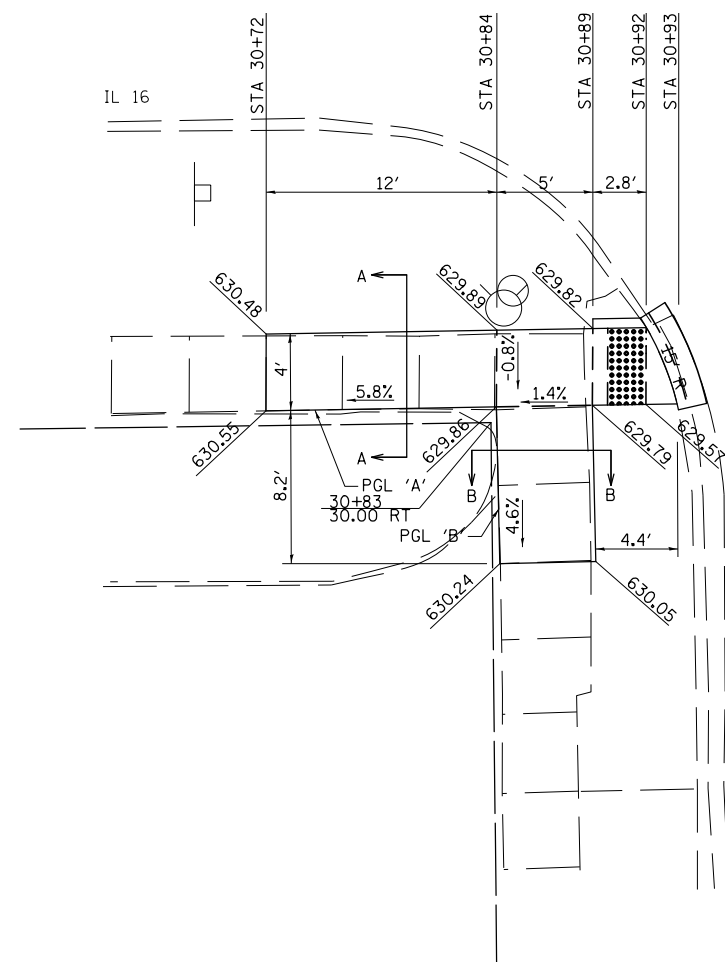

ANNA ST.

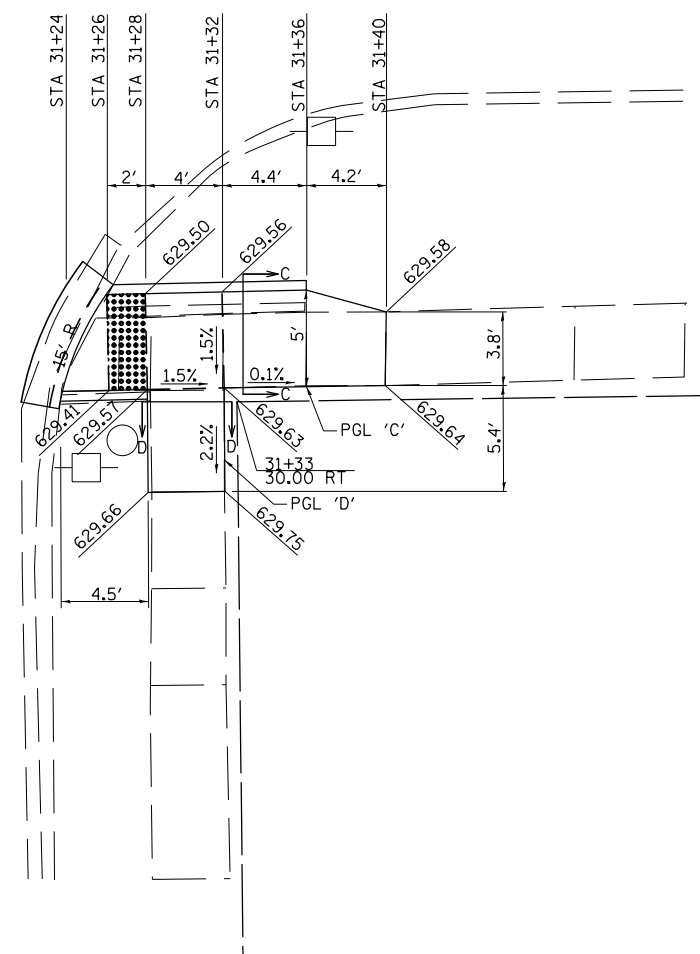

NOTES:

1. MATCH PROPOSED CURB & GUTTER TO EXISTING CURB AND GUTTER AT THE APPROXIMATE LOCATIONS SHOWN ON THE DRAWING. SAW CUT FULL-DEPTH FOR REMOVAL OF CURB AND GUTTER.
2. MATCH PROPOSED SIDEWALK TO THE EXISTING SIDEWALK AT AN EXISTING JOINT. SAW CUT FULL-DEPTH FOR REMOVAL OF SIDEWALK.
3. SEE IDOT STD. 424001 FOR DETAILS OF PERPENDICULAR CURB RAMPS FOR SIDEWALKS.
4. STA.'S & OFFSETS ARE FROM IL RT. 16  $\perp$
5. ELEVATIONS SHOWN ARE TO THE TOP OF SIDEWALK UNLESS OTHERWISE NOTED.
6. THE CONTRACTOR SHALL VERIFY EXISTING FIELD CONDITIONS PRIOR TO THE CONSTRUCTION OF ANY RAMP OR SIDEWALK. ANY ADJUSTMENTS NECESSARY TO MEET EXISTING FIELD CONDITIONS SHALL BE APPROVED BY THE ENGINEER PRIOR TO CONSTRUCTION.

FILE NAME =	USER NAME = \$USER*	DESIGNED - CWG	REVISED -
*FILEL*		DRAWN - BWC	REVISED -
	PLOT SCALE = \$SCALE*	CHECKED -	REVISED -
*MODELNAME*	PLOT DATE = \$DATE*	DATE -	REVISED -

STATE OF ILLINOIS  
DEPARTMENT OF TRANSPORTATION

SIDEWALK DETAILS  
ANNA ST. & IL 16

SCALE: 1"=5' SHEET 10 OF 16 SHEETS STA. TO STA.

F.A. RTE.	SECTION	COUNTY	TOTAL SHEETS	SHEET NO.
VAR	D6 MONTGOMERY CO. ADA	MONTGOMERY	24	17
			CONTRACT NO. 72J15	
ILLINOIS FED. AID PROJECT				

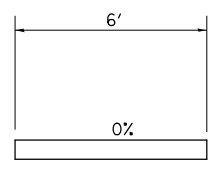
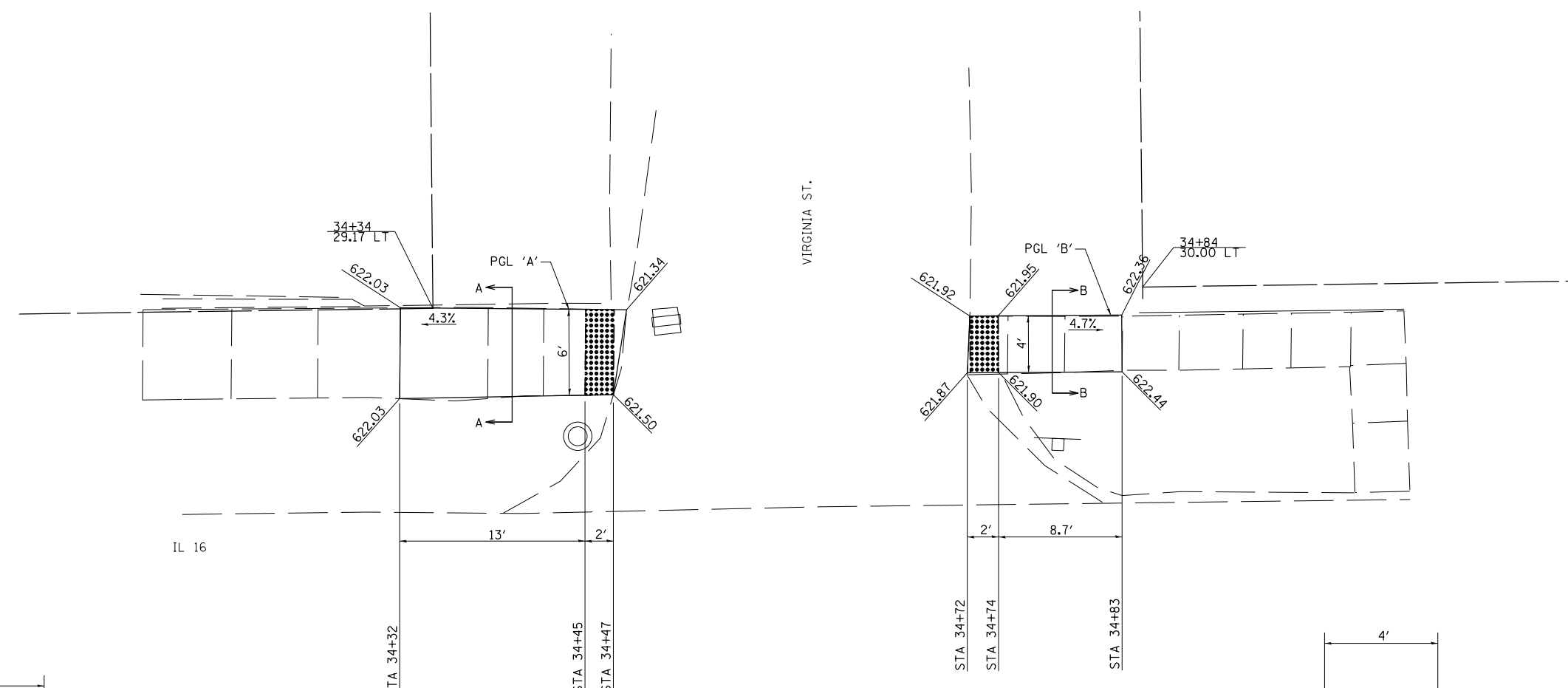
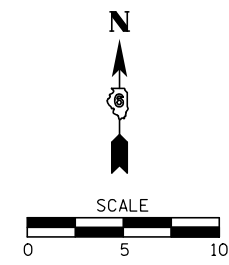

SECTION A-A

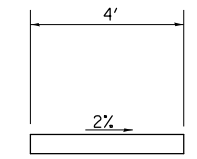

SECTION B-B

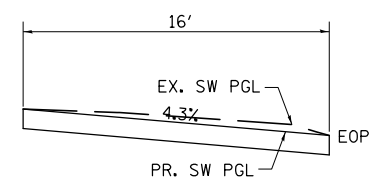

PROFILE 'A'

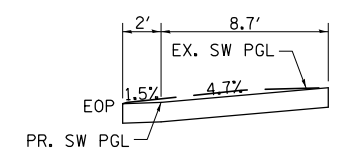

PROFILE 'B'

NOTES:

1. MATCH PROPOSED CURB & GUTTER TO EXISTING CURB AND GUTTER AT THE APPROXIMATE LOCATIONS SHOWN ON THE DRAWING. SAW CUT FULL-DEPTH FOR REMOVAL OF CURB AND GUTTER.
2. MATCH PROPOSED SIDEWALK TO THE EXISTING SIDEWALK AT AN EXISTING JOINT. SAW CUT FULL-DEPTH FOR REMOVAL OF SIDEWALK.
3. SEE IDOT STD. 424001 FOR DETAILS OF PERPENDICULAR CURB RAMPS FOR SIDEWALKS.
4. STA.'S & OFFSETS ARE FROM IL RT. 16 C
5. ELEVATIONS SHOWN ARE TO THE TOP OF SIDEWALK UNLESS OTHERWISE NOTED.
6. THE CONTRACTOR SHALL VERIFY EXISTING FIELD CONDITIONS PRIOR TO THE CONSTRUCTION OF ANY RAMP OR SIDEWALK. ANY ADJUSTMENTS NECESSARY TO MEET EXISTING FIELD CONDITIONS SHALL BE APPROVED BY THE ENGINEER PRIOR TO CONSTRUCTION.

FILE NAME =	USER NAME = \$USER*	DESIGNED - CWG	REVISED -
*FILEL*		DRAWN - BWC	REVISED -
	PLOT SCALE = \$SCALE*	CHECKED -	REVISED -
*MODELNAME*	PLOT DATE = \$DATE*	DATE -	REVISED -

**STATE OF ILLINOIS  
DEPARTMENT OF TRANSPORTATION**

**SIDEWALK DETAILS  
VIRGINIA ST. & IL 16**

SCALE: 1"=5'      SHEET 11 OF 16 SHEETS      STA.      TO STA.

F.A. RTE.	SECTION	COUNTY	TOTAL SHEETS	SHEET NO.
VAR	D6 MONTGOMERY CO. ADA	MONTGOMERY	24	18
			CONTRACT NO. 72J15	
ILLINOIS FED. AID PROJECT				

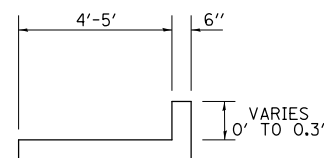

SECTION A-A

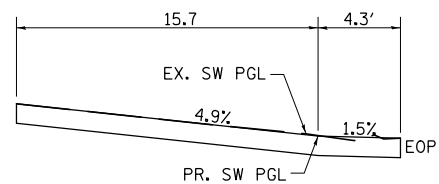

PROFILE 'A'

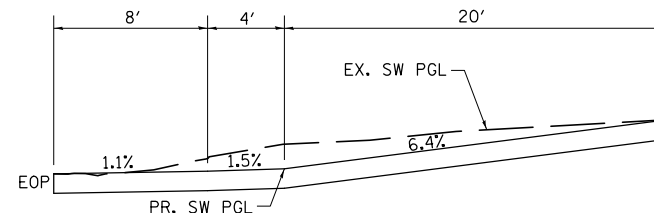

PROFILE 'B'

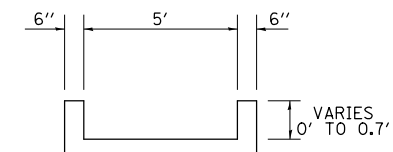

SECTION B-B

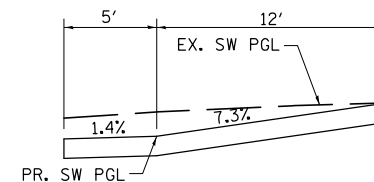

PROFILE 'C'

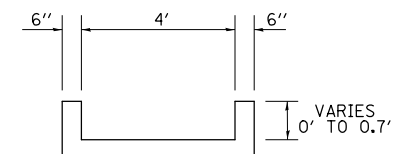

SECTION C-C

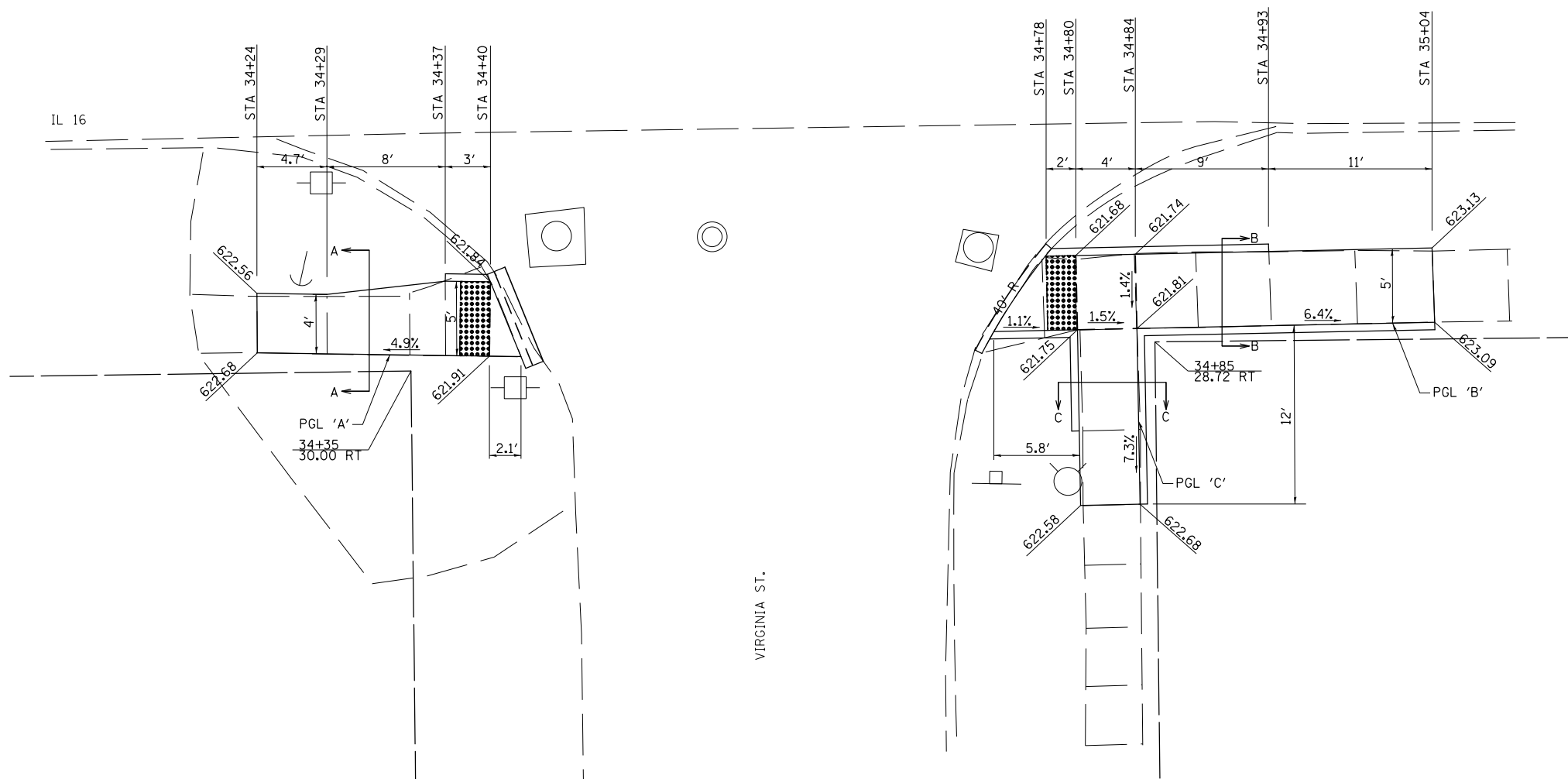
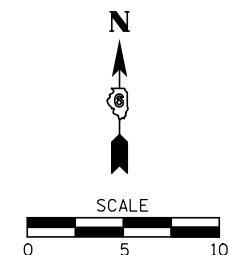

- NOTES:
1. MATCH PROPOSED CURB & GUTTER TO EXISTING CURB AND GUTTER AT THE APPROXIMATE LOCATIONS SHOWN ON THE DRAWING. SAW CUT FULL-DEPTH FOR REMOVAL OF CURB AND GUTTER.
  2. MATCH PROPOSED SIDEWALK TO THE EXISTING SIDEWALK AT AN EXISTING JOINT. SAW CUT FULL-DEPTH FOR REMOVAL OF SIDEWALK.
  3. SEE IDOT STD. 424001 FOR DETAILS OF PERPENDICULAR CURB RAMPS FOR SIDEWALKS.
  4. STA.'S & OFFSETS ARE FROM IL RT. 16  $\nabla$
  5. ELEVATIONS SHOWN ARE TO THE TOP OF SIDEWALK UNLESS OTHERWISE NOTED.
  6. THE CONTRACTOR SHALL VERIFY EXISTING FIELD CONDITIONS PRIOR TO THE CONSTRUCTION OF ANY RAMP OR SIDEWALK. ANY ADJUSTMENTS NECESSARY TO MEET EXISTING FIELD CONDITIONS SHALL BE APPROVED BY THE ENGINEER PRIOR TO CONSTRUCTION.

FILE NAME =	USER NAME = *USER*	DESIGNED - CWG	REVISED -
*FILEL*		DRAWN - BWC	REVISED -
	PLOT SCALE = *SCALE*	CHECKED -	REVISED -
*MODELNAME*	PLOT DATE = *DATE*	DATE -	REVISED -

STATE OF ILLINOIS  
DEPARTMENT OF TRANSPORTATION

SIDEWALK DETAILS  
VIRGINIA ST. & IL 16

SCALE: 1"=5' SHEET 12 OF 16 SHEETS STA. TO STA.

F.A. RTE.	SECTION	COUNTY	TOTAL SHEETS	SHEET NO.
VAR	D6 MONTGOMERY CO. ADA	MONTGOMERY	24	19
			CONTRACT NO. 72J15	
ILLINOIS FED. AID PROJECT				

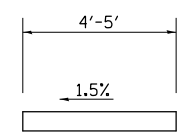
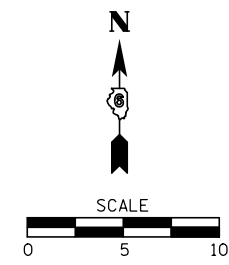

SECTION A-A

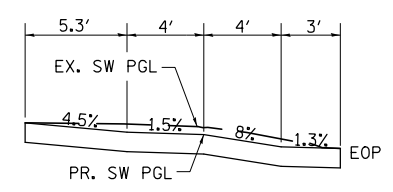

PROFILE 'A'

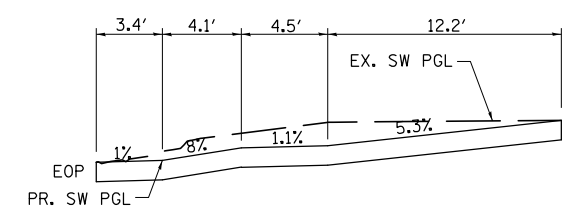

PROFILE 'C'

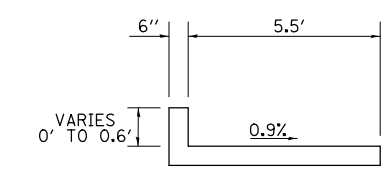

SECTION C-C

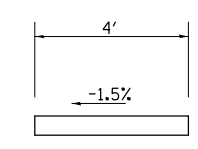

SECTION B-B

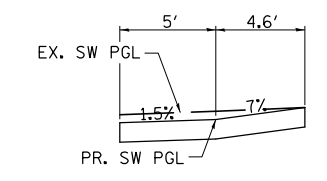

PROFILE 'B'

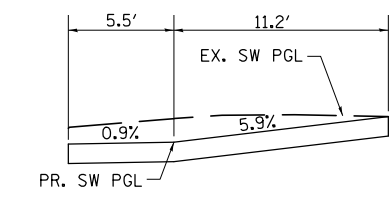

PROFILE 'D'

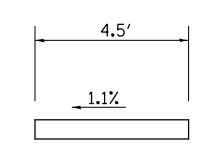

SECTION D-D

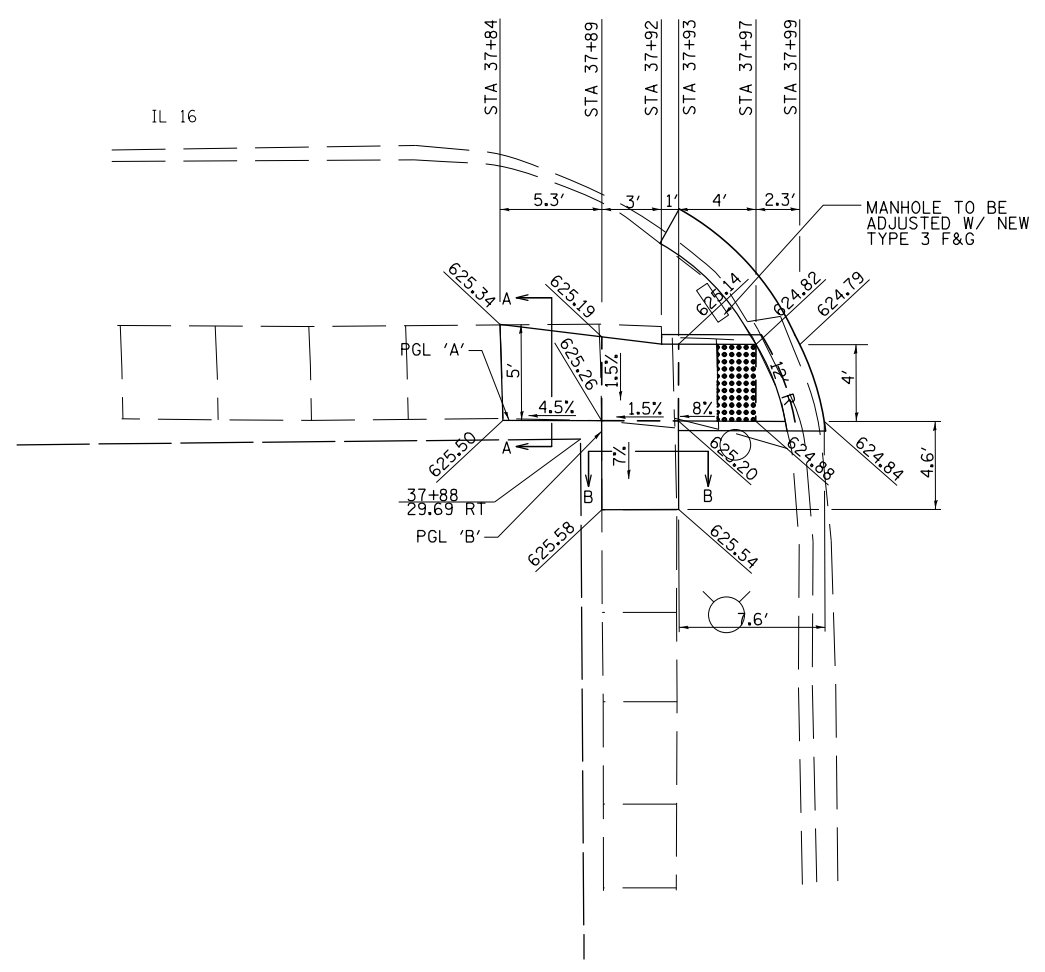

PARK ST.

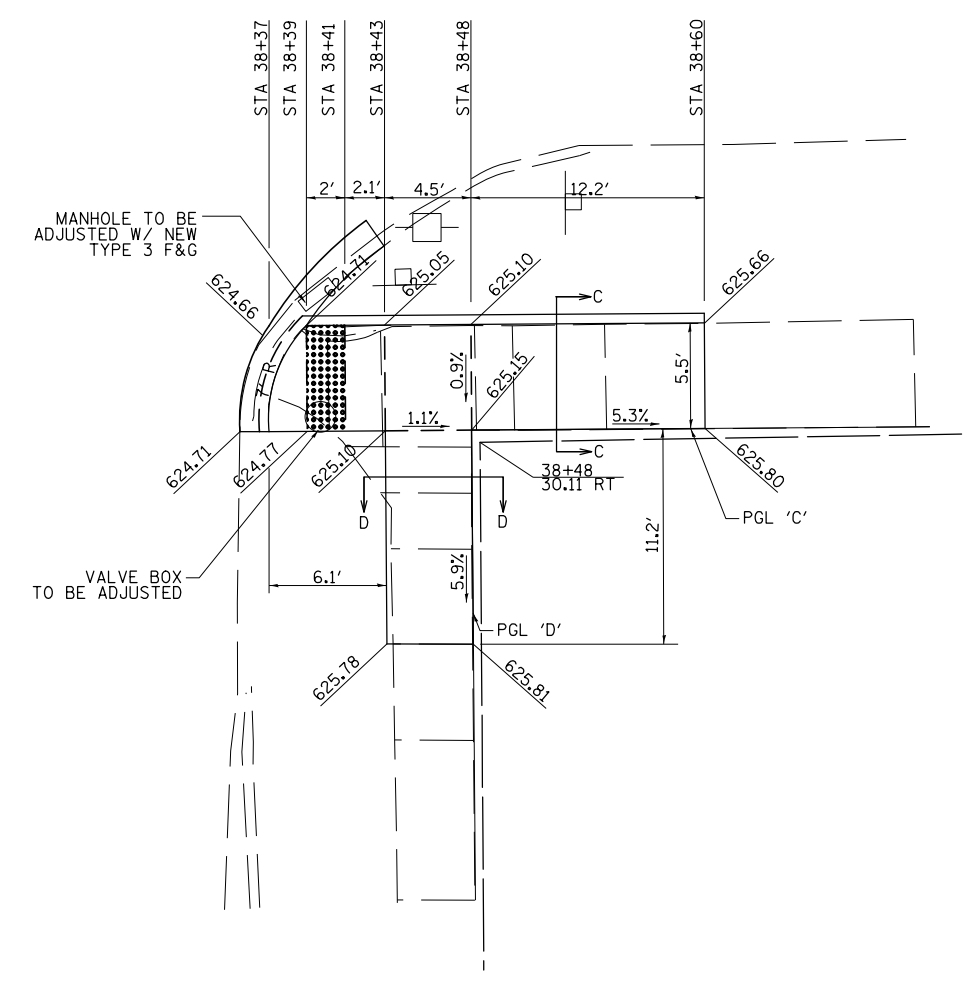

NOTES:

1. MATCH PROPOSED CURB & GUTTER TO EXISTING CURB AND GUTTER AT THE APPROXIMATE LOCATIONS SHOWN ON THE DRAWING. SAW CUT FULL-DEPTH FOR REMOVAL OF CURB AND GUTTER.
2. MATCH PROPOSED SIDEWALK TO THE EXISTING SIDEWALK AT AN EXISTING JOINT. SAW CUT FULL-DEPTH FOR REMOVAL OF SIDEWALK.
3. SEE IDOT STD. 424001 FOR DETAILS OF PERPENDICULAR CURB RAMP FOR SIDEWALKS.
4. STA.'S & OFFSETS ARE FROM IL RT. 16  $\perp$
5. ELEVATIONS SHOWN ARE TO THE TOP OF SIDEWALK UNLESS OTHERWISE NOTED.
6. THE CONTRACTOR SHALL VERIFY EXISTING FIELD CONDITIONS PRIOR TO THE CONSTRUCTION OF ANY RAMP OR SIDEWALK. ANY ADJUSTMENTS NECESSARY TO MEET EXISTING FIELD CONDITIONS SHALL BE APPROVED BY THE ENGINEER PRIOR TO CONSTRUCTION.

FILE NAME =	USER NAME = *USER*	DESIGNED - CWG	REVISED -
*FILEL*		DRAWN - BWC	REVISED -
*MODELNAME*		CHECKED -	REVISED -
	PLOT DATE = *DATE*	DATE -	REVISED -

STATE OF ILLINOIS  
DEPARTMENT OF TRANSPORTATION

SIDEWALK DETAILS  
PARK ST. & IL 16

SCALE: 1"=5' SHEET 13 OF 16 SHEETS STA. TO STA.

F.A. RTE.	SECTION	COUNTY	TOTAL SHEETS	SHEET NO.
VAR D6	MONTGOMERY CO. ADA	MONTGOMERY	24	20
			CONTRACT NO. 72J15	
ILLINOIS FED. AID PROJECT				

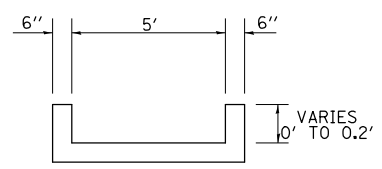
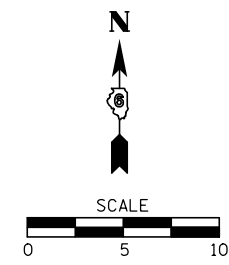

SECTION A-A

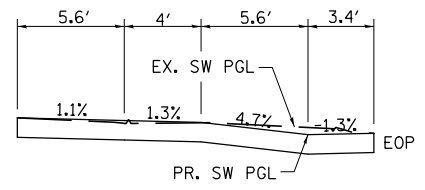

PROFILE 'A'

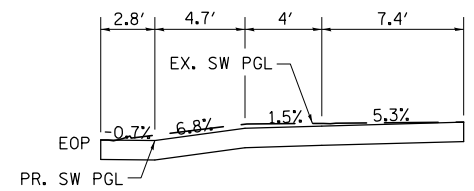

PROFILE 'C'

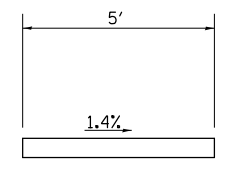

SECTION C-C

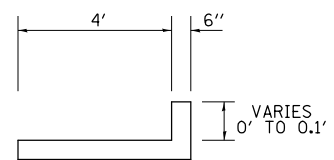

SECTION B-B

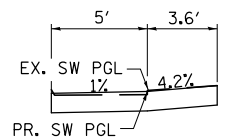

PROFILE 'B'

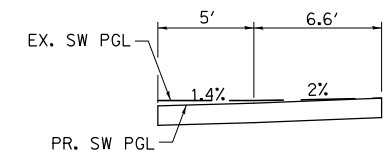

PROFILE 'D'

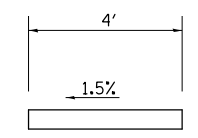

SECTION D-D

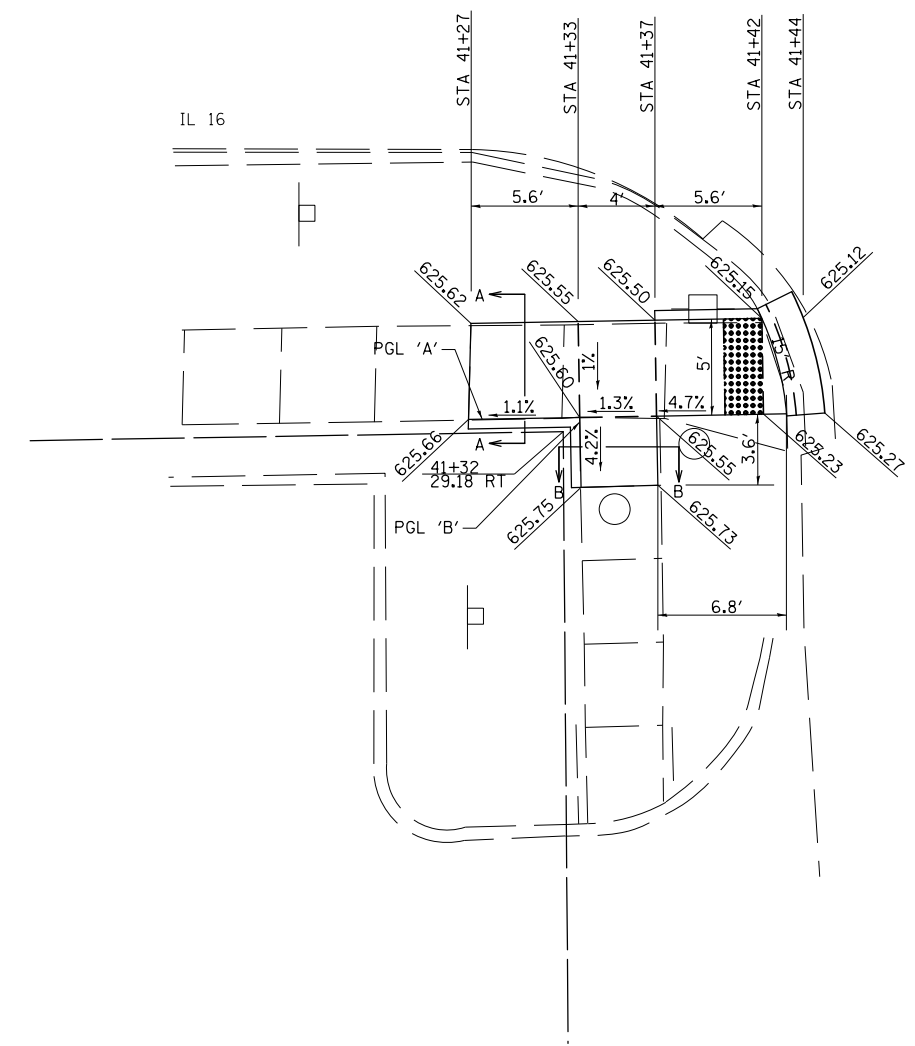

BEAL ST.

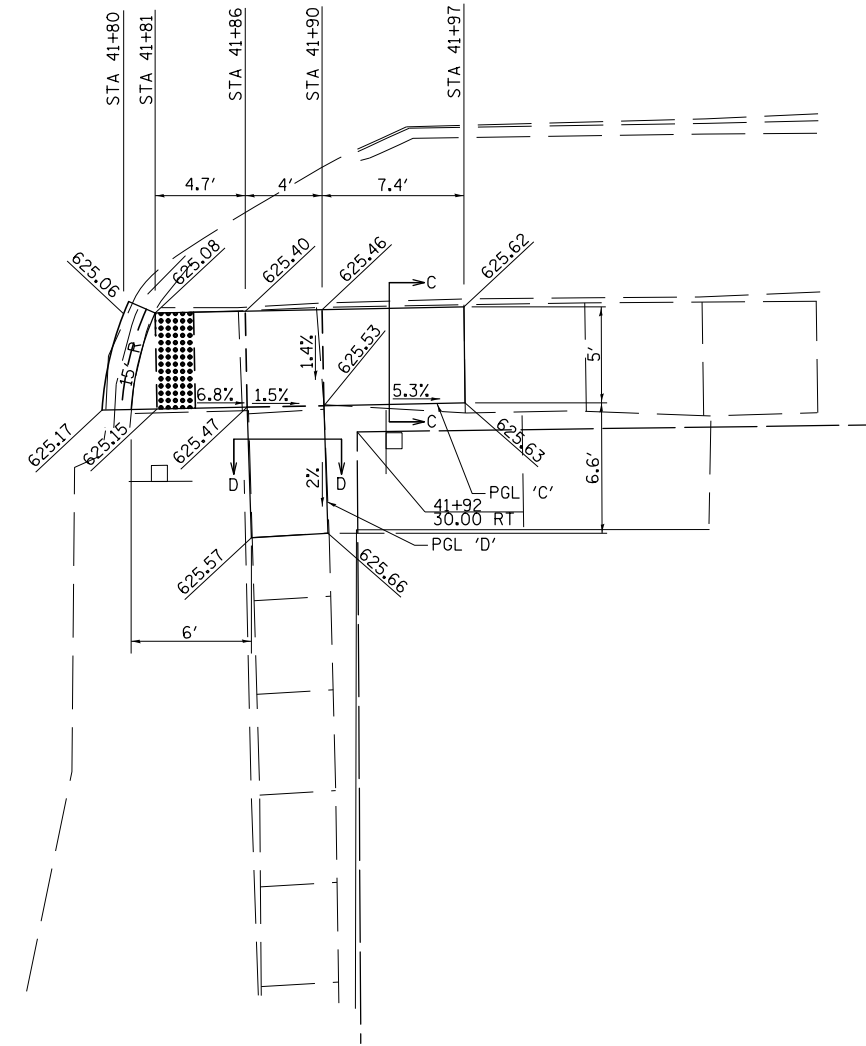

- NOTES:
1. MATCH PROPOSED CURB & GUTTER TO EXISTING CURB AND GUTTER AT THE APPROXIMATE LOCATIONS SHOWN ON THE DRAWING. SAW CUT FULL-DEPTH FOR REMOVAL OF CURB AND GUTTER.
  2. MATCH PROPOSED SIDEWALK TO THE EXISTING SIDEWALK AT AN EXISTING JOINT. SAW CUT FULL-DEPTH FOR REMOVAL OF SIDEWALK.
  3. SEE IDOT STD. 424001 FOR DETAILS OF PERPENDICULAR CURB RAMPS FOR SIDEWALKS.
  4. STA.'S & OFFSETS ARE FROM IL RT. 16  $\phi$
  5. ELEVATIONS SHOWN ARE TO THE TOP OF SIDEWALK UNLESS OTHERWISE NOTED.
  6. THE CONTRACTOR SHALL VERIFY EXISTING FIELD CONDITIONS PRIOR TO THE CONSTRUCTION OF ANY RAMP OR SIDEWALK. ANY ADJUSTMENTS NECESSARY TO MEET EXISTING FIELD CONDITIONS SHALL BE APPROVED BY THE ENGINEER PRIOR TO CONSTRUCTION.

FILE NAME =	USER NAME = \$USER*	DESIGNED - CWG	REVISED -
*FILEL*		DRAWN - BWC	REVISED -
	PLOT SCALE = \$SCALE*	CHECKED -	REVISED -
*MODELNAME*	PLOT DATE = \$DATE*	DATE -	REVISED -

STATE OF ILLINOIS  
DEPARTMENT OF TRANSPORTATION

SIDEWALK DETAILS  
BEAL ST. & IL 16

SCALE: 1"=5' SHEET 14 OF 16 SHEETS STA. TO STA.

F.A. RTE.	SECTION	COUNTY	TOTAL SHEETS	SHEET NO.
VAR	D6 MONTGOMERY CO. ADA	MONTGOMERY	24	21
			CONTRACT NO. 72J15	
ILLINOIS FED. AID PROJECT				

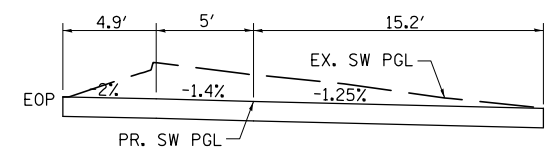
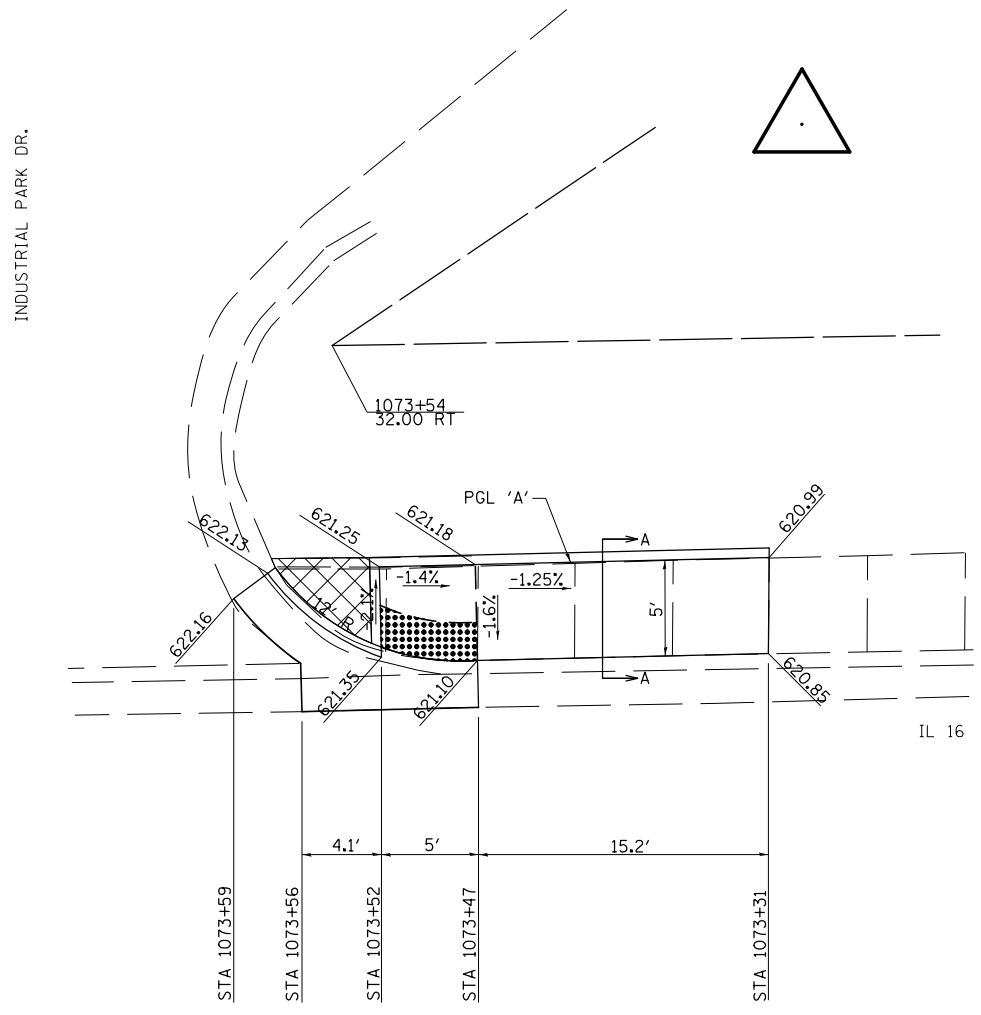
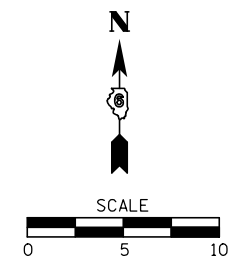

PROFILE 'A'

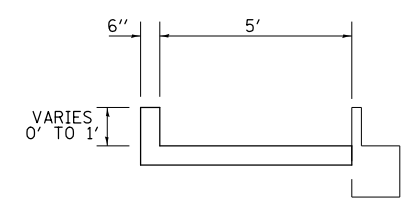

SECTION A-A

NOTES:

1. MATCH PROPOSED CURB & GUTTER TO EXISTING CURB AND GUTTER AT THE APPROXIMATE LOCATIONS SHOWN ON THE DRAWING. SAW CUT FULL-DEPTH FOR REMOVAL OF CURB AND GUTTER.
2. MATCH PROPOSED SIDEWALK TO THE EXISTING SIDEWALK AT AN EXISTING JOINT. SAW CUT FULL-DEPTH FOR REMOVAL OF SIDEWALK.
3. SEE IDOT STD. 424001 FOR DETAILS OF PERPENDICULAR CURB RAMPS FOR SIDEWALKS.
4. STA.'S & OFFSETS ARE FROM IL RT. 16 C
5. ELEVATIONS SHOWN ARE TO THE TOP OF SIDEWALK UNLESS OTHERWISE NOTED.
6. THE CONTRACTOR SHALL VERIFY EXISTING FIELD CONDITIONS PRIOR TO THE CONSTRUCTION OF ANY RAMP OR SIDEWALK. ANY ADJUSTMENTS NECESSARY TO MEET EXISTING FIELD CONDITIONS SHALL BE APPROVED BY THE ENGINEER PRIOR TO CONSTRUCTION.

FILE NAME =	USER NAME = \$USER*	DESIGNED - CWG	REVISED -	<b>STATE OF ILLINOIS DEPARTMENT OF TRANSPORTATION</b>	<b>SIDEWALK DETAILS INDUSTRIAL PARK DR. &amp; IL 16</b>	F.A. RTE.	SECTION	COUNTY	TOTAL SHEETS	SHEET NO.	
*FILEL\$		DRAWN - BWC	REVISED -			VAR	D6 MONTGOMERY CO. ADA	MONTGOMERY	24	22	
*MODELNAME\$		CHECKED -	REVISED -			CONTRACT NO. 72J15					
		DATE -	REVISED -			ILLINOIS FED. AID PROJECT					
				SCALE: 1"=5'		SHEET 15 OF 16 SHEETS		STA.		TO STA.	

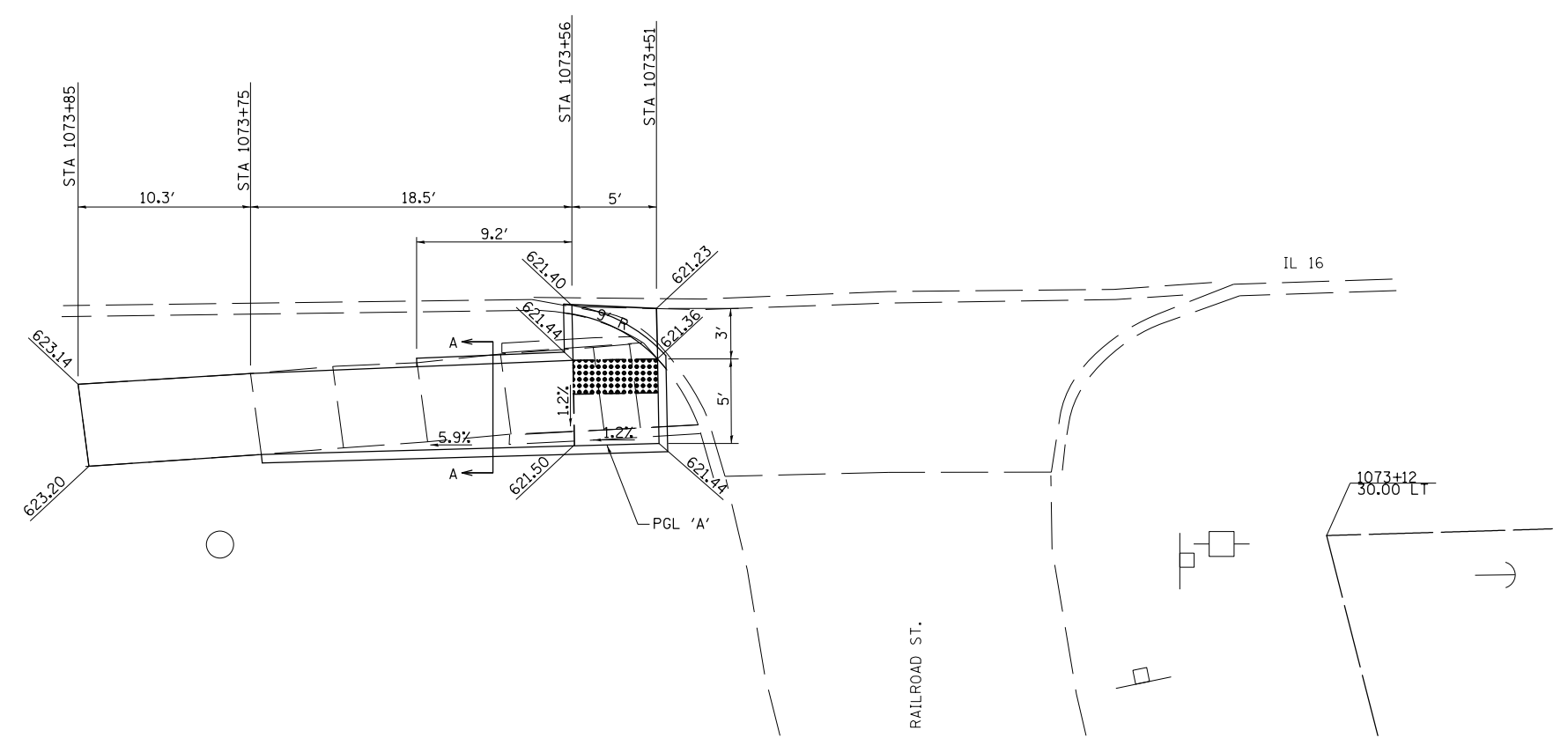
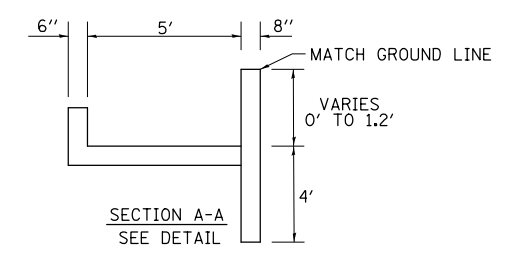
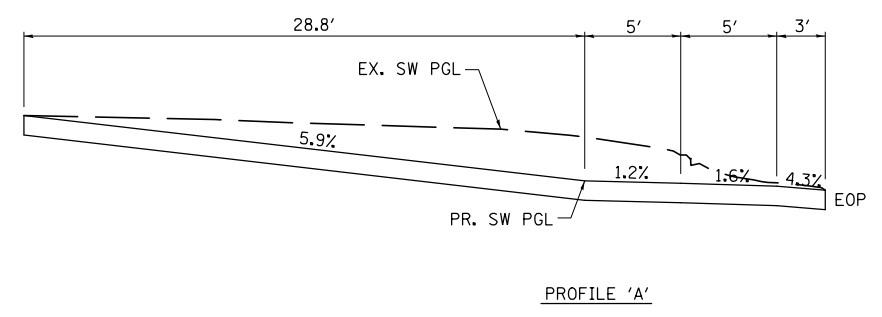
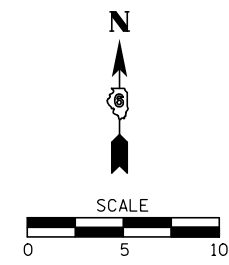

- NOTES:
1. MATCH PROPOSED CURB & GUTTER TO EXISTING CURB AND GUTTER AT THE APPROXIMATE LOCATIONS SHOWN ON THE DRAWING. SAW CUT FULL-DEPTH FOR REMOVAL OF CURB AND GUTTER.
  2. MATCH PROPOSED SIDEWALK TO THE EXISTING SIDEWALK AT AN EXISTING JOINT. SAW CUT FULL-DEPTH FOR REMOVAL OF SIDEWALK.
  3. SEE IDOT STD. 424001 FOR DETAILS OF PERPENDICULAR CURB RAMPS FOR SIDEWALKS.
  4. STA.'S & OFFSETS ARE FROM IL RT. 16  $\perp$
  5. ELEVATIONS SHOWN ARE TO THE TOP OF SIDEWALK UNLESS OTHERWISE NOTED.
  6. THE CONTRACTOR SHALL VERIFY EXISTING FIELD CONDITIONS PRIOR TO THE CONSTRUCTION OF ANY RAMP OR SIDEWALK. ANY ADJUSTMENTS NECESSARY TO MEET EXISTING FIELD CONDITIONS SHALL BE APPROVED BY THE ENGINEER PRIOR TO CONSTRUCTION.

FILE NAME =	USER NAME = \$USER*	DESIGNED - CWG	REVISED -	<b>STATE OF ILLINOIS DEPARTMENT OF TRANSPORTATION</b>	<b>SIDEWALK DETAILS RAILROAD ST. &amp; IL 16</b>				F.A. RTE.	SECTION	COUNTY	TOTAL SHEETS	SHEET NO.
*FILEL*		DRAWN - BWC	REVISED -		VAR	D6 MONTGOMERY CO. ADA	MONTGOMERY	24	23				
*MODELNAME*	PLOT SCALE = \$SCALE*	CHECKED -	REVISED -		SCALE: 1"=5'    SHEET 16 OF 16 SHEETS    STA.    TO STA.				CONTRACT NO. 72J15				
	PLOT DATE = \$DATE*	DATE -	REVISED -		ILLINOIS FED. AID PROJECT								

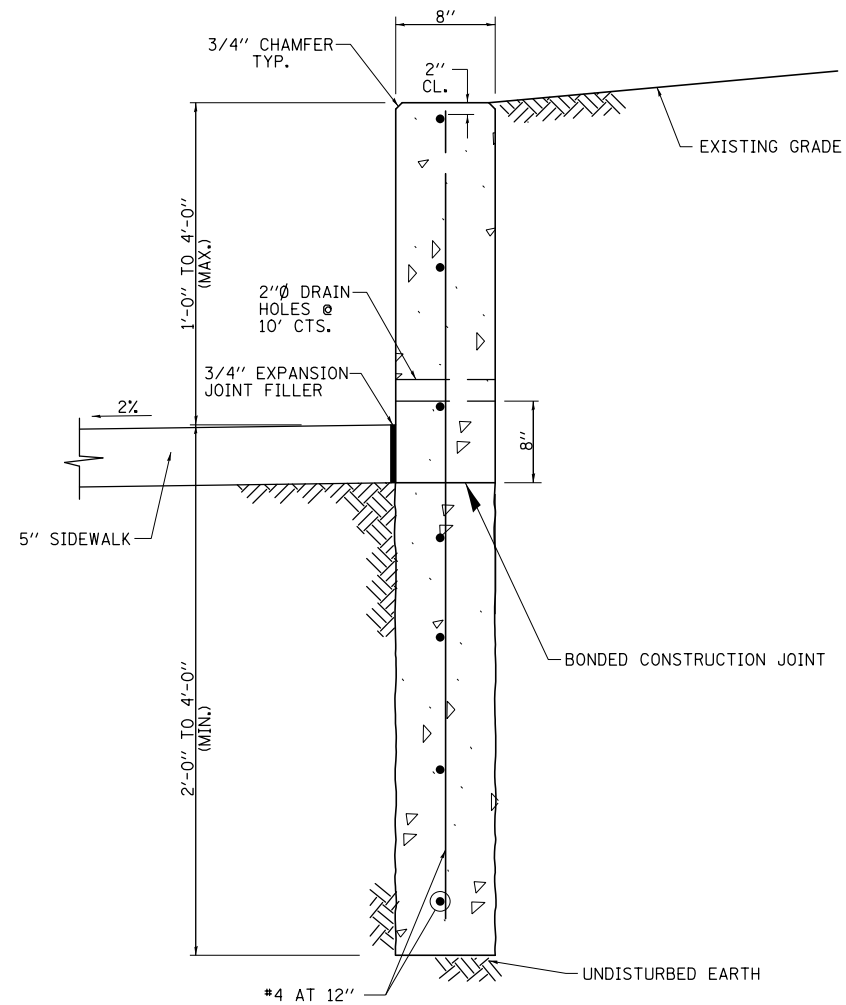

**CURB WALL DETAIL**

**GENERAL NOTES**

1. REINFORCEMENT BARS SHALL CONFORM TO THE REQUIREMENTS OF SECTION 508 OF THE STANDARD SPECIFICATIONS. THE COST OF FURNISHING AND INSTALLING ALL REINFORCEMENT SHALL BE INCLUDED IN THE COST PER CU. YD. OF CONCRETE STRUCTURES.
2. CONCRETE FOR WALLS AND STEPS SHALL BE CLASS SI CONCRETE. ALL WORK SHALL BE PERFORMED IN ACCORDANCE WITH SECTION 503 OF THE STANDARD SPECIFICATIONS. THE EXPOSED FACES OF WALLS SHALL BE A TEXTURED FINISH. FORM LINERS SHALL BE USED ON THE EXPOSED VERTICAL FACES AS DIRECTED AND APPROVED BY THE ENGINEER. ALL TRENCHES, REINFORCEMENT AND FORMWORK SHALL BE APPROVED BY THE ENGINEER PRIOR TO POURING CONCRETE WALLS OR FOOTINGS. THE COST OF CONSTRUCTING WALLS AND STEPS IN PLACE, INCLUDING ALL FORM WORK, FORM LINERS, TRENCHING, EXCAVATIONS, BACKFILL AND JOINT FILLERS SHALL BE INCLUDED IN THE COST PER CU. YD. OF CONCRETE STRUCTURES.
3. CONTRACTOR SHALL BE RESPONSIBLE FOR ANY EARTH RETENTION SYSTEMS AS REQUIRED TO CONSTRUCT WALLS TO PREVENT PROPERTY DAMAGE. ANY PROPERTY DAMAGE SHALL BE REPAIRED PER SECTION 107 OF THE STANDARD SPECIFICATIONS.

FILE NAME =	USER NAME = \$USER*	DESIGNED - CWG	REVISED -
\$FILEL\$		DRAWN - BWC	REVISED -
\$MODELNAME\$		CHECKED -	REVISED -
	PLOT DATE = \$DATE*	DATE -	REVISED -

**STATE OF ILLINOIS  
DEPARTMENT OF TRANSPORTATION**

**MISCELLANEOUS DETAILS**

SCALE: 1"=20' SHEET 1 OF 1 SHEETS STA. TO STA.

F.A. RTE.	SECTION	COUNTY	TOTAL SHEETS	SHEET NO.
VAR	D6 MONTGOMERY CO. ADA	MONTGOMERY	24	24
			CONTRACT NO. 72J15	
ILLINOIS FED. AID PROJECT				