

STATE OF ILLINOIS  
DEPARTMENT OF TRANSPORTATION

F.A.P. RTE.	SECTION	COUNTY	TOTAL SHEETS	SHEET NO.
789	68RS-4	MADISON	10	1
		ILLINOIS	CONTRACT NO. 76K07	

FOR INDEX OF SHEETS, SEE SHEET NO. 2  
FOR ADT SEE SHEET 10.

# PROPOSED HIGHWAY PLANS

FAP ROUTE 789 (IL 143)  
SECTION 68RS-4  
MICROSURFACING IL 143 FROM 0.2 MI W OF  
I-70 RAMPS TO W OF CHERRY ST IN HIGHLAND  
MADISON COUNTY

C-98-011-17

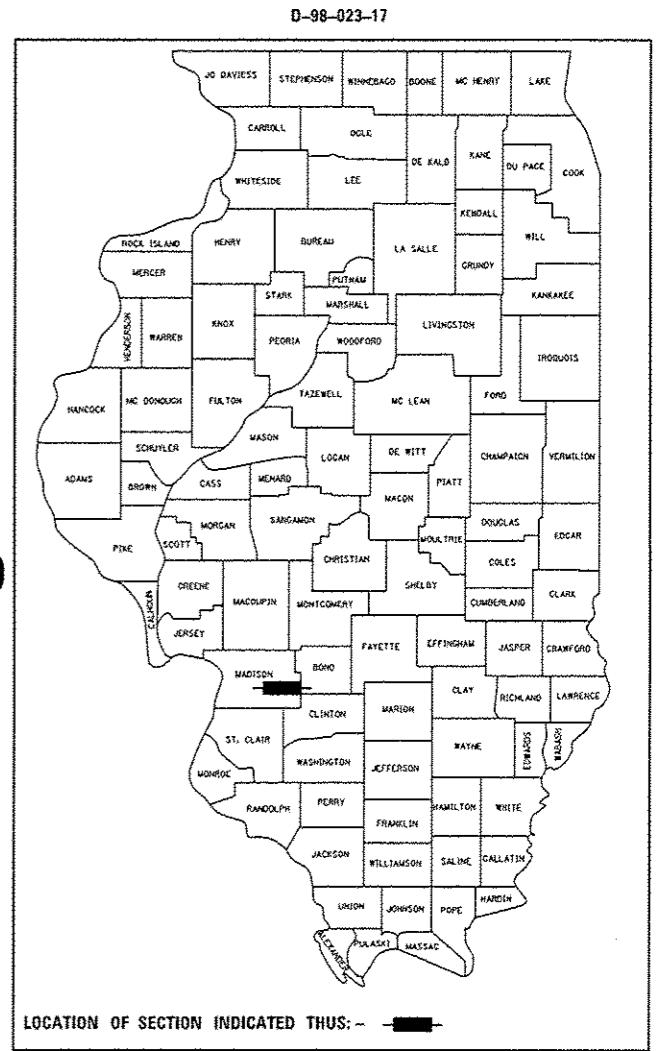

BEGIN PROJECT  
MS 0.00  
LONG =  $-89^{\circ}44'50.5''$   
LAT =  $38^{\circ}46'43.6''$

BRIDGE OMISSION  
MS 0.31 - 0.37

BRIDGE OMISSION  
MS 2.94 - 2.96

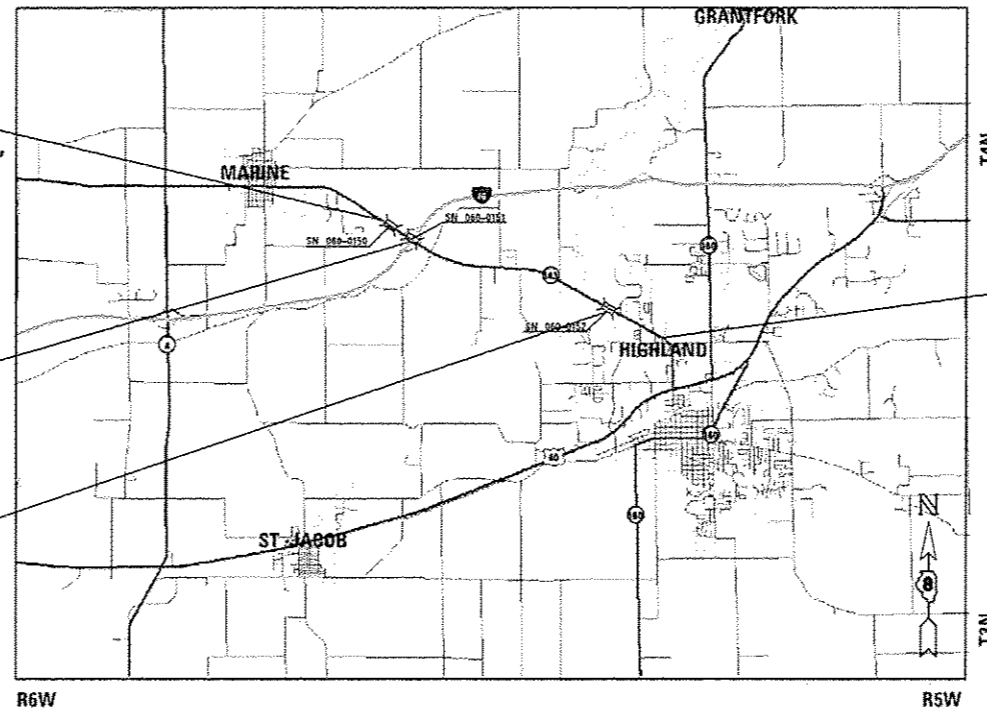

END PROJECT  
MS 3.80  
LONG =  $-89^{\circ}41'3.33''$   
LAT =  $38^{\circ}45'29.89''$

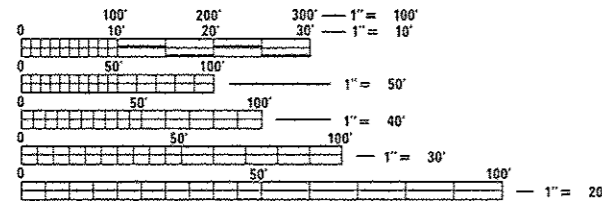

FULL SIZE PLANS HAVE BEEN PREPARED USING STANDARD ENGINEERING SCALES. REDUCED SIZED PLANS WILL NOT CONFORM TO STANDARD SCALES. IN MAKING MEASUREMENTS ON REDUCED PLANS, THE ABOVE SCALES MAY BE USED.

J.U.L.I.E.  
JOINT UTILITY LOCATION INFORMATION FOR EXCAVATION  
1-800-892-0123  
OR 811

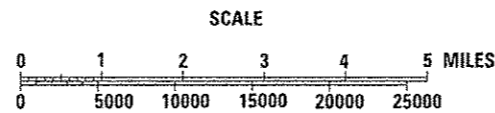

GROSS LENGTH = 20,064 FT. = 3.80 MILE  
NET LENGTH = 19,659 FT. = 3.72 MILE

PROJECT ENGINEER TIM PADGETT (618) 346-3325  
PROJECT MANAGER LIZ BURNSIDE (618) 346-3180

CONTRACT NO. 76K07

STATE OF ILLINOIS  
DEPARTMENT OF TRANSPORTATION

SUBMITTED *Dec 2 20 16*  
*Jeffrey L. Kan*  
REGIONAL ENGINEER

*Jan 27 20 17*  
*Muhammad M. Addis*  
ENGINEER OF DESIGN AND ENVIRONMENT

*Jan 27 20 17*  
*[Signature]*  
DIRECTOR OF PROGRAM DEVELOPMENT

PRINTED BY THE AUTHORITY  
OF THE STATE OF ILLINOIS



### SUMMARY OF QUANTITIES

CODE NO.	ITEM	UNIT	TOTAL QUANTITY	CONSTRUCTION CODE	
				100 % STATE	
				ROADWAY	ROADWAY
				0005	0005
				RURAL	URBAN
40600290	BITUMINOUS MATERIALS (TACK COAT)	POUND	15260		
				4871	10389
44004250	PAVED SHOULDER REMOVAL	SQ YD	199		
				0	199
48203021	HOT-MIX ASPHALT SHOULDERS, 6"	SQ YD	199		
				0	199
67000400	ENGINEER'S FIELD OFFICE, TYPE A	CAL MO	1		
				0.5	0.5
67100100	MOBILIZATION	LSUM	1		
				0.5	0.5
70100450	TRAFFIC CONTROL AND PROTECTION, STANDARD 701201	LSUM	1		
				1	0
70100460	TRAFFIC CONTROL AND PROTECTION, STANDARD 701306	LSUM	1		
				1	0
70100600	TRAFFIC CONTROL AND PROTECTION, STANDARD 701336	LSUM	1		
				1	0
70102620	TRAFFIC CONTROL AND PROTECTION, STANDARD 701501	LSUM	1		
				0	1
70102622	TRAFFIC CONTROL AND PROTECTION, STANDARD 701502	LSUM	1		
				0	1
70106800	CHANGEABLE MESSAGE SIGN	CAL MO	2		
				1	1
70300100	SHORT TERM PAVEMENT MARKING	FOOT	3167		
				1034	2133
70300150	SHORT TERM PAVEMENT MARKING REMOVAL	SQ FT	1057		
				346	711
70300210	TEMPORARY PAVEMENT MARKING LETTERS AND SYMBOLS	SQ FT	156		
				0	156

14

SUMMARY OF QUANTITIES				CONSTRUCTION CODE	
CODE NO.	ITEM	UNIT	TOTAL QUANTITY	100% STATE	
				ROADWAY 0005 RURAL	ROADWAY 0005 URBAN
				70300220	TEMPORARY PAVEMENT MARKING - LINE 4"
70300260	TEMPORARY PAVEMENT MARKING - LINE 12"	FOOT	265	0	265
70300280	TEMPORARY PAVEMENT MARKING - LINE 24"	FOOT	57	0	57
* 78000100	THERMOPLASTIC PAVEMENT MARKING - LETTERS AND SYMBOLS	SQ FT	156	0	156
* 78000200	THERMOPLASTIC PAVEMENT MARKING - LINE 4"	FOOT	54355	17359	36996
* 78000600	THERMOPLASTIC PAVEMENT MARKING - LINE 12"	FOOT	265	0	265
* 78000650	THERMOPLASTIC PAVEMENT MARKING - LINE 24"	FOOT	57	0	57
* 78001110	PAINT PAVEMENT MARKING - LINE 4"	FOOT	1470	1268	202
* 78100100	RAISED REFLECTIVE PAVEMENT MARKER	EACH	300	81	219
78300200	RAISED REFLECTIVE PAVEMENT MARKER REMOVAL	EACH	300	81	219
X0326218	FIBER-MODIFIED ASPHALT CRACK SEALING	FOOT	6000	3000	3000
X0327980	PAVEMENT MARKING REMOVAL - WATER BLASTING	SQ FT	37793	11994	25799
X3200001	BUMP REMOVAL	EACH	12	6	6
X4406020	PARTIAL DEPTH REMOVAL, TYPE I, 2"	SQ YD	77	0	77

14

\* SPECIALTY ITEM

FILE NAME =	USER NAME = burrisdeem	DESIGNED -	REVISED -	<b>STATE OF ILLINOIS DEPARTMENT OF TRANSPORTATION</b>	<b>SUMMARY OF QUANTITIES</b>				F.A.P. RTE.	SECTION	COUNTY	TOTAL SHEETS	SHEET NO.
pw\11804EBIDINTEG\Illinois.gov\PIWIDOT\Documents\DOT Office\District B\Projects\087-DR\Drawings\RAD\Drawings\087-DR\plan.dwg	PROJECT = 087-DR	CHECKED -	REVISED -		789	6BRS-4	MADISON	10	4				
PLOT SCALE = 1/8" = 1'-0"	DATE = 12/1/2016	CHECKED -	REVISED -		SCALE: SHEET OF SHEETS STA. TO STA.				CONTRACT NO. 76K07				
									ILLINOIS FED. AID PROJECT				

3/18/2016

SUMMARY OF QUANTITIES				CONSTRUCTION CODE	
CODE NO.	ITEM	UNIT	TOTAL QUANTITY	100% STATE	
				ROADWAY 0005 RURAL	ROADWAY 0005 URBAN
				X4406220	PARTIAL DEPTH REMOVAL, TYPE II, 2"
X4406420	PARTIAL DEPTH REMOVAL, TYPE III, 2"	SQ YD	268	0	268
X4421000	PARTIAL DEPTH PATCHING	TON	100	4.7	95.3
Z0063804	MICRO-SURFACING, SINGLE PASS, TYPE II, MIXTURE D	SQ YD	67821	21648	46173

6/

FILE NAME =	USER NAME = burrisdean	DESIGNED -	REVISED -	<b>STATE OF ILLINOIS DEPARTMENT OF TRANSPORTATION</b>	<b>SUMMARY OF QUANTITIES</b>	F.A.P. RTE.	SECTION	COUNTY	TOTAL SHEETS	SHEET NO.	
pw\11084EBID\INTEG\illinois.gov\PIWIDOT\Do	Documents\DOT Offices\District 8\Projects\0875	CHECKED -	REVISED -			789	68RS-4	MADISON	10	5	
	PLOT SCALE = 100.0000' / in.	CHECKED -	REVISED -			CONTRACT NO. 76K07					
	PLOT DATE = 12/1/2016	DATE -	REVISED -			SCALE:	SHEET	OF	SHEETS	STA.	TO
ILLINOIS FED. AID PROJECT											

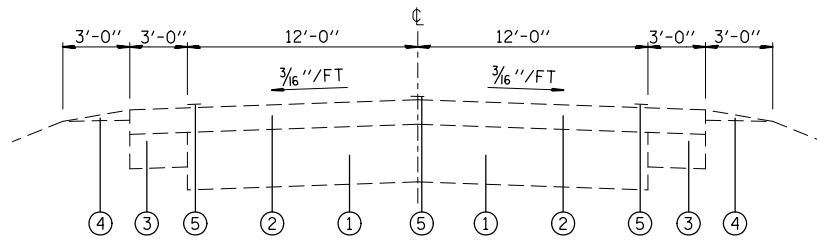

**EXISTING TANGENT SECTIONS**  
 MS 0.00 TO MS 0.31      MS 0.37 TO MS 0.62  
 MS 0.80 TO MS 1.05      MS 1.25 TO MS 1.88  
 MS 2.21 TO MS 2.51      MS 3.01 TO MS 3.56

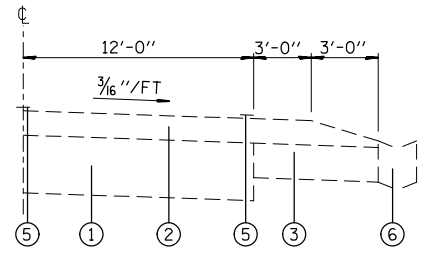

**EXISTING GUTTER SECTIONS**  
 LT MS 2.49 TO MS 2.51  
 LT MS 3.27 TO MS 3.33  
 RT MS 3.12 TO MS 3.45

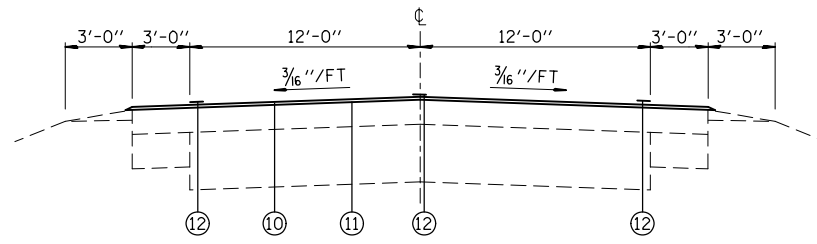

**PROPOSED TANGENT SECTIONS**  
 MS 0.00 TO MS 0.31      MS 0.37 TO MS 0.62  
 MS 0.80 TO MS 1.05      MS 1.25 TO MS 1.88  
 MS 2.21 TO MS 2.51      MS 3.01 TO MS 3.56

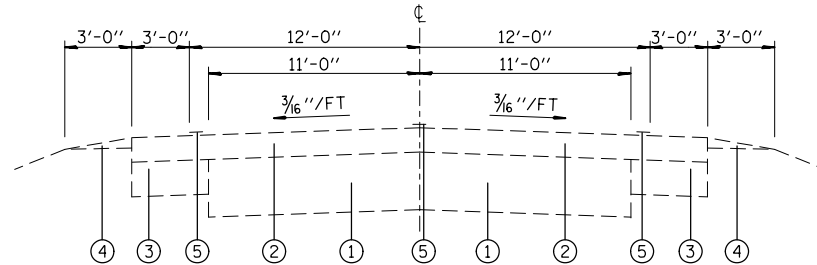

**EXISTING TANGENT SECTIONS**  
 MS 2.51 TO MS 2.94      MS 2.96 TO MS 3.01

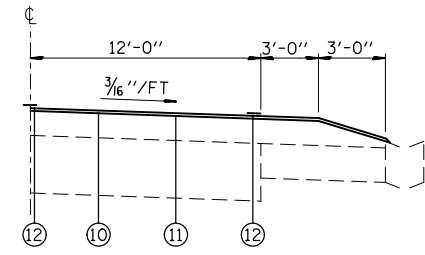

**PROPOSED GUTTER SECTIONS**  
 LT MS 2.49 TO MS 2.51  
 LT MS 3.27 TO MS 3.33  
 RT MS 3.12 TO MS 3.45

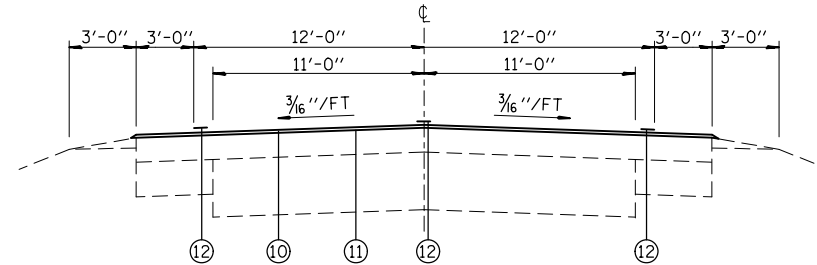

**PROPOSED TANGENT SECTIONS**  
 MS 2.51 TO MS 2.94      MS 2.96 TO MS 3.01

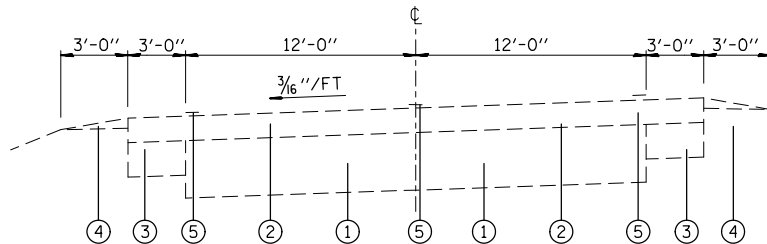

**EXISTING SUPERELEVATED SECTIONS**  
 MS 0.62 TO MS 0.80 LEFT      MS 1.05 TO MS 1.25 LEFT  
 MS 1.88 TO MS 2.21 RIGHT

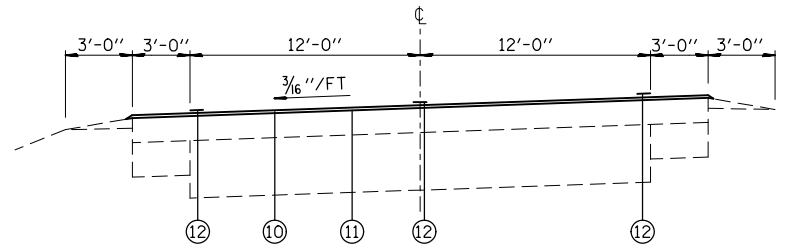

**PROPOSED SUPERELEVATED SECTIONS**  
 MS 0.62 TO MS 0.80 LEFT      MS 1.05 TO MS 1.25 LEFT  
 MS 1.88 TO MS 2.21 RIGHT

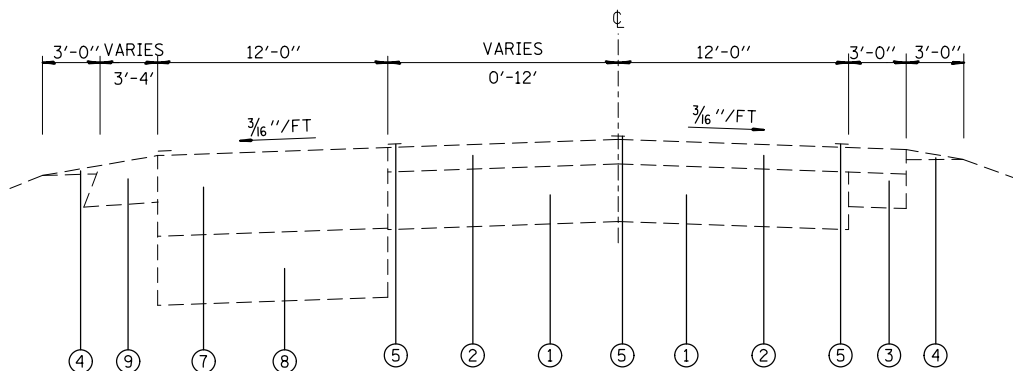

**EXISTING TANGENT SECTIONS**  
 MS 3.56 TO MS 3.80

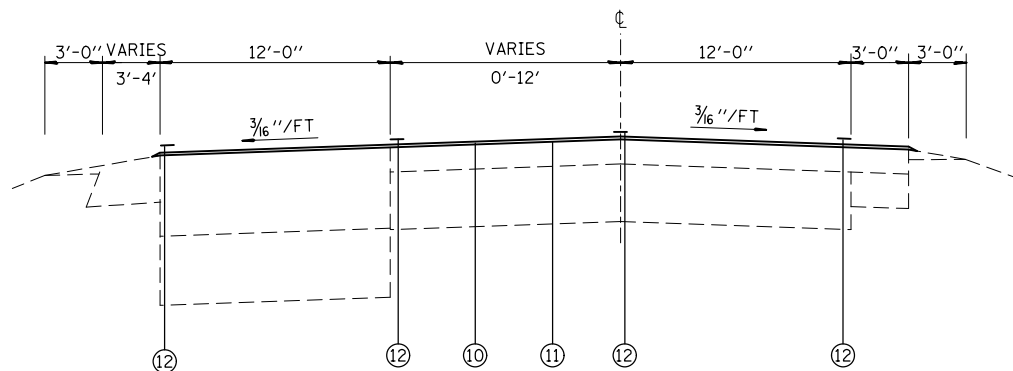

**PROPOSED TANGENT SECTIONS**  
 MS 3.56 TO MS 3.80

- LEGEND**
- ① EXISTING PCC PAVEMENT, 10"
  - ② EXISTING HMA RESURFACING 4.25"
  - ③ EXISTING BITUMINOUS SHOULDER, 6"
  - ④ EXISTING AGGREGATE WEDGE SHOULDER, TYPE B
  - ⑤ EXISTING PAVEMENT MARKING LINE, 4"
  - ⑥ EXISTING GUTTER
  - ⑦ EXISTING WIDENING, 14"
  - ⑧ EXISTING LIME MODIFIED SOILS, 12"
  - ⑨ EXISTING BITUMINOUS SHOULDERS, 8"
  - ⑩ PROPOSED MICROSURFACING SINGLE PASS
  - ⑪ PROPOSED BITUMINOUS MATERIAL (TACK COAT)
  - ⑫ PROPOSED PAVEMENT MARKING, 4"

FILE NAME =	USER NAME = burnsideem	DESIGNED -	REVISED -
pw:\IL\084EBIDINTEG\illinois.gov\PIDOT\Documents\IDOT Offices\District 8\Projects\D876K07\DRAWING\DATA\EA0\Sheets\D876K07-sht-plan.dwg		CHECKED -	REVISED -
Default	PLOT DATE = 12/1/2016	DATE -	REVISED -

**STATE OF ILLINOIS  
 DEPARTMENT OF TRANSPORTATION**

<b>TYPICAL SECTIONS</b>			
SCALE:	SHEET	OF SHEETS	STA. TO STA.

F.A.P. RTE.	SECTION	COUNTY	TOTAL SHEETS	SHEET NO.
789	68RS-4	MADISON	10	6
CONTRACT NO. 76K07				
ILLINOIS FED. AID PROJECT				

MICRO-SURFACING SCHEDULE				
STATION			BITUMINOUS MATERIAL (TACK COAT)	MICRO-SURFACING SINGLE PASS
IL 143			( POUND)	( SQ YD)
0.00	TO	0.31	1228	5456
0.31	TO	0.37	BRIDGE OMISSION	
0.37	TO	1.29	3643	16192
1.29	TO	2.52	4871	21648
2.52	TO	2.54	87	387
2.54	TO	2.94	1584	7040
2.94	TO	2.96	BRIDGE OMISSION	
2.96	TO	3.15	752	3344
3.15	TO	3.48	1503	6679
3.48	TO	3.56	317	1408
3.56	TO	3.63	333	1478
3.63	TO	3.80	942	4189
TOTAL			15260	67821

RAISED REFLECTIVE PAVEMENT MARKERS						
LOCATION			TWO WAY AMBER	ONE WAY AMBER	ONE WAY CRYSTAL	REMOVAL
STA	TO	STA	( EACH)	( EACH)	( EACH)	( EACH)
IL43						
0.00	TO	0.31	20			20
0.31	TO	0.37	BRIDGE OMISSION			
0.37	TO	1.29	61			61
1.29	TO	2.94	109			109
2.94	TO	2.96	BRIDGE OMISSION			
2.96	TO	3.56	42			42
3.56	TO	3.80	28	35	5	67
SUBTOTAL:			260	35	5	299
SUBTOTAL:			300			300

BUMP REMOVAL				
LOCATION		LENGTH	WIDTH	BUMP REMOVAL
MS	RT/LT	( FT)	( FT)	( EACH)
IL 143				
0.1	RT/LT	8.0	25.0	1
0.12	RT/LT	8.0	25.0	1
0.14	RT/LT	8.0	25.0	1
0.15	RT/LT	8.0	25.0	1
0.17	RT/LT	10.0	25.0	1
0.7	RT/LT	15.0	30.0	1
1.6	RT/LT	30.0	30.0	1
1.75	RT/LT	10.0	30.0	1
1.755	RT/LT	10.0	30.0	1
2	RT/LT	30.0	30.0	1
2.2	RT/LT	70.0	30.0	1
2.4	RT	20.0	15.0	1
TOTAL:				12

HMA SHOULDERS					
LOCATION		LENGTH	WIDTH	PAVED SHOULDER REMOVAL	HMA SHOULDERS 6"
MS	RT/LT	( FT)	( FT)	( SQ YD)	( SQ YD)
IL 143					
2.69	RT	8.0	3.0	2.7	2.7
2.70	RT	10.0	3.0	3.3	3.3
2.71	RT	60.0	3.0	20.0	20.0
2.74	RT	200.0	3.0	66.7	66.7
2.78	RT	80.0	3.0	26.7	26.7
2.81	RT	50.0	3.0	16.7	16.7
2.84	RT	30.0	3.0	10.0	10.0
2.86	RT	160.0	3.0	53.3	53.3
TOTAL:				199	199

PAVEMENT MARKING SCHEDULE

LOCATION			THERMOPLASTIC PAVEMENT MARKING AND TEMPORARY PAVEMENT MARKING						BRIDGE PAINT PAVEMENT MARKING			PAVE MARKING REMOVAL WATER BLASTING (TEMP&EXIST PAVE MARKINGS) (2 LIFTS)	SHORT- TERM PAVEMENT MARKING (1 LIFT) (WHITE)	SHORT- TERM PAVEMENT MARKING (1 LIFT) (YELLOW)	SHORT- TERM PAVEMENT MARKING REMOVAL (1 LIFT)	
			LINE, 4" SOLID (WHITE)	LINE, 4" SKIP-DASH (YELLOW)	LINE, 4" EB NO PASS (YELLOW)	LINE, 4" WB NO PASS (YELLOW)	LINE, 12" SOLID (WHITE)	LINE, 24" SOLID (WHITE)	LETTERS & SYMBOLS	LINE, 4" SOLID (WHITE)	LINE, 4" SKIP-DASH (YELLOW)					LINE, 4" NO PASS (YELLOW)
STA	TO	STA	FOOT	FOOT	FOOT	FOOT	FOOT	FOOT	SQ FT	FOOT	FOOT	FOOT	SQ FT	FOOT	FOOT	SQ FT
IL 143																
0.00	TO	0.182	1922	240	961								2082	77	109	62
0.182	TO	0.310	1112		676	676							1642	44	123	56
0.310	TO	0.370							634		634		422	25	63	30
0.370	TO	0.595	2141	297		1188							2417	86	135	74
0.595	TO	1.290	7229	917									5431	289	83	124
1.290	TO	2.222	9524	1230									7169	381	112	164
2.222	TO	2.412	1916	251	1003								2114	77	114	64
2.412	TO	2.622	2218	277		1109							2402	89	126	72
2.622	TO	2.943	3390	424									2542	136	39	58
2.943	TO	2.960							180	22			67	7	9	5
2.960	TO	3.071	1172	147									879	47	13	20
3.071	TO	3.230	1604	210	840								1769	64	95	53
3.230	TO	3.329	1045		523	523							1394	42	95	46
3.329	TO	3.560	2219	305		1220							2496	89	139	76
3.560	TO	3.655	1003		1003	1003							2006	40	182	74
3.655	TO	3.690	45		185	185	190	25	31				819	2	51	18
3.690	TO	3.708	190		190	190	75	32	125				908	8	41	16
3.708	TO	3.800	637	243	486	486							1234	25	110	45
SUBTOTAL:			37367	4541	5867	6580	265	57	156	814	22	634	37793	1528	1639	1057
TOTAL:			54355				265	57	156	1470			37793	3167		1057



PARTIAL DEPTH HOT MIX ASPHALT PATCHING - 2"

LOCATION	LANE	LENGTH	WIDTH	PARTIAL DEPTH REMOVAL, TYPE I, 2"	PARTIAL DEPTH REMOVAL, TYPE II, 2"	PARTIAL DEPTH REMOVAL, TYPE III, 2"	PARTIAL DEPTH PATCHING	LOCATION	LANE	LENGTH	WIDTH	PARTIAL DEPTH REMOVAL, TYPE I, 2"	PARTIAL DEPTH REMOVAL, TYPE II, 2"	PARTIAL DEPTH REMOVAL, TYPE III, 2"	PARTIAL DEPTH PATCHING
MS	RT/LT	(FT)	(FT)	(SQ. YD.)	(SQ. YD.)	(SQ. YD.)	(TON)	MS	RT/LT	(FT)	(FT)	(SQ. YD.)	(SQ. YD.)	(SQ. YD.)	(TON)
IL 143								IL 143							
0.2	LT	10.0	15.0		16.7		1.9	2.74	RT	6.0	12.0		8.0		0.9
0.22	LT	6.0	15.0		10.0		1.1	2.74	LT	6.0	15.0		10.0		1.1
0.55	RT	6.0	15.0		10.0		1.1	2.76	RT	6.0	15.0		10.0		1.1
1.80	RT	40.0	15.0			66.7	7.5	2.76	LT	6.0	15.0		10.0		1.1
1.80	LT	40.0	15.0			66.7	7.5	2.77	RT	4.0	15.0	6.7			0.7
2.33	RT	30.0	15.0			50.0	5.6	2.77	LT	4.0	15.0	6.7			0.7
2.33	LT	30.0	15.0			50.0	5.6	2.78	RT	6.0	12.0		8.0		0.9
2.50	RT	6.0	15.0		10.0		1.1	2.78	LT	6.0	15.0		10.0		1.1
2.50	LT	6.0	15.0		10.0		1.1	2.81	RT	6.0	12.0		8.0		0.9
2.53	RT	6.0	15.0		10.0		1.1	2.81	LT	6.0	15.0		10.0		1.1
2.53	LT	6.0	15.0		10.0		1.1	2.82	RT	4.0	15.0	6.7			0.7
2.55	RT	6.0	15.0		10.0		1.1	2.82	LT	4.0	15.0	6.7			0.7
2.55	LT	6.0	15.0		10.0		1.1	2.85	RT	8.0	15.0		13.3		1.5
2.60	RT	6.0	15.0		10.0		1.1	2.85	LT	8.0	15.0		13.3		1.5
2.60	LT	6.0	15.0		10.0		1.1	2.86	RT	6.0	15.0		10.0		1.1
2.65	RT	6.0	15.0		10.0		1.1	2.86	LT	6.0	15.0		10.0		1.1
2.65	LT	6.0	15.0		10.0		1.1	2.87	RT	4.0	15.0	6.7			0.7
2.67	RT	6.0	15.0		10.0		1.1	2.87	LT	4.0	15.0	6.7			0.7
2.67	LT	6.0	15.0		10.0		1.1	2.90	RT	4.0	15.0	6.7			0.7
2.68	RT	6.0	15.0		10.0		1.1	2.90	LT	4.0	15.0	6.7			0.7
2.68	LT	6.0	15.0		10.0		1.1	2.95	RT	6.0	15.0		10.0		1.1
2.69	RT	8.0	12.0		10.7		1.2	2.95	LT	6.0	15.0		10.0		1.1
2.69	LT	8.0	15.0		13.3		1.5	2.96	RT	6.0	15.0		10.0		1.1
2.70	RT	6.0	12.0		8.0		0.9	2.96	LT	6.0	15.0		10.0		1.1
2.70	LT	6.0	15.0		10.0		1.1	3.00	RT	4.0	15.0	6.7			0.7
2.705	RT	6.0	15.0		10.0		1.1	3.00	LT	4.0	15.0	6.7			0.7
2.705	LT	6.0	15.0		10.0		1.1	3.05	RT	15.0	15.0		25.0		2.8
2.72	RT	6.0	15.0		10.0		1.1	3.58	RT	8.0	12.0		10.7		1.2
2.72	LT	6.0	15.0		10.0		1.1	3.58	LT	8.0	25.0		22.2		2.5
SUBTOTAL:				0.0	258.7	233.3	55.1	SUBTOTAL:				66.7	218.6	0.0	31.9
ANTICIPATED FAILURES (15%):				0.0	38.8	35.0	8.3	ANTICIPATED FAILURES (15%):				10.0	32.8	0.0	4.8
TOTAL:												77	549	268	100

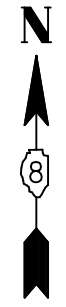
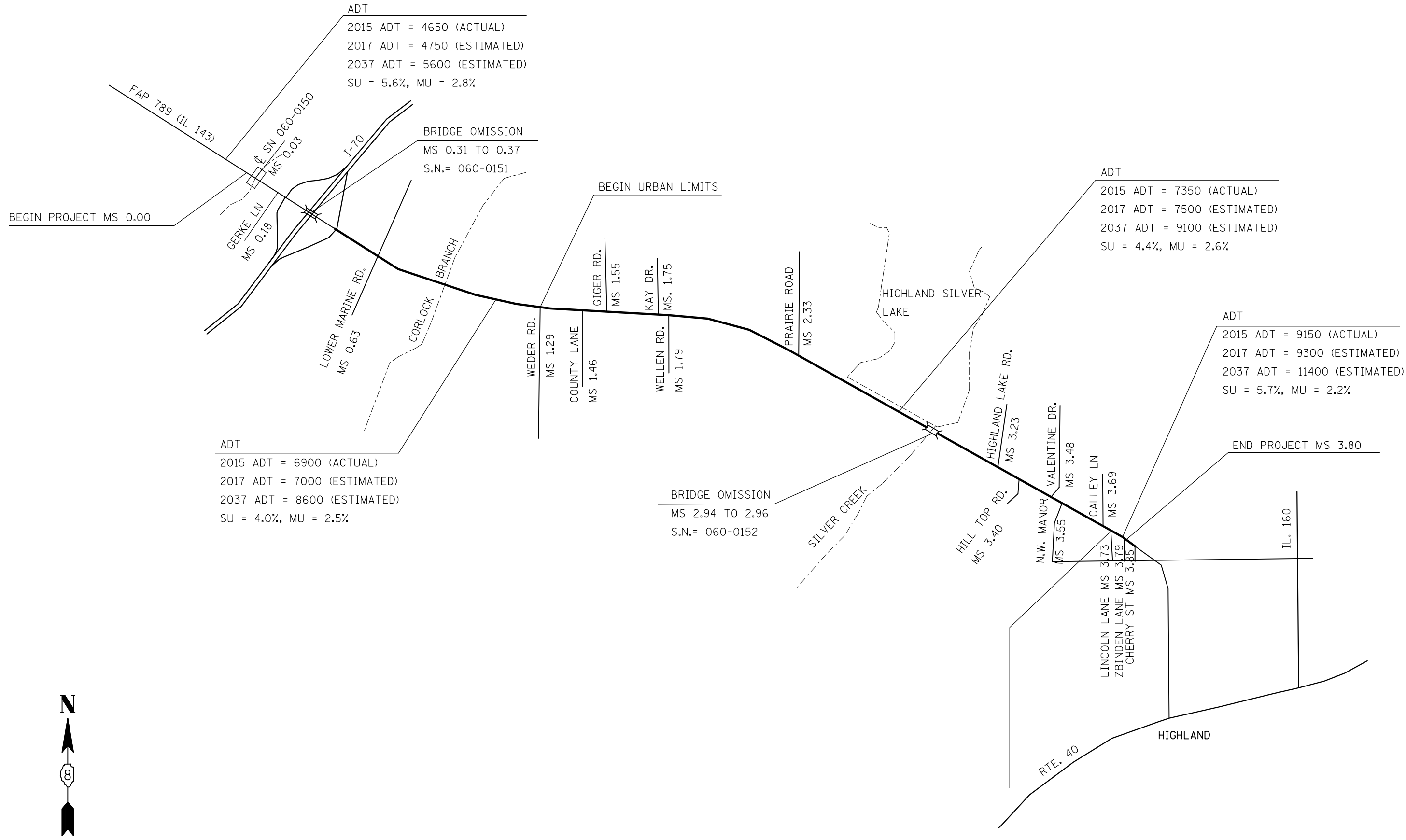

NOT TO SCALE

FILE NAME =	USER NAME = burnsideem	DESIGNED -	REVISED -	<b>STATE OF ILLINOIS DEPARTMENT OF TRANSPORTATION</b>	<b>LOCATION MAP</b>				F.A.P. RTE.	SECTION	COUNTY	TOTAL SHEETS	SHEET NO.
pw:\IL\084EBIDINTEG.illinois.gov\PIWIDOT\Documents\IDOT Offices\District 8\Projects\D876K07\DRAWING\DATA\EA0\Sheets\D876K07-sht-plan.dwg		CHECKED -	REVISED -		789	68RS-4	MADISON	10	10				
Default	PLOT SCALE = 100.0000' / in.	CHECKED -	REVISED -		CONTRACT NO. 76K07				ILLINOIS FED. AID PROJECT				
	PLOT DATE = 12/1/2016	DATE -	REVISED -		SCALE:	SHEET	OF	SHEETS	STA.	TO	STA.		