

FEDERAL AID PROGRAM ENGINEER: FAWAD AQUEEL, P.E., P.T.O.E. (847) 705-4021, SCHAUMBURG, IL

F.A.U. RTE.	SECTION	COUNTY	TOTAL SHEETS	SHEET NO.
2996	15-00095-00-RS	DuPAGE	12	1
FED. ROAD DIST. NO. 1	ILLINOIS	CONTRACT NO. 61C42		

STATE OF ILLINOIS
DEPARTMENT OF TRANSPORTATION
DIVISION OF HIGHWAYS

PLANS FOR PROPOSED FEDERAL AID HIGHWAY

**F.A.U. ROUTE 2996 (HIGH RIDGE ROAD)
 VILLA PARK CORP. LIMITS TO
 ARDMORE AVE. RESURFACING
 SECTION 15-00095-00-RS
 PROJECT NO. M-4003(578)
 VILLAGE OF VILLA PARK
 DuPAGE COUNTY
 JOB NO. C-91-033-16**



FOR INDEX OF SHEETS, SEE SHEET NO. 2
 FOR HIGHWAY STANDARDS, SEE SHEET NO. 2

TRAFFIC DATA

2010 ADT: 3,418
 POSTED SPEED LIMIT: 30 MPH (20 MPH WHEN CHILDREN PRESENT)
 FUNCTIONAL CLASSIFICATION: MAJOR COLLECTOR

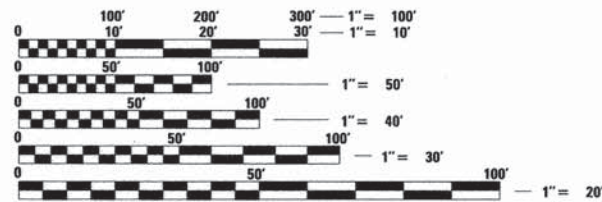

FULL SIZE PLANS HAVE BEEN PREPARED USING STANDARD ENGINEERING SCALES. REDUCED SIZED PLANS WILL NOT CONFORM TO STANDARD SCALES. IN MAKING MEASUREMENTS ON REDUCED PLANS, THE ABOVE SCALES MAY BE USED.

J.U.L.I.E.
 JOINT UTILITY LOCATION INFORMATION FOR EXCAVATION
 1-800-892-0123
 OR 811

PROJECT ENGINEER: WILLIAM M. ELDRINGHOFF, P.E.
 PROJECT MANAGER: RONALD O. NORDMEYER, P.E.

CONTRACT NO. 61C42



BEGIN IMPROVEMENTS
 STA. 26+09.81

END IMPROVEMENTS
 STA. 49+79.47

LOCATION MAP
 NOT TO SCALE

GROSS AND NET LENGTH = 2,369.66 FT. = 0.449 MILES

VILLAGE OF VILLA PARK DEPARTMENT OF PUBLIC WORKS	
APPROVED	December 10 2015 <i>Dydas Jankelka</i> VILLAGE OF VILLA PARK, DIRECTOR OF PUBLIC WORKS
PASSED	DECEMBER 17 2015 <i>C. Holt</i> DISTRICT 1 ENGINEER OF LOCAL ROADS & STREETS
RELEASING FOR BID BASED ON LIMITED REVIEW	December 17 2015 <i>John Furlong</i> DEPUTY DIRECTOR OF HIGHWAYS, REGION 1 ENGINEER

**PRINTED BY THE AUTHORITY
OF THE STATE OF ILLINOIS**

WILLIAM M. ELDRINGHOFF
 062-059445
 REGISTERED
 PROFESSIONAL
 ENGINEER
 OF
 ILLINOIS
 EXPIRES NOV. 30, 2017
W.M. Eldringhoff
 SIGNATURE
 12-8-15
 DATE

Clark Dietz
 ENGINEERS
 DESIGN FIRM REGISTRATION
 No. 184-000450
 118 SOUTH CLINTON STREET
 SUITE 600
 CHICAGO, IL 60661
 PHONE : 312.648.9900
 FAX : 312.648.0204

INDEX OF SHEETS

SHEET NO.	TITLE
1	COVER SHEET
2	INDEX OF SHEET, STANDARDS, GENERAL NOTES, AND COMMITMENTS
3	SUMMARY OF QUANTITIES
4	TYPICAL SECTIONS
5-7	ROADWAY PLAN
8	DETOUR PLAN
9-12	DISTRICT 1 STANDARDS

LIST OF DISTRICT 1 STANDARDS

BD-32	BUTT JOINT AND HMA TAPER DETAILS
TC-10	TRAFFIC CONTROL AND PROTECTION FOR SIDE ROADS, INTERSECTIONS, AND DRIVEWAYS
TC-13	DISTRICT ONE TYPICAL PAVEMENT MARKINGS
TC-16	PAVEMENT MARKING LETTERS AND SYMBOLS FOR TRAFFIC STAGING

LIST OF HIGHWAY STANDARDS

000001-06	STANDARD SYMBOLS, ABBREVIATIONS, AND PATTERNS
424001-08	PERPENDICULAR CURB RAMPS FOR SIDEWALKS
542001-04	CONCRETE END SECTIONS FOR PIPE CULVERTS 15" THRU 84" DIA.
542301-03	PRECAST REINFORCED CONCRETE FLARED END SECTION
542401-01	METAL END SECTION FOR PIPE CULVERTS
606001-06	CONCRETE CURB TYPE B AND COMBINATION CONCRETE CURB AND GUTTER
701006-05	OFF-RD OPERATIONS, 2L, 2W, 15' (4.5m) TO 24" (600 mm) FROM PAVEMENT EDGE
701301-04	LANE CLOSURE, 2L, 2W, SHORT TIME OPERATIONS
701311-03	LANE CLOSURE, 2L, 2W, MOVING OPERATIONS - DAY ONLY
701501-06	URBAN LANE CLOSURE, 2L, 2W, UNDIVIDED
701801-05	SIDEWALK, CORNER OR CROSSWALK CLOSURE
701901-04	TRAFFIC CONTROL DEVICES
780001-05	TYPICAL PAVEMENT MARKINGS

GENERAL NOTES

- ALL CONSTRUCTION SHALL BE DONE IN ACCORDANCE WITH THE DETAILS IN THE PLANS, THE SPECIAL PROVISIONS INCLUDED IN THE CONTRACT DOCUMENTS, AND THE LATEST EDITION OF THE FOLLOWING STATE OF ILLINOIS SPECIFICATIONS: "THE STANDARD SPECIFICATIONS FOR ROAD AND BRIDGE CONSTRUCTION" (REFERRED TO AS THE "STANDARD SPECIFICATIONS"), THE "SUPPLEMENTAL SPECIFICATIONS AND RECURRING SPECIAL PROVISIONS," THE "MANUAL ON UNIFORM TRAFFIC CONTROL DEVICES FOR STREETS AND HIGHWAYS," AND THE "MANUAL OF TEST PROCEDURES FOR MATERIALS."
- THE LOCATIONS OF PUBLIC OR PRIVATE UTILITIES SHOWN ON THE PLANS REPRESENT ONLY THE OPINION OF THE VILLAGE. THEY ARE ONLY INCLUDED FOR THE CONVENIENCE OF THE BIDDER AND THEIR ACCURACY IS NOT GUARANTEED. THE CONTRACTOR SHALL BE RESPONSIBLE FOR THE PROTECTION OF ALL UNDERGROUND OR SURFACE UTILITIES, EVEN THOUGH THEY MAY NOT BE SHOWN ON THE PLANS.
- THE CONTRACTOR SHALL NOTIFY VYDAS JUSKELIS, THE DIRECTOR OF PUBLIC WORKS (630-834-8505), AT LEAST 48 HOURS IN ADVANCE OF BEGINNING WORK TO OBTAIN VILLAGE UTILITY LOCATIONS.
- ONE (1) SET OF APPROVED PLANS MUST BE ON THE SITE AT ALL TIMES.
- THE CONTRACTOR SHALL CONTACT JEREMIE LUKOWICZ, THE ASSISTANT VILLAGE ENGINEER (630-834-8505), AND THE ENGINEER AT LEAST 48 HOURS PRIOR TO ANY CONCRETE OR HOT-MIX ASPHALT MATERIAL DELIVERIES.
- ACCESS TO PRIVATE DRIVEWAYS SHALL BE PROVIDED AT ALL TIMES EXCEPT DURING ACTUAL CONSTRUCTION ADJACENT THERETO.
- ANY EROSION CONTROL MEASURES THAT ARE DEEMED NECESSARY BY THE VILLAGE ENGINEER SHALL BE IMPLEMENTED IMMEDIATELY BY THE CONTRACTOR.
- PDFS OF THE LATEST FULL SIZE PLAN SET AND SPECIAL PROVISIONS WILL BE PROVIDED BY THE VILLAGE ON A CD WHICH WILL BE GIVEN TO THE GENERAL CONTRACTOR AT THE PRE-CONSTRUCTION CONFERENCE FOR THEIR USE. ADDITIONAL PAPER COPIES WILL NOT BE DISTRIBUTED BY THE ENGINEER.
- THE DAY'S PAVING OPERATION SHOULD RESULT IN A SINGLE TRANSVERSE JOINT. ANY COLD LONGITUDINAL JOINTS WILL NOT BE ACCEPTED. PROVIDING A SINGLE TRANSVERSE JOINT SHALL BE ACCOMPLISHED BY PAVING ONE LANE OF SUFFICIENT LENGTH THAT WILL ALLOW FOR THE PAVING OF THE ADJACENT LANE IN THE SAME DAY.
- IN ALL TRENCHES CROSSING DRIVEWAYS, SIDEWALKS, AND ALL PROPOSED AND EXISTING ROADWAYS, THE MATERIALS FOR THE TOP 12 INCHES SHALL BE CA-6 CRUSHED GRAVEL OR CRUSHED STONE AND BE INCLUDED IN THE PAY ITEM FOR TRENCH BACKFILL.
- AGGREGATE SHOULDERS, TYPE B SHALL MEET THE REQUIREMENTS OF ARTICLE 1004.4 OF THE STANDARD SPECIFICATIONS. RECLAIMED ASPHALT PAVEMENT (RAP) SHALL NOT BE ALLOWED AS AN ACCEPTABLE MATERIAL FOR AGGREGATE SHOULDERS, TYPE B.
- THE CONTRACTOR SHALL PROVIDE AN INSTALL TWO (2) WEIGHTED SANDBAGS ON EACH TYPE I OR TYPE II BARRICADE USED. ONE (1) WEIGHTED SANDBAG SHALL BE PLACED ACROSS EACH BOTTOM RAIL.
- ANY GEOTECHNICAL INFORMATION PROVIDED IS FOR INFORMATIONAL PURPOSES ONLY, AND DOES NOT GUARANTEE CONDITIONS WHICH WILL BE ENCOUNTERED IN THE FIELD.
- PROPERTY LINES SHOWN ARE BASED ON VILLA PARK G.I.S. AND ARE APPROXIMATE.
- ALL STATIONING ON THE PROJECT IS APPROXIMATE. ALL WORK LOCATIONS SHALL BE APPROVED BY THE ENGINEER.
- THE CONTRACTOR SHALL MEASURE THE LOCATION OF ALL EXISTING PAVEMENT MARKINGS PRIOR TO REMOVAL. THE CONTRACTOR SHALL REPLACE THE PAVEMENT MARKING AS SHOWN ON THE PLANS.
- THE R.O.W SHOWN IS FROM THE VILLA PARK GIS.
- THE CONTRACTOR SHALL VERIFY AND MARK THE LOCATION OF ALL UTILITIES WITHIN THE CONSTRUCTION LIMITS AND IDENTIFY ANY UTILITY CONFLICTS PRIOR TO THE START OF CONSTRUCTION.
- THE CONTRACTOR SHALL BE RESPONSIBLE FOR PROTECTING UTILITY PROPERTY FROM CONSTRUCTION OPERATIONS AS OUTLINED IN ARTICLE 107.31 OF THE STANDARD SPECIFICATIONS. THE J.U.L.I.E PHONE NUMBER IS: 800-892-0123. A MINIMUM OF 48 HOURS ADVANCE NOTICE IS REQUIRED.

COMMITMENTS

- NONE.

FILE NAME =	USER NAME = User:BEIdringhoff	DESIGNED -	REVISED -	STATE OF ILLINOIS DEPARTMENT OF TRANSPORTATION	HIGH RIDGE ROAD INDEX OF SHEETS, STANDARDS, GENERAL NOTES, AND COMMITMENTS	F.A.U. RTE.	SECTION	COUNTY	TOTAL SHEETS	SHEET NO.	
P:\V0048170_Villa Park - High Ridge Rd	P:\PH I\Plans\Sheets\Index General Notes.dgn	DRAWN -	REVISED -			2996	15-00095-00-RS	DuPAGE	12	2	
Default	PLOT SCALE = 1:8000' / 1/4"	CHECKED -	REVISED -			CONTRACT NO. 61C42					
	PLOT DATE = 12/11/2015	DATE -	REVISED -			ILLINOIS FED. AID PROJECT					

SUMMARY OF QUANTITIES

CODE NO.	ITEM	UNIT	TOTAL QUANTITY	ROADWAY STU FUNDS 75% FEDERAL 25% LOCAL 0005
20200100	EARTH EXCAVATION	CU YD	407	407
20800150	TRENCH BACKFILL	CU YD	30	30
25000110	SEEDING, CLASS 1A	ACRE	0.25	0.25
35101400	AGGREGATE BASE COURSE, TYPE B	TON	350	350
35200500	CEMENT	100 WT	3,670	3,670
40201000	AGGREGATE FOR TEMPORARY ACCESS	TON	44	44
Δ 40600275	BITUMINOUS MATERIALS (PRIME COAT)	POUND	3,030	3,030
40600827	POLYMERIZED LEVELING BINDER (MACHINE METHOD), IL-4.75, N50	TON	367	367
40600982	HOT-MIX ASPHALT SURFACE REMOVAL - BUTT JOINT	SQ YD	184	184
40603335	HOT-MIX ASPHALT SURFACE COURSE, MIX "D", N50	TON	763	763
42400100	PORTLAND CEMENT CONCRETE SIDEWALK 4 INCH	SQ FT	390	390
42400800	DETECTABLE WARNINGS	SQ FT	48	48
44000100	PAVEMENT REMOVAL	SQ YD	58	58
44000300	CURB REMOVAL	FOOT	20	20
44000600	SIDEWALK REMOVAL	SQ FT	390	390
48101500	AGGREGATE SHOULDERS, TYPE B 6"	SQ YD	1220	1220
50105220	PIPE CULVERT REMOVAL	FOOT	340	340
54213447	END SECTIONS 12"	EACH	2	2
54213453	END SECTIONS 18"	EACH	8	8
54213471	END SECTIONS 36"	EACH	4	4
542D0217	PIPE CULVERTS, CLASS D, TYPE 1 12"	FOOT	30	30
542D0223	PIPE CULVERTS, CLASS D, TYPE 1 18"	FOOT	184	184
542D0241	PIPE CULVERTS, CLASS D, TYPE 1 36"	FOOT	125	125
60600605	CONCRETE CURB, TYPE B	FOOT	20	20
67100100	MOBILIZATION	LSUM	1	1
* 78000100	THERMOPLASTIC PAVEMENT MARKING - LETTERS AND SYMBOLS	SO FT	78	78
* 78000200	THERMOPLASTIC PAVEMENT MARKING - LINE 4"	FOOT	594	594
* 78000650	THERMOPLASTIC PAVEMENT MARKING - LINE 24"	FOOT	94	94
Δ X2020110	GRADING AND SHAPING SHOULDERS	UNIT	37	37
Δ X7010216	TRAFFIC CONTROL AND PROTECTION (SPECIAL)	LSUM	1	1
Δ XX009077	FULL-DEPTH RECLAMATION WITH CEMENT	SQ YD	6,660	6,660

LEGEND

Δ = SPECIAL PROVISION

* = SPECIALITY ITEMS

FILE NAME *	USER NAME = User:BEldringhoff	DESIGNED -	REVISED -	STATE OF ILLINOIS DEPARTMENT OF TRANSPORTATION	HIGH RIDGE ROAD SUMMARY OF QUANTITIES				F.A.U. RTE.	SECTION	COUNTY	TOTAL SHEETS	SHEET NO.	
P:\V0040178_Villa Park - High Ridge Rd L	FO PH II\Plans\Sheets\Summary Of Quantities	DRAWN -	REVISED -		SCALE:	SHEET	OF	SHEETS	STA.	TO STA.	2996	15-00095-00-RS	DUPAGE	12 3
Default	PLOT SCALE = 1:8000 ' / in.	CHECKED -	REVISED -						CONTRACT NO. 61C42					
	PLOT DATE = 12/11/2015	DATE -	REVISED -						ILLINOIS FED. AID PROJECT					

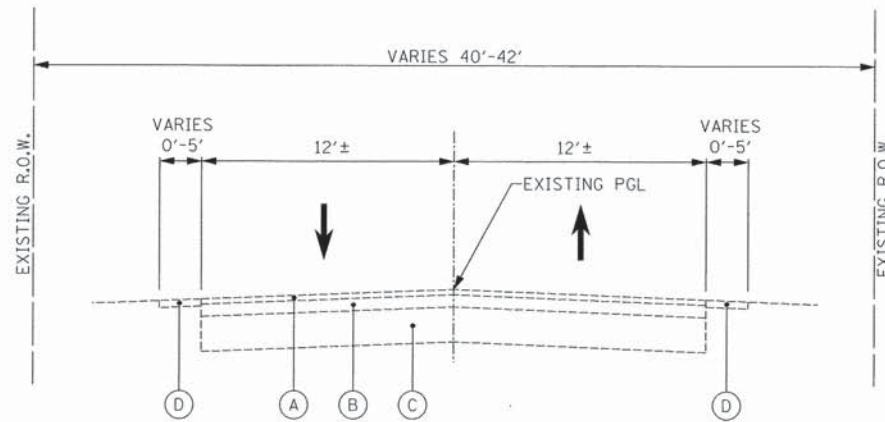

EXISTING TYPICAL SECTION
HIGH RIDGE ROAD
STA. 26+09.81 TO 46+35.00

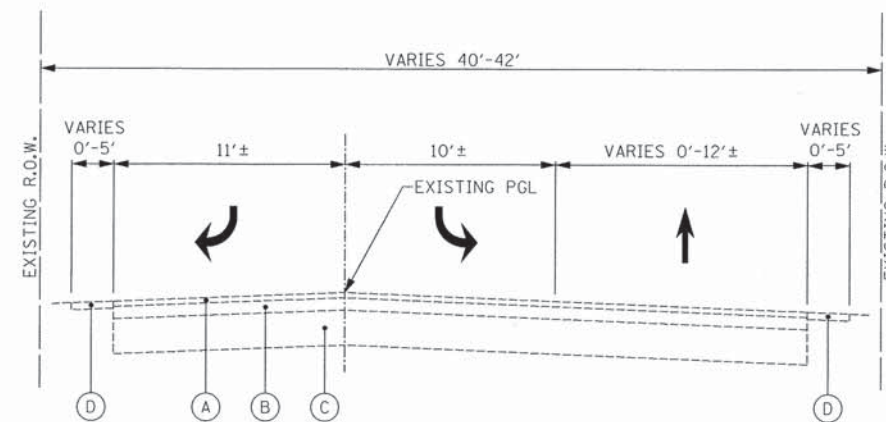

EXISTING TYPICAL SECTION
HIGH RIDGE ROAD
STA. 46+35.00 TO 49+79.47

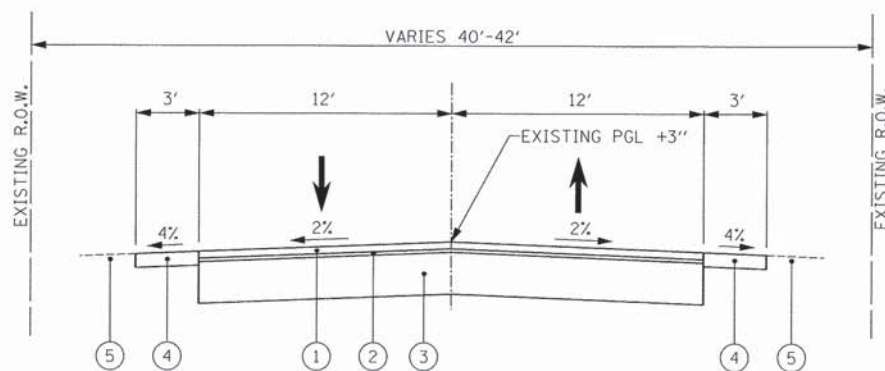

PROPOSED TYPICAL SECTION
HIGH RIDGE ROAD
STA. 26+09.81 TO 46+35.00

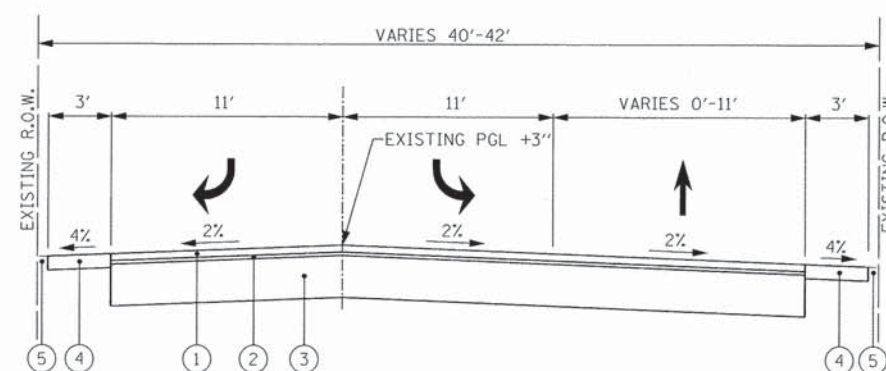

PROPOSED TYPICAL SECTION
HIGH RIDGE ROAD
STA. 46+35.00 TO 49+79.47

EXISTING LEGEND

- (A) HOT-MIX ASPHALT SURFACE COURSE - VARIES 1"-2"
- (B) HOT-MIX ASPHALT BINDER COURSE - VARIES 2"-6"
- (C) CRUSHED LIMESTONE BASE - VARIES 6"-14"
- (D) AGGREGATE SHOULDER - VARIES

PROPOSED LEGEND

- (1) HOT-MIX ASPHALT SURFACE COURSE, MIX "D", N50, 2"
- (2) POLYMERIZED LEVELING BINDER (MACHINE METHOD), IL-19.0, N50, 1"
- (3) FULL-DEPTH RECLAMATION, 12"
- (4) AGGREGATE SHOULDERS, TYPE B 6"
- (5) SEEDING, CLASS 1A

NOTE:
THE EXISTING PAVEMENT MATERIALS AND THICKNESSES WERE OBTAINED FROM PAVEMENT CORES. THIS REPRESENTS THE BEST AVAILABLE EXISTING PAVEMENT INFORMATION. NO ADDITIONAL COMPENSATION WILL BE ALLOWED FOR PAY ITEMS RELATED TO EXISTING PAVEMENT DUE TO VARIATIONS IN EXISTING PAVEMENT MATERIALS OR THICKNESS.

HOT-MIX ASPHALT MIXTURE REQUIREMENTS

MIXTURE TYPE	AIR VOIDS
ROADWAY	
HOT-MIX ASPHALT SURFACE COURSE, MIX, "D", N50	4.0% @ 50 Gyr.
POLYMERIZED LEVELING BINDER (MACHINE METHOD), IL-4.75, N50	3.5% @ 50 Gyr.

THE UNIT WEIGHT USED TO CALCULATE ALL HMA SURFACE MIXTURE QUANTITIES IS 112 LBS/50 YD/IN.

THE "AC TYPE" FOR POLYMERIZED HMA MIXES SHALL BE "SBS/SBR PG 76-22" AND FOR NON-POLYMERIZED HMA THE "AC TYPE" SHALL BE "PG 64-22" UNLESS MODIFIED BY DISTRICT ONE SPECIAL PROVISIONS. FOR USE OF RECYCLED MATERIAL SEE SPECIAL PROVISIONS.

FILE NAME =	USER NAME = User:BEIDrsinghoff	DESIGNED -	REVISED -
P:\V0040170_Villa Park - High Ridge Rd L	FD PH I\Plans\Sheets\Typical Sections.dgn	DRAWN -	REVISED -
Default	PLOT SCALE = 1:8000' / 1"	CHECKED -	REVISED -
	PLOT DATE = 12/11/2015	DATE -	REVISED -

STATE OF ILLINOIS
DEPARTMENT OF TRANSPORTATION

HIGH RIDGE ROAD
TYPICAL SECTIONS

SCALE: N.T.S SHEET OF SHEETS STA. TO STA.

F.A.J. RTE.	SECTION	COUNTY	TOTAL SHEETS	SHEET NO.
2996	15-00095-00-RS	DuPAGE	12	4
CONTRACT NO. 61C42				
ILLINOIS FED. AID PROJECT				

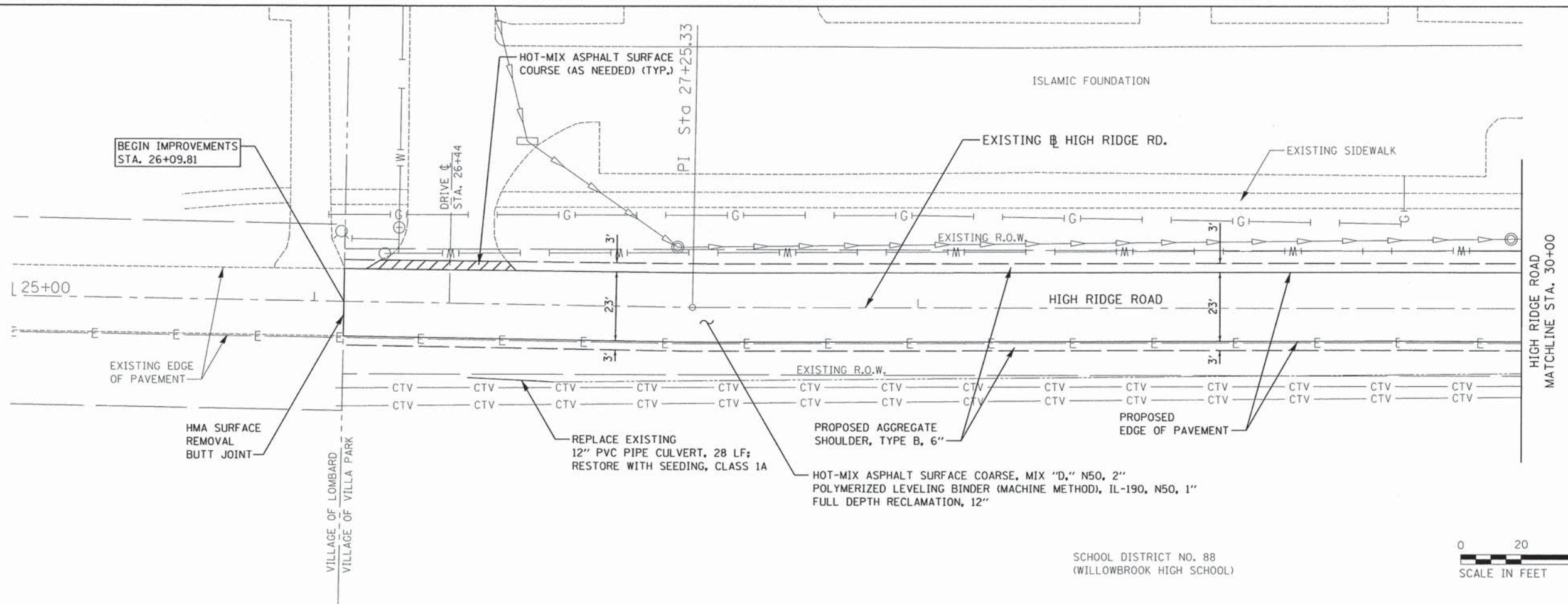

SCHOOL DISTRICT NO. 88
(WILLOWBROOK HIGH SCHOOL)

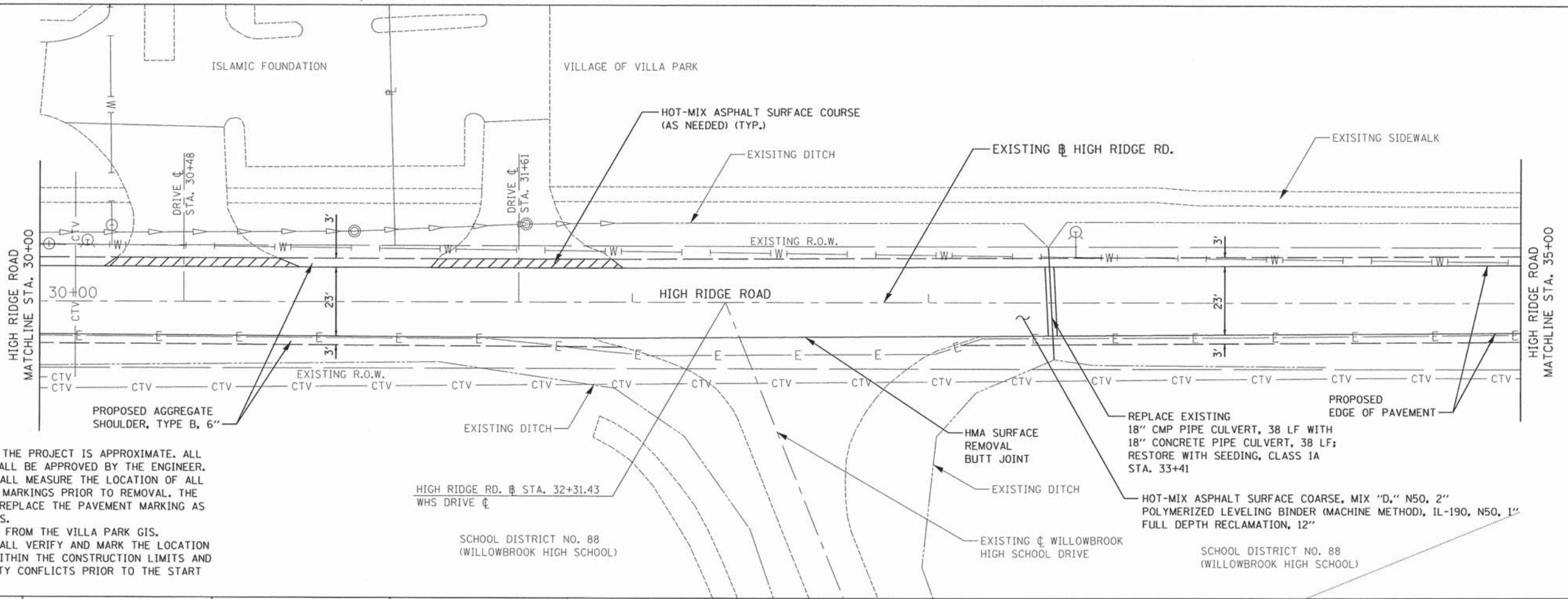

- NOTES**
1. ALL STATIONING ON THE PROJECT IS APPROXIMATE. ALL WORK LOCATIONS SHALL BE APPROVED BY THE ENGINEER.
 2. THE CONTRACTOR SHALL MEASURE THE LOCATION OF ALL EXISTING PAVEMENT MARKINGS PRIOR TO REMOVAL. THE CONTRACTOR SHALL REPLACE THE PAVEMENT MARKING AS SHOWN ON THE PLANS.
 3. THE R.O.W SHOWN IS FROM THE VILLA PARK GIS.
 4. THE CONTRACTOR SHALL VERIFY AND MARK THE LOCATION OF ALL UTILITIES WITHIN THE CONSTRUCTION LIMITS AND IDENTIFY ANY UTILITY CONFLICTS PRIOR TO THE START OF CONSTRUCTION.

FILE NAME =	USER NAME = User:BEI\dringhoff	DESIGNED -	REVISED -	STATE OF ILLINOIS DEPARTMENT OF TRANSPORTATION	HIGH RIDGE ROAD ROADWAY PLAN	F.A.U. RTE.	SECTION	COUNTY	TOTAL SHEETS	SHEET NO.	
P:\V0048170_Villa Park - High Ridge Rd L	FD PH I\Plans\Sheets\Plan sht 01.dgn	DRAWN -	REVISED -			2996	15-00095-00-R5	DuPAGE	12	5	
Default	PLOT SCALE = 20.0000' / 1" =	CHECKED -	REVISED -			SCALE: 1"=20'		SHEET OF SHEETS		STA. 25+00 TO STA. 35+00	
	PLOT DATE = 12/11/2015	DATE -	REVISED -			CONTRACT NO. 61C42 [ILLINOIS] FED. AID PROJECT					

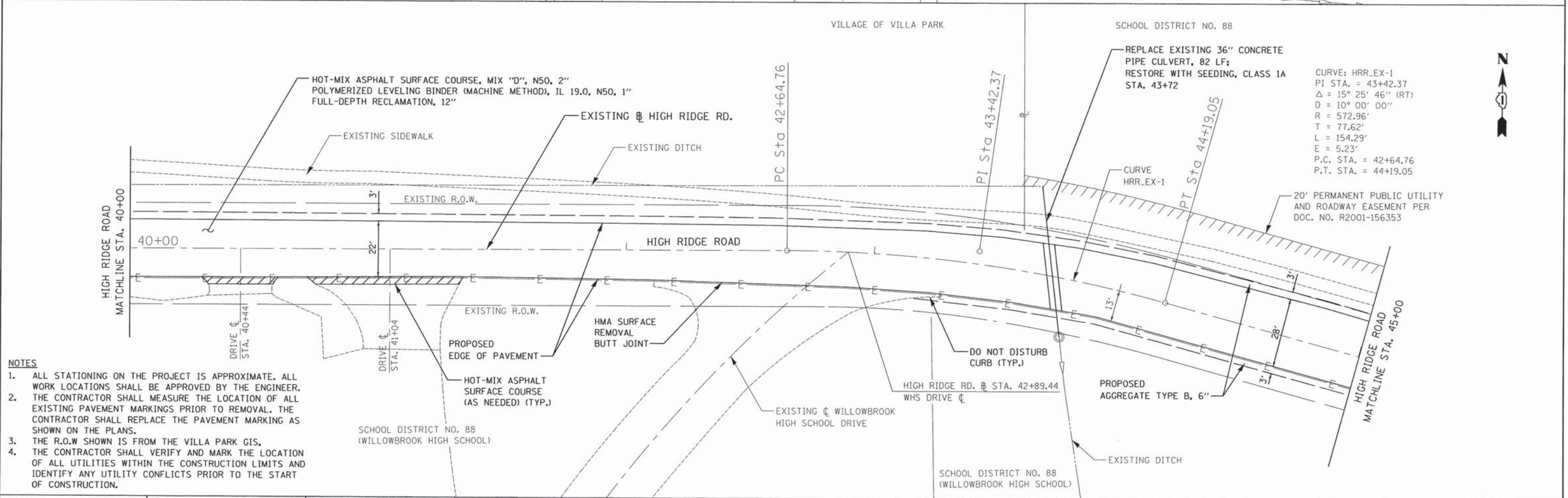
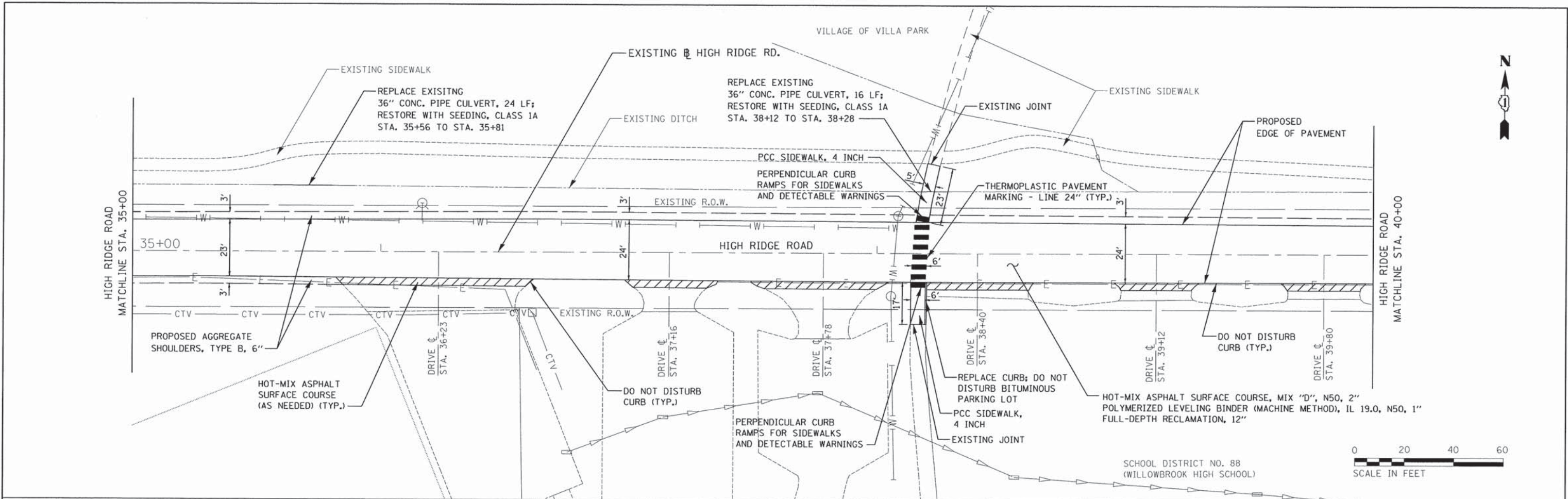

- NOTES**
1. ALL STATIONING ON THE PROJECT IS APPROXIMATE. ALL WORK LOCATIONS SHALL BE APPROVED BY THE ENGINEER.
 2. THE CONTRACTOR SHALL MEASURE THE LOCATION OF ALL EXISTING PAVEMENT MARKINGS PRIOR TO REMOVAL. THE CONTRACTOR SHALL REPLACE THE PAVEMENT MARKING AS SHOWN ON THE PLANS.
 3. THE R.O.W SHOWN IS FROM THE VILLA PARK GIS.
 4. THE CONTRACTOR SHALL VERIFY AND MARK THE LOCATION OF ALL UTILITIES WITHIN THE CONSTRUCTION LIMITS AND IDENTIFY ANY UTILITY CONFLICTS PRIOR TO THE START OF CONSTRUCTION.

FILE NAME =	USER NAME = Users\Beldringhoff	DESIGNED -	REVISED -	STATE OF ILLINOIS DEPARTMENT OF TRANSPORTATION	HIGH RIDGE ROAD ROADWAY PLAN	F.A.U. RTE.	SECTION	COUNTY	TOTAL SHEETS	SHEET NO.
P:\V0040170.Villa Park - High Ridge Rd L&P PH I\Plans\Sheets\Plan sht 02.dgn	DRAWN -	REVISED -	2996			15-00095-00-RS	DuPAGE	12	6	
PLOT SCALE = 20.0000' = 1"	CHECKED -	REVISED -	CONTRACT NO. 61C42							
PLOT DATE = 12/11/2015	DATE -	REVISED -	ILLINOIS FED. AID PROJECT							

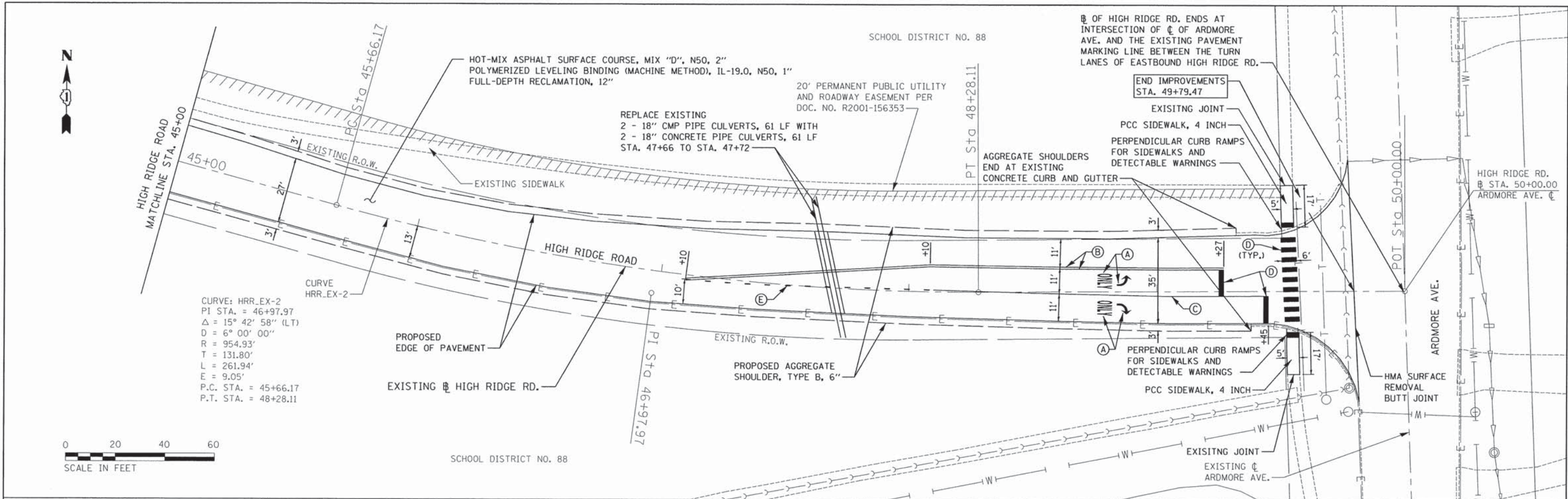

PAVEMENT MARKING LEGEND

- (A) THERMOPLASTIC PAVEMENT MARKING - LETTERS AND SYMBOLS
- (B) THERMOPLASTIC PAVEMENT MARKING - LINE 4" (YELLOW)
- (C) THERMOPLASTIC PAVEMENT MARKING - LINE 4" (WHITE)
- (D) THERMOPLASTIC PAVEMENT MARKING - LINE 24" (WHITE)
- (E) THERMOPLASTIC PAVEMENT MARKING - LINE 4" (WHITE) (2' DASH, 6' SKIP)

NOTES

1. ALL STATIONING ON THE PROJECT IS APPROXIMATE. ALL WORK LOCATIONS SHALL BE APPROVED BY THE ENGINEER.
2. THE CONTRACTOR SHALL MEASURE THE LOCATION OF ALL EXISTING PAVEMENT MARKINGS PRIOR TO REMOVAL. THE CONTRACTOR SHALL REPLACE THE PAVEMENT MARKING AS SHOWN ON THE PLANS.
3. THE R.O.W SHOWN IS FROM THE VILLA PARK GIS.
4. THE CONTRACTOR SHALL VERIFY AND MARK THE LOCATION OF ALL UTILITIES WITHIN THE CONSTRUCTION LIMITS AND IDENTIFY ANY UTILITY CONFLICTS PRIOR TO THE START OF CONSTRUCTION.

FILE NAME =	USER NAME = User:BEIdringhoff	DESIGNED -	REVISED -	STATE OF ILLINOIS DEPARTMENT OF TRANSPORTATION	HIGH RIDGE ROAD ROADWAY PLAN	F.A.J. RTE.	SECTION	COUNTY	TOTAL SHEETS	SHEET NO.
P:\V0040170-Villa Park - High Ridge Rd L	FD PH I\Plans\Sheets\Plan sht 03.dgn	DRAWN -	REVISED -			2996	15-00095-00-RS	DuPAGE	12	7
Default	PLOT SCALE = 20.0000' / in.	CHECKED -	REVISED -			CONTRACT NO. 61C42				
	PLOT DATE = 12/11/2015	DATE -	REVISED -			ILLINOIS FED. AID PROJECT				

SCALE: 1"=20' SHEET OF SHEETS STA. 45+00 TO STA. 50+00

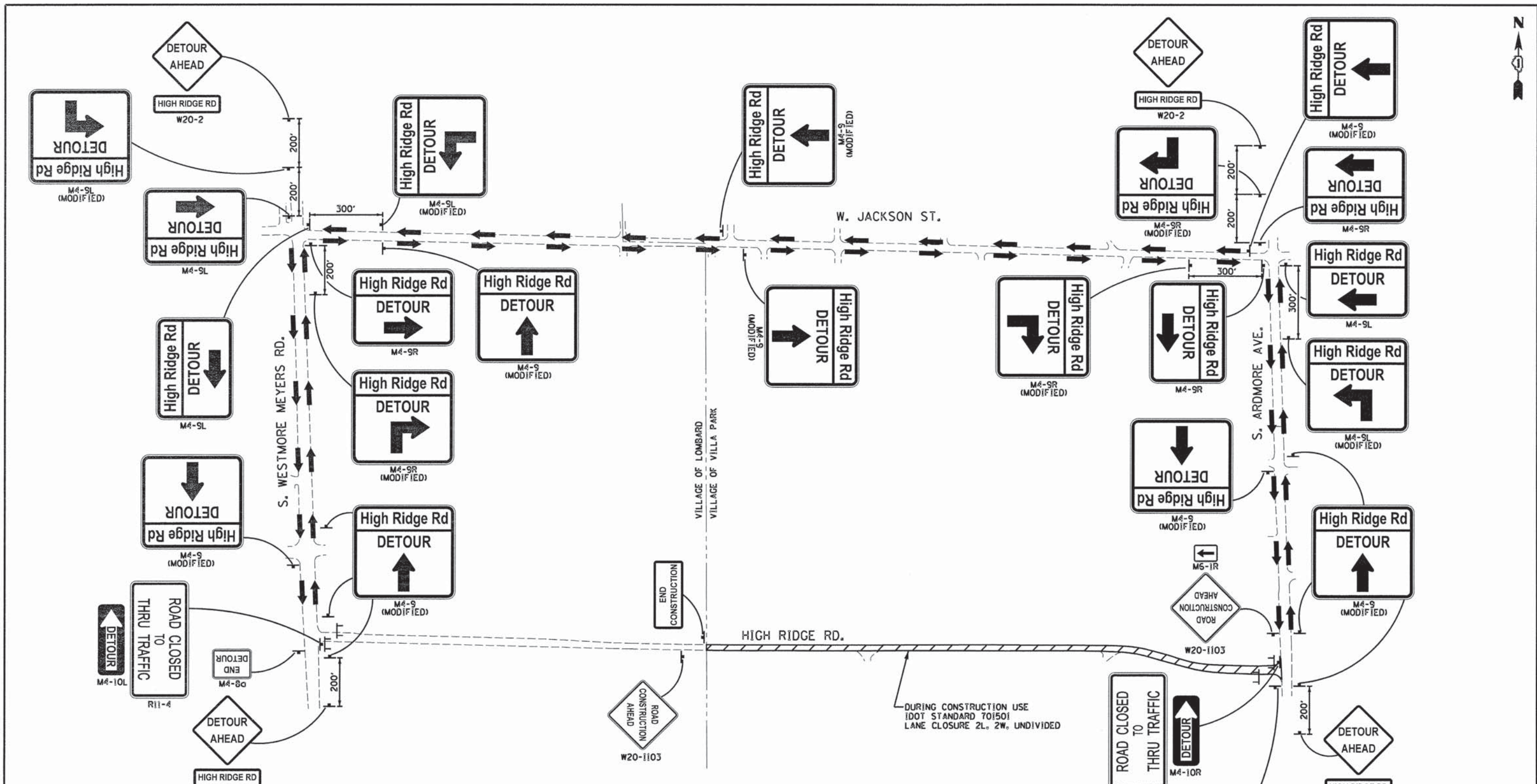

- NOTES:**
1. DETOUR IS ON LOCAL ROADS.
 2. THE CONTRACTOR SHALL NOTIFY AND OBTAIN ANY PERMITS FROM THE VILLAGE OF LOMBARD 14 DAYS PRIOR TO INSTALLATION OF THE DETOUR.
 3. THE CONTRACTOR SHALL COORDINATE THE CONSTRUCTION SCHEDULE WITH THE VILLAGES OF LOMBARD AND VILLA PARK, THE ISLAMIC FOUNDATION AND WILLOWBROOK HIGH SCHOOL SO THAT CONSTRUCTION ACTIVITIES DO NOT CONFLICT WITH EVENTS OR TIMES OF WORSHIP.
 4. ACCESS TO ADJACENT PROPERTIES SHALL BE MAINTAINED AT ALL TIMES.
 5. STATE HIGHWAY STANDARDS FOR TRAFFIC CONTROL SHALL BE INCLUDED IN THE COST OF "TRAFFIC CONTROL PLAN."

LEGEND

- CONSTRUCTION AREA
- DIRECTION OF TRAFFIC
- SIGN
- BARRICADE, TYPE III

0 200 400 600
SCALE IN FEET

FILE NAME =	USER NAME = User:BELdr:ng:hoff	DESIGNED -	REVISED -	STATE OF ILLINOIS DEPARTMENT OF TRANSPORTATION	HIGH RIDGE ROAD DETOUR PLAN	F.A.U. RTE.	SECTION	COUNTY	TOTAL SHEETS	SHEET NO.	
P:\V0848178.V:11a Park - High Ridge Rd	FD PH 11\Plans\Sheets\Detour Plan.dgn	DRAWN -	REVISED -			2996	15-00095-00-R5	DUPAGE	12	8	
Default	PLOT SCALE = 400.0000' / 1"	CHECKED -	REVISED -			CONTRACT NO. 61C42					
	PLOT DATE = 12/22/2015	DATE -	REVISED -			ILLINOIS FED. AID PROJECT					
						SCALE: 1" = 200'		SHEET OF SHEETS		STA. TO STA.	

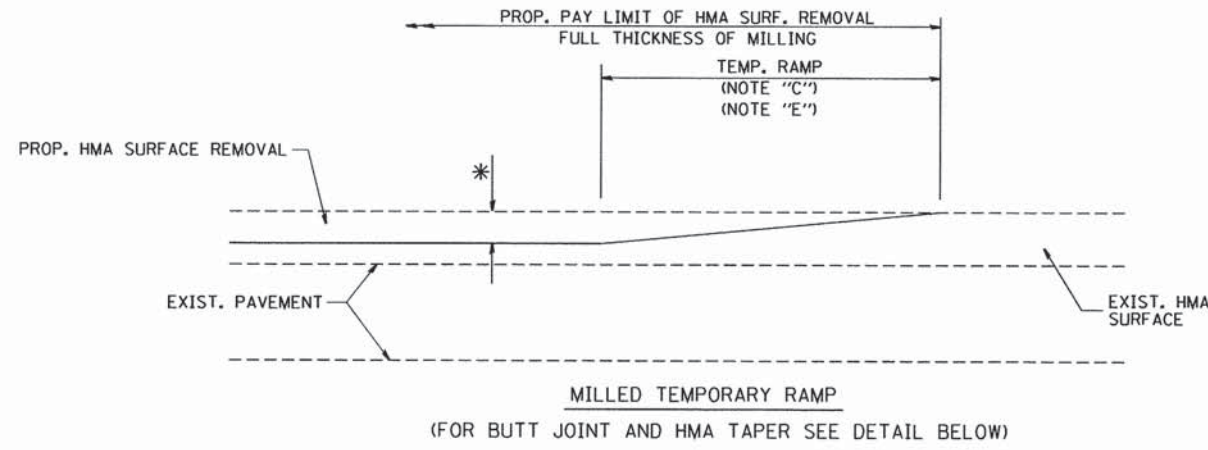

OPTION 1

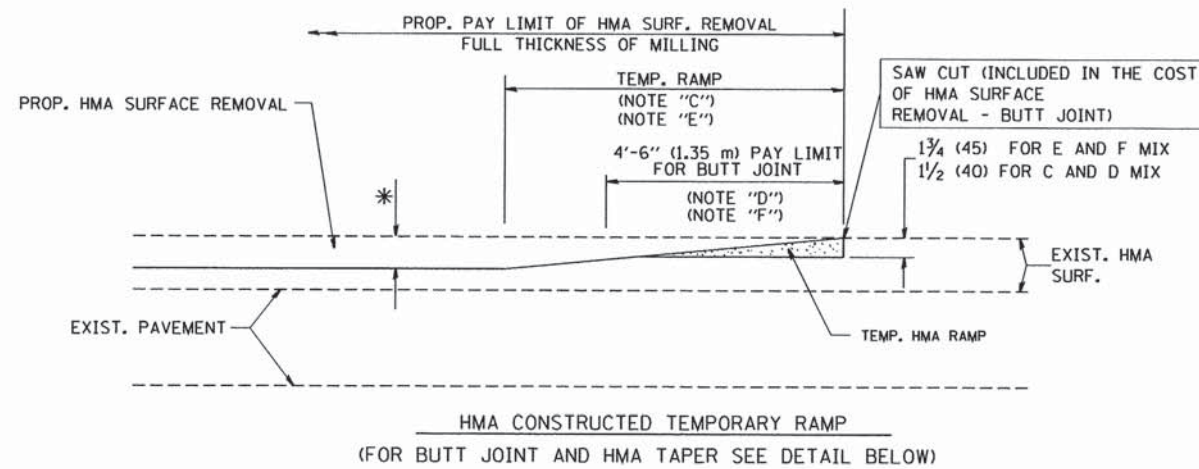

**OPTION 2
TYPICAL TEMPORARY RAMP**

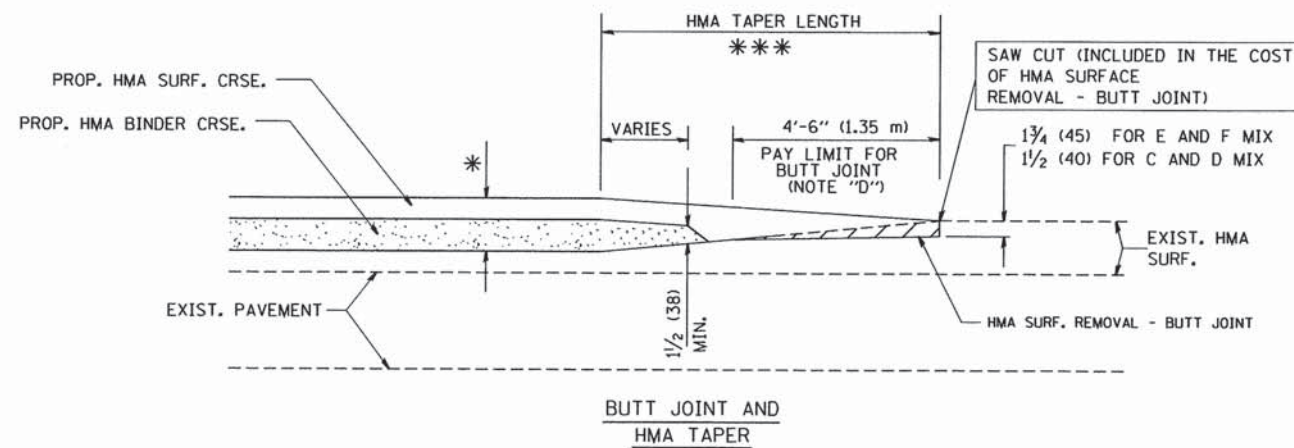

**TYPICAL BUTT JOINT AND HMA TAPER
FOR MILLING AND RESURFACING**

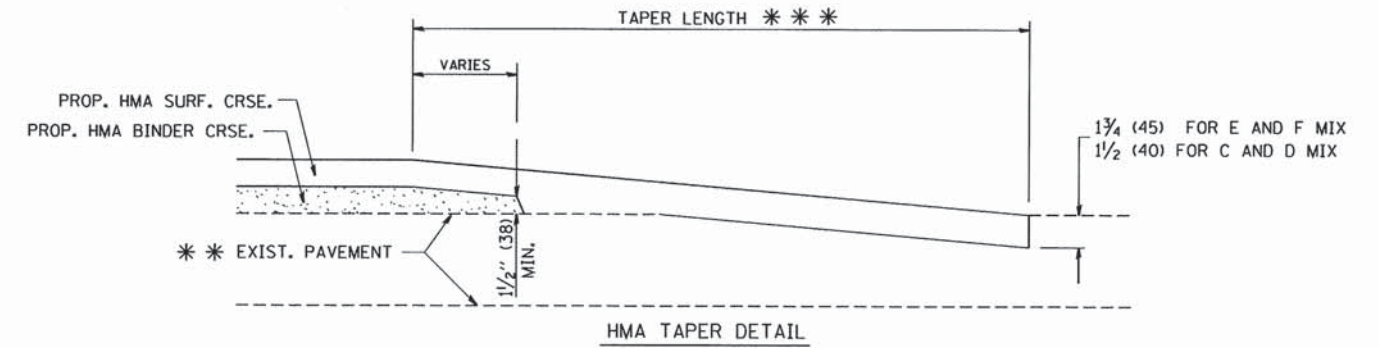
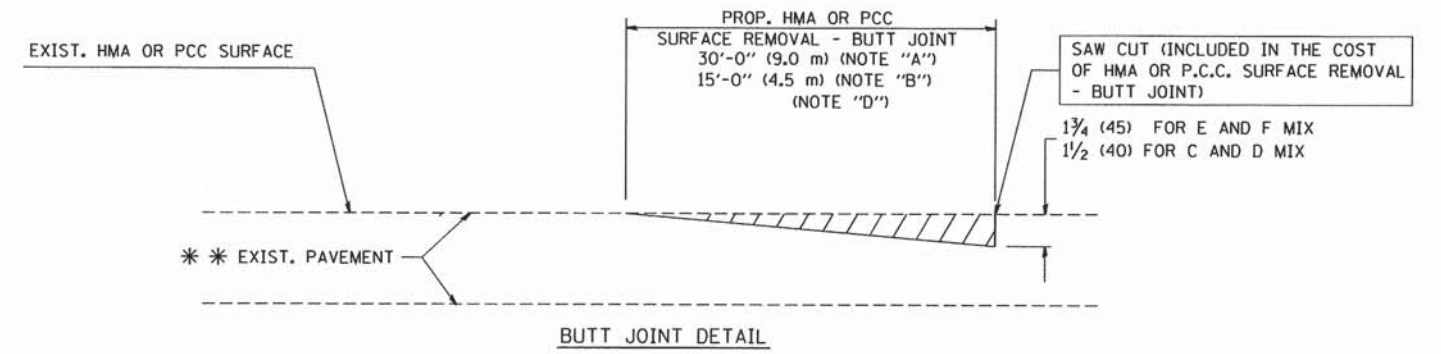

**TYPICAL BUTT JOINT AND HMA TAPER
FOR RESURFACING ONLY**

*** PC CONCRETE, HMA OR HMA RESURFACED PAVEMENT.

NOTES

- A: MAINLINE ROADWAYS AND MAJOR SIDE ROADS.
 - B: MINOR SIDE ROADS.
 - C: THE TEMP. RAMP SHALL BE CONSTRUCTED IMMEDIATELY UPON REMOVAL OF THE EXISTING HMA SURFACE.
 - D: THE BUTT JOINT SHALL BE CONSTRUCTED IMMEDIATELY PRIOR TO PLACING THE PROPOSED HMA COURSES.
 - E: TAPER THE TEMP. RAMP AT A RATE OF 3'-0" (900 mm) PER 1 INCH (25 mm) OF MILLING THICKNESS.
 - F: INSTALLATION AND REMOVAL OF THE 4'-6" (1.35 m) TEMP. RAMP IS INCLUDED IN COST OF HMA SURFACE REMOVAL - BUTT JOINT
 - G: SEE ARTICLE 406.08 AND 406.14 OF THE STANDARD SPECIFICATIONS FOR "HMA AND/OR PCC SURFACE REMOVAL, BUTT JOINT".
- * SEE TYPICAL SECTIONS FOR MILLING THICKNESS.
- *** 20'-0" (6.1 m) PER 1 (25) RESURFACING (NOTE "A")
10'-0" (3.0 m) PER 1 (25) RESURFACING (NOTE "B")

BASIS OF PAYMENT:

THE BUTT JOINT WILL BE PAID FOR AT THE CONTRACT UNIT PRICE PER SQUARE YARD (SQUARE METER) FOR "HOT-MIX ASPHALT SURFACE REMOVAL - BUTT JOINT" OR FOR "PORTLAND CEMENT CONCRETE SURFACE REMOVAL - BUTT JOINT".

ALL DIMENSIONS ARE IN INCHES (MILLIMETERS) UNLESS OTHERWISE SHOWN.

FILE NAME = W:\diststd\22x34\bd32.dgn

USER NAME = goglionob	DESIGNED - M. DE YONG	REVISED - R. SHAH 10-25-94
PLOT SCALE = 50,0000 "/ IN.	DRAWN -	REVISED - A. ABBAS 03-21-97
PLOT DATE = 1/4/2008	CHECKED -	REVISED - M. GOMEZ 04-06-01
	DATE - 06-13-90	REVISED - R. BORO 01-01-07

**STATE OF ILLINOIS
DEPARTMENT OF TRANSPORTATION**

**BUTT JOINT AND
HMA TAPER DETAILS**

SCALE: NONE SHEET NO. 1 OF 1 SHEETS STA. TO STA.

F.A.U. RTE. 2996	SECTION 15-00095-00-RS	COUNTY DuPAGE	TOTAL SHEETS 12	SHEET NO. 9
BD400-05 BD32			CONTRACT NO. 61C42	
FED. ROAD DIST. NO. 1 ILLINOIS FED. AID PROJECT				

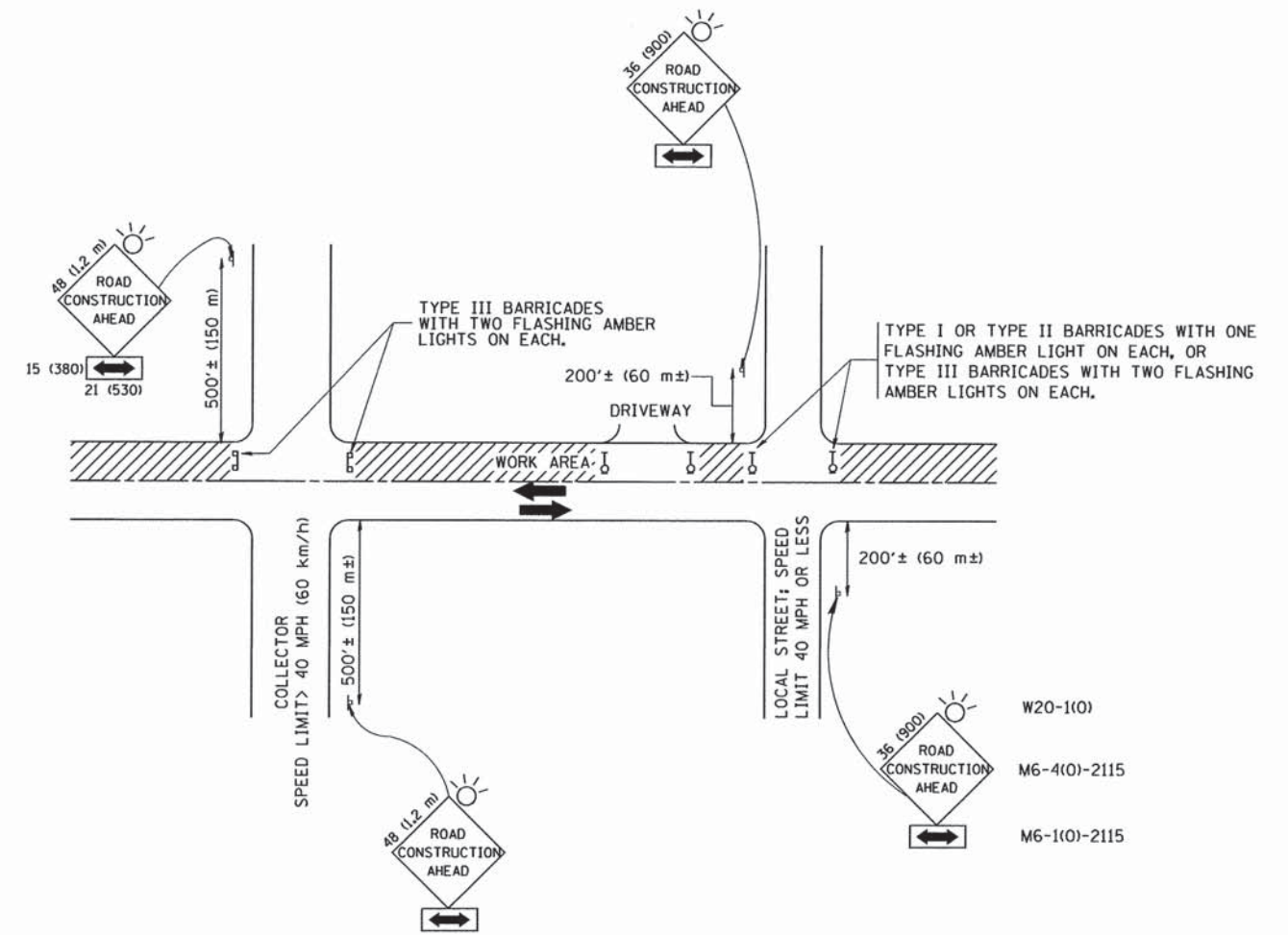

W20-1(0)
M6-4(0)-2115
M6-1(0)-2115

TRAFFIC CONTROL AND PROTECTION FOR SIDE ROADS, INTERSECTIONS, AND DRIVEWAYS

NOTES:

- A. FOR NO LANE RESTRICTION ON THE SIDE ROAD OR DRIVEWAYS
 1. SIDE ROAD WITH A SPEED LIMIT OF 40 MPH (60 km/h) OR LESS AS SHOWN ON THE DRAWING AND AS DIRECTED BY THE ENGINEER:
 - a) ONE ROAD CONSTRUCTION AHEAD SIGN 36 x 36 (900x900) WITH A FLASHER AND FLAG MOUNTED ON IT APPROXIMATELY 200' (60 m) IN ADVANCE OF THE MAIN ROUTE.
 - b) THE CLOSED PORTION OF THE MAIN ROUTE SHALL BE PROTECTED BY BLOCKING WITH TYPE I, TYPE II OR TYPE III BARRICADES, 1/3 OF THE CROSS SECTION OF THE CLOSED PORTION.
 2. SIDE ROAD WITH A SPEED LIMIT GREATER THAN 40 MPH (60 km/h) AS SHOWN ON THE DRAWING AND AS DIRECTED BY THE ENGINEER:
 - a) ONE ROAD CONSTRUCTION AHEAD SIGN 48 x 48 (1.2 m x 1.2 m) WITH A FLASHER MOUNTED ON IT APPROXIMATELY 500' (150 m) IN ADVANCE OF THE MAIN ROUTE.
 - b) THE CLOSED PORTION OF THE MAIN ROUTE SHALL BE PROTECTED BY BLOCKING WITH TYPE III BARRICADES, 1/2 OF THE CROSS SECTION OF THE CLOSED PORTION.
 3. WHEN THE SIDE ROAD LIES BETWEEN THE BEGINNING OF THE MAINLINE SIGNING AND THE WORK ZONE, A SINGLE HEADED ARROW (M6-1) SHALL BE USED IN LIEU OF THE DOUBLE HEADED ARROW (M6-4).
- B. FOR A LANE CLOSURE ON A SIDE ROAD OR DRIVEWAY:

USE APPLICABLE PORTIONS OF THE TYPICAL APPLICATION OF TRAFFIC CONTROL DEVICES (STD. 701501, STD. 701606 OR THE APPROPRIATE STANDARD). THE SPACING OF SIGNS AND BARRICADES SHALL BE ADJUSTED FOR FIELD CONDITIONS AS DIRECTED BY THE ENGINEER. THE DIRECTIONAL ARROW SHALL BE COVERED OR REMOVED WHEN NO LONGER CONSISTENT WITH THE SIDE ROAD LANE CLOSURE.
- C. ADVANCE WARNING SIGNS ARE TO BE OMITTED ON DRIVEWAY UNLESS OTHERWISE NOTED.
- D. THE TRAFFIC CONTROL AND PROTECTION FOR SIDE ROADS, INTERSECTIONS, AND DRIVEWAYS SHALL BE INCIDENTAL TO THE COST OF SPECIFIED TRAFFIC CONTROL STANDARDS OR ITEMS.

All dimensions are in millimeters (inches) unless otherwise shown.

FILE NAME = W:\diststd\22x34\sc10.dgn

USER NAME = goglianobt	DESIGNED - LHA	REVISED - J. OBERLE 10-18-95
PLOT SCALE = 50.000' / IN.	CHECKED -	REVISED - A. HOUSEH 03-06-96
PLOT DATE = 1/4/2008	DATE - 06-89	REVISED - T. RAMMACHER 01-06-00

STATE OF ILLINOIS
DEPARTMENT OF TRANSPORTATION

TRAFFIC CONTROL AND PROTECTION FOR SIDE ROADS, INTERSECTIONS, AND DRIVEWAYS			
SCALE: NONE	SHEET NO. 1 OF 1 SHEETS	STA.	TO STA.

F.A.U. RTE.	SECTION	COUNTY	TOTAL SHEETS	SHEET NO.
2996	15-00095-00-RS	DuPAGE	12	10
TC-10			CONTRACT NO. 61C42	
FED. ROAD DIST. NO. 1 ILLINOIS FED. AID PROJECT				

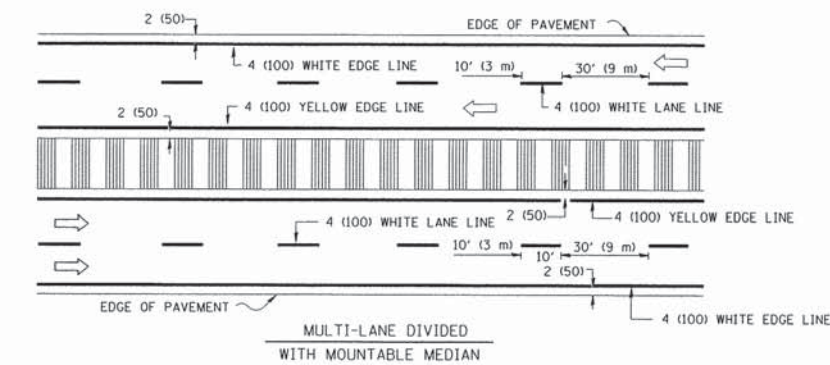
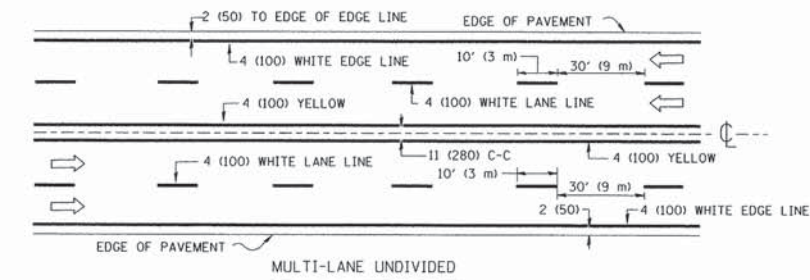
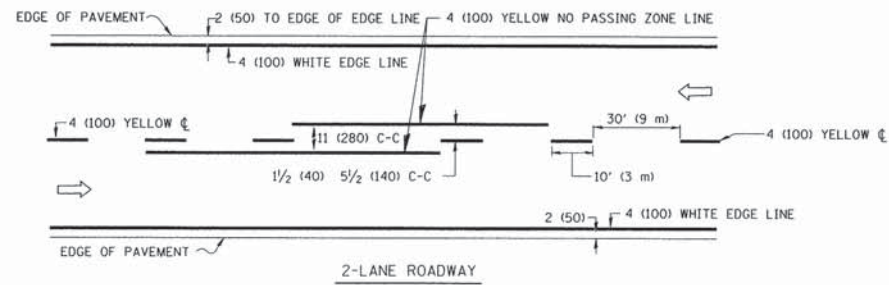

NOTE: MEDIANS WITH BARRIER CURB DO NOT REQUIRE AN EDGE LINE

TYPICAL LANE AND EDGE LINE MARKING

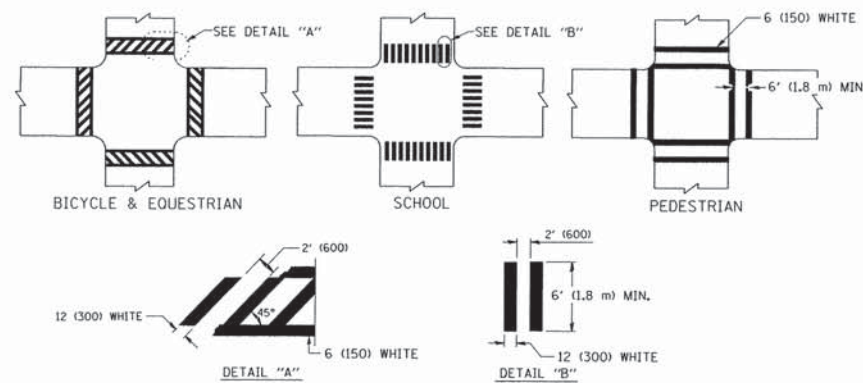

TYPICAL CROSSWALK MARKING

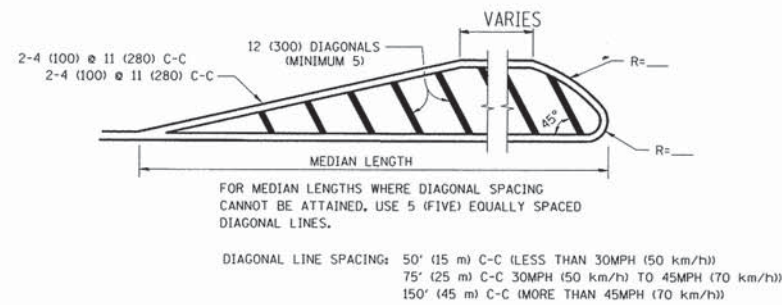
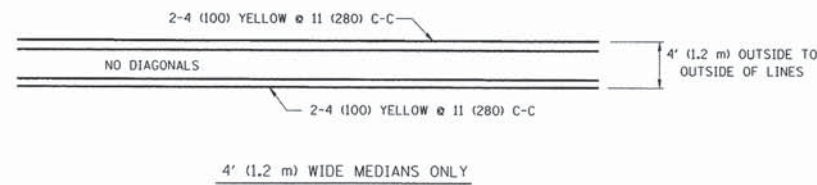

MEDIANS OVER 4' (1.2 m) WIDE

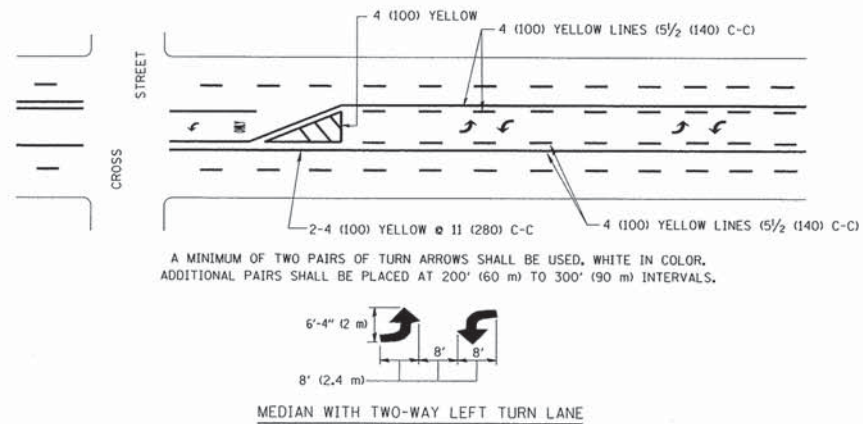

TYPICAL PAINTED MEDIAN MARKING

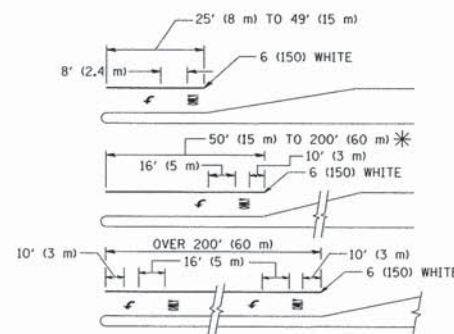

FULL SIZE LETTERS 8' (2.4 m) AND ARROWS SHALL BE USED.
AREA = 15.6 SQ. FT. (1.5 m²) ONLY AREA = 20.8 SQ. FT. (1.9 m²)

* TURN LANES IN EXCESS OF 400' (120 m) IN LENGTH MAY HAVE AN ADDITIONAL SET OF ARROW - "ONLY" INSTALLED MIDWAY BETWEEN THE OTHER TWO SETS OF ARROW - "ONLY".

TYPICAL LEFT (OR RIGHT) TURN LANE

TYPICAL TURN LANE MARKING

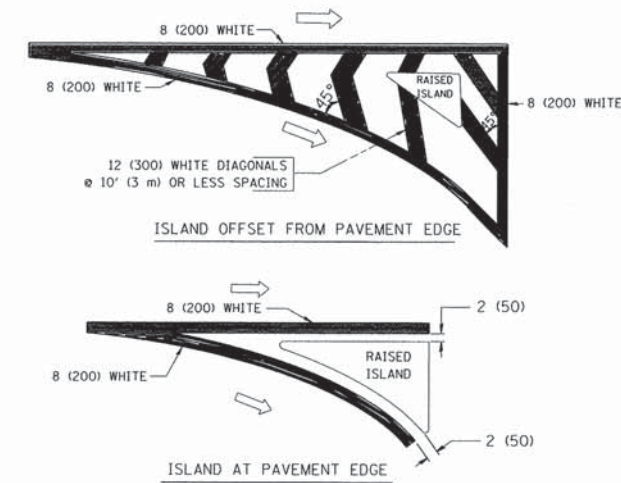

TYPICAL ISLAND MARKING

TYPE OF MARKING	WIDTH OF LINE	PATTERN	COLOR	SPACING / REMARKS
CENTERLINE ON 2 LANE PAVEMENT	4 (100)	SKIP-DASH	YELLOW	10' (3 m) LINE WITH 30' (9 m) SPACE
CENTERLINE ON MULTI-LANE UNDIVIDED PAVEMENT	2 @ 4 (100)	SOLID	YELLOW	11 (280) C-C
NO PASSING ZONE LINES: FOR ONE DIRECTION	4 (100)	SOLID	YELLOW	5/2 (140) C-C FROM SKIP-DASH CENTERLINE
NO PASSING ZONE LINES: FOR BOTH DIRECTIONS	2 @ 4 (100)	SOLID	YELLOW	11 (280) C-C OMIT SKIP-DASH CENTERLINE BETWEEN
LANE LINES	4 (100) 5 (125) ON FREEWAYS	SKIP-DASH SKIP-DASH	WHITE WHITE	10' (3 m) LINE WITH 30' (9 m) SPACE
DOTTED LINES (EXTENSIONS OF CENTER, LANE OR TURN LANE MARKINGS)	SAME AS LINE BEING EXTENDED	SKIP-DASH	SAME AS LINE BEING EXTENDED	2' (600) LINE WITH 6' (1.8 m) SPACE
EDGE LINES	4 (100)	SOLID	YELLOW-LEFT WHITE-RIGHT	OUTLINE MOUNTABLE MEDIANS IN YELLOW; EDGE LINES ARE NOT USED NEXT TO BARRIER CURB
TURN LANE MARKINGS	6 (150) LINE; FULL SIZE LETTERS & SYMBOLS (8' (2.4m))	SOLID	WHITE	SEE TYPICAL TURN LANE MARKING DETAIL
TWO WAY LEFT TURN MARKING	2 @ 4 (100) EACH DIRECTION	SKIP-DASH AND SOLID	YELLOW	10' (3 m) LINE WITH 30' (9 m) SPACE FOR SKIP-DASH; 5/2 (140) C-C BETWEEN SOLID LINE AND SKIP-DASH LINE
	8' (2.4m) LEFT ARROW	IN PAIRS	WHITE	SEE TYPICAL TWO-WAY LEFT TURN MARKING DETAIL
CROSSWALK LINES (PEDESTRIAN A. DIAGONALS (BIKE & EQUESTRIAN) B. LONGITUDINAL BARS (SCHOOL))	2 @ 6 (150) 12 (300) @ 45° 12 (300) @ 90°	SOLID SOLID SOLID	WHITE WHITE WHITE	NOT LESS THAN 6' (1.8 m) APART 2' (600) APART 2' (600) APART SEE TYPICAL CROSSWALK MARKING DETAILS.
STOP LINES	24 (600)	SOLID	WHITE	PLACE 4' (1.2 m) IN ADVANCE OF AND PARALLEL TO CROSSWALK, IF PRESENT. OTHERWISE, PLACE AT DESIRED STOPPING POINT, PARALLEL TO CROSSROAD CENTERLINE, WHERE POSSIBLE
PAINTED MEDIANS	2 @ 4 (100) WITH 12 (300) DIAGONALS @ 45°	SOLID	YELLOW: TWO WAY TRAFFIC WHITE: ONE WAY TRAFFIC	11 (280) C-C FOR THE DOUBLE LINE SEE TYPICAL PAINTED MEDIAN MARKING.
GORE MARKING AND CHANNELIZING LINES	8 (200) WITH 12 (300) DIAGONALS @ 45°	SOLID	WHITE	DIAGONALS: 15' (4.5 m) C-C (LESS THAN 30MPH (50 km/h)) 20' (6 m) C-C 30MPH (50 km/h) TO 45MPH (70 km/h) 30' (9 m) C-C (OVER 45MPH (70 km/h))
RAILROAD CROSSING	24 (600) TRANSVERSE LINES; "RR" IS 6' (1.8 m) LETTERS; 16 (400) LINE FOR "X"	SOLID	WHITE	SEE STATE STANDARD 780001 AREA OF: "R"=3.6 SQ. FT. (0.33 m ²) EACH "X"=54.0 SQ. FT. (5.0 m ²)
SHOULDER DIAGONALS	12 (300) @ 45°	SOLID	WHITE - RIGHT YELLOW - LEFT	50' (15 m) C-C (LESS THAN 30MPH (50 km/h)) 75' (25 m) C-C (30 MPH (50 km/h) TO 45MPH (70 km/h)) 150' (45 m) C-C (OVER 45MPH (70 km/h))

FOR FURTHER DETAILS ON PAVEMENT MARKING REFER TO STANDARD SPECIFICATIONS FOR ROAD AND BRIDGE CONSTRUCTION AND STATE STANDARD 780001.

All dimensions are in inches (millimeters) unless otherwise shown.

FILE NAME =	USER NAME = drivakosgn	DESIGNED - EVERS	REVISED - T. RAMMACHER 10-27-94
ci:\pw\work\p\widot\drivakosgn\d0108315\td	3.dgn	DRAWN -	REVISED - C. JUCIUS 09-09-09
	PLOT SCALE = 50,000' / IN.	CHECKED -	REVISED -
	PLOT DATE = 9/9/2009	DATE - 03-19-90	REVISED -

STATE OF ILLINOIS DEPARTMENT OF TRANSPORTATION

DISTRICT ONE TYPICAL PAVEMENT MARKINGS

SCALE: NONE	SHEET NO. 1 OF 1 SHEETS	STA. TO STA.	F.A.U. RTE. 2996	SECTION 15-00095-00-RS	COUNTY DuPAGE	TOTAL SHEETS 12	SHEET NO. 11
			TC-13		CONTRACT NO. 61C42		
FED. ROAD DIST. NO. 1 ILLINOIS FED. AID PROJECT							

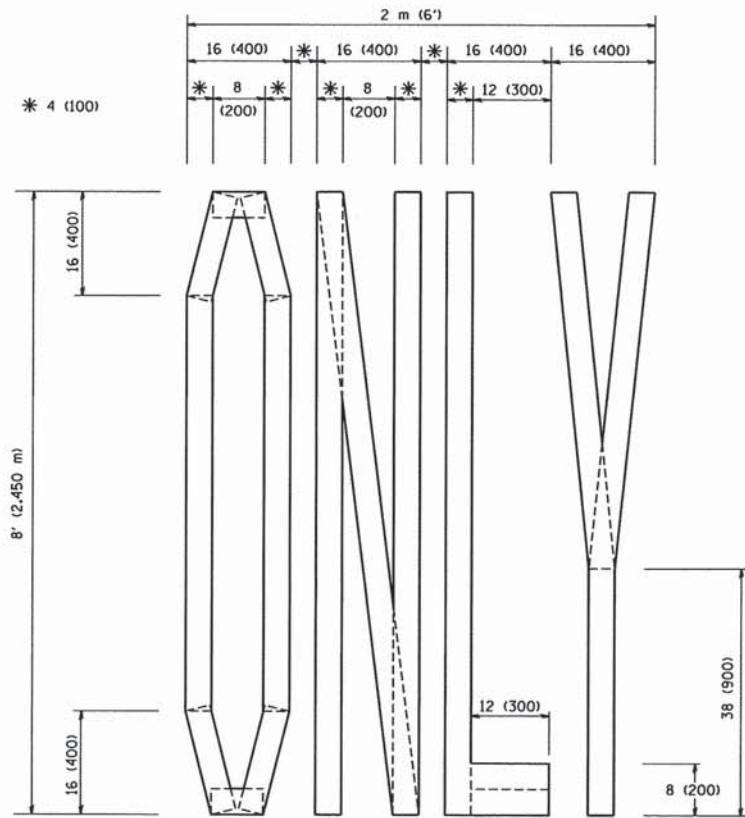

QUANTITY
 4 (100) LINE = 64.1 ft. (19.7 m)
 21.1 sq. ft. (1.97 sq. m)

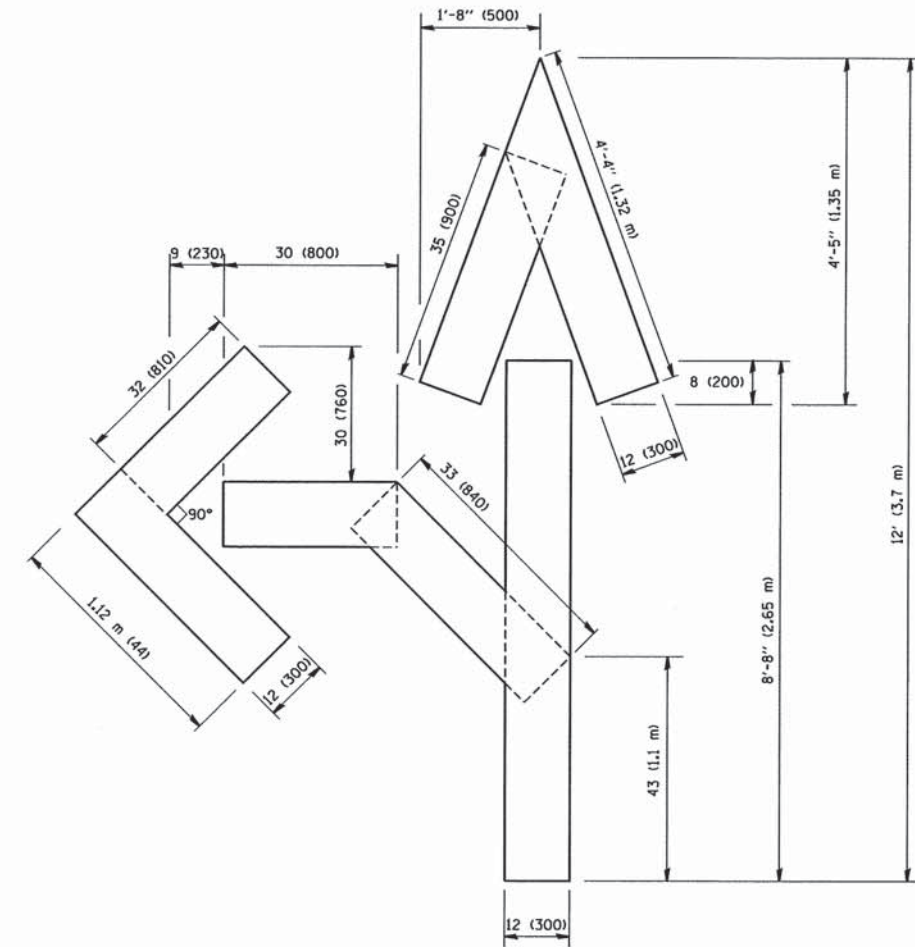

QUANTITY
 4 (100) LINE = 82.5 ft. (25.3 m)
 27.5 sq. ft. (2.53 sq. m)

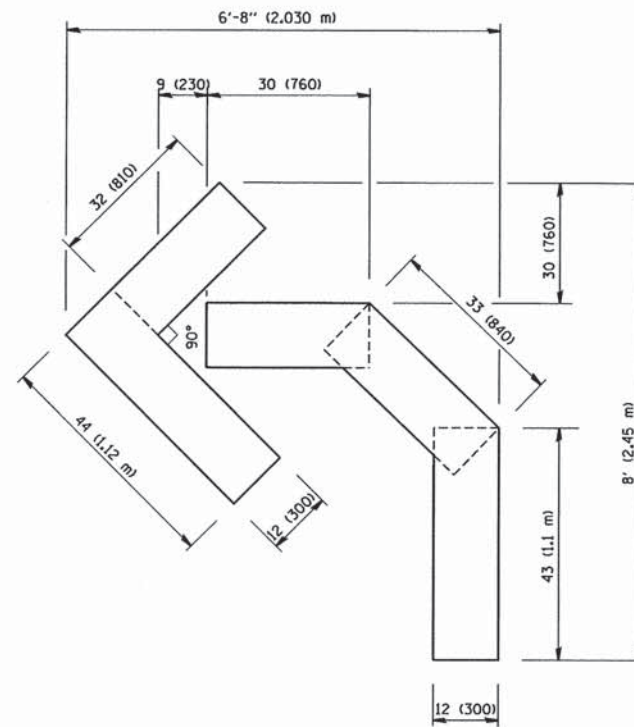

QUANTITY
 4 (100) LINE = 45.5 ft. (13.9 m)
 15.2 sq. ft. (1.39 sq. m)

All dimensions are in inches (millimeters) unless otherwise shown.

FILE NAME = W:\dststd\22x34\tc16.dgn	USER NAME = gaglianob	DESIGNED - DRAWN -	REVISED -T. RAMMACHER 06-05-96 REVISED -T. RAMMACHER 11-04-97
	PLOT SCALE = 58.0000 "/ IN.	CHECKED -	REVISED -T. RAMMACHER 03-02-98
	PLOT DATE = 1/4/2008	DATE - 09-18-94	REVISED -E. GOMEZ 08-28-00

STATE OF ILLINOIS
 DEPARTMENT OF TRANSPORTATION

PAVEMENT MARKING LETTERS AND SYMBOLS
 FOR TRAFFIC STAGING

SCALE: NONE SHEET NO. 1 OF 1 SHEETS STA. TO STA.

F.A.I. RTE. 2996	SECTION 15-00095-00-RS	COUNTY DuPAGE	TOTAL SHEETS 12	SHEET NO. 12
TC-16			CONTRACT NO. 61C42	
FED. ROAD DIST. NO. 1 ILLINOIS FED. AID PROJECT				