

STATE OF ILLINOIS
DEPARTMENT OF TRANSPORTATION
DIVISION OF HIGHWAYS

F.A.P. RTE.	SECTION	COUNTY	TOTAL SHEETS	SHEET NO.
305	3293 RS-2	COOK	25	1
FED. ROAD DIST. NO.	ILLINOIS	CONTRACT NO. 60H91		

FOR INDEX OF SHEETS, SEE SHEET NO. 2

PROPOSED HIGHWAY PLANS

F.A.P. ROUTE 305: ILL RTE. 50 (CICERO AVE.)
SECTION: 3293 RS-2
46TH ST. TO MARQUETTE RD.
RESURFACING (3P)
COOK COUNTY
C-91-831-09

THE PROJECT IS LOCATED
IN THE CITY OF CHICAGO AND
THE VILLAGE OF BEDFORD PARK



PROJECT ENDS
STA. 144 + 86

OMISSION
STA. 44 + 50 TO STA. 69 + 60

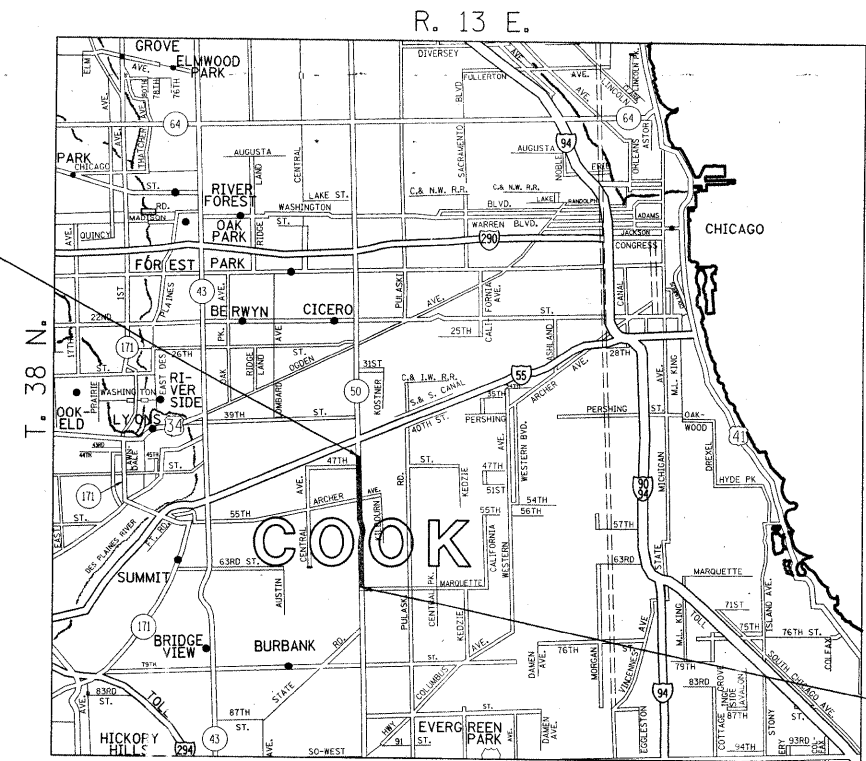

TRAFFIC DATA
2007 ADT = 64,800
SPEED LIMIT = 30 MPH

PROJECT BEGINS
STA. 1 + 36

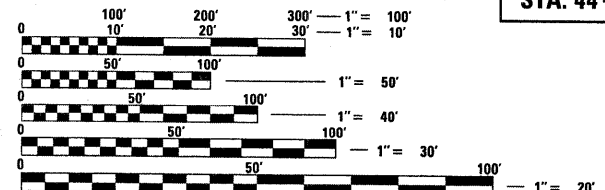

FULL SIZE PLANS HAVE BEEN PREPARED USING STANDARD ENGINEERING SCALES. REDUCED SIZED PLANS WILL NOT CONFORM TO STANDARD SCALES. IN MAKING MEASUREMENTS ON REDUCED PLANS, THE ABOVE SCALES MAY BE USED.

J.U.L.I.E.
JOINT UTILITY LOCATION INFORMATION FOR EXCAVATION
1-800-892-0123 OR 811
C.U.A.N
CHICAGO UTILITY ALERT NETWORK
(312) 744-7000

PROJECT ENGINEER - KARI SMITH (847) 705-4437
PROJECT MANAGER - KEN ENG (847) 705-4247
CONTRACT NO. 60H91

STICKNEY & LAKE TOWNSHIPS

GROSS LENGTH OF PROJECT = 14,350 LIN. FT. = 2.72 MILES
NET LENGTH OF PROJECT = 11,840 LIN. FT. = 2.24 MILES

STATE OF ILLINOIS
DEPARTMENT OF TRANSPORTATION
DIVISION OF HIGHWAYS

SUBMITTED DECEMBER 17, 2009

Diana M. O'Keefe
DEPUTY DIRECTOR OF HIGHWAYS, REGION ENGINEER

January 29, 2010
Scott E. Stitt, P.E.
ENGINEER OF DESIGN AND ENVIRONMENT

January 29, 2010
Christie M. Reed
DIRECTOR OF HIGHWAYS, CHIEF ENGINEER

PRINTED BY THE AUTHORITY
OF THE STATE OF ILLINOIS