

TRAFFIC SIGNAL LEGEND

	PROPOSED	EXISTING
DETECTOR LOOP		
SIGNAL HEAD		
G.S. CONDUIT IN TRENCH OR PUSHED		
SIGNAL HEAD WITH BACKPLATE		
RACEWAY FOR MAGNETIC DETECTOR, TYPE I OR II		
VEHICLE DETECTOR, NON-COMPENSATED MAGNETIC TYPE		

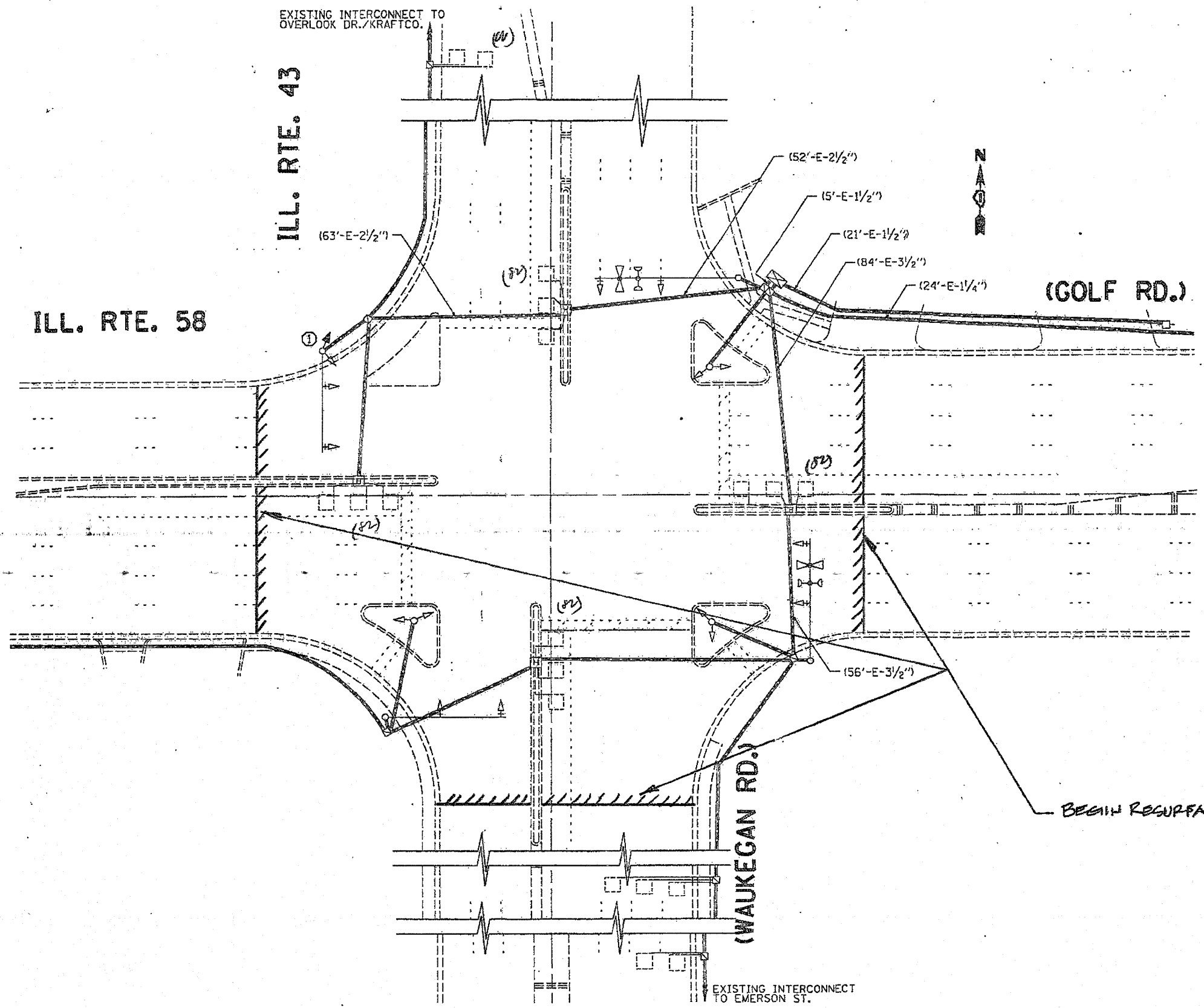

THIS PLAN IS FOR THE SOLE PURPOSE OF DETECTOR LOOP REPLACEMENTS ONLY

REPLACE ALL DETECTOR LOOPS AS SHOWN (WITHIN THE RESURFACING LIMITS)

CODE	QUANTITY	UNIT	ITEM
86600600	394	FOOT	DETECTOR LOOP, REPLACEMENT

FILE NAME =	USER NAME = kant@ephraxgbo	DESIGNED - BCK	REVISED -
g:\p\work\PM\DOT\KANT\PHIXAYBC\01126	traffic_legend_v7.dgn	DRAWN - BCK	REVISED -
	PLOT SCALE = 3/4" = 1' IN.	CHECKED - DAD	REVISED -
	PLOT DATE = 4/3/2009	DATE -	REVISED -

STATE OF ILLINOIS
DEPARTMENT OF TRANSPORTATION

DISTRICT ONE - DETECTOR LOOP REPLACEMENT
ILL. RTE. 43 (WAUKEGAN) @ ILL. RTE. 58

F.A.P. RTE.	SECTION	COUNTY	TOTAL SHEETS	SHEET NO.
348 (3071 (A16)	AS-4	COOK	35	15
CONTRACT NO. 6001				
SCALE: NONE SHEET NO. OF SHEETS STA. TO STA. FED. ROAD DIST. NO. ILLINOIS FED. AID PROJECT				