

CONSTRUCTION NOTES:

① EXISTING ISLANDS SHALL BE REPLACED WITH SUB-BASE GRANULAR MATERIAL, TYPE B, 4"; CLASS D PATCHES, 10" AND HMA SURFACE COURSE MIX "D", N70, 2". PAVED ISLANDS SHALL BE MARKED PER DISTRICT ONE TYPICAL PAVEMENT MARKINGS.

Restoration of Work Area. Restoration of the traffic signal work area shall be incidental to the related pay items such as foundation, conduit, handhole, trench and backfill, etc., and no extra compensation shall be allowed. All roadway surfaces such as shoulders, medians, sidewalks, pavement, etc. shall be replaced in kind. All damage to mowed lawns shall be replaced with an approved sod, and all damage to unmowed fields shall be seeded in accordance with Standard Specifications 252 and 250 respectively.

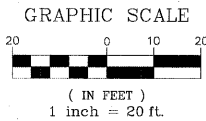

MATCH LINE (SEE BELOW)

MATCHLINE (SEE ABOVE)

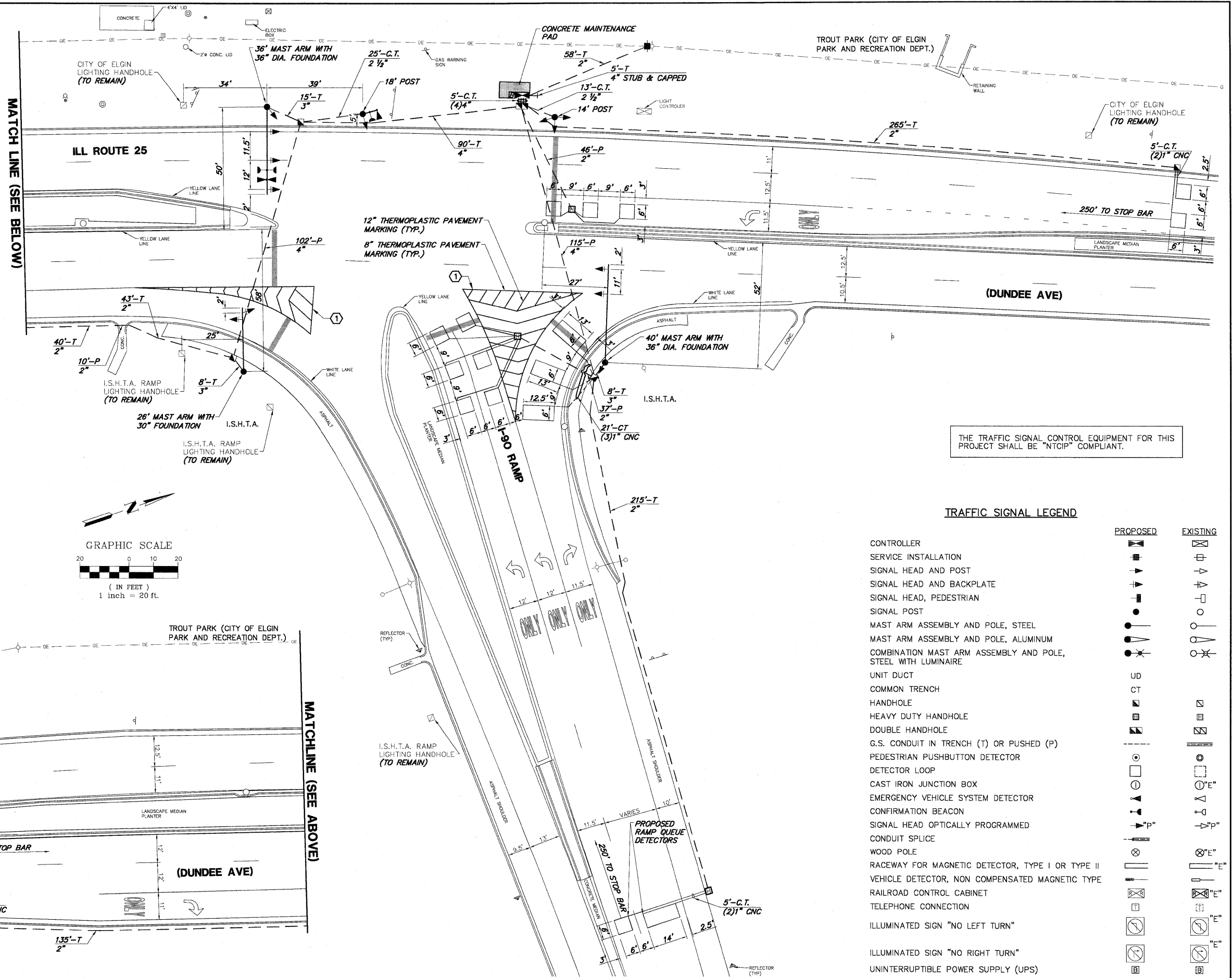

THE TRAFFIC SIGNAL CONTROL EQUIPMENT FOR THIS PROJECT SHALL BE "NTCIP" COMPLIANT.

TRAFFIC SIGNAL LEGEND

	PROPOSED	EXISTING
CONTROLLER	[Symbol]	[Symbol]
SERVICE INSTALLATION	[Symbol]	[Symbol]
SIGNAL HEAD AND POST	[Symbol]	[Symbol]
SIGNAL HEAD AND BACKPLATE	[Symbol]	[Symbol]
SIGNAL HEAD, PEDESTRIAN	[Symbol]	[Symbol]
SIGNAL POST	[Symbol]	[Symbol]
MAST ARM ASSEMBLY AND POLE, STEEL	[Symbol]	[Symbol]
MAST ARM ASSEMBLY AND POLE, ALUMINUM	[Symbol]	[Symbol]
COMBINATION MAST ARM ASSEMBLY AND POLE, STEEL WITH LUMINAIRE	[Symbol]	[Symbol]
UNIT DUCT	UD	[Symbol]
COMMON TRENCH	CT	[Symbol]
HANDHOLE	[Symbol]	[Symbol]
HEAVY DUTY HANDHOLE	[Symbol]	[Symbol]
DOUBLE HANDHOLE	[Symbol]	[Symbol]
G.S. CONDUIT IN TRENCH (T) OR PUSHED (P)	[Symbol]	[Symbol]
PEDESTRIAN PUSHBUTTON DETECTOR	[Symbol]	[Symbol]
DETECTOR LOOP	[Symbol]	[Symbol]
CAST IRON JUNCTION BOX	[Symbol]	[Symbol]
EMERGENCY VEHICLE SYSTEM DETECTOR	[Symbol]	[Symbol]
CONFIRMATION BEACON	[Symbol]	[Symbol]
SIGNAL HEAD OPTICALLY PROGRAMMED	[Symbol]	[Symbol]
CONDUIT SPLICE	[Symbol]	[Symbol]
WOOD POLE	[Symbol]	[Symbol]
RACEWAY FOR MAGNETIC DETECTOR, TYPE I OR TYPE II	[Symbol]	[Symbol]
VEHICLE DETECTOR, NON COMPENSATED MAGNETIC TYPE	[Symbol]	[Symbol]
RAILROAD CONTROL CABINET	[Symbol]	[Symbol]
TELEPHONE CONNECTION	[Symbol]	[Symbol]
ILLUMINATED SIGN "NO LEFT TURN"	[Symbol]	[Symbol]
ILLUMINATED SIGN "NO RIGHT TURN"	[Symbol]	[Symbol]
UNINTERRUPTIBLE POWER SUPPLY (UPS)	[Symbol]	[Symbol]

FILE NAME = 4085.852-TR1.dwg	USER NAME = GHA	DESIGNED - JRD	REVISED -	STATE OF ILLINOIS DEPARTMENT OF TRANSPORTATION	TRAFFIC SIGNAL MODERNIZATION PLAN ILL RTE 25 (DUNDEE AVE) AT I-90 RAMP	SCALE 1"=20'	SHEET NO. OF SHEETS	STA. TO STA.	FAU. RITE. VARIES	SECTION 2009-105-TS	COUNTY KANE	TOTAL SHEETS 36	SHEET NO. 11
PLOT SCALE = 1" = .0833'	DRAWN - ZCW	CHECKED - KLB	REVISED -			CONTRACT # 60J01							
PLOT DATE = 12/9/2009	DATE - 11/20/09	REVISED -	REVISED -			ILLINOIS FED. AID PROJECT							