

SCHEDULE OF QUANTITIES

ILL RTE 31 (STATE ST) AT KIMBALL ST/LAWRENCE AVE

NO.	QUANT.	UNIT	DESCRIPTION
1.	32.0	SQ FT	SIGN PANEL - TYPE 1
2.	1	EACH	MAINTENANCE OF EXISTING TRAFFIC SIGNAL INSTALLATION
3.	176	FOOT	ELECTRIC CABLE IN CONDUIT, SIGNAL, NO. 14 2C
4.	2	EACH	TRAFFIC SIGNAL POST, GALVANIZED STEEL, 18 FT
5.	8	FOOT	CONCRETE FOUNDATION, TYPE A
6.	11	EACH	SIGNAL HEAD, LED, 1-FACE, 3-SECTION, MAST ARM MOUNTED
7.	3	EACH	SIGNAL HEAD, LED, 1-FACE, 3-SECTION, BRACKET MOUNTED
8.	1	EACH	SIGNAL HEAD, LED, 1-FACE, 5-SECTION, MAST ARM MOUNTED
9.	2	EACH	SIGNAL HEAD, LED, 2-FACE, 3-SECTION, BRACKET MOUNTED
10.	1	EACH	SIGNAL HEAD, LED, 2-FACE, 1-3 SECTION, 1-5 SECTION, BRACKET MOUNTED
11.	2	EACH	PEDESTRIAN SIGNAL HEAD, LED, 1-FACE, BRACKET MOUNTED
12.	2	EACH	PEDESTRIAN SIGNAL HEAD, LED, 2-FACE, BRACKET MOUNTED
13.	12	EACH	TRAFFIC SIGNAL BACKPLATE, LOUVERED, ALUMINIUM
14.	6	EACH	PEDESTRIAN PUSH-BUTTON
15.	2	EACH	ILLUMINATED SIGN, LED
16.	1	EACH	REMOVE EXISTING TRAFFIC SIGNAL EQUIPMENT
17.	1	L SUM	RAILROAD PROTECTIVE LIABILITY INSURANCE
18.	1	EACH	RADIO ACTIVATED SOLAR ADVANCE FLASHING BEACON SYSTEM (COMPLETE)

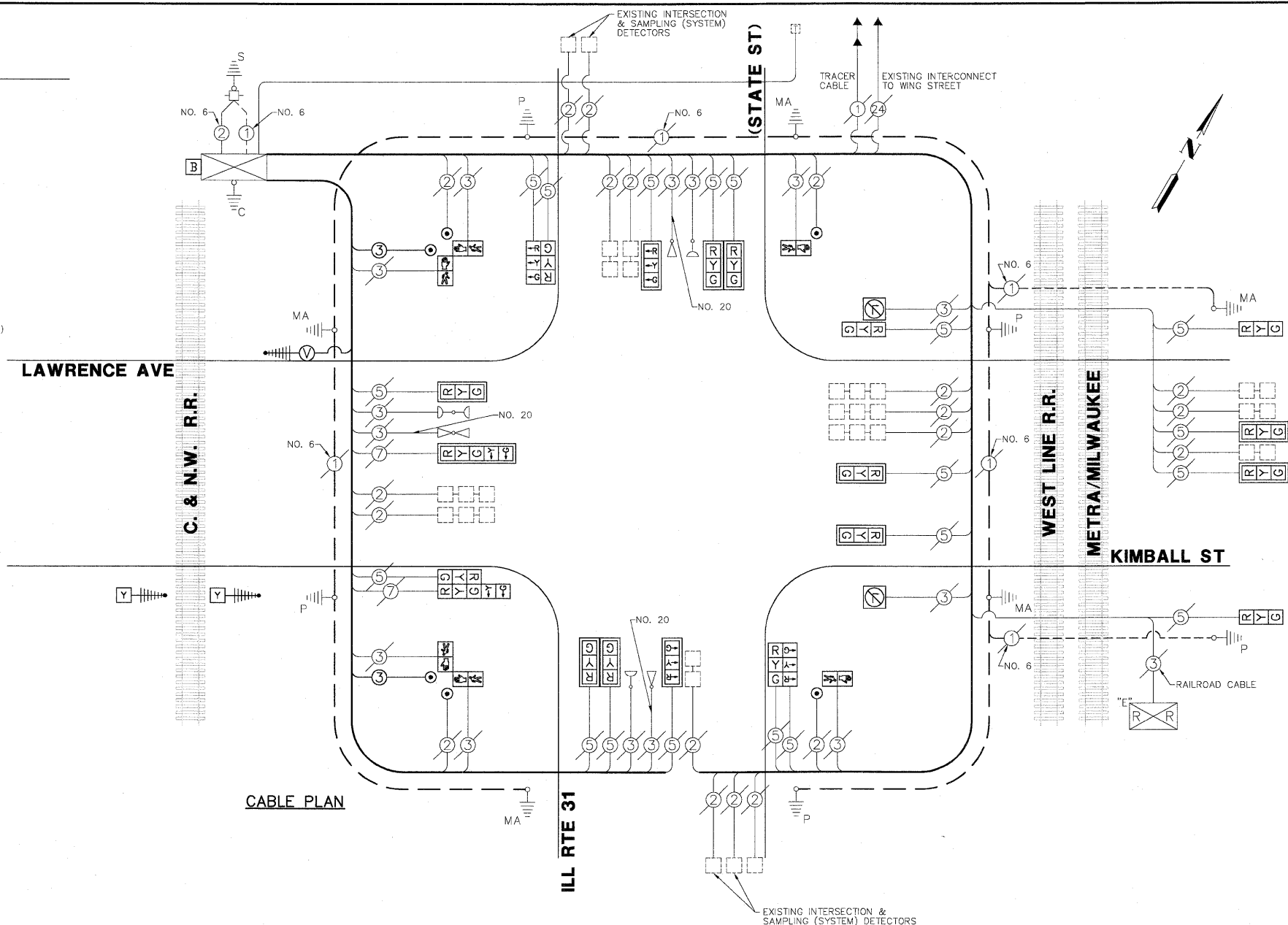

CABLE PLAN LEGEND

EXISTING	PROPOSED	DESCRIPTION
[Symbol]	[Symbol]	8" (200mm) TRAFFIC SIGNAL SECTION
[Symbol]	[Symbol]	12" (300mm) TRAFFIC SIGNAL SECTION
[Symbol]	[Symbol]	12" (300mm) PEDESTRIAN SIGNAL SECTION
[Symbol]	[Symbol]	12" (300mm) PEDESTRIAN SIGNAL SECTION
[Symbol]	[Symbol]	CONTROLLER CABINET
[Symbol]	[Symbol]	SERVICE INSTALLATION
[Symbol]	[Symbol]	TELEPHONE
[Symbol]	[Symbol]	VEHICLE DETECTOR, INDUCTION LOOP
[Symbol]	[Symbol]	MAGNETIC DETECTOR
[Symbol]	[Symbol]	EMERGENCY VEHICLE LIGHT DETECTOR
[Symbol]	[Symbol]	CONFIRMATION BEACON
[Symbol]	[Symbol]	PUSHBUTTON DETECTOR
[Symbol]	[Symbol]	DENOTES NUMBER OF CONDUCTORS. ALL CABLE NO. 14 EXCEPT AS INDICATED. ALL LOOP DETECTOR CABLE TO BE SHIELDED.
[Symbol]	[Symbol]	GROUND CABLE IN CONDUIT NO.6 SOLID COPPER (GREEN)
[Symbol]	[Symbol]	FIBER OPTIC CABLE IN CONDUIT NO. 62.5/125 MM12F SM24F
[Symbol]	[Symbol]	SIGNAL FACE WITH BACKPLATE. "P" INDICATES PROGRAMMED HEAD
[Symbol]	[Symbol]	RAILROAD CONTROL CABINET
[Symbol]	[Symbol]	ILLUMINATED SIGN "NO LEFT TURN"
[Symbol]	[Symbol]	ILLUMINATED SIGN "NO RIGHT TURN"
[Symbol]	[Symbol]	GROUND ROD AT HANDHOLE (H), DOUBLE HANDHOLE (H), OR CONTROLLER (C)
[Symbol]	[Symbol]	GROUND ROD AT POST (P) OR MAST ARM POLE (MA)
[Symbol]	[Symbol]	GROUND ROD AT ELECTRIC SERVICE INSTALLATION
[Symbol]	[Symbol]	UNINTERRUPTIBLE POWER SUPPLY (UPS)
[Symbol]	[Symbol]	12" (300mm) PEDESTRIAN SIGNAL SECTION WITH COUNTDOWN TIMER
[Symbol]	[Symbol]	VENDOR CABLE
[Symbol]	[Symbol]	RADIO ANTENNA

Restoration of Work Area. Restoration of the traffic signal work area shall be incidental to the related pay items such as foundation, conduit, handhole, trench and backfill, etc., and no extra compensation shall be allowed. All roadway surfaces such as shoulders, medians, sidewalks, pavement, etc. shall be replaced in kind. All damage to mowed lawns shall be replaced with an approved sod, and all damage to unmowed fields shall be seeded in accordance with Standard Specifications 252 and 250 respectively.

THE TRAFFIC SIGNAL CONTROL EQUIPMENT FOR THIS PROJECT SHALL BE "NTCIP" COMPLIANT.

I.D.O.T. TRAFFIC SIGNAL INSTALLATION ELECTRICAL SERVICE REQUIREMENTS					TOTAL WATTAGE
TYPE	NO LAMPS	WATTAGE INCAND.	L.E.D.	% OPERATION	
SIGNAL (RED)	21	135	17	0.50	178.50
SIGNAL (YELLOW)	21	135	25	0.25	131.25
SIGNAL (GREEN)	21	135	15	0.25	78.75
ARROW	4	135	12	0.10	4.80
PED.SIGNAL	6	90	25	1.00	150.00
CONTROLLER	1	-	100	1.00	100.00
LUMINAIRE	-	-	250	0.50	-
L.E.D. ST. NAME SIGN	-	-	64	0.50	-
VIDEO SYSTEM	-	-	150	1.00	-
BATTERY BACKUP	1	-	25	1.00	25.00
ILLUM. SIGN	2	-	25	0.05	2.50
TOTAL =					670.80

ENERGY COSTS - BILLED TO: CITY OF ELGIN
 (ADDRESS) 150 DEXTER COURT
 (ADDRESS) ELGIN, IL 60120
 ENERGY SUPPLY - CONTACT: KATHY NYSTROM
 PHONE: (847) 816-5489
 COMPANY: COM. ED - ELGIN