

F.A.U. RTE.	SECTION	COUNTY	TOTAL SHEETS	SHEET NO.
0085	00-00246-01-FP	MCHENRY	236	24
STA. TO STA.		FED. ROAD DIST. NO. 1 ILLINOIS FED. AID PROJECT		
		CONTRACT NO: 63266		

EXISTING PLAN

PROPOSED PLAN

- REMOVAL LEGEND**
- DRIVEWAY PAVEMENT REMOVAL
 - HOT-MIX ASPHALT SURFACE REMOVAL, VARIABLE DEPTH (SEE NOTE 1 SHEET 30)
 - PAVEMENT REMOVAL
 - HOT-MIX ASPHALT SURFACE REMOVAL - BUTT JOINT
 - TREE REMOVAL (WITH DIAMETER)
 - LINEAR REMOVALS

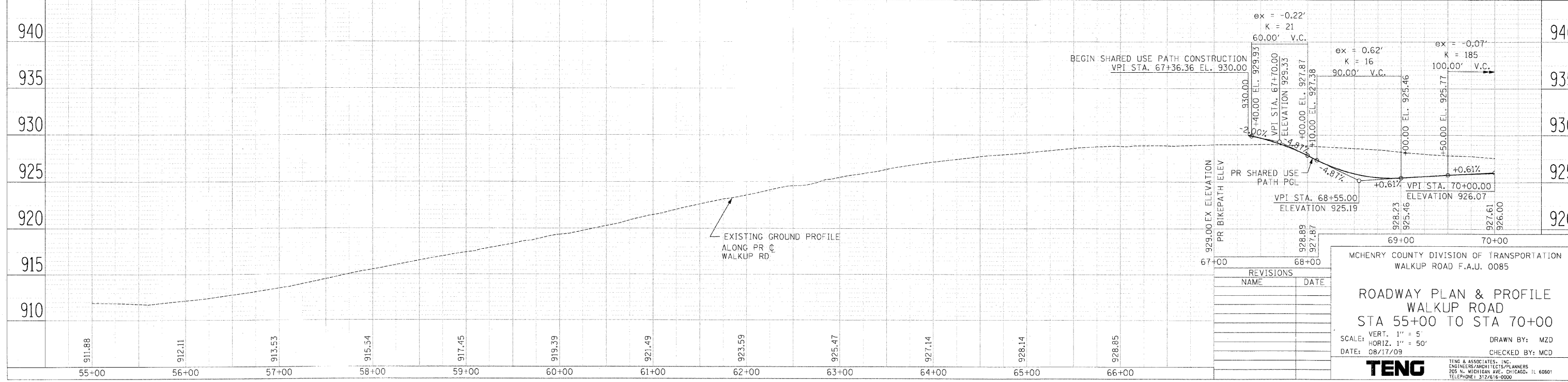
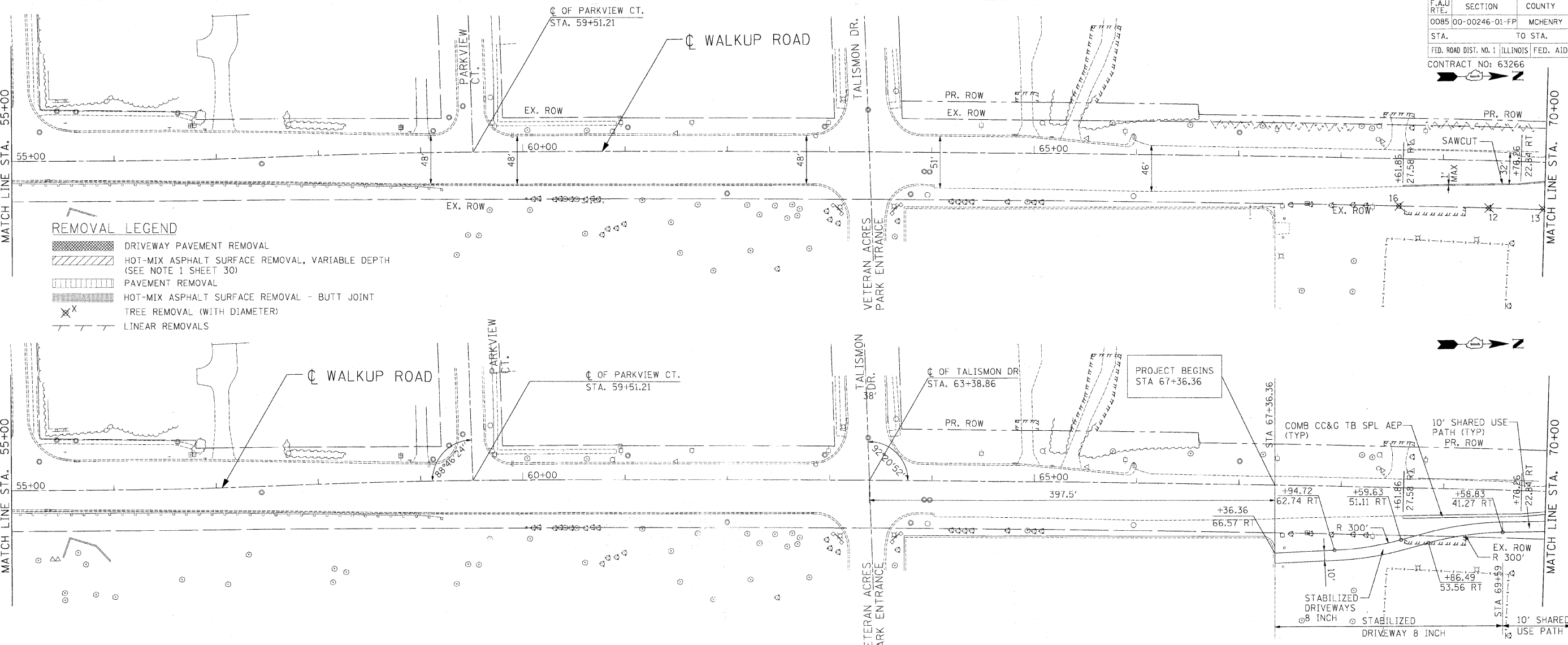

MCHENRY COUNTY DIVISION OF TRANSPORTATION
WALKUP ROAD F.A.U. 0085

ROADWAY PLAN & PROFILE
WALKUP ROAD
STA 55+00 TO STA 70+00

SCALE: VERT. 1" = 5'
HORIZ. 1" = 50'

DATE: 08/17/09
DRAWN BY: MZD
CHECKED BY: MCD

TENG
TENG & ASSOCIATES, INC.
ENGINEERS ARCHITECTS PLANNERS
205 N. MICHIGAN AVE., CHICAGO, IL 60601
TELEPHONE: 312/616-0000

REVISIONS	
NAME	DATE

DATE: _____ BY: _____
 PLAN NO. _____
 SURVEYED BY: _____
 ALIGNED BY: _____
 CHECKED BY: _____
 DATE: _____

DATE: _____ BY: _____
 PROFILE NO. _____
 SURVEYED BY: _____
 GRADES CHECKED BY: _____
 STRUCK OFF BY: _____
 DATE: _____

\\VALT0080A.DGN, \\RDW006R6.DGN, \\RDW006R6.DGN, \\TIP000R1.DGN, \\TIP000R2.DGN, \\TIP000R3.DGN, \\TIP000R4.DGN, \\TIP000R5.DGN, \\TIP000R6.DGN, \\TIP000R7.DGN, \\TIP000R8.DGN, \\TIP000R9.DGN, \\TIP000R10.DGN, \\TIP000R11.DGN, \\TIP000R12.DGN, \\TIP000R13.DGN, \\TIP000R14.DGN, \\TIP000R15.DGN, \\TIP000R16.DGN, \\TIP000R17.DGN, \\TIP000R18.DGN, \\TIP000R19.DGN, \\TIP000R20.DGN, \\TIP000R21.DGN, \\TIP000R22.DGN, \\TIP000R23.DGN, \\TIP000R24.DGN, \\TIP000R25.DGN, \\TIP000R26.DGN, \\TIP000R27.DGN, \\TIP000R28.DGN, \\TIP000R29.DGN, \\TIP000R30.DGN, \\TIP000R31.DGN, \\TIP000R32.DGN, \\TIP000R33.DGN, \\TIP000R34.DGN, \\TIP000R35.DGN, \\TIP000R36.DGN, \\TIP000R37.DGN, \\TIP000R38.DGN, \\TIP000R39.DGN, \\TIP000R40.DGN, \\TIP000R41.DGN, \\TIP000R42.DGN, \\TIP000R43.DGN, \\TIP000R44.DGN, \\TIP000R45.DGN, \\TIP000R46.DGN, \\TIP000R47.DGN, \\TIP000R48.DGN, \\TIP000R49.DGN, \\TIP000R50.DGN, \\TIP000R51.DGN, \\TIP000R52.DGN, \\TIP000R53.DGN, \\TIP000R54.DGN, \\TIP000R55.DGN, \\TIP000R56.DGN, \\TIP000R57.DGN, \\TIP000R58.DGN, \\TIP000R59.DGN, \\TIP000R60.DGN, \\TIP000R61.DGN, \\TIP000R62.DGN, \\TIP000R63.DGN, \\TIP000R64.DGN, \\TIP000R65.DGN, \\TIP000R66.DGN, \\TIP000R67.DGN, \\TIP000R68.DGN, \\TIP000R69.DGN, \\TIP000R70.DGN, \\TIP000R71.DGN, \\TIP000R72.DGN, \\TIP000R73.DGN, \\TIP000R74.DGN, \\TIP000R75.DGN, \\TIP000R76.DGN, \\TIP000R77.DGN, \\TIP000R78.DGN, \\TIP000R79.DGN, \\TIP000R80.DGN, \\TIP000R81.DGN, \\TIP000R82.DGN, \\TIP000R83.DGN, \\TIP000R84.DGN, \\TIP000R85.DGN, \\TIP000R86.DGN, \\TIP000R87.DGN, \\TIP000R88.DGN, \\TIP000R89.DGN, \\TIP000R90.DGN, \\TIP000R91.DGN, \\TIP000R92.DGN, \\TIP000R93.DGN, \\TIP000R94.DGN, \\TIP000R95.DGN, \\TIP000R96.DGN, \\TIP000R97.DGN, \\TIP000R98.DGN, \\TIP000R99.DGN, \\TIP000R100.DGN