

EXISTING PLAN

PROPOSED PLAN

REMOVAL LEGEND

- DRIVEWAY PAVEMENT REMOVAL
- HOT-MIX ASPHALT SURFACE REMOVAL, VARIABLE DEPTH (SEE NOTE 1 SHEET 30)
- PAVEMENT REMOVAL
- HOT-MIX ASPHALT SURFACE REMOVAL - BUTT JOINT
- TREE REMOVAL (WITH DIAMETER)
- LINEAR REMOVALS

PROP. CURVE WALKPR-10
 PI STA. = 208+41.01 e = 0.032
 Δ = 47° 15' 12" (RT) T.R. = 55.5
 D = 3° 23' 58" S.E. RUN = 88.8
 R = 1,685.42'
 T = 737.28'
 L = 1,390.01'
 E = 154.20'
 P.C. STA. = 201+03.73
 P.T. STA. = 214+93.74

START TRANS (NORMAL CROWN) = STA. 199+89.00
 END TRANS (FULL SE -3.2%) = STA. 201+34.00
 START TRANS (FULL SE -3.2%) = STA. 214+64.00
 END TRANS (NORMAL CROWN) = STA. 216+09.00

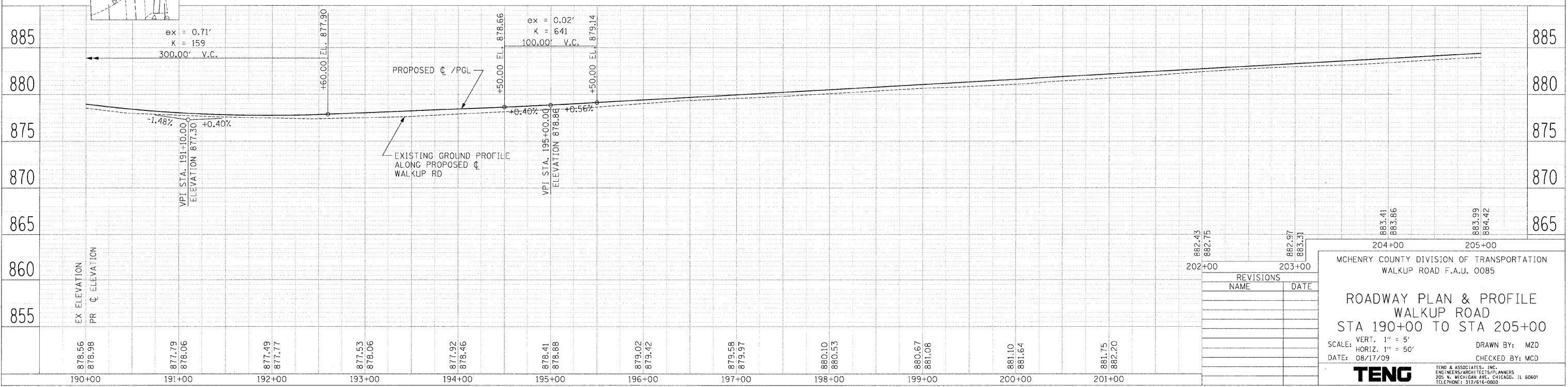

REVISIONS	
NAME	DATE

MCHENRY COUNTY DIVISION OF TRANSPORTATION
 WALKUP ROAD F.A.U. 0085

ROADWAY PLAN & PROFILE
 WALKUP ROAD
 STA 190+00 TO STA 205+00

SCALE: VERT. 1" = 5'
 HORIZ. 1" = 50'

DATE: 08/17/09

DRAWN BY: MZD
 CHECKED BY: MCD

TENG
 TENG & ASSOCIATES, INC.
 ENGINEERS/ARCHITECTS/PLANNERS
 205 N. MICHIGAN AVE., CHICAGO, IL 60601
 TELEPHONE: 312.678-0000

PLAN SURVEYED BY DATE
 PLOTTED BY DATE
 CHECKED BY DATE
 NOTE BOOK NO. FILE NAME
 NO. FILE NAME

PROF. ILE SURVEYED BY DATE
 PLOTTED BY DATE
 CHECKED BY DATE
 NOTE BOOK NO. FILE NAME
 NO. FILE NAME

A:\T0808ADEN\RDW00855.DGN, \TTBODY.V.DGN, \RDW00866.DGN, \RDW00888.DGN, \RDW00892.DGN, \RDW00893.DGN, \RDW00894.DGN, \RDW00895.DGN, \RDW00896.DGN, \RDW00897.DGN, \RDW00898.DGN, \RDW00899.DGN, \RDW00900.DGN, \RDW00901.DGN, \RDW00902.DGN, \RDW00903.DGN, \RDW00904.DGN, \RDW00905.DGN, \RDW00906.DGN, \RDW00907.DGN, \RDW00908.DGN, \RDW00909.DGN, \RDW00910.DGN, \RDW00911.DGN, \RDW00912.DGN, \RDW00913.DGN, \RDW00914.DGN, \RDW00915.DGN, \RDW00916.DGN, \RDW00917.DGN, \RDW00918.DGN, \RDW00919.DGN, \RDW00920.DGN, \RDW00921.DGN, \RDW00922.DGN, \RDW00923.DGN, \RDW00924.DGN, \RDW00925.DGN, \RDW00926.DGN, \RDW00927.DGN, \RDW00928.DGN, \RDW00929.DGN, \RDW00930.DGN, \RDW00931.DGN, \RDW00932.DGN, \RDW00933.DGN, \RDW00934.DGN, \RDW00935.DGN, \RDW00936.DGN, \RDW00937.DGN, \RDW00938.DGN, \RDW00939.DGN, \RDW00940.DGN, \RDW00941.DGN, \RDW00942.DGN, \RDW00943.DGN, \RDW00944.DGN, \RDW00945.DGN, \RDW00946.DGN, \RDW00947.DGN, \RDW00948.DGN, \RDW00949.DGN, \RDW00950.DGN, \RDW00951.DGN, \RDW00952.DGN, \RDW00953.DGN, \RDW00954.DGN, \RDW00955.DGN, \RDW00956.DGN, \RDW00957.DGN, \RDW00958.DGN, \RDW00959.DGN, \RDW00960.DGN