

F.A.U. SECTION	COUNTY	TOTAL SHEETS	SHEET NO.
0085 00-00246-01-FP	MCHENRY	236	136
STA.	TO STA.	FED. ROAD DIST. NO. 1 ILLINOIS FED. AID PROJECT	
		CONTRACT NO: 63266	

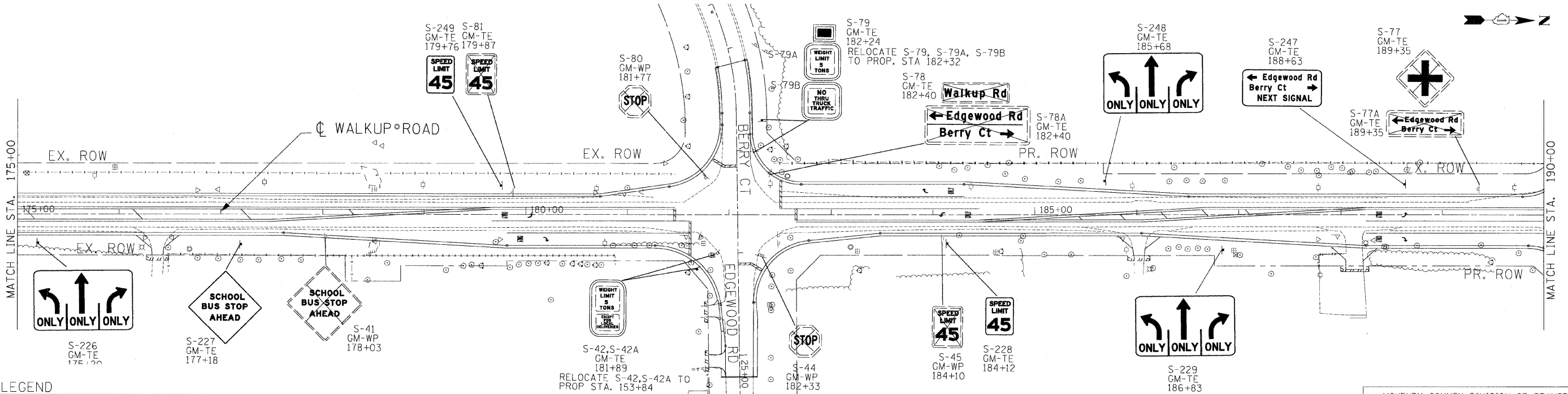
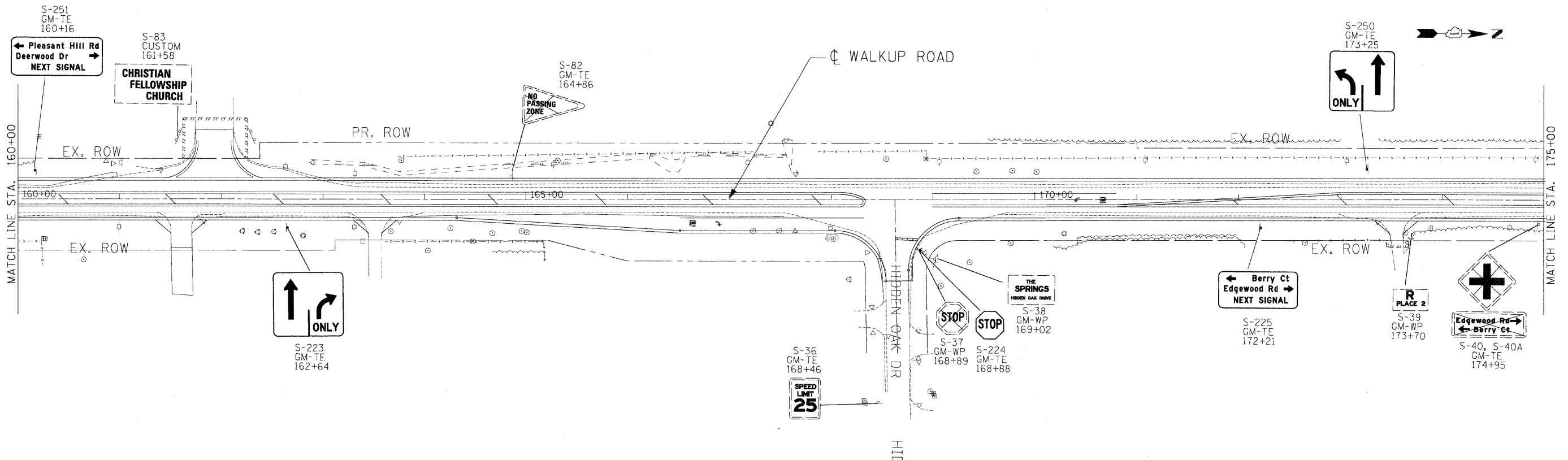

SIGNING LEGEND

	EXISTING SIGN PANEL TO REMAIN		EXISTING PANEL ID MOUNTING TYPE		PROPOSED PANEL ID MOUNTING TYPE
	EXISTING SIGN PANEL TO BE RELOCATED (AT SAME LOCATION UNLESS SPECIFIED)		EX. STATION		PROP. STATION
	EXISTING SIGN PANEL TO BE REMOVED		GM- GROUND MOUNT		MP- METAL POST
	PROPOSED SIGN PANEL		TS- TRAFFIC SIGNAL		TE- TELESCOPING STEEL
	EXISTING GROUND MOUNTED SIGN		UP- UTILITY POLE		WP- WOOD POST
	PROPOSED GROUND MOUNTED SIGN				

REVISIONS	
NAME	DATE

MCHENRY COUNTY DIVISION OF TRANSPORTATION
WALKUP ROAD F.A.U. 0085

EXISTING & PROPOSED SIGNING
WALKUP ROAD
STA 160+00 TO STA 190+00

SCALE: 1" = 50'
DATE: 08/17/09
DRAWN BY: MAM
CHECKED BY: BRH

TENG
TENG & ASSOCIATES, INC.
ENGINEERS/ARCHITECTS/PLANNERS
205 N. MICHIGAN AVE. - CHICAGO, IL 60601
TELEPHONE: 312/616-0000

N:\PROJECTS\08-17-09\08-17-09-0085\FRD\08-17-09-0085-01-FP\08-17-09-0085-01-FP-00136.DWG
 8/14/2009 10:45:54
 1, 2, 3, 4, 5, 6, 7, 8, 9, 10, 11, 12, 13, 14, 15, 16, 17, 18, 19, 20, 21, 22, 23, 24, 25, 26, 27, 28, 29, 30, 31, 32, 33, 34, 35, 36, 37, 38, 39, 40, 41, 42, 43, 44, 45, 46, 47, 48, 49, 50, 51, 52, 53, 54, 55, 56, 57, 58, 59, 60, 61, 62, 63