

F.A.U. RTE.	SECTION	COUNTY	TOTAL SHEETS	SHEET NO.
00085	00-00246-01-PP	MCHENRY	236	201
STA.	TO STA.			
FED. ROAD DIST. NO. 1	ILLINOIS	FED. AID PROJECT		
CONTRACT NO: 63266				

DATE	BY	DATE	BY
DATE	BY	DATE	BY

ORIGINAL SURVEY	EMPHASIS	PLOTTED	DATE
NO.	NO.	NO.	NO.

DATE	BY

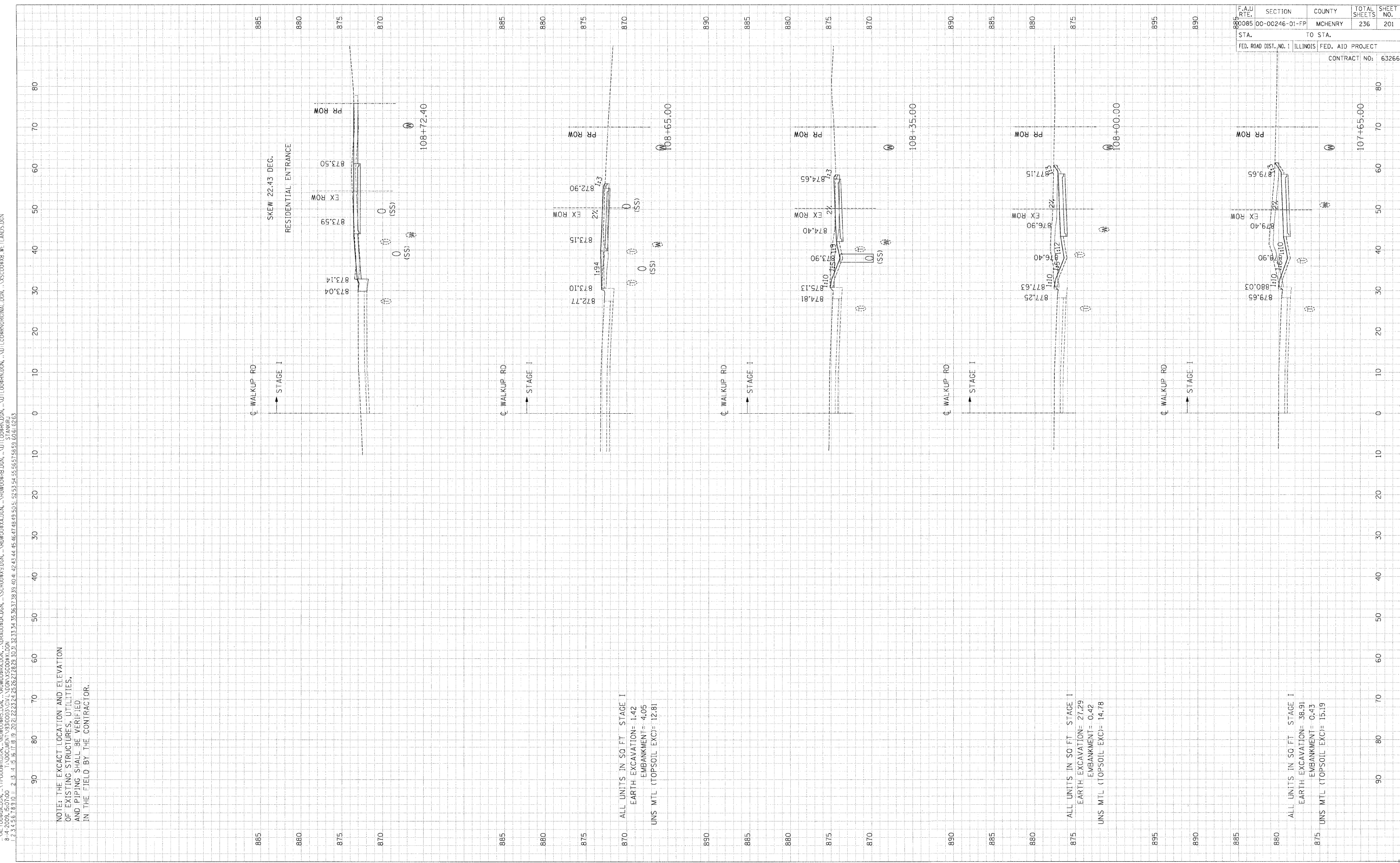

NOTE: THE EXACT LOCATION AND ELEVATION OF EXISTING STRUCTURES, UTILITIES, AND PIPING SHALL BE VERIFIED IN THE FIELD BY THE CONTRACTOR.

ALL UNITS IN SQ FT STAGE 1
 EARTH EXCAVATION= 1.42
 EMBANKMENT= 4.05
 UNS MTL (TOPSOIL EXC)= 12.81

ALL UNITS IN SQ FT STAGE 1
 EARTH EXCAVATION= 27.29
 EMBANKMENT= 0.42
 UNS MTL (TOPSOIL EXC)= 14.78

ALL UNITS IN SQ FT STAGE 1
 EARTH EXCAVATION= 38.91
 EMBANKMENT= 0.43
 UNS MTL (TOPSOIL EXC)= 15.19

PROPOSED CROSS SECTIONS: WALKUP ROAD