

DATE	BY

DATE	BY

\ALT00804.DGN, \TIP0008.DGN, \R000085.DGN, \R000086.DGN, \R000087.DGN, \R000088.DGN, \R000089.DGN, \R000090.DGN, \R000091.DGN, \R000092.DGN, \R000093.DGN, \R000094.DGN, \R000095.DGN, \R000096.DGN, \R000097.DGN, \R000098.DGN, \R000099.DGN, \R000100.DGN, \R000101.DGN, \R000102.DGN, \R000103.DGN, \R000104.DGN, \R000105.DGN, \R000106.DGN, \R000107.DGN, \R000108.DGN, \R000109.DGN, \R000110.DGN, \R000111.DGN, \R000112.DGN, \R000113.DGN, \R000114.DGN, \R000115.DGN, \R000116.DGN, \R000117.DGN, \R000118.DGN, \R000119.DGN, \R000120.DGN, \R000121.DGN, \R000122.DGN, \R000123.DGN, \R000124.DGN, \R000125.DGN, \R000126.DGN, \R000127.DGN, \R000128.DGN, \R000129.DGN, \R000130.DGN, \R000131.DGN, \R000132.DGN, \R000133.DGN, \R000134.DGN, \R000135.DGN, \R000136.DGN, \R000137.DGN, \R000138.DGN, \R000139.DGN, \R000140.DGN, \R000141.DGN, \R000142.DGN, \R000143.DGN, \R000144.DGN, \R000145.DGN, \R000146.DGN, \R000147.DGN, \R000148.DGN, \R000149.DGN, \R000150.DGN, \R000151.DGN, \R000152.DGN, \R000153.DGN, \R000154.DGN, \R000155.DGN, \R000156.DGN, \R000157.DGN, \R000158.DGN, \R000159.DGN, \R000160.DGN

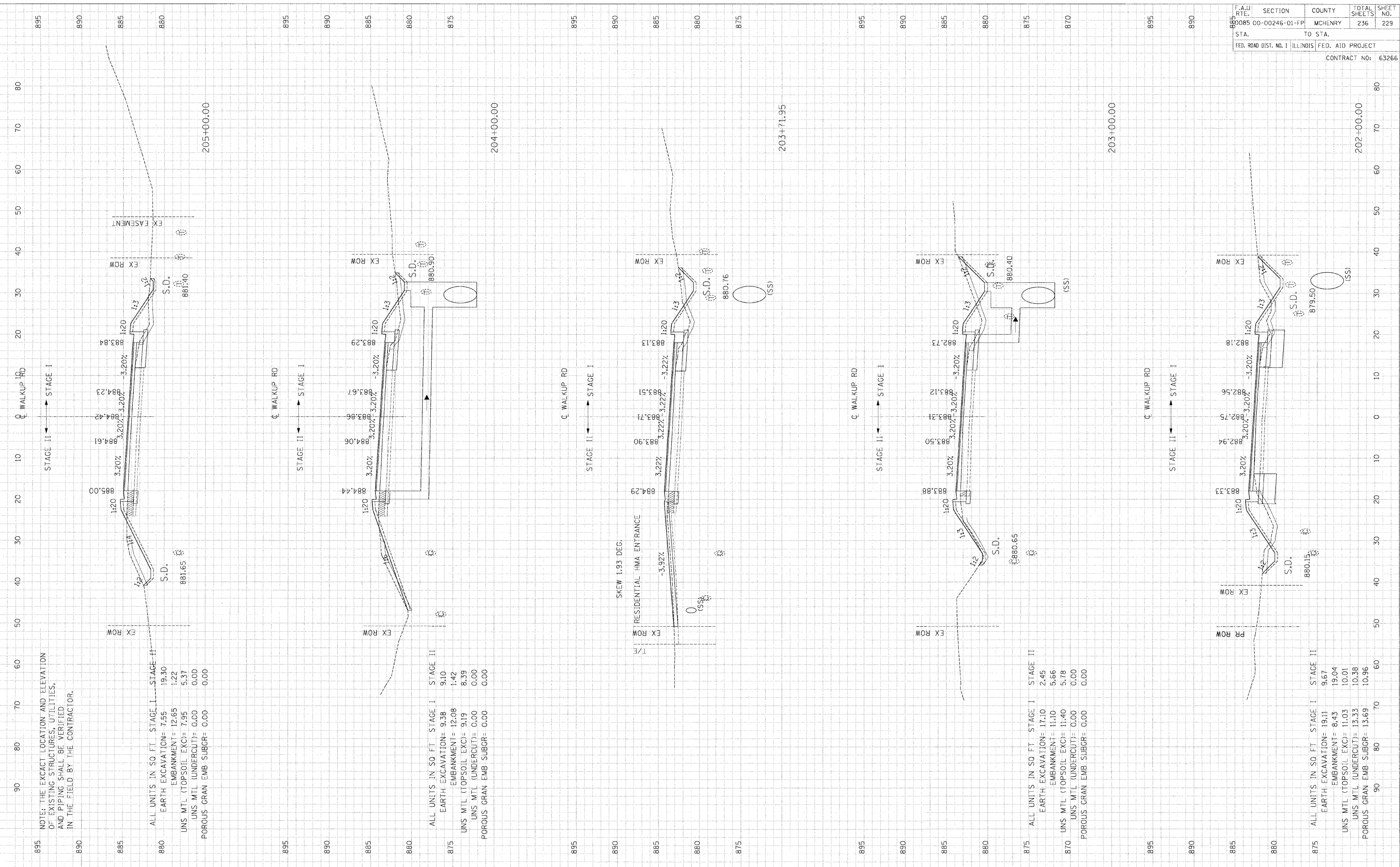

NOTE: THE EXACT LOCATION AND ELEVATION OF EXISTING STRUCTURES, UTILITIES, AND PIPING SHALL BE VERIFIED IN THE FIELD BY THE CONTRACTOR.

ALL UNITS IN SQ. FT. STAGE I STAGE II
 EARTH EXCAVATION= 7.55 19.30
 EMBANKMENT= 12.65 1.22
 UNS MTL (TOPSOIL EXC)= 7.95 5.37
 UNS MTL (UNDERCUT)= 0.00 0.00
 POROUS GRAN EMB SUBGR= 0.00 0.00

ALL UNITS IN SQ. FT. STAGE I STAGE II
 EARTH EXCAVATION= 9.38 9.10
 EMBANKMENT= 12.08 1.42
 UNS MTL (TOPSOIL EXC)= 9.19 8.39
 UNS MTL (UNDERCUT)= 0.00 0.00
 POROUS GRAN EMB SUBGR= 0.00 0.00

ALL UNITS IN SQ. FT. STAGE I STAGE II
 EARTH EXCAVATION= 17.10 2.45
 EMBANKMENT= 11.10 5.66
 UNS MTL (TOPSOIL EXC)= 11.40 5.78
 UNS MTL (UNDERCUT)= 0.00 0.00
 POROUS GRAN EMB SUBGR= 0.00 0.00

ALL UNITS IN SQ. FT. STAGE I STAGE II
 EARTH EXCAVATION= 19.11 9.67
 EMBANKMENT= 8.43 19.04
 UNS MTL (TOPSOIL EXC)= 11.03 10.01
 UNS MTL (UNDERCUT)= 13.33 10.38
 POROUS GRAN EMB SUBGR= 13.69 10.96

F.A.U. R.T.E.	SECTION	COUNTY	TOTAL SHEETS	SHEET NO.
89085	00-00246-01-FP	MCHENRY	236	229
STA.	TO STA.		FED. AID PROJECT	
FED. ROAD DIST. NO. 1		ILLINOIS		CONTRACT NO: 63266