

ORIGINAL SURVEY SURVEYED BY DATE
 SURVEY PLOTTED BY DATE
 NOTE BOOK NO. PLotted AREA CHECKED
 NO. AREAS CHECKED

\ALTD008A.DGN, \TP0008A.DGN, \RDW0895.DGN, \RDW0894.DGN, \RDW0893.DGN, \SR00804.DGN, \SR00803.DGN, \SR00802.DGN, \SR00801.DGN, \RDW0894A.DGN, \RDW0893A.DGN, \RDW0892A.DGN, \RDW0891A.DGN, \UTL008FRI.DGN, \UTL008FRI.DGN, \UTL008FRI.DGN, \VSC008X9.METLANDS.DGN
 8-4-2009, 15:06:01 T:\NOC\PROJECT\30000\3\CVL\UDN\YSC008X1.DGN
 L2,3,4,5,6,7,8,9,10,11,12,13,14,15,16,17,18,19,20,21,22,23,24,25,26,27,28,29,30,31,32,33,34,35,36,37,38,39,40,41,42,43,44,45,46,47,48,49,50,51,52,53,54,55,56,57,58,59,60,61,62,63

NOTE: THE EXACT LOCATION AND ELEVATION OF EXISTING STRUCTURES, UTILITIES, AND PIPING SHALL BE VERIFIED IN THE FIELD BY THE CONTRACTOR.

F.A.U. FILE NO.	SECTION	COUNTY	TOTAL SHEETS	SHEET NO.
8400085	00-00246-01-FP	MCHENRY	236	205
STA.	TO STA.		FED. ROAD DIST. NO. 1	ILLINOIS FED. AID PROJECT
				CONTRACT NO: 63266

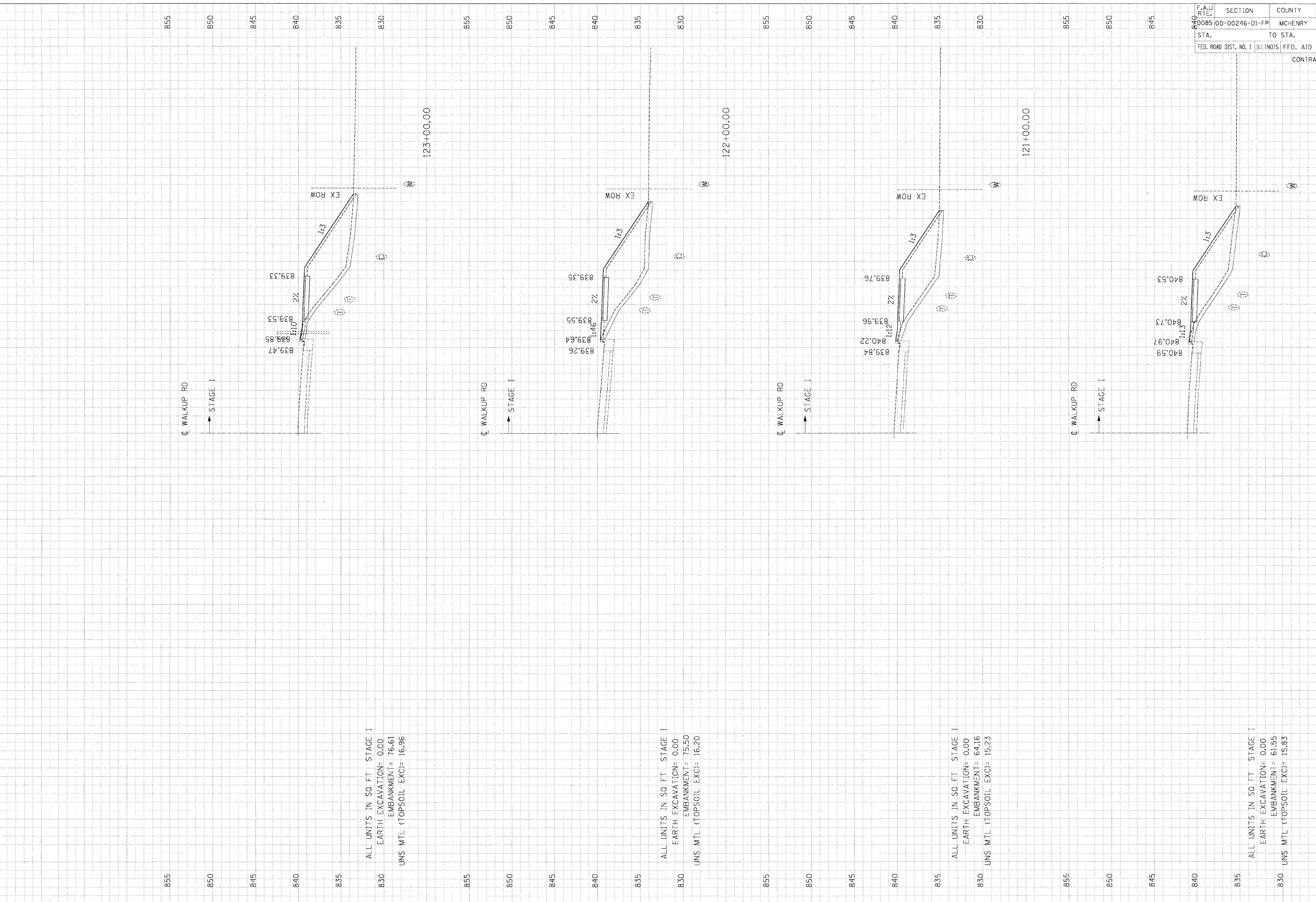

ALL UNITS IN SQ FT. STAGE I
 EARTH EXCAVATION= 0.00
 EMBANKMENT= 76.61
 UNS. MTL. (TOPSOIL. EXC)= 16.96

ALL UNITS IN SQ FT. STAGE I
 EARTH EXCAVATION= 0.00
 EMBANKMENT= 75.50
 UNS. MTL. (TOPSOIL. EXC)= 16.20

ALL UNITS IN SQ FT. STAGE I
 EARTH EXCAVATION= 0.00
 EMBANKMENT= 64.16
 UNS. MTL. (TOPSOIL. EXC)= 15.23

ALL UNITS IN SQ FT. STAGE I
 EARTH EXCAVATION= 0.00
 EMBANKMENT= 61.55
 UNS. MTL. (TOPSOIL. EXC)= 15.83

PROPOSED CROSS-SECTIONS: WALKUP ROAD

DATE	BY	REVISION
		FINAL SURVEY PLOTTED NOTE BOOK AREAS CHECKED

DATE	BY	REVISION
		ORIGINAL SURVEY PLOTTED NOTE BOOK AREAS CHECKED

\\AL10080A.DGN, \\1P0008A.DGN, \\RDW0085.DGN, \\RDW0084.DGN, \\UR40008.DGN, \\UR40009.DGN, \\UR40010.DGN, \\UR40011.DGN, \\UR40012.DGN, \\UR40013.DGN, \\UR40014.DGN, \\UR40015.DGN, \\UR40016.DGN, \\UR40017.DGN, \\UR40018.DGN, \\UR40019.DGN, \\UR40020.DGN, \\UR40021.DGN, \\UR40022.DGN, \\UR40023.DGN, \\UR40024.DGN, \\UR40025.DGN, \\UR40026.DGN, \\UR40027.DGN, \\UR40028.DGN, \\UR40029.DGN, \\UR40030.DGN, \\UR40031.DGN, \\UR40032.DGN, \\UR40033.DGN, \\UR40034.DGN, \\UR40035.DGN, \\UR40036.DGN, \\UR40037.DGN, \\UR40038.DGN, \\UR40039.DGN, \\UR40040.DGN, \\UR40041.DGN, \\UR40042.DGN, \\UR40043.DGN, \\UR40044.DGN, \\UR40045.DGN, \\UR40046.DGN, \\UR40047.DGN, \\UR40048.DGN, \\UR40049.DGN, \\UR40050.DGN, \\UR40051.DGN, \\UR40052.DGN, \\UR40053.DGN, \\UR40054.DGN, \\UR40055.DGN, \\UR40056.DGN, \\UR40057.DGN, \\UR40058.DGN, \\UR40059.DGN, \\UR40060.DGN

NOTE: THE EXACT LOCATION AND ELEVATION
 OF EXISTING STRUCTURES, UTILITIES,
 AND PIPING SHALL BE VERIFIED
 IN THE FIELD BY THE CONTRACTOR.

F.A.U. R.T.E.	SECTION	COUNTY	TOTAL SHEETS	SHEET NO.
8450085	00-00246-01-FP	MCHENRY	236	208
STA.	TO STA.			
FED. ROAD DIST. NO. 1	ILLINOIS	FED. AID PROJECT		
CONTRACT NO: 63266				

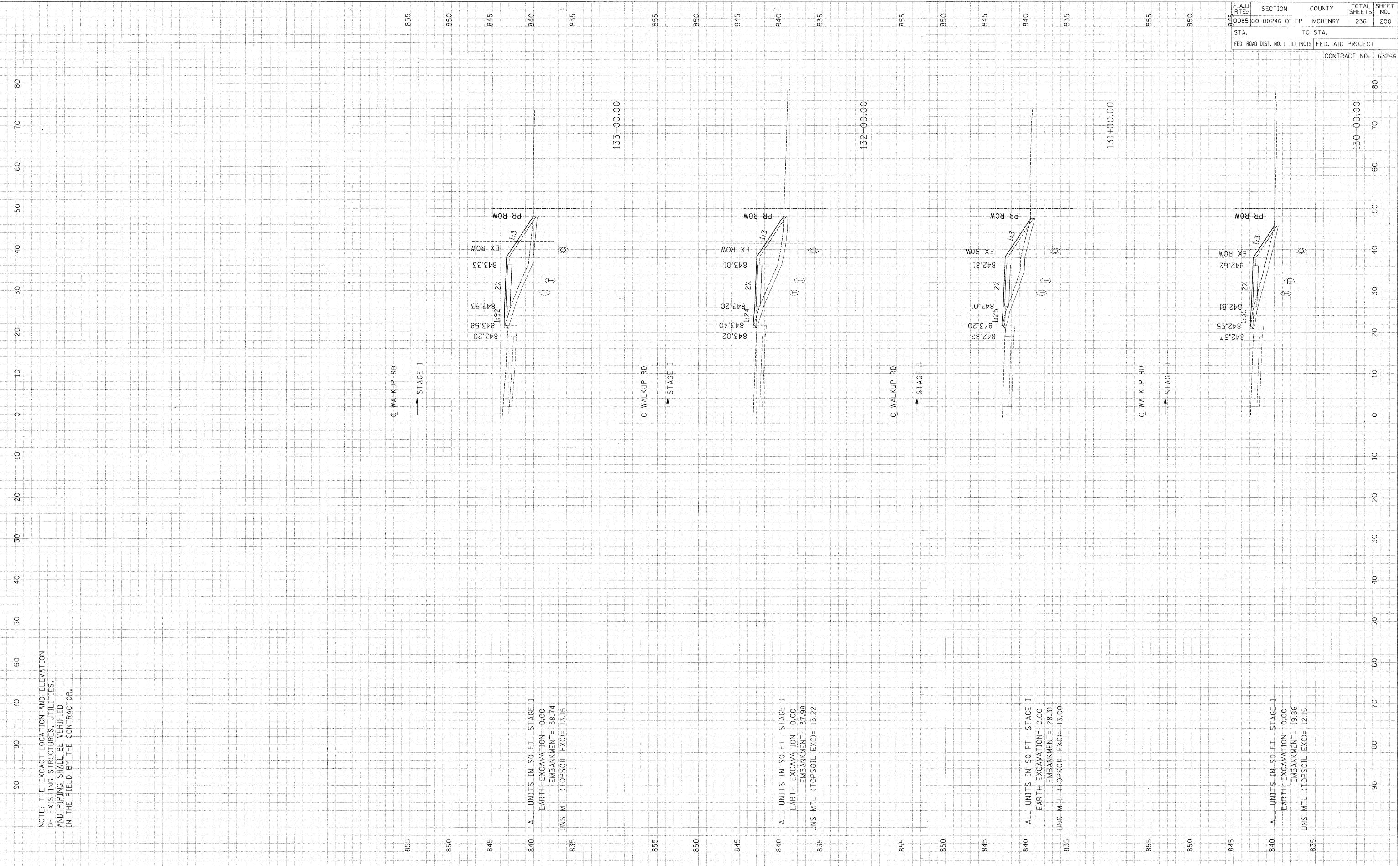

840 ALL UNITS IN 50 FT STAGE I
 EARTH EXCAVATION= 0.00
 EMBANKMENT= 38.74
 UNS MTL (TOPSOIL EXO)= 13.15

840 ALL UNITS IN 50 FT STAGE I
 EARTH EXCAVATION= 0.00
 EMBANKMENT= 37.98
 UNS MTL (TOPSOIL EXO)= 13.22

840 ALL UNITS IN 50 FT STAGE I
 EARTH EXCAVATION= 0.00
 EMBANKMENT= 28.31
 UNS MTL (TOPSOIL EXO)= 13.00

840 ALL UNITS IN 50 FT STAGE I
 EARTH EXCAVATION= 0.00
 EMBANKMENT= 19.86
 UNS MTL (TOPSOIL EXO)= 12.15

FINAL SURVEY PLOTTED NOTE BOOK NO.	BY	DATE
AREAS CHECKED		

ORIGINAL SURVEY PLOTTED NOTE BOOK NO.	BY	DATE
AREAS CHECKED		

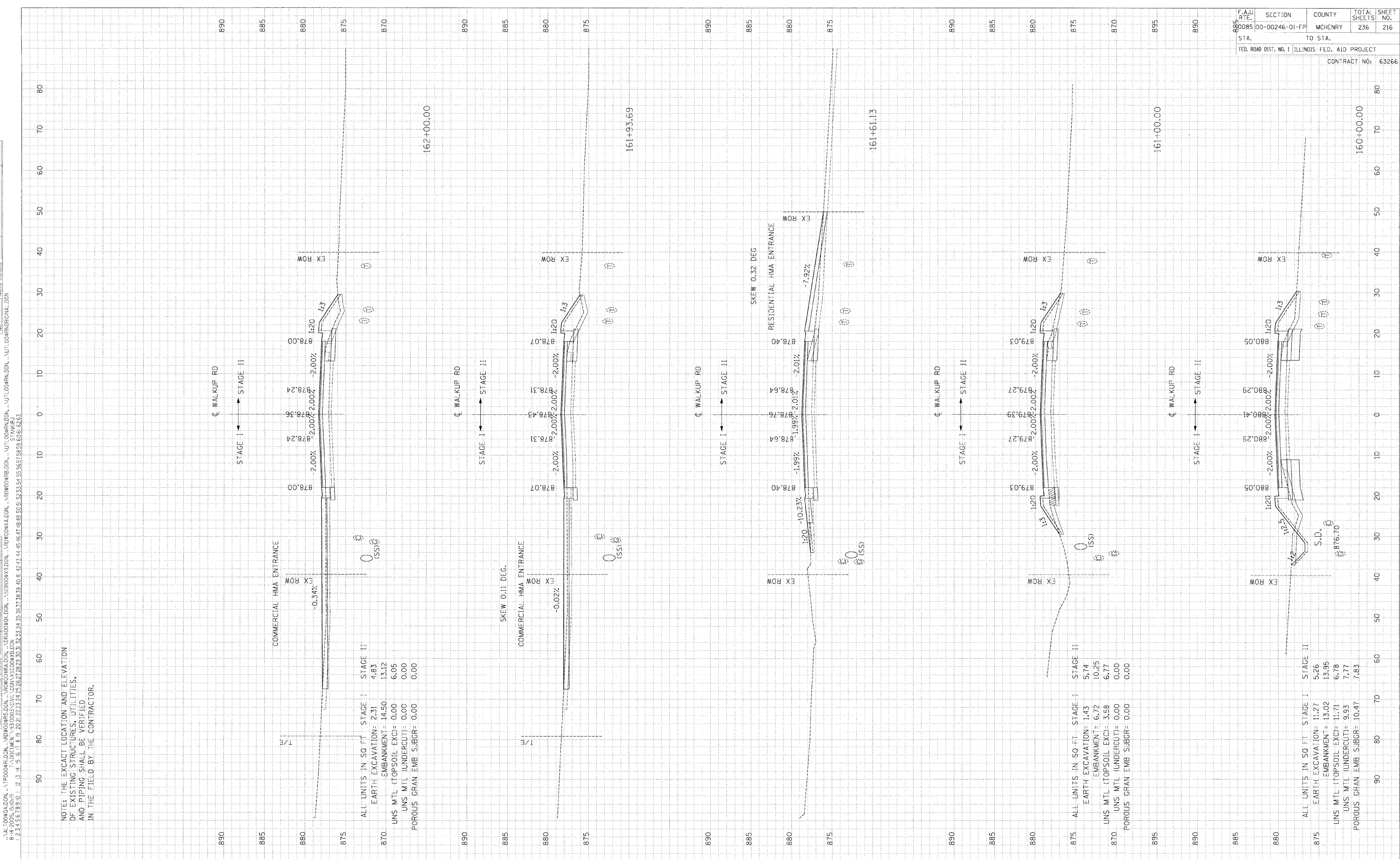

NOTE: THE EXACT LOCATION AND ELEVATION OF EXISTING STRUCTURES, UTILITIES, AND PIPING SHALL BE VERIFIED IN THE FIELD BY THE CONTRACTOR.

ALL UNITS IN SQ. FT.	STAGE I	STAGE II
EARTH EXCAVATION	2.31	4.83
EMBANKMENT	14.50	13.12
UNS. MTL. (TOPSOIL EXC.)	0.00	6.05
UNS. MTL. (UNDERCUT)	0.00	0.00
POROUS GRAN. EMB. SUBGR.	0.00	0.00

SKREW 0.11 DEG.

SKREW 0.32 DEG.

ALL UNITS IN SQ. FT.	STAGE I	STAGE II
EARTH EXCAVATION	1.43	5.74
EMBANKMENT	6.72	10.25
UNS. MTL. (TOPSOIL EXC.)	3.58	6.77
UNS. MTL. (UNDERCUT)	0.00	0.00
POROUS GRAN. EMB. SUBGR.	0.00	0.00

ALL UNITS IN SQ. FT.	STAGE I	STAGE II
EARTH EXCAVATION	11.27	5.26
EMBANKMENT	13.02	13.95
UNS. MTL. (TOPSOIL EXC.)	11.71	6.78
UNS. MTL. (UNDERCUT)	9.93	7.77
POROUS GRAN. EMB. SUBGR.	10.47	7.83

DATE	BY

DATE	BY

\\VAL\DOOR\ADGN... \1P0004\RD.DGN... \RDW008RE.DGN... \RDW008RA.DGN... \DRAG00BK.DGN... \SCRO00K3.DGN... \VIEW008X.DGN... \VIEW008R.DGN... \UI\LOOR\RD.DGN... \UI\LOOR\NOTIONAL.DGN... \UI\LOOR\STANK.PJ... \UI\LOOR\STANK.PJ...
 8-14-2009 16:22:24
 12 3 14 15 16 17 18 19 20 21 22 23 24 25 26 27 28 29 30 31 32 33 34 35 36 37 38 39 40 41 42 43 44 45 46 47 48 49 50 51 52 53 54 55 56 57 58 59 60 61 62 63

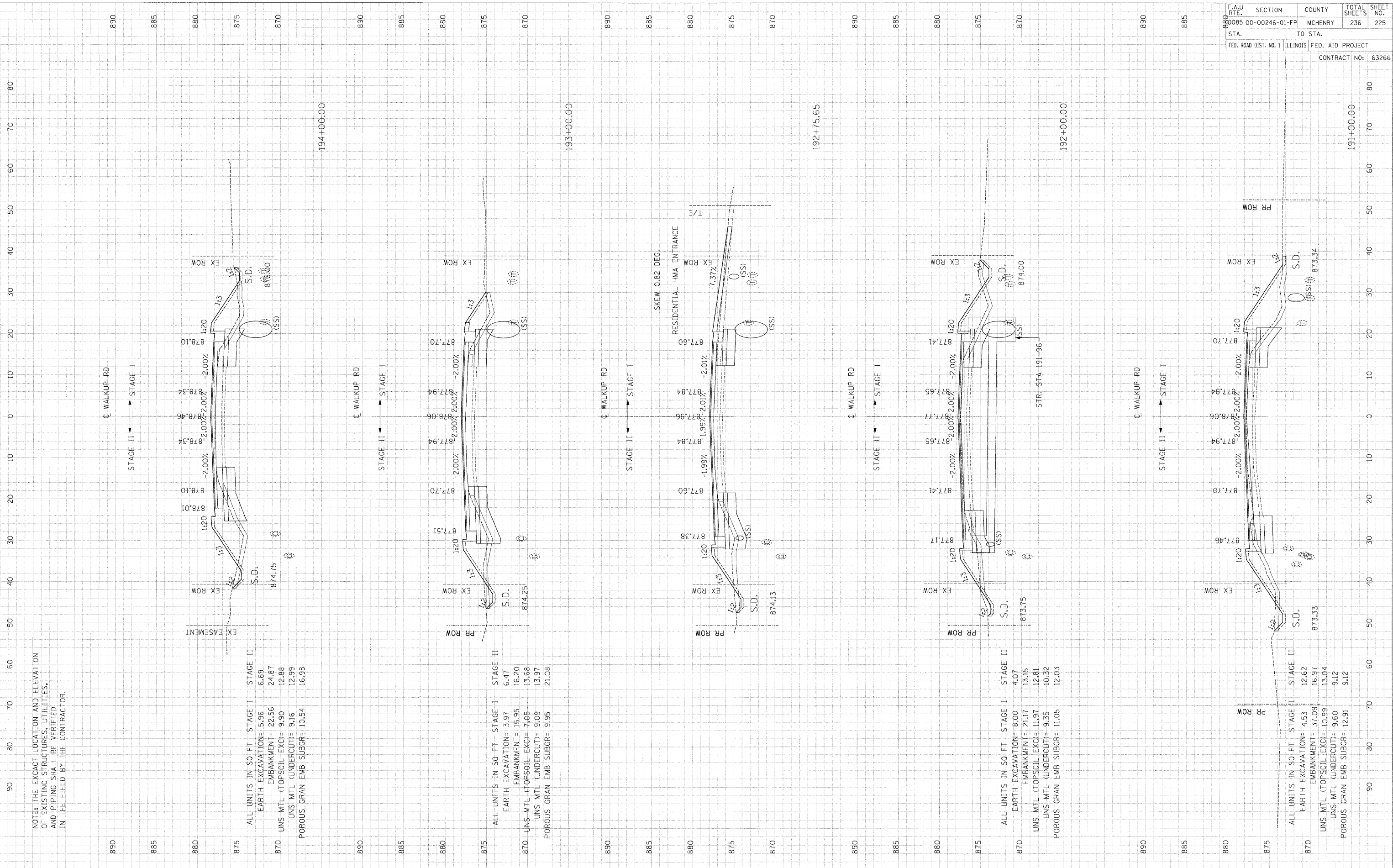

NOTE: THE EXACT LOCATION AND ELEVATION OF EXISTING STRUCTURES, UTILITIES, AND PIPING SHALL BE VERIFIED IN THE FIELD BY THE CONTRACTOR.

ALL UNITS IN SO. FT.	STAGE I	STAGE II
EARTH EXCAVATION	5.96	6.69
EMBANKMENT	22.56	24.87
UNS. MTL. (TOPSOIL EXC)	9.90	12.88
UNS. MTL. (UNDERCUT)	9.16	12.99
POROUS GRAN. EMB. SUBGR.	10.54	16.98

ALL UNITS IN SO. FT.	STAGE I	STAGE II
EARTH EXCAVATION	3.97	6.47
EMBANKMENT	15.95	16.20
UNS. MTL. (TOPSOIL EXC)	7.05	13.68
UNS. MTL. (UNDERCUT)	9.09	13.97
POROUS GRAN. EMB. SUBGR.	9.95	21.08

ALL UNITS IN SO. FT.	STAGE I	STAGE II
EARTH EXCAVATION	8.00	4.07
EMBANKMENT	21.17	13.15
UNS. MTL. (TOPSOIL EXC)	11.97	12.81
UNS. MTL. (UNDERCUT)	9.35	10.32
POROUS GRAN. EMB. SUBGR.	11.05	12.03

ALL UNITS IN SO. FT.	STAGE I	STAGE II
EARTH EXCAVATION	4.53	12.62
EMBANKMENT	37.09	16.97
UNS. MTL. (TOPSOIL EXC)	10.99	13.04
UNS. MTL. (UNDERCUT)	9.60	9.12
POROUS GRAN. EMB. SUBGR.	12.91	9.12

SECTION	COUNTY	TOTAL SHEETS	SHEET NO.
00-00246-01-FP	MCHENRY	236	226
STA. TO STA.		FED. AID PROJECT	
F.A.U. DIST. NO. 1 ILLINOIS		CONTRACT NO: 63266	

BY	DATE

BY	DATE

\VAL10080A.DGN, \IP0008R.DGN, \RDW008RS.DGN, \RDW008RA.DGN, \DR00080K.DGN, \ASCR008X9.DGN, \VEDW008A.DGN, \R0W008RB.DGN, \VU11008R.DGN, \VU11008NR.DGN, \VU11008NRORIG.DGN
 8-14-2009 15:24:42
 T:\DOCUMENT\55000\CVL\RDW\RDW008RA.DGN, \RDW008RS.DGN, \DR00080K.DGN, \ASCR008X9.DGN, \VEDW008A.DGN, \R0W008RB.DGN, \VU11008R.DGN, \VU11008NR.DGN, \VU11008NRORIG.DGN
 1,2,3,4,5,6,7,8,9,10,11,12,13,14,15,16,17,18,19,20,21,22,23,24,25,26,27,28,29,30,31,32,33,34,35,35,37,38,39,40,41,42,43,44,45,46,47,48,49,50,51,52,53,54,55,56,57,58,59,60,61,62,63

NOTE: THE EXACT LOCATION AND ELEVATION
 OF EXISTING STRUCTURES, UTILITIES,
 AND PIPING SHALL BE VERIFIED
 IN THE FIELD BY THE CONTRACTOR.

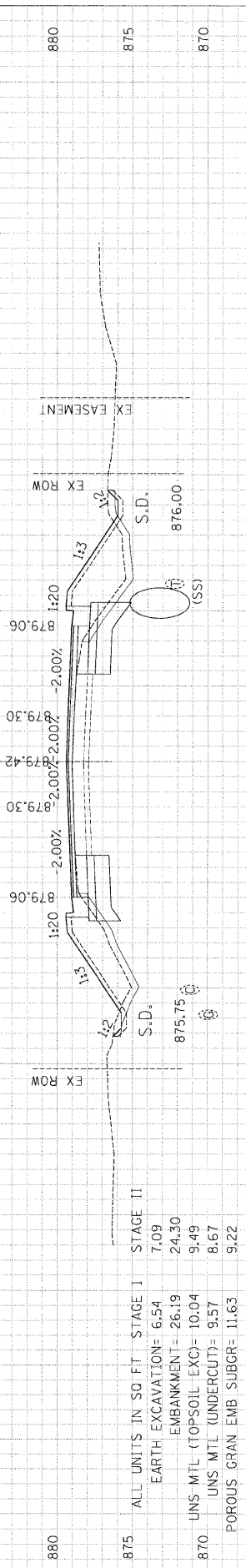
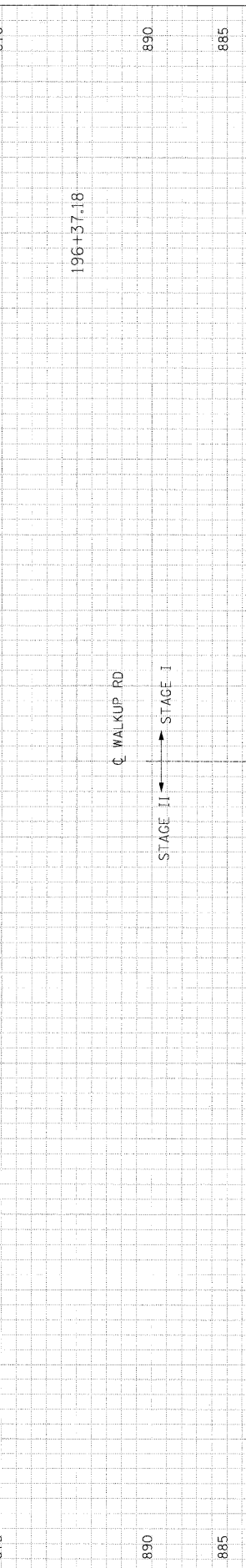
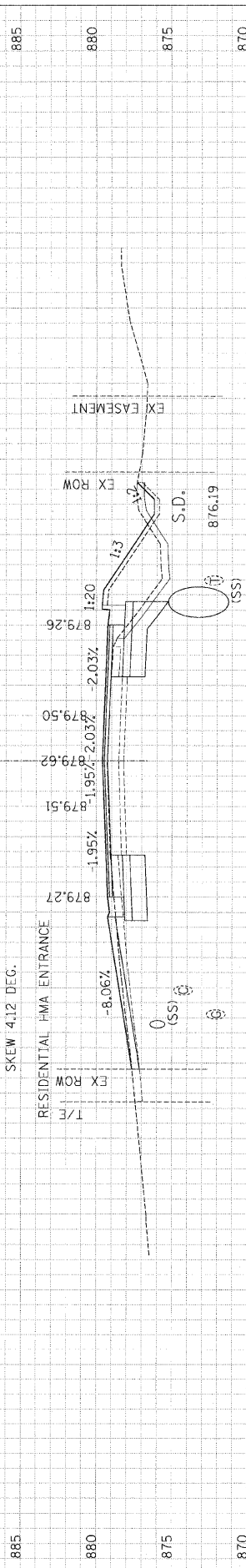
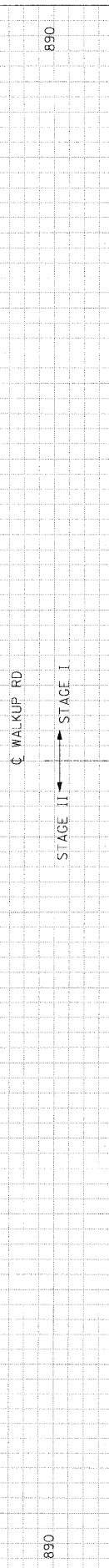

	STAGE I	STAGE II
ALL UNITS IN SQ FT	7.09	7.09
EARTH EXCAVATION	6.54	7.28
EMBANKMENT	24.30	21.84
UNS MTL (TOPSOIL EXC)	10.04	10.90
UNS MTL (UNDERCUT)	9.57	8.67
POROUS GRAN EMB SUBGR	11.63	9.22

	STAGE I	STAGE II
ALL UNITS IN SQ FT	4.83	4.83
EARTH EXCAVATION	4.83	7.28
EMBANKMENT	23.94	21.84
UNS MTL (TOPSOIL EXC)	9.18	10.90
UNS MTL (UNDERCUT)	8.87	8.75
POROUS GRAN EMB SUBGR	10.59	9.52

PROPOSED CROSS-SECTIONS: WALKUP ROAD

DATE	BY

DATE	BY

\ALT00804.DGN, \TIP0008.DGN, \R000085.DGN, \R000086.DGN, \R000087.DGN, \R000088.DGN, \R000089.DGN, \R000090.DGN, \R000091.DGN, \R000092.DGN, \R000093.DGN, \R000094.DGN, \R000095.DGN, \R000096.DGN, \R000097.DGN, \R000098.DGN, \R000099.DGN, \R000100.DGN, \R000101.DGN, \R000102.DGN, \R000103.DGN, \R000104.DGN, \R000105.DGN, \R000106.DGN, \R000107.DGN, \R000108.DGN, \R000109.DGN, \R000110.DGN, \R000111.DGN, \R000112.DGN, \R000113.DGN, \R000114.DGN, \R000115.DGN, \R000116.DGN, \R000117.DGN, \R000118.DGN, \R000119.DGN, \R000120.DGN, \R000121.DGN, \R000122.DGN, \R000123.DGN, \R000124.DGN, \R000125.DGN, \R000126.DGN, \R000127.DGN, \R000128.DGN, \R000129.DGN, \R000130.DGN, \R000131.DGN, \R000132.DGN, \R000133.DGN, \R000134.DGN, \R000135.DGN, \R000136.DGN, \R000137.DGN, \R000138.DGN, \R000139.DGN, \R000140.DGN, \R000141.DGN, \R000142.DGN, \R000143.DGN, \R000144.DGN, \R000145.DGN, \R000146.DGN, \R000147.DGN, \R000148.DGN, \R000149.DGN, \R000150.DGN, \R000151.DGN, \R000152.DGN, \R000153.DGN, \R000154.DGN, \R000155.DGN, \R000156.DGN, \R000157.DGN, \R000158.DGN, \R000159.DGN, \R000160.DGN

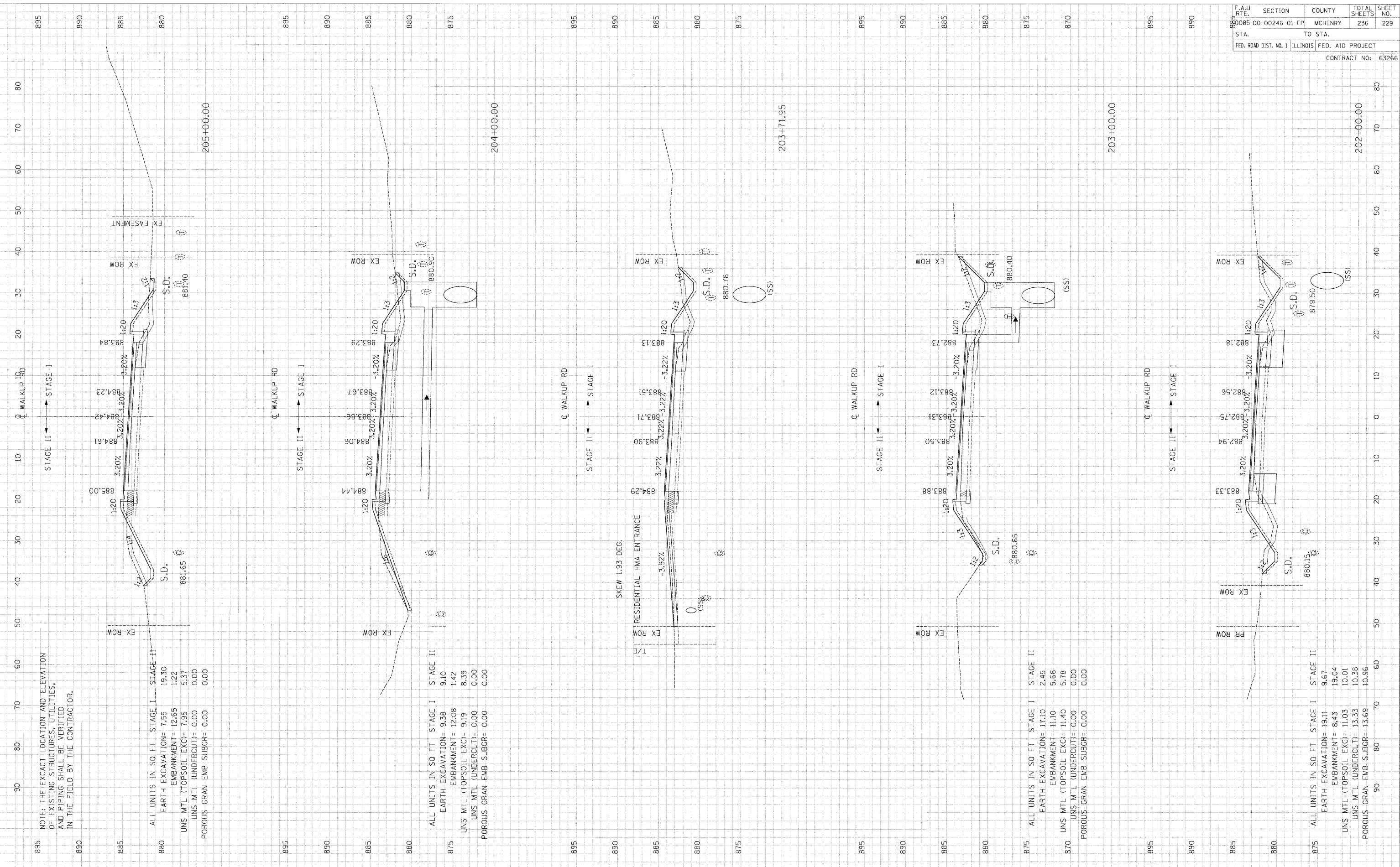

NOTE: THE EXACT LOCATION AND ELEVATION OF EXISTING STRUCTURES, UTILITIES, AND PIPING SHALL BE VERIFIED IN THE FIELD BY THE CONTRACTOR.

ALL UNITS IN SQ. FT. STAGE I STAGE II
 EARTH EXCAVATION= 7.55 19.30
 EMBANKMENT= 12.65 1.22
 UNS MTL (TOPSOIL EXC)= 7.95 5.37
 UNS MTL (UNDERCUT)= 0.00 0.00
 POROUS GRAN EMB SUBGR= 0.00 0.00

ALL UNITS IN SQ. FT. STAGE I STAGE II
 EARTH EXCAVATION= 9.38 9.10
 EMBANKMENT= 12.08 1.42
 UNS MTL (TOPSOIL EXC)= 9.19 8.39
 UNS MTL (UNDERCUT)= 0.00 0.00
 POROUS GRAN EMB SUBGR= 0.00 0.00

ALL UNITS IN SQ. FT. STAGE I STAGE II
 EARTH EXCAVATION= 17.10 2.45
 EMBANKMENT= 11.10 5.66
 UNS MTL (TOPSOIL EXC)= 11.40 5.78
 UNS MTL (UNDERCUT)= 0.00 0.00
 POROUS GRAN EMB SUBGR= 0.00 0.00

ALL UNITS IN SQ. FT. STAGE I STAGE II
 EARTH EXCAVATION= 19.11 9.67
 EMBANKMENT= 8.43 19.04
 UNS MTL (TOPSOIL EXC)= 11.03 10.01
 UNS MTL (UNDERCUT)= 13.33 10.38
 POROUS GRAN EMB SUBGR= 13.69 10.96

F.A.U. R.T.E. 89085	SECTION 00-00246-01-FP	COUNTY MCHENRY	TOTAL SHEETS 236	SHEET NO. 229
STA. TO STA.		FED. AID PROJECT		
FED. ROAD DIST. NO. 1 ILLINOIS		CONTRACT NO: 63266		

FINAL SURVEY PLOTTED	BY	DATE
NOTE BOOK TEMPLATE		
AREAS CHECKED		

ORIGINAL SURVEY PLOTTED	BY	DATE
NOTE BOOK TEMPLATE		
AREAS CHECKED		

\\ALT008OLDON...\\P0008RD.DGN...\\R0008R.DGN...\\R0008R.DGN...\\UTL008R.DGN...\\UTL008R.DGN...\\UTL008R.DGN...\\UTL008R.DGN...
 STATIONING: 206+00.00 TO 209+00.00
 F.A. PROJECT: 00-00246-01-PP
 COUNTY: MCHENRY
 SHEET NO.: 230

NOTE: THE EXACT LOCATION AND ELEVATION
 OF EXISTING STRUCTURES, UTILITIES,
 AND PIPING SHALL BE VERIFIED
 IN THE FIELD BY THE CONTRACTOR.

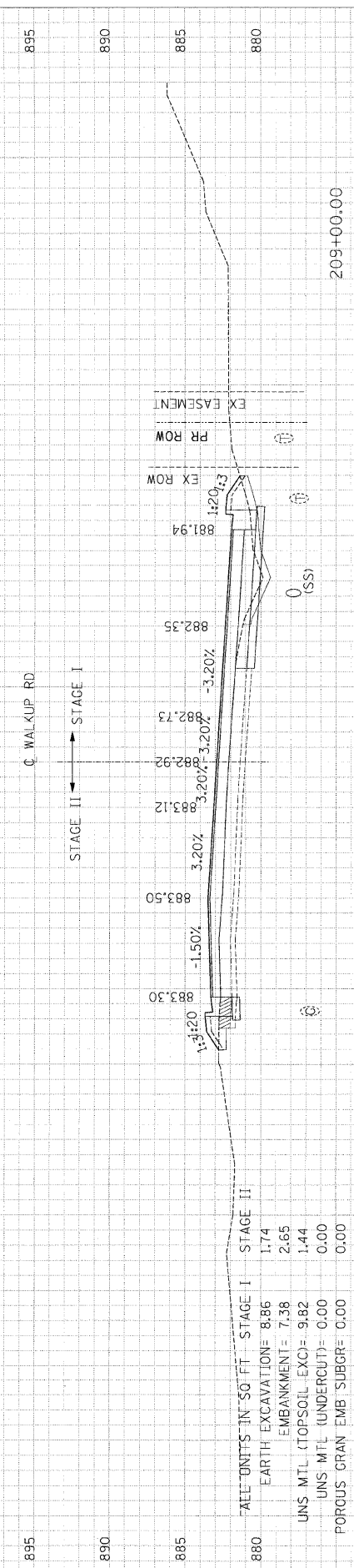

ALL UNITS IN SQ FT
 STAGE I EARTH EXCAVATION= 8.86
 EMBANKMENT= 1.74
 STAGE II EARTH EXCAVATION= 7.38
 EMBANKMENT= 2.65
 UNS MTL (TOPSOIL EXC)= 9.82
 UNS MTL (UNDERCUT)= 0.00
 POROUS GRAN EMB SUBGR= 0.00

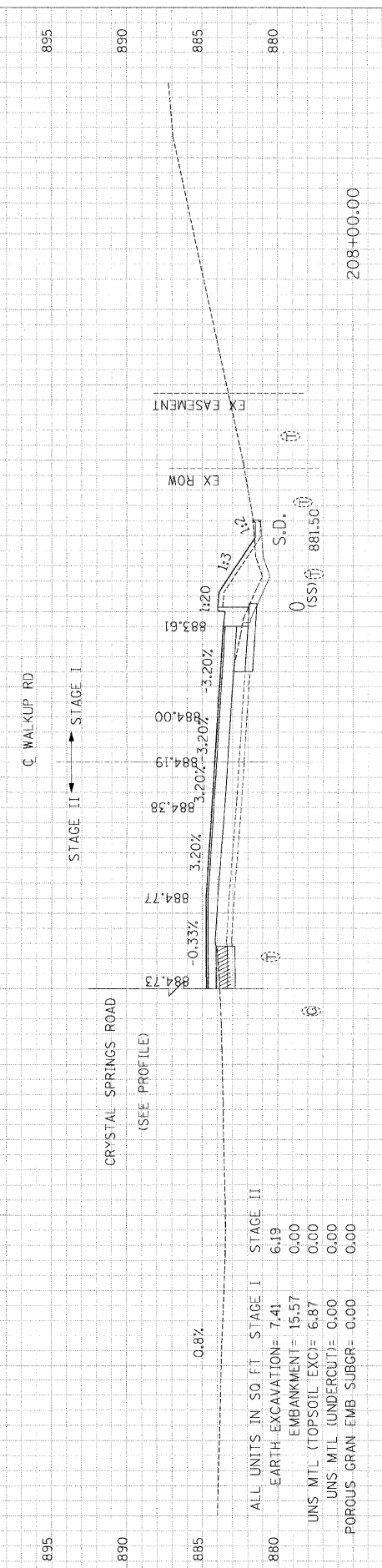

ALL UNITS IN SQ FT
 STAGE I EARTH EXCAVATION= 7.41
 EMBANKMENT= 15.57
 STAGE II EARTH EXCAVATION= 6.87
 EMBANKMENT= 0.00
 UNS MTL (TOPSOIL EXC)= 6.87
 UNS MTL (UNDERCUT)= 0.00
 POROUS GRAN EMB SUBGR= 0.00

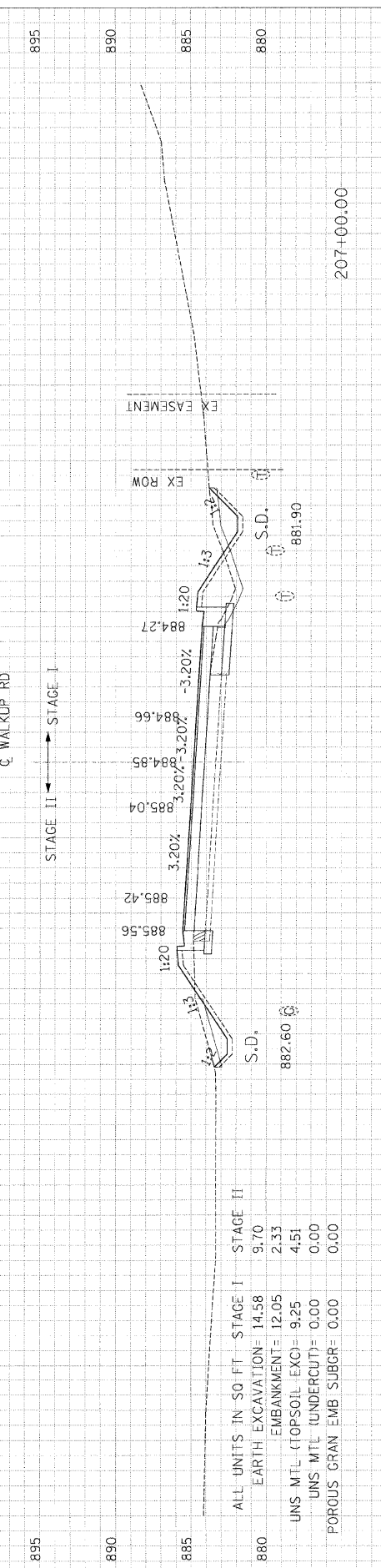

ALL UNITS IN SQ FT
 STAGE I EARTH EXCAVATION= 14.58
 EMBANKMENT= 12.05
 STAGE II EARTH EXCAVATION= 9.70
 EMBANKMENT= 2.33
 UNS MTL (TOPSOIL EXC)= 9.25
 UNS MTL (UNDERCUT)= 0.00
 POROUS GRAN EMB SUBGR= 0.00

DATE	
BY	
DATE	
BY	
DATE	
BY	

DATE	
BY	
DATE	
BY	
DATE	
BY	

\\ALTO089JLDN... \1P000R4LDN... \R0W0048RD.DGN... \R0W0048RD.DGN... \R0W0048RD.DGN... \R0W0048RD.DGN... \R0W0048RD.DGN...
 P: 24059.13128
 L: 24358.1320. 12. 13. 14. 15. 16. 17. 18. 19. 20. 21. 22. 23. 24. 25. 26. 27. 28. 29. 30. 31. 32. 33. 34. 35. 36. 37. 38. 39. 40. 41. 42. 43. 44. 45. 46. 47. 48. 49. 50. 51. 52. 53. 54. 55. 56. 57. 58. 59. 60. 61. 62. 63

NOTE: THE EXACT LOCATION AND ELEVATION OF EXISTING STRUCTURES, UTILITIES, AND PIPING SHALL BE VERIFIED IN THE FIELD BY THE CONTRACTOR.

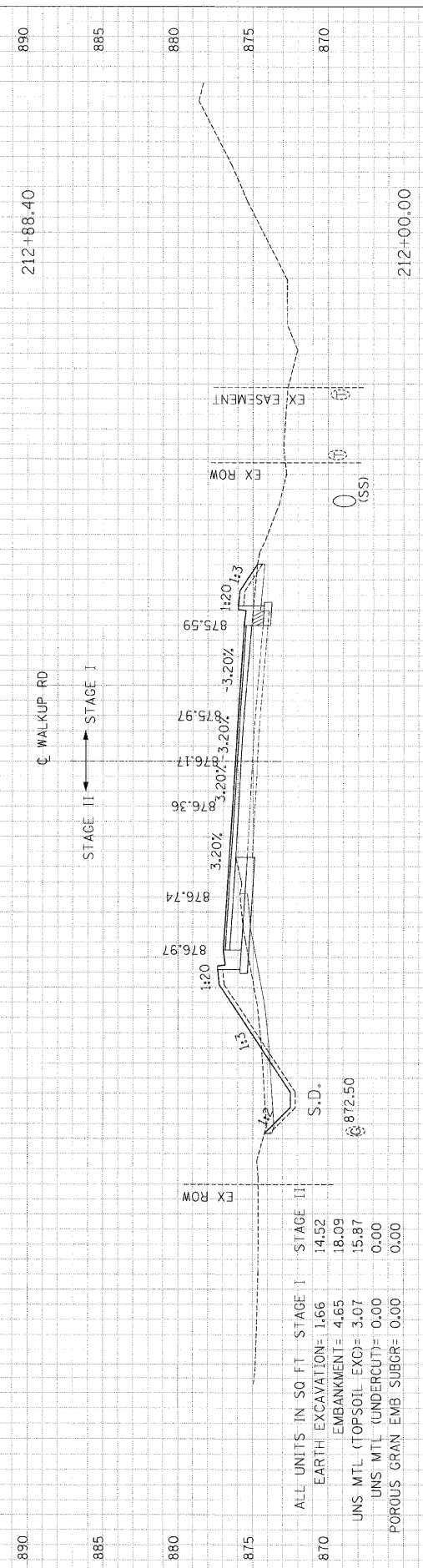
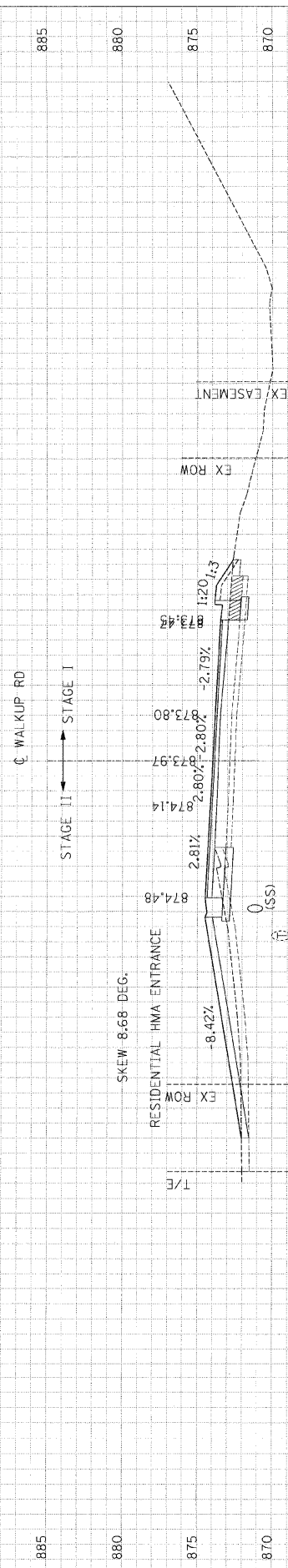

ALL UNITS IN SQ. FT. STAGE I STAGE II
 EARTH EXCAVATION= 1.66 14.52
 EMBANKMENT= 4.65 18.09
 UNS MTL (TOPSOIL EXD)= 3.07 15.87
 UNS MTL (UNDERCUT)= 0.00 0.00
 POROUS GRAN EMB SUBGR= 0.00 0.00

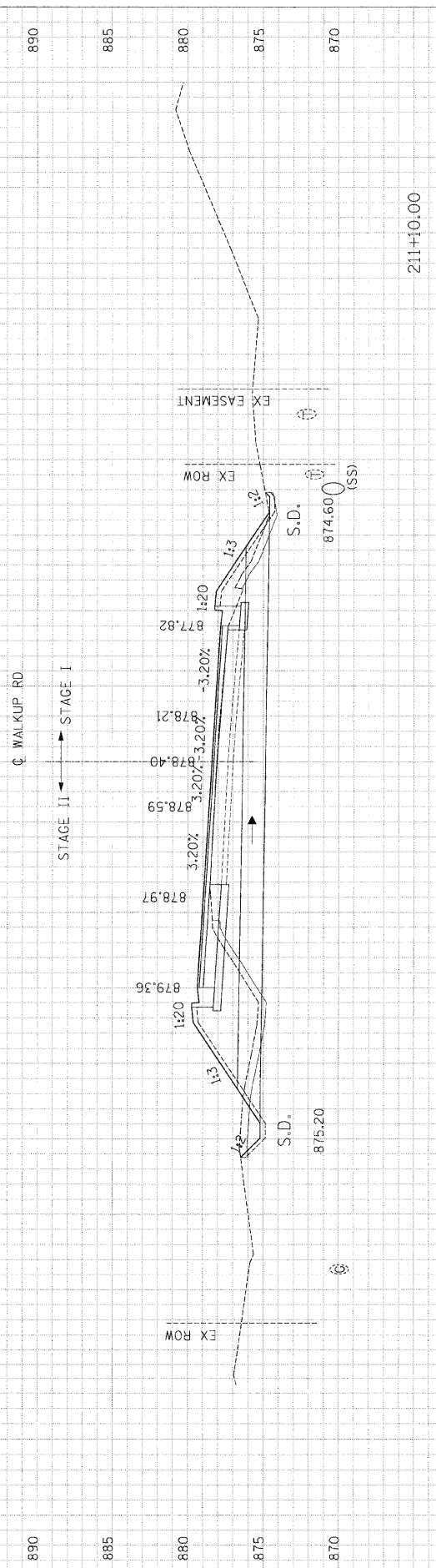

ALL UNITS IN SQ. FT. STAGE I STAGE II
 EARTH EXCAVATION= 3.96 11.03
 EMBANKMENT= 12.36 45.14
 UNS MTL (TOPSOIL EXD)= 5.87 15.49
 UNS MTL (UNDERCUT)= 0.00 0.00
 POROUS GRAN EMB SUBGR= 0.00 0.00

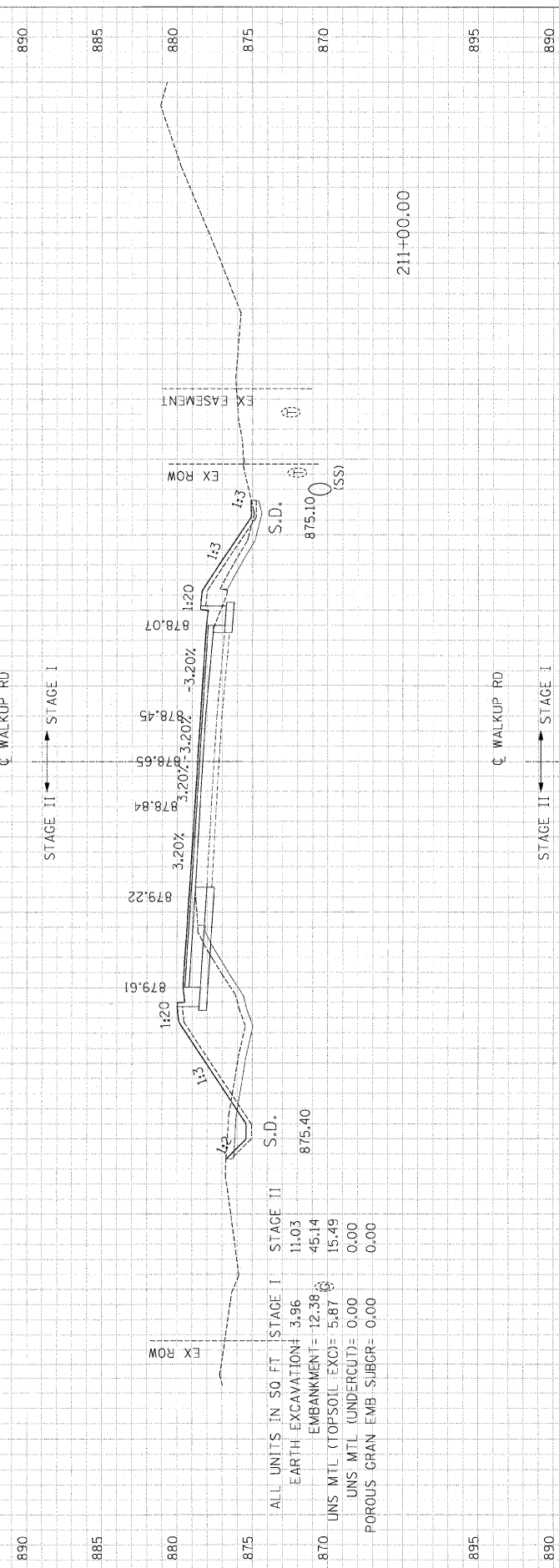

ALL UNITS IN SQ. FT. STAGE I STAGE II
 EARTH EXCAVATION= 8.13 4.57
 EMBANKMENT= 8.87 9.22
 UNS MTL (TOPSOIL EXD)= 7.57 4.12
 UNS MTL (UNDERCUT)= 0.00 0.00
 POROUS GRAN EMB SUBGR= 0.00 0.00

DATE	
BY	
FINL SURVEY PLOTTED NOTE BOOK NO.	
SURFED PLOTTED TEMPLATE NO.	
AREAS CHECKED	

DATE	
BY	
ORIGINAL SURVEY PLOTTED NOTE BOOK NO.	
SURFED PLOTTED TEMPLATE NO.	
AREAS CHECKED	

F.A.L.U. STA.	SECTION	COUNTY	TOTAL SHEETS	SHEET NO.
870085	00-00246-01-FP	MCHENRY	236	232
TO STA.			FED. AID PROJECT	
FED. ROAD DIST. NO. 1 ILLINOIS			CONTRACT NO: 63266	

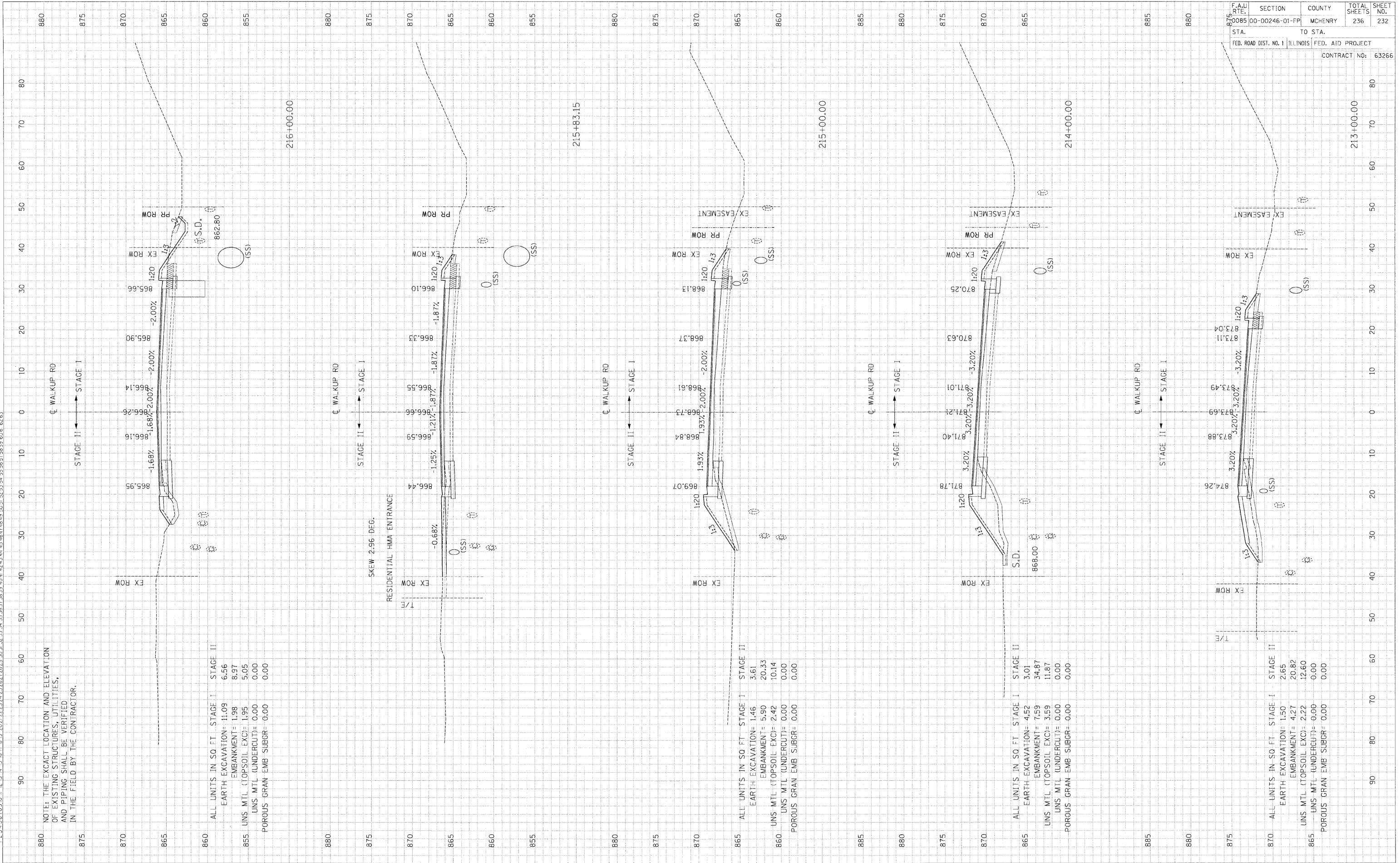

880 NOTE: THE EXACT LOCATION AND ELEVATION OF EXISTING STRUCTURES, UTILITIES, AND PIPING SHALL BE VERIFIED IN THE FIELD BY THE CONTRACTOR.

860

ALL UNITS IN SQ. FT.	STAGE I	STAGE II
EARTH EXCAVATION=	11.09	6.56
EMBANKMENT=	1.98	8.97
UNS MTL (TOPSOIL EXC)=	1.95	5.05
UNS MTL (UNDERCUT)=	0.00	0.00
POROUS GRAN EMB SUBGR=	0.00	0.00

865

ALL UNITS IN SQ. FT.	STAGE I	STAGE II
EARTH EXCAVATION=	1.46	3.61
EMBANKMENT=	5.90	20.33
UNS MTL (TOPSOIL EXC)=	2.42	10.14
UNS MTL (UNDERCUT)=	0.00	0.00
POROUS GRAN EMB SUBGR=	0.00	0.00

865

ALL UNITS IN SQ. FT.	STAGE I	STAGE II
EARTH EXCAVATION=	4.52	3.01
EMBANKMENT=	7.59	34.87
UNS MTL (TOPSOIL EXC)=	3.59	11.87
UNS MTL (UNDERCUT)=	0.00	0.00
POROUS GRAN EMB SUBGR=	0.00	0.00

870

ALL UNITS IN SQ. FT.	STAGE I	STAGE II
EARTH EXCAVATION=	1.50	2.65
EMBANKMENT=	4.27	20.82
UNS MTL (TOPSOIL EXC)=	2.22	12.60
UNS MTL (UNDERCUT)=	0.00	0.00
POROUS GRAN EMB SUBGR=	0.00	0.00

