

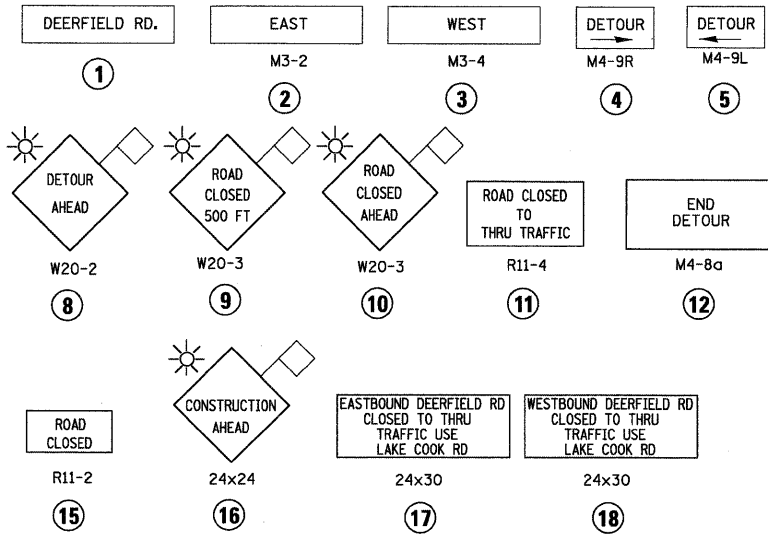

- EAST/WEST DETOUR ROUTE
- ▬ BRIDGE CLOSED
- LOCAL AND CONSTRUCTION TRAFFIC ONLY



PLACE 100' AHEAD OF PROPOSED PATH

- 4 PROPOSED CONSTRUCTION SIGN
- 1 TYPE III BARRICADE
- DEERFIELD RD - COUNTY RTE A47 (LAKE COUNTY JURISDICTION)
- MILWAUKEE AVE - STATE RTE 21 - US RTE 45 (IDOT JURISDICTION)
- LAKE COOK RD - COUNTY RTE A50 (COOK COUNTY JURISDICTION)
- SAUNDERS RD - COUNTY RTE W24 (LAKE COUNTY JURISDICTION)

**SUGGESTED TRAFFIC CONTROL PLAN GENERAL NOTES**

1. ALL SIGNING SHALL BE IN ACCORDANCE WITH THE APPLICABLE PROVISIONS OF THE STATE OF ILLINOIS "STANDARD SPECIFICATIONS FOR ROAD AND BRIDGE CONSTRUCTION ADOPTED JANUARY 1, 2007", "THE QUALITY STANDARD FOR WORK ZONE TRAFFIC CONTROL DEVICES ADOPTED 2004", THE DETAILS IN THESE PLANS, THE LATEST EDITION OF THE STATE OF ILLINOIS "MANUAL OF UNIFORM TRAFFIC CONTROL DEVICES", AND THE SPECIAL PROVISIONS.
2. THE ENGINEER SHALL BE NOTIFIED IN WRITING AT LEAST THREE WEEKS PRIOR TO THE DAY THE DETOUR IS TO BE IN EFFECT. THE ENGINEER SHALL DETERMINE THE HOUR OF CLOSURE. THE ENGINEER WILL CONTACT THE APPROPRIATE LOCAL AGENCIES AND INTERESTED PARTIES.
3. THE CONTRACTOR SHALL SUPPLY TO THE ENGINEER THE NAMES AND TELEPHONE NUMBERS OF HIS REPRESENTATIVES ON THE CONSTRUCTION SITE AND HIS REPRESENTATIVE RESPONSIBLE FOR THE DETOUR SIGNING PRIOR TO THE START OF THE WORK.
4. IF REQUESTED BY THE CONTRACTOR IN WRITING AT LEAST THREE WEEKS PRIOR TO THE DAY THE DETOUR IS TO BE IN EFFECT, THE ENGINEER WILL FIELD LOCATE THE POSITIONS OF ANY SIGNS.
5. THE DURATION OF THIS DETOUR SHALL NOT EXCEED FOUR (4) CALENDAR DAYS. THE CONTRACTOR SHALL PROCEED WITH THE WORK IN AN EXPEDIENT MANNER TO REDUCE THE LENGTH OF TIME THAT THE DETOUR NEEDS TO BE IN EFFECT.
6. THE ROAD SHALL NOT BE CLOSED UNTIL ALL SIGNING IS ERECTED IN ACCORDANCE WITH THE DETOUR PLAN AND INSPECTED AND APPROVED BY THE ENGINEER.
7. THE CONTRACTOR SHALL BE RESPONSIBLE FOR ENSURING THAT ALL BARRICADES, SIGNS, LIGHTS, AND OTHER DEVICES INSTALLED BY HIM ARE IN PLACE AND OPERATING 24 HOURS EACH DAY INCLUDING SUNDAYS AND HOLIDAYS DURING THE TIME THE DETOUR IS IN EFFECT.
8. THE TRAFFIC CONTROL SHOWN ON THE DETOUR PLAN IS THE MINIMUM NECESSARY TO ENSURE THIS ROAD CLOSURE. THE CONTRACTOR SHALL MAKE ALL CHANGES IN TRAFFIC CONTROL THAT IS DEEMED NECESSARY BY THE ENGINEER. ADDITIONS AND DELETIONS OF TRAFFIC CONTROL FOR THIS DETOUR SHALL BE CONSIDERED INCLUDED IN THE COST OF THE PAY ITEM "TRAFFIC CONTROL AND PROTECTION, (DETOUR 1)".
9. ALL EXISTING SIGNING THAT IS NOT APPLICABLE WHILE THE DETOUR IS IN EFFECT SHALL BE COMPLETELY COVERED BY THE CONTRACTOR, IN A MANNER APPROVED BY THE ENGINEER.
10. ALL DETOUR SIGNING SHALL BE POST MOUNTED IF THE ROAD CLOSURE IS TO EXCEED FOUR (4) CALENDAR DAYS.

SIGN SPACING:  
200' BETWEEN 8&13, 7&4, AND 6&5  
300' BETWEEN 9&7, 9&6, AND 9&8  
500' BETWEEN 8&9, 14&15, 17&8, 18&8 AND 10&14

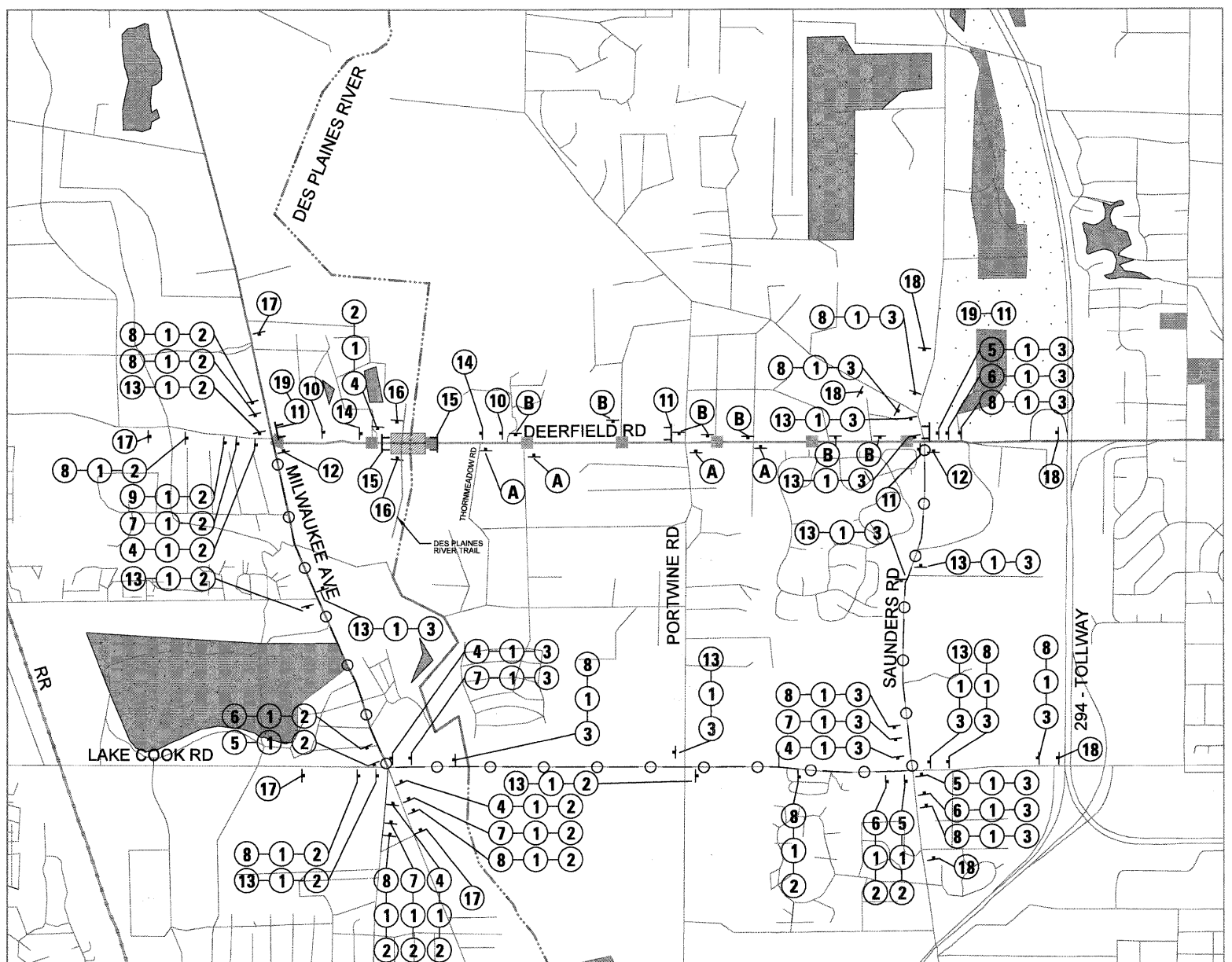
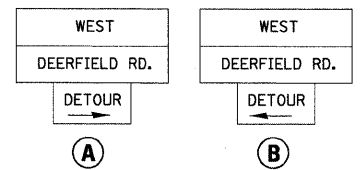
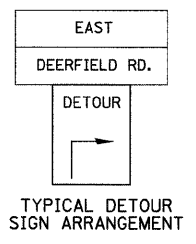

11. ALL DETOUR SIGNING EXCEPT REGULATORY SIGNS SHALL HAVE BLACK LEGENDS ON FLUORESCENT ORANGE SHEETING AND STANDARD BLACK BORDERS. THE FLUORESCENT ORANGE REFLECTIVE SHEETING SHALL MEET THE REQUIREMENTS OF ARTICLE 1084.02 OF THE STANDARD SPECIFICATIONS. ALL DETOUR SIGNING SHALL BE NEW OR LIKE NEW CONDITION OF THE SIGNS. THE ENGINEER SHALL BE THE SOLE JUDGE OF THE CONDITION OF THE SIGNS.
12. THE SIZES OF ALL SIGNS NOT SPECIFIED IN THESE PLANS SHALL BE AS REQUIRED BY THE ILLINOIS MANUAL ON UNIFORM TRAFFIC CONTROL DEVICES.
13. AS A MINIMUM, ALL AMBER FLASHING LIGHTS THAT ARE REQUIRED FOR THIS DETOUR SHALL MEET THE REQUIREMENTS FOR TYPE A-LOW INTENSITY FLASHING LIGHTS IN ARTICLE 1084.01 OF THE STANDARD SPECIFICATIONS. ALL LIGHTS SHALL OPERATE DURING THE HOURS OF DARKNESS. ONLY LIGHTS THAT HAVE BEEN APPROVED BY THE ILLINOIS DEPARTMENT OF TRANSPORTATION SHALL BE USED.
14. WHEN REQUIRED THE MINIMUM DIMENSIONS OF THE ORANGE WARNING FLAGS SHOWN IN THESE PLANS ARE 18" X 18".
15. ALL BARRICADES SHALL HAVE REFLECTORIZED STRIPING ON BOTH SIDES OF THE BARRICADES. THE TYPE III BARRICADES USED AT THE POINT OF CLOSURE TO THRU TRAFFIC SHALL NOT EXCEED 8 FEET IN WIDTH EACH, FOR A SINGLE APPROACH LANE.
16. THE "ROAD CLOSED" (R11-2), THE "ROAD CLOSED TO THRU TRAFFIC" (R11-4) SIGNS SHALL BE MOUNTED ABOVE THE TOP OF THE BARRICADE. ALL TYPE III BARRICADES SHALL HAVE TWO (2) AMBER TYPE A-LOW INTENSITY FLASHING LIGHTS SPACED NEAR THE CENTERLINE OF THE SUPPORTS.
17. THE ROAD NAME SIGN SHALL HAVE A BLACK LEGEND ON FLUORESCENT ORANGE REFLECTIVE SHEETING. THE SIGN SHALL BE A 9" X VARIABLE OR A 12" X VARIABLE WITH DESIGN SERIES C LETTERS. THE CAPITAL LETTERS SHALL BE 6" WITH 5" LOWER CASE.
18. DURING NON-WORKING HOURS AT THE POINT OF ROAD CLOSURE TO ALL TRAFFIC THE CONTRACTOR SHALL PROVIDE A MEANS TO RESTRAIN THE BARRICADES FROM EASY MOVEMENT BY VANDALS. THE CHOSEN METHOD SHALL BE APPROVED BY THE ENGINEER.
19. CONSTRUCTION EQUIPMENT SHALL NOT BE PARKED WITHIN 25 FT BEHIND THE TYPE III BARRICADES. IN ANY EVENT ARTICLE 701.04 OF THE STANDARD SPECIFICATIONS SHALL APPLY.
20. THE CONTRACTOR SHALL BE RESPONSIBLE FOR MAINTAINING THE VISIBILITY OF ALL DETOUR AND CONSTRUCTION SIGNING, INCLUDING BRUSHING BACK VEGETATION IF DEEMED NECESSARY BY THE ENGINEER.
21. THE ENGINEER SHALL BE NOTIFIED AT LEAST TWO (2) HOURS BEFORE THE ROAD IS TO BE OPENED TO TRAFFIC. THE ENGINEER WILL CONTACT THE APPROPRIATE LOCAL AGENCIES AND INTERESTED PARTIES.
22. LIQUIDATED DAMAGES WILL APPLY IF DEERFIELD ROAD ROADWAY CLOSURE DURATION EXCEEDS FOUR CONSECUTIVE CALENDAR DAYS. SEE SPECIAL PROVISIONS.
23. THE ENGINEER SHALL CONTACT THE TRAFFIC CONTROL SUPERVISOR AT 847-705-4470 A MINIMUM OF 72 HOURS PRIOR TO THE PLACEMENT OF ANY TEMPORARY TRAFFIC CONTROL DEVICES.

FILE NAME = N:\LCDOT\06377A\CV1\1\DOTR_06377A.SHT	USER NAME = JBARNETT	DESIGNED - BLL	REVISED -	STATE OF ILLINOIS DEPARTMENT OF TRANSPORTATION		DEERFIELD ROAD BIKE PATH SUGGESTED TRAFFIC CONTROL - DETOUR ROUTE		F.A.U. RTE. 1257	SECTION 04-0038-03-BT	COUNTY LAKE	TOTAL SHEETS 40	SHEET NO. 12
PLOT SCALE = 200'	CHECKED - JGS	REVISED -	REVISED -					SCALE: NONE	SHEET NO. 1 OF 1 SHEETS	STA. TO STA.	FED. ROAD DIST. NO. 1 ILLINOIS FED. AID PROJECT	CONTRACT NO. 63408
PLOT DATE = 12/9/2009	DATE = 12/01/09	REVISED -	REVISED -									