

Notes:
 See sheet S-7 of S-25 for Sections C-C & D-D.
 a(E), a₁(E), and w(E) bar spacings measured perpendicular to ϕ Rdwy.
 For Bridge Approach layout see Sheet S-8.

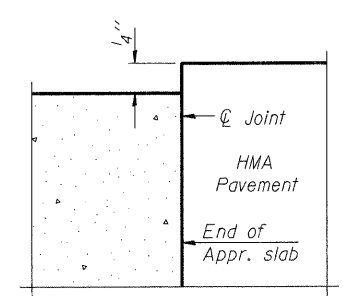

* Tilt #9 b₁(E) bars as required to maintain clearance.
 ** Trim bars to maintain clearance to Bridge Approach Pavement Drains

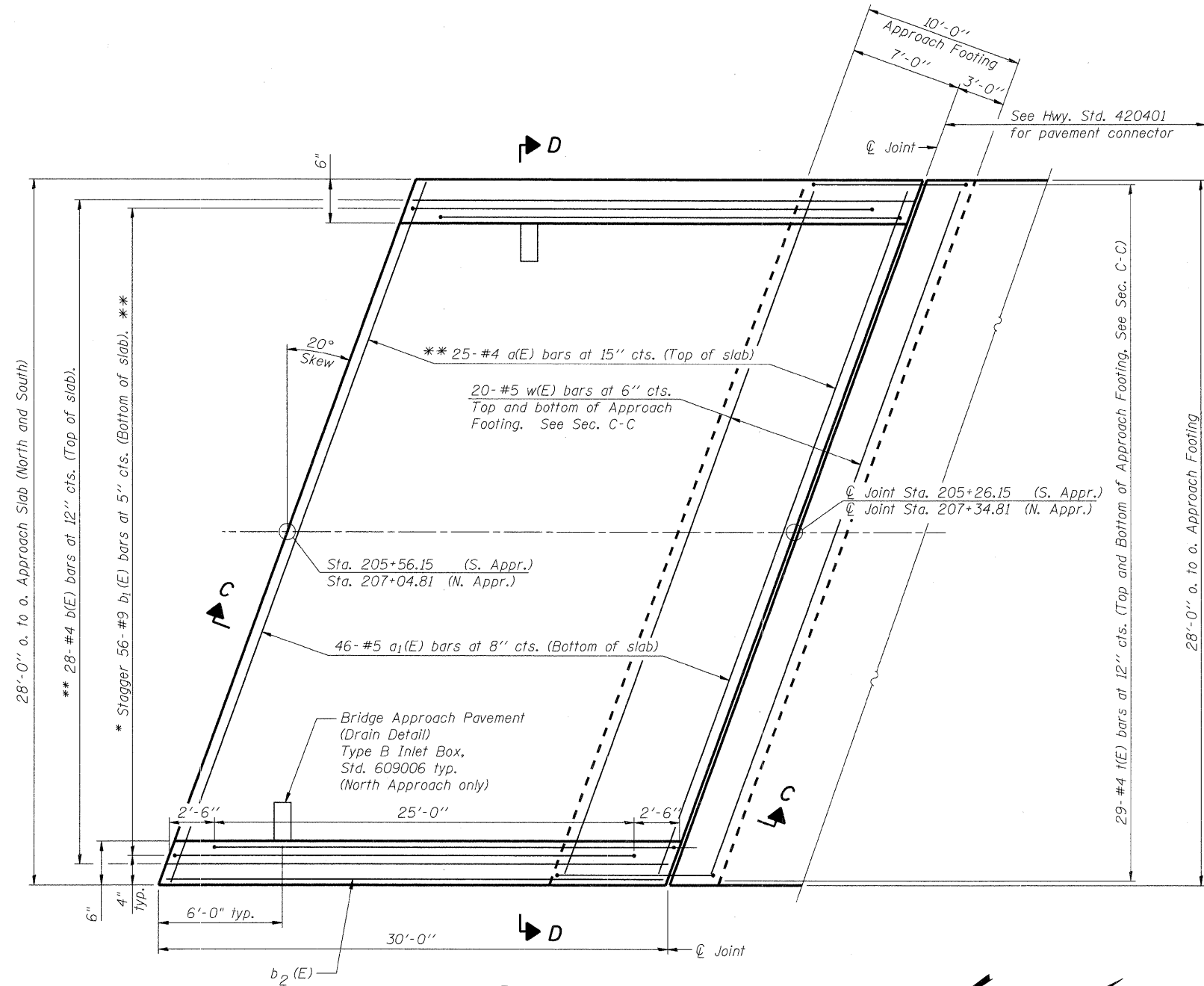
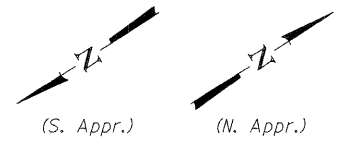

BRIDGE APPROACH SLAB REBAR DETAILS
 THOMPSON ROAD
 OVER NIPPERSINK CREEK
 SECTION NO. 06-00005-00-BR
 McHENRY COUNTY
 STATION 206+30.48
 STRUCTURE NO. 056-6006

DESIGNED	MGH/JPG
CHECKED	KMA
DRAWN	WJH
CHECKED	RGD

SEC GROUP, INC.
 Illinois Professional Design Firm # 184-000108
 • Engineering • Surveying • Planning • Landscape Architecture
 420 N. Front Street, McHenry, IL 60050
 t. 815.385.1778 f. 815.385.1781
 www.secgroupinc.com
 • McHenry, IL • Yorkville, IL • New Lenox, IL • Chicago, IL

SHEET NO. S-6	F.A.U. RTE.	SECTION	COUNTY	TOTAL SHEETS	SHEET NO.
	4081	06-00005-00-BR	McHENRY	45	17
S-25 SHEETS					
CONTRACT NO. 63409					
FED. ROAD DIST. NO. 1 ILLINOIS FED. AID PROJECT					

DATE: 11/18/09