

STRUCTURES							
NO.	STATION	OFFSET	TYPE	EX. FRAME	PR. FRAME	RIM / EP	INVERT
S-1	99+03	5.8' LT	-	TY 1 CL	TY 1 CL	-	-
S-2	100+66	13' LT	-	TY 1 CL	TY 1 CL	-	-
S-3	100+68	3.7 LT	-	TY 1 CL	TY 1 CL	-	-

**WATER MAIN CASING PIPE**  
 WM-CP1  
 20 L.F. OF 20" P.V.C. CASING PIPE  
 INSTALLED IN OPEN-CUT TRENCH

**WATER MAIN FITTINGS (RJT)**

- WM-F1  
STA. 99+43, 22' RT  
8" SLEEVE
- WM-F2  
STA. 99+85, 26' RT  
8" - 11 1/2" BEND  
ROLLED DOWN
- WM-F3A  
STA. 99+95, 29' RT  
8" - 11 1/2" BEND  
ROLLED UP
- WM-F3B  
STA. 99+97, 29' RT  
8" - 22 1/2" BEND  
ROLLED UP
- WM-F4  
STA. 99+95, 4' RT  
10" X 8" TEE
- WM-F5  
NOTE USED
- WM-F6  
STA. 100+87, 4' RT  
10" X 6" TEE

- WATER MAIN VALVES**
- WM-V1  
STA. 100+80, 4' RT  
10" GATE VALVE WITH  
5' DIA VALVE VAULT
  - WM-V2  
STA. 100+00, 27' RT  
8" X 8" TEE AND 8" GATE  
VALVE INSIDE 6' DIA VALVE VAULT
- FIRE HYDRANTS**
- WM-FH1  
STA. 100+87, 32' RT  
FIRE HYDRANT WITH 23 L.F.  
OF 6" LEADER PIPE (RJT)

- WATER MAIN PIPES**
- WM-P1  
55 L.F. OF 8" WATER MAIN (RJT)
  - WM-P2  
105 L.F. OF 10" WATER MAIN (RJT)

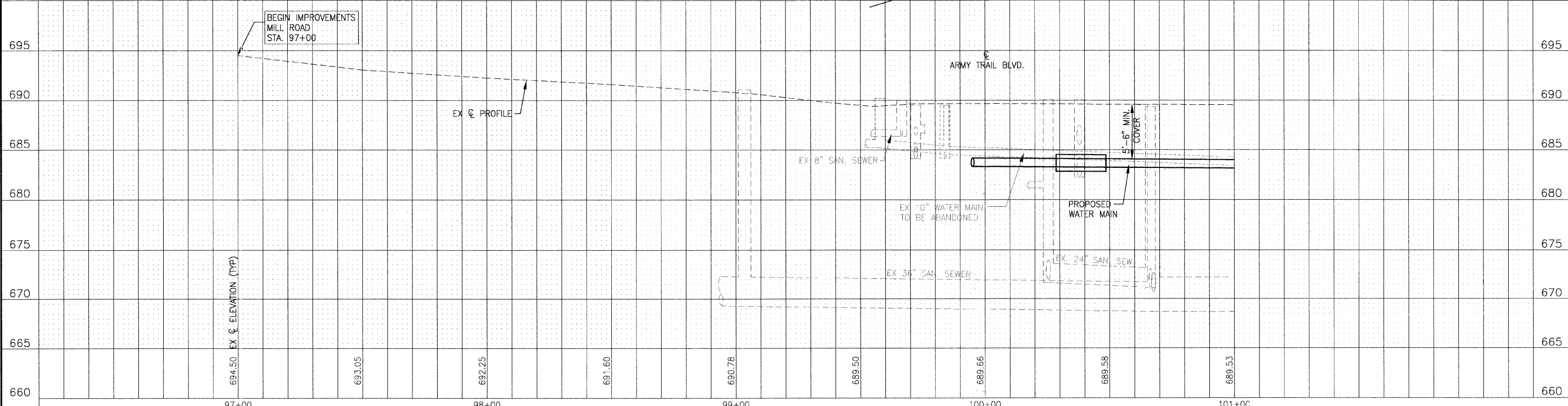
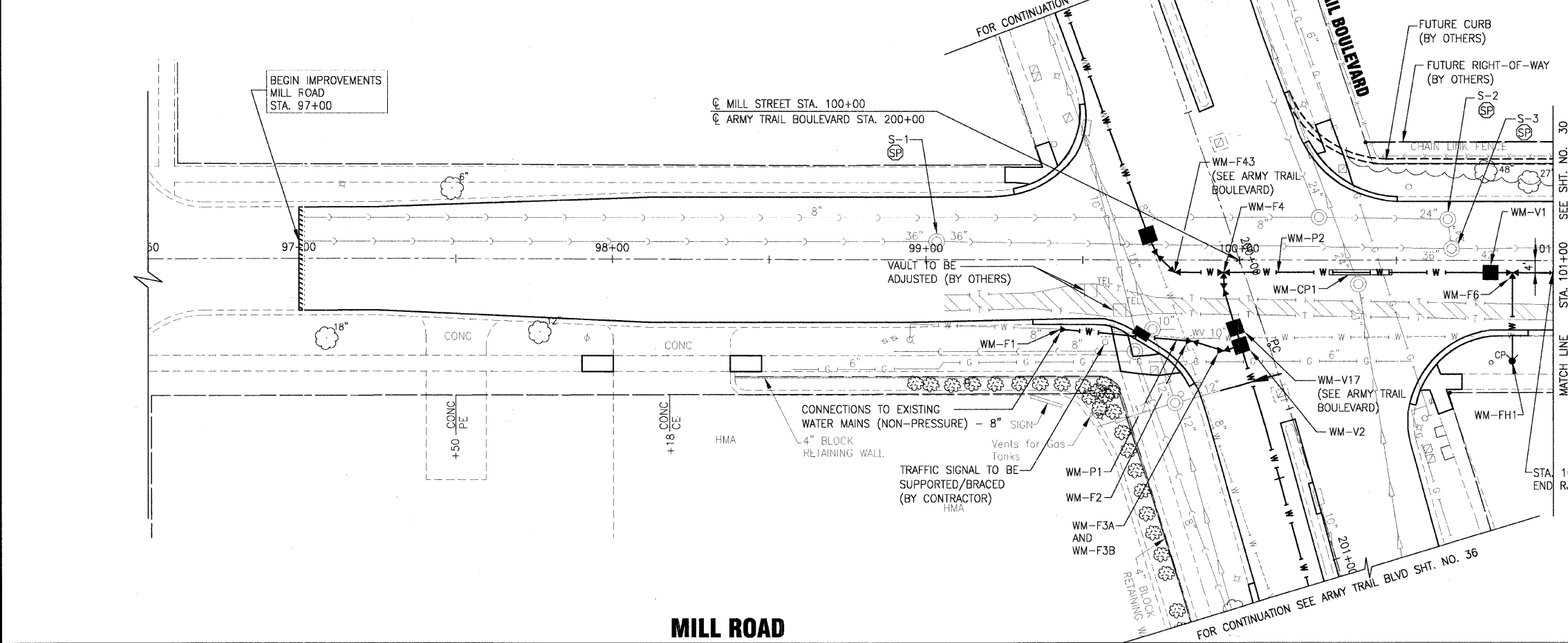

**BAXTER**  
**WOODMAN**  
 Consulting Engineers

DESIGNED - JJS	REVISED - VILLAGE REVIEW 9-08-09
DRAWN - UKB	REVISED - VILLAGE REVIEW 11-05-09
CHECKED - SMV	REVISED - IDOT REVIEW 11-17-09
DATE - 8-19-09	REVISED - VILLAGE REVIEW 12-07-09

**VILLAGE OF ADDISON, ILLINOIS  
 MILL ROAD AND ARMY TRAIL BOULEVARD  
 STP IMPROVEMENTS**

**DRAINAGE AND UTILITY  
 MILL ROAD**

\*3884 ARMY TRAIL BLVD.  
 \*2625 MILL ROAD

SCALE: HORIZ. 1"=20' / VERT. 1"=5'  
 PROJECT NO: 070142 STA. 96+50 TO STA. 101+00

F.A.U. RTE.	SECTION	COUNTY	TOTAL SHEETS	SHEET NO.
*	09-00098-00-RS	DuPage	69	29
C-91-056-10	CONTRACT NO. 63427			
FED. ROAD DIST. NO. 1	ILLINOIS	FED. AID PROJECT M-9003 (474)		

I:\ADDITION\070142-ARMY TRAIL-MILL LAPP & WATER MAIN\CADD-SURVEY\DRAWINGS\070142-MILL-WM-PRF.DWG PP29  
 Plotted: 12/8/2009 6:38 PM By: 231UKB  
 State of Illinois - Professional Design Firm  
 License No. - 184-001121 - Expires 4-30-11