

STRUCTURES							
NO.	STATION	OFFSET	TYPE	EX. FRAME	PR. FRAME	RIM / EP	INVERT
S-57	216+82	32.8' LT		TY 3	TY 3		
S-58	216+83	32.8' RT		TY 3	TY 3		
S-59	216+91.9	15.3' RT		TY 1 CL	TY 1 CL		
S-59A	216+92	56' RT		TY 1 CL	TY 1 CL		
S-60	218+33	30.2' LT		TY 9	TY 9		
S-61	218+33	29' RT	INLET, TYPE A	TY 3	TY 3		
S-62	219+91.3	31.4' RT	INLET, TYPE A	TY 3	TY 3		
S-63	220+29.7	3.5' RT		TY 1 CL	TY 1 CL		
S-64	220+26	45.4' RT		TY 1 CL	TY 1 CL		

FIRE HYDRANTS

WM-FH13
STA. 216+64.5, 45.5' RT
FIRE HYDRANT WITH 12 L.F. OF 6" LEADER PIPE

WM-FH14
STA. 220+98, 35' RT
FIRE HYDRANT WITH 8 L.F. OF 6" LEADER PIPE

WM-FH15
NOT USED

WM-V26
STA. 217+92, 26' RT
8" GATE VALVE WITH 5' DIA. VALVE VAULT

WM-V27
STA. 218+00, 26' RT
8" X 8" TEE AND 8" GATE VALVE INSIDE 6' DIA. VALVE VAULT

WATER MAIN VALVES

WM-V28
STA. 219+82, 26.5' RT
8" X 8" TEE AND 8" GATE VALVE INSIDE 6' DIA. VALVE VAULT

WM-V29
STA. 220+66, 22.5' RT
8" GATE VALVE WITH 5' DIA. VALVE VAULT

WM-V30
NOT USED

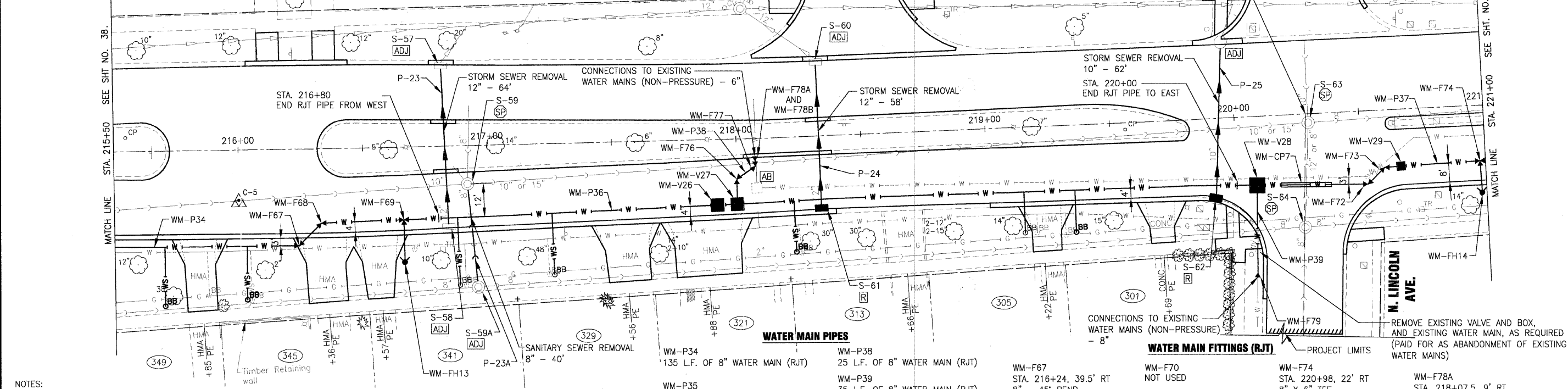

NOTES:
1. MOLE/AUGER SERVICE LINES BEYOND TREES AND/OR MINIMIZE EXCAVATION AROUND TREES.

PIPES						
NO.	TYPE	LENGTH (LF)	DIA (IN)	SLOPE	TBF (CY)	
P-23	STORM SEWER (WATER MAIN REQUIREMENTS)	64	12	MATCH EX	11	
P-23A	SANITARY SEWER (WATER MAIN REQUIREMENTS)	40	8	MATCH EX	20	
P-24	STORM SEWER (WATER MAIN REQUIREMENTS)	58	12	MATCH EX	11	
P-25	STORM SEWER (WATER MAIN REQUIREMENTS)	62	10	MATCH EX	14	

WATER MAIN CASING PIPE

WM-CP7
20 L.F. OF 20" PVC CASING PIPE
INSTALLED IN OPEN CUT TRENCH

ARMY TRAIL BOULEVARD

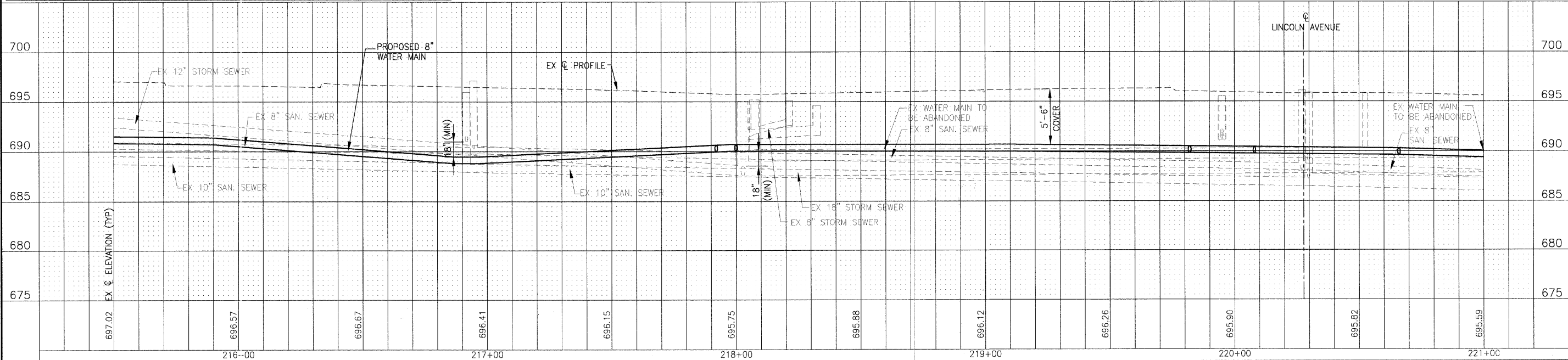

DESIGNED - JWS	REVISED - VILLAGE REVIEW 9-08-09
DRAWN - UKB	REVISED - VILLAGE REVIEW 11-05-09
CHECKED - SMV	REVISED - IDOT REVIEW 11-17-09
DATE - 8-19-09	REVISED - VILLAGE REVIEW 12-07-09

VILLAGE OF ADDISON, ILLINOIS
MILL ROAD AND ARMY TRAIL BOULEVARD
STP IMPROVEMENTS

DRAINAGE AND UTILITY		*3884 ARMY TRAIL BLVD.		F.A.U. RTE.	SECTION	COUNTY	TOTAL SHEETS	SHEET NO.
		*2625 MILL ROAD		*	09-00098-00-RS	DuPage	69	39
SCALE: HORIZ. 1"=20' / VERT. 1"=5'		PROJECT NO: 070142		STA. 215+50		TO STA. 221+00		FED. ROAD DIST. NO. 1 ILLINOIS FED. AID PROJECT M-9003 (474)

I:\ADDN\070142-ARMY TRAIL-MILL LAPP & WATER MAIN\CADD-SURVEY\DRAWINGS\DWGS\070142-ARMY-TR-WM-PRE.DWG PP39
 Project: 12/8/2009 2:01 PM By: 231UGK
 Copyright 2009, by Baxter Woodman, Inc.
 Copyright of Illinois Professional Design Firm.
 License No. 184-001121 Expires 4-30-11