

MATCH LINE STA. 228+00 SEE SHT. NO. 42

WATER MAIN PIPES

- WM-P46
136 L.F. OF 8" WATER MAIN (RJT)
HORIZONTAL DIRECTIONALLY DRILLED
INTO PLACE
- WM-P47
161 L.F. OF 8" WATER MAIN

FIRE HYDRANTS

- WM-FH17
STA. 226+40, 35.5' LT
FIRE HYDRANT

WATER MAIN FITTINGS (RJT)

- WM-F89
STA. 226+36.5, 36' LT
8" X 6" HYDRANT TEE
- WM-F90
NOT USED

JOHN F. KENNEDY DRIVE

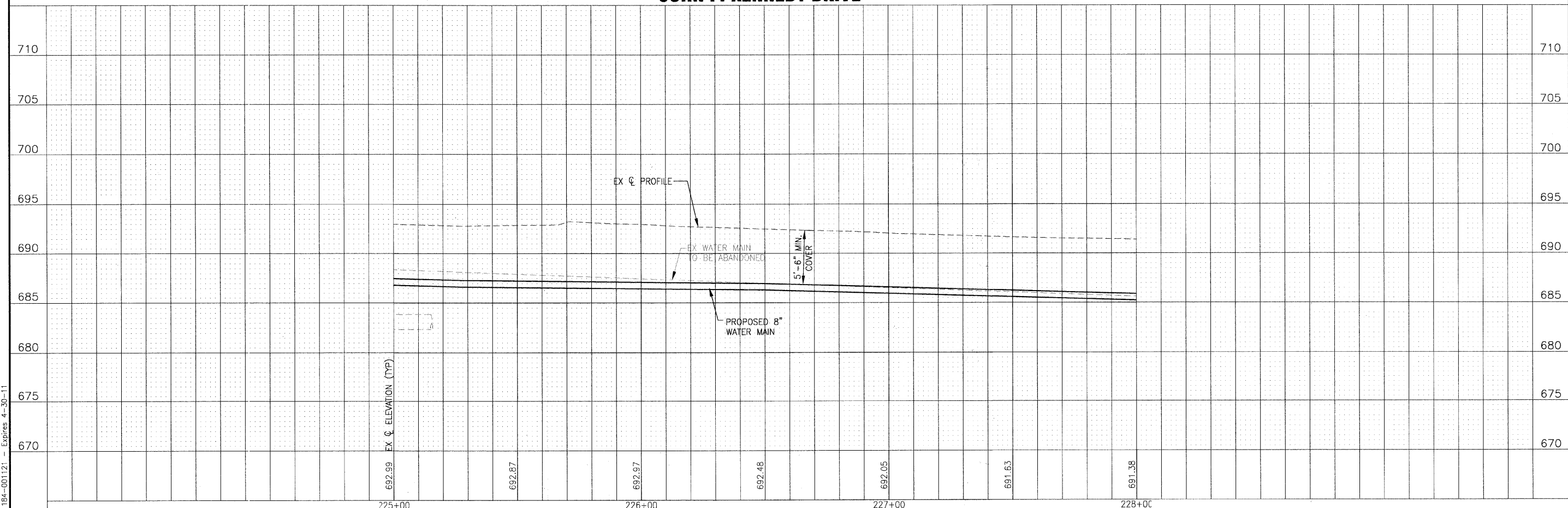

I:\ADDON\070142-ARMY TRAIL-MILL LAPP & WATER MAIN\CADD-SURVEY\DRAWINGS\DWGS\070142-ARMY-TR-WM-PRE.DWG PP41
 Plotted: 11/23/2009 9:48 PM By: 231UKB
 Copyright © 2009, By: Baxter & Woodman, Inc.
 State of Illinois - Professional Design Firm
 License No. - 184-001121 - Expires 4-30-11

	DESIGNED - JJS	REVISED - VILLAGE REVIEW 9-08-09	VILLAGE OF ADDISON, ILLINOIS MILL ROAD AND ARMY TRAIL BOULEVARD STP IMPROVEMENTS	DRAINAGE AND UTILITY JOHN F KENNEDY DRIVE	*3884 ARMY TRAIL BLVD. *2625 MILL ROAD	F.A.U. RTE.	SECTION	COUNTY	TOTAL SHEETS	SHEET NO.
	DRAWN - UKB	REVISED - VILLAGE REVIEW 11-05-09				C-91-056-10	DuPage	69	41	
CHECKED - SMV	REVISED - IDOT REVIEW 11-17-09	SCALE: HORIZ. 1"=20' / VERT. 1"=5'		PROJECT NO: 070142 STA. 225+00 TO STA. 228+00		CONTRACT NO. 63427				
DATE - 8-19-09	REVISED -			FED. ROAD DIST. NO. 1		ILLINOIS FED. AID PROJECT M-9003 (474)				