

F.A.U. RTE.	SECTION	COUNTY	TOTAL SHEETS	SHEET NO.
---	09-00071-00-BR	COOK	31	1
		ILLINOIS	CONTRACT NO. 63437	

INDEX OF SHEETS

SHEET NO.	DESCRIPTION
1	TITLE SHEET
2	GENERAL NOTES AND IDOT STANDARDS
3	SUMMARY OF QUANTITIES
4	TYPICAL SECTIONS
5	ALIGNMENT, TIES AND BENCHMARKS - WHITEHALL AVENUE
6	ALIGNMENT, TIES AND BENCHMARKS - PRATER AVENUE
7	EXISTING CONDITIONS AND REMOVAL PLAN - WHITEHALL AVENUE
8	PROPOSED ROADWAY PLAN AND PROFILE - WHITEHALL AVENUE
9	EROSION CONTROL AND STAGING PLAN - WHITEHALL AVENUE
10	EROSION CONTROL AND STAGING PLAN - PRATER AVENUE
11	EXISTING AND PROPOSED LIGHTING IMPROVEMENT PLAN
12	LIGHTING DETAILS
13	GENERAL PLAN AND ELEVATION - WHITEHALL AVENUE
14	GENERAL NOTES
15	TOP OF DECK ELEVATIONS I
16	TOP OF DECK ELEVATIONS II
17	TOP OF APPROACH SLAB ELEVATIONS
18	DECK PLAN AND CROSS SECTIONS
19	SUPERSTRUCTURE DETAILS
20	DIAPHRAGM DETAILS
21	ALUMINUM RAILING, TYPE L
22	FRAMING PLAN DETAILS
23	STEEL DETAILS
24	EXISTING ABUTMENT
25	PROPOSED ABUTMENT
26	BRIDGE APPROACH SLAB DETAILS 1
27	BRIDGE APPROACH SLAB DETAILS 2
28	GENERAL PLAN AND ELEVATION - PRATER AVENUE
29	CONSTRUCTION DETAILS
30	DISTRICT ONE TYPICAL PAVEMENT MARKINGS
31	TRAFFIC CONTROL AND PROTECTION FOR SIDE ROADS, INTERSECTIONS, AND DRIVEWAYS

STATE OF ILLINOIS
DEPARTMENT OF TRANSPORTATION
DIVISION OF HIGHWAYS
PLANS FOR PROPOSED
FEDERAL AID HIGHWAY
WHITEHALL AVENUE
PRATER AVENUE
Section No.: 09-00071-00-BR
BRIDGE REHABILITATION
Project No.: ARA-9003 (399)
CITY OF NORTHLAKE
COOK COUNTY
JOB NO.: C-91-808-09



THE CONTRACTOR SHALL BE SOLELY RESPONSIBLE FOR JOB SITE SAFETY AS WELL AS SUPERVISION/DIRECTION AND MEANS/METHODS OF CONSTRUCTION.

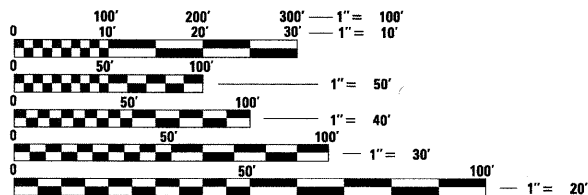

FULL SIZE PLANS HAVE BEEN PREPARED USING STANDARD ENGINEERING SCALES. REDUCED SIZED PLANS WILL NOT CONFORM TO STANDARD SCALES. IN MAKING MEASUREMENTS ON REDUCED PLANS, THE ABOVE SCALES MAY BE USED.

J.U.L.I.E.
JOINT UTILITY LOCATION INFORMATION FOR EXCAVATION
1-800-892-0123

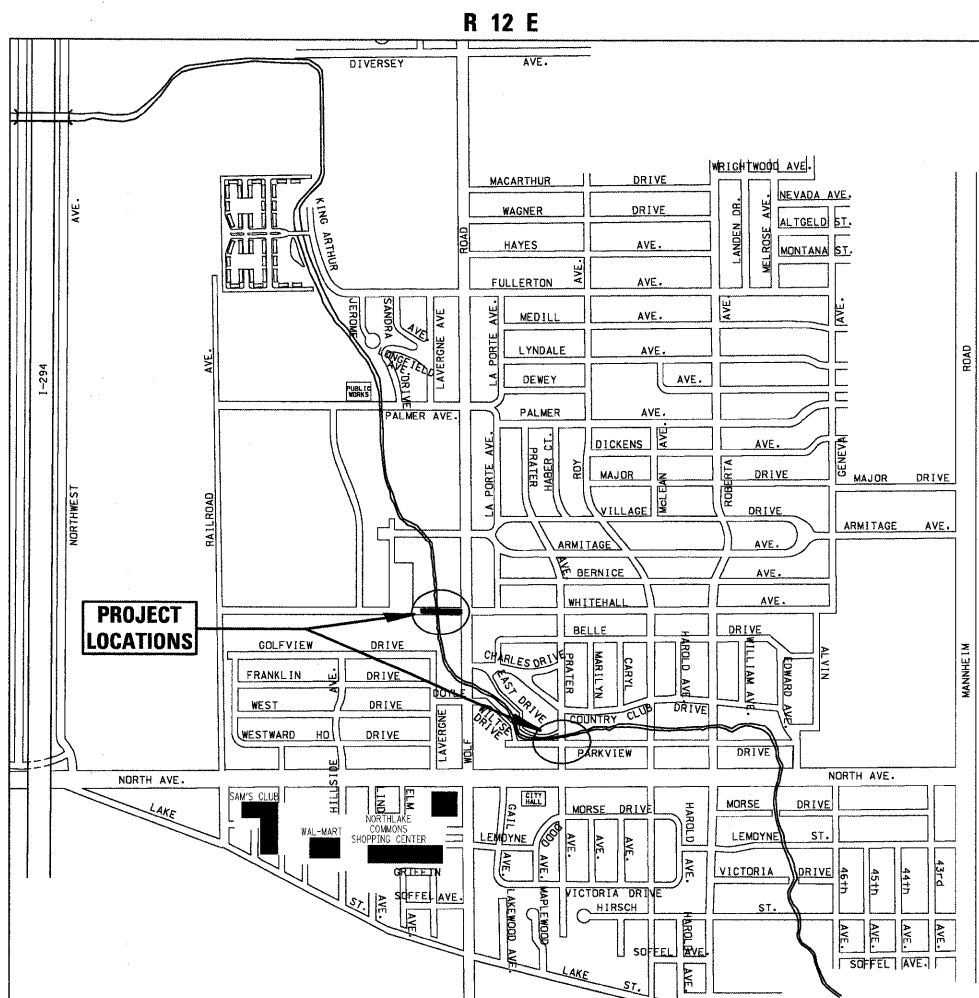

LOCATION MAP - PROVISO TOWNSHIP
GROSS LENGTH OF PROJECT = 120 LINEAL FEET (0.02 MI.)
NET LENGTH OF PROJECT = 120 LINEAL FEET (0.02 MI.)

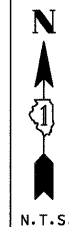

TRAFFIC DATA - PRATER AVENUE
ADT (YEAR) = 400 (2008)
POSTED SPEED LIMIT = 25 MPH

TRAFFIC DATA - WHITEHALL AVENUE
ADT (YEAR) = 400 (2008)
POSTED SPEED LIMIT = 10 MPH

STATE OF ILLINOIS
DEPARTMENT OF TRANSPORTATION
DIVISION OF HIGHWAYS

APPROVED Nov. 30 20 09

MAYOR
CITY OF NORTHLAKE

PASSED December 3 20 09

DISTRICT 1 ENGINEER OF LOCAL ROADS AND STREETS

RELEASING FOR BID BASED ON LIMITED REVIEW December 16, 20 09

Debra M. O'Keefe
DEPUTY DIRECTOR OF HIGHWAYS
REGION ONE ENGINEER

PRINTED BY THE AUTHORITY OF THE STATE OF ILLINOIS



ELECTRICAL

NOVEMBER 30, 2009

ANTHONY J. DeRICCO
 ILLINOIS REGISTRATION No. 062-057484 ENGINEER
 EXPIRATION DATE: 11/30/11

CIVIL

NOVEMBER 30, 2009

ANDREW M. PUFUNDT
 ILLINOIS REGISTRATION No. 062-061729 ENGINEER
 EXPIRATION DATE: 11/30/11

PROFESSIONAL DESIGN FIRM No. 184-001175
EXPIRATION DATE: 04/30/11

FIELD ENGINEER: MARILIN SOLOMON TEL. 847-705-4407

CONTRACT NO. 63437