

STATE OF ILLINOIS
DEPARTMENT OF TRANSPORTATION

NORTH EDGE OF SLAB

Locations	Stations	Offset	Theoretical Grade Elevations
End W. Appr. Pav't	30+29.83	22.50' LT	647.08
A	30+39.83	22.50' LT	646.99
Bk. W. Abutment	30+49.83	22.17' LT	646.91

NORTH EDGE OF PAVEMENT / FACE OF SIDEWALK

Locations	Stations	Offset	Theoretical Grade Elevations
End W. Appr. Pav't	30+29.83	16.50' LT	647.20
A	30+39.83	16.50' LT	647.11
Bk. W. Abutment	30+49.83	16.50' LT	647.02

PGL

Locations	Stations	Offset	Theoretical Grade Elevations
End W. Appr. Pav't	30+29.83	0.00'	647.53
A	30+39.83	0.00'	647.44
Bk. W. Abutment	30+49.83	0.00'	647.35

SOUTH EDGE OF PAVEMENT / FACE OF CURB

Locations	Stations	Offset	Theoretical Grade Elevations
End W. Appr. Pav't	30+29.83	16.92' RT	647.20
A	30+39.83	16.92' RT	647.10
Bk. W. Abutment	30+49.83	16.92' RT	647.01

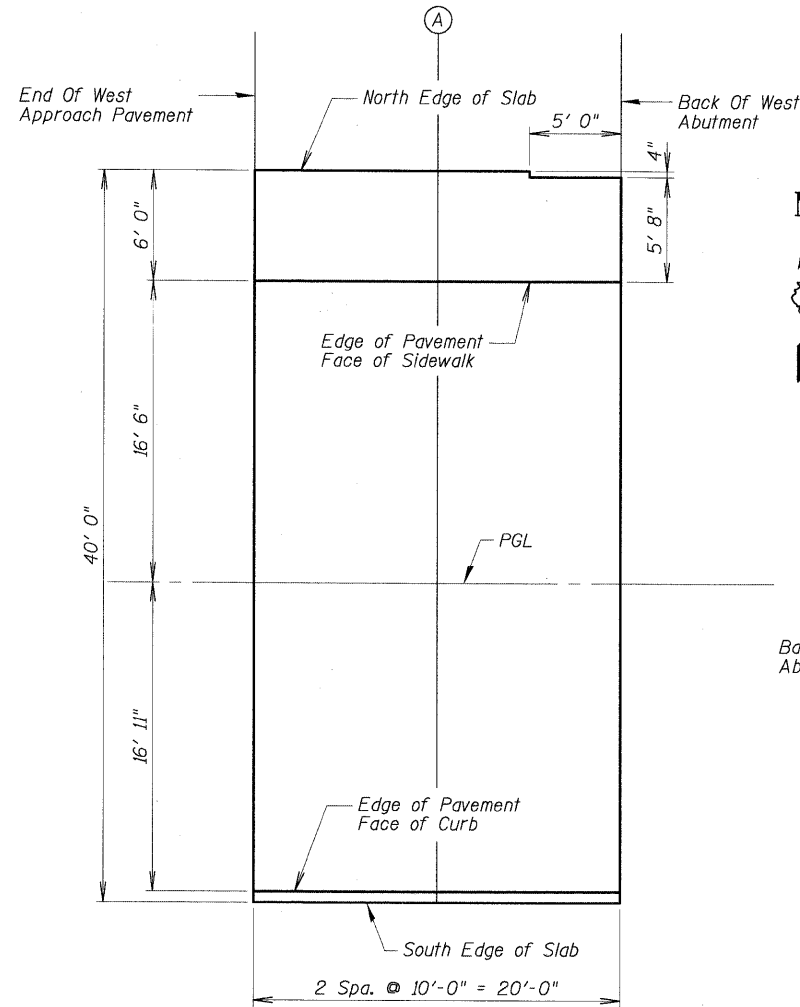

WEST APPROACH PAVEMENT

NORTH EDGE OF SLAB

Locations	Stations	Offset	Theoretical Grade Elevations
Bk. E. Abutment	30+84.25	22.17' LT	646.65
B	30+94.25	22.50' LT	646.54
End E. Appr. Pav't	31+04.25	22.50' LT	646.38

NORTH EDGE OF PAVEMENT / FACE OF SIDEWALK

Locations	Stations	Offset	Theoretical Grade Elevations
Bk. E. Abutment	30+84.25	16.50' LT	646.76
B	30+94.25	16.50' LT	646.66
End E. Appr. Pav't	31+04.25	16.50' LT	646.50

PGL

Locations	Stations	Offset	Theoretical Grade Elevations
Bk. E. Abutment	30+84.25	0.00'	647.09
B	30+94.25	0.00'	646.99
End E. Appr. Pav't	31+04.25	0.00'	646.83

SOUTH EDGE OF PAVEMENT / FACE OF CURB

Locations	Stations	Offset	Theoretical Grade Elevations
Bk. E. Abutment	30+84.25	16.92' RT	646.75
B	30+94.25	16.92' RT	646.66
End E. Appr. Pav't	31+04.25	16.92' RT	646.49

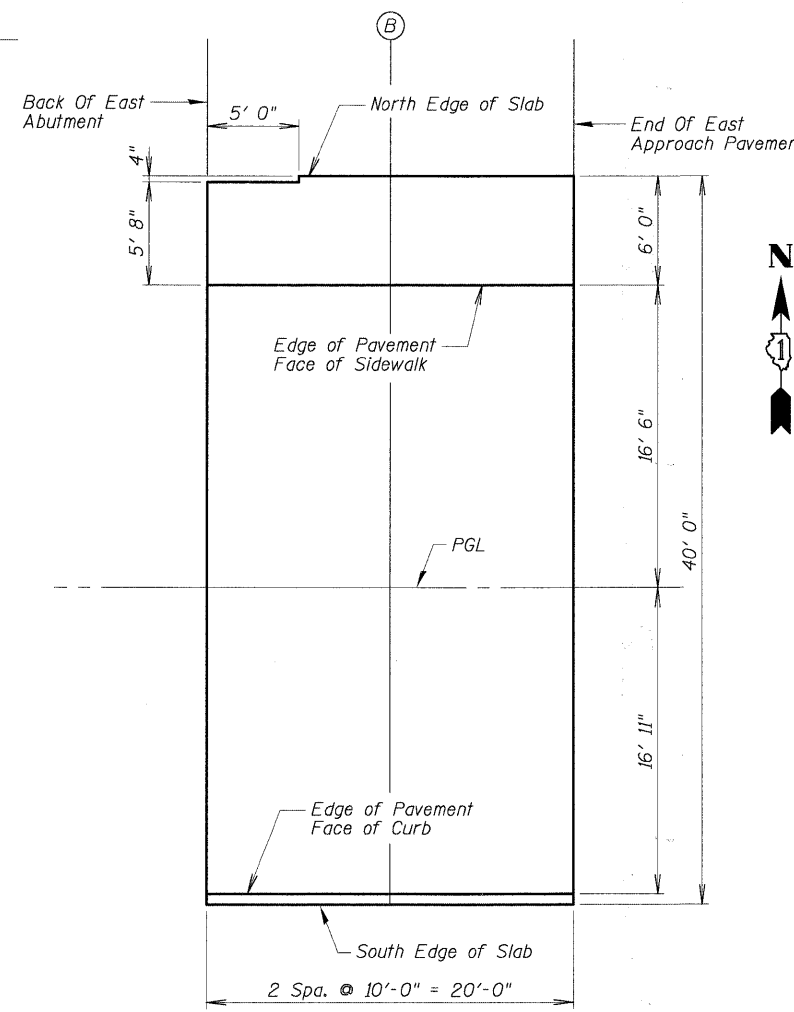

EAST APPROACH PAVEMENT

TOP OF APPROACH SLAB ELEVATIONS
WHITEHALL AVENUE OVER
ADDISON CREEK
F.A. RTE. 4025
SECTION 09-00071-00-BR
COOK COUNTY
STATION 30+67.04
STRUCTURE No. 016-7618

DESIGNED -	200
CHECKED -	EXAMINED
DRAWN -	PASSED
CHECKED -	ENGINEER OF BRIDGES AND STRUCTURES

SHEET NO. S-5 SHEETS	F.A. RTE.	SECTION	COUNTY	TOTAL SHEETS	SHEET NO.
	4025	09-00071-00-BR	COOK	31	17
CONTRACT NO. 63437					
FED. ROAD DIST. NO. ILLINOIS FED. AID PROJECT					