

STATE OF ILLINOIS
DEPARTMENT OF TRANSPORTATION

Notes:
See sheet S-15 for Sections C-C & D-D.
 $a_{11}(E)$, $a_{10}(E)$, and $w(E)$ bar spacings measured perpendicular to $\text{C} \perp$ Rdwy.

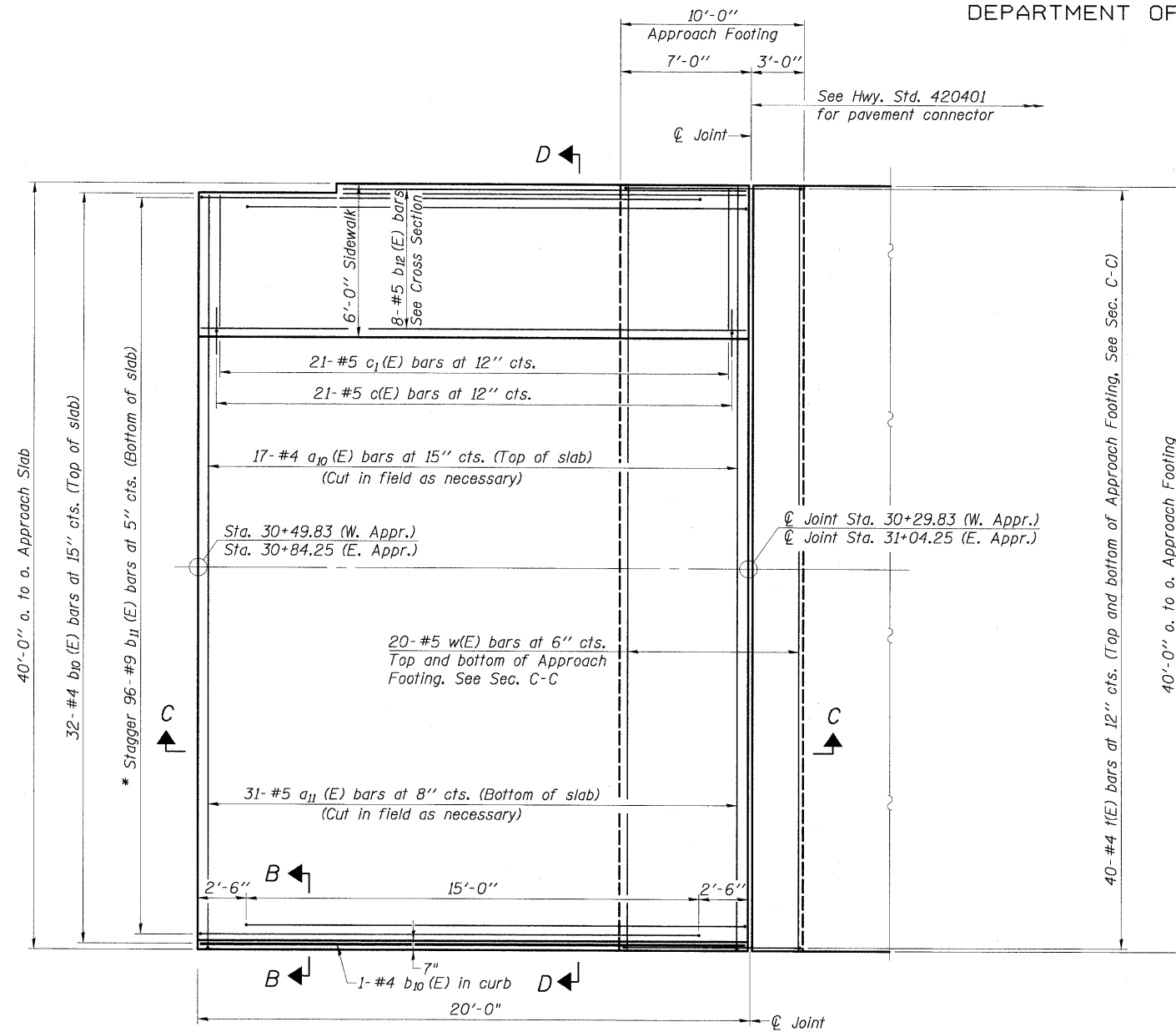

PLAN

* Tilt #9 $b_1(E)$ bars as required to maintain clearance.

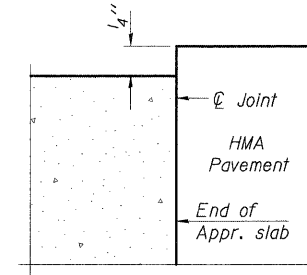

FLEXIBLE PAVEMENT

DETAIL A

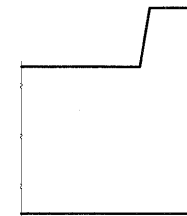

VIEW B-B

Angle Preformed Joint Seal at 45°
at curbs when req'd for drainage.

DESIGNED -	200
CHECKED -	EXAMINED
DRAWN -	PASSED
CHECKED -	ENGINEER OF BRIDGES AND STRUCTURES

(Sheet 1 of 2)
BRIDGE APPROACH SLAB DETAILS
WHITEHALL AVENUE OVER
ADDISON CREEK
F.A. RTE. 4025
SECTION 09-00071-00-BR
COOK COUNTY
STATION 30+67.04
STRUCTURE No. 016-7618

SHEET NO.	F.A. RTE.	SECTION	COUNTY	TOTAL SHEETS	SHEET NO.
S-14	4025	09-00071-00-BR	COOK	31	26
CONTRACT NO. 63437					
FED. ROAD DIST. NO. ILLINOIS FED. AID PROJECT					