

DATE	
BY	
PLANNED	
DESIGNED	
CHECKED	
DRAWN	
NOTED	
STRUCTURE	
NOTATIONS	
CHRD	

DATE	
BY	
PLANNED	
DESIGNED	
CHECKED	
DRAWN	
NOTED	
STRUCTURE	
NOTATIONS	
CHRD	

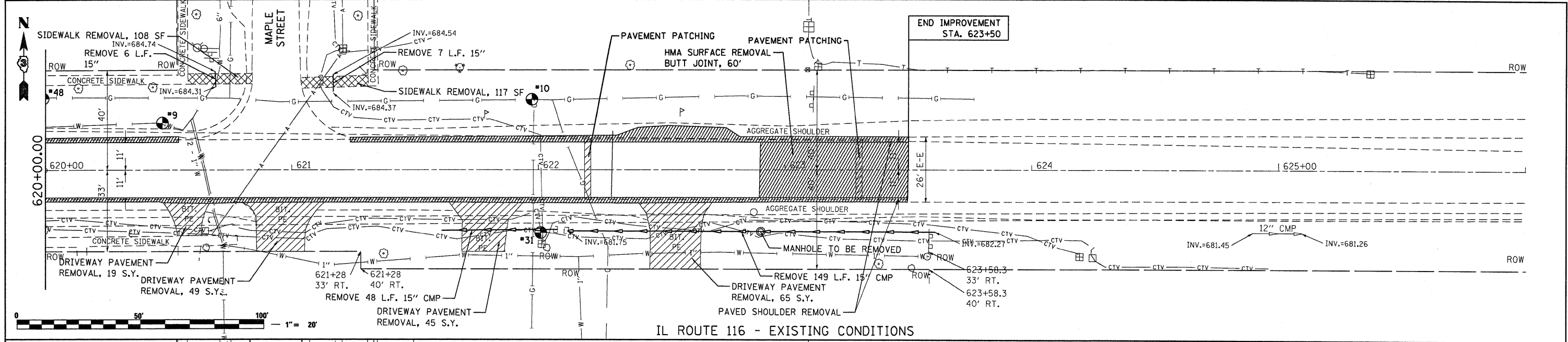

IL ROUTE 116 - EXISTING CONDITIONS

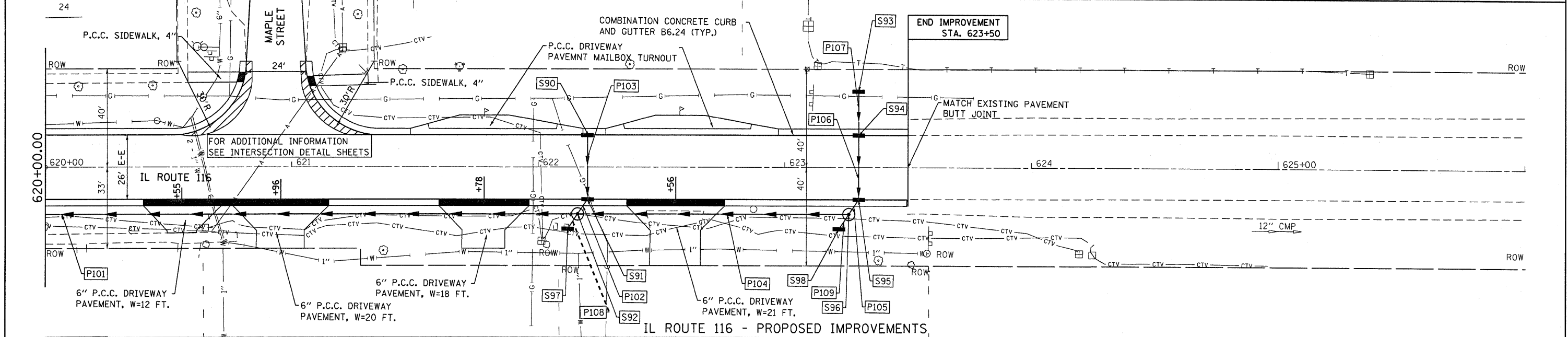

IL ROUTE 116 - PROPOSED IMPROVEMENTS

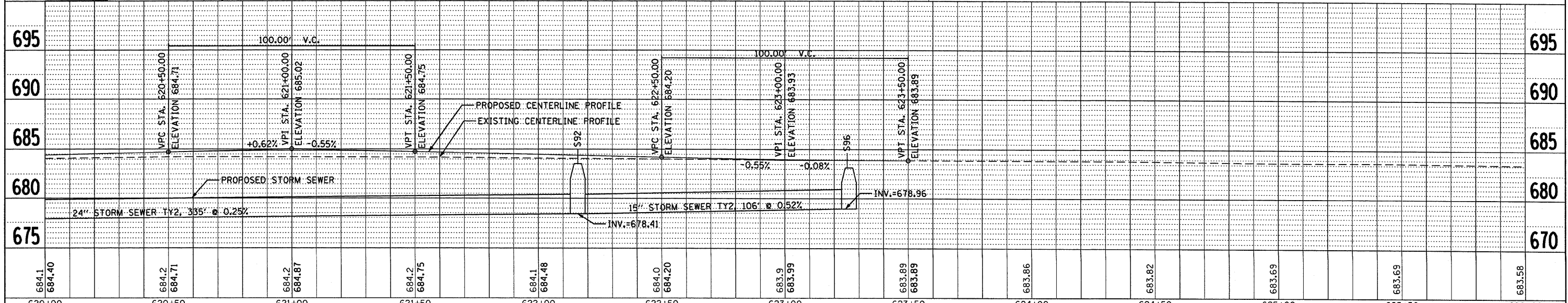

620+00	620+50	621+00	621+50	622+00	622+50	623+00	623+50	624+00	624+50	625+00	625+50	626+00								
695	690	685	680	675	695	690	685	680	675	695	690	685								
684.1	684.40	684.2	684.71	684.2	684.87	684.2	684.75	684.1	684.48	684.0	684.20	683.9	683.99	683.89	683.89	683.86	683.82	683.69	683.69	683.58

FILE NAME =	USER NAME = schwanerg	DESIGNED - SPF	REVISED -
ct:\pwork\pwork\schwanerg\d117211\202309\p1n.dgn		CHECKED - JMS	REVISED -
		DRAWN - AJP	REVISED -
		CHECKED - 09/25/09	REVISED -

**STATE OF ILLINOIS**  
**DEPARTMENT OF TRANSPORTATION**

**PLAN AND PROFILE**

SCALE: 1"=20'      SHEET NO. 7 OF 7 SHEETS      STA. 620+00.00 TO STA. 626+00.00

F.A.P. RTE.	SECTION	COUNTY	TOTAL SHEETS	SHEET NO.
681	114 RS-2	LIVINGSTON	63	17
CONTRACT NO. 66532				
FED. ROAD DIST. NO.      ILLINOIS FED. AID PROJECT				