

**TYPICAL SODDING DETAILS FOR SIDEWALK RAMPS**

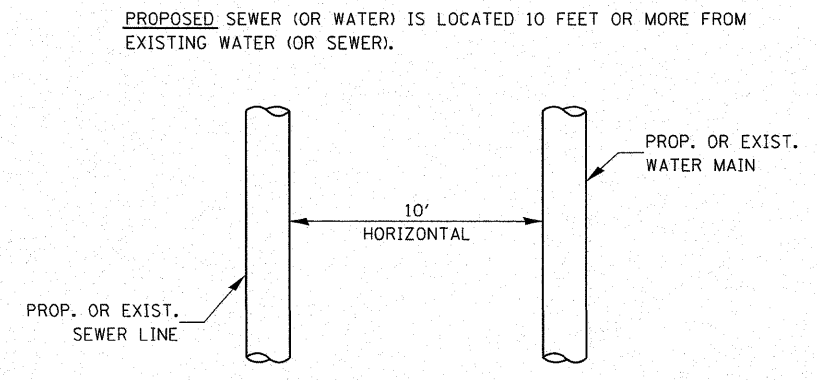

**PLAN VIEW**

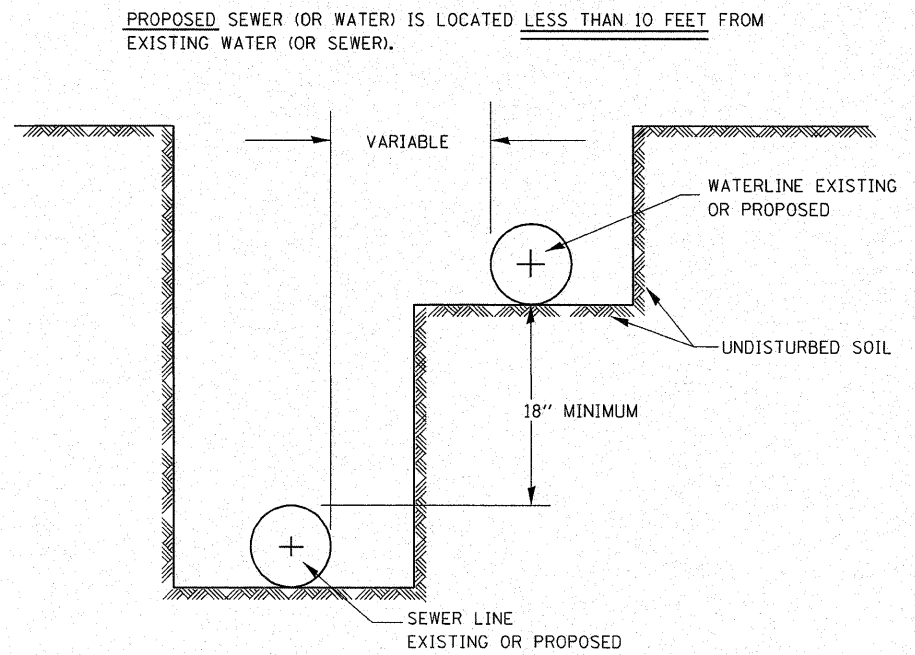

**WATER AND SEWER SEPARATION REQUIREMENTS - HORIZONTAL SEPARATION**

563-3

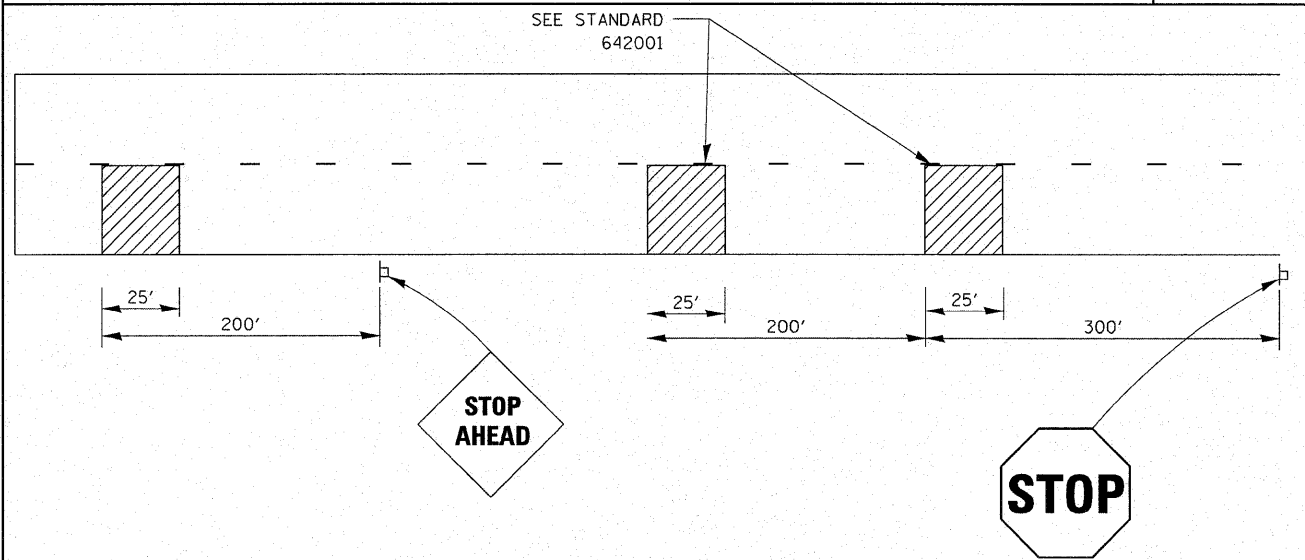

**TYPICAL GROOVED RUMBLE STRIP APPLICATION IN ADVANCE OF AN INTERSECTION**

440-3

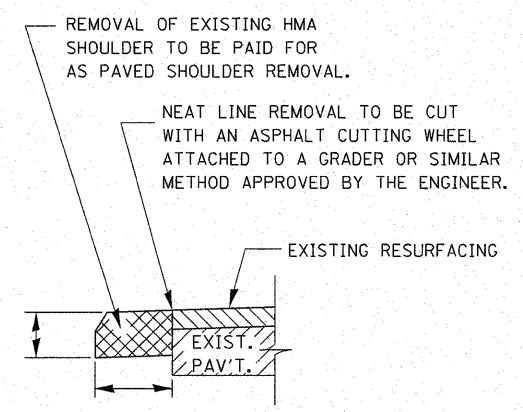

**REMOVAL OF EXISTING HMA SHOULDER**

440-1

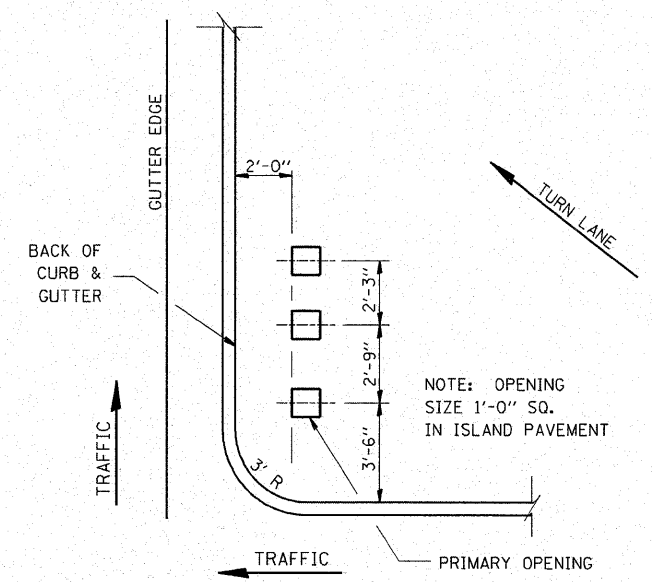

**ISLAND SIGN POST SPACING DETAIL**

606-2

FILE NAME =	USER NAME = IDOTCAD	DESIGNED - SPF	REVISED -
W:\2183.03-100T IL 116 Plans\09\Sheet Files\202300DET.dgn		DRAWN - FJS	REVISED -
		CHECKED - JMS	REVISED -
		DATE - 09/25/09	REVISED -

STATE OF ILLINOIS  
DEPARTMENT OF TRANSPORTATION

DETAILS

SCALE: SHEET NO. 02 OF 09 SHEETS STA. TO STA.

F.A.P. RTE.	SECTION	COUNTY	TOTAL SHEETS	SHEET NO.
681	114 RS-2	LIVINGSTON	63	40
FED. ROAD DIST. NO. ILLINOIS FED. AID PROJECT			CONTRACT NO. 66532	