

DETOUR NOTES:

1. THE CONTRACTOR MUST FURNISH, INSTALL, MAINTAIN AND REMOVE ALL TEMPORARY SIGNS AND SUPPORTS. AFTER REMOVING THE SUPPORTS, THE CONTRACTOR MUST FILL HOLES (IF ANY) AND RESTORE THE GROUND TO ITS ORIGINAL CONDITION AND ELEVATION. THE COST OF PLACING GRAVEL, SOD, OR SEED MUST BE INCLUDED IN THE TRAFFIC CONTROL AND PROTECTION REQUIRED UNDER STANDARD 701901 AND BLR 21 AND WILL BE PAID FOR AT THE CONTRACT LUMP SUM PRICE.
2. SIGNING SHALL BE PLACED AT LOCATIONS THAT WILL BE COMPATIBLE WITH EXISTING SIGNING.
3. ALL EXISTING SIGNS OR OTHER DETOUR SIGNS THAT CONFLICT WITH THE DETOUR MUST BE COVERED.
4. IL-115 ROUTE MARKERS SHALL BE 24" X 24", BLACK AND WHITE TYPE AP SHEETING.
5. M4-8, M4-8b, AND W20-2 SIGNS SHALL BE BLACK LETTERING ON FLORESENT ORANGE BACKGROUND.
6. (8) SIGNS SHALL BE INSTALLED NEXT TO I-57 ROUTE MARKERS AT CLIFTON AND CHEBANSE INTERCHANGE.
7. (8) & (14) SIGNS SHALL BE INSTALLED ADJACENT TO I-57 ROUTE MARKER.

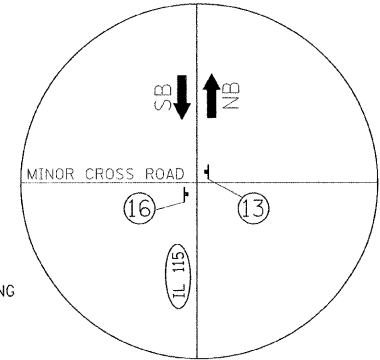

TYPICAL SIGNING AT CROSSROAD
KELLY CREEK NORTH TO KANKAKEE
(N-S LEG SHOWN, E-W LEG SIMILAR)

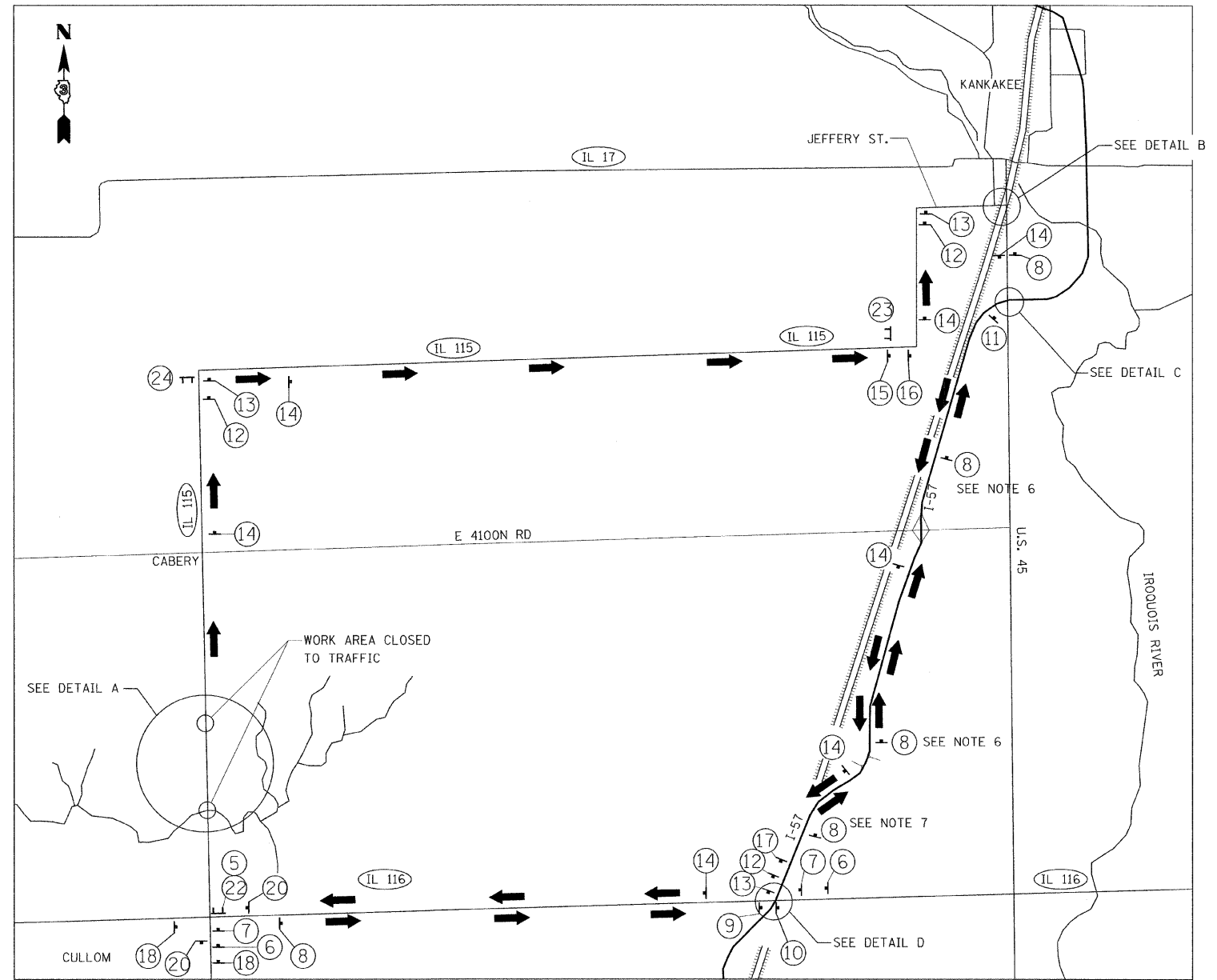
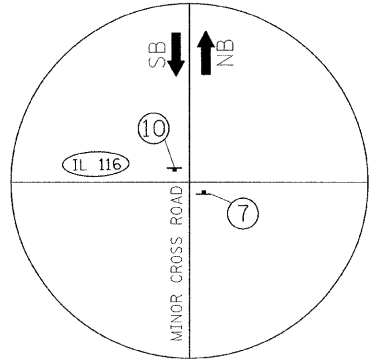

TYPICAL SIGNING AT CROSSROAD
IL-116 EAST TO I-57 WEST

- LEGEND**
- ➔ DETOUR TRAFFIC FLOW DIRECTION
 - ⊥ DETOUR GUIDE SIGN ASSEMBLY
 - ⊥ TYPE III BARRICADE WITH FLASHING LIGHTS AND ROAD CLOSED SIGN

benesch
alfred benesch & company
Engineers • Surveyors • Planners
205 North Michigan Avenue, Suite 2400
Chicago, Illinois 60601
312-565-0450
Job # 3938.02

FILE NAME =	USER NAME = \$USER\$	DESIGNED - JRM	REVISED - JDC
\$FILEL\$		DRAWN - JRM	REVISED -
	PLOT SCALE = \$SCALE\$	CHECKED - DJC	REVISED -
	PLOT DATE = \$DATE\$	DATE - 10/24/09	REVISED -

STATE OF ILLINOIS
DEPARTMENT OF TRANSPORTATION

IL 115 - DETOUR PLAN

SCALE: NONE	SHEET NO. 1 OF 2 SHEETS	STA. TO STA.
-------------	-------------------------	--------------

F.A.P. RTE.	SECTION	COUNTY	TOTAL SHEETS	SHEET NO.
796	104 I & 105 BR-1	FORD	51	11
FED. ROAD DIST. NO. ILLINOIS FED. AID PROJECT			CONTRACT NO. 66848	