

STATE OF ILLINOIS
DEPARTMENT OF TRANSPORTATION

NOTES:
1. See sheet S12 for Sections C-C & D-D and View E-E.
2. $a_3(E)$, $a_4(E)$, and $w(E)$ bar spacings measured perpendicular to \perp Rdwy.

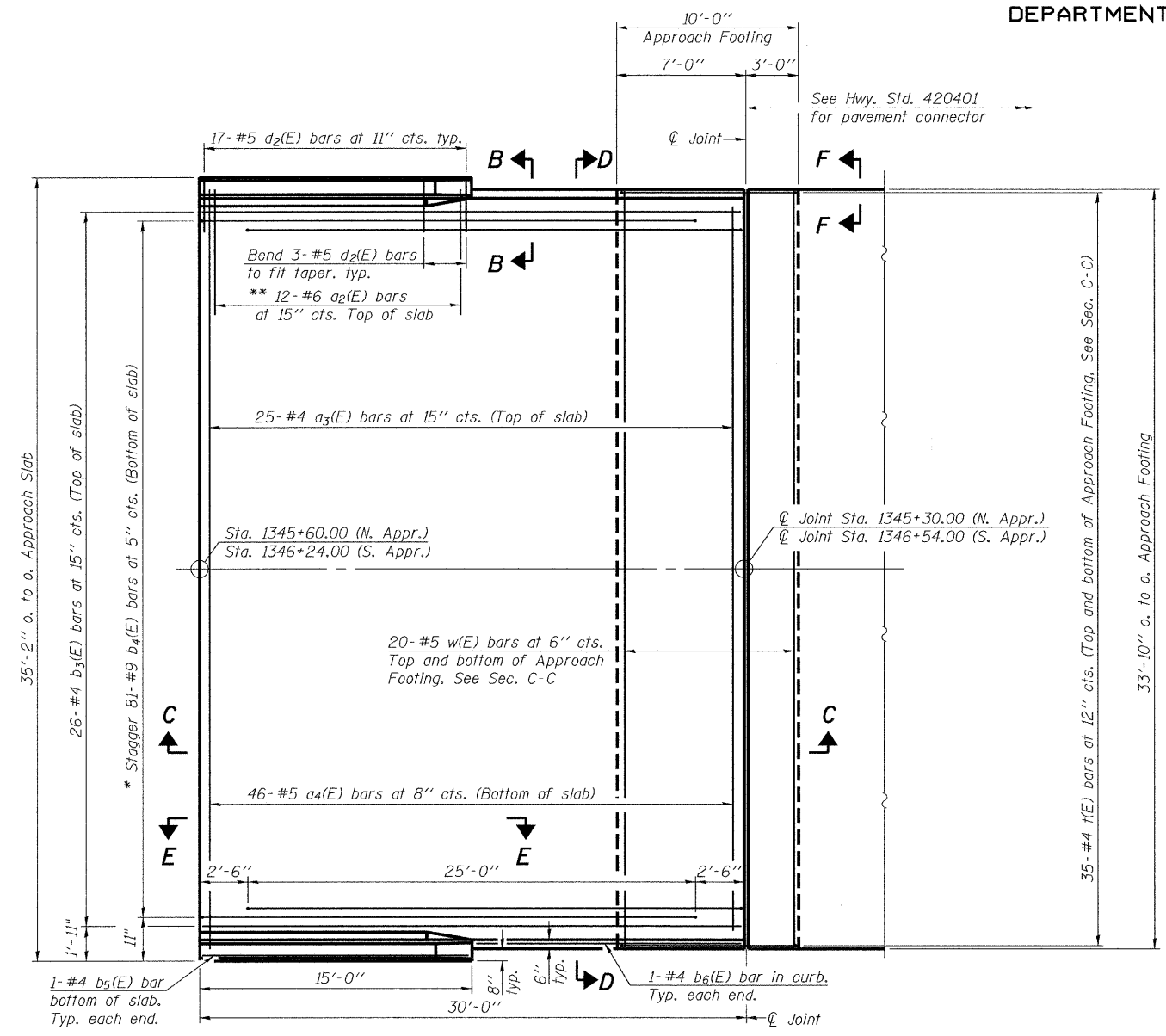

PLAN

* Tilt #9 $b_4(E)$ bars as required to maintain clearance.
** Alternate with $a_3(E)$ bars, typ. ea. parapet.

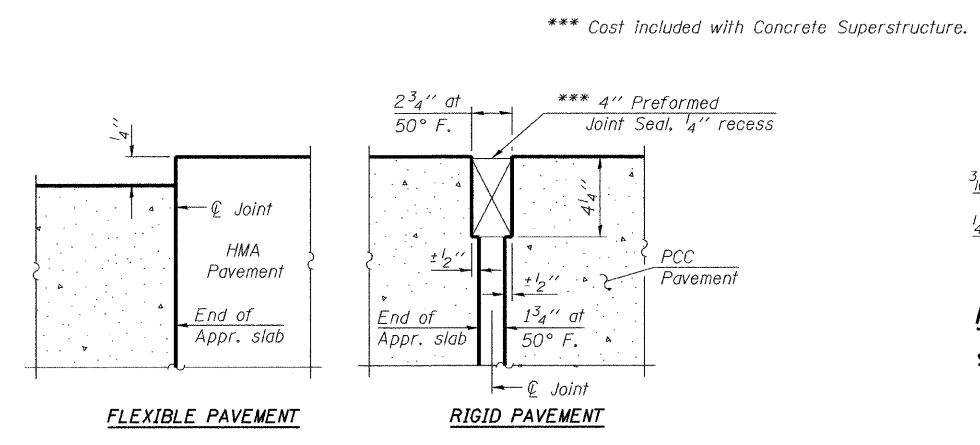

DETAIL A

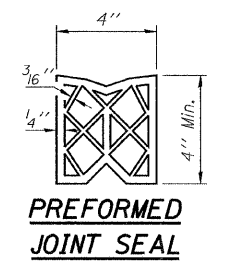

PREFORMED JOINT SEAL

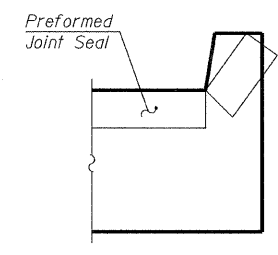

VIEW F-F

Angle Preformed Joint Seal at 45° at curbs when req'd for drainage.

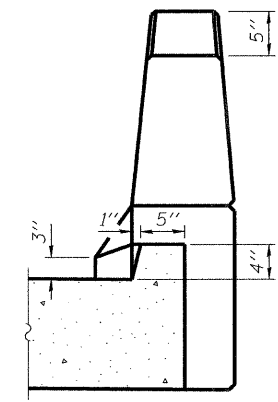

VIEW B-B

DESIGNED -	MRB
CHECKED -	KWS
DRAWN -	VH
CHECKED -	MRB

benesch

alfred benesch & company
Engineers • Surveyors • Planners
205 North Michigan Avenue, Suite 2400
Chicago, Illinois 60601
312-565-0450
Job # 3938.02

**BRIDGE APPROACH SLAB DETAILS 1 OF 2
STRUCTURE NO. 027-0097**

SHEET NO. S11	F.A.P. RTE. 796	SECTION 104 I & 105 BR-1	COUNTY FORD	TOTAL SHEETS 51	SHEET NO. 25
SHEETS S22	CONTRACT NO. 66848		ILLINOIS FED. AID PROJECT		

x:\3900c\3938\structures\illcoverkellycreek\final\plans\0270097-66848-01-dpsld1.dgn

154542

11/03/2009