

F.A.P. RTE.	SECTION	COUNTY	TOTAL SHEETS	SHEET NO.
326	(111)I-6	GRUNDY	10	1
FED. ROAD DIST. NO.	ILLINOIS	CONTRACT NO. 66996		

**STATE OF ILLINOIS  
DEPARTMENT OF TRANSPORTATION  
DIVISION OF HIGHWAYS**

**PROPOSED  
HIGHWAY PLANS**

**F.A.P. ROUTE 326 (IL ROUTE 47)  
SECTION (111)I-6**

**GRUNDY COUNTY  
WETLAND MAINTENANCE**

**C-93-054-10**

INDEX OF SHEETS

1. COVER SHEET
2. GENERAL NOTES
3. SUMMARY OF QUANTITIES
4. WETLAND MITIGATION SITE MAP
5. WETLAND MITIGATION SITE MAP
6. PLAN AND PROFILE LOW WATER CROSSING (A)
7. LOW WATER CROSSING (A)
8. PLAN AND PROFILE LOW WATER CROSSING (B)
9. LOW WATER CROSSING (B)
10. LOW WATER CROSSING (E)

STANDARDS

- 000001-05 STANDARD SYMBOLS, ABBREVIATIONS AND PATTERNS
- 420701-02 PAVEMENT FABRIC

MICROFILMED \_\_\_\_\_

REEL NUMBER \_\_\_\_\_

AWARDED \_\_\_\_\_

RESIDENT ENGINEER \_\_\_\_\_

AS BUILT CHANGES WERE MADE ON THE FOLLOWING SHEETS \_\_\_\_\_

**J.U.L.I.E.**  
JOINT UTILITY LOCATION INFORMATION FOR EXCAVATION  
1-800-892-0123

**DISTRICT 3 NO. (815) 434-6131**

**PROJECT ENGINEER: JOE KANNEL**

**UNIT CHIEF: RON WOODSHANK**

**TOWNSHIP: WAUPONSEE**

**CONTRACT NO. 66996**

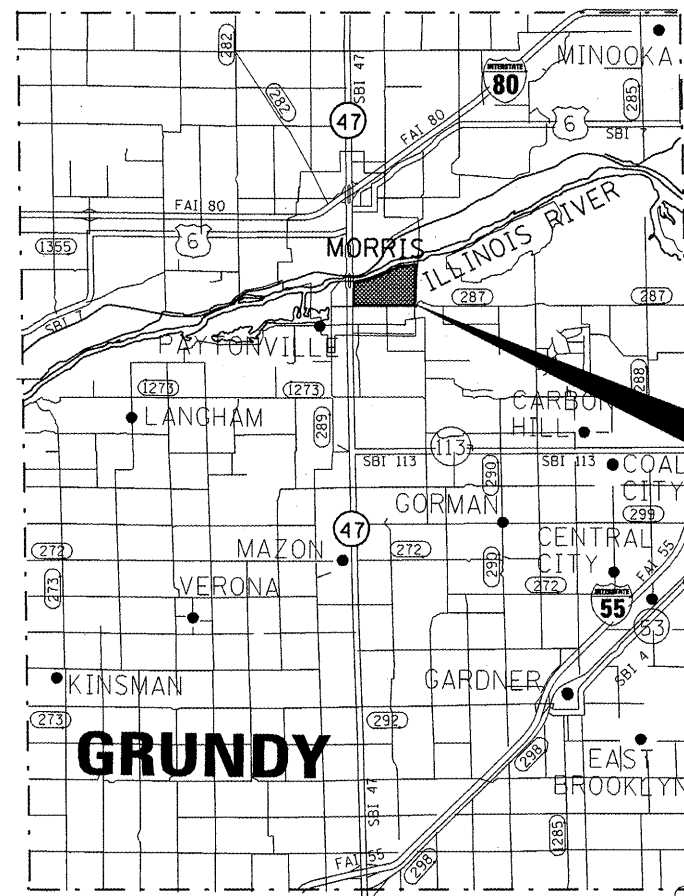

**LOCATION MAP  
NOT TO SCALE**

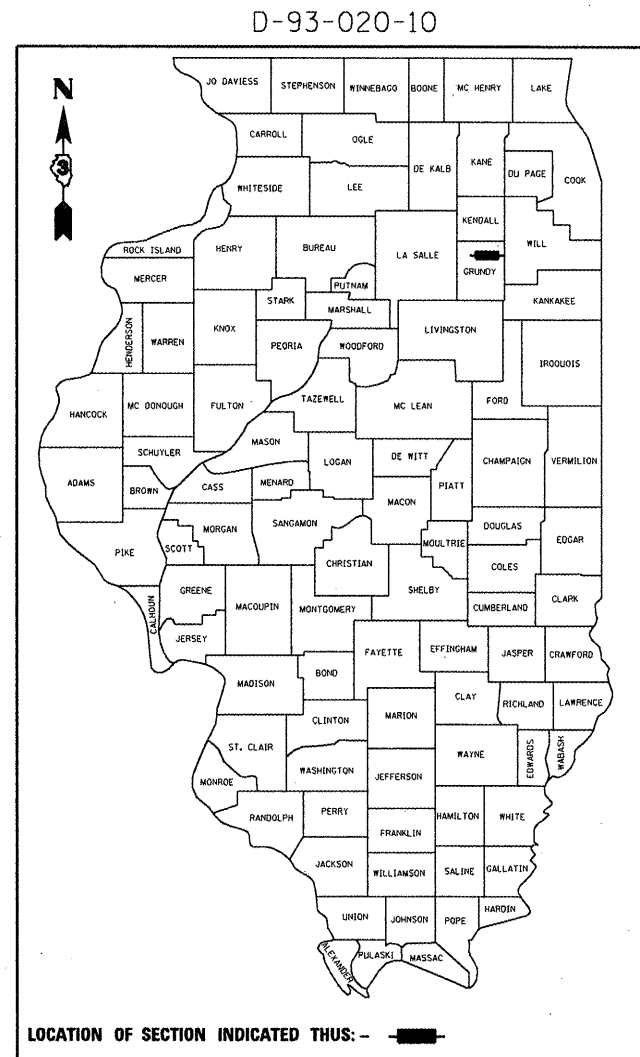

FUNCTIONAL CLASSIFICATION  
URBAN: OTHER PRINCIPAL ARTERIAL  
F.A.P. ROUTE 326 (IL 47)  
2007 ADT = 20200  
P.V. = 86.9% M.U. = 6.2% S.U. = 6.9%

STATE OF ILLINOIS  
DEPARTMENT OF TRANSPORTATION  
DIVISION OF HIGHWAYS

SUBMITTED 12-7 2009  
*Morgan Ryan*  
DEPUTY DIRECTOR OF HIGHWAYS, REGION ENGINEER

January 29 2010  
*Scott E. Still* P.E., I.E.  
Acting ENGINEER OF DESIGN AND ENVIRONMENT

January 09 2010  
*Christine M. Reed*  
DIRECTOR OF HIGHWAYS, CHIEF ENGINEER

**PRINTED BY THE AUTHORITY  
OF THE STATE OF ILLINOIS**

**GENERAL NOTES**

PLAN DIMENSIONS AND DETAILS RELATIVE TO THE EXISTING PLANS ARE SUBJECT TO ROUTINE VARIATIONS. THE CONTRACTOR SHALL FIELD VERIFY EXISTING DIMENSIONS AND DETAILS AFFECTING NEW CONSTRUCTION AND MAKE NECESSARY APPROVED ADJUSTMENTS PRIOR TO CONSTRUCTION OR ORDERING OF MATERIALS. SUCH VARIATIONS SHALL NOT BE CAUSE FOR ADDITIONAL COMPENSATION FOR A CHANGE IN THE SCOPE OF THE WORK. HOWEVER, THE CONTRACTOR WILL BE PAID FOR THE QUANTITY FURNISHED BASED UPON THE UNIT BID PRICE FOR THE WORK.

THE CONTRACTOR SHALL BE RESPONSIBLE FOR PROTECTING UTILITY PROPERTY FROM CONSTRUCTION OPERATIONS AS OUTLINED IN ARTICLE 107.31 OF THE STANDARD SPECIFICATIONS. THE "JULIE" NUMBER IS 1-800-892-0123. A MINIMUM OF FORTY-EIGHT (48) HOURS ADVANCE NOTICE IS REQUIRED.

ABANDONED UNDERGROUND UTILITIES THAT CONFLICT WITH CONSTRUCTION SHALL BE DISPOSED OF OUTSIDE THE LIMITS OF THE RIGHT OF WAY ACCORDING TO ARTICLE 202.03 OF THE STANDARD SPECIFICATIONS AND AS DIRECTED BY THE ENGINEER. THIS WORK WILL NOT BE PAID FOR SEPARATELY, BUT SHALL BE INCLUDED IN THE COST OF EARTH EXCAVATION.

ANY REFERENCE TO A STANDARD IN THESE PLANS SHALL BE INTERPRETED TO MEAN THE EDITION AS INDICATED BY THE SUBNUMBER SHOWN IN THE LIST OF STANDARDS OR THE COPY INCLUDED IN THESE PLANS.

THE CONTRACTOR SHALL PROTECT ALL TREES AND SHRUBS FROM HIS(HER) MOWING OPERATIONS. IF TREES OR SHRUBS ARE DAMAGED DUE TO THE CONTRACTORS OPERATIONS, THE DAMAGED TREE(S) OR SHRUBS(S) SHALL BE REMOVED AND REPLACED AT THE CONTRACTORS EXPENSE.

THE FOLLOWING RATES OF APPLICATION HAVE BEEN USED IN CALCULATING PLAN QUANTITIES:

GRANULAR MATERIALS	2.05 TONS / CU YD
--------------------	-------------------

DATE: 12-4-09

PREPARED BY: *David Bevil*  
 DISTRICT STUDIES & PLANS ENGINEER

EXAMINED BY: *[Signature]*  
 DISTRICT CONSTRUCTION ENGINEER

*[Signature]*  
 DISTRICT MATERIALS ENGINEER

*[Signature]*  
 DISTRICT OPERATIONS ENGINEER

FILE NAME =	USER NAME = woodshankr1	DESIGNED - RON WOODSHANK	REVISED -
c:\p\work\p\dot\woodshankr1\0168300	366996-details.dgn	DRAWN - RON WOODSHANK	REVISED -
	PLOT SCALE = 100,0000 ' / IN.	CHECKED -	REVISED -
	PLOT DATE = Dec 01, 2009 - 07:29:07 AM	DATE -	REVISED -

**STATE OF ILLINOIS  
 DEPARTMENT OF TRANSPORTATION**

**GENERAL NOTES**

SCALE: \_\_\_\_\_ SHEET NO. 1 OF 1 SHEETS

F.A.P. RTE.	SECTION	COUNTY	TOTAL SHEETS	SHEET NO.
326	(111)-6	GRUNDY	10	2
FED. ROAD DIST. NO. - ILLINOIS			CONTRACT NO. 66996	

# SUMMARY OF QUANTITIES

CONSTRUCTION CODE TYPE:

Y003

URBAN  
100% STATE  
TOTAL  
QUANTITY

CODE NO.	ITEM	UNIT	TOTAL QUANTITY
20200100	EARTH EXCAVATION	CU YD	50
28100107	STONE RIPRAP, CLASS A4	SQ YD	253
28200200	FILTER FABRIC	SQ YD	430
31100300	SUB-BASE GRANULAR MATERIAL, TYPE A 4"	SQ YD	78
40200800	AGGREGATE SURFACE COURSE, TYPE B	TON	200
42000300	PORTLAND CEMENT CONCRETE PAVEMENT 8"	SQ YD	78
42000600	PORTLAND CEMENT CONCRETE PAVEMENT 16 1/2 - 10 1/2 - 16 1/2	SQ YD	67
42001200	PAVEMENT FABRIC	SQ YD	134
51100300	SLOPE WALL 6"	SQ YD	63
542C5479	PIPE CULVERTS, CLASS C, TYPE 1 EQUIVALENT ROUND-SIZE 24"	FOOT	66
67100100	MOBILIZATION	L SUM	1
X2010505	CLEARING (SPECIAL)	L SUM	1
Z0001058	AGGREGATE SUBGRADE 18"	SQ YD	87
Z0015500	DEBRIS REMOVAL	L SUM	1

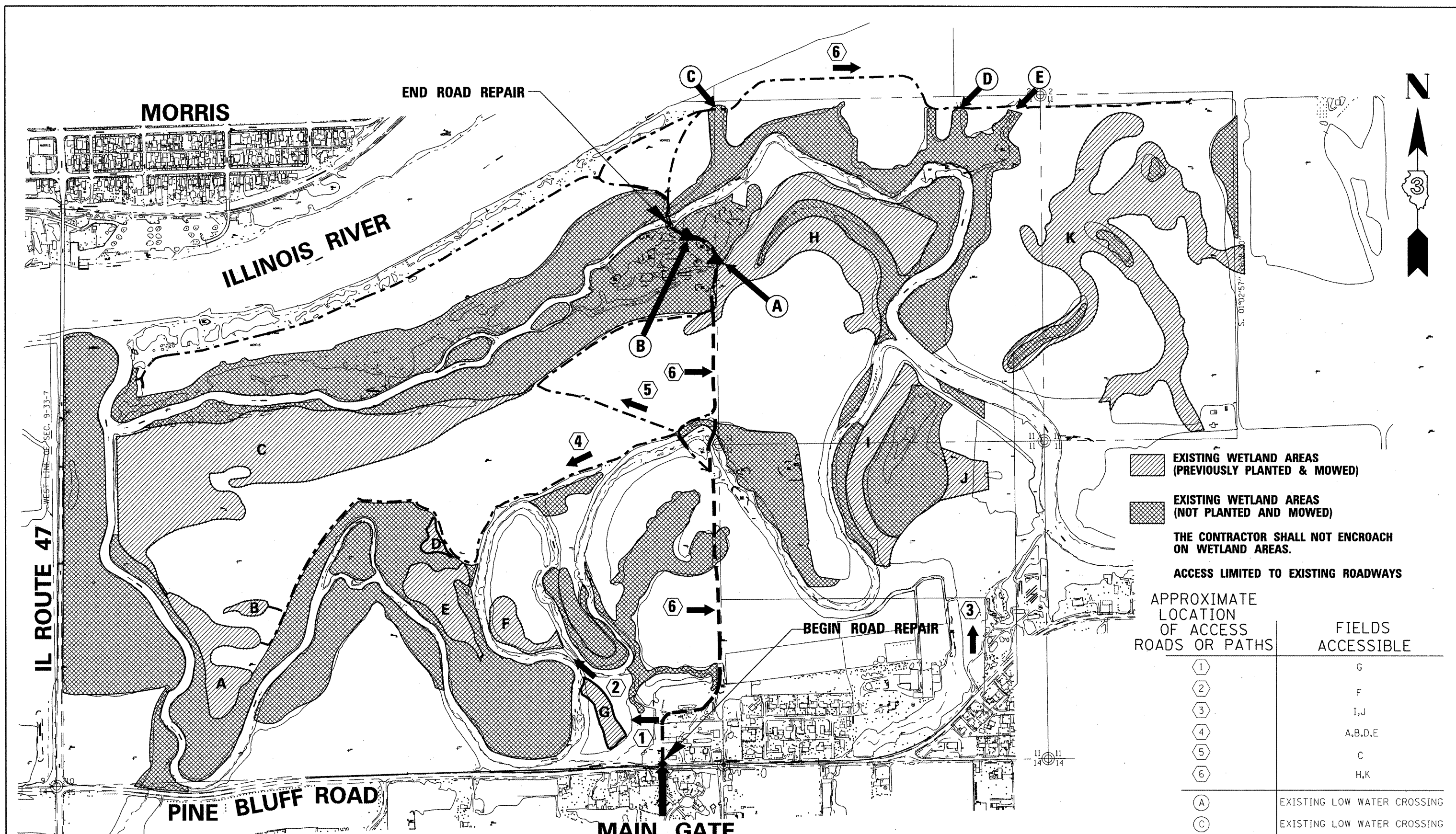

APPROXIMATE LOCATION OF ACCESS ROADS OR PATHS

ACCESS ROAD OR PATH	FIELDS ACCESSIBLE
1	G
2	F
3	I, J
4	A, B, D, E
5	C
6	H, K

ACCESS ROAD OR PATH	FIELDS ACCESSIBLE
(A)	EXISTING LOW WATER CROSSING
(C)	EXISTING LOW WATER CROSSING
(D)	EXISTING LOW WATER CROSSING
(E)	EXISTING LOW WATER CROSSING

FILE NAME =	USER NAME = woodshankr1	DESIGNED - RON WOODSHANK	REVISED -
c:\p\work\pwsdot\woodshankr1\d0168300\366996-details.dgn		DRAWN - RON WOODSHANK	REVISED -
		CHECKED -	REVISED -
		DATE -	REVISED -

**STATE OF ILLINOIS**  
**DEPARTMENT OF TRANSPORTATION**

**WETLAND MITIGATION SITE MAP**

SCALE: \_\_\_\_\_ SHEET NO. 1 OF 1 SHEETS

F.A.P. RTE. 326	SECTION (111)1-6	COUNTY GRUNDY	TOTAL SHEETS 10	SHEET NO. 4
FED. ROAD DIST. NO. _____		ILLINOIS		

CONTRACT NO. 66996

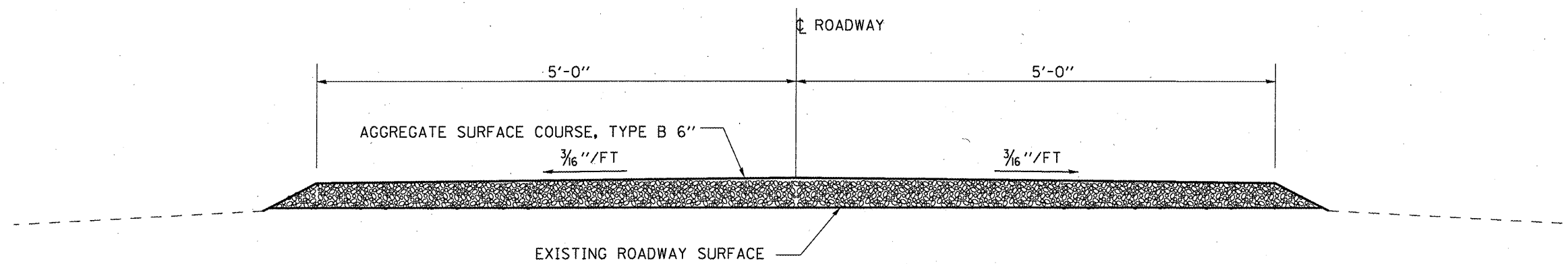

**TYPICAL SECTION**

ROADWAY REPAIR

*BILL OF MATERIAL*

ITEM	UNIT	QUANTITY
AGGREGATE SURFACE COURSE, TYPE B, 6"	TON	200

FILE NAME =	USER NAME = woodshankr1	DESIGNED - RON WOODSHANK	REVISED -	<b>STATE OF ILLINOIS DEPARTMENT OF TRANSPORTATION</b>	<b>TYPICAL SECTION</b>	F.A.P. RTE.	SECTION	COUNTY	TOTAL SHEETS	SHEET NO.
o:\pwork\pwork\woodshankr1\d0168300\366996-details.dgn	DRAWN - RON WOODSHANK	REVISED -	326			(111)I-6	GRUNDY	10	5	
PLOT SCALE = 100.0000' / IN.	CHECKED -	REVISED -	CONTRACT NO. 66996							
PLOT DATE = Dec 01, 2009 - 07:30:21 AM	DATE -	REVISED -	FED. ROAD DIST. NO. - ILLINOIS							
				SCALE: -----	SHEET NO. 1 OF 1 SHEETS					

PLAN	SURVEYED	DATE
NOTE BOOK	PLOTTED	BY
NO.	CHECKED	
	DATE	
	CAD FILE NAME	

PROFILE	SURVEYED	DATE
NOTE BOOK	PLOTTED	BY
NO.	CHECKED	
	DATE	
	STRUCTURE NOTATION	

BM #1 2"x2" WOODEN HUB, STA. 1+00 LT ELEV. 100.00  
 BM #2 2"x2" WOODEN HUB, STA. 1±75 RT. ELEV. 99.27  
 BM #2 2"x2" WOODEN HUB, STA. 1±60 RT. ELEV. 103.35

**DESCRIPTION OF WORK**

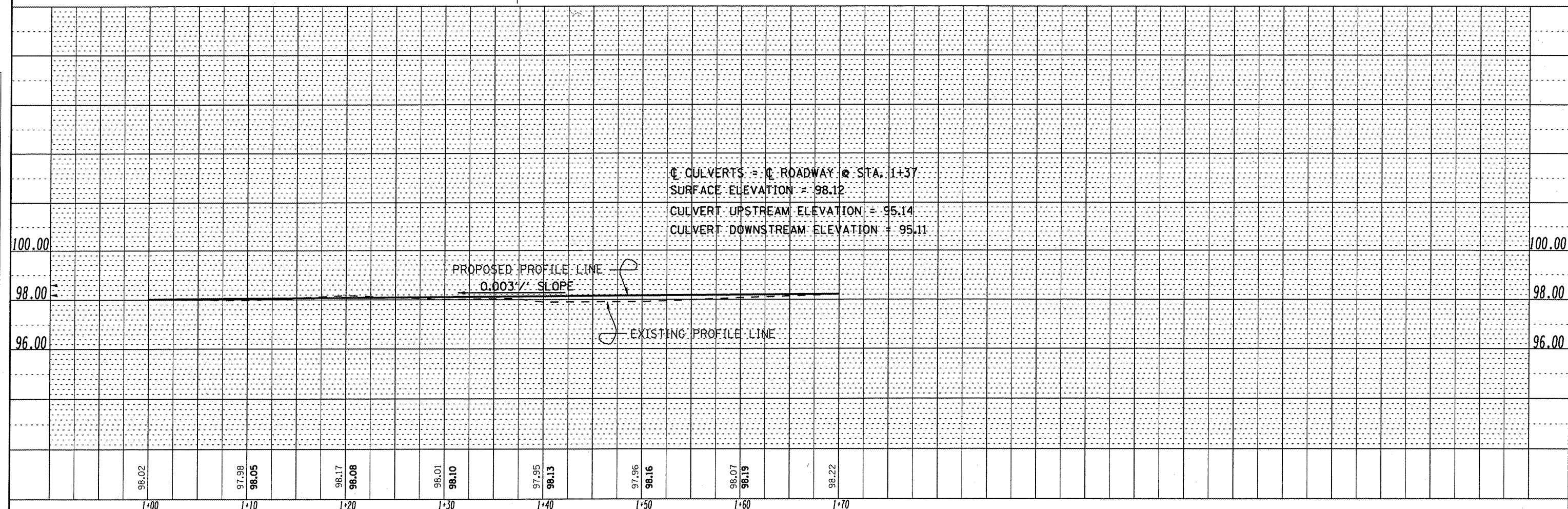
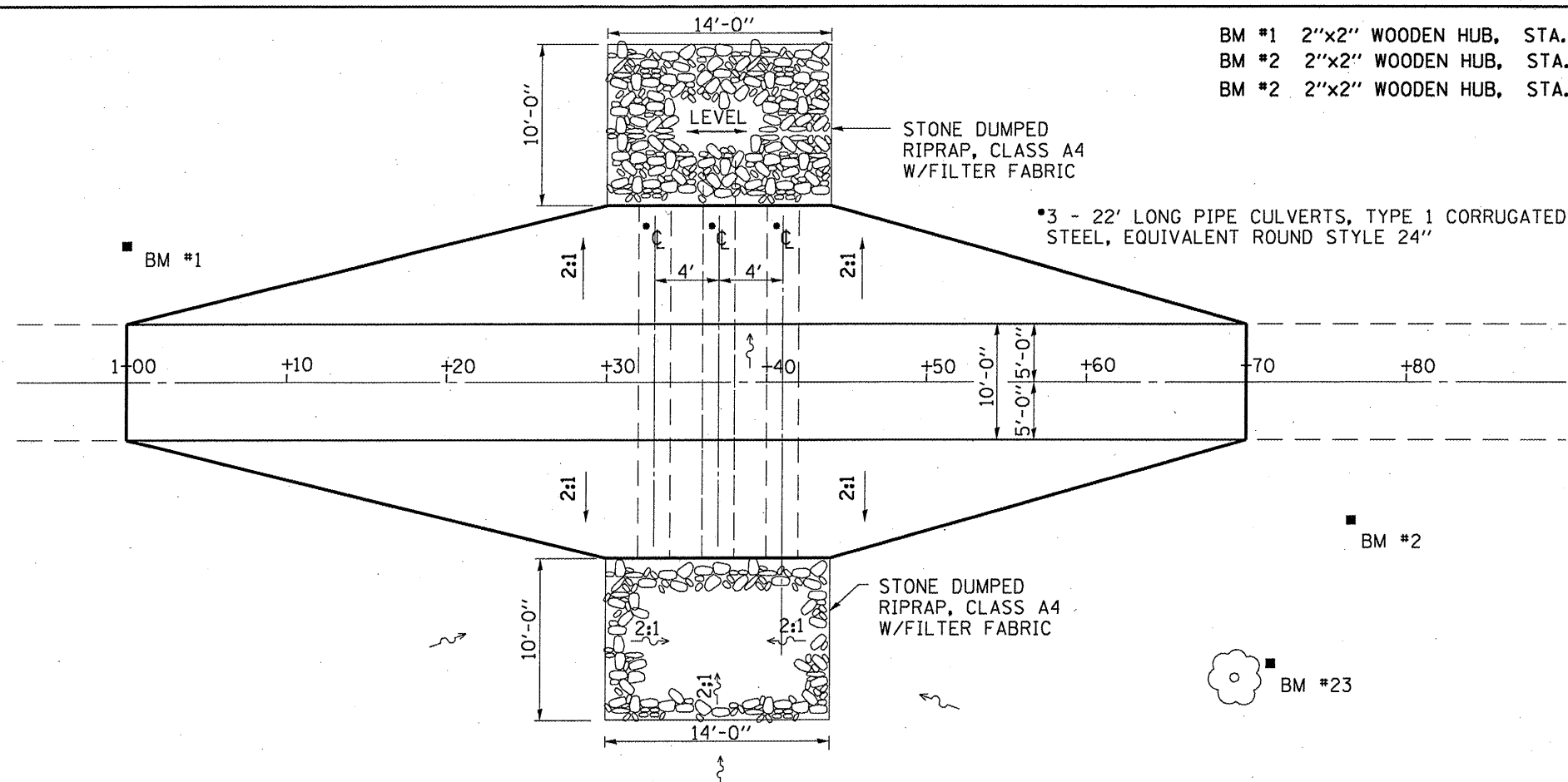

FILE NAME =	USER NAME = woodshenkr-l	DESIGNED -	REVISED -	<b>STATE OF ILLINOIS</b> <b>DEPARTMENT OF TRANSPORTATION</b>	<b>PLAN AND PROFILE</b> <b>LOW WATER CROSSING (A)</b>	F.A.P. RTE. 326	SECTION (111)I-6	COUNTY GRUNDY	TOTAL SHEETS 10	SHEET NO. 6		
ca:\pw\work\pwwdot\woodshenkr-l\00168300\0366996-details.dgn	PLOT SCALE = 1/8" = 1' IN.	CHECKED -	REVISED -			SCALE: _____	SHEET NO. 1 OF 1 SHEETS	STA. 1+00 TO STA. 1+80	CONTRACT NO. 66996			
PLOT DATE = Dec 01, 2009 - 07:30:27 AM	DATE -	REVISED -	REVISED -			FED. ROAD DIST. NO. ILLINOIS						

LT.  
DOWNSTREAM

RT.  
UPSTREAM

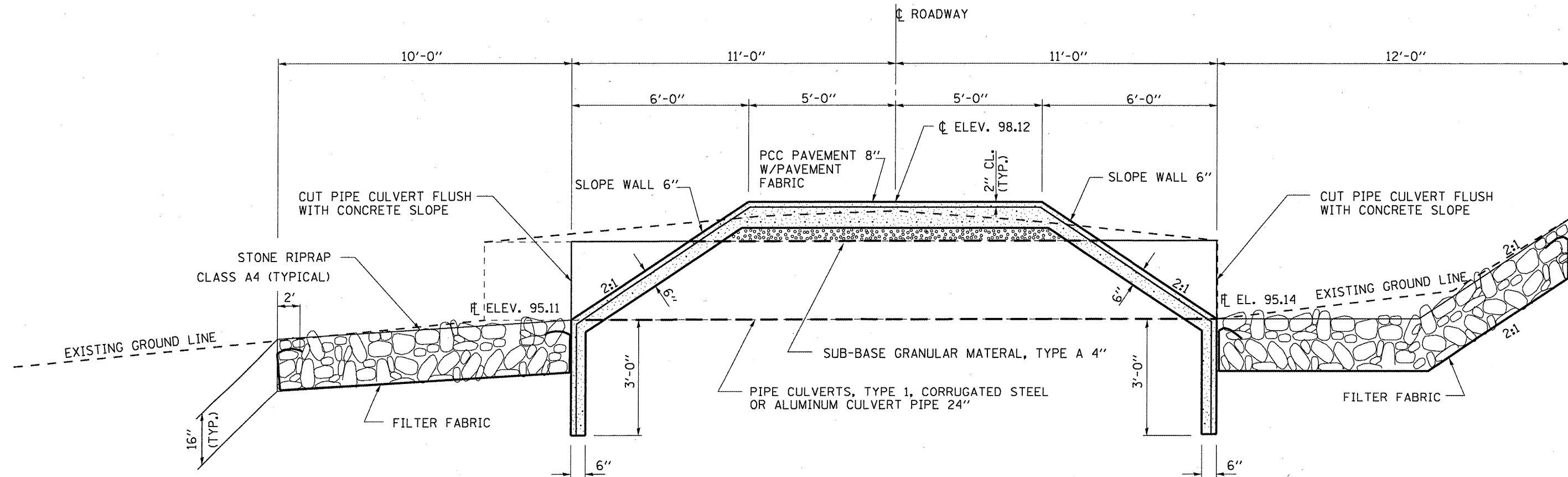

**CROSS SECTION  
STA. 1+37**

**BILL OF MATERIAL**

ITEM	UNIT	QUANTITY
SUB-BASE GRANULAR MATERIAL, TYPE A, 4"	SQ YD	78
STONE RIPRAP, CLASS A4	SQ YD	43
FILTER FABRIC	SQ YD	43
PCC PAVEMENT 8"	SQ YD	78
PAVEMENT FABRIC	SQ YD	78
SLOPE WALL 6"	SQ YD	87
PIPE CULVERT, TYPE 1, CORRUGATED STEEL, EQUIVALENT ROUND STYLE 24"	FOOT	66

FILE NAME =	USER NAME = woodshankr1	DESIGNED - RON WOODSHANK	REVISED -
ca:\pyr_work\pwidot\woodshankr1\d0168300\366996-details.dgn		DRAWN - RON WOODSHANK	REVISED -
		CHECKED -	REVISED -
		DATE -	REVISED -

STATE OF ILLINOIS  
DEPARTMENT OF TRANSPORTATION

LOW WATER CROSSING (A)  
SCALE: \_\_\_\_\_ SHEET NO. 1 OF 1 SHEETS

F.A.P. RTE. 326	SECTION (111)1-6	COUNTY GRUNDY	TOTAL SHEETS 10	SHEET NO. 7
FED. ROAD DIST. NO. - ILLINOIS			CONTRACT NO. 66996	

BM #1 2"x2" WOODEN HUB, STA. 1+00 LT ELEV. 100.00  
 BM #2 2"x2" WOODEN HUB, STA. 1±75 RT. ELEV. 102.19  
 BM #3 RAILROAD SPIKE IN DEAD TREE, STA. 1±80 RT. ELEV. 101.68

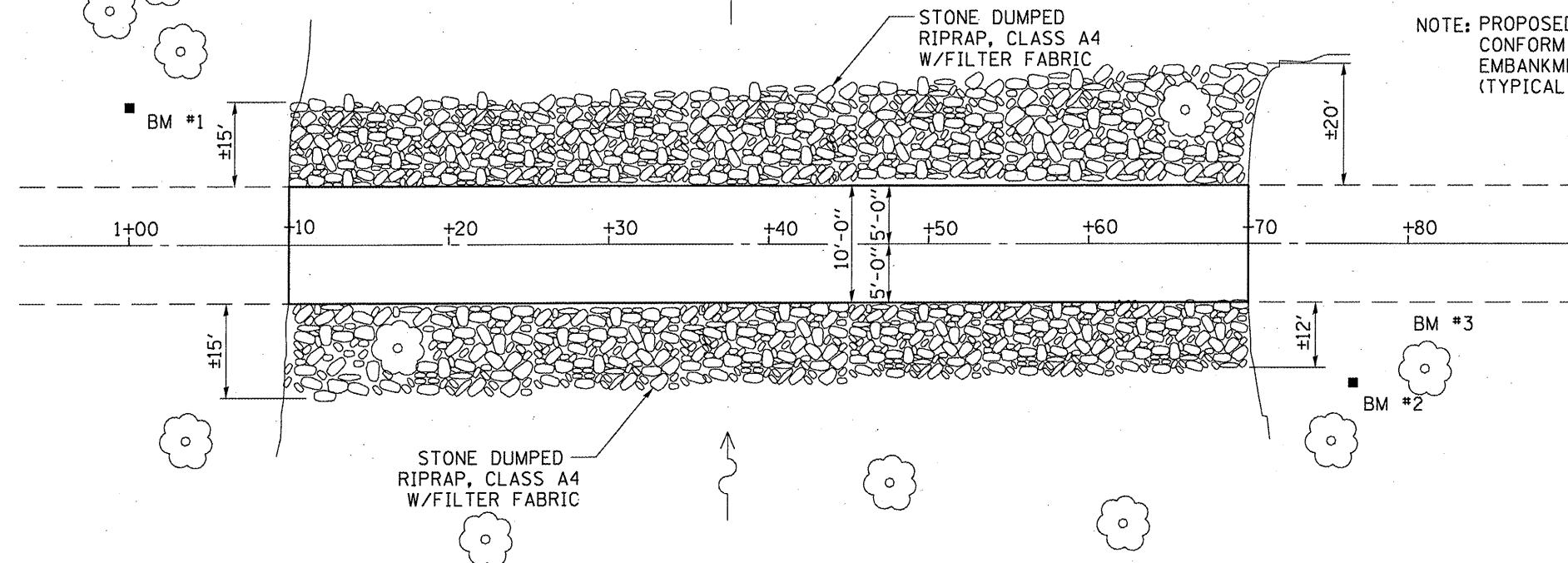

DATE	
BY	
DESIGNED	
DRAWN	
CHECKED	
DATE	

DATE	
BY	
DESIGNED	
DRAWN	
CHECKED	
DATE	

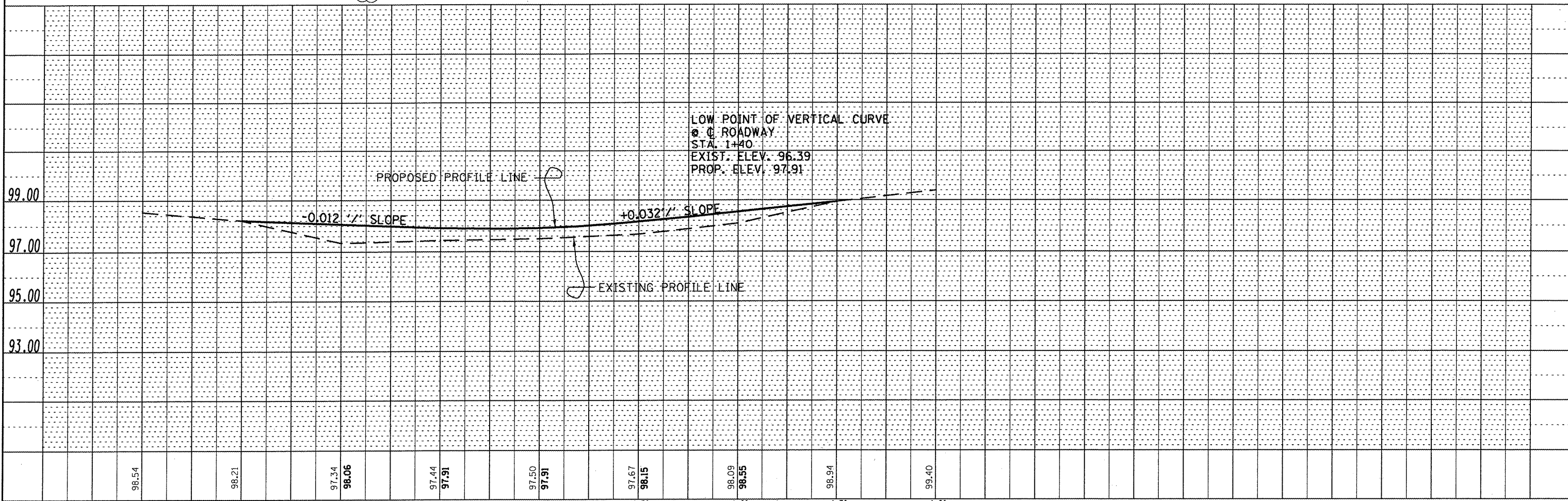

FILE NAME =	USER NAME = woodshankr1	DESIGNED -	REVISED -	<b>STATE OF ILLINOIS DEPARTMENT OF TRANSPORTATION</b>	<b>PLAN AND PROFILE LOW WATER CROSSING (B)</b>	F.A.P. RTE. 326	SECTION (111)1-6	COUNTY GRUNDY	TOTAL SHEETS 10	SHEET NO. 8
ci:\pw_work\pwwidot\woodshankr1\0168300\0366996-detail3.dgn	DRAWN -	REVISED -	CONTRACT NO. 66996							
PLOT SCALE = 100.0000' / IN.	CHECKED -	REVISED -	FED. ROAD DIST. NO. ILLINOIS							
PLOT DATE = Dec 01, 2009 - 07:38:39 AM	DATE -	REVISED -	SCALE: SHEET NO. 1 OF 1 SHEETS STA. 1+00 TO STA. 1+80							



LT.  
DOWNSTREAM

RT.  
UPSTREAM

\* CL ELEV. 97.88  
STA. 1+37

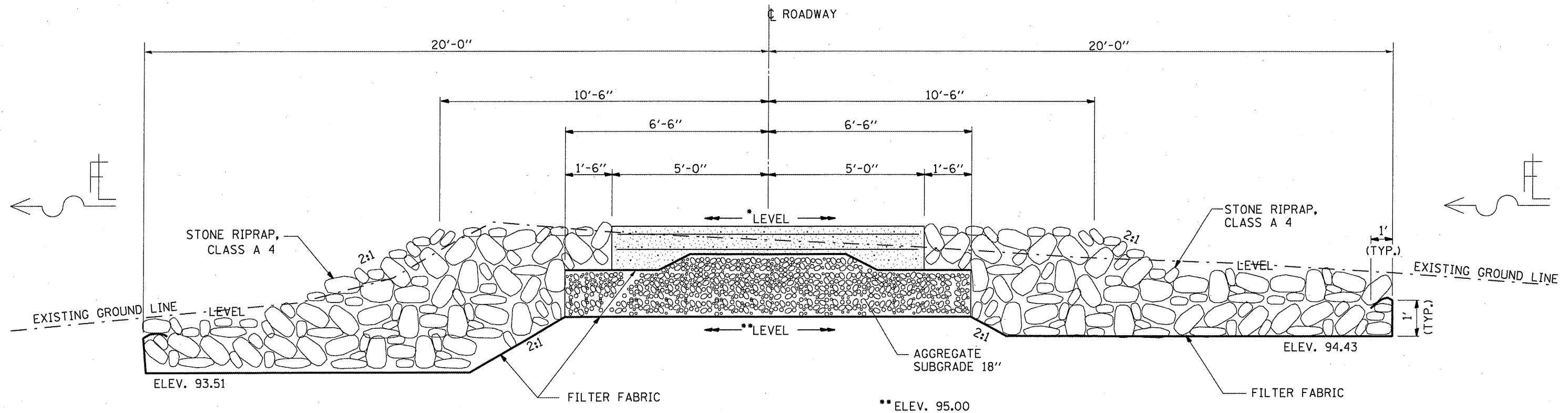

**CROSS SECTION  
STA. 1+37**

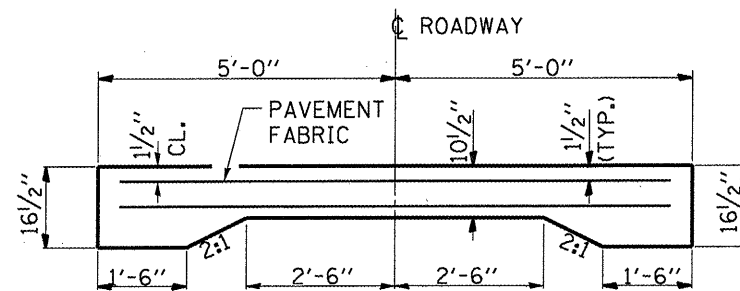

**PAVEMENT DETAIL**

**BILL OF MATERIAL**

ITEM	UNIT	QUANTITY
EARTH EXCAVATION	CU YD	50
STONE RIPRAP, CLASS A4	SQ YD	210
FILTER FABRIC	SQ YD	387
PCC PAVEMENT 16 1/2" - 10 1/2" - 16 1/2"	SQ YD	67
PAVEMENT FABRIC	SQ YD	134
AGGEGATE SUBGRADE 18"	SQ YD	87

FILE NAME =	USER NAME = woodshankr1	DESIGNED - RON WOODSHANK	REVISED -
c:\pwwork\pwwork\woodshankr1\d0168380	366996-details.dgn	DRAWN - RON WOODSHANK	REVISED -
PLOT SCALE = 100.0000' / IN.	CHECKED -	REVISIED -	
PLOT DATE = Dec 01, 2009 - 07:30:44 AM	DATE -	REVISIED -	

STATE OF ILLINOIS  
DEPARTMENT OF TRANSPORTATION

LOW WATER CROSSING (B)

SCALE: \_\_\_\_\_ SHEET NO. 1 OF 1 SHEETS

F.A.P. RTE.	SECTION	COUNTY	TOTAL SHEETS	SHEET NO.
326	(111)I-6	GRUNDY	10	9
FED. ROAD DIST. NO. - [ILLINOIS]			CONTRACT NO. 66996	

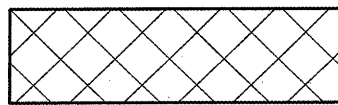
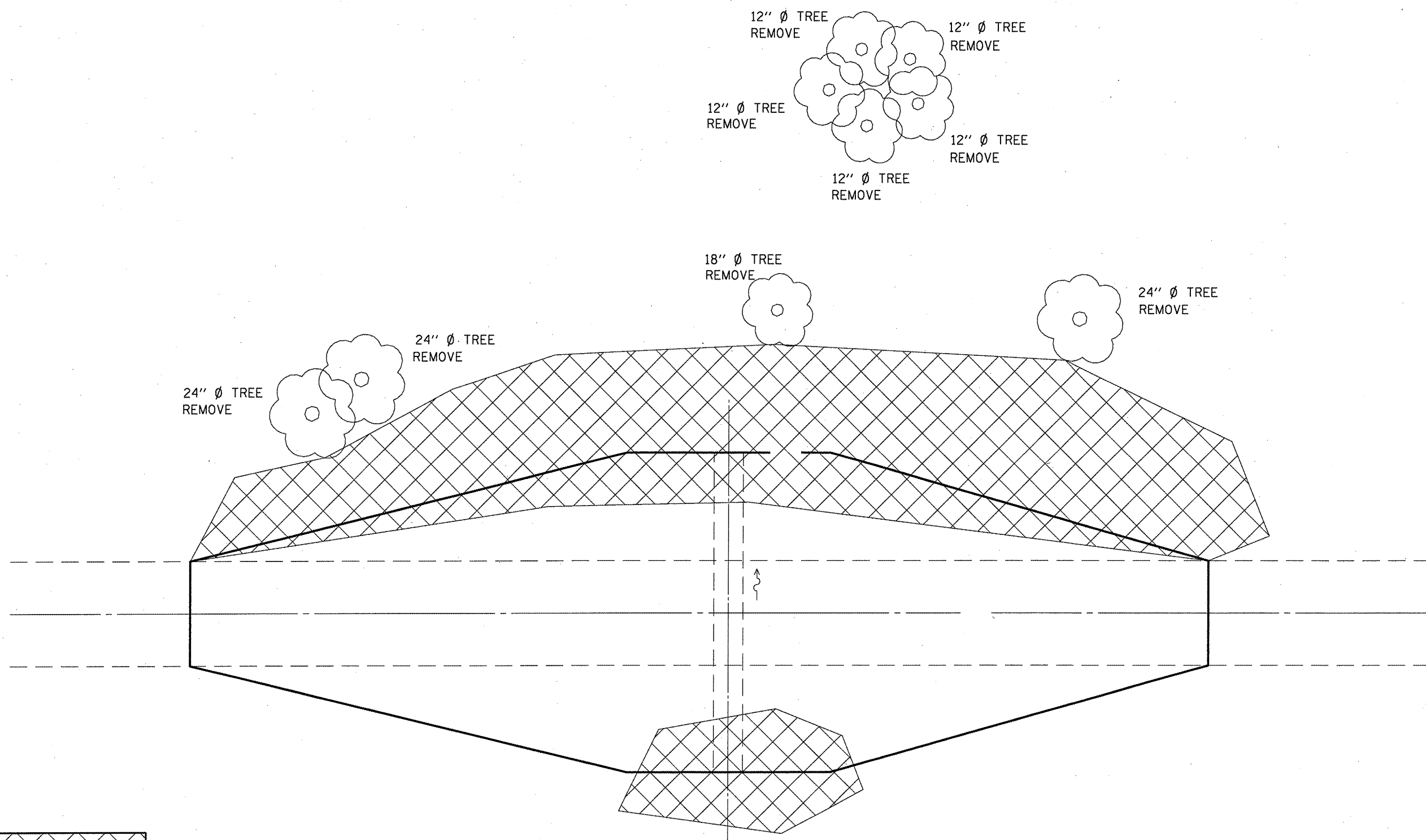

**DEBRIS REMOVAL**

**PLAN  
LOW WATER CROSSING (E)**

**BILL OF MATERIAL**

ITEM	UNIT	QUANTITY
DEBRIS REMOVAL	L SUM	1

FILE NAME =	USER NAME = woodshankr1	DESIGNED - RON WOODSHANK	REVISED -
c:\pwork\pwork\woodshankr1\d0168300\1366996-details.dgn		DRAWN - RON WOODSHANK	REVISED -
PLOT SCALE = 100.0000' / IN.	CHECKED -	REVISED -	
PLOT DATE = Dec 01, 2009 - 07:59:40 AM	DATE -	REVISED -	

**STATE OF ILLINOIS  
DEPARTMENT OF TRANSPORTATION**

**LOW WATER CROSSING (E)**

SCALE: \_\_\_\_\_ SHEET NO. 1 OF 1 SHEETS

F.A.P. RTE. 326	SECTION (111)-6	COUNTY GRUNDY	TOTAL SHEETS 10	SHEET NO. 10
FED. ROAD DIST. NO. - ILLINOIS			CONTRACT NO. 66996	