

EXIST. CURVE 11  
 PI STA. = 5+76.94  
 $\Delta = 14^\circ 27' 36''$  (RT)  
 $D = 14^\circ 32' 14''$   
 $R = 394.13'$   
 $T = 50.00'$   
 $L = 99.47'$   
 $E = 3.16'$   
 $e = \text{---}$   
 $T.R. = \text{---}$   
 $S.E. \text{ RUN} = \text{---}$   
 $P.C. \text{ STA.} = 5+26.94$   
 $P.T. \text{ STA.} = 6+26.41$



92+00.00

98+00.00

BEGIN SECTION (28Z)RS-5  
 STATION 92+58.00

STA 94+89.79 (US 150/45) =  
 STA 5+00.00 (WRIGHT STREET)

LIMITS OF RESURFACING  
 STATION 5+26.94

COMMUNITY BLOOD  
 SERVICES OF ILLINOIS

ILLINOIS-AMERICAN  
 WATER

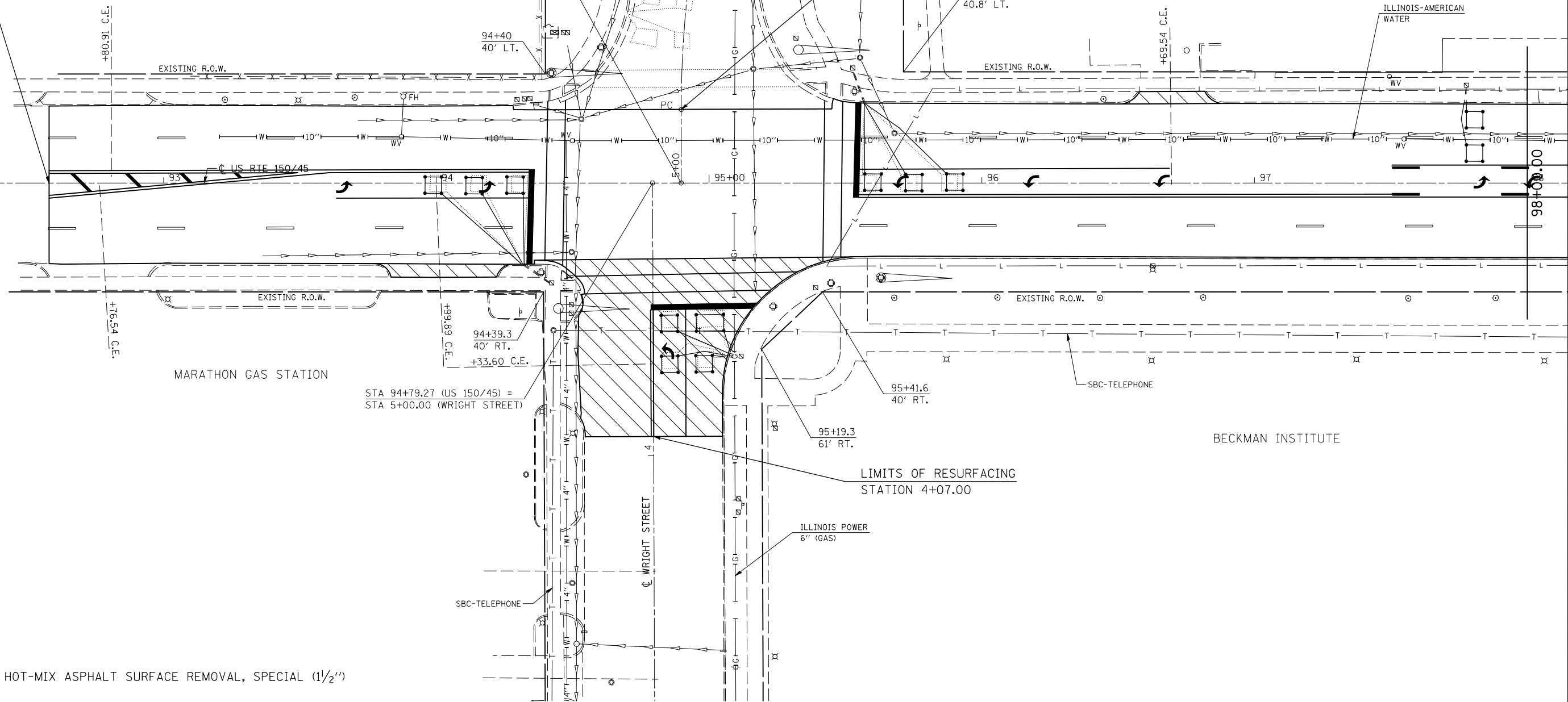

MARATHON GAS STATION

STA 94+79.27 (US 150/45) =  
 STA 5+00.00 (WRIGHT STREET)

LIMITS OF RESURFACING  
 STATION 4+07.00

BECKMAN INSTITUTE

ILLINOIS POWER  
 6\"/>

HOT-MIX ASPHALT SURFACE REMOVAL, SPECIAL (1 1/2\"/>

FILE NAME = c:\pwwork\pwwid\BUCKLESJJ\d0141682\0570121-shr-plan1.dgn	USER NAME = bucklesjj	DESIGNED -	REVISED -
PLOT SCALE = 40.0000' / IN.	CHECKED -	REVISOR -	REVISOR -
PLOT DATE = 12/11/2009	DATE -	REVISOR -	REVISOR -

**STATE OF ILLINOIS  
 DEPARTMENT OF TRANSPORTATION**

**PLAN SHEET**  
 SCALE: SHEET NO. OF SHEETS STA. 92+00 TO STA. 98+00

F.A.P. RTE. 808	SECTION (28Z)RS-5	COUNTY Champaign	TOTAL SHEETS 59	SHEET NO. 30
CONTRACT NO. 70121			ILLINOIS FED. AID PROJECT	