

SEC. 31, T. 16 N., R. 7 E., 3rd P.M.

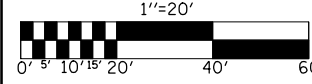

TEMPORARY DITCH CHECK
PERIMETER EROSION BARRIER

PROPOSED S.N. 021-2027
DOUBLE 12' X 12' X 52'
PRECAST BOX CULVERT (M273)
STA. 82+10.00, 0° SKEW
DESIGN FILL HEIGHT < 2'

EXISTING S.N. 021-0016
SINGLE SPAN REINFORCED CONCRETE SLAB
STA. 82+10.00, 0° SKEW
24'-6" BK TO BK ABUTMENT
EXISTING STRUCTURE TO BE REMOVED

RADII - BITSURFACE = 26.36'
AGG. SHOULDER = 18.10'
GUARDRAIL = 17.0'

BM 4754-2
CHISELED SQUARE ON THE NW
CORNER OF THE NE WINGWALL
ELEV. = 667.546

PLAN	SURVEYED	DATE
	PLOTTED	
	CHECKED	
	ATTEMPTED	
	FILE NAME	
	NO.	

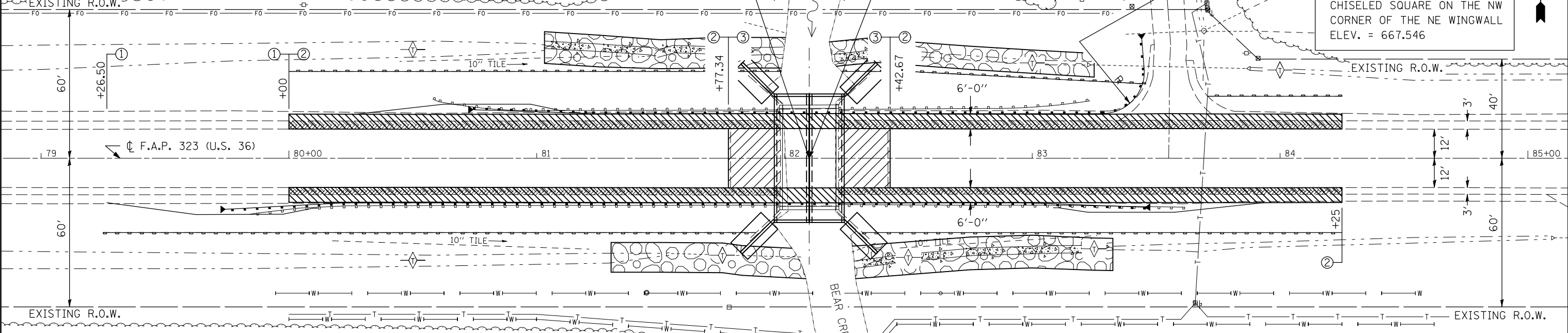

WATERWAY INFORMATION TABLE

Existing Low Grade Elev. = 665.3 @ Sta. 74+25		Proposed Low Grade Elev. = 665.3 @ Sta. 74+25	
Drainage Area = 2.8 mi. ²			
Flood	Freq. Yr.	Q C.F.S.	Opening Sq. Ft. Existing Proposed
Design	10	370	156 182
Base	50	590	189 218
Overtopping	100	686	198 227
Max. Calc.	500	918	200 230
Natural H.W.E.		Head - Ft. Existing Proposed	
661.7		0 0.1	
663.2		0.1 0.1	
663.6		0.1 0	
663.7		663.9 663.7	
663.7		663.9 663.7	
10 YEAR VELOCITY THROUGH EXISTING BRIDGE = 2.39 ft/sec		10 YEAR VELOCITY THROUGH PROPOSED BRIDGE = 2.05 ft/sec	
ALL-TIME H.W.E. & DATE: Unknown			

SEC. 5, T. 15 N., R. 7 E., 3rd P.M.

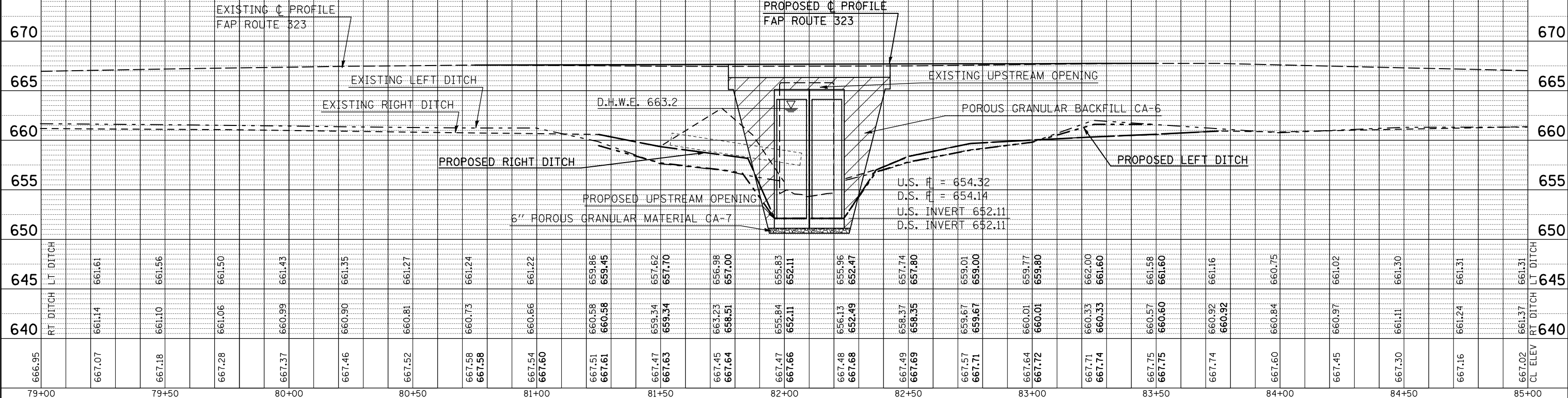

PROFILE	SURVEYED	DATE
	PLOTTED	
	CHECKED	
	ATTEMPTED	
	FILE NAME	
	NO.	

FILE NAME =	USER NAME = ceorlockjd	DESIGNED -	REVISED -	<p align="center">STATE OF ILLINOIS DEPARTMENT OF TRANSPORTATION</p>	<p align="center">PLAN & PROFILE SHEET</p>	F.A.P. RTE. = 323	SECTION = (143BR)BR	COUNTY = DOUGLAS	TOTAL SHEETS = 68	SHEET NO. = 13	
ct:\pwork\pwork\ceorlockjd\0110229\475\ppsheets.dgn		DRAWN -	REVISED -			SCALE:	SHEET NO. OF SHEETS	STA. TO STA.	CONTRACT NO. 70223		ILLINOIS FED. AID PROJECT
PLOT SCALE = 40.0000' / IN.		CHECKED -	REVISED -								
PLOT DATE = 12/17/2009		DATE -	REVISED -								