

SW 1/4, NE 1/4, SEC 30, T5N, R4E

NW 1/4, SE 1/4, SEC 30, T5N, R4E

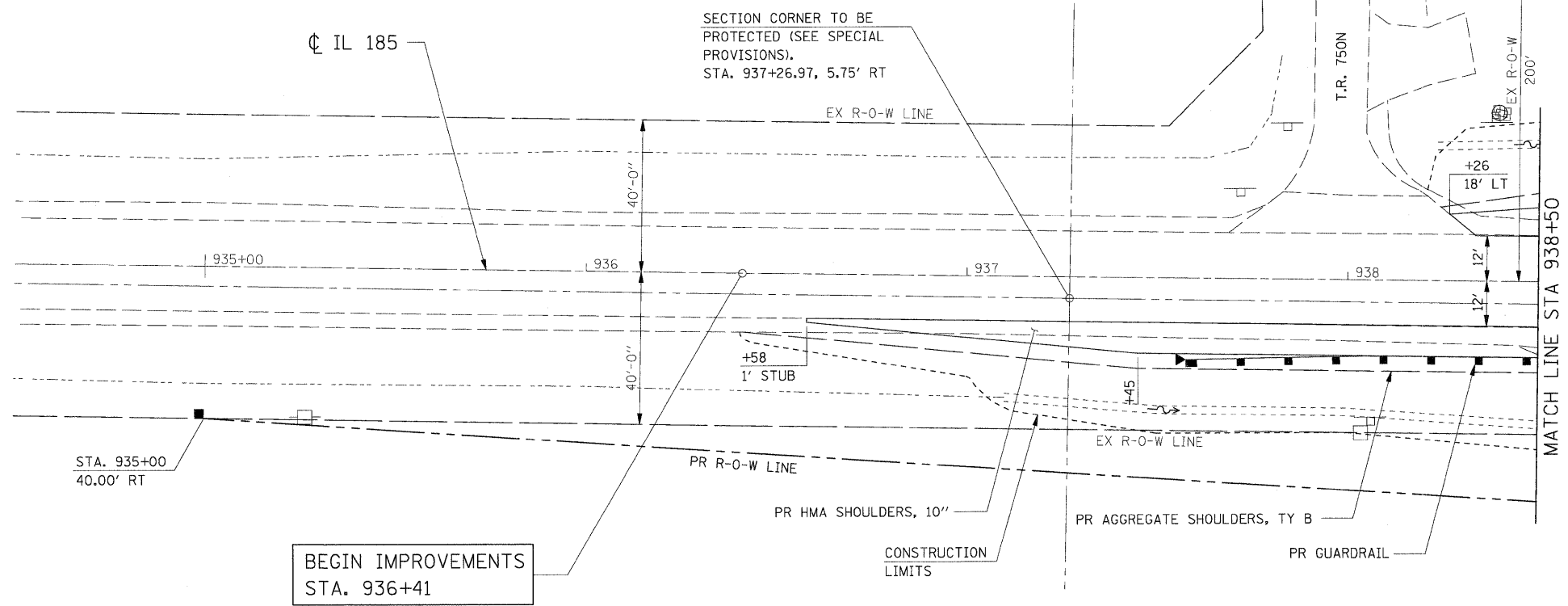
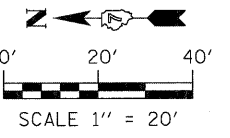

SE 1/4, NW 1/4, SEC 30, T5N, R4E

NE 1/4, SW 1/4, SEC 30, T5N, R4E

LEGEND

EX PAVEMENT REMOVAL

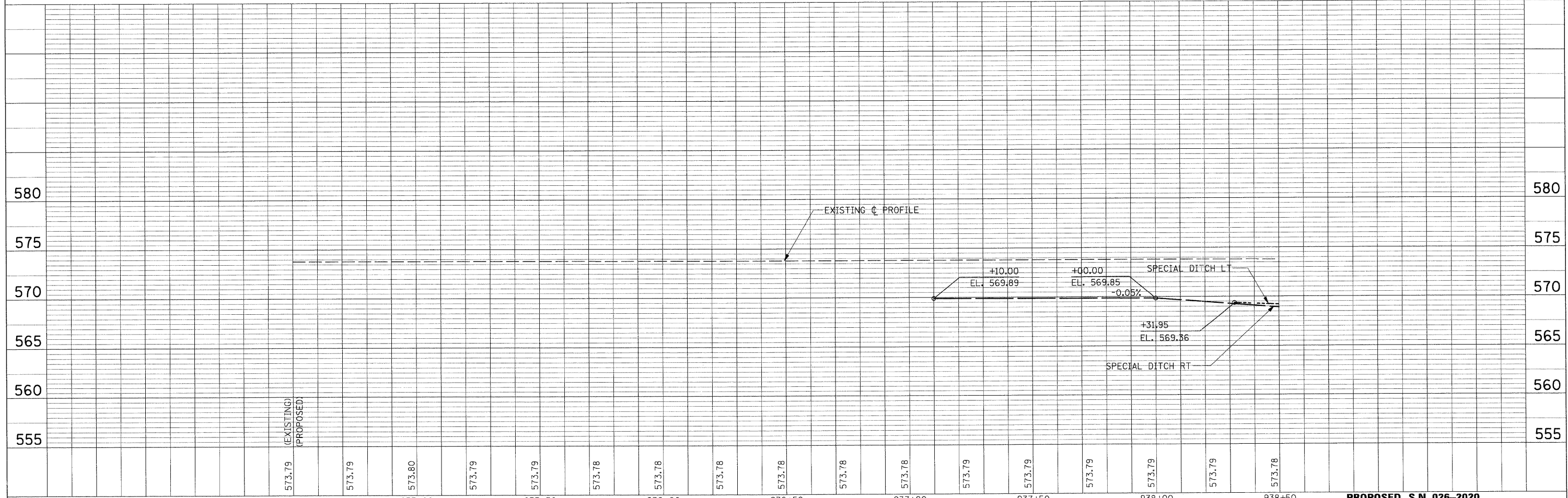

PLAN	SURVEYED	DATE
	ALIGNED	
	CHECKED	
	BY	
	NO. OF WAYS CHECKED	
	CADD FILE NAME	

PROFILE	SURVEYED	DATE
	PLOTTED	
	CHECKED	
	BY	
	NO. OF WAYS CHECKED	
	STRUCTURE NOTATIONS CHECKED	

FILE NAME = G:\S08026-5\CADD Sheets\0774110-sht-PLNPRF01.dgn	USER NAME = IE Consultants	DESIGNED -	REVISED -	STATE OF ILLINOIS DEPARTMENT OF TRANSPORTATION	PLAN & PROFILE				F.A. RTE.	SECTION	COUNTY	TOTAL SHEETS	SHEET NO.
PLOT SCALE = 20.0000' / IN.	CHECKED -	REVISED -	REVISED -		SCALE:	SHEET NO.	OF	SHEETS	STA.	TO	STA.	54	12
PLOT DATE = 9/29/2009	DATE -	REVISED -	REVISED -		PROPOSED S.N. 026-2020								
											FAYETTE		CONTRACT NO. 74110