

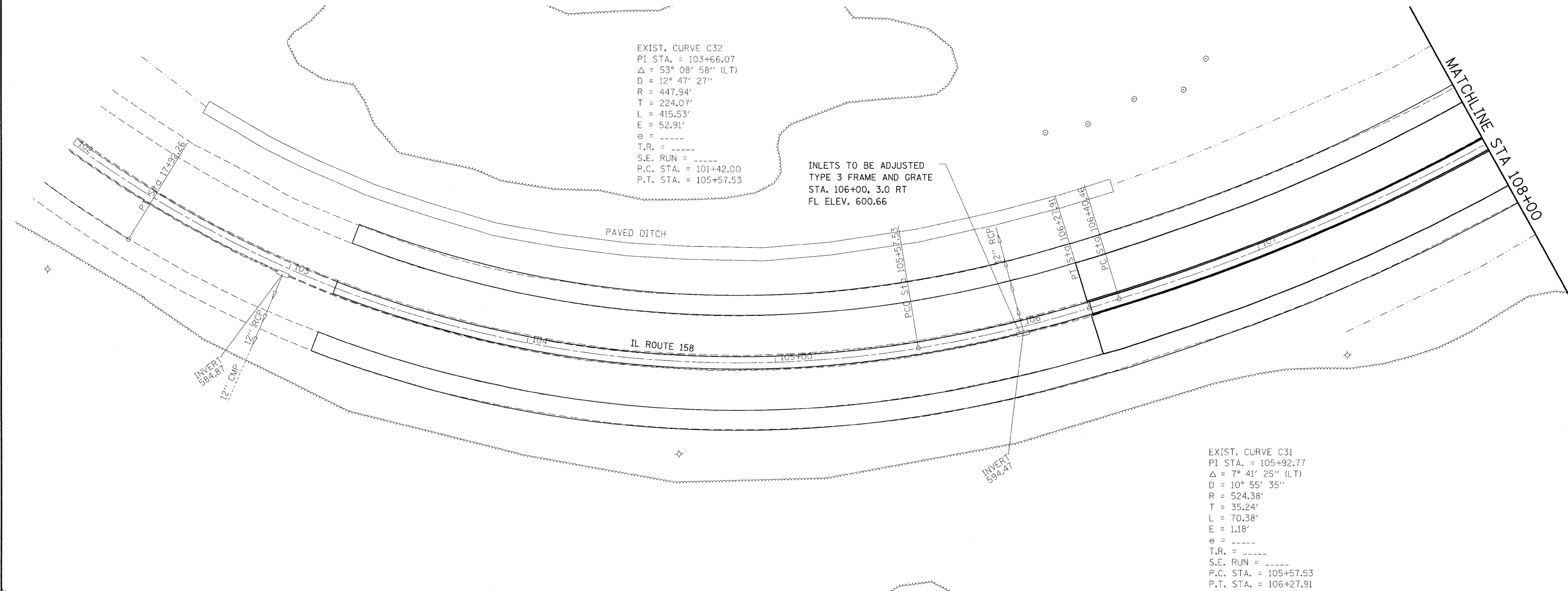

EXIST. CURVE C32
 PI STA. = 103+66.07
 Δ = 53° 08' 58" (LT)
 D = 12° 47' 27"
 R = 447.94'
 T = 224.07'
 L = 415.53'
 E = 52.91'
 e = -----
 T.R. = -----
 S.E. RUN = -----
 P.C. STA. = 101+42.00
 P.T. STA. = 105+57.53

INLETS TO BE ADJUSTED
 TYPE 3 FRAME AND GRATE
 STA. 106+00, 3.0 RT
 FL ELEV. 600.66

EXIST. CURVE C31
 PI STA. = 105+92.77
 Δ = 7° 41' 25" (LT)
 D = 10° 55' 35"
 R = 524.38'
 T = 35.24'
 L = 70.38'
 E = 1.18'
 e = -----
 T.R. = -----
 S.E. RUN = -----
 P.C. STA. = 105+57.53
 P.T. STA. = 106+27.91



FILE NAME =	USER NAME = muelheidac	DESIGNED -	REVISED -
ct:\pwork\pwidot\mueheidac\dms52558\1n20606a.dgn		DRAWN -	REVISED -
PLOT SCALE = 20.0000 ' / IN.		CHECKED -	REVISED -
PLOT DATE = 12/11/2009		DATE -	REVISED -

**STATE OF ILLINOIS
 DEPARTMENT OF TRANSPORTATION**

DRAINAGE PLAN

SCALE: SHEET NO. OF SHEETS STA. TO STA.

F.A.P. RTE.	SECTION	COUNTY	TOTAL SHEETS	SHEET NO.
809	67-IHBR	MONROE	144	48
CONTRACT NO. 76977				
FED. ROAD DIST. NO. ILLINOIS FED. AID PROJECT				