

EXIST. CURVE C109
 PI STA. = 23+10.16
 $\Delta = 14^\circ 37' 28''$ (LT)
 $D = 2^\circ 21' 42''$
 $R = 2,426.18'$
 $T = 311.33'$
 $L = 619.27'$
 $E = 19.89'$
 $e = \text{-----}$
 T.R. = -----
 S.E. RUN = -----
 P.C. STA. = 19+98.83
 P.T. STA. = 26+18.10

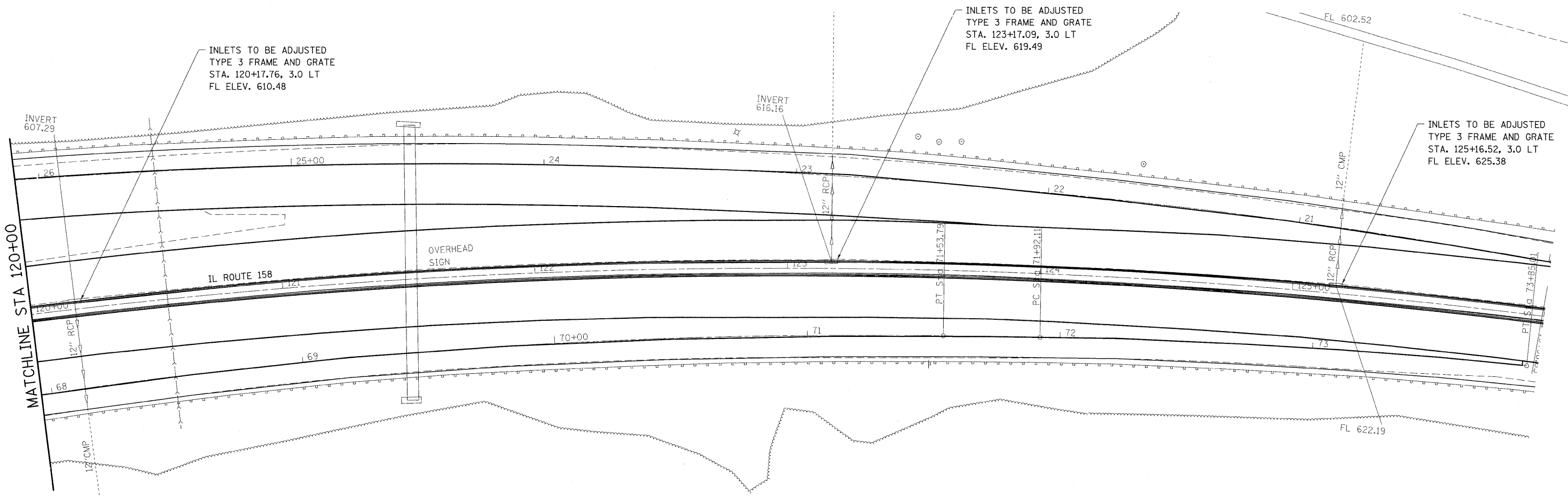

INLETS TO BE ADJUSTED
 TYPE 3 FRAME AND GRATE
 STA. 120+17.76, 3.0 LT
 FL ELEV. 610.48

INLETS TO BE ADJUSTED
 TYPE 3 FRAME AND GRATE
 STA. 123+17.09, 3.0 LT
 FL ELEV. 619.49

INLETS TO BE ADJUSTED
 TYPE 3 FRAME AND GRATE
 STA. 125+16.52, 3.0 LT
 FL ELEV. 625.38

EXIST. CURVE C208
 PI STA. = 68+80.14
 $\Delta = 14^\circ 13' 45''$ (RT)
 $D = 2^\circ 35' 11''$
 $R = 2,215.22'$
 $T = 276.49'$
 $L = 550.14'$
 $E = 17.19'$
 $e = \text{-----}$
 T.R. = -----
 S.E. RUN = -----
 P.C. STA. = 66+03.65
 P.T. STA. = 71+53.79

EXIST. CURVE C2
 PI STA. = 123+50.42
 $\Delta = 27^\circ 50' 31''$ (RT)
 $D = 2^\circ 23' 14''$
 $R = 2,400.00'$
 $T = 594.87'$
 $L = 1,166.24'$
 $E = 72.62'$
 $e = \text{-----}$
 T.R. = -----
 S.E. RUN = -----
 P.C. STA. = 117+55.54
 P.T. STA. = 129+21.79

EXIST. CURVE C209
 PI STA. = 72+88.62
 $\Delta = 4^\circ 54' 50''$ (RT)
 $D = 2^\circ 32' 51''$
 $R = 2,249.13'$
 $T = 96.51'$
 $L = 192.90'$
 $E = 2.07'$
 $e = \text{-----}$
 T.R. = -----
 S.E. RUN = -----
 P.C. STA. = 71+92.11
 P.T. STA. = 73+85.01

FILE NAME =	USER NAME = muehifeldao	DESIGNED -	REVISED -	STATE OF ILLINOIS DEPARTMENT OF TRANSPORTATION	DRAINAGE PLAN			F.A.P. RTE.	SECTION	COUNTY	TOTAL SHEETS	SHEET NO.
02\pwork\pwork\dms52558\1r00606a.dgn	1r00606a.dgn	DRAWN -	REVISED -					809	67-IHBR	MONROE	144	51
PLOT SCALE = 20,0000' / IN.		CHECKED -	REVISED -					CONTRACT NO. 76977				
PLOT DATE = 12/11/2009		DATE -	REVISED -					FED. ROAD DIST. NO. ILLINOIS FED. AID PROJECT				
				SCALE:	SHEET NO.	OF	SHEETS	STA. TO STA.				