

PLAN  
 DESIGNED BY: \_\_\_\_\_  
 PLOTTED BY: \_\_\_\_\_  
 CHECKED BY: \_\_\_\_\_  
 DATE: \_\_\_\_\_  
 NO. \_\_\_\_\_  
 FILE NAME: \_\_\_\_\_

PROFILE  
 DESIGNED BY: \_\_\_\_\_  
 PLOTTED BY: \_\_\_\_\_  
 CHECKED BY: \_\_\_\_\_  
 DATE: \_\_\_\_\_  
 NO. \_\_\_\_\_  
 FILE NAME: \_\_\_\_\_

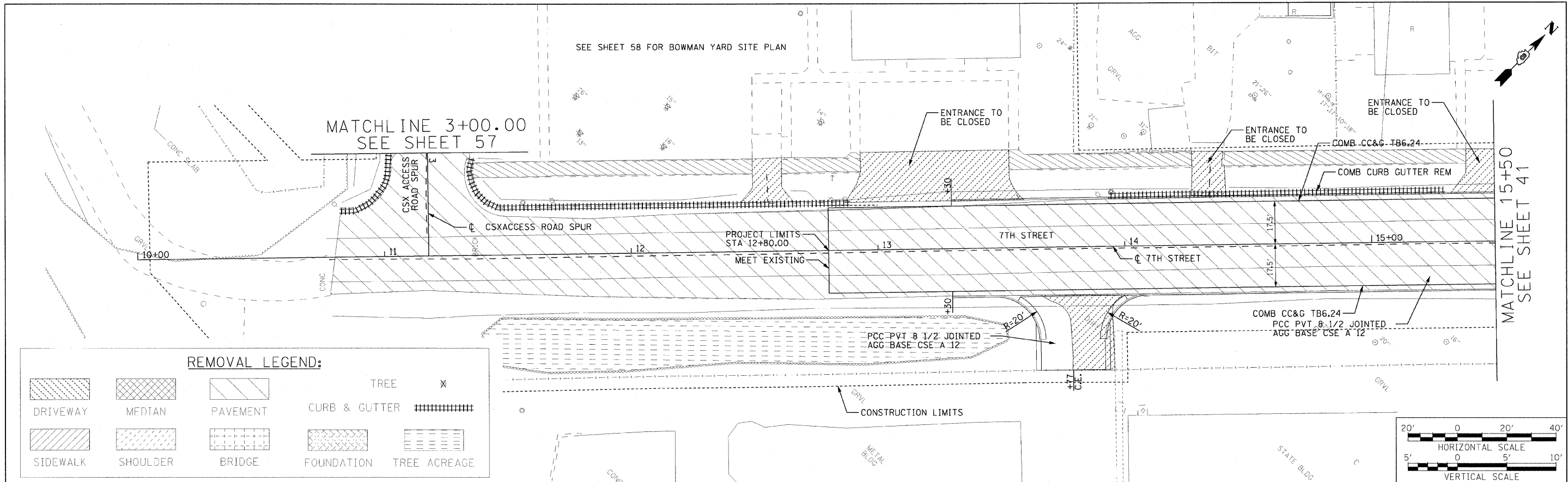

**REMOVAL LEGEND:**

			TREE	
DRIVEWAY	MEDIAN	PAVEMENT	CURB & GUTTER	
			FOUNDATION	TREE ACREAGE
SIDEWALK	SHOULDER	BRIDGE		

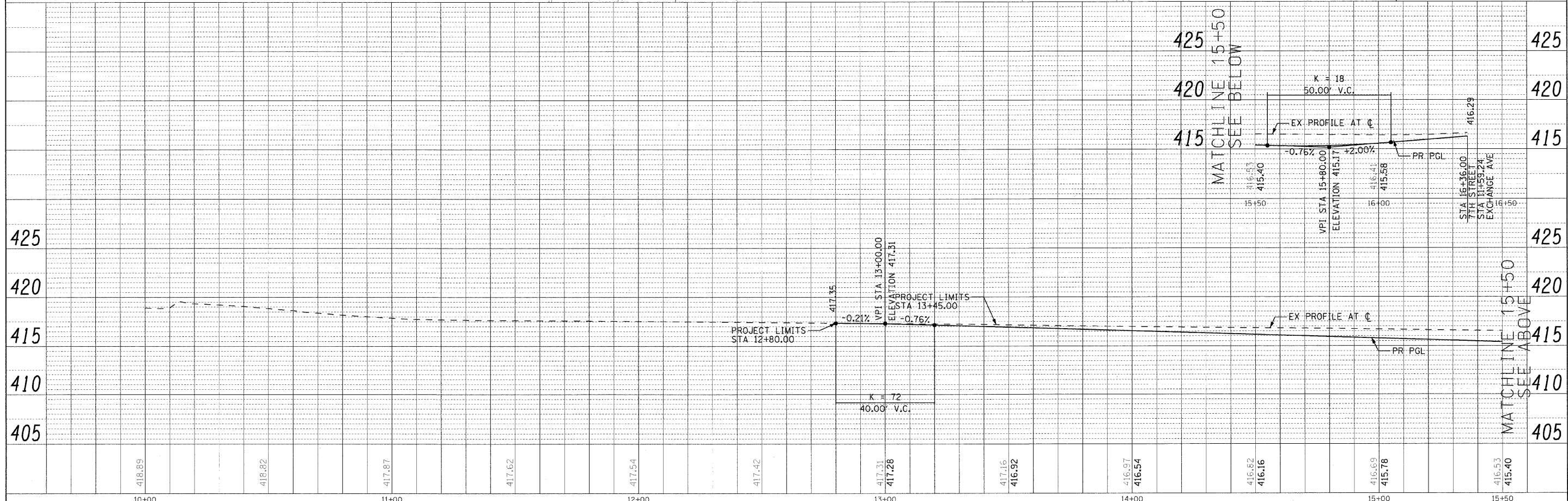

FILE NAME =	USER NAME = #USER#	DESIGNED - RRV	REVISED -	<b>STATE OF ILLINOIS DEPARTMENT OF TRANSPORTATION</b>	<b>ROADWAY PLAN AND PROFILE 7TH ST.</b>			F.A.J. RTE. 70	SECTION 82-2-1HB	COUNTY ST. CLAIR	TOTAL SHEETS 236	SHEET NO. 55			
#FILE#		DRAWN - KNW	REVISED -					SCALE: 1"=20'			SHEET NO. 15 OF 17 SHEETS			STA. 12+80.00 TO STA. 15+50.00	
		CHECKED - DRH	REVISED -					DATE - OCTOBER 9, 2009			FED. ROAD DIST. NO. ILLINOIS FED. AID PROJECT		CONTRACT NO. 76C55		
		DATE - OCTOBER 9, 2009	REVISED -												