

F.A.S. RTE.	SECTION	COUNTY	TOTAL SHEETS	SHEET NO.
206	06-00094-05-DR	MERCER	36	1
STA. 257+10.06 TO STA. 428+35.00				
FED. ROAD DIST. NO. 7		ILLINOIS		

# STATE OF ILLINOIS DEPARTMENT OF TRANSPORTATION

## PLANS FOR PROPOSED LOCAL AGENCY IMPROVEMENT FEDERAL-AID STR PROJECT

F.A.S. 206 (C.H. 4)  
KNOXVILLE ROAD  
PROJECT ARA-RS-0206 (117)  
MERCER COUNTY  
SECTION 06-00094-05-DR  
JOB NO. C-94-010-10

INDEX OF SHEETS	
SHEET NO.	DESCRIPTION
1	COVER SHEET
2	GENERAL NOTES & SUMMARY OF QUANTITIES
3-6	SCHEDULE OF QUANTITIES
7	TYPICAL SECTIONS AND DETAILS
8-18	PLAN AND PROFILE
19-22	EROSION CONTROL PLAN
23-32	PATCHING PLANS
33-34	DETAILS
35-36	CROSS SECTIONS

PLAN	1 INCH = 50 FEET	
PROFILE HORIZONTAL	1 INCH = 50 FEET	
PROFILE VERTICAL	1 INCH = 10 FEET	
CROSS SECTION HORIZ.	1 INCH = 10 FEET	
CROSS SECTION VERT.	1 INCH = 5 FEET	

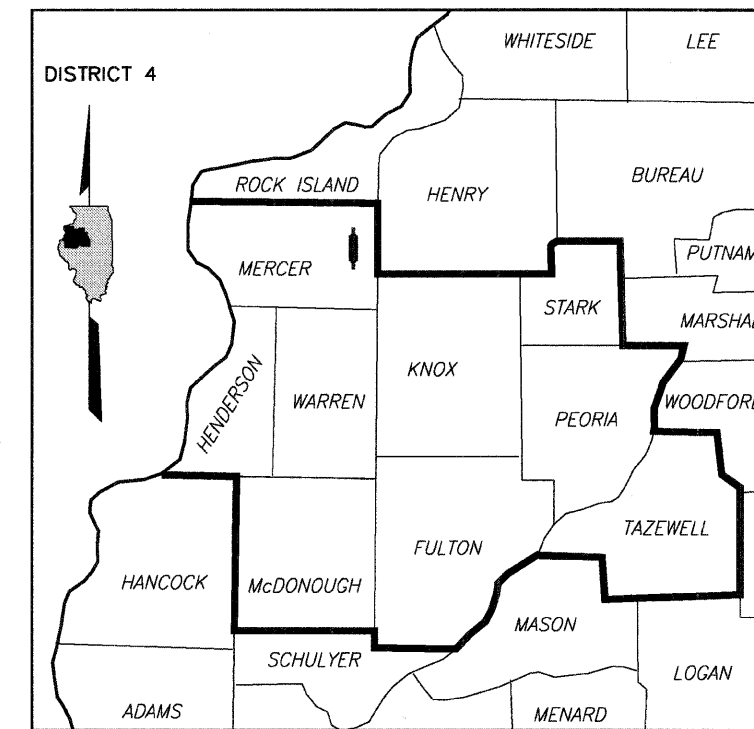

LOCATION OF SECTION INDICATED THUS:

**WARNING**



**CALL BEFORE  
YOU DIG**

- LIST OF STANDARDS**
- 000001-05 STANDARD SYMBOLS, ABBREVIATIONS AND PATTERNS
  - 280001-05 TEMPORARY EROSION CONTROL SYSTEMS
  - 406201-01 MAILBOX TURNOUT
  - 442201-03 CLASS C AND D PATCHES
  - 542401-01 METAL END SECTION FOR PIPE CULVERTS
  - 701006-03 OFF-ROAD OPERATIONS, 2L, 2W, 4.5M (15') TO 600 MM (24") FROM PAVEMENT EDGE
  - 701201-03 LANE CLOSURE, 2L, 2W, DAY ONLY, FOR SPEEDS ≥ 45 MPH
  - 701306-02 LANE CLOSURE, 2L, 2W, SLOW MOVING OPERATIONS DAY ONLY, FOR SPEEDS ≥ 45 MPH
  - 701311-03 LANE CLOSURE, 2L, 2W, MOVING OPERATIONS - DAY ONLY
  - 701336-05 LANE CLOSURE, 2L, 2W, WORK AREAS IN SERIES, FOR SPEEDS ≥ 45 MPH
  - 701901-01 TRAFFIC CONTROL DEVICES
  - 720001-01 SIGN PANEL MOUNTING DETAILS
  - 720006-02 SIGN PANEL ERECTION DETAILS
  - 720011-01 METAL POSTS FOR SIGNS, MARKERS AND DELINEATORS
  - 780001-02 TYPICAL PAVEMENT MARKINGS
  - BLR 21-8 TYPICAL APPLICATION OF TRAFFIC CONTROL DEVICES FOR CONSTRUCTION ON RURAL LOCAL HIGHWAYS

**DESIGN DESIGNATION**

HIGHWAY CLASS: RURAL COLLECTOR  
DESIGN SPEED: 55 M.P.H.  
ADT = 1300  
DESIGN GUIDELINES: 3R

COMMITMENTS: NONE  
VARIANCES GRANTED: NONE

CONTRACT NO. 89559  
JOB NO. C-94-010-10

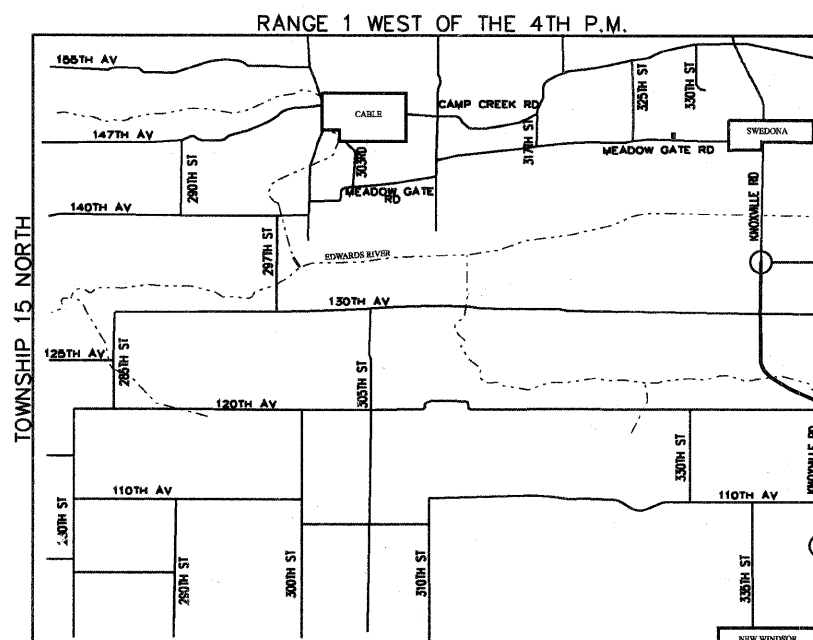

**LOCATION MAP**

TOTAL LENGTH OF PROJECT = 17,124.94 ft. (3.24 mi)  
NET LENGTH OF PROJECT = 17,124.94 ft. (3.24 mi)

PROPOSED IMPROVEMENT  
BEGINS STA. 257+10.06

PROPOSED IMPROVEMENT  
ENDS STA. 428+35.00

I HEREBY CERTIFY THAT THIS ENGINEERING DOCUMENT  
WAS PREPARED BY ME OR UNDER MY DIRECT SUPERVISION  
AND THAT I AM A DULY LICENSED PROFESSIONAL  
ENGINEER UNDER THE LAWS OF THE STATE OF ILLINOIS.

*Bryce A. Johnson* 12/16/09  
BRYCE A. JOHNSON DATE  
LICENSE EXPIRES 11/30/2011

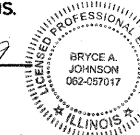

Civil Engineering • Surveying • Environmental Services  
Rock Island, Illinois • Rockford, Illinois • Stettendorf, Iowa • Des Moines, Iowa  
(309) 788-7844 FAX (309) 788-7891  
MSA JOB #: A09T019

APPROVED	<i>Dec 16</i>	20 <i>09</i>
	COUNTY ENGINEER	
APPROVED		20
	ROAD COMMISSIONER	
PASSED	<i>12-23</i>	20 <i>09</i>
	DISTRICT FOUR ENGINEER OF LOCAL ROADS & STREETS	
Releasing For Bid Based on Limited Review	<i>12-23</i>	20 <i>09</i>
	DEPUTY DIRECTOR OF HIGHWAYS, REGION THREE ENGINEER	
STATE OF ILLINOIS DEPARTMENT OF TRANSPORTATION		